

- (D) Montageanleitung
- (NL) Handleiding voor de montage
- (HU) Szerelési útmutató
- (GB) Assembly instructions

- (PL) Instrukcja montażu
- (RO) Instrucțiuni de montaj
- (FR) Notice de montage
- (CZ) Montážní návod
- (TR) Montaj talimatı
- (IT) Istruzioni di montaggio
- (SK) Návod na montáž
- (RU) Инструкция по монтажу

**Service • Assistenza • Dienstverlening • Serwis
Servis • Szerviz • Сервисная служба**

Name • Nom • Nome • Naam •
Nazwa • Jméno • Názov • Név •
Denumire • Isim • Название

Nr. • No. • N° • Номер • Č • Sz

Typ • Type • Tip • Tipus • Тип •
Тип

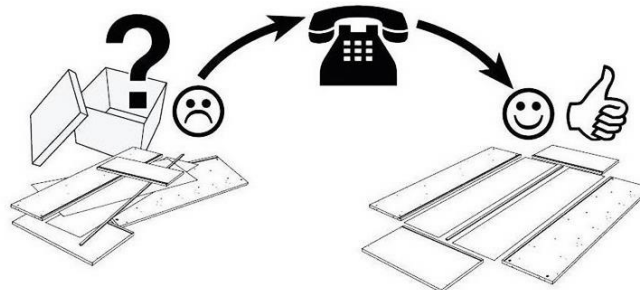
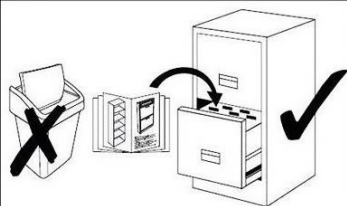

1	1x	ca. 1520 x 330 mm
2a	1x	ca. 1501 x 330 mm
3b	1x	ca. 1520 x 330 mm
4b	1x	ca. 318 x 330 mm

50b	2x	ca. 318 x 315 mm
51b	1x	ca. 318 x 315 mm
6	4x	ca. 352 x 377 mm
7b	1x	ca. 318 x 330 mm

1 ≠ **3b**

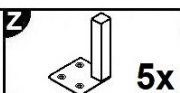
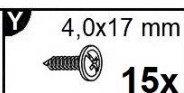
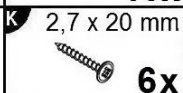
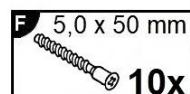
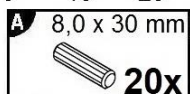
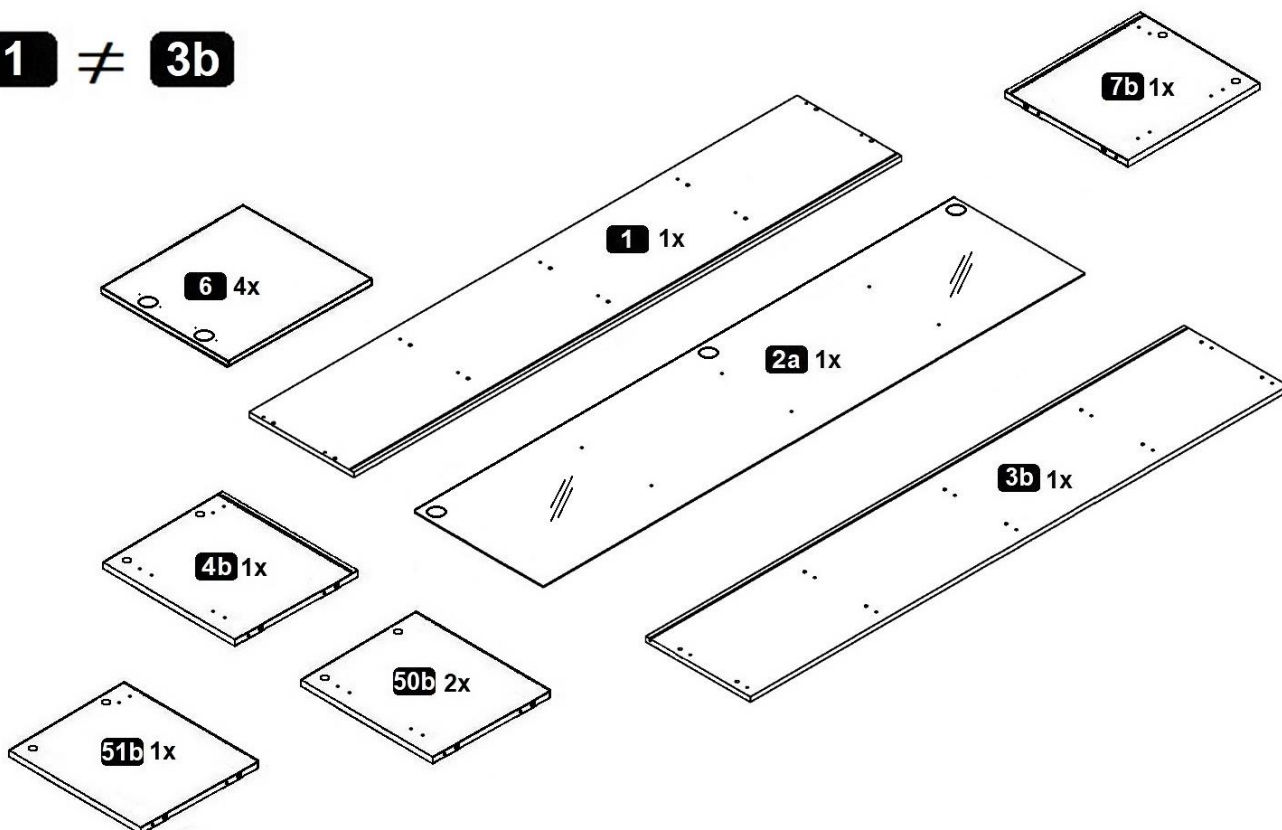

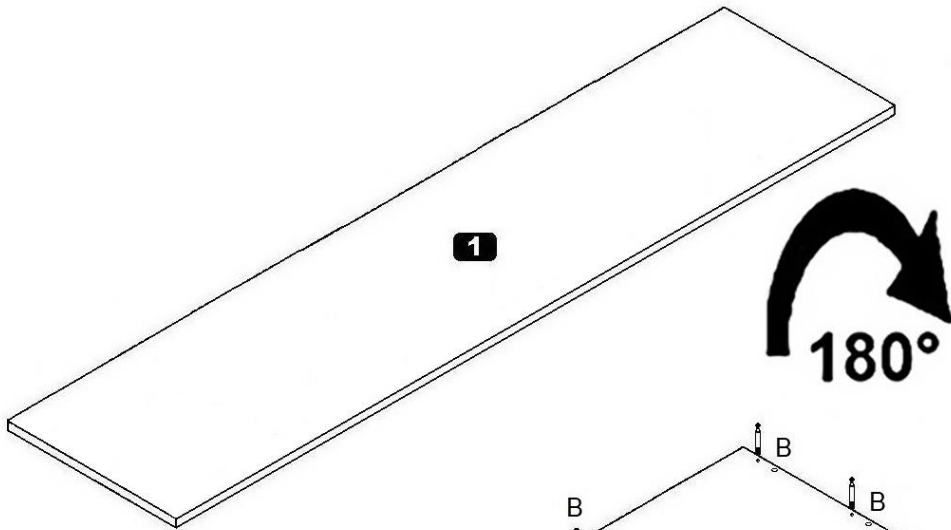
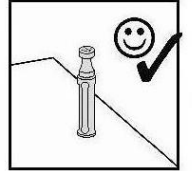
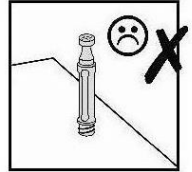
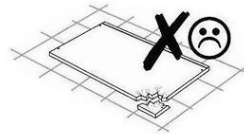
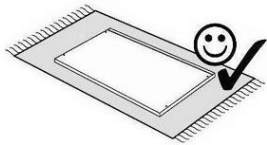
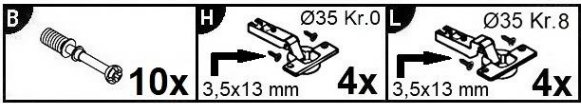

1

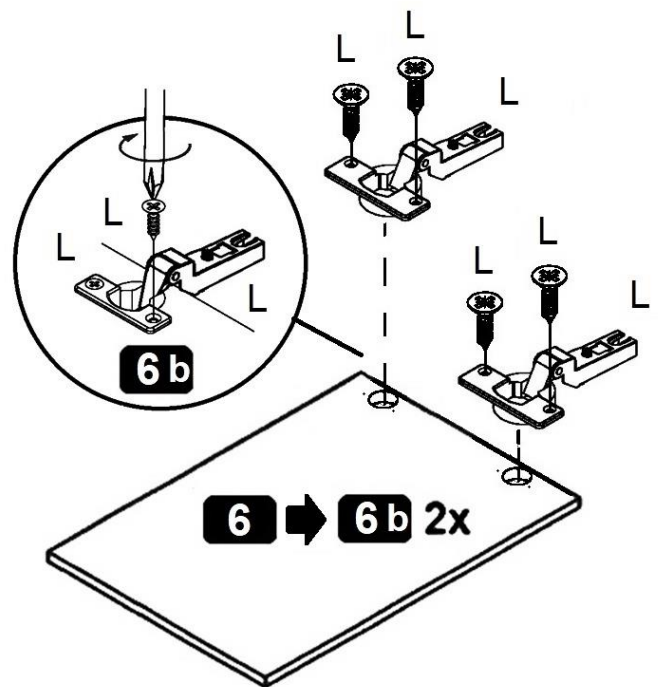
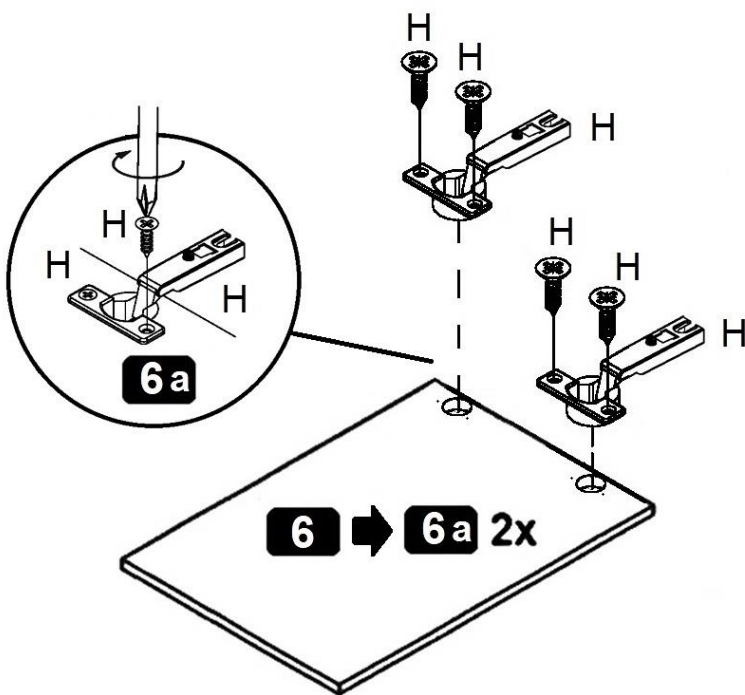
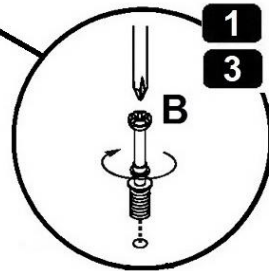
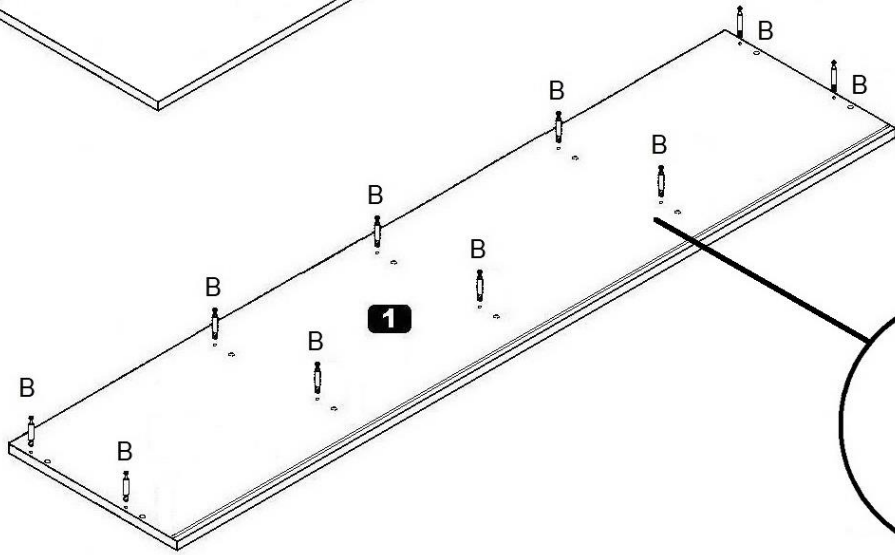

180°



2

A 8,0 x 30 mm	C	h=2
 20x	 10x	 8x

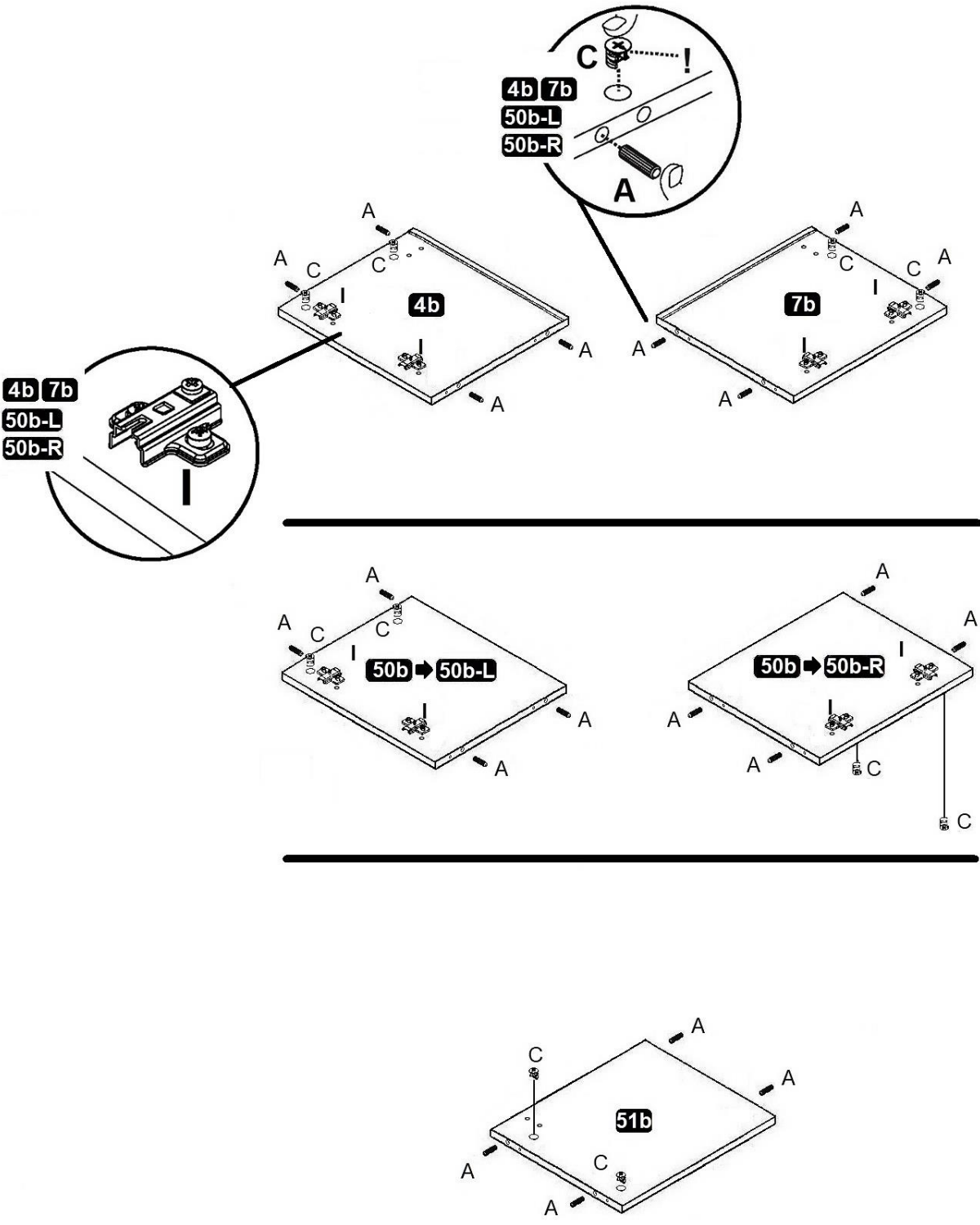
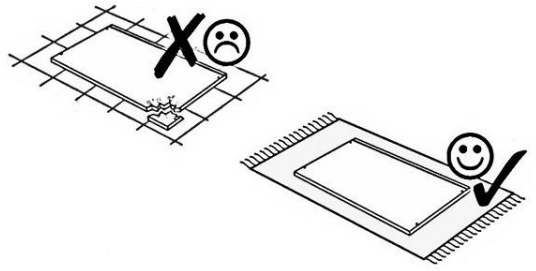

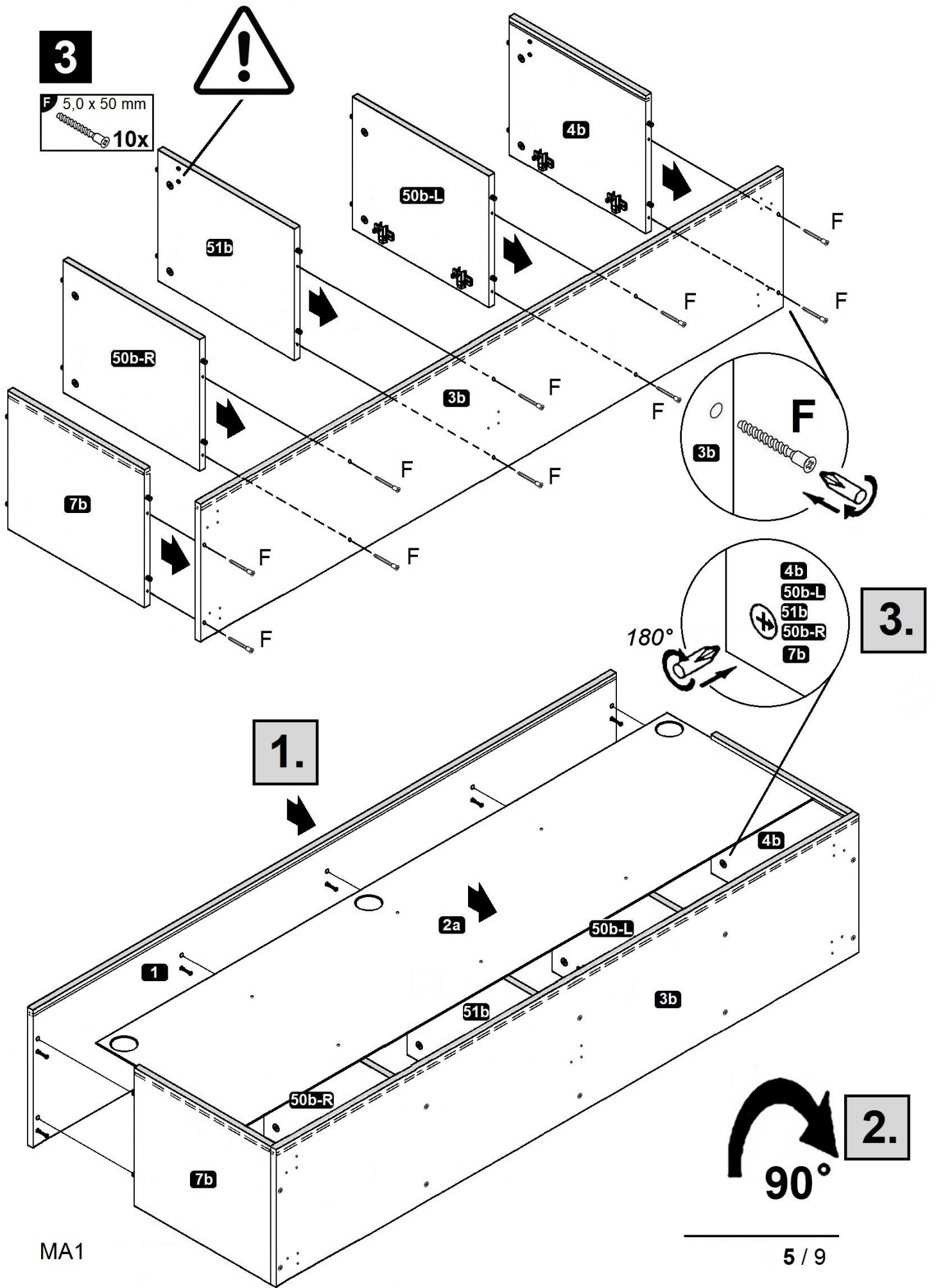

4

K 2,7 x 20 mm
6x

1.
90°

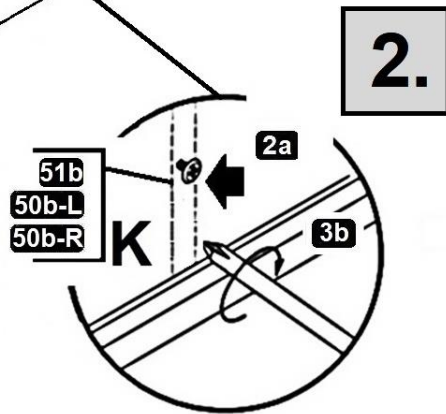
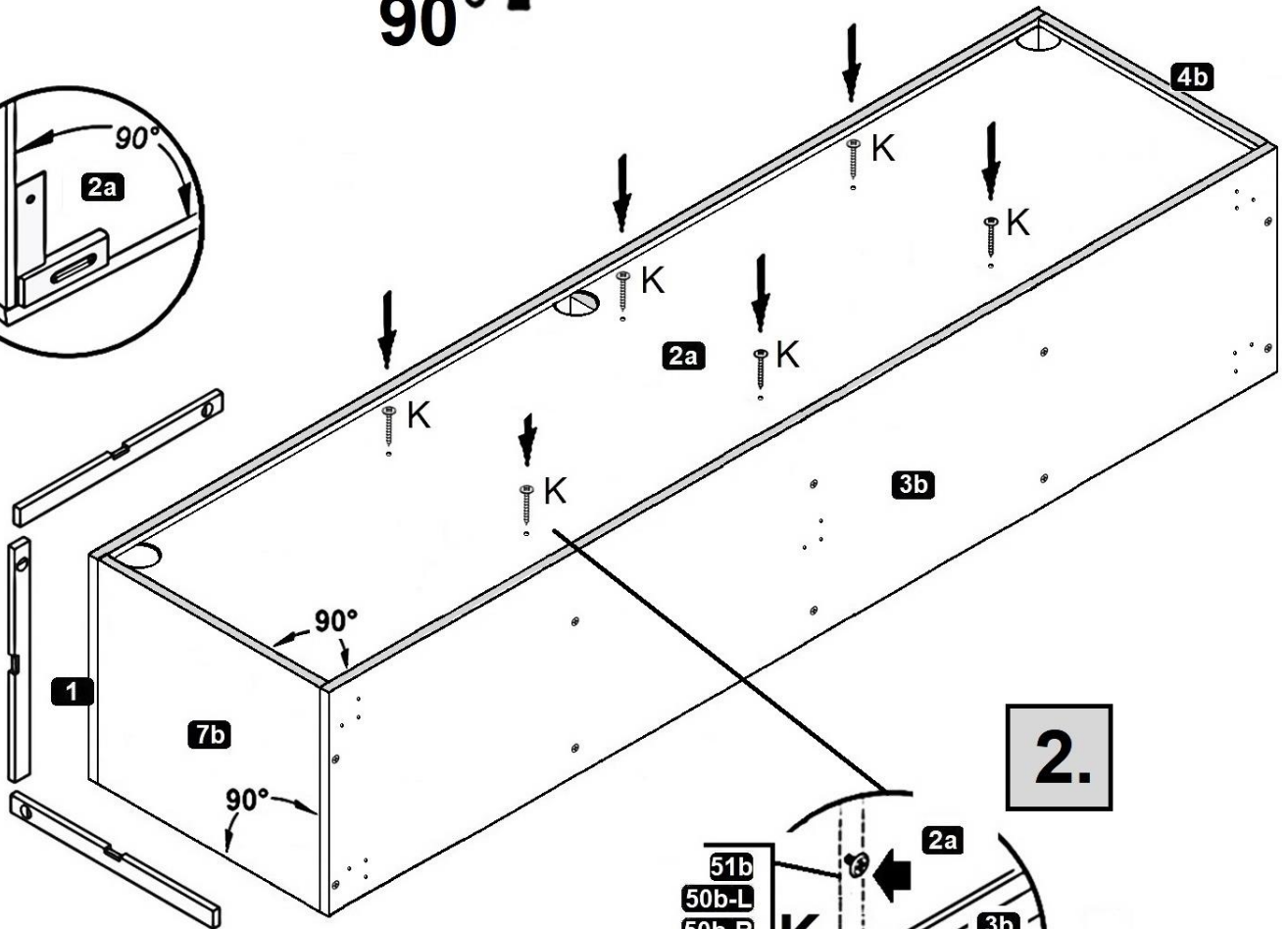
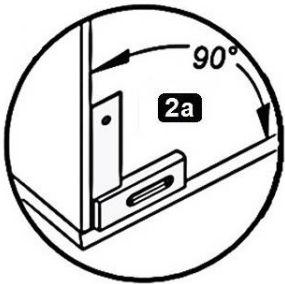

3. 90° 180°

5

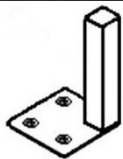

- | | |
|--|---|
| (D) Montage der Metallfüße | (CZ) Montáž kovových nožiček |
| (GB) Assembly of the metal feet | (RO) Asamblarea picioarelor metalice |
| (FR) Assemblage des pieds métalliques | (HU) A fém lábak összeszerelése |
| (IT) Montaggio dei piedini in metallo | (SK) Montáž kovových nožičiek |
| (NL) Montage van de metalen voetjes | (TR) Metal ayakların montajı |
| (PL) Montaż metalowych nóżek | (RU) Asamblarea picioarelor metalice |

X M4x16 mm 10x	Y 4,0x17 mm 15x	Z 5x
----------------	-----------------	------

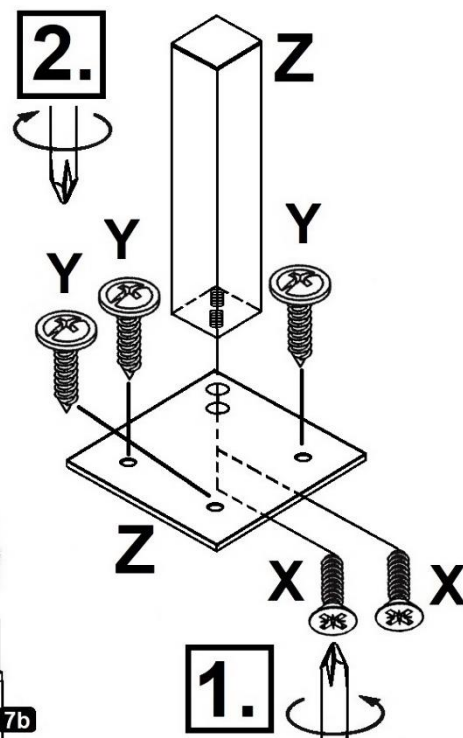
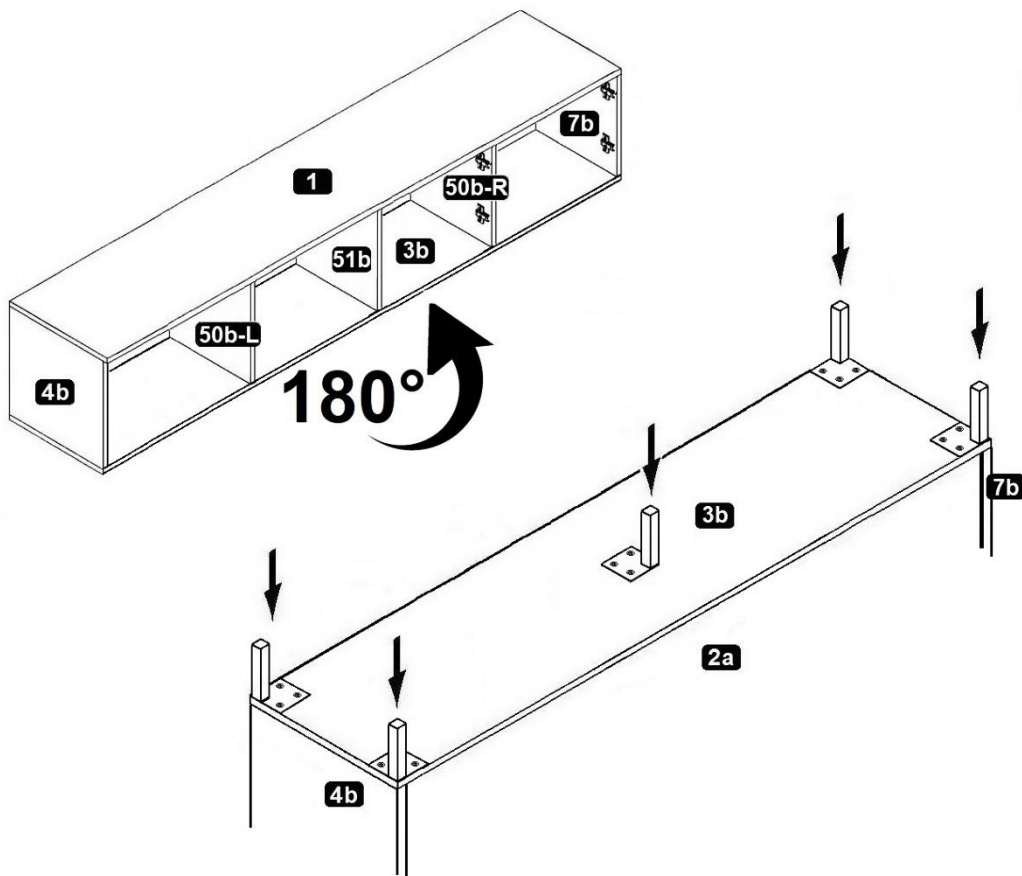

6

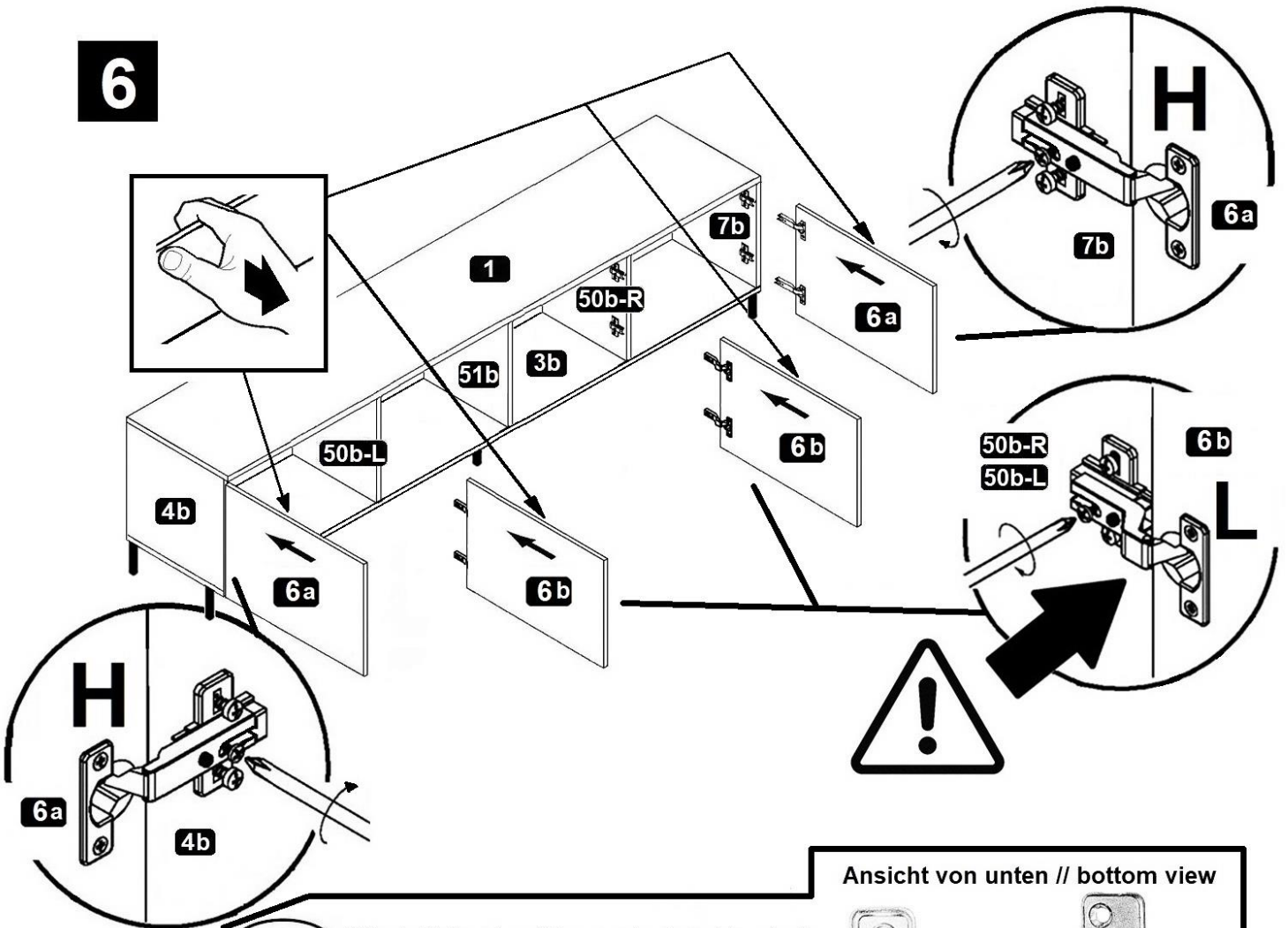

- D** Bitte in Schraubenführung stecken. Eventuell Verstellerschraube leicht herausdrehen.
- GB** Please put in screw guide. If necessary, unscrew the adjusting screw slightly.

Ansicht von unten // bottom view

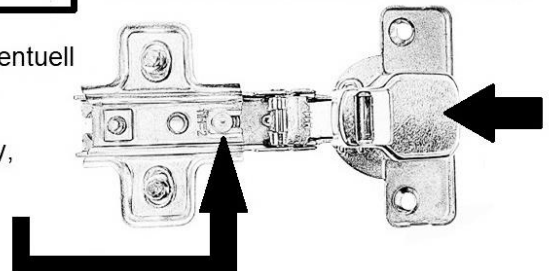

➔ 9 / 9

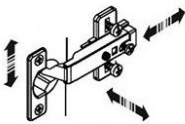

- D** Türen einstellen (Scharniere justieren)
- GB** Adjusting the doors (adjusting the hinges)
- FR** Régler les portes (ajuster les charnières)
- IT** Sistemare le porte (regolare le cerniere)

- NL** Deuren instellen (scharnieren afstellen)
- PL** Nastawić drzwi (wyregulować zawiasy)
- CZ** Vyrovnajte dvířka (seřid'te závěsy)
- RO** Nastavenie dverí (nastavenie závesov)
- HU** Állítsa be az ajtókat (állítsa be a zsanérokot)
- SK** Reglare uši (ajustare balamale)
- TR** Kapıların ayarlanması (menteşelerin seviye ayarı)
- RU** Регулировка дверей (регулировка шарнира)

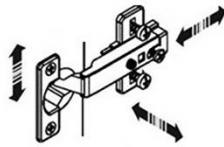
7

(D) Türen einstellen
(Scharniere justieren)

(GB) Adjusting the doors
(adjusting the hinges)

(FR) Régler les portes
(ajuster les charnières)

(IT) Sistemare le porte
(regolare le cerniere)

(NL) Deuren instellen
(scharnieren afstellen)

(PL) Nastawić drzwi
(wyregulować zawiasy)

(CZ) Vyrovnajte dvířka
(seřid'ťe závěsy)

(RO) Nastavenie dverí
(nastavenie závesov)

(HU) Állítsa be az ajtókat
(állítsa be a zsanérokat)

(SK) Reglare uši
(ajustare balamale)

(TR) Kapıların ayarlanması
(menteşelerin seviye ayarı)

(RU) Регулировка дверей
(регулировка шарнира)

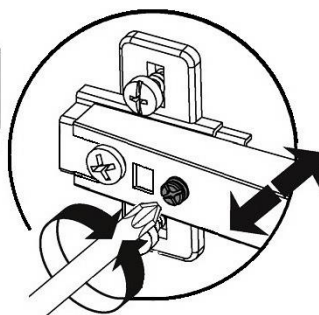
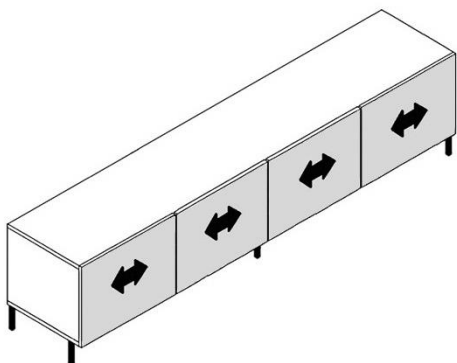
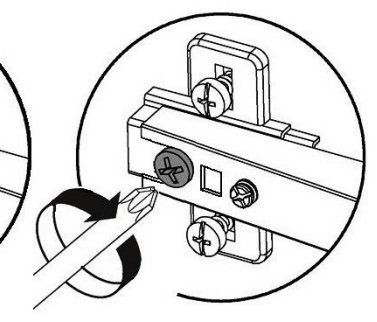
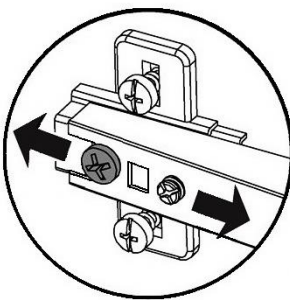
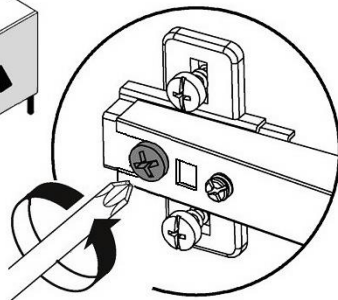
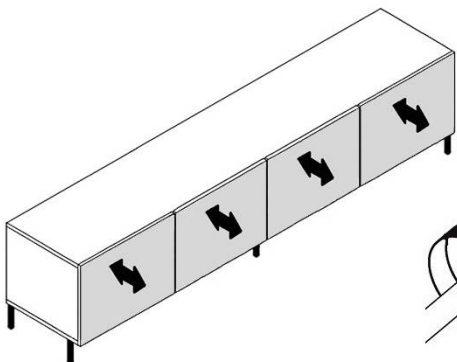
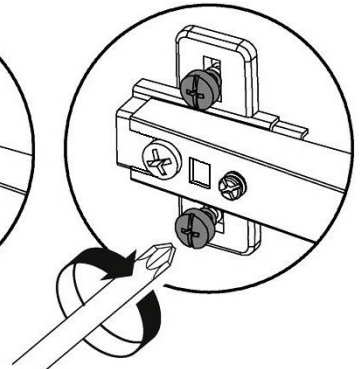
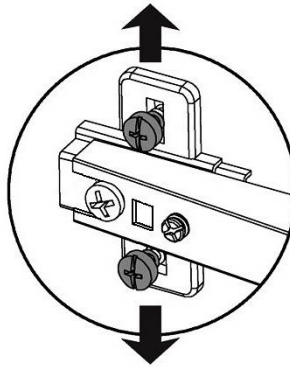
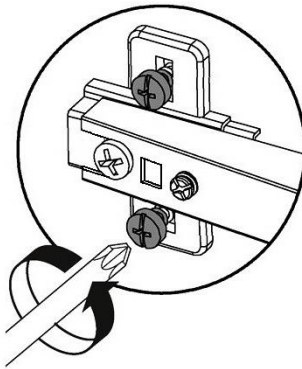
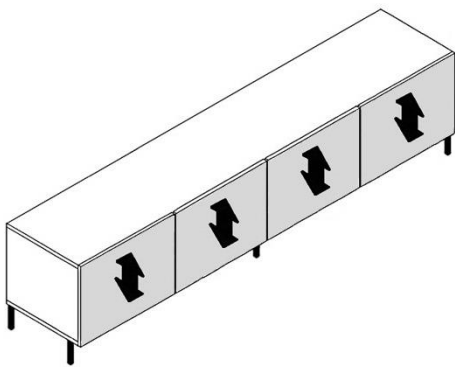

MA1