

SPECIFICATION:

Operating Voltage (Max.): 60 Vdc
 Operating Current (Max.): 24 A
 Operating Temperature: -10°C to 70°C
 Measuring Category: 0

MATERIAL:

Material (Housing): ABS
 Material (Contact Area): brass, nickel plated

HANDLING:

Terminal: screw

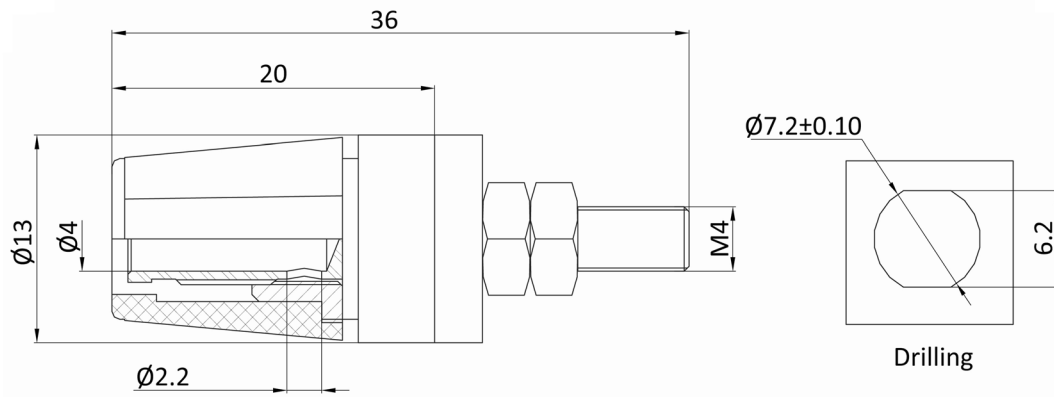

Order Information

Identifier:

PKI40

Colour:

#

Binding post 4 mm insulated

SW: black

RT: red

BL: blue

GE: yellow

GN: green