

# GOEBEL

## M 10

D1 = 12,9 mm

D2 = 14,5 mm

L1 = 8,2 / 10,7 mm

k = 1,0 mm

 13,0 mm

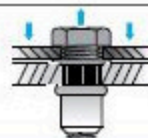
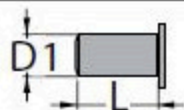

12,9 x 19,5 mm

0,8 - 3,5 mm

75510 12000

37000 N

12,9 x 22,0 mm

3,5 - 6,0 mm

75510 12001

48,0 Nm