

OPERATION

(Wi-Fi) Guide

OPERATION GUIDE:

01 Please ensure your mobile device is connected to WiFi router. Also, the WiFi router should already be connected to the Internet before doing user registration and network configuration process.

02 **Download and Install APP:**

Use your phone to scan the QR code below or search in APP store to download and install the App.

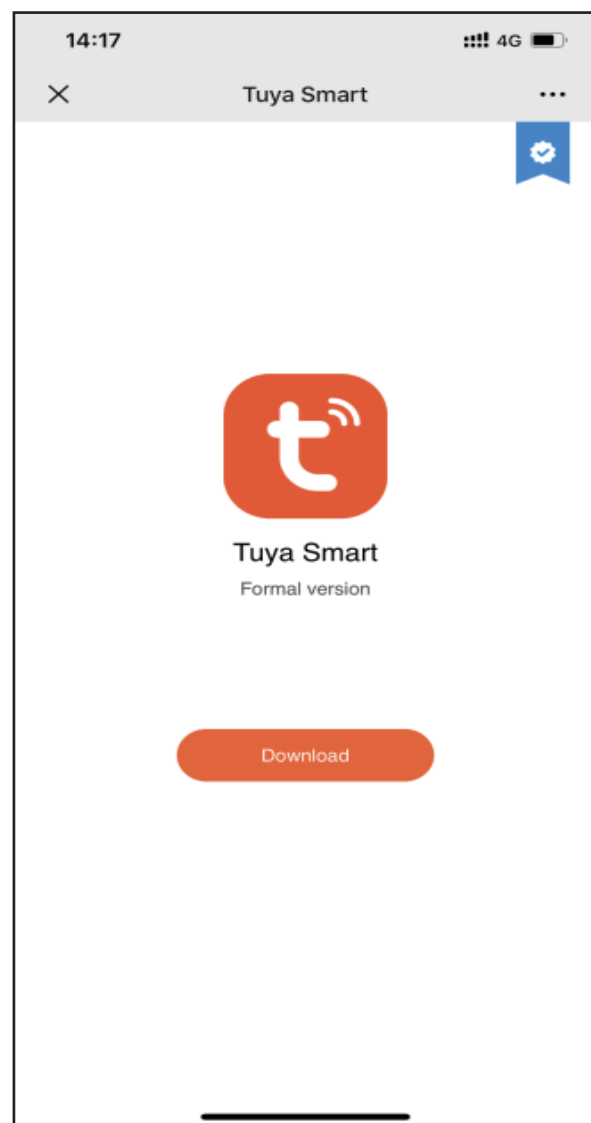

* The above wifi instruction pictures are only for reference. Always follow the on-screen instructions in the TUYA app for guidance.

OPERATION

(Wi-Fi) Guide

OPERATION GUIDE:

03 Registration

1. Tab the Register.
2. Enter your Mobile Number or Email. Get the Verification Code and type in.
3. Enter your Password and confirm to finish your registration.

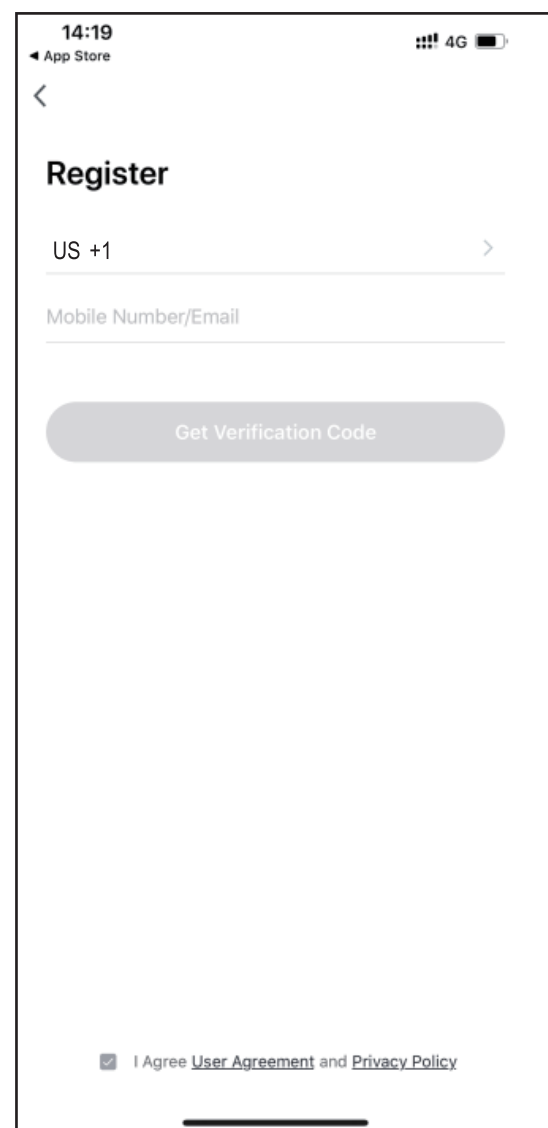
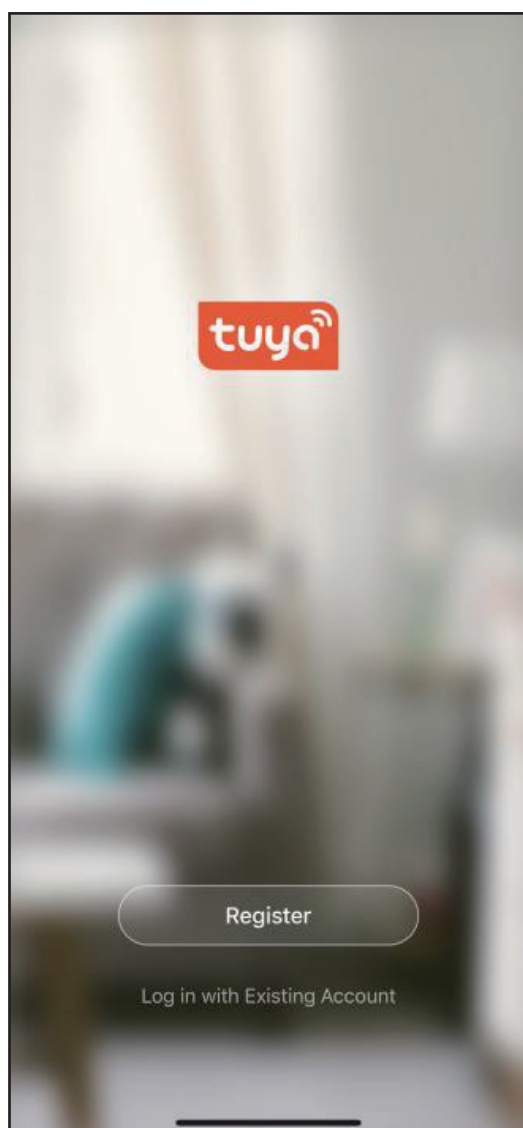

* The above wifi instruction pictures are only for reference. Always follow the on-screen instructions in the TUYA app for guidance.

OPERATION

(Wi-Fi) Guide

OPERATION GUIDE:

04 Add a new unit.

1. Tab the Add device.
2. Follow the prompts, turn on Bluetooth

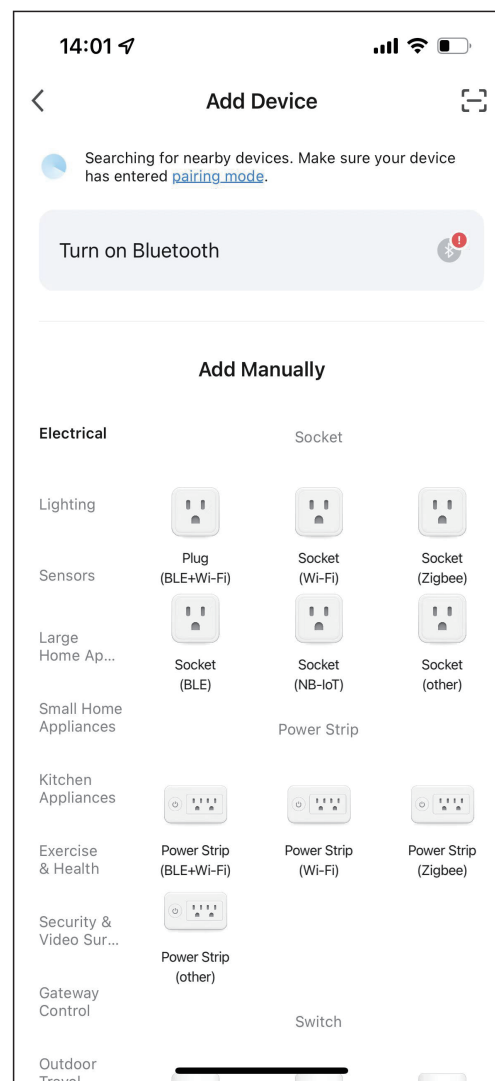
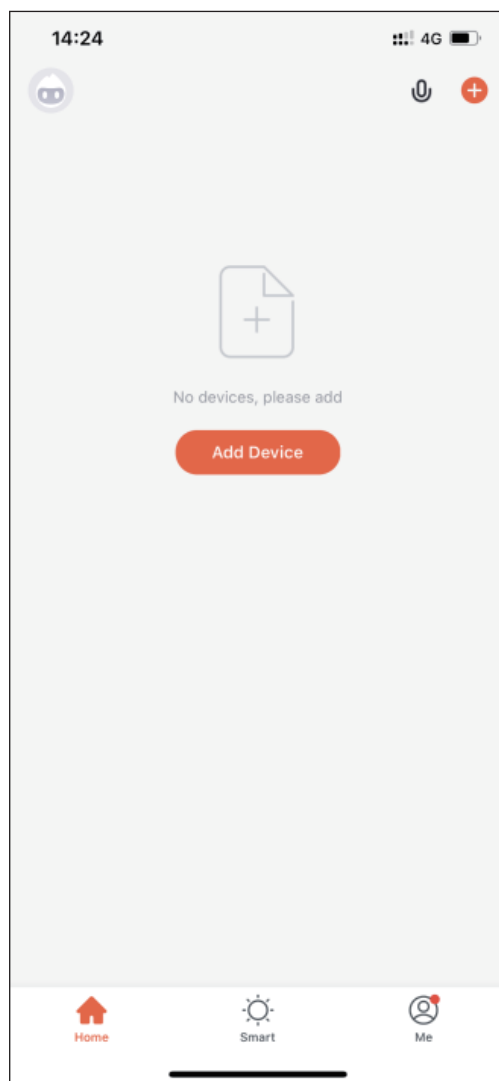

* The above wifi instruction pictures are only for reference. Always follow the on-screen instructions in the TUYA app for guidance.

OPERATION

(Wi-Fi) Guide

OPERATION GUIDE:

04 Add a new unit.

1. After connecting to Bluetooth, the device will automatically pop out.
2. Tab “Go to add”

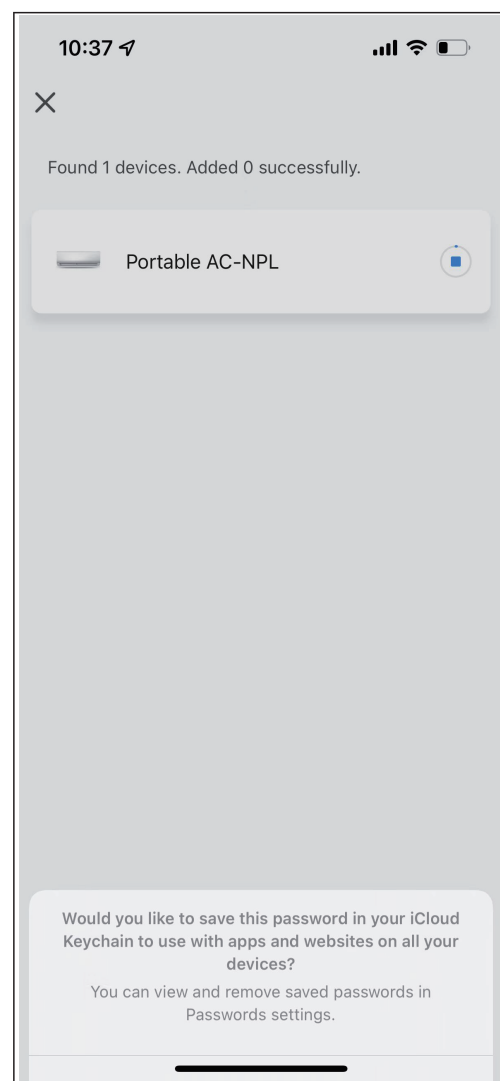
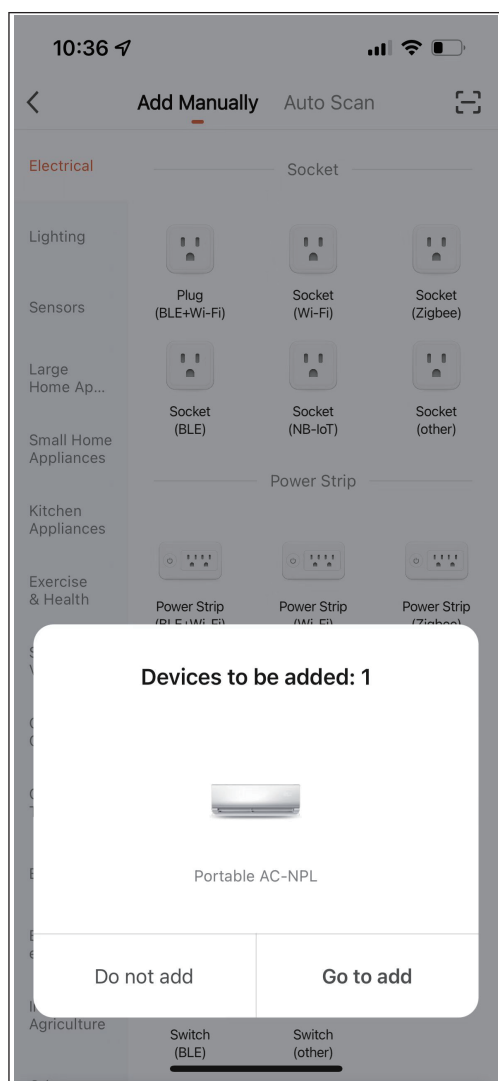

*** The above wifi instruction pictures are only for reference. Always follow the on-screen instructions in the TUYA app for guidance.**

OPERATION

(Wi-Fi) Guide

OPERATION GUIDE:

04 Add a new unit.

3. Wait for a while, until the device add successfully.
4. Tab Next to get the control of your Portable air conditioner.

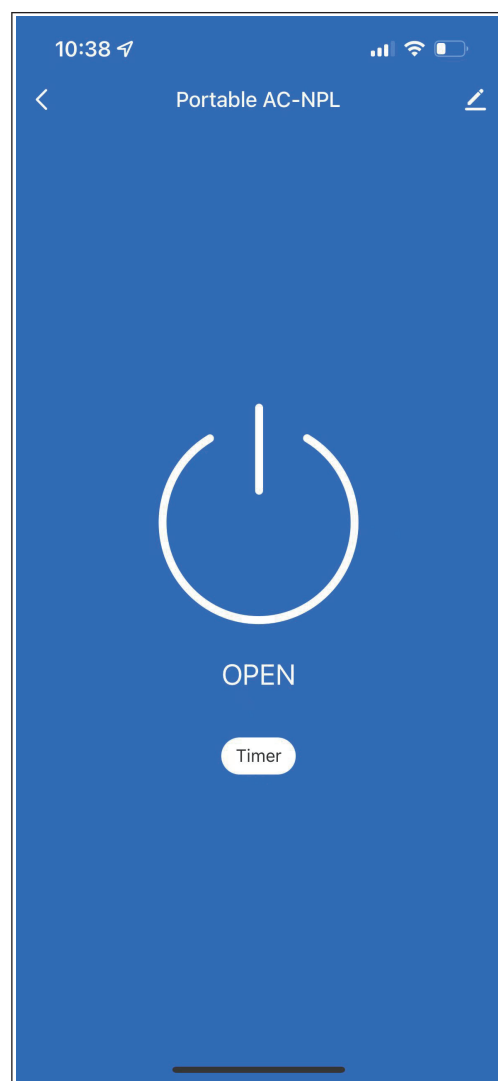
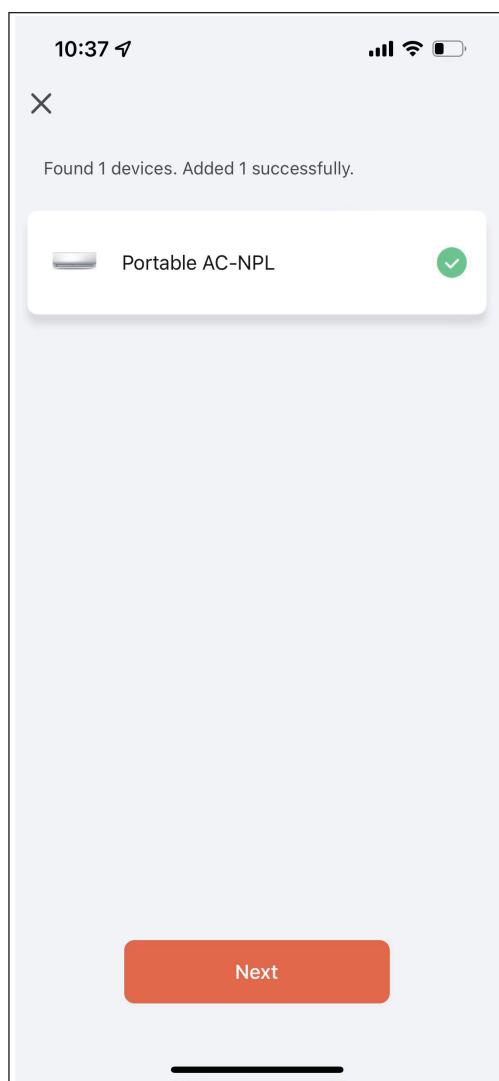

*** The above wifi instruction pictures are only for reference. Always follow the on-screen instructions in the TUYA app for guidance.**

OPERATION

(Wi-Fi) Guide

OPERATION GUIDE:

04 Add a new unit.

1. If the device does not automatically pop up, you can choose to manually add.
2. Choose the Air Conditioner in Large Home Appliance.

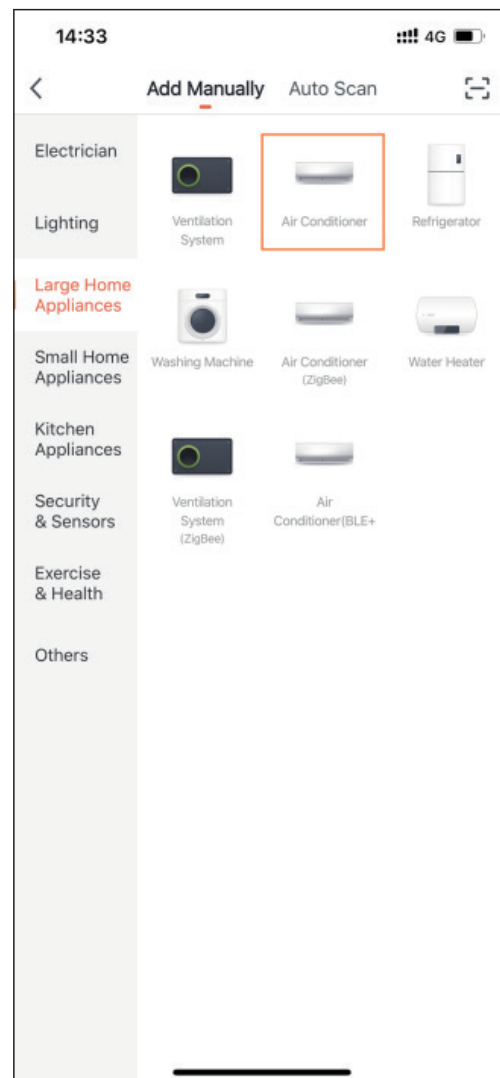
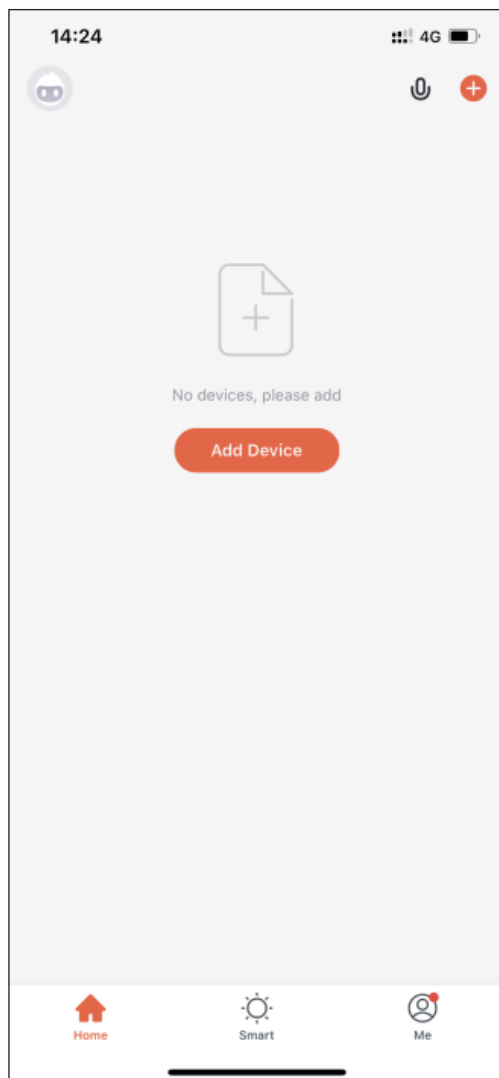

* The above wifi instruction pictures are only for reference. Always follow the on-screen instructions in the TUYA app for guidance.

OPERATION

(Wi-Fi) Guide

OPERATION GUIDE:

04 Add a new unit.

3. Touch the Timer button for 5 seconds, the WiFi icon will flash on the display screen.
4. Tab Confirm indicator rapidly blink.

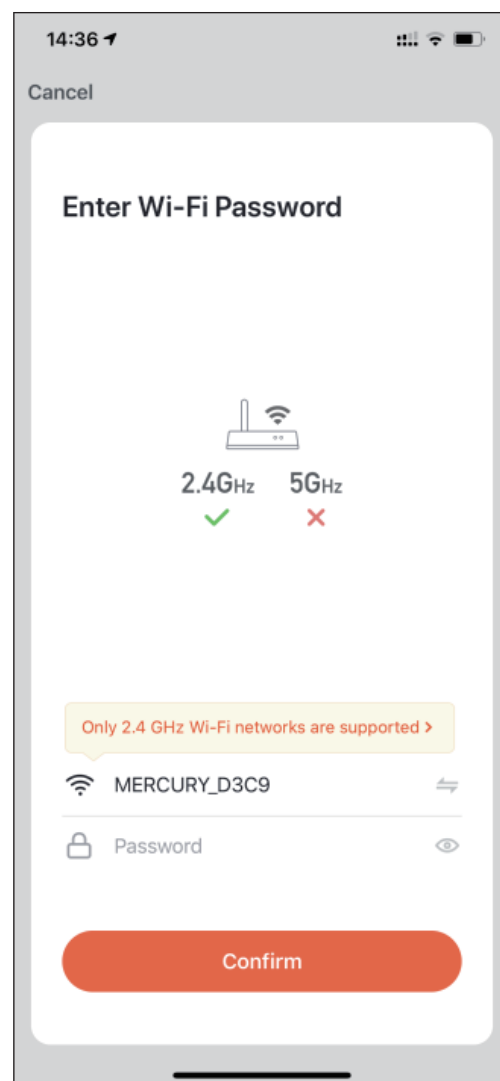
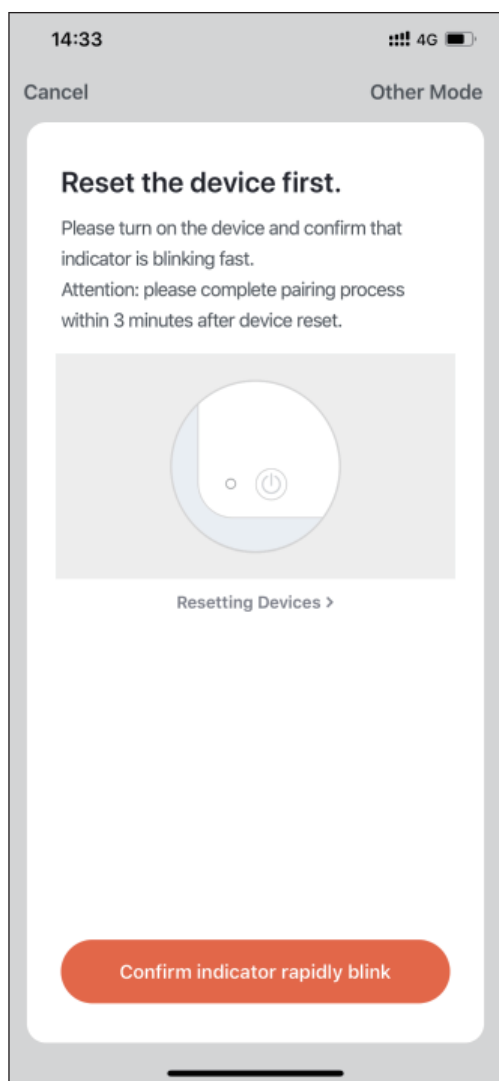

* The above wifi instruction pictures are only for reference. Always follow the on-screen instructions in the TUYA app for guidance.

OPERATION

(Wi-Fi) Guide

OPERATION GUIDE:

04 Add a new unit.

5. Enter WiFi password and Confirm.
6. The Connecting screen will show and wait until Device added successfully.
7. Tab Done to get the control of your Portable air conditioner.

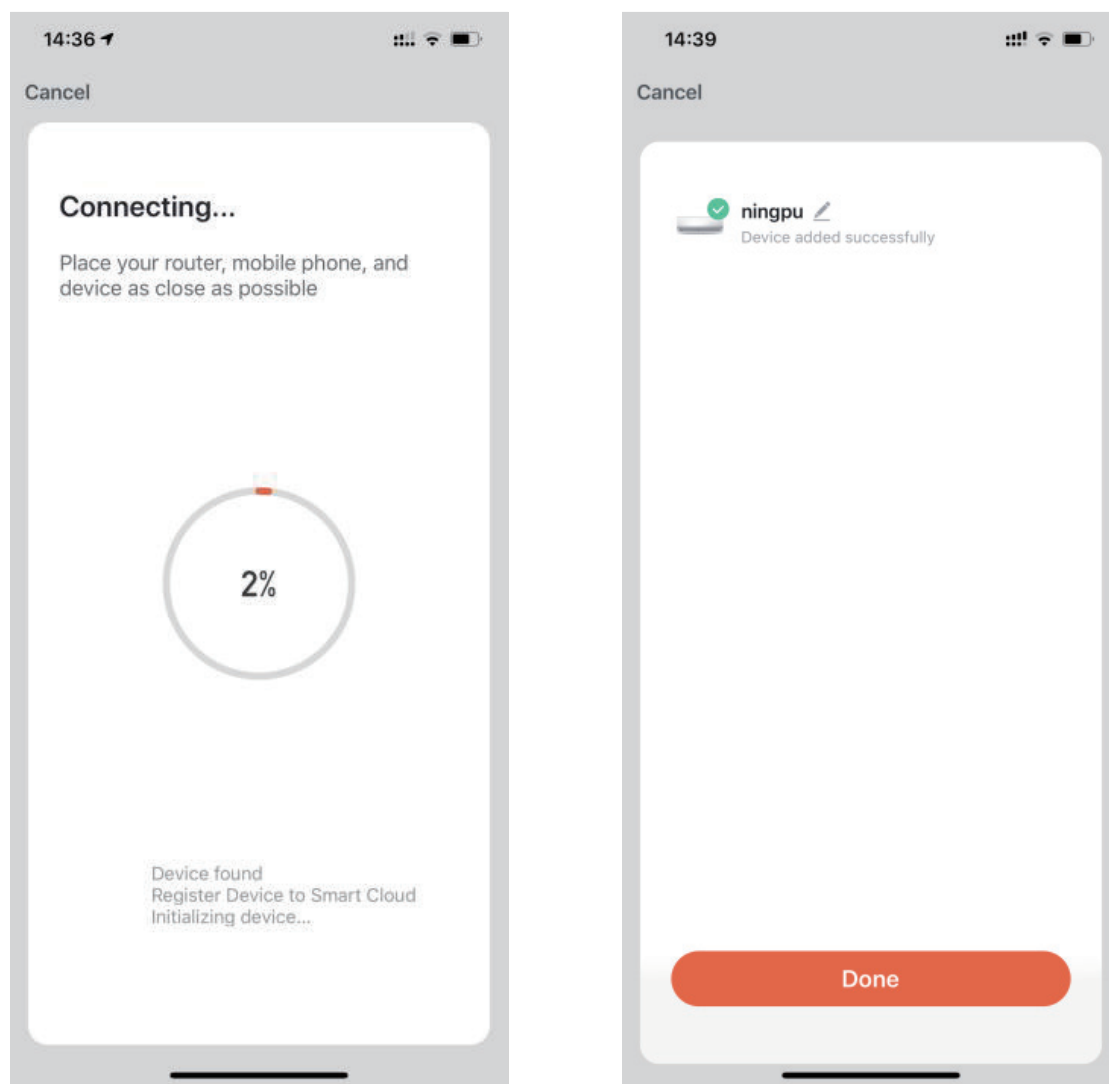

* The above wifi instruction pictures are only for reference. Always follow the on-screen instructions in the TUYA app for guidance.

OPERATION

(Wi-Fi) Guide

OPERATION GUIDE:

05 Now you can control the unit

1. Tab ON to turn on your AC.
2. Tab Timer to set when you need the AC to turn on.

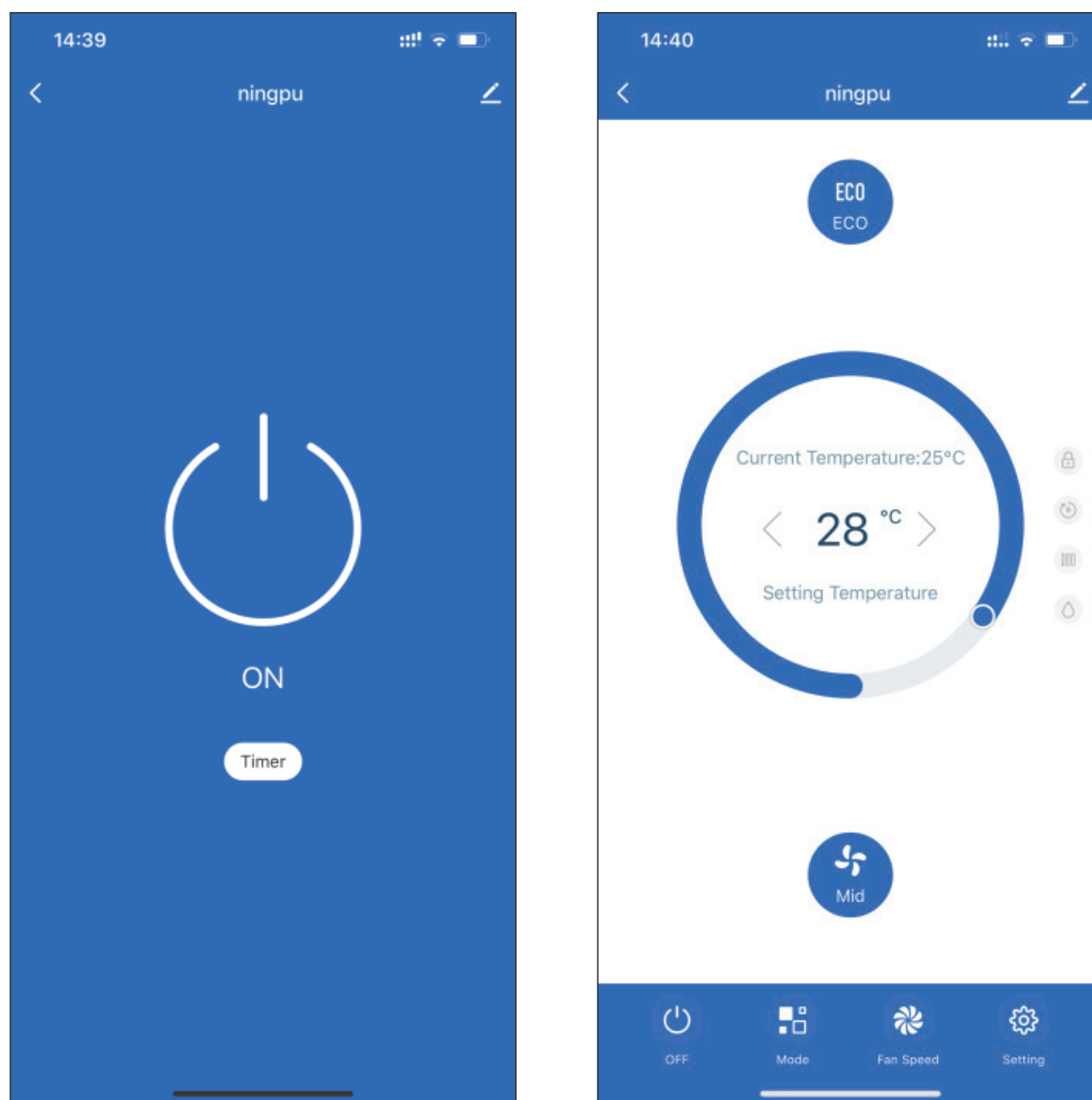

* The above wifi instruction pictures are only for reference. Always follow the on-screen instructions in the TUYA app for guidance.

OPERATION

(Wi-Fi) Guide

OPERATION GUIDE:

- 05 Now you can control the unit to set your room temperature whether you are driving on road or at the office.
3. Tab mode to select the mode.
4. Tab the Fan Speed to select the fan.

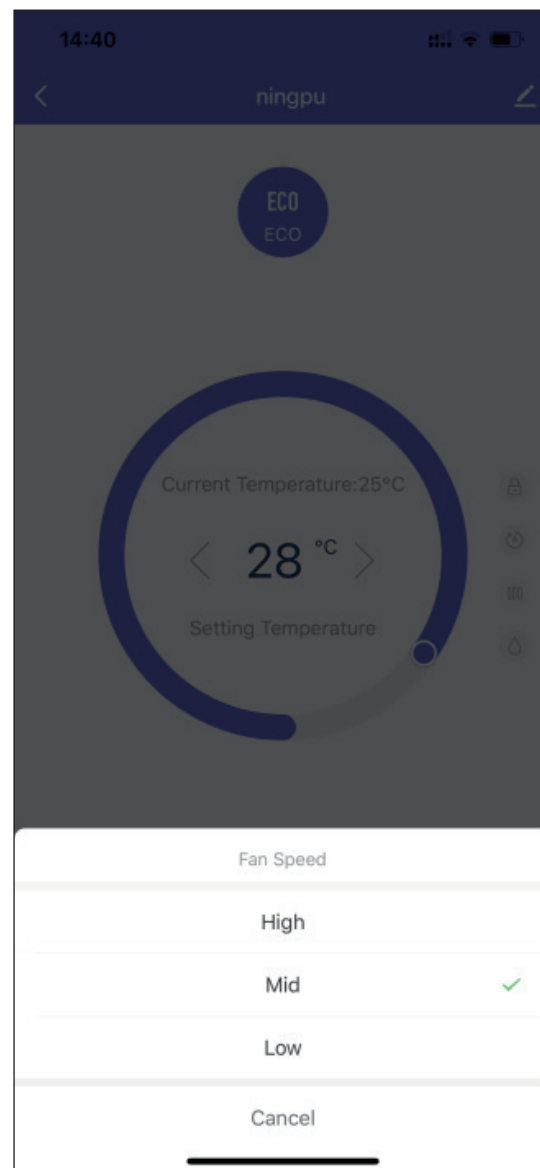
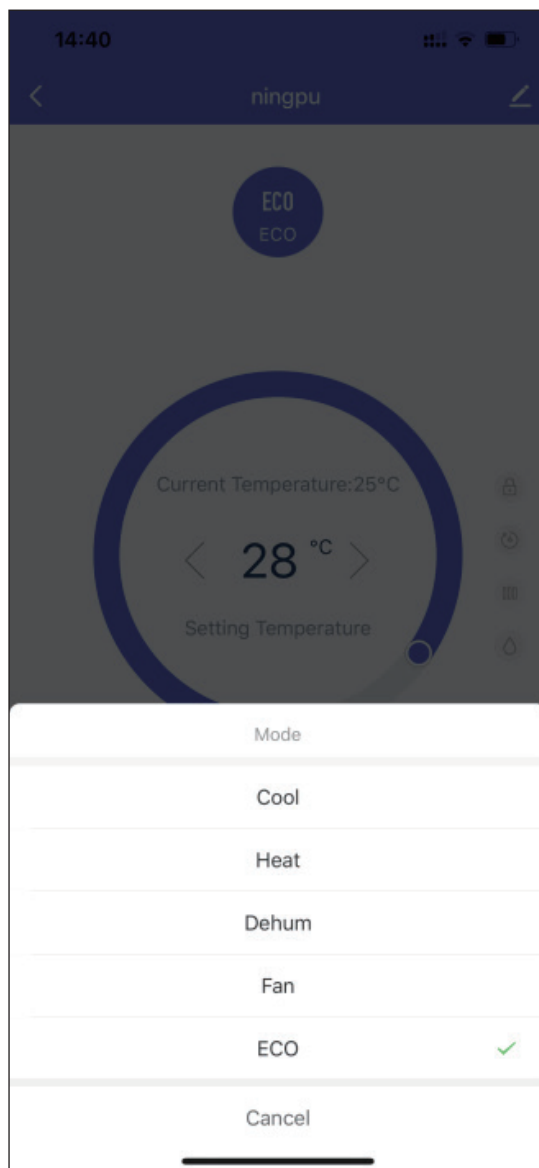

* The above wifi instruction pictures are only for reference. Always follow the on-screen instructions in the TUYA app for guidance.

OPERATION

(Wi-Fi) Guide

OPERATION GUIDE:

- 05 Now you can control the unit to set your room temperature whether you are driving on road or at the office.
5. Tab Setting to set the extra functions.
6. Tab the Pen icon in the right conner on the top to change the basic settings.

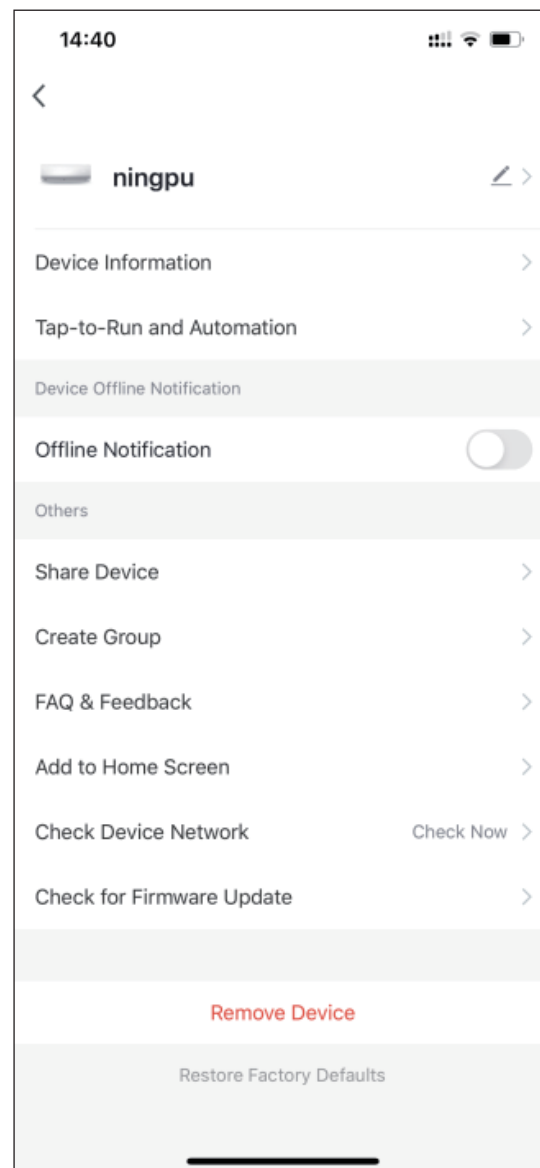
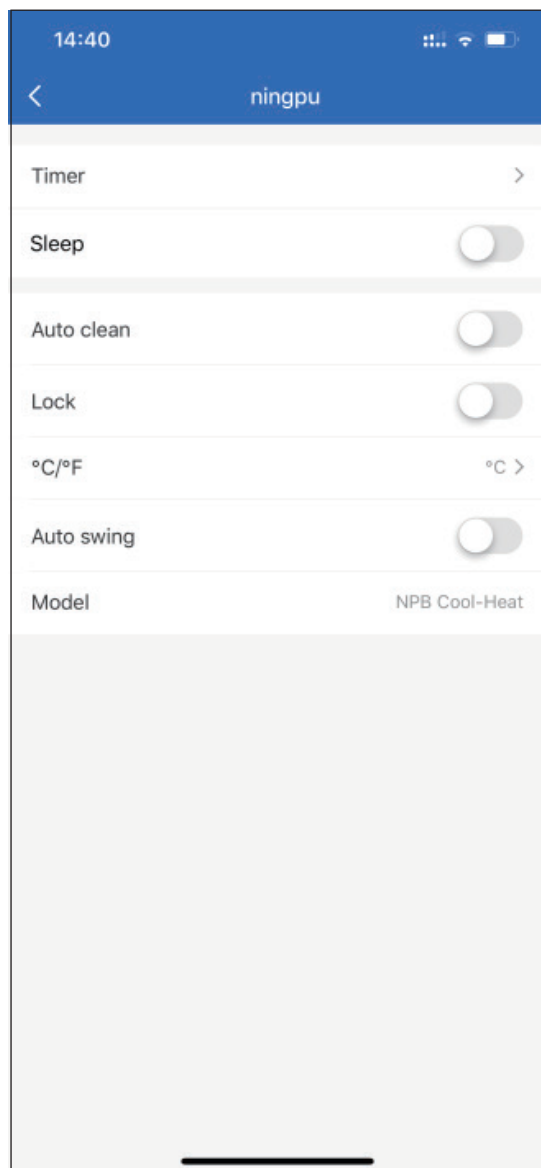

* The above wifi instruction pictures are only for reference. Always follow the on-screen instructions in the TUYA app for guidance.