

Ⓓ Aufbauanleitung

Ⓕ Notice de montage

Ⓖ Montagehandleiding

Ⓒ Montážní návod

Ⓗ Szerelési útmutató

Ⓙ Montaj talimatları

ⒼⒸ Assembly instruction

Ⓘ Istruzioni di montaggio

⒲ Instrukcja montażu

Ⓔ Navod na montaž

Ⓓ Instrucțiuni de montaj

Ⓔ Инструкция по монтажу

36-4281-82-09A

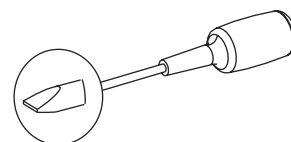
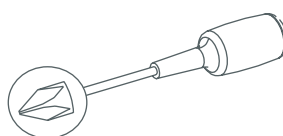
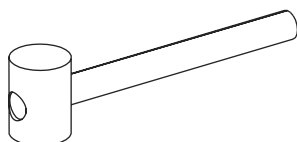
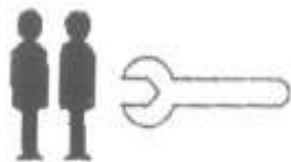
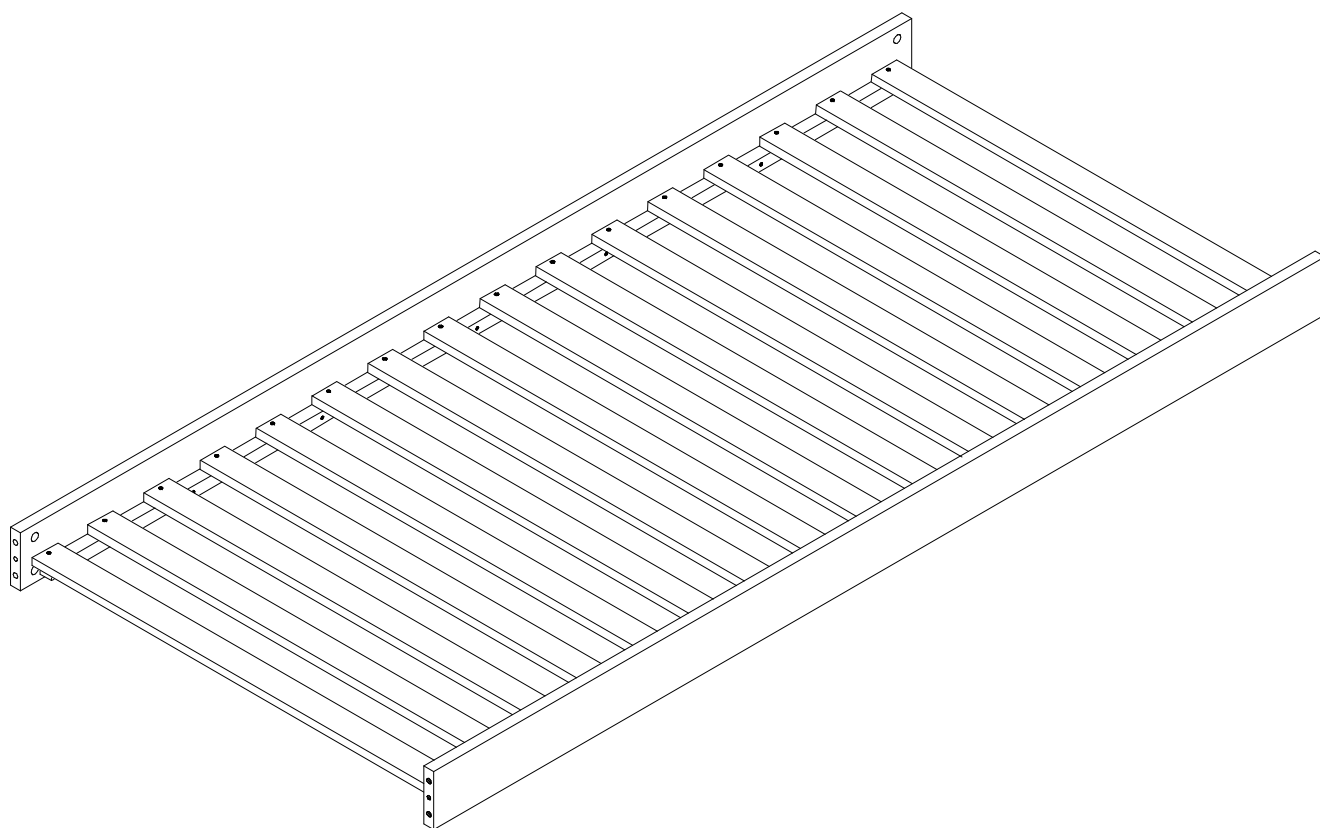

Service • Assistenza • Dienstverlening • Serwis Servis • Szerviz • Сервисная служба

Name • Nom • Nome • Naam • Nazwa • Jméno • Názov
Név • Denumire • Isim • Название

Nr. Nr. • No. • N° • Č • Sz • Номер

Typ • Тип • Type • Tip • Tipus • Druh • Тіро • Тип

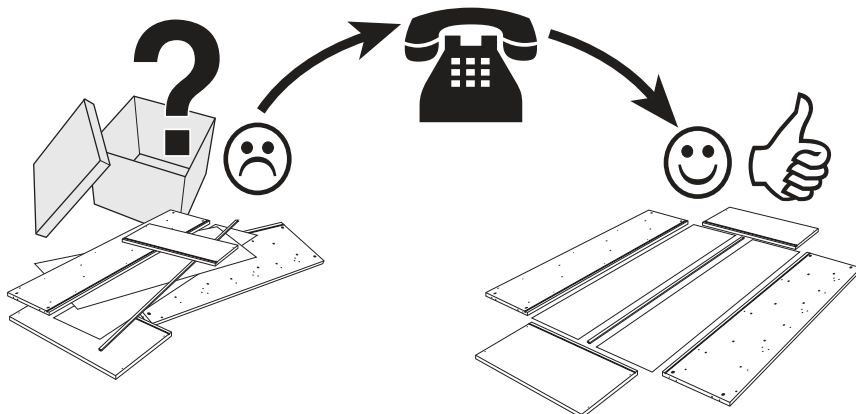
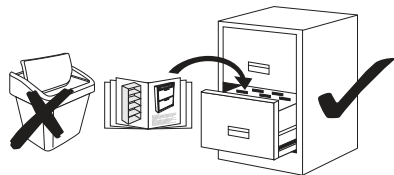

Detail specification

| A.i. Nr. | Article Nr. | pcs |
|----------|-------------|-----|
| 3 | 208748-32 | x2 |
| 4 | 108820-00 | x16 |

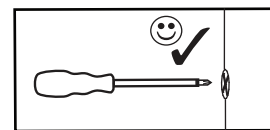
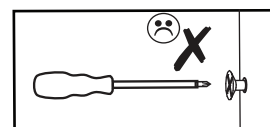
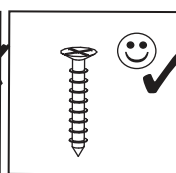
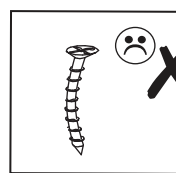
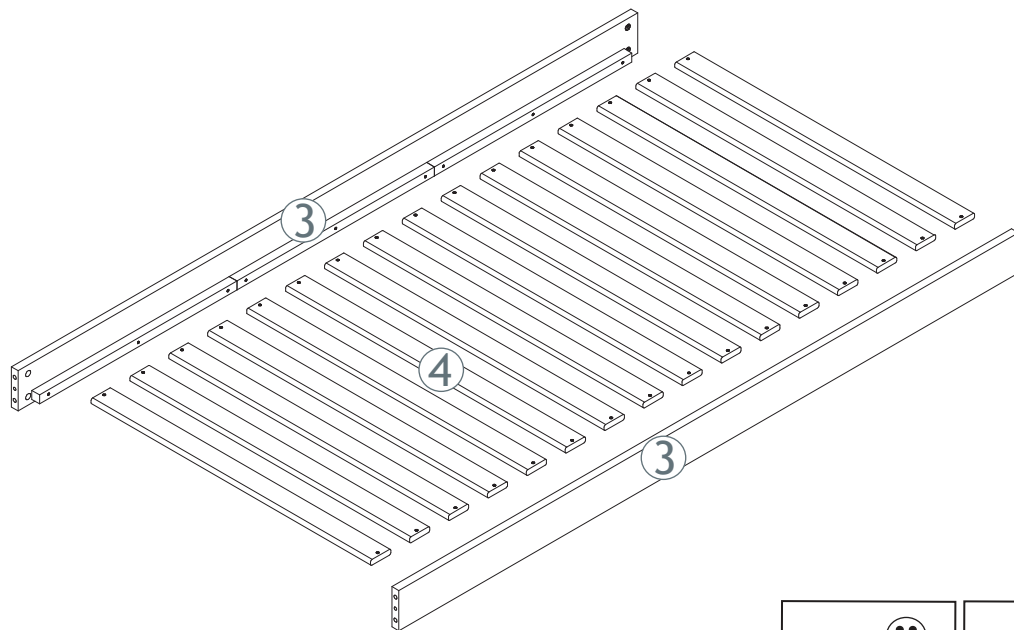

Fitting specification

| A.i. Nr. | Article Nr. | Dimentions | pcs |
|----------|-------------|------------|-----|
| a | 1-000013-00 | 8x40 | x4 |
| b | 1-000084-07 | 10x46 | x8 |
| c | 1-000085-07 | 16x20 | x8 |
| d | 1-000086-07 | M10x14 | x8 |
| e | 1-000012-07 | 3x30 | x32 |
| f | 1-000087-07 | 4x70 | x4 |

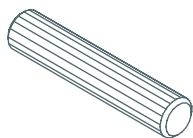

a

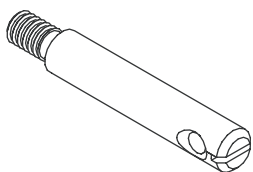

b

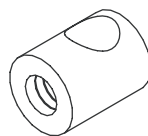

c



d



e

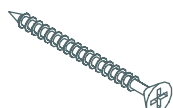

f

1-000001=

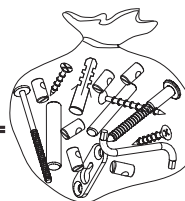

0
10
20
30
40
50
60
70
80
90
100
110
120
130
140
150
160
170
180

1.

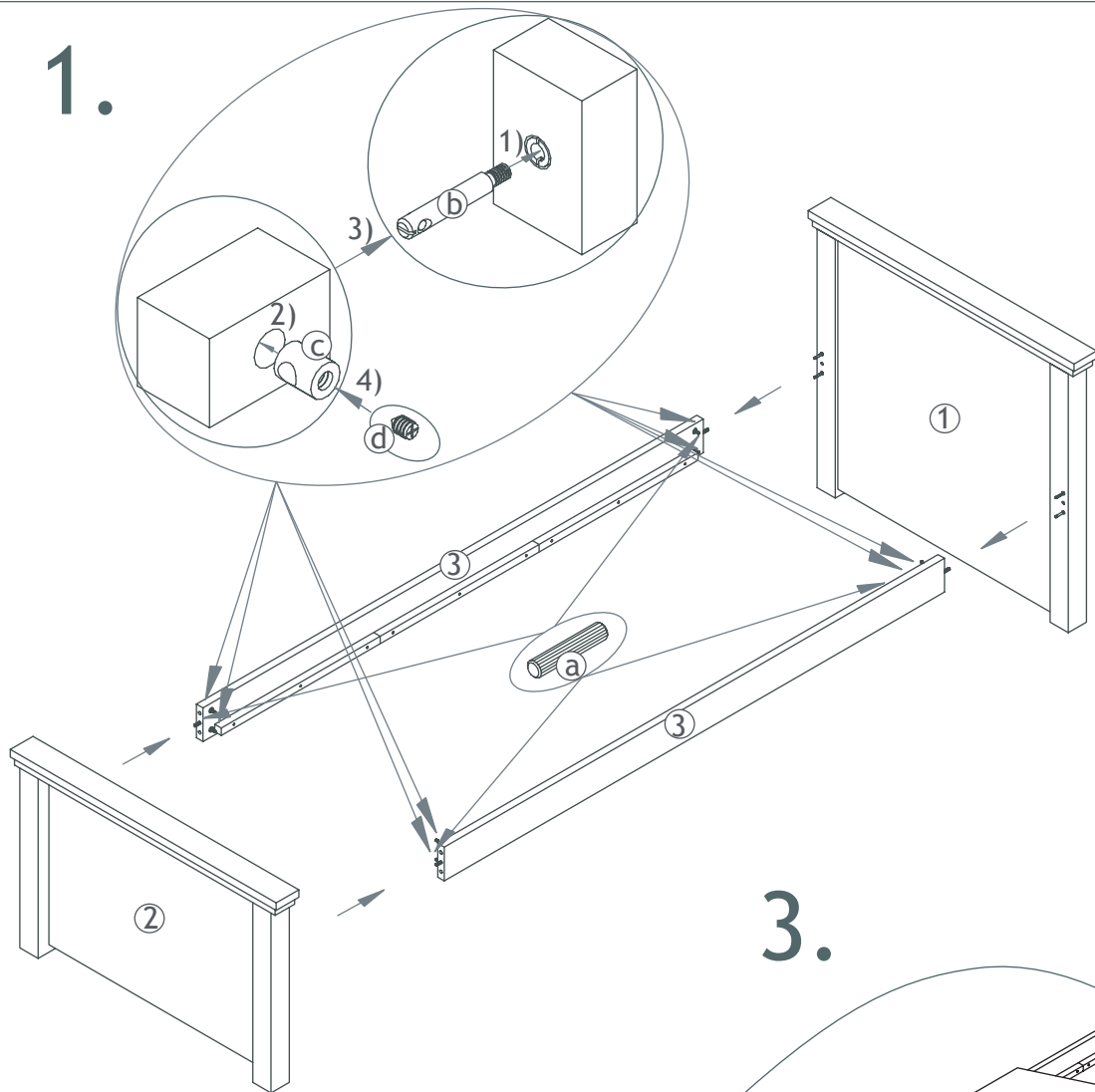

2.

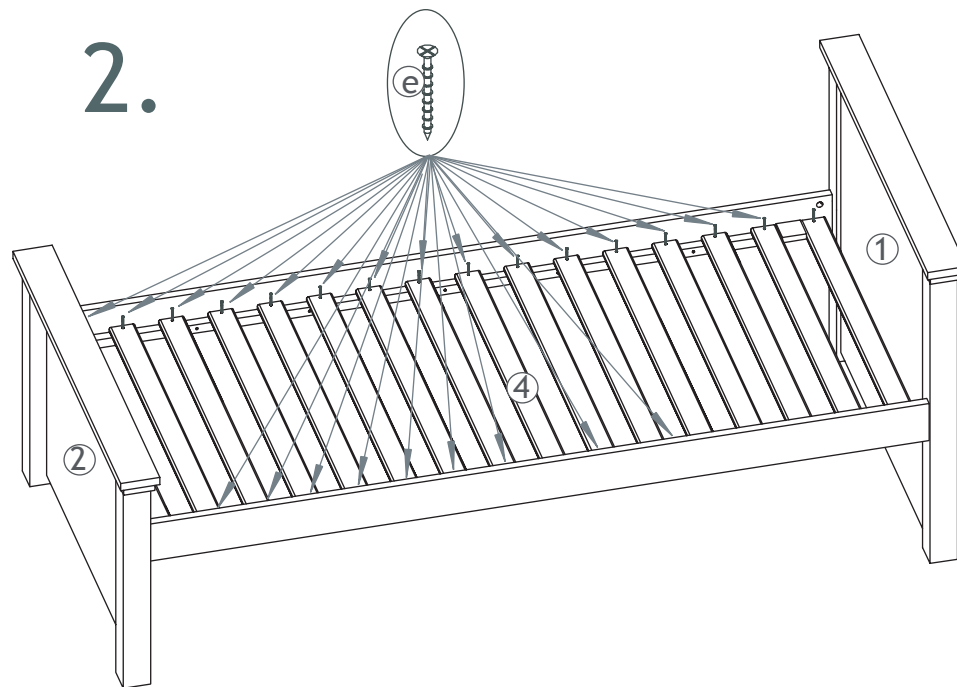

3.

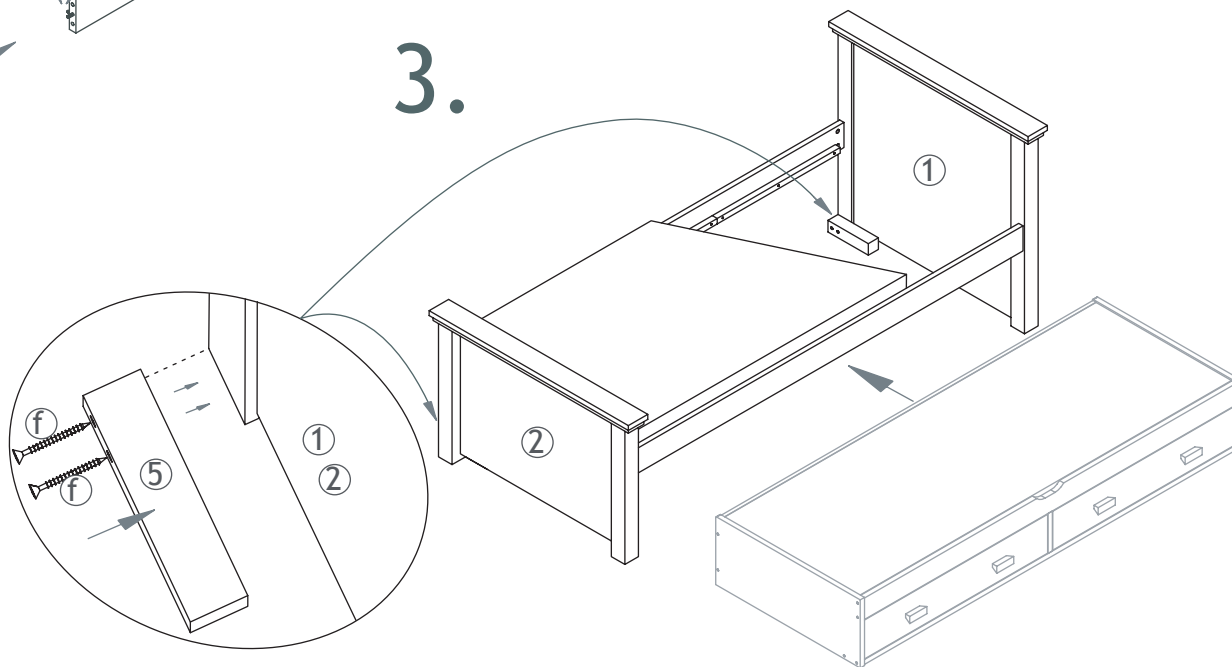

Ⓓ Aufbauanleitung

Ⓕ Notice de montage

Ⓖ Montagehandleiding

Ⓒ Montážní návod

Ⓗ Szerelési útmutató

Ⓓ Montaj talimatları

Ⓖ Assembly instruction

Ⓙ Istruzione di montaggio

Ⓟ Instrukcja montażu

Ⓚ Navod na montaž

Ⓡ Instrucțiuni de montaj

Ⓡ Инструкция по монтажу

36-4285-82-000

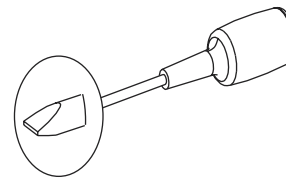
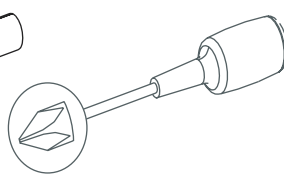
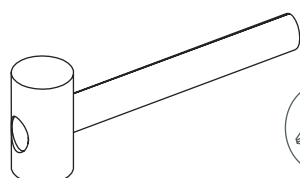
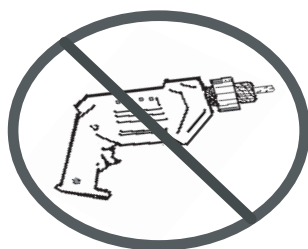
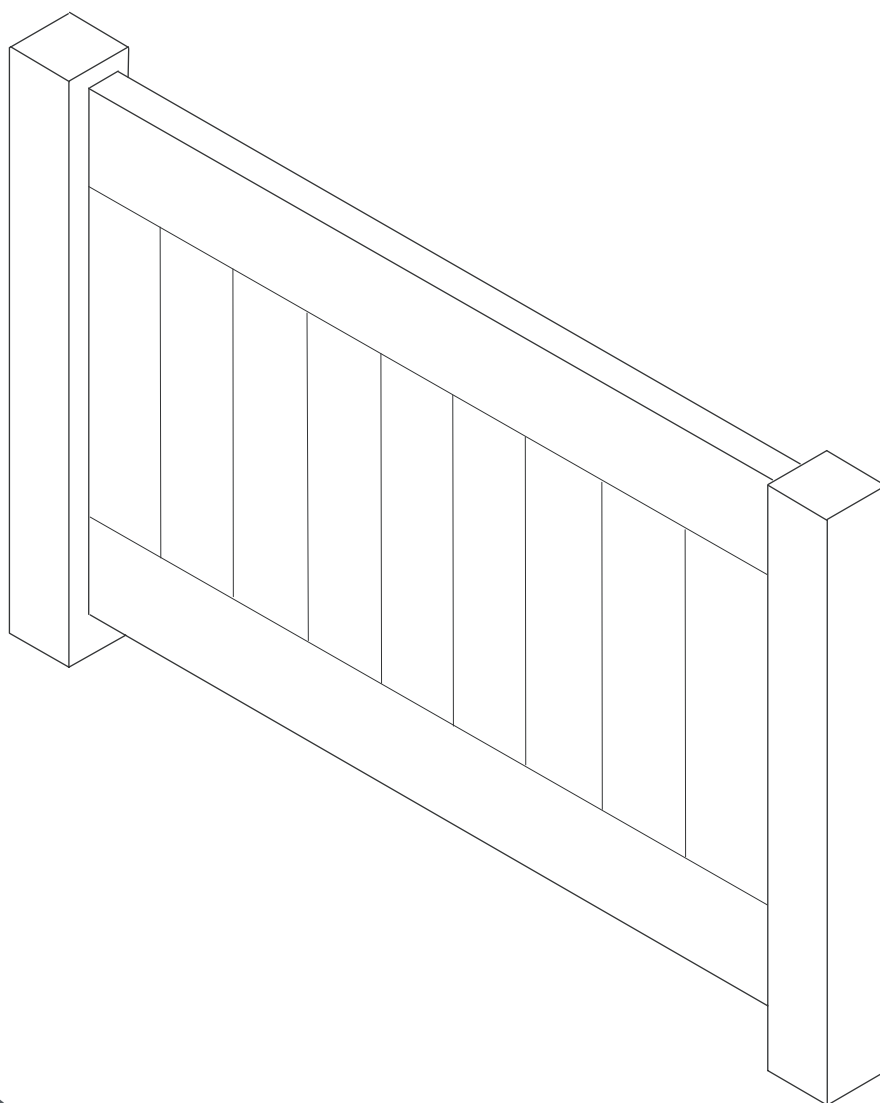

Service • Assistenza • Dienstverlening • Serwis Servis • Szerviz • Сервисная служба

Name • Nom • Nome • Naam • Nazwa • Jméno • Názov
Név • Denumire • Isim • Название

Nr. • No. • N° • Č • Sz • Номер

Typ • Type • Tip • Tipus • Druh • Тип • Тип

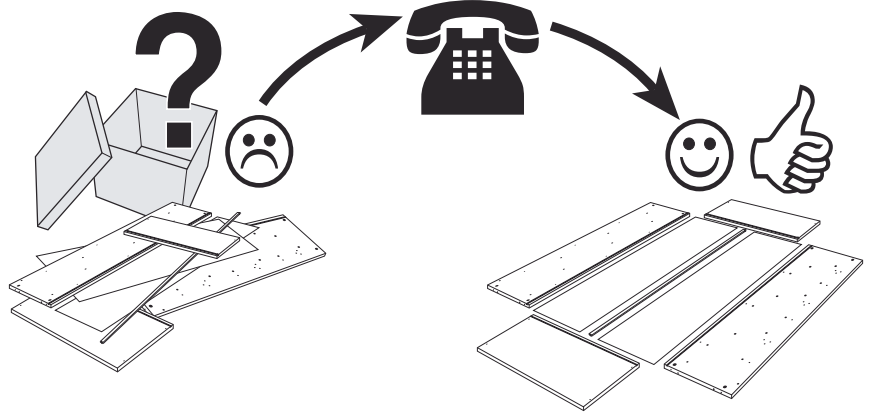
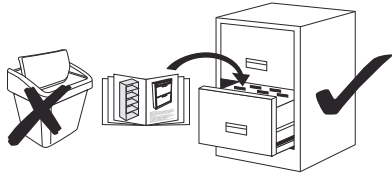

| | | |
|---|-----------|----|
| 2 | 169225-82 | x1 |
| 6 | 208778-32 | x1 |
| 7 | 208779-32 | x1 |

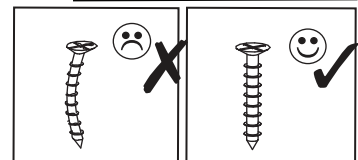
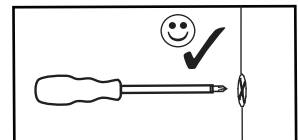
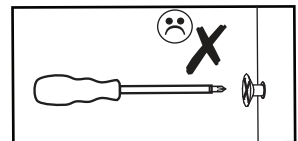
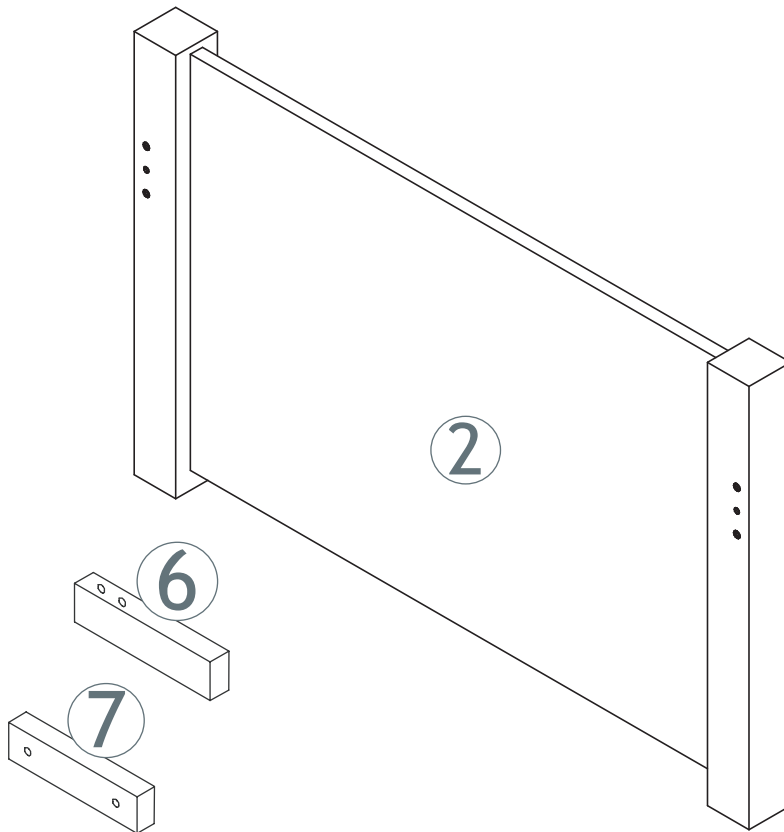

g

mm
1-000094-07 4x40 x2

0
10
20
30
40
50
60
70
80
90
100
110
120
130
140
150
160
170
180
190
200

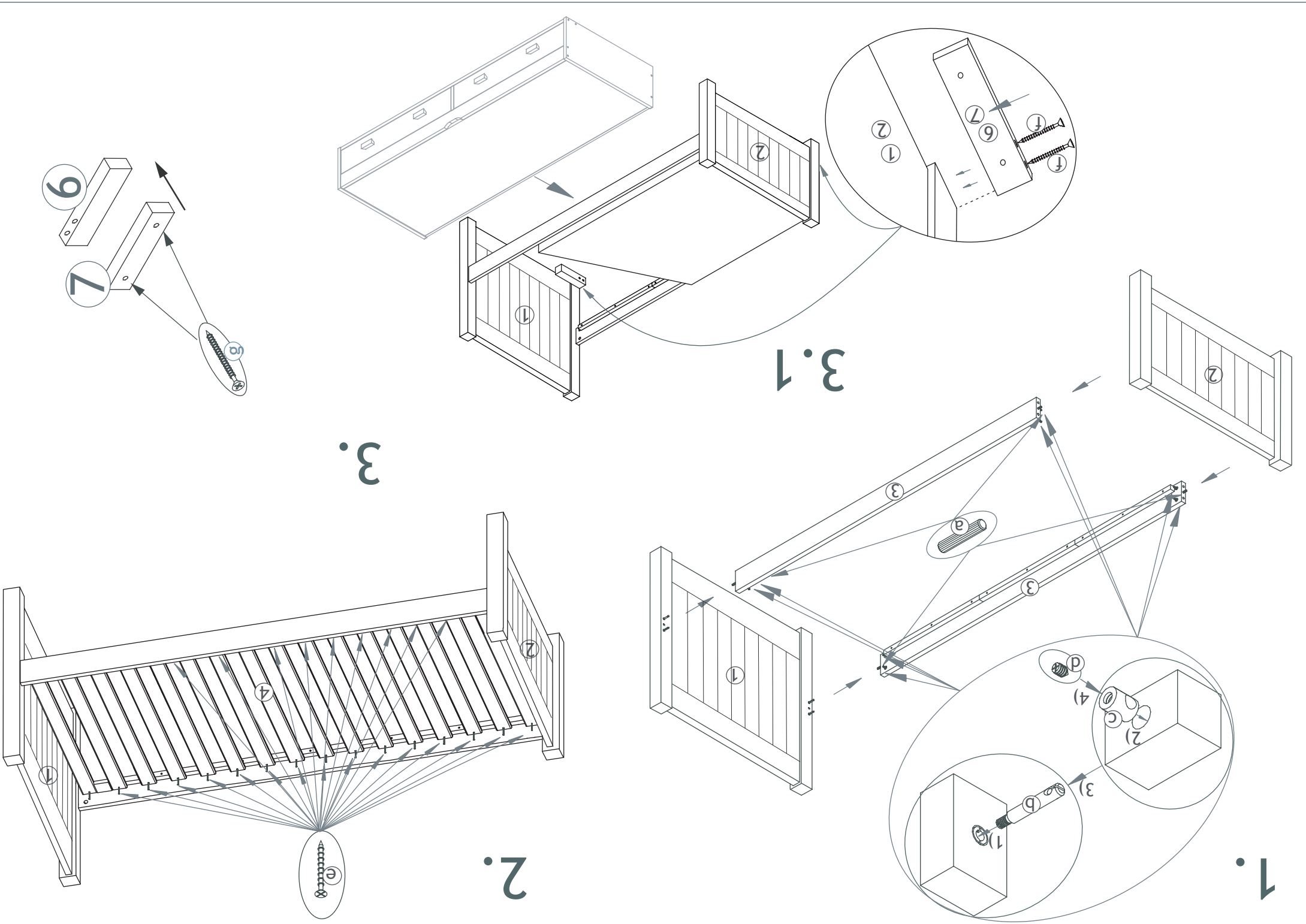

Ⓓ Aufbauanleitung

Ⓕ Notice de montage

Ⓖ Montagehandleiding

Ⓒ Montážní návod

Ⓗ Szerelési útmutató

Ⓓ Montaj talimatları

Ⓖ Assembly instruction

Ⓙ Istruzione di montaggio

Ⓟ Instrukcja montażu

Ⓚ Navod na montaž

Ⓡ Instrucțiuni de montaj

Ⓡ Инструкция по монтажу

36-4286-82-000

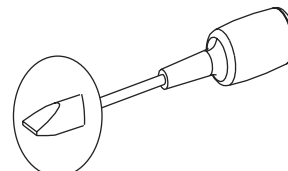
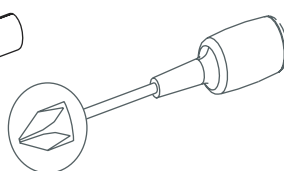
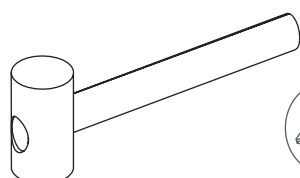
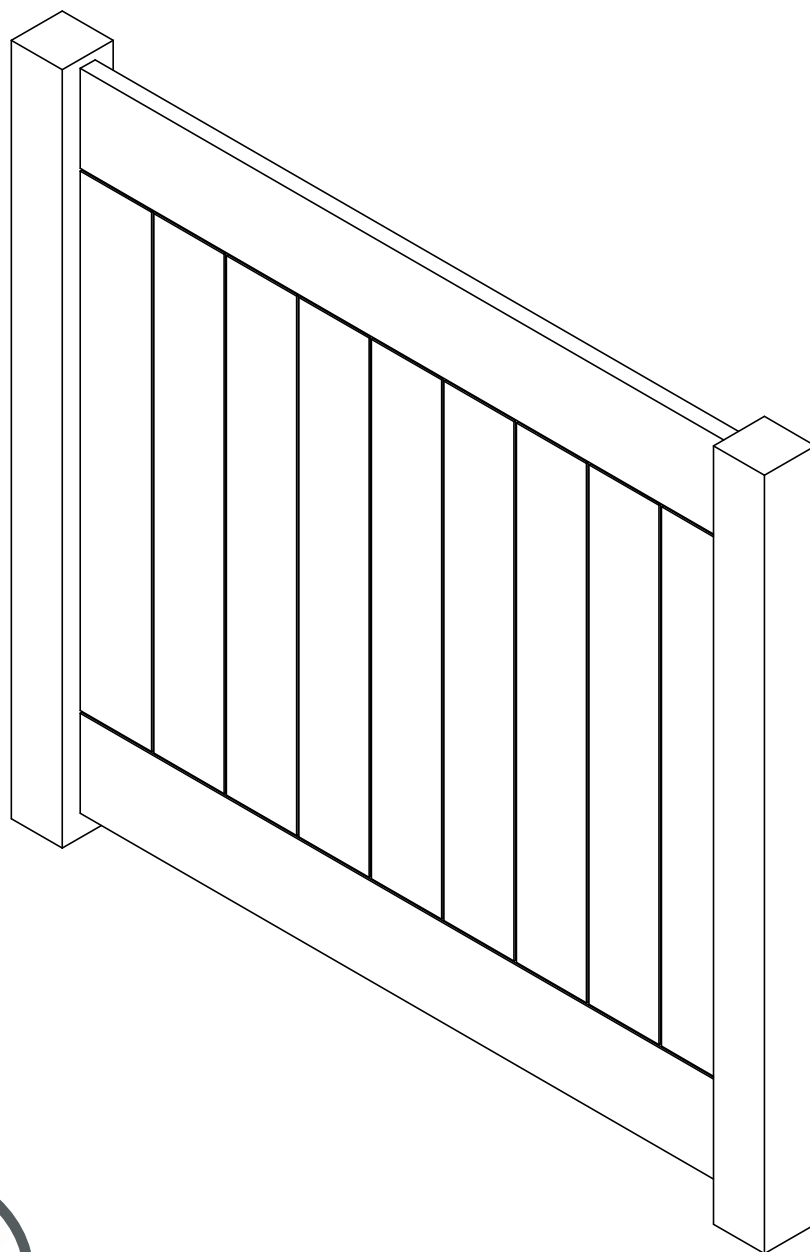

Service • Assistenza • Dienstverlening • Serwis Servis • Szerviz • Сервисная служба

Name • Nom • Nome • Naam • Nazwa • Jméno • Názov
Név • Denumire • Isim • Название

Nr. • No. • N° • Č • Sz • Номер

Typ • Type • Tip • Tipus • Druh • Тип • Тип

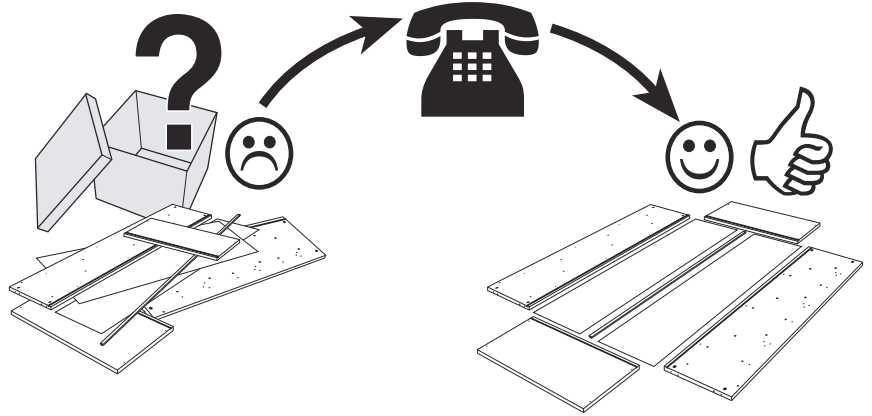
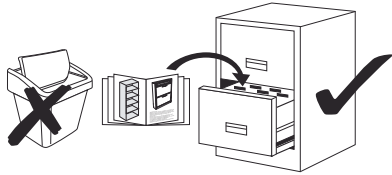

Detail specification

| A.i. Nr. | Article Nr. | pcs |
|----------|-------------|-----|
| 1 | 169224-82 | x1 |
| 6 | 208778-32 | x1 |
| 7 | 208779-32 | x1 |

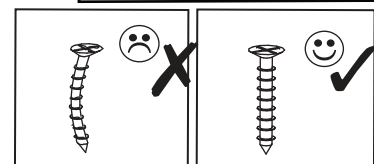
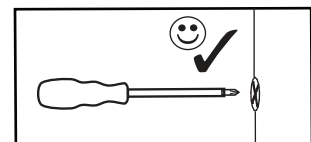
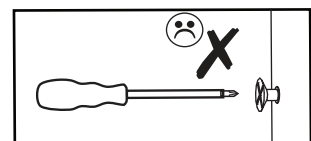
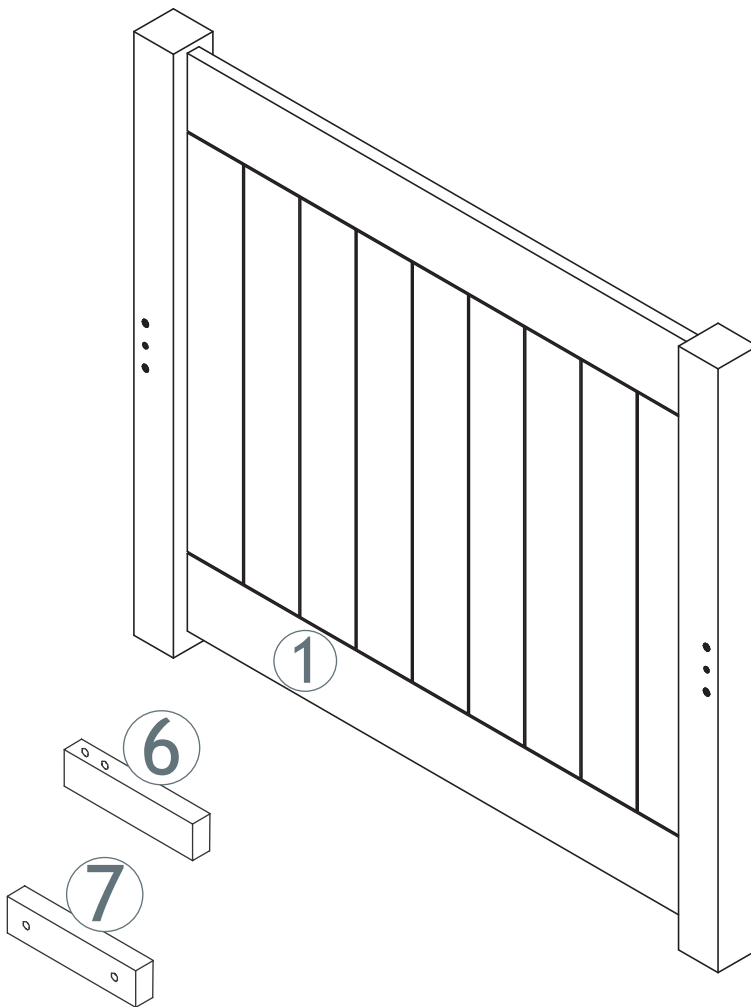

mm
1-000094-07 4x40 x2

0
10
20
30
40
50
60
70
80
90
100
110
120
130
140
150
160
170
180
190
200

1.

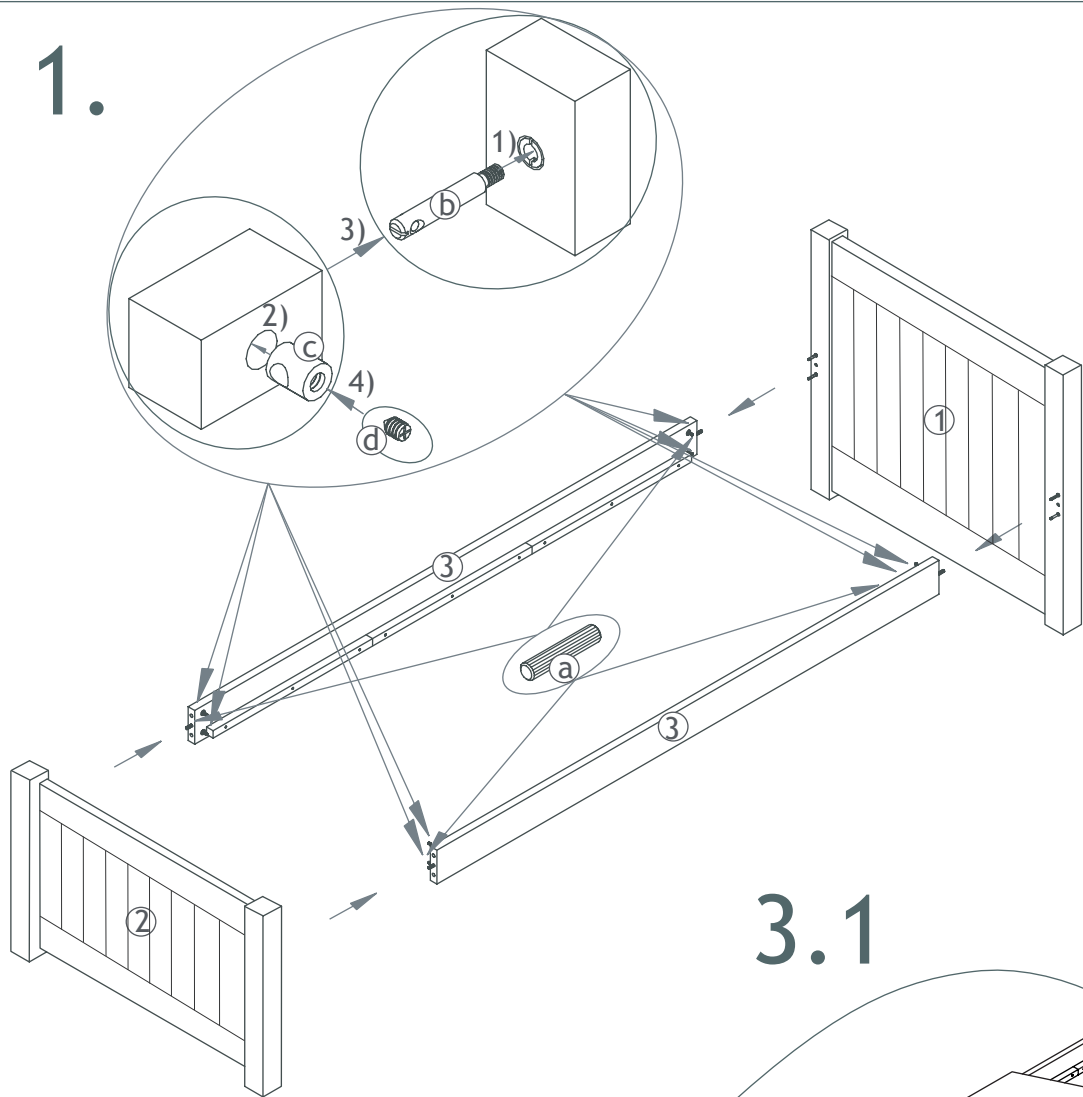

2.

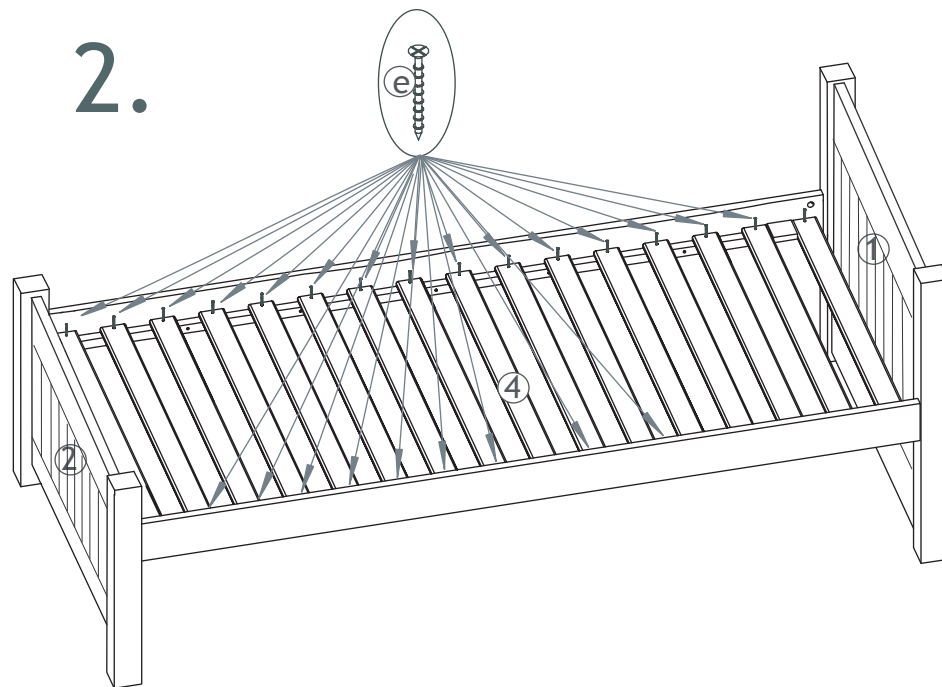

3.

3.1

