

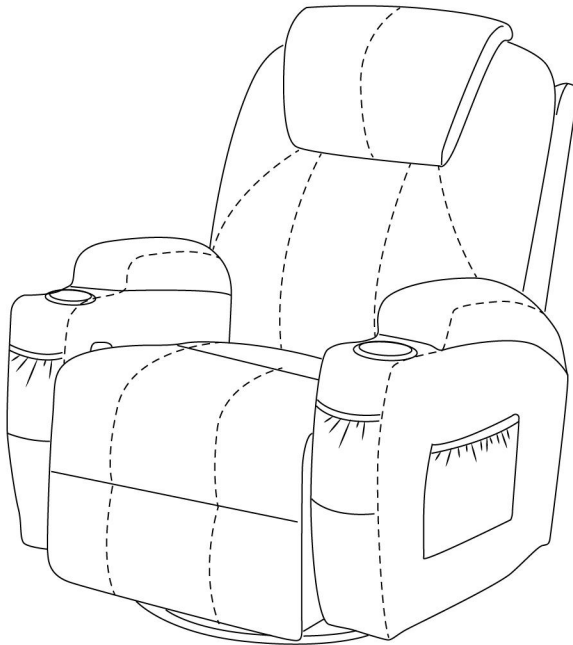

MCombo

Sofa assembly instruction







(English / Deutsch / Français / Español / Italiano)

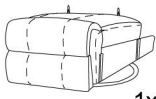

Pfillo GmbH

6160-7070

Sofa assembly instruction 7070

A  1x	B  2x	C  1x	D  1x	E  1x	F  1x
Chair base	Left and right armrest	Backrest	Remote control 1	Power supply	Remote control 2

Step1

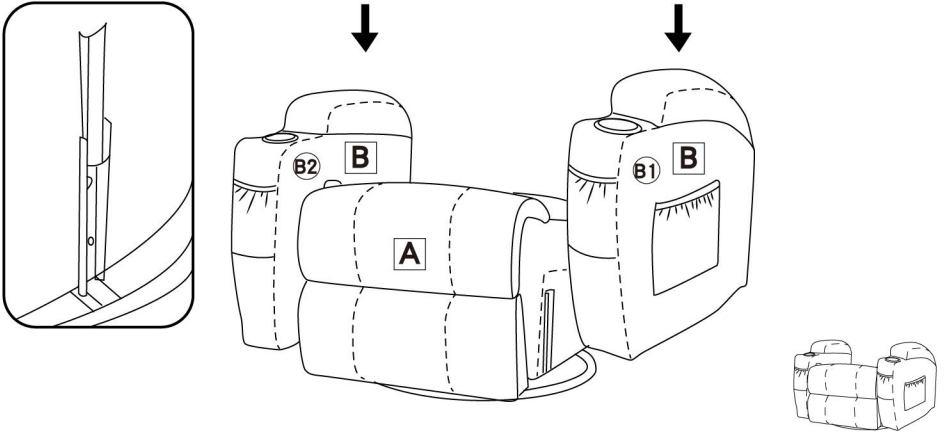

Step2

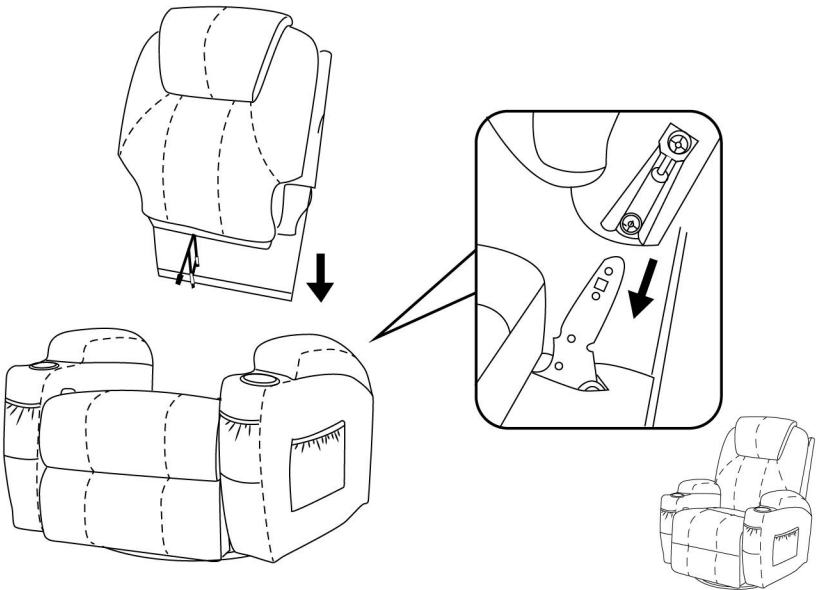

Sofa assembly instruction 7070

Step3

Connect cables ① and 1, cables ② and 2, cables ④ and 4 of the same color from the backrest and cushions.

Connect cable ③ from the backrest to remote control2 **F**.

Connect remote control1 **D** with interface ⑤ from the seat base.

Connect the USB cable to interface ⑥ of the seat base.

Connect the power supply unit **E** to the interface ⑦ of the seat base.

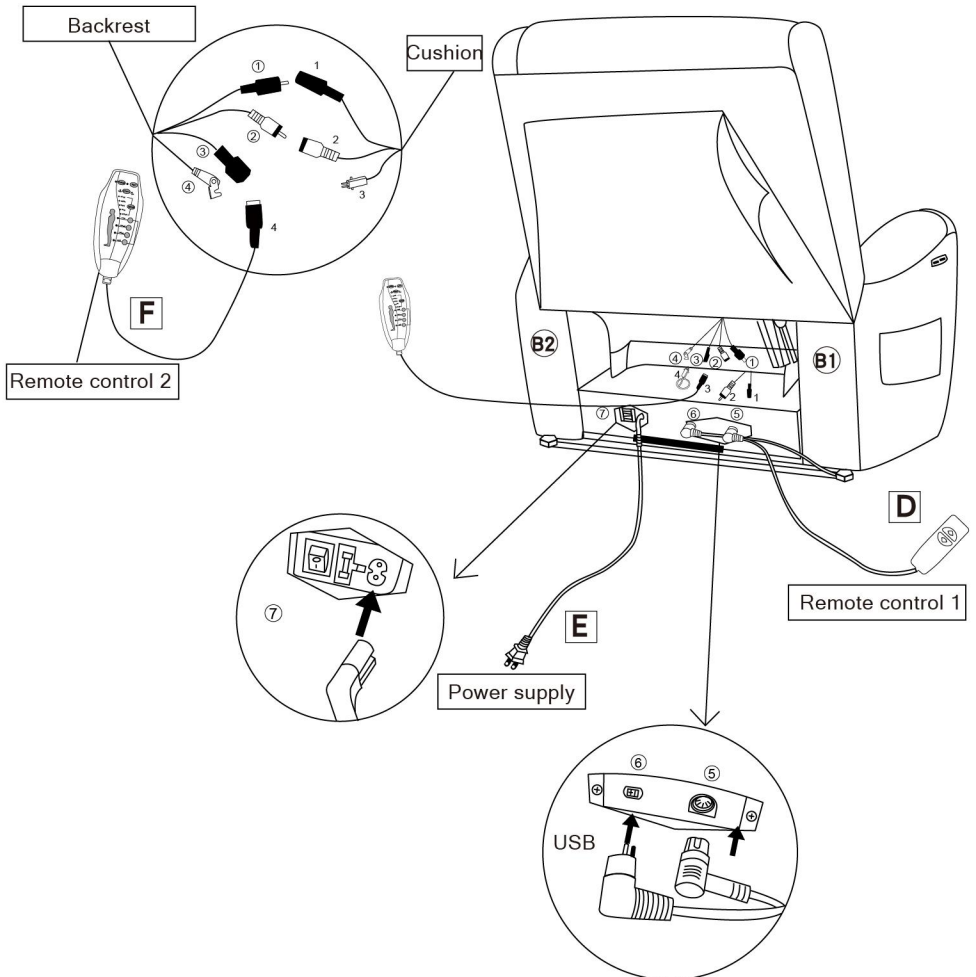

NOTE:

The USB port is installed on the bottom of the armrest of the sofa.

Sofa assembly instruction 7070

How to recline?

Press

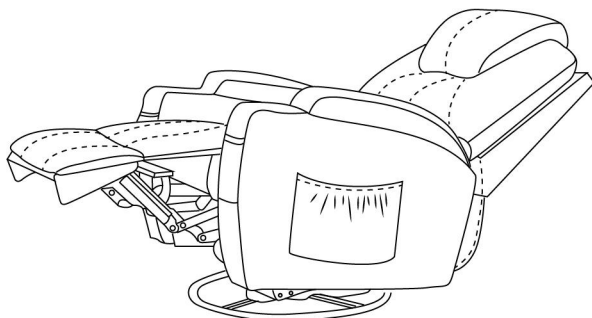
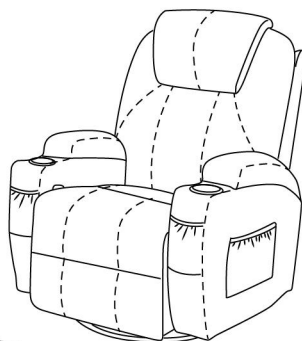
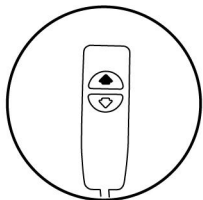

Sitting/ reclining position: backrest down and footrest up.

How to return the sofa to its original position?

Press

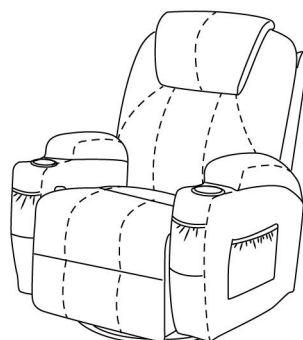
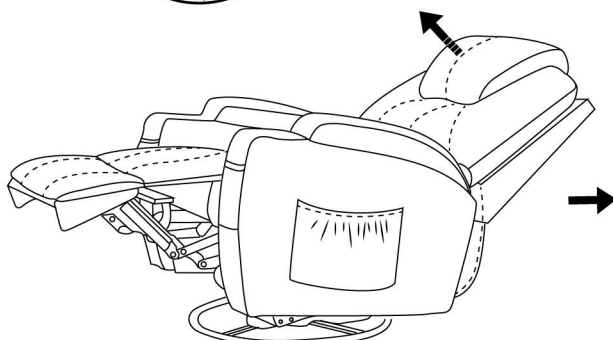
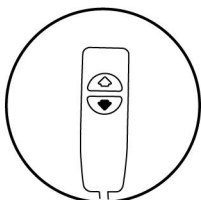

Reclining/sitting position: backrest straight and footrest down.

Sofa assembly instruction 7070

How to use the remote control for the massage?

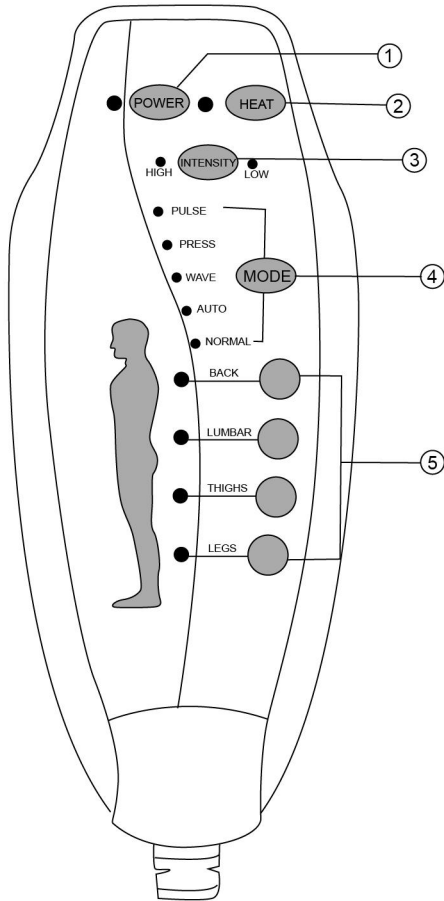

- ① POWER: Turn on/off remote control
- ② HEAT: Turn/off heat function for lumbar part.
- ③ INTENSITY: Control massages function from low to high
- ④ MODE: Choose a massage mode you like (pulse, press, wave, and auto, normal)
- ⑤ You can choose 1-4 massage parts (back, lumbar thighs, legs) to enjoy.

Sofa assembly instruction 7070

How do you use the remote control for the sitting / lying position?

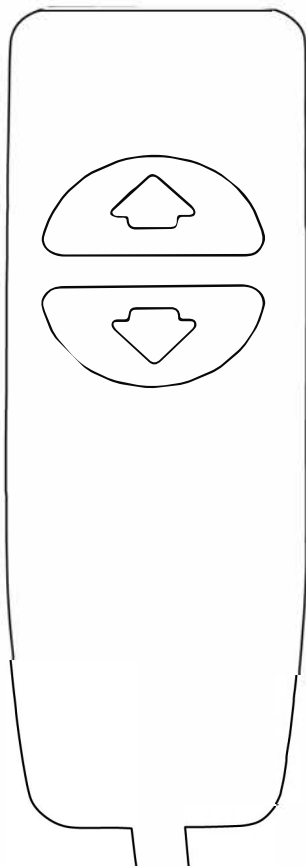







Backrest down and footrest up (reclining position)

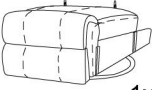

Backrest straight and foot section down. (sitting position)

Sofa assembly instruction 7070

A  1x	B  2x	C  1x	D  1x	E  1x	F  1x
Sitzbasis	Armlehne	Rückenlehne	Fernbedienung1	Netzteil	Fernbedienung2

Schritt 1

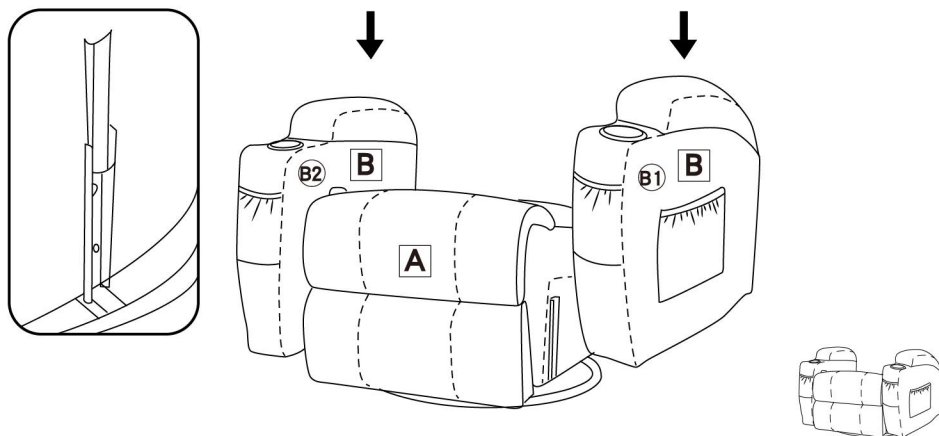

Schritt 2

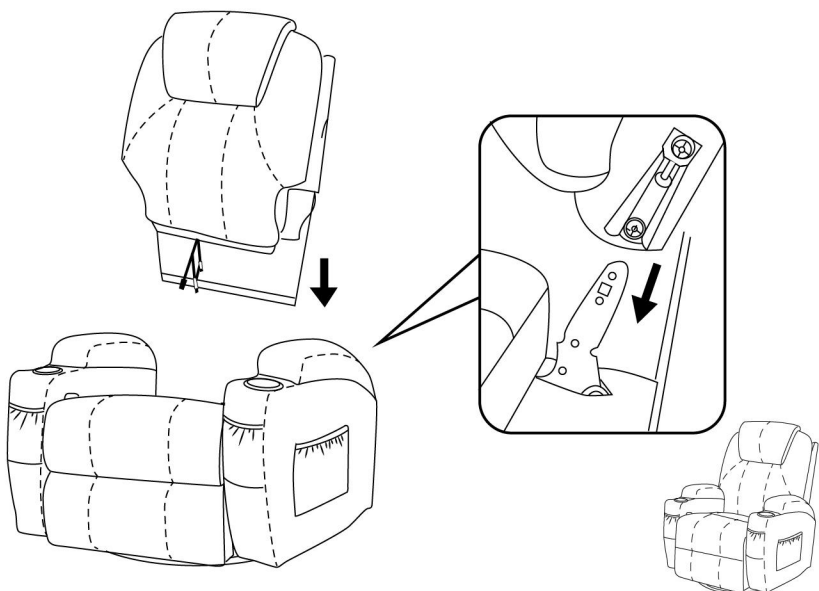

Sofa assembly instruction 7070

Schritt 3

Kabel ① und 1, Kabe ② und 2 , Kabe ④ und 4 derselben Farbe aus der Rückenlehne und den Kissen miteinander verbinden.

Kabel ③ aus der Rückenlehne mit Fernbedienung2 **F** verbinden.

Fernbedienung1 **D** mit dem Schnittstelle ⑤ aus dem Sitzbasis verbinden.

Die USB Kabel mit dem Schnittstelle ⑥ aus dem Sitzbasis verbinden.

Netzteil **E** mit dem Schnittstelle ⑦ aus dem Sitzbasis verbinden.

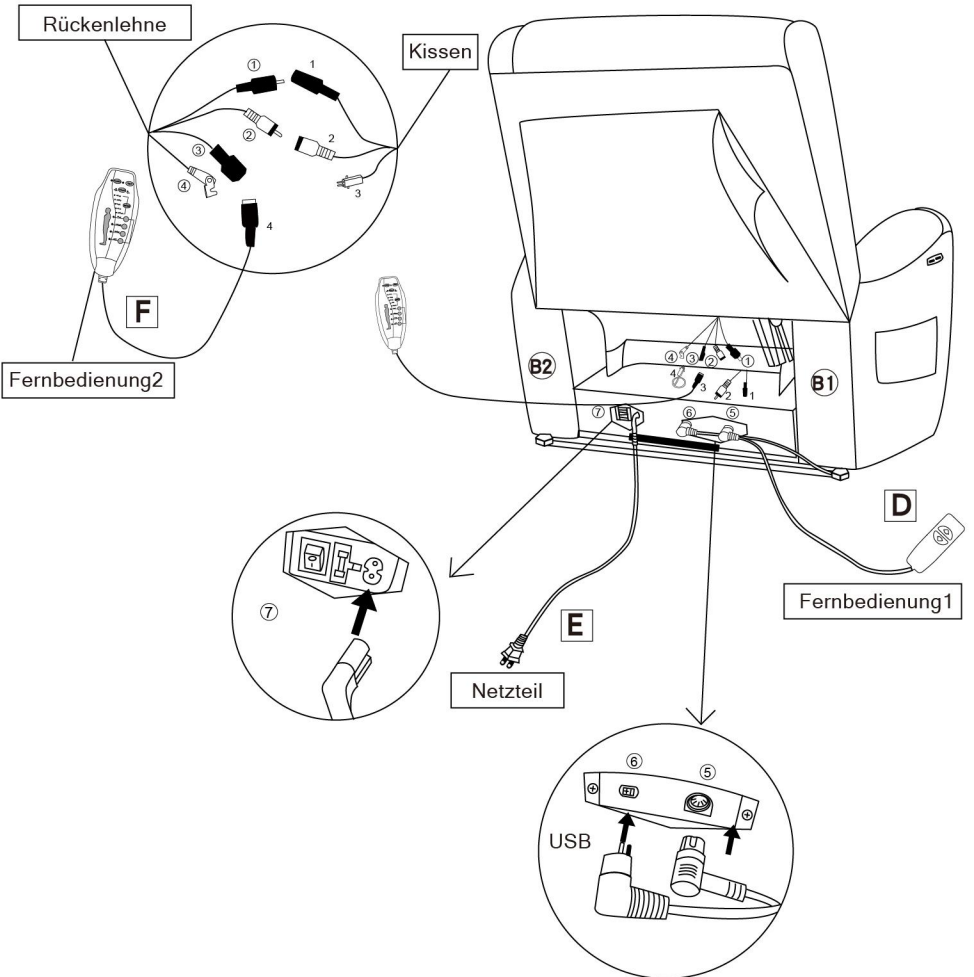

HINWEIS:

Die USB-Schnittstelle ist an der Unterseite der Armlehne des Sofas eingebaut.

Sofa assembly instruction 7070

Wie lehnt man sich zurück?

Drücken

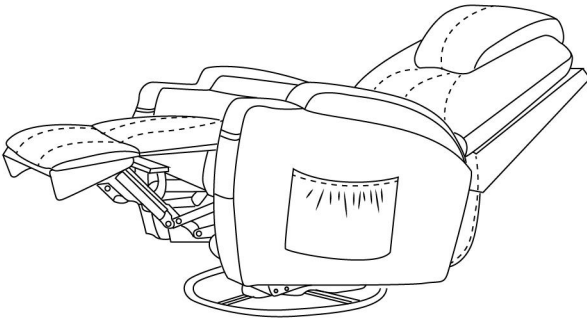
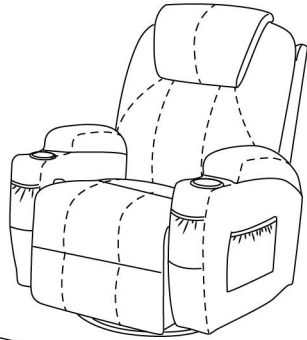
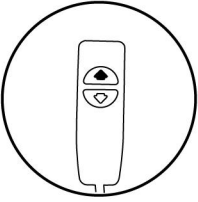

Sitz-/Liegeposition: Rückenlehne nach unten und Fußteil nach oben.

Wie stellt man das Sofa in ursprüngliche Position zurück?

Drücken

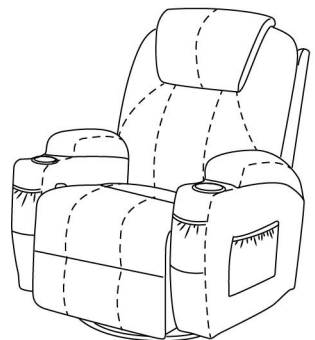
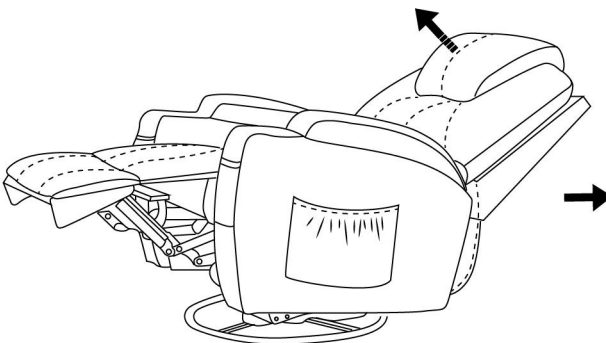
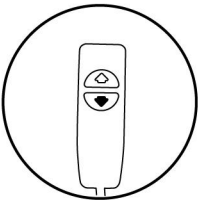

Liege-/Sitzposition: Rückenlehne grad und Fußteil nach unten.

Sofa assembly instruction 7070

Wie benutzt man die Fernbedienung für die Massage?

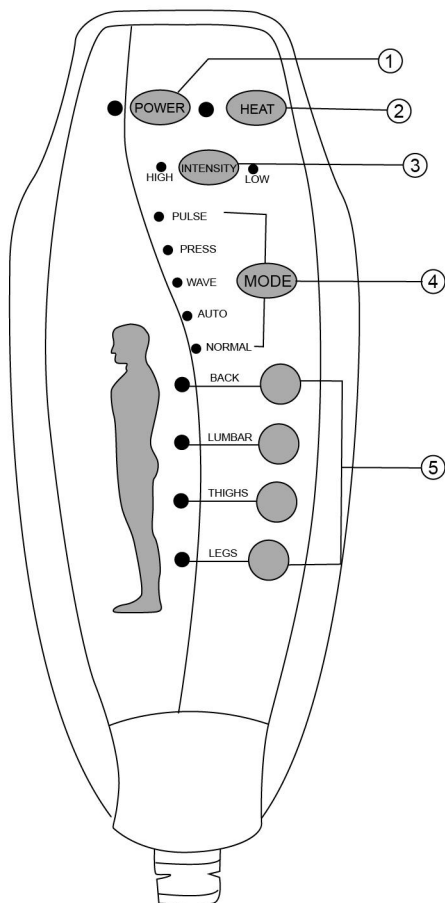

- ① POWER: die Fernbedienung ein - / ausschalten.
- ② HEAT: Wärmefunktion für Rücken ein - / ausschalten.
- ③ INTENSITÄT: Stärke der Massagefunktion auswählen.
- ④ MODE: unterschiedliche Massagemodi einstellen (pulse, drücken, Welle, automatisch und normal).
- ⑤ Einzeln Massagepunkte steuern (Rücken, Hüfte, Bein, Wade).

Sofa assembly instruction 7070

Wie benutzt man die Fernbedienung für die Sitz- /Liegeposition?

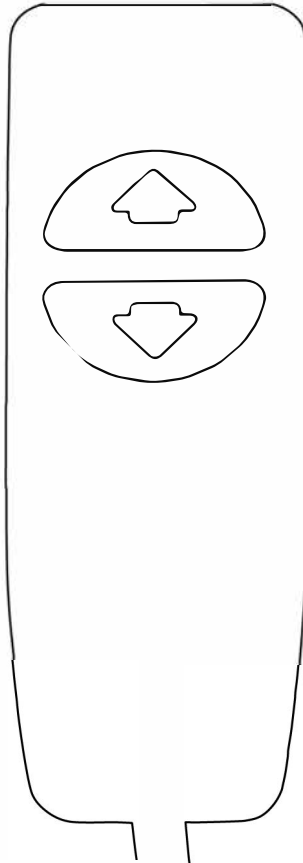





Rückenlehne nach unten, Fußteil nach oben stellen. (Liegeposition)

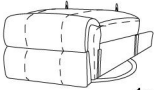
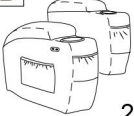

Rückenlehne grad, Fußteil nach unten. (Sitzposition)

Sofa assembly instruction 7070

A  1x	B  2x	C  1x	D  1x	E  1x	F  1x
Base de la présidence	Accoudoir gauche et droit	Dossier	Télécommande 1	Alimentation électrique	Télécommande 2

Étape 1

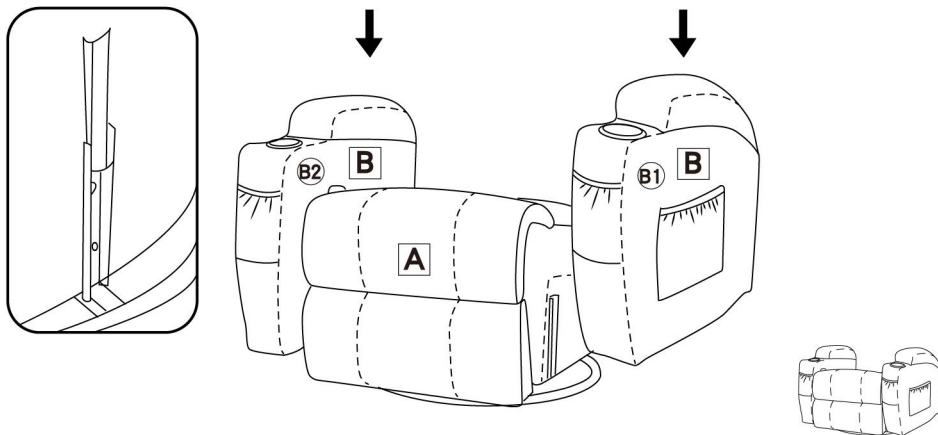

Étape 2

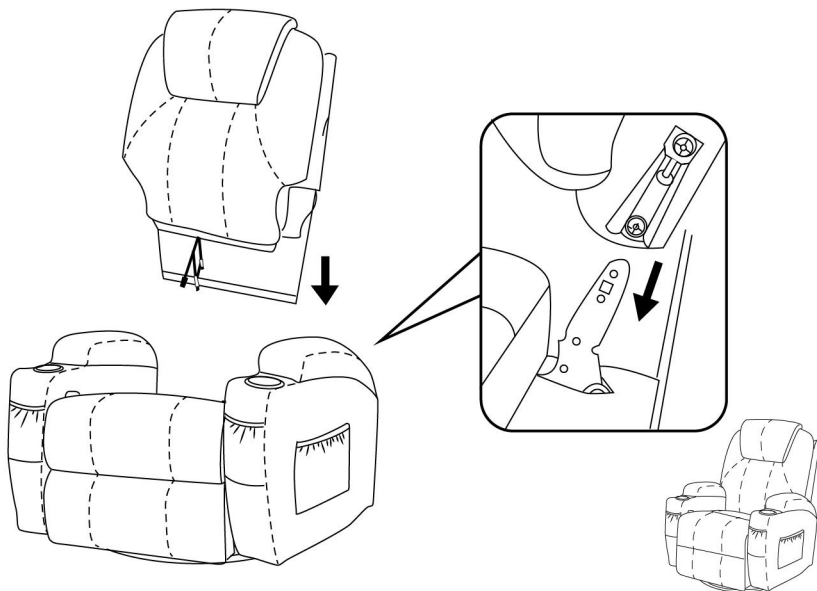

Sofa assembly instruction 7070

Étape 3

Kabel ① und 1, Kabe ② und 2 , Kabe ④ und 4 derselben Farbe aus der Rückenlehne und den Kissen miteinander verbinden.

Kabel ③ aus der Rückenlehne mit Fernbedienung2 **F** verbinden.

Fernbedienung1 **D** mit dem Schnittstelle ⑤ aus dem Sitzbasis verbinden.

Die USB Kabel mit dem Schnittstelle ⑥ aus dem Sitzbasis verbinden.

Netzteil **E** mit dem Schnittstelle ⑦ aus dem Sitzbasis verbinden.

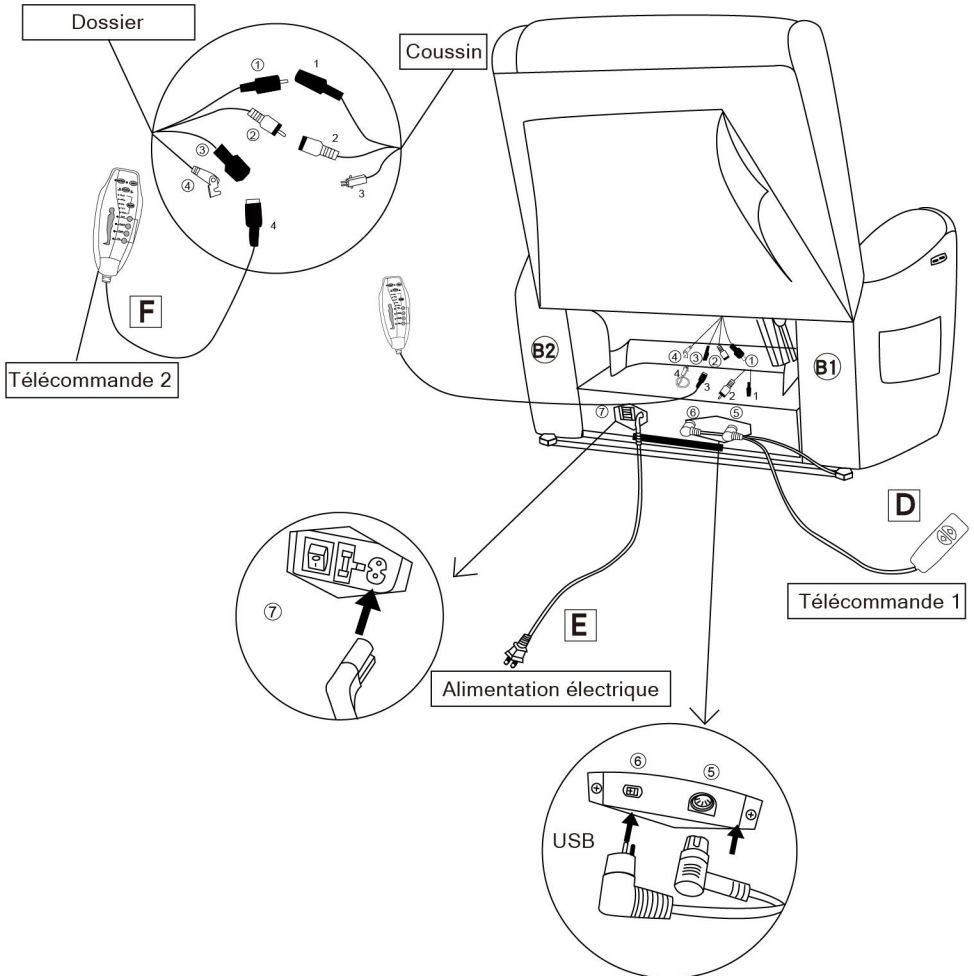

NOTE:

Le port USB est installé sur le bas de l'accoudoir du canapé.

Sofa assembly instruction 7070

Comment s'incliner?

Appuyer sur

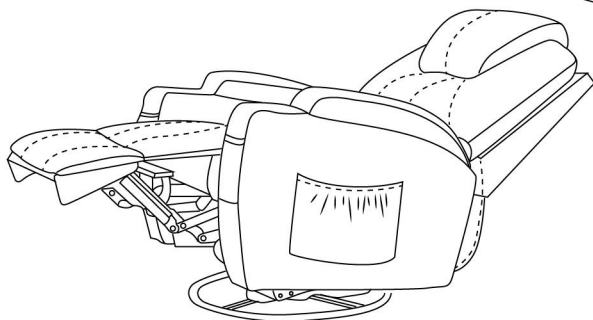
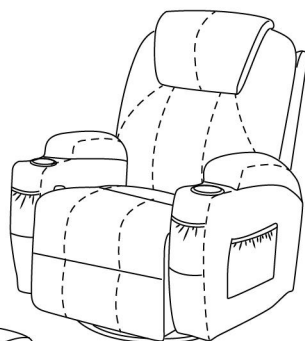
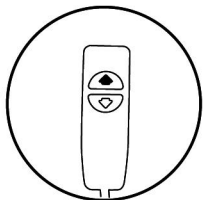

Position assise/inclinée : dossier vers le bas et repose-pieds vers le haut.

Comment remettre le canapé dans sa position initiale ?

Appuyez sur

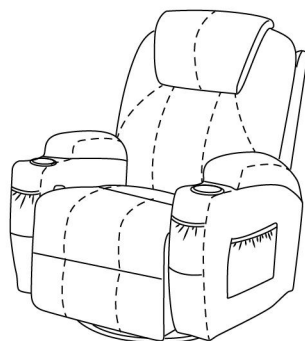
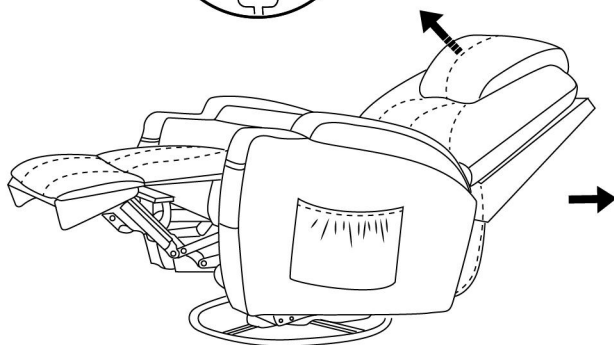
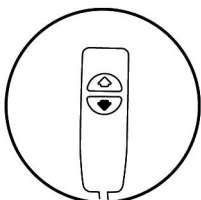

Position inclinée/assise: dossier droit et repose-pieds vers le bas.

Sofa assembly instruction 7070

Comment utiliser la télécommande pour le massage?

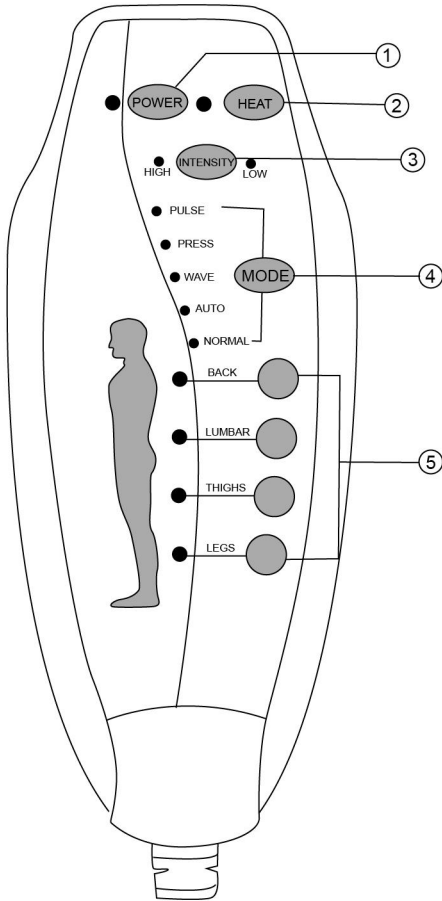

- ① POWER: Allumer/éteindre la télécommande
- ② HEAT: Fonction d'arrêt de la chaleur pour la partie lombaire.
- ③ INTENSITÉ: contrôle de la fonction de massages de basse à haute
- ④ MODE: Choisissez le mode de massages qui vous convient (impulsion, pression, onde, automatique, normal)
- ⑤ Vous pouvez choisir de 1 à 4 parties de massage (dos, cuisses lombaires, jambes) pour en profiter.

Sofa assembly instruction 7070

Comment utiliser la télécommande pour la position assise / couchée ?

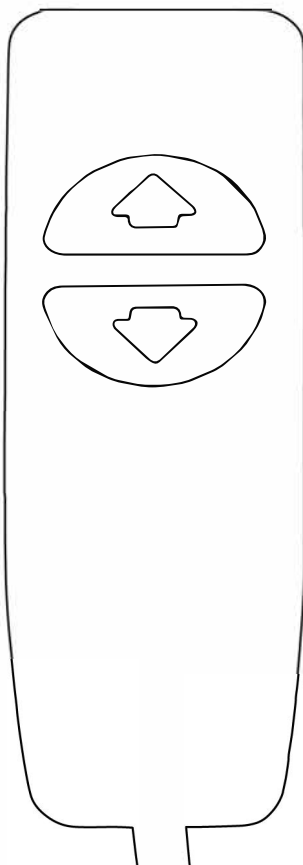







Dossier abaisse et repose-pieds releve (position couchée)

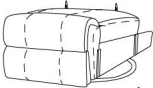

Dossier droit et partie pieds en bas. (position assise)

Sofa assembly instruction 7070

A  1x	B  2x	C  1x	D  1x	E  1x	F  1x
Base de la silla	Reposabrazos izquierdo y derecho	Respaldo	Mando a distancia1	Fuente de alimentación	Mando a distancia2

PASO 1

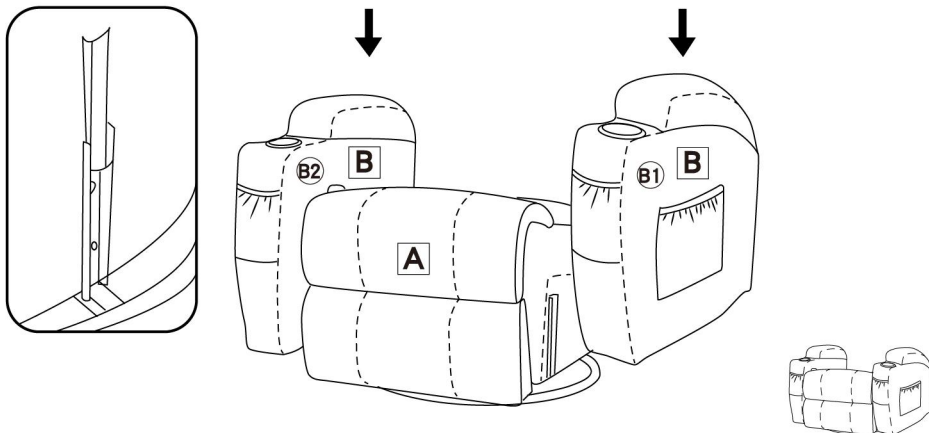

PASO 2

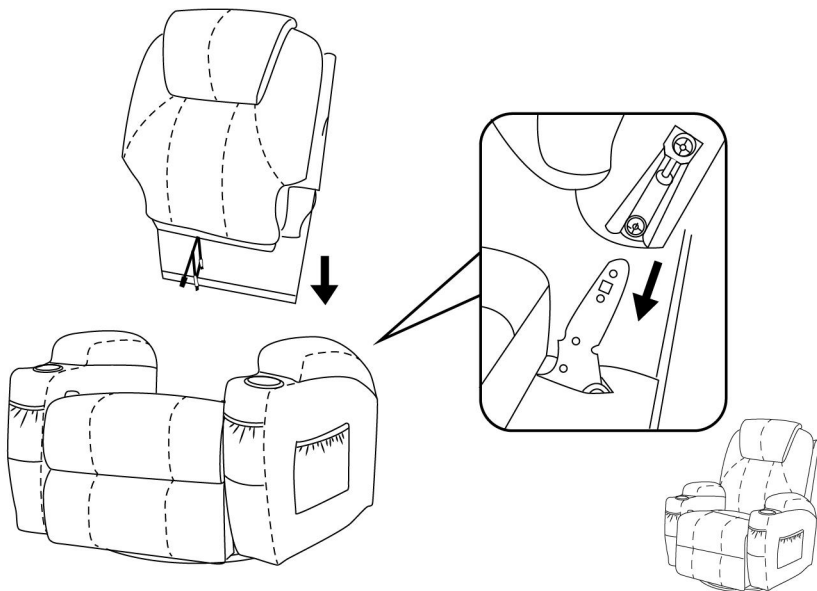

Sofa assembly instruction 7070

PASO 3

Conecte los cables ① y 1, los cables ② y 2, los cables ④ y 4 del mismo color del respaldo y los
Conecte el cable ③ del respaldo al mando a distancia2 **F**.

Conecte el mando a distancia1 **D** con interfaz ⑤ de la base del asiento

Conecte el cable USB a la interfaz ⑥ de la base del asiento.

Conecte la fuente de alimentación **E** a la interfaz ⑦ de la base del asiento.

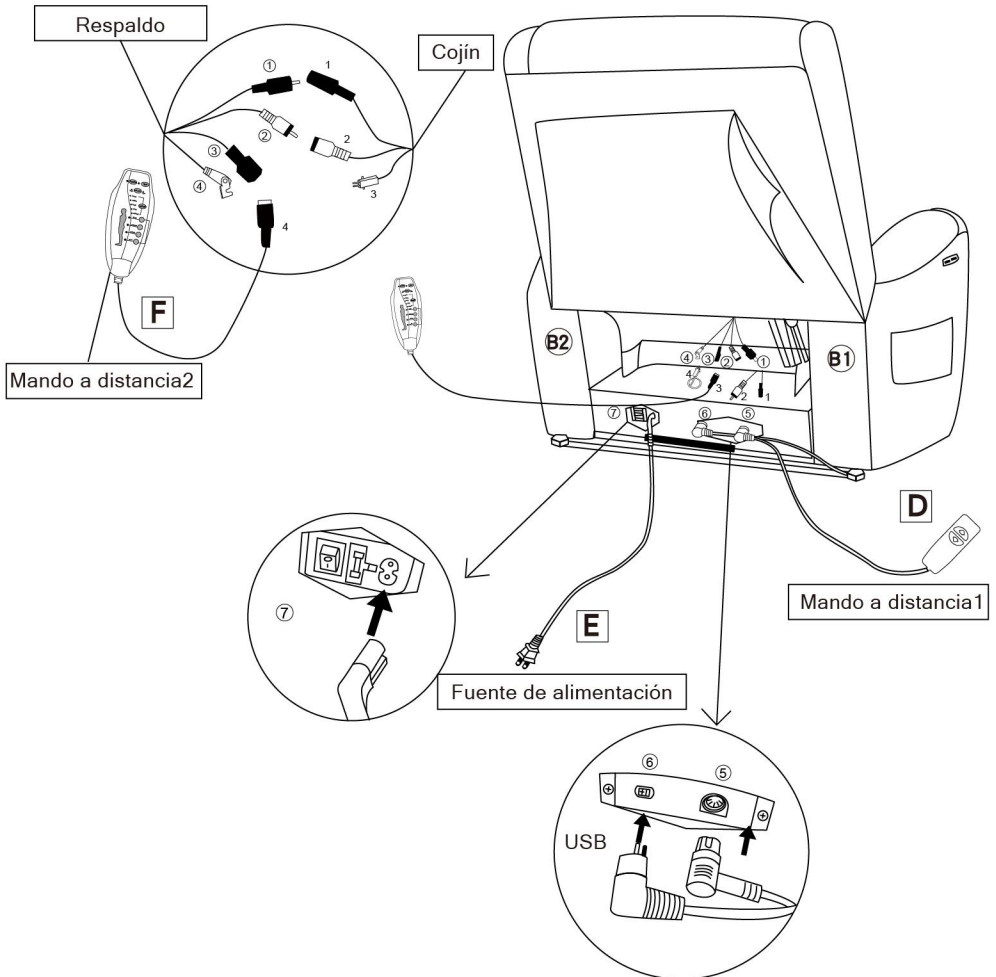

NOTA:

El puerto USB está instalado en la parte inferior del reposabrazos del sofá.

Sofa assembly instruction 7070

¿Cómo se reclina?

Pulse

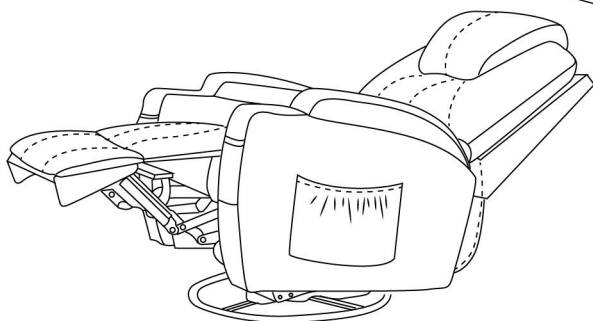
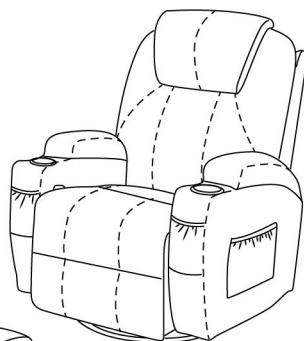
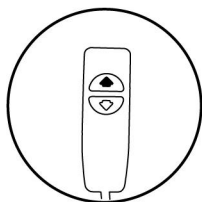

Posición sentada/ reclinada: respaldo hacia abajo y reposapiés hacia arriba.

¿Cómo devolver el sofá a su posición original?

Pulse

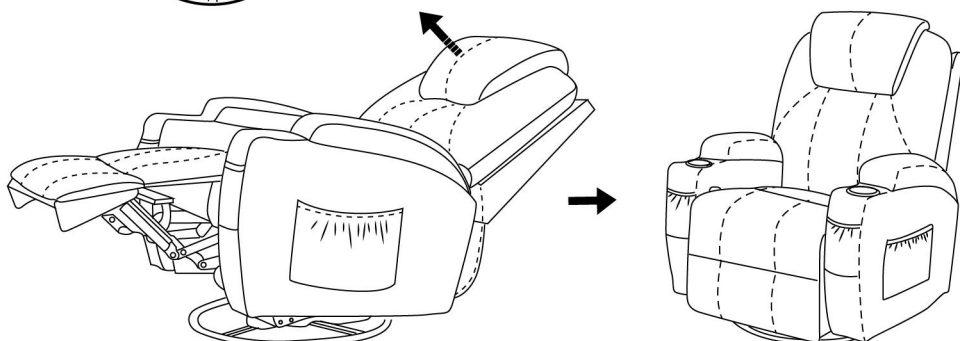
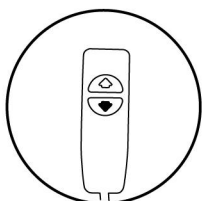

Posición reclinada/sentada: respaldo recto y reposapiés hacia abajo.

Sofa assembly instruction 7070

¿Cómo usar el mando a distancia para el masaje?

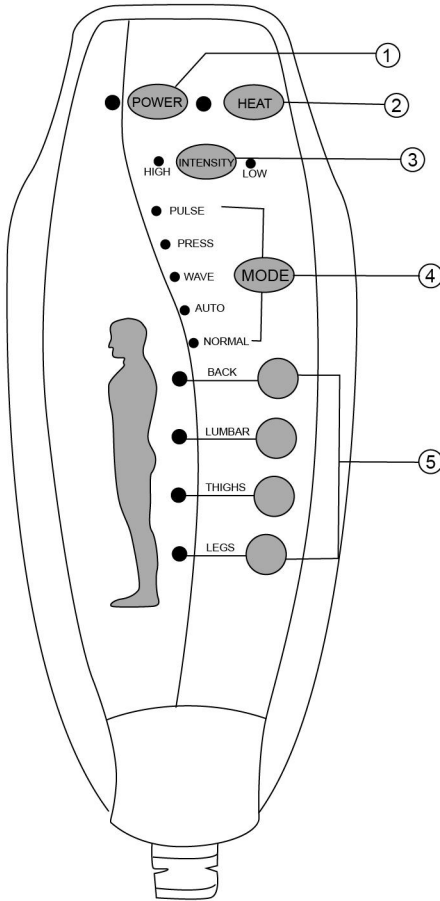

- ① **POWER**: Encender/apagar el mando a distancia
- ② **CALOR**: Función de calor para la parte lumbar.
- ③ **INTENSIDAD**: Controlar la función de masaje de bajo a alto
- ④ **MODO**: Elija un modo de masaje que le guste (pulso, pulsación, onda, automático, normal)
- ⑤ **Puedes elegir de 1 a 4 partes de masaje (espalda, muslos lumbares, piernas) para disfrutar.**

Sofa assembly instruction 7070

¿Cómo se usa el mando a distancia para la posición sentada / tumbada?

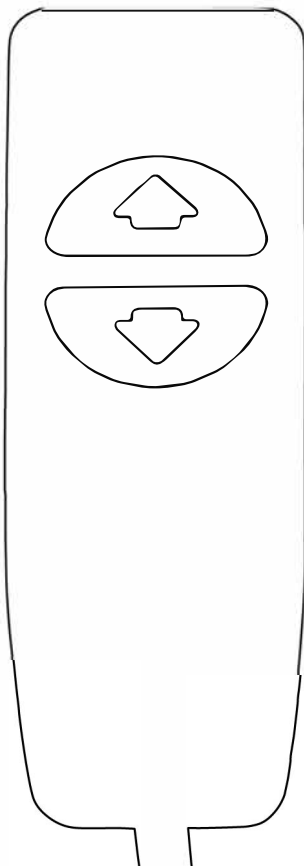







Respaldó abajó y repósapiés arriba (pósición reclinada)

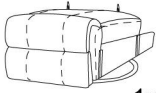

El respaldó rectó y la sección de lós pies hacia abajó. (pósición sentada)

Sofa assembly instruction 7070

A  1x	B  2x	C  1x	D  1x	E  1x	F  1x
Base della sedia	bracciolo sinistro e destro	Schienaler	Telecomando 1	Alimentazione	Telecomando 2

PASSO 1

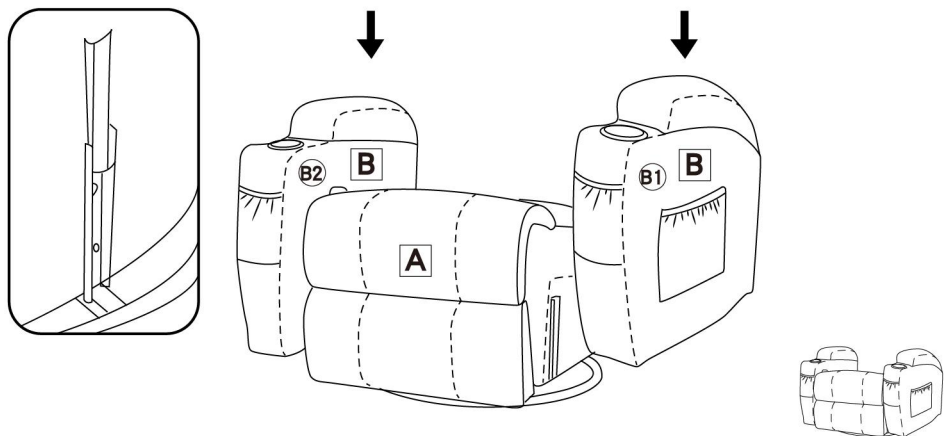

PASSO 2

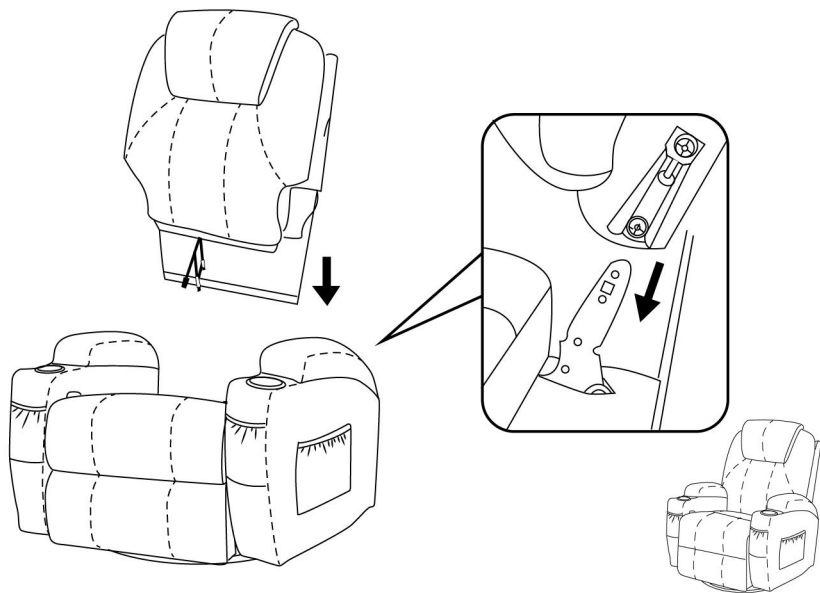

Sofa assembly instruction 7070

PASSO 3

Collegare i cavi ① e 1, i cavi ② e 2, i cavi ④ e 4 dello stesso colore dello schienale e dei cuscini.

Collegare il cavo ③ dallo schienale al telecomando2 **F**

Collegare il telecomando1 **D** con interfaccia ⑤ dalla base del sedile

Collegare il cavo USB all'interfaccia ⑥ della base del sedile.

Collegare l'alimentatore **E** all'interfaccia ⑦ della base del sedile.

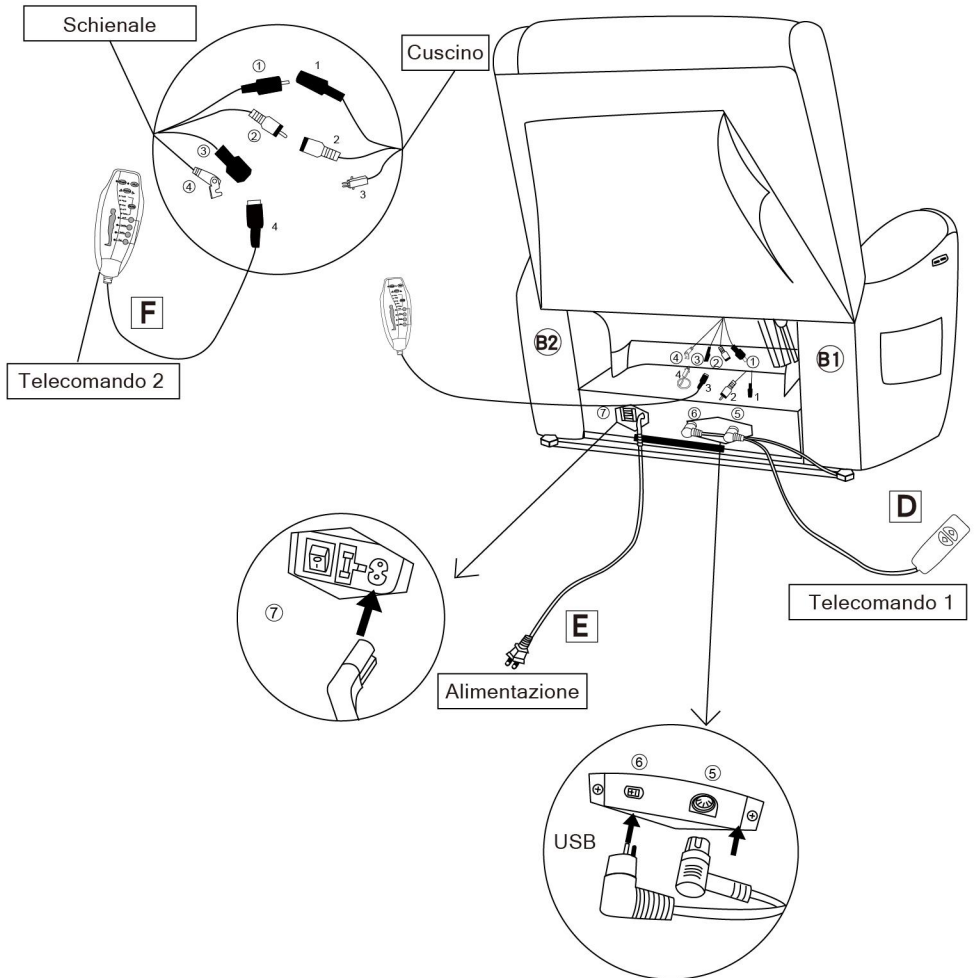

HINWEIS:

La porta USB è installata sul fondo del bracciolo del divano.

Sofa assembly instruction 7070

Come reclinare?

Premere

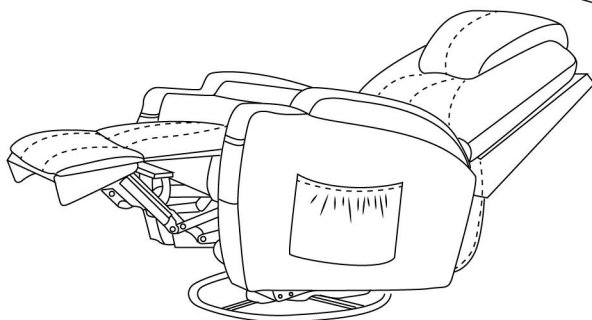
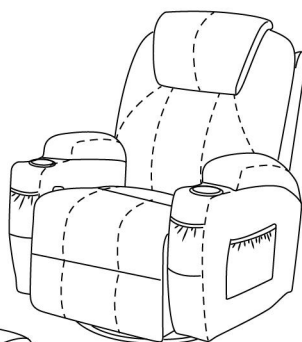
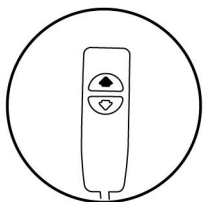

Posizione seduta/reclinata: schienale giù e poggiatesta su.

Come riportare il divano nella sua posizione originale?

Premere

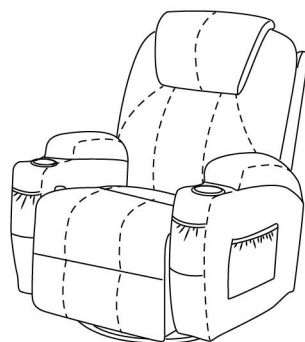
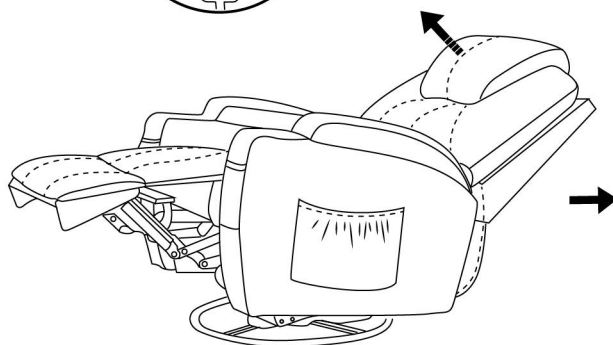
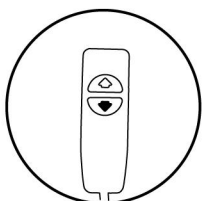

Posizione reclinata/seduta: schienale dritto e poggiatesta in basso.

Sofa assembly instruction 7070

Come si usa il telecomando per il massaggio?

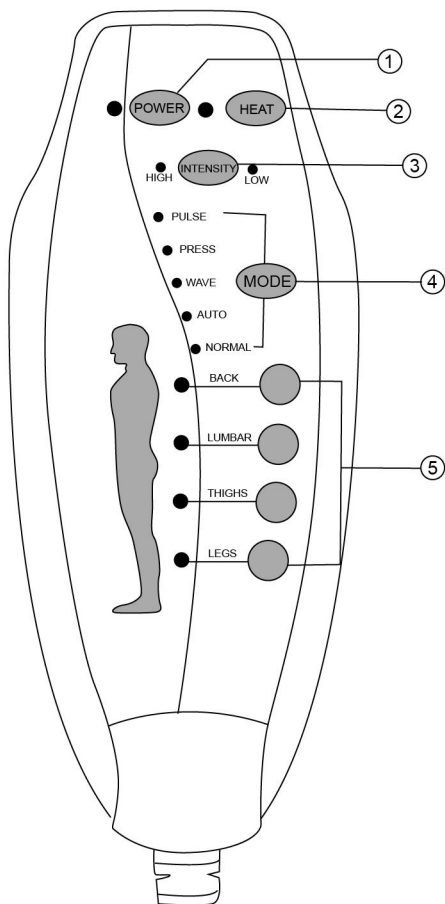

- ① POWER: Accendere e spegnere il telecomando
- ② CALORE: funzione di spegnimento del calore per la parte lombare.
- ③ INTENSITÀ: funzione di controllo del massaggio da basso ad alto
- ④ MODALITA': Scegliete la modalità di massaggio che preferite (impulso, pressione, onda, auto, normale)
- ⑤ È possibile scegliere 1-4 parti di massaggio (schiena, cosce lombari, gambe) per godere.

Sofa assembly instruction 7070

Come si usa il telecomando per la posizione seduta / sdraiata?

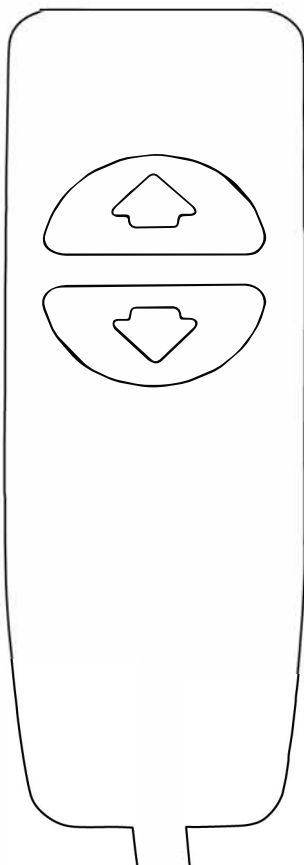

Schienale in basso e poggiatesta in alto. (posizione reclinata)



Schienale dritto e sezione dei piedi verso il basso. (posizione seduta)



Pfillo GmbH

Adresse: Kreuzweg 60, 47809 Krefeld

E-Mail: pfillo.de@gmail.com

® MCombo; 2. Auflage Dez. 2021