

Box-1/2	WF306440
Box-2/2	WF306441

CE

Deutsch: Dieses Produkt besteht aus 2 Logistikpaketen, bitte überprüfen Sie die Anzahl Ihrer Pakete, falls eines fehlt, wenden Sie sich bitte an die Logistik.

English: This product consists of 2 packages. Please check the number of your packages. If one is missing, please contact the logistics department.

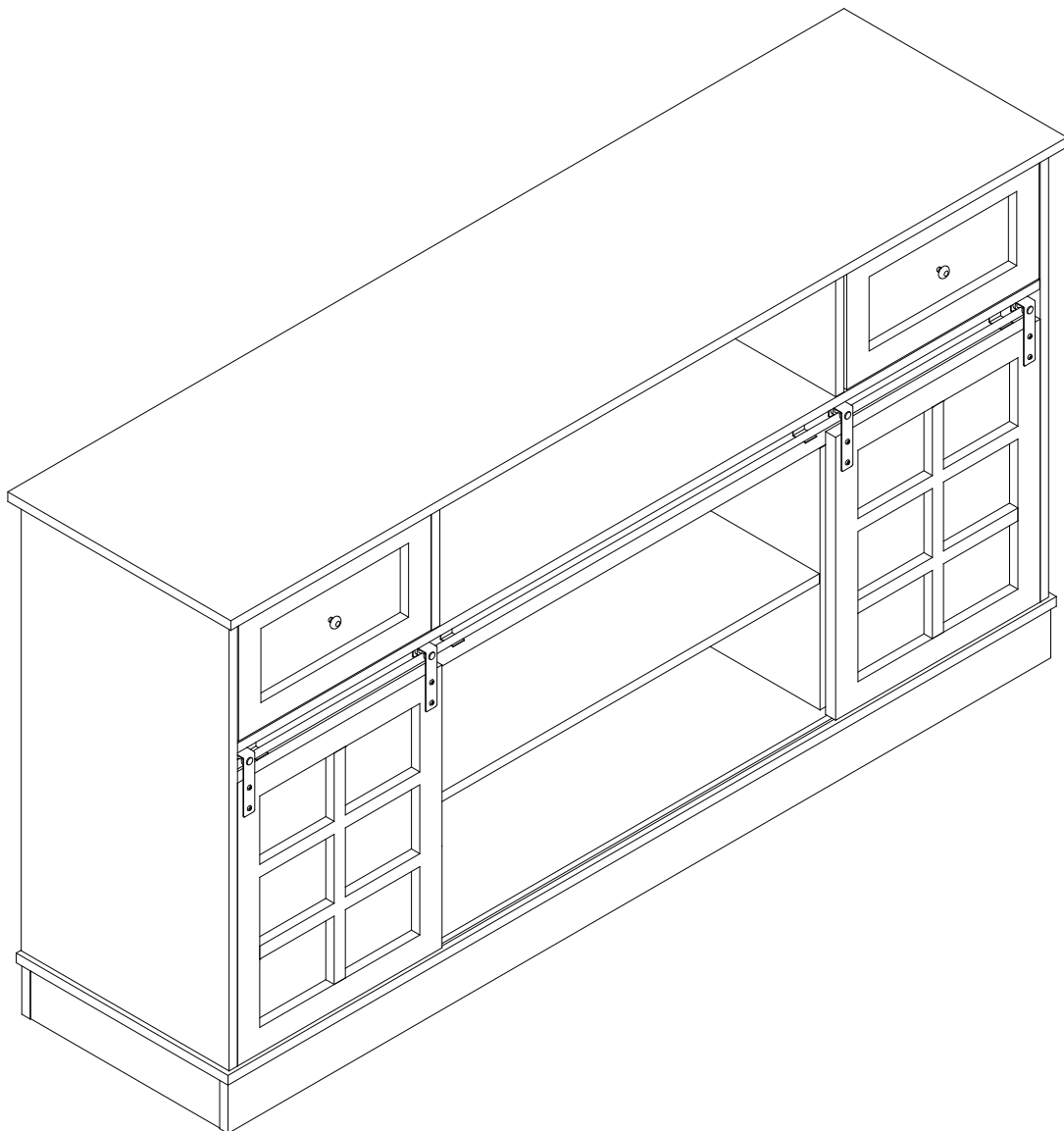

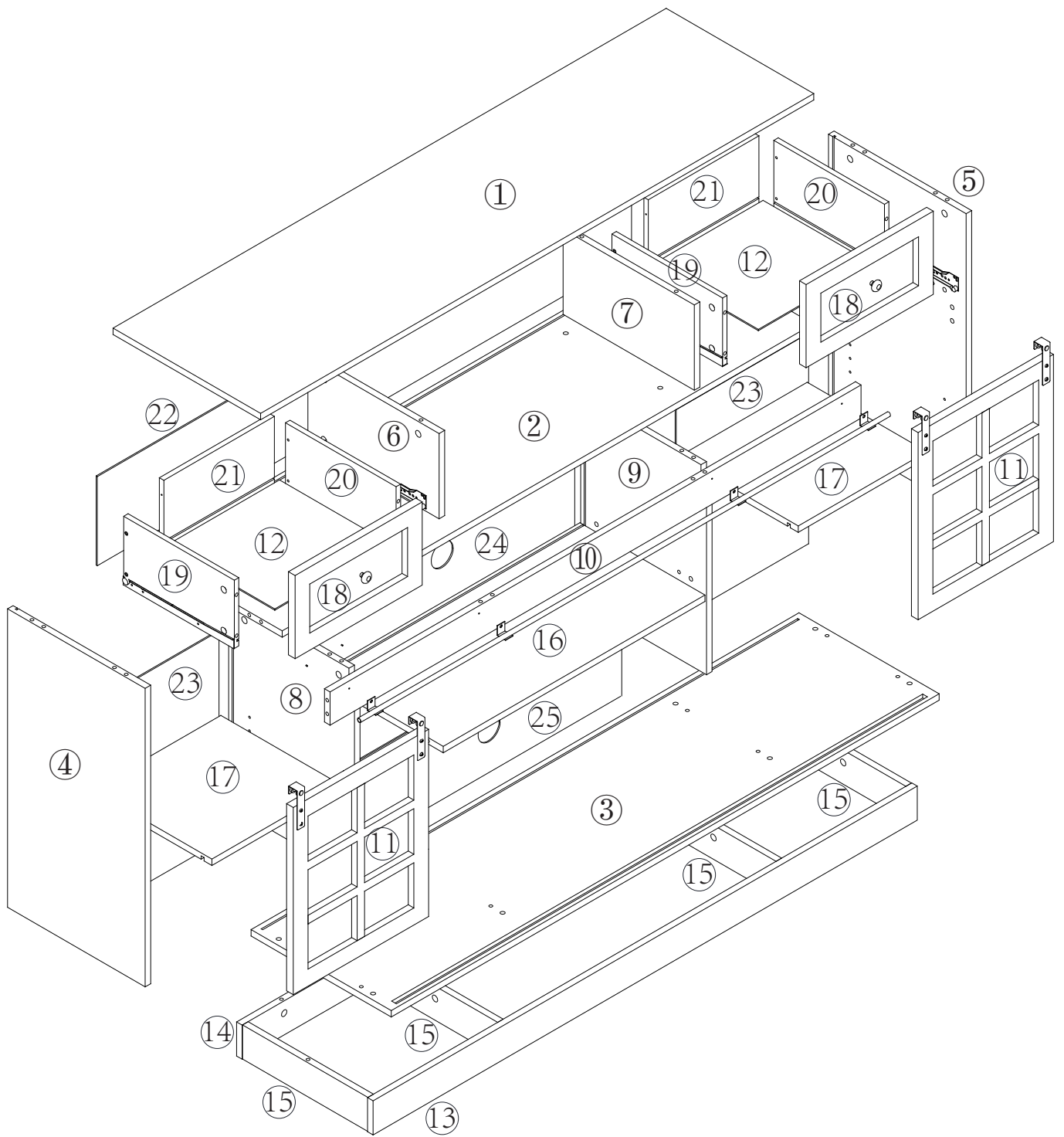

① x 1

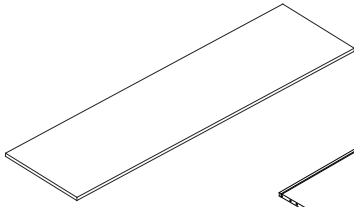

② x 1

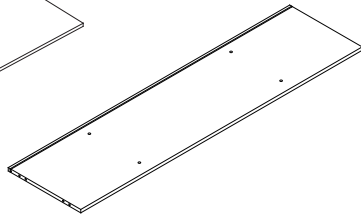

③ x 1

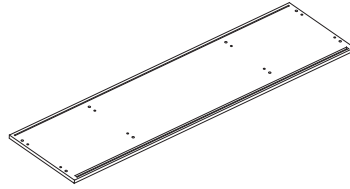

④ x 1

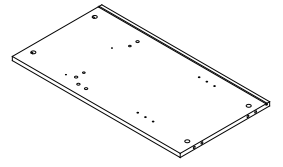

⑤ x 1

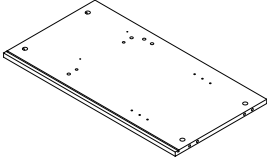

⑥ x 1

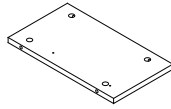

⑦ x 1

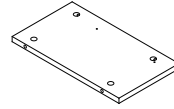

⑧ x 1

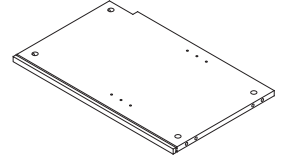

⑨ x 1

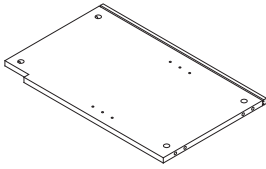

⑩ x 1

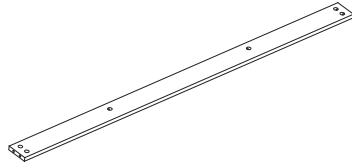

⑪ x 2

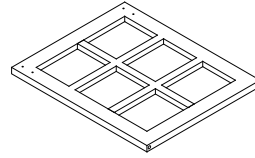

⑫ x 2

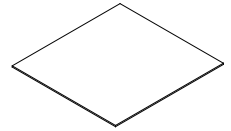

⑬ x 1

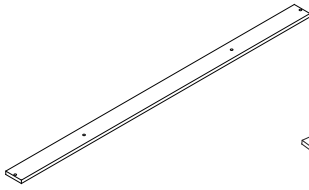

⑭ x 1

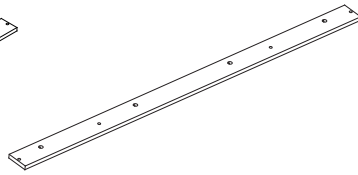

⑮ x 4

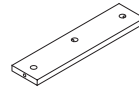

⑯ x 1

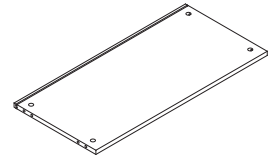

⑰ x 2

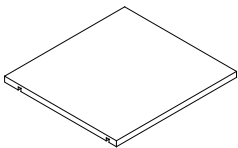

⑱ x 2

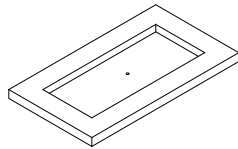

⑲ x 2

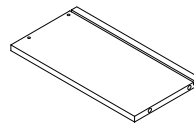

⑳ x 2

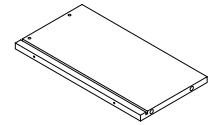

㉑ x 2

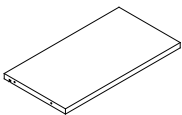

㉒ x 1

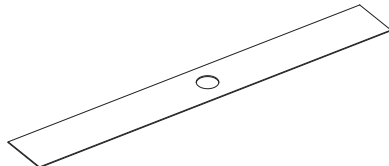

㉓ x 2

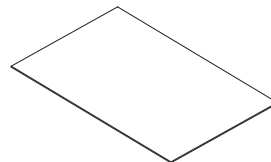

㉔ x 1

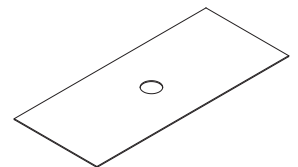

㉕ x 1

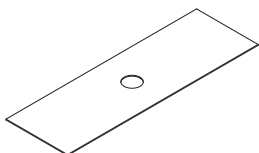

Hardwareliste

Größe



$\phi 15 \times 9.5 \text{mm}$

A X 62



B X 62

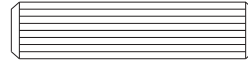

$\phi 8 \times 30 \text{mm}$

C X 28

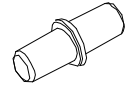

DX 8

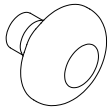

EX 2

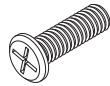

M4x8mm

FX 2

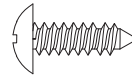

$\phi 4 \times 14 \text{mm}$

G X 12

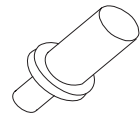

H X 4

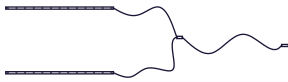

I X 1

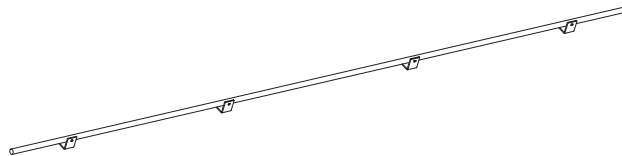

J X 1

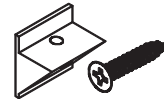

K X 4

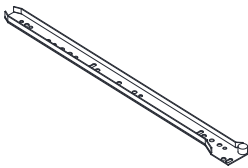

L X 2

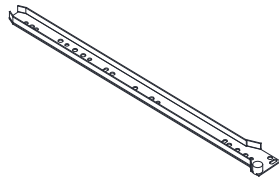

MX 2

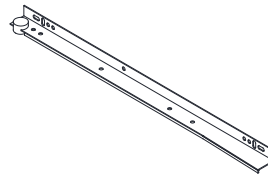

N X 2

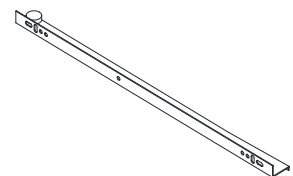

OX 2

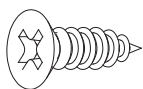

3.5x12mm

P X 16

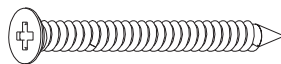

3.5x35mm

Q X 8

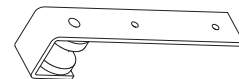

R X 4

Schritt 1

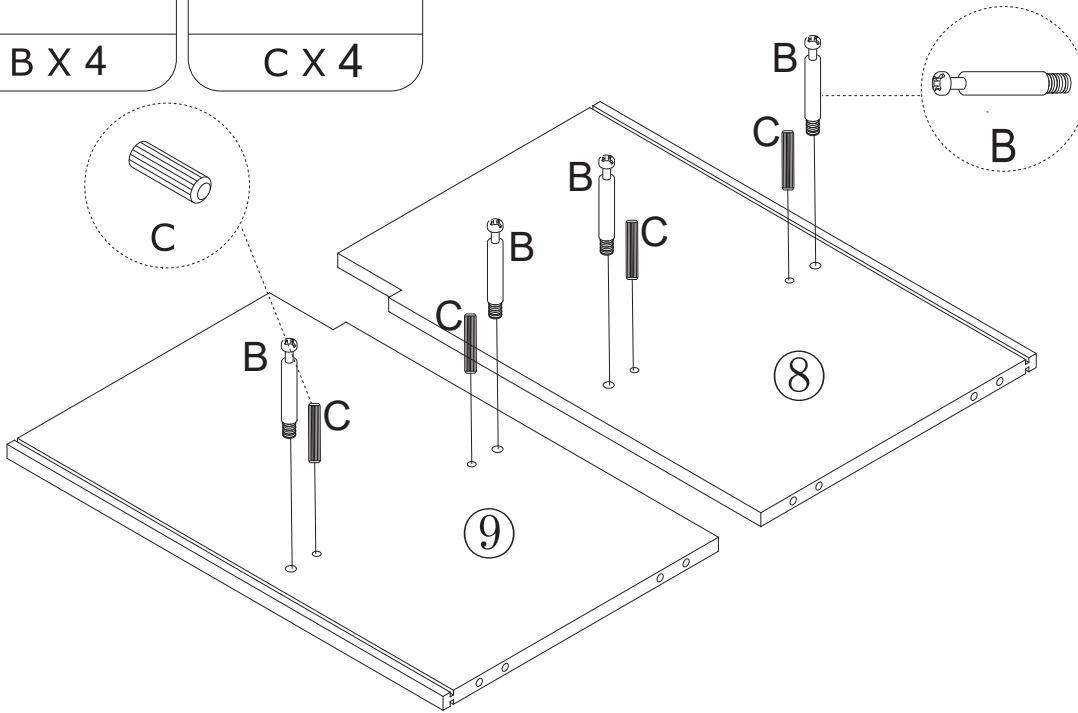
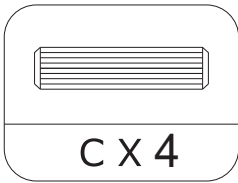
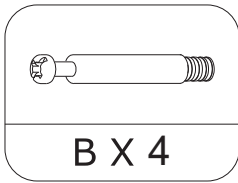

Schritt 2

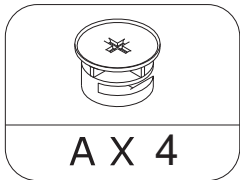

<p>B</p>		<p>Arrow must face hole</p> <p>⊕ A</p>	
<p>Gently screw cam bolt into the threaded anchor.</p>		<p>Lightly glue wood dowel and connect to second panel by inserting dowels into holes.</p>	<p>Screw the camlock firmly into locked position.</p>

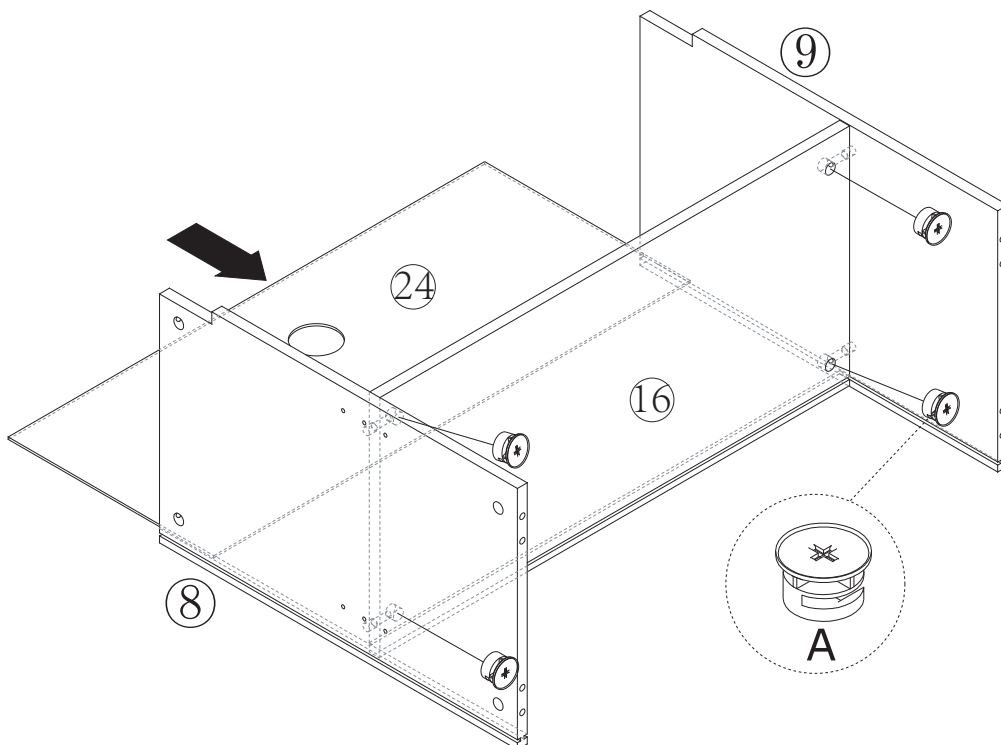

Schritt 3

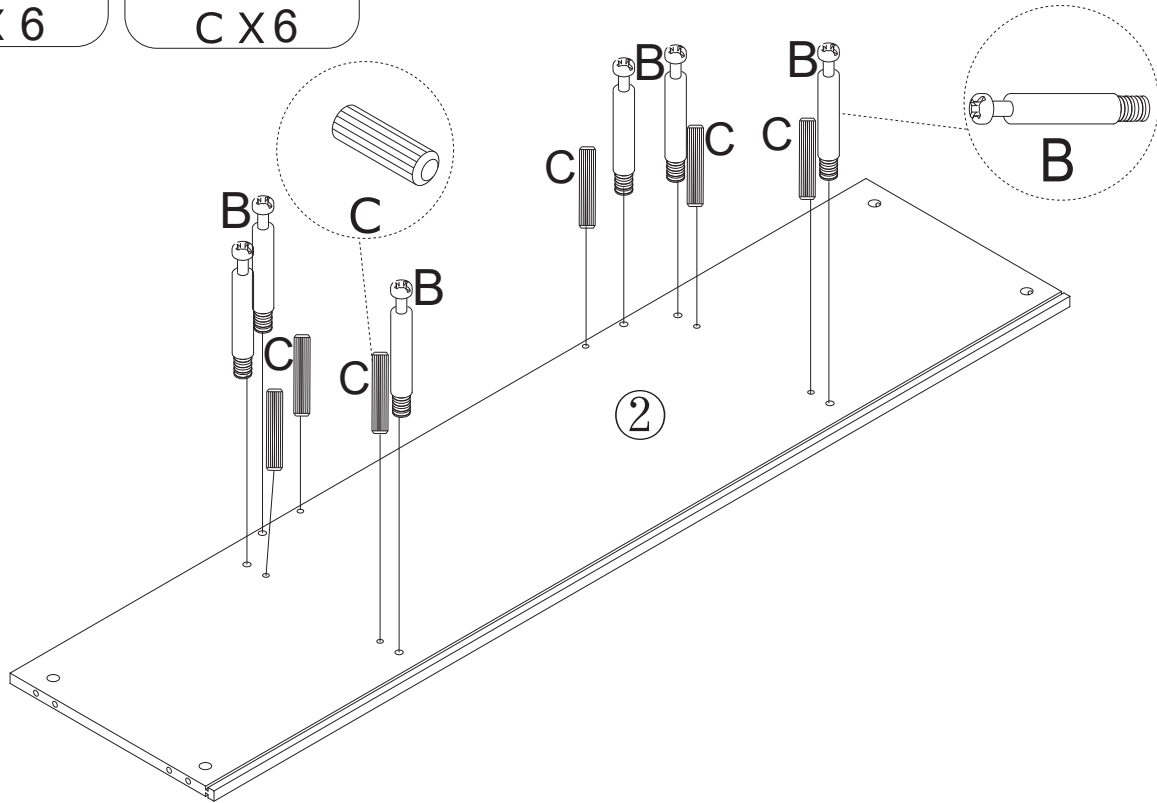
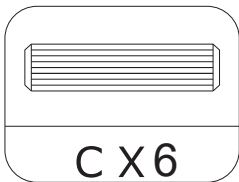
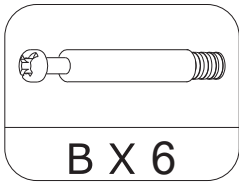

Schritt 4

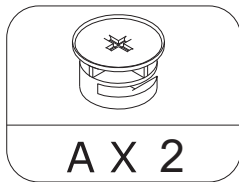

<p>B</p>		<p>Arrow must face hole</p> <p>A</p>	
<p>Gently screw cam bolt into the threaded anchor.</p>		<p>Lightly glue wood dowel and connect to second panel by inserting dowels into holes.</p>	<p>Screw the camlock firmly into locked position.</p>

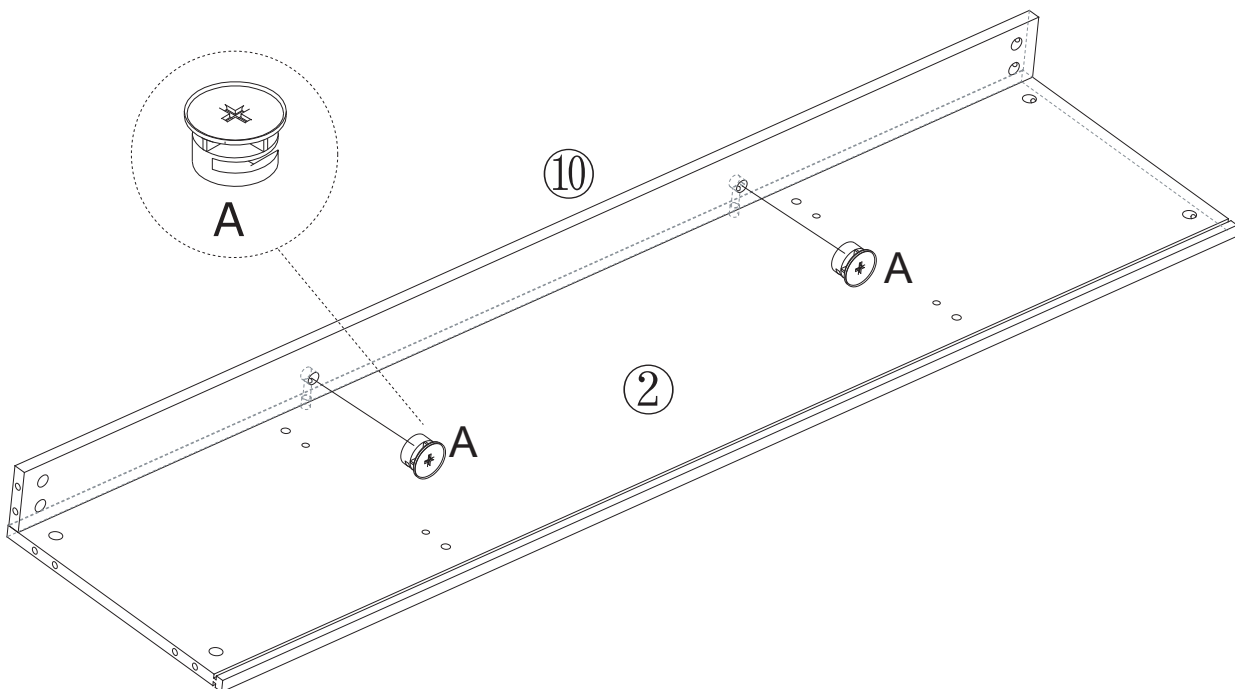

Schritt 5

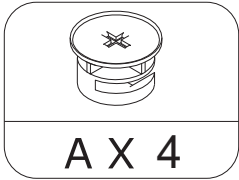

A X 4

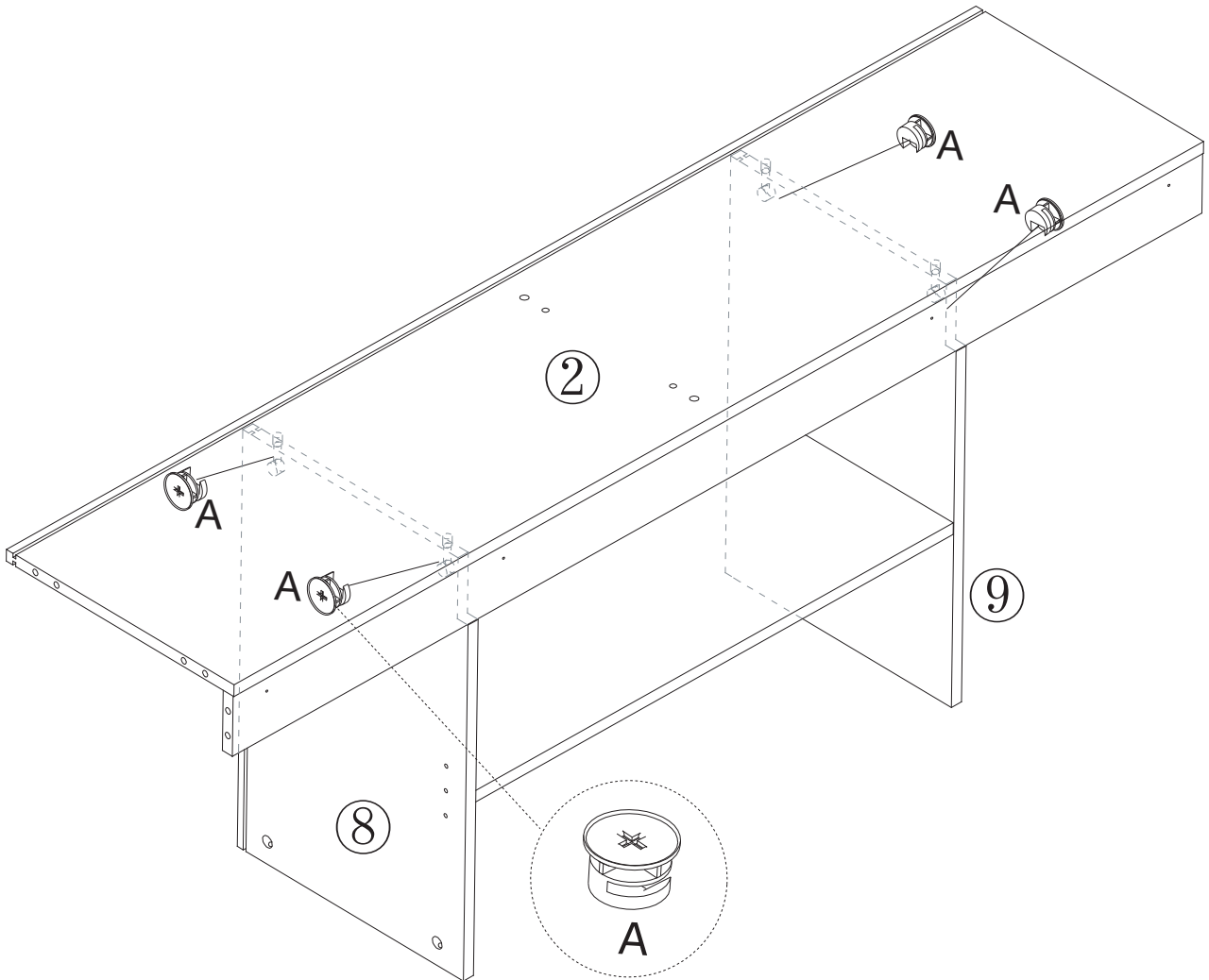

		<p>Arrow must face hole</p>	
<p>Gently screw cam bolt into the threaded anchor.</p>		<p>Lightly glue wood dowel and connect to second panel by inserting dowels into holes.</p>	<p>Screw the camlock firmly into locked position.</p>

Schritt 6

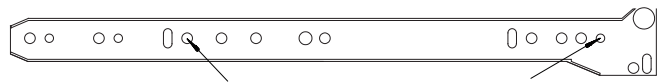
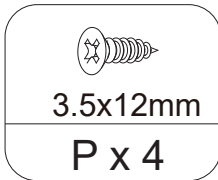
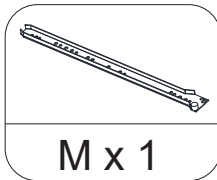
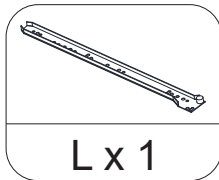

Assemble the screw into the hole
Mark with arrows

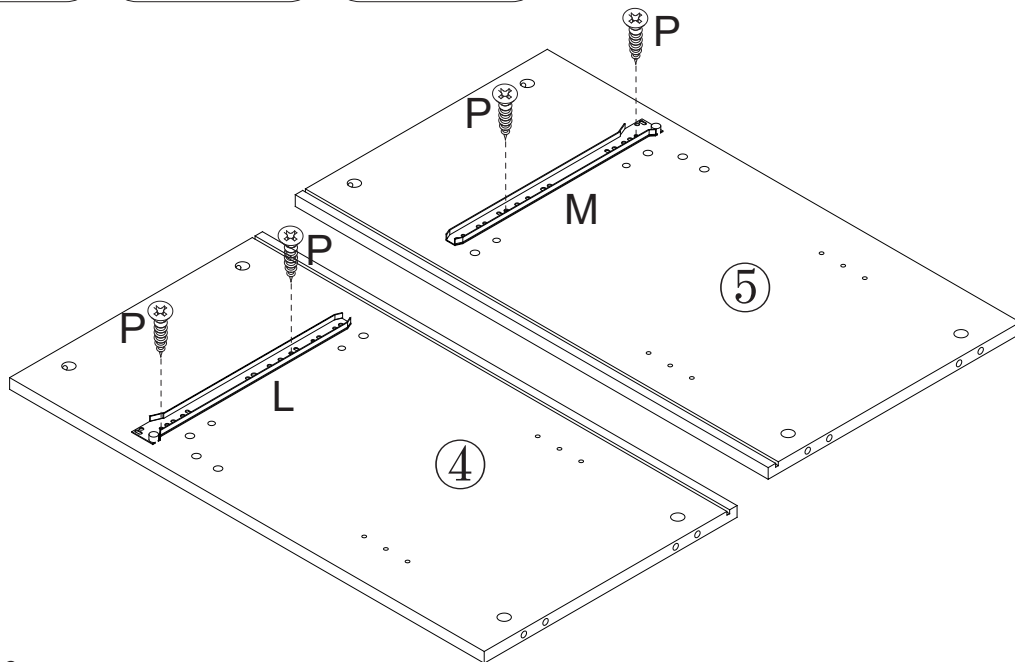

Schritt 7

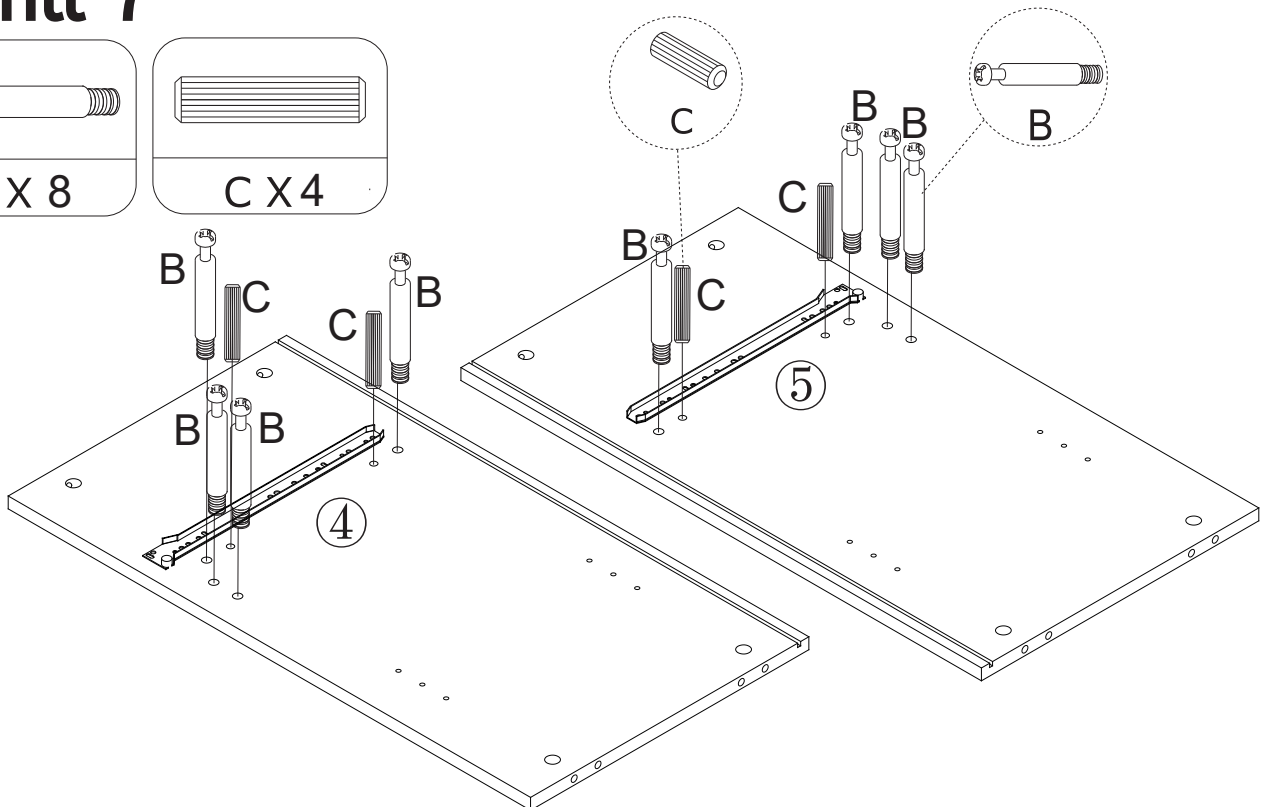
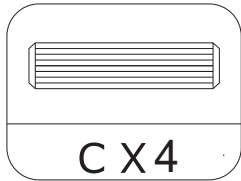
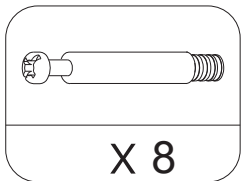

		<p>Arrow must face hole</p>	
<p>Gently screw cam bolt into the threaded anchor.</p>		<p>Lightly glue wood dowel and connect to second panel by inserting dowels into holes.</p>	<p>Screw the camlock firmly into locked position.</p>

Schritt 8

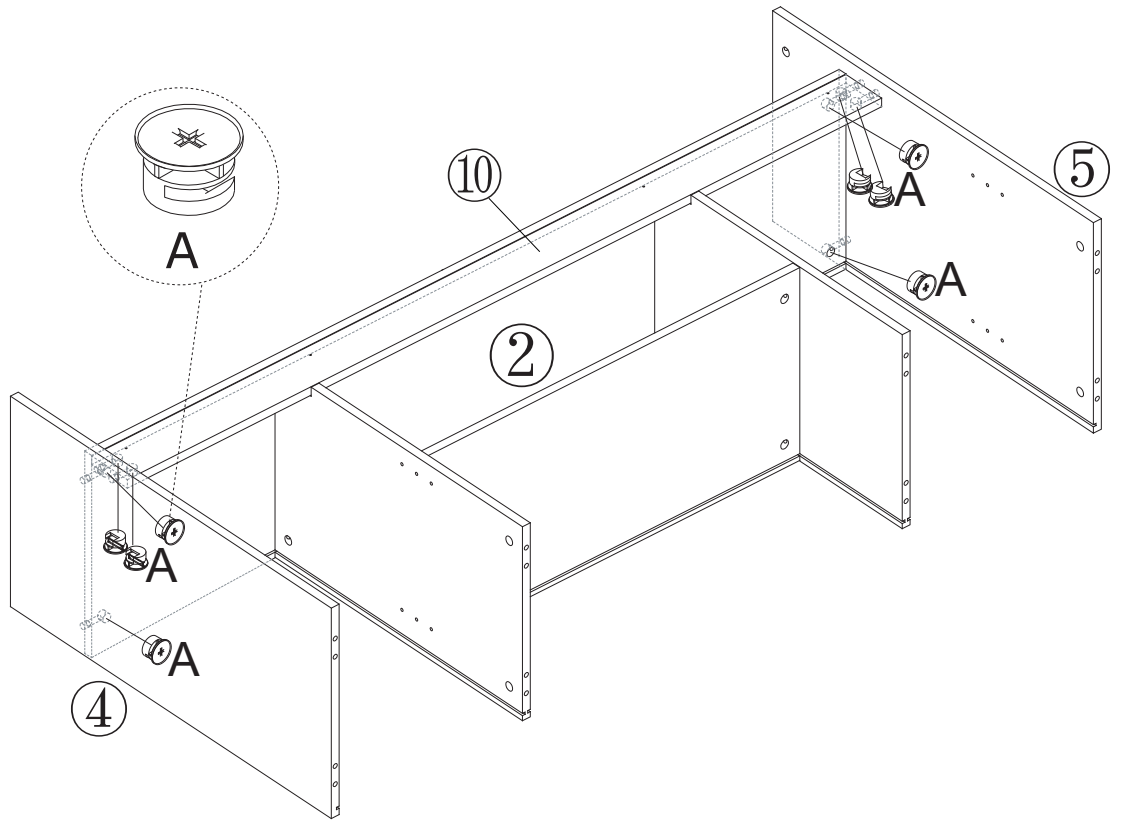
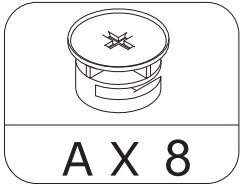

<p>B</p>		<p>Arrow must face hole</p> <p>A</p>	
<p>Gently screw cam bolt into the threaded anchor.</p>		<p>Lightly glue wood dowel and connect to second panel by inserting dowels into holes.</p>	<p>Screw the camlock firmly into locked position.</p>

Schritt 9

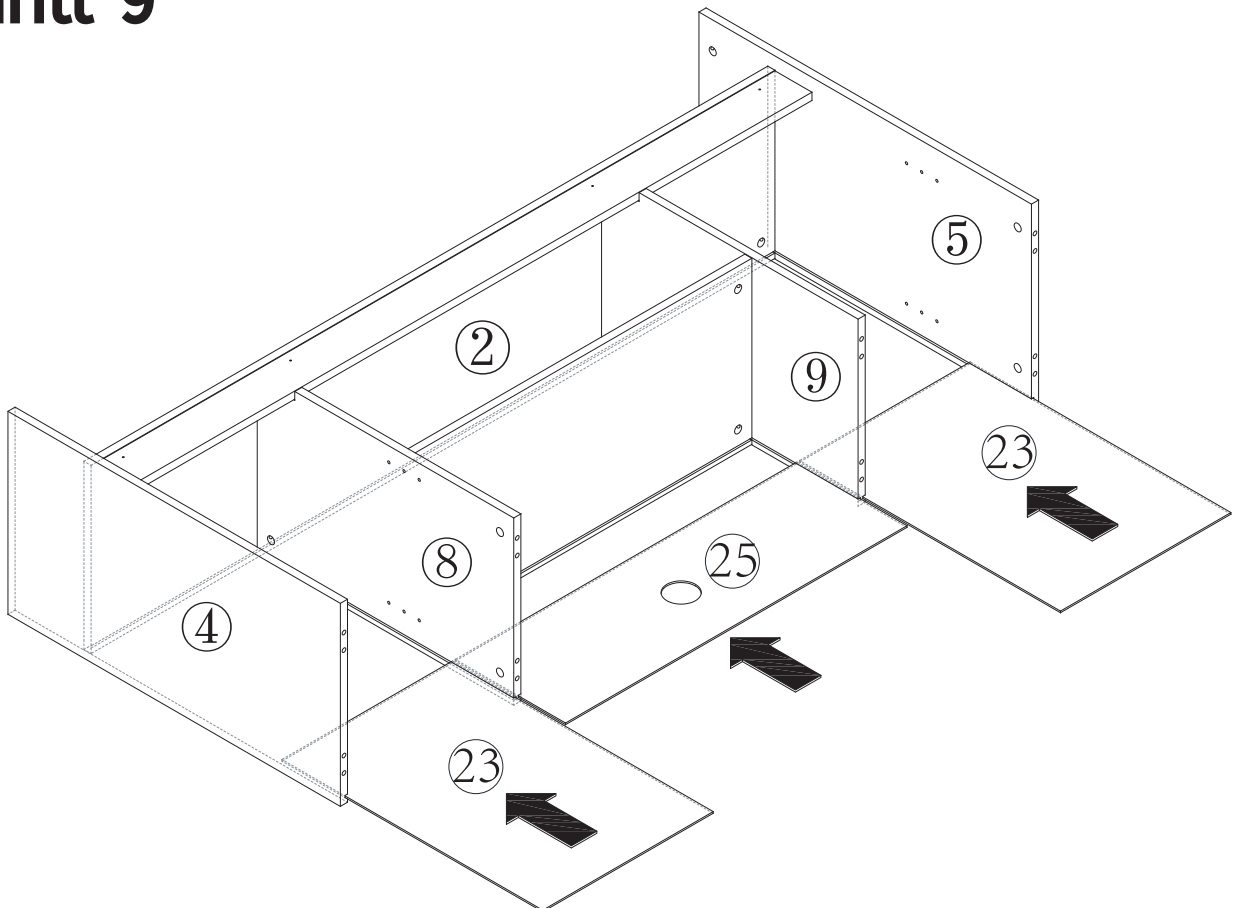

Schritt 10

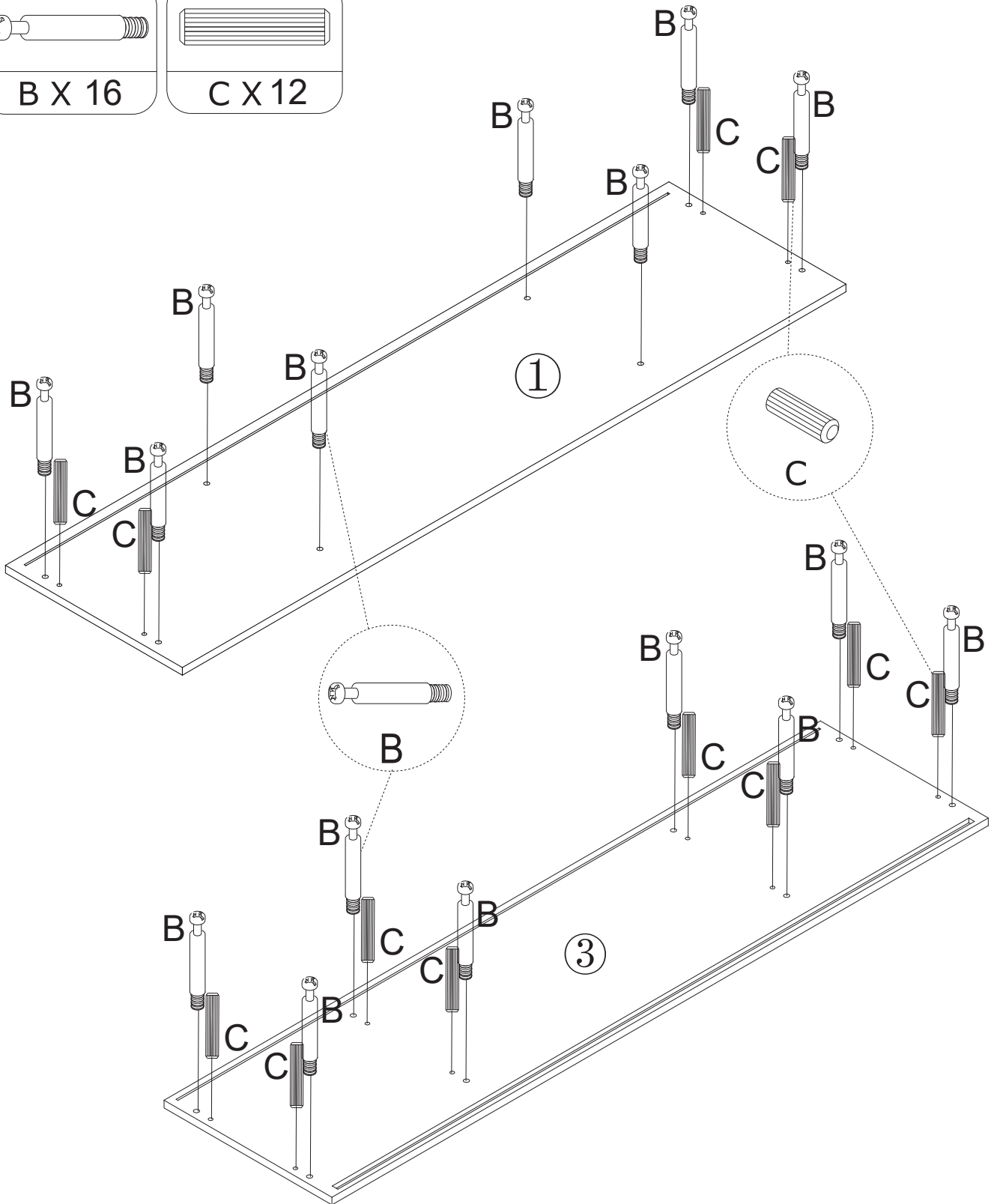
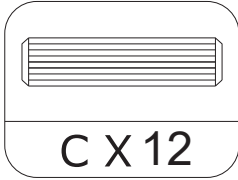
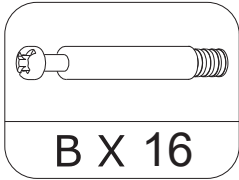

		<p>Arrow must face hole</p> <p>⊕ A</p>	
<p>Gently screw cam bolt into the threaded anchor.</p>		<p>Lightly glue wood dowel and connect to second panel by inserting dowels into holes.</p>	<p>Screw the camlock firmly into locked position.</p>

Schritt 11

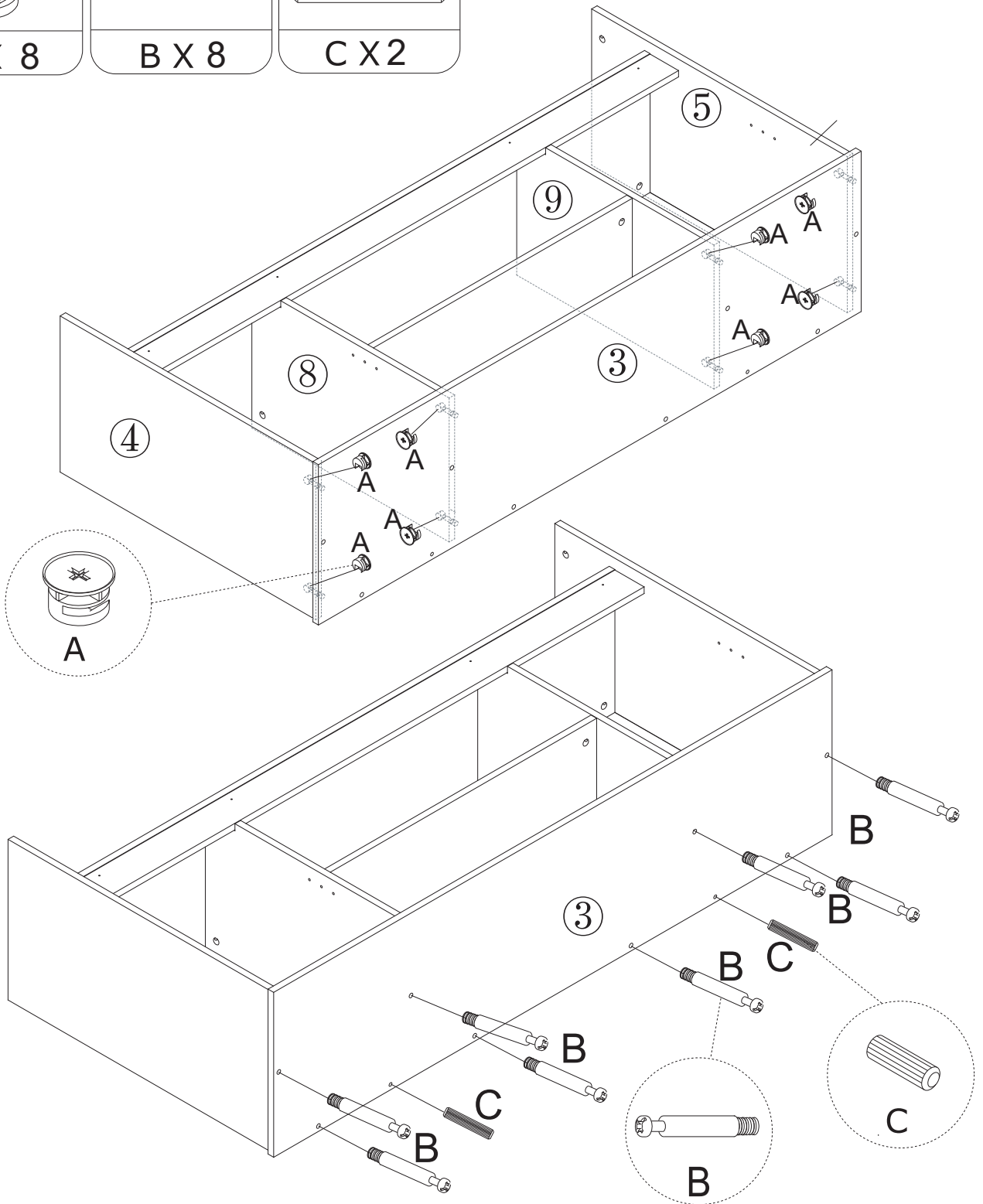
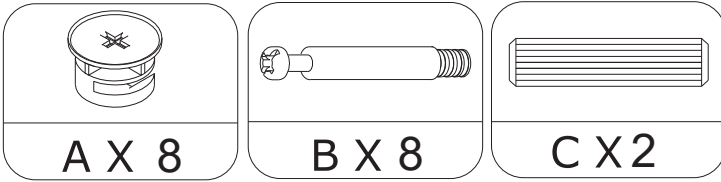

		<p>Arrow must face hole</p>	
<p>Gently screw cam bolt into the threaded anchor.</p>		<p>Lightly glue wood dowel and connect to second panel by inserting dowels into holes.</p>	<p>Screw the camlock firmly into locked position.</p>

Schritt 12

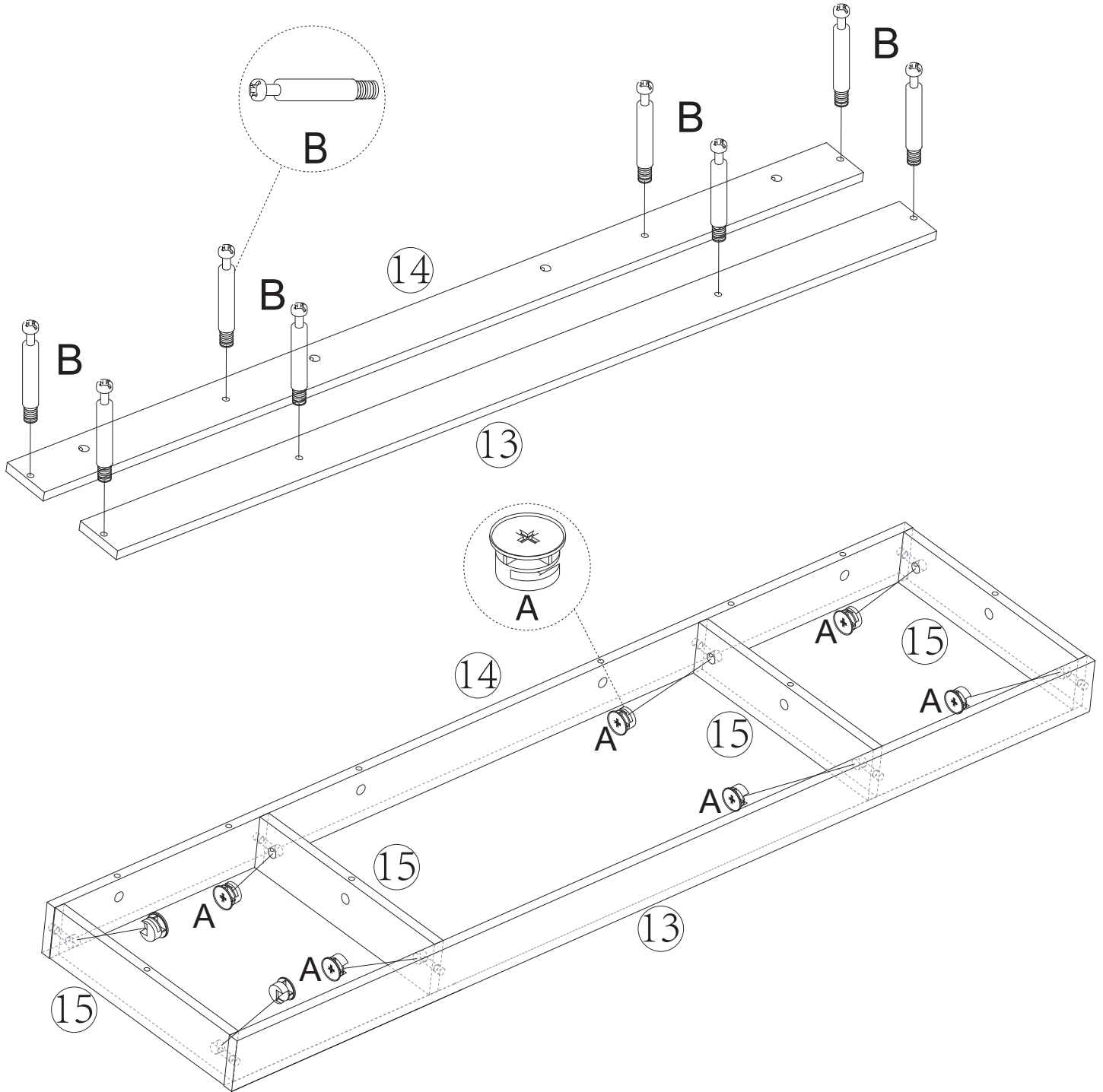
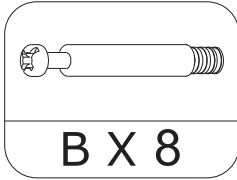
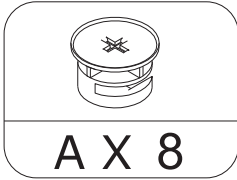

<p>B</p>		<p>Arrow must face hole</p> <p>A</p>	
<p>Gently screw cam bolt into the threaded anchor.</p>		<p>Lightly glue wood dowel and connect to second panel by inserting dowels into holes.</p>	<p>Screw the camlock firmly into locked position.</p>

Schritt 13

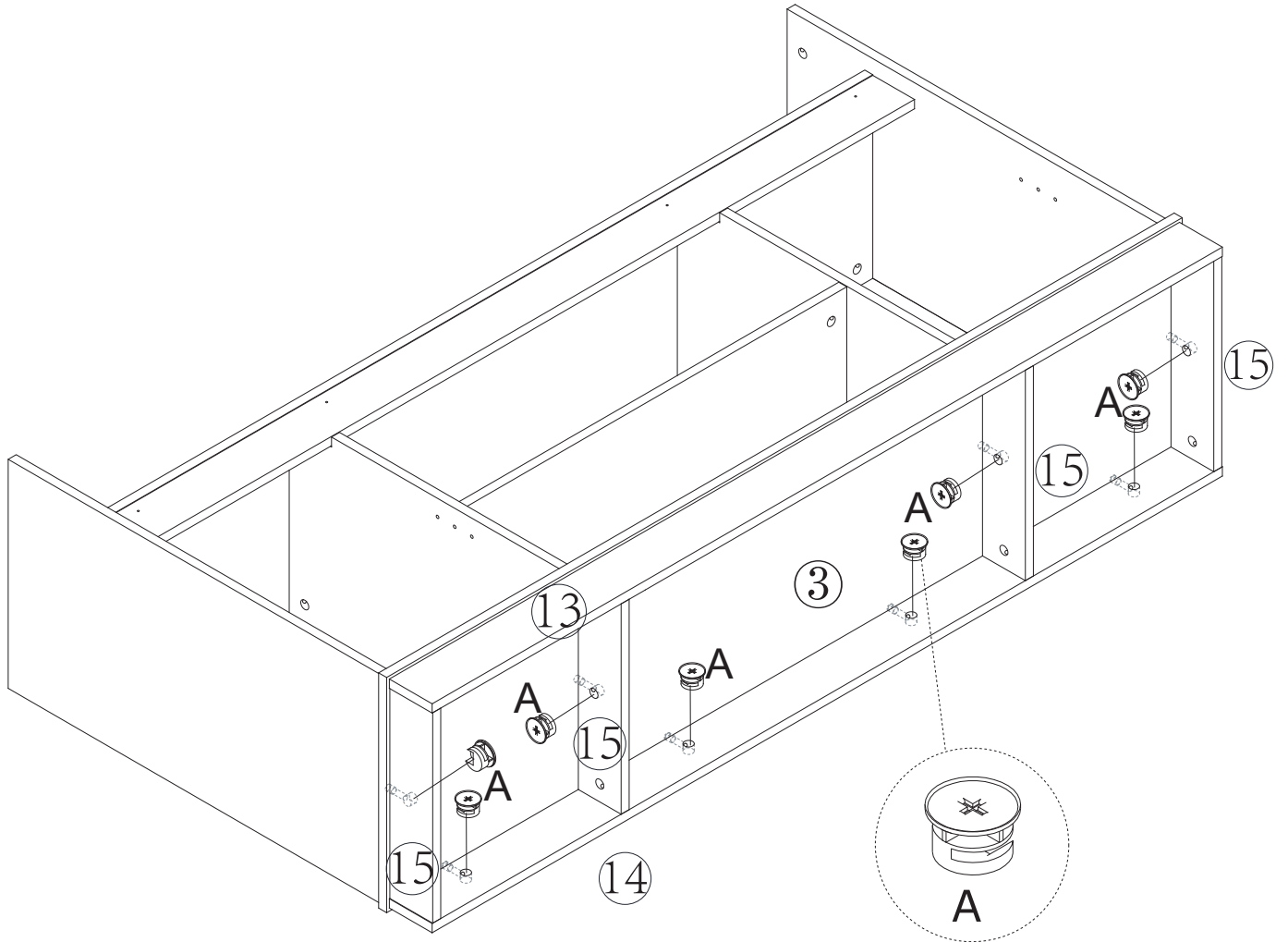
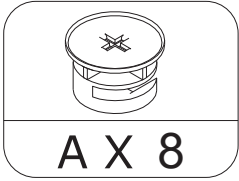

		<p>Arrow must face hole</p>	
<p>Gently screw cam bolt into the threaded anchor.</p>		<p>Lightly glue wood dowel and connect to second panel by inserting dowels into holes.</p>	<p>Screw the camlock firmly into locked position.</p>

Schritt 14

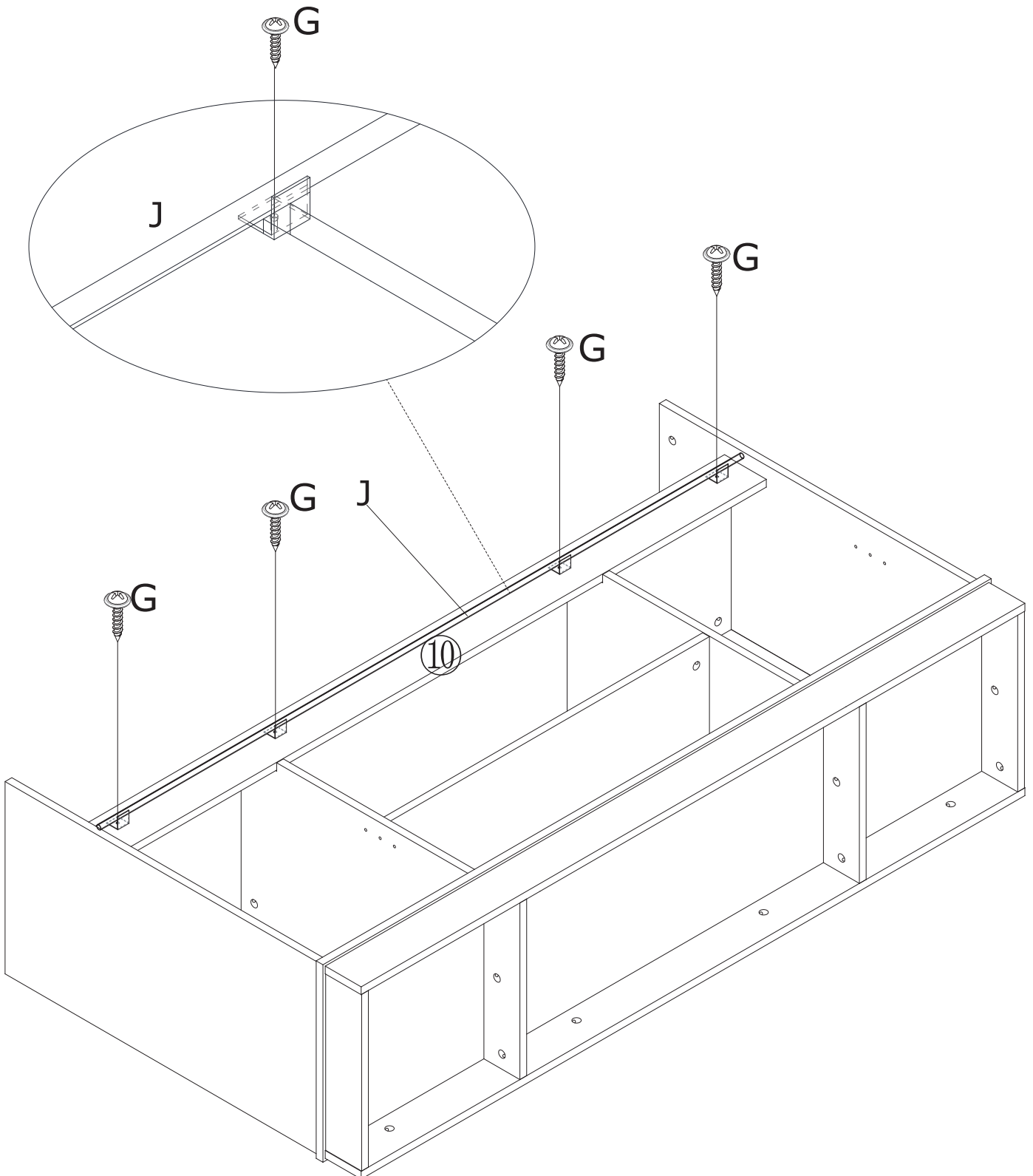
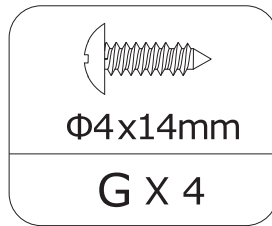
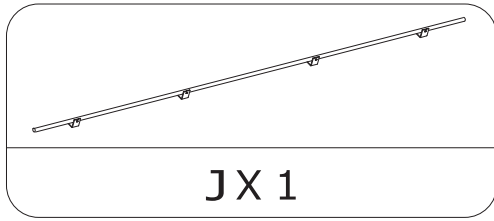

Schritt 15

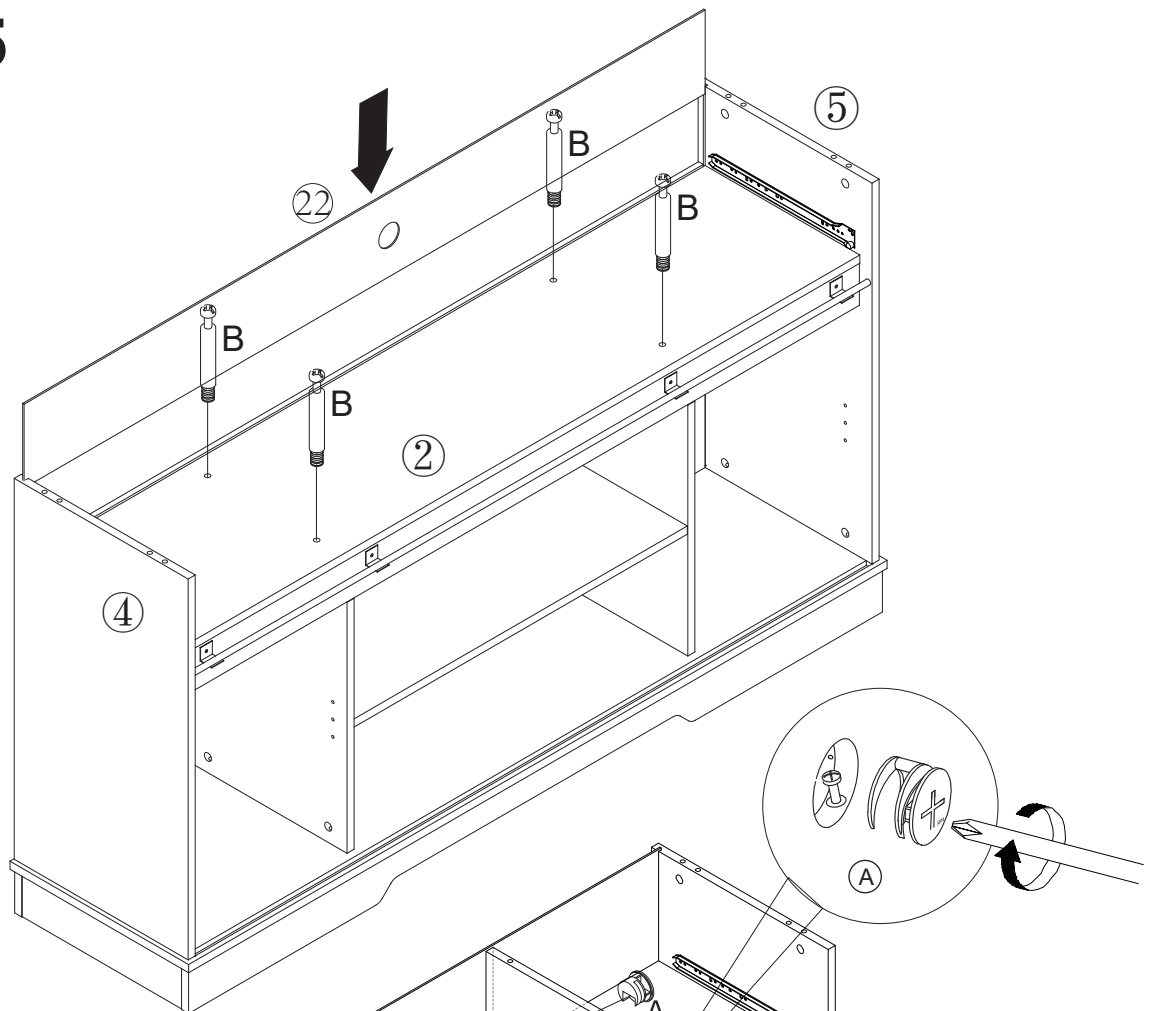
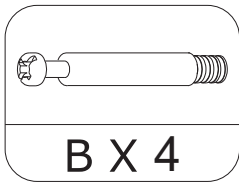

Schritt 16

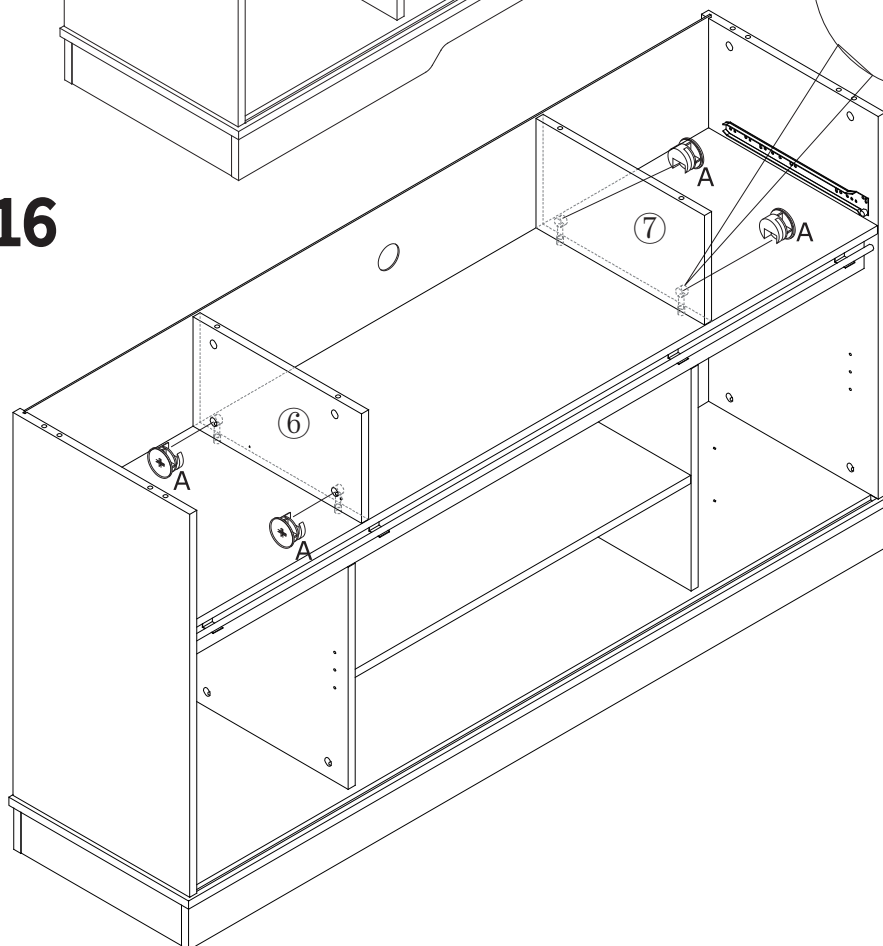

		<p>Arrow must face hole</p>	
<p>Gently screw cam bolt into the threaded anchor.</p>		<p>Lightly glue wood dowel and connect to second panel by inserting dowels into holes.</p>	<p>Screw the camlock firmly into locked position.</p>

Schritt 17

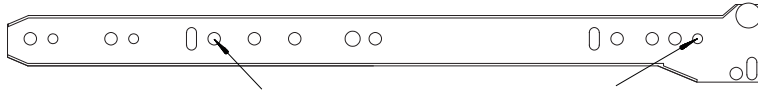
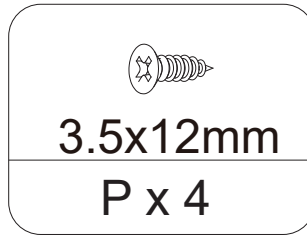
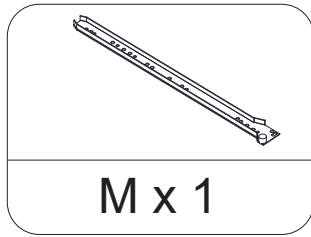
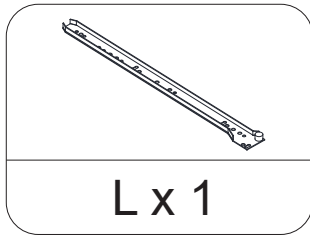

Assemble the screw into the hole
Mark with arrows

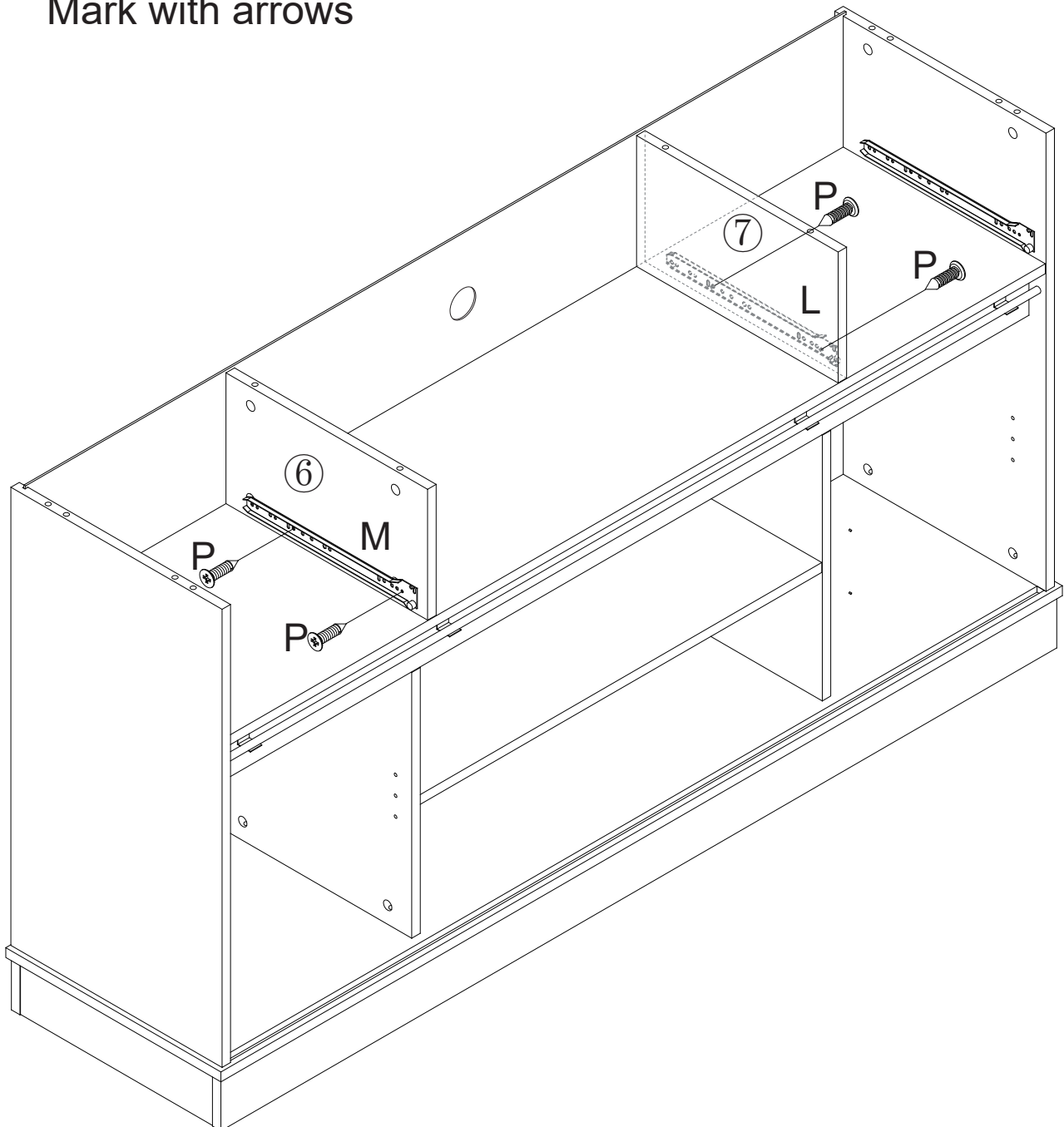

Schritt 18

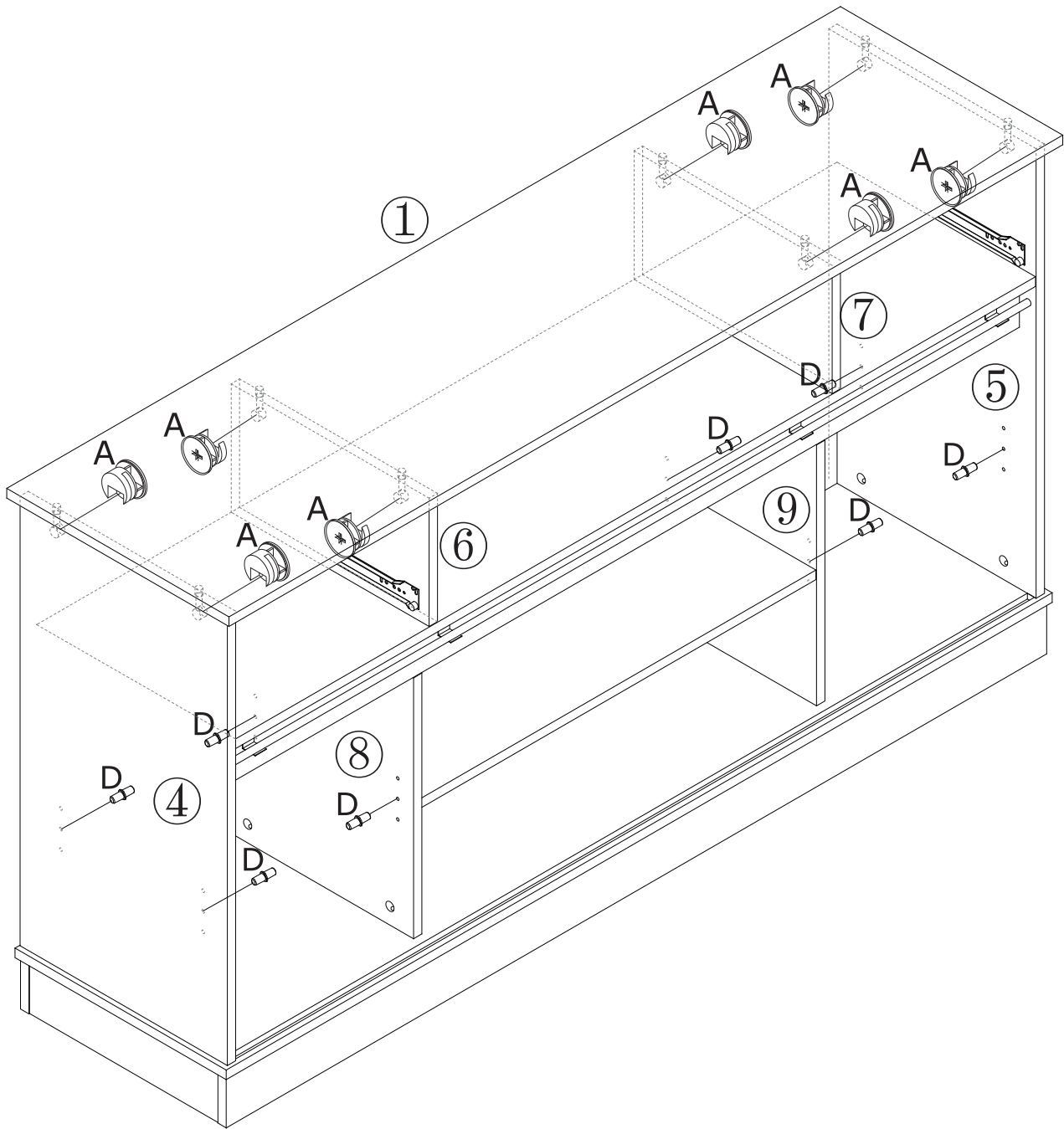
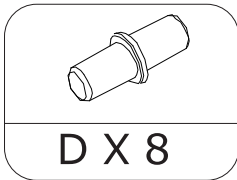
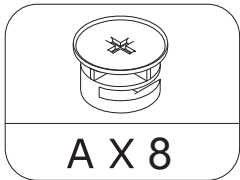

<p>B</p>		<p>Arrow must face hole</p> <p>A</p>	
<p>Gently screw cam bolt into the threaded anchor.</p>		<p>Lightly glue wood dowel and connect to second panel by inserting dowels into holes.</p>	<p>Screw the camlock firmly into locked position.</p>

Schritt 19

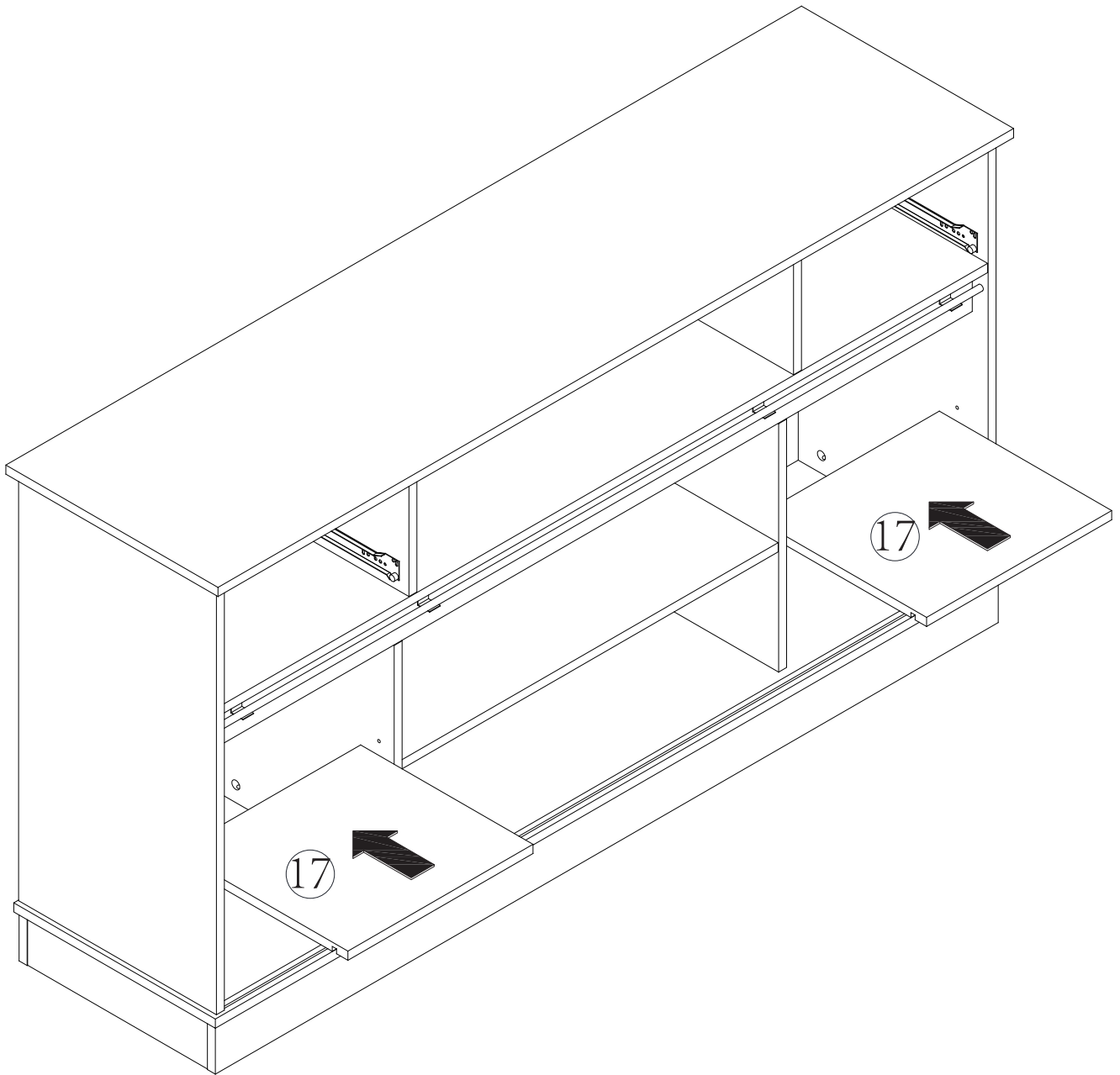

Schritt 20

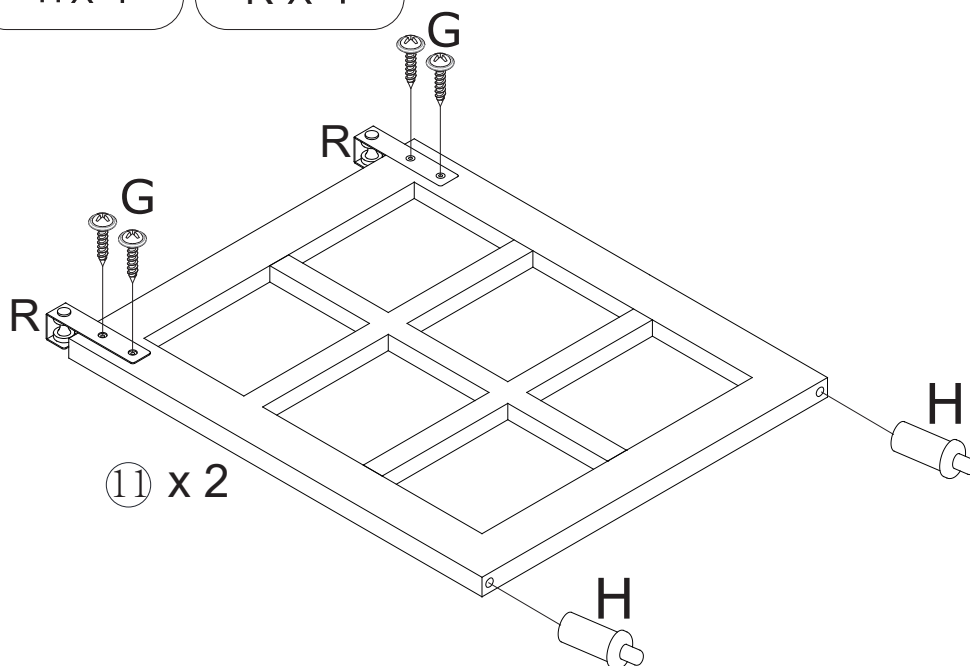
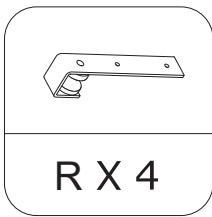
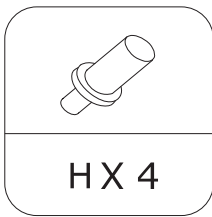
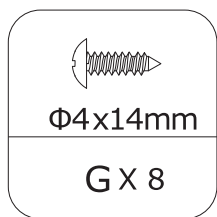

Schritt 21

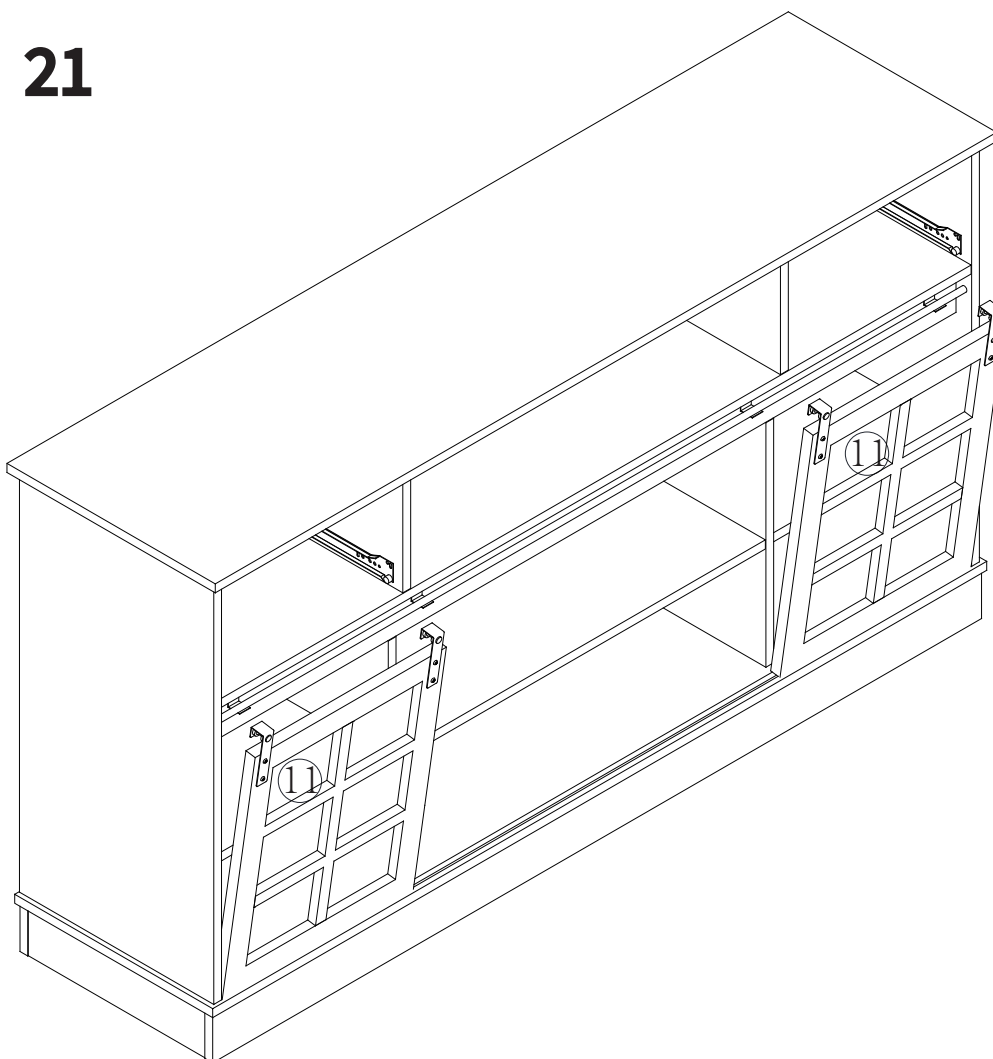

Schritt 22 x2

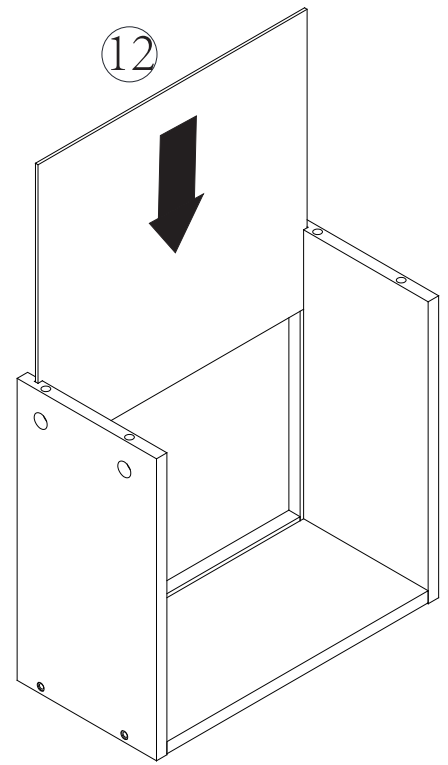
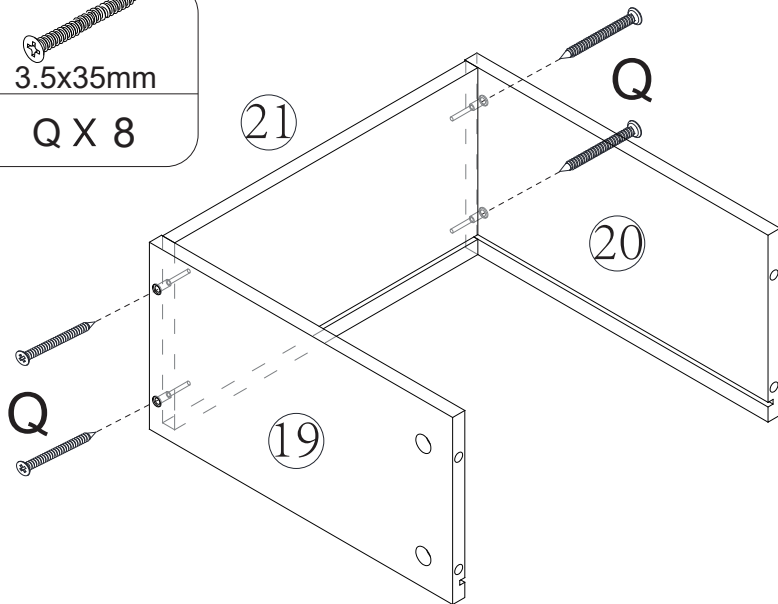
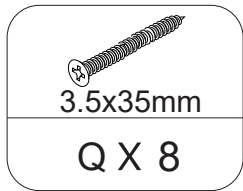

Schritt 23 x2

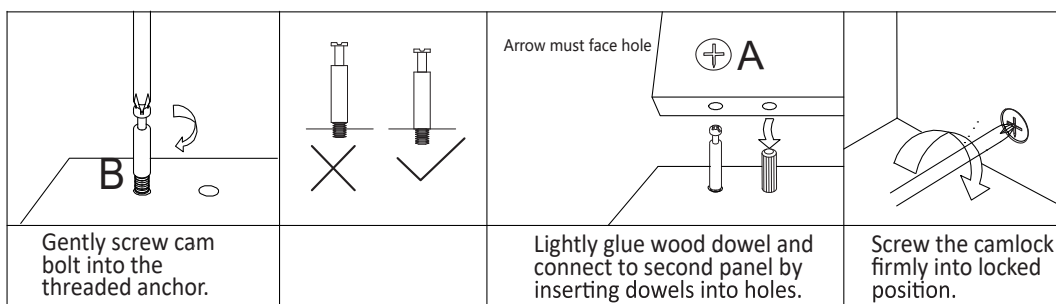
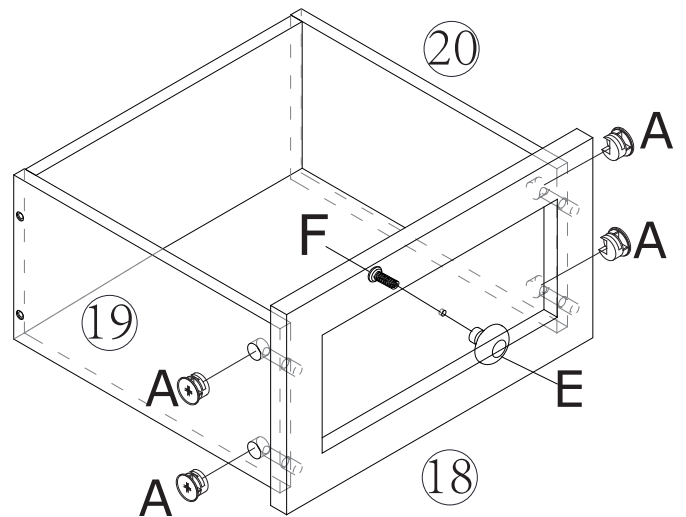
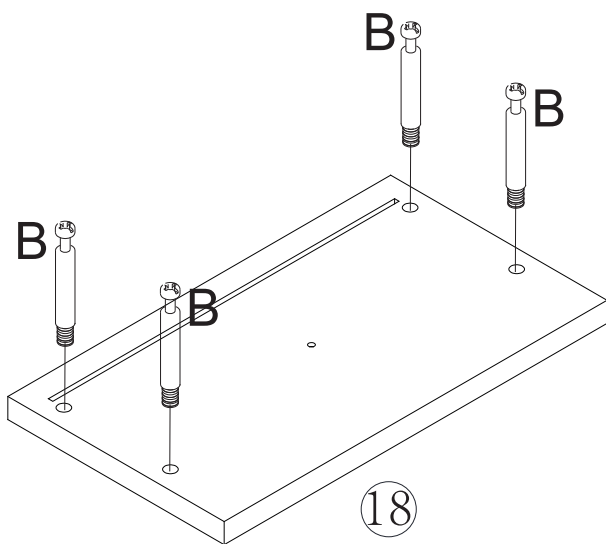
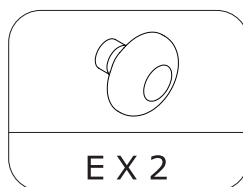
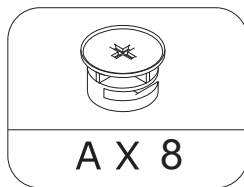
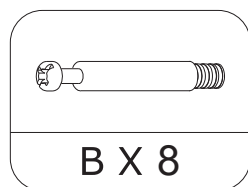

Schritt 24 x2

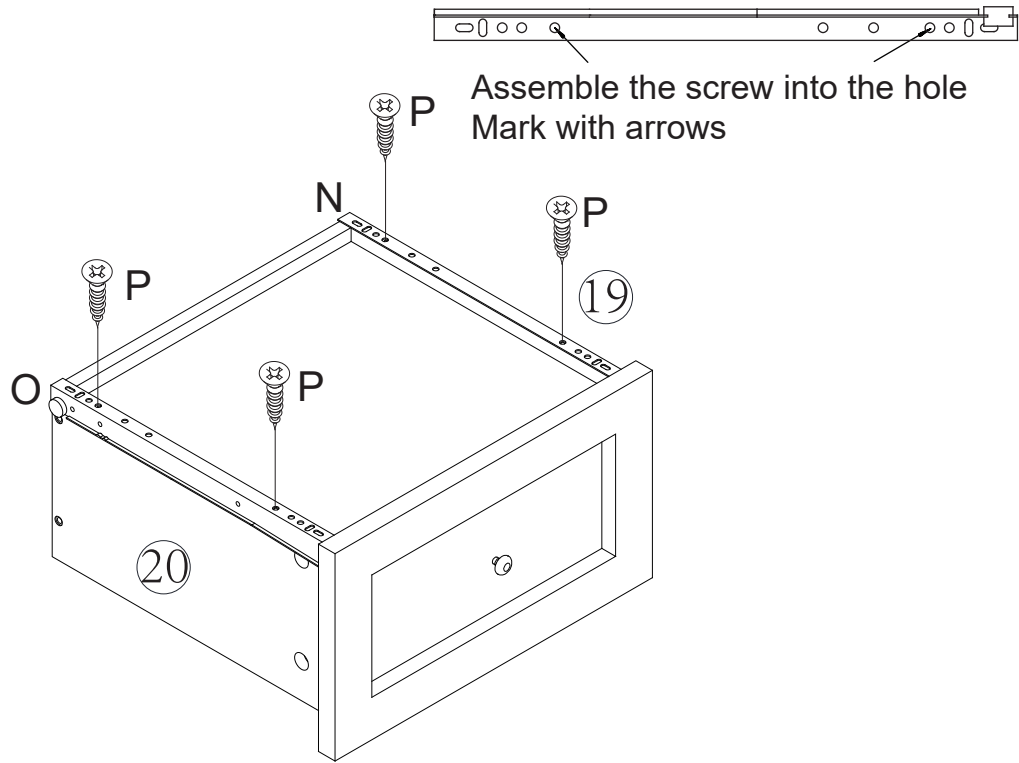
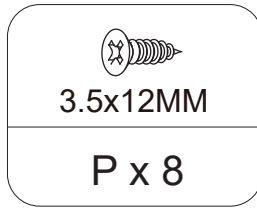
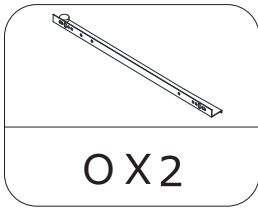
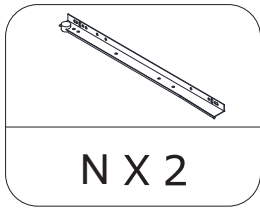

Schritt 25

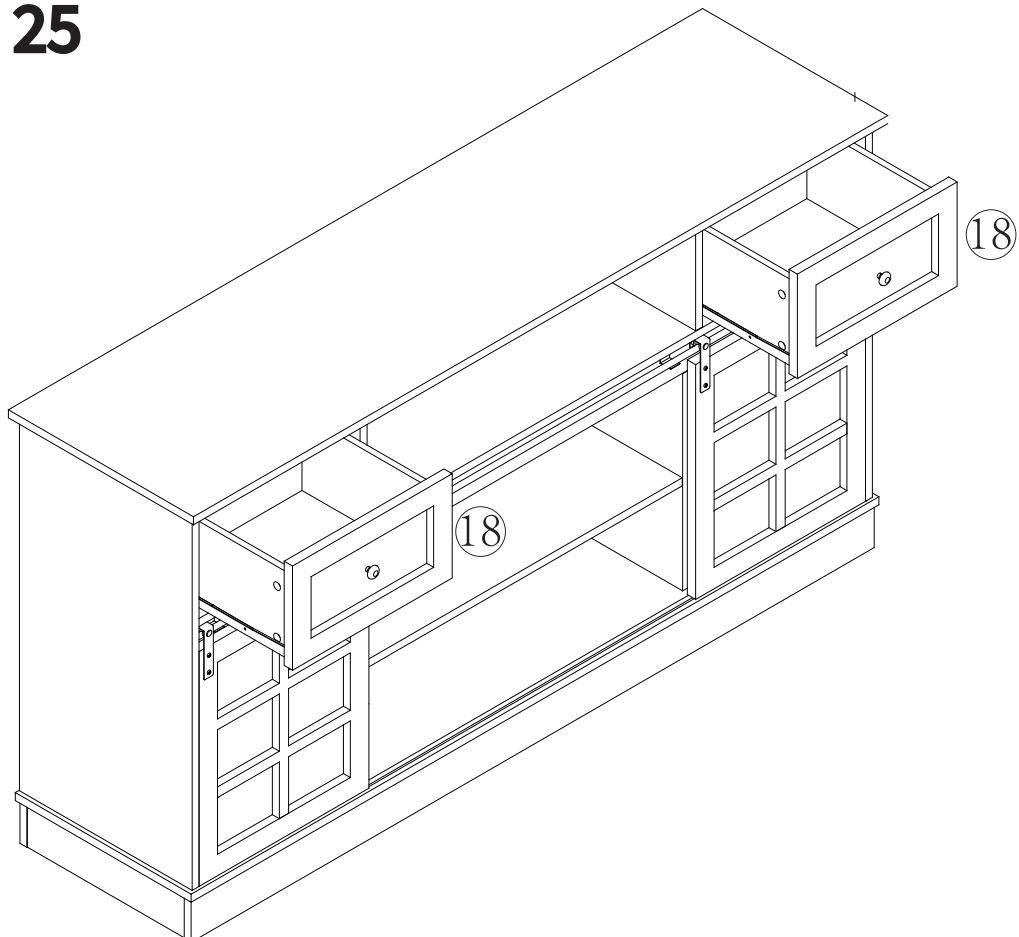

Schritt 26

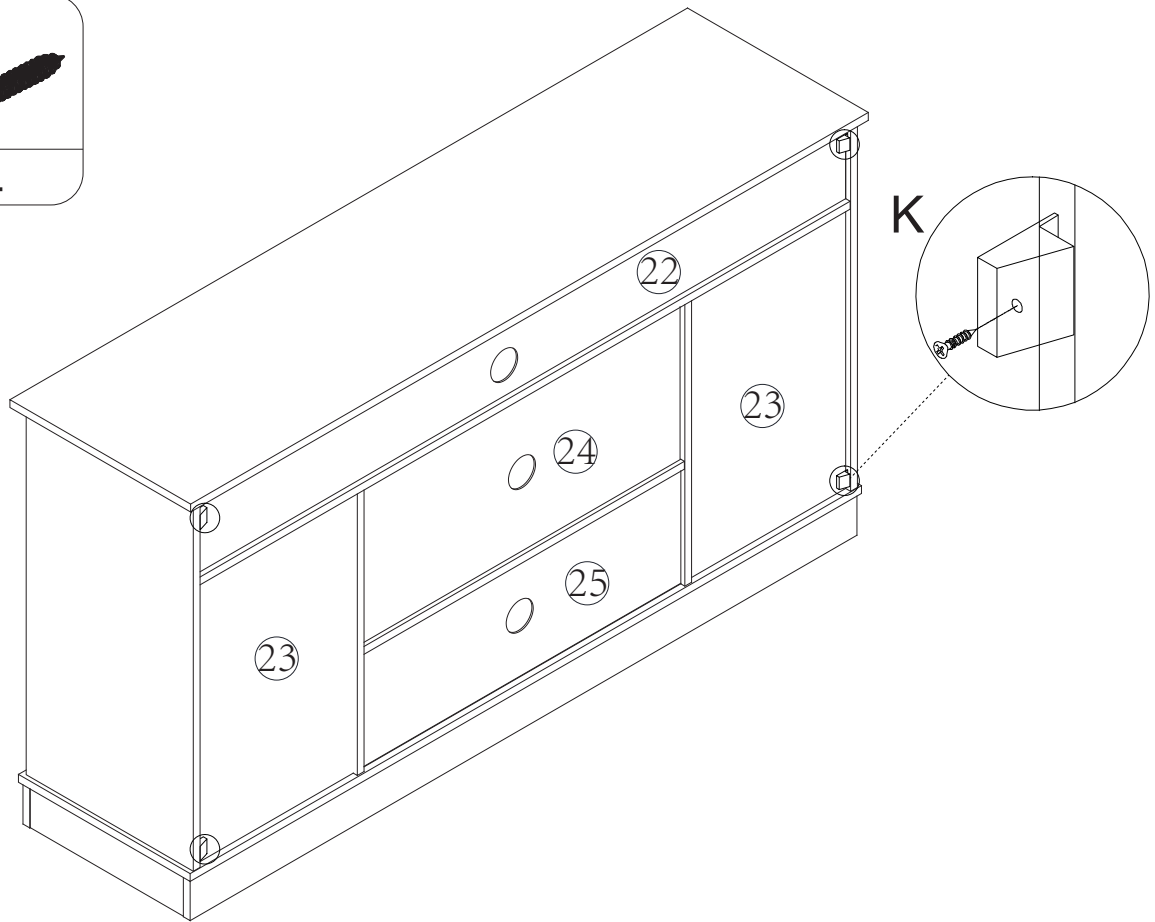
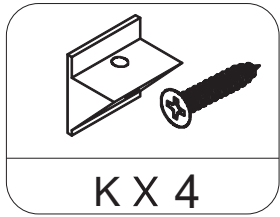

Schritt 27

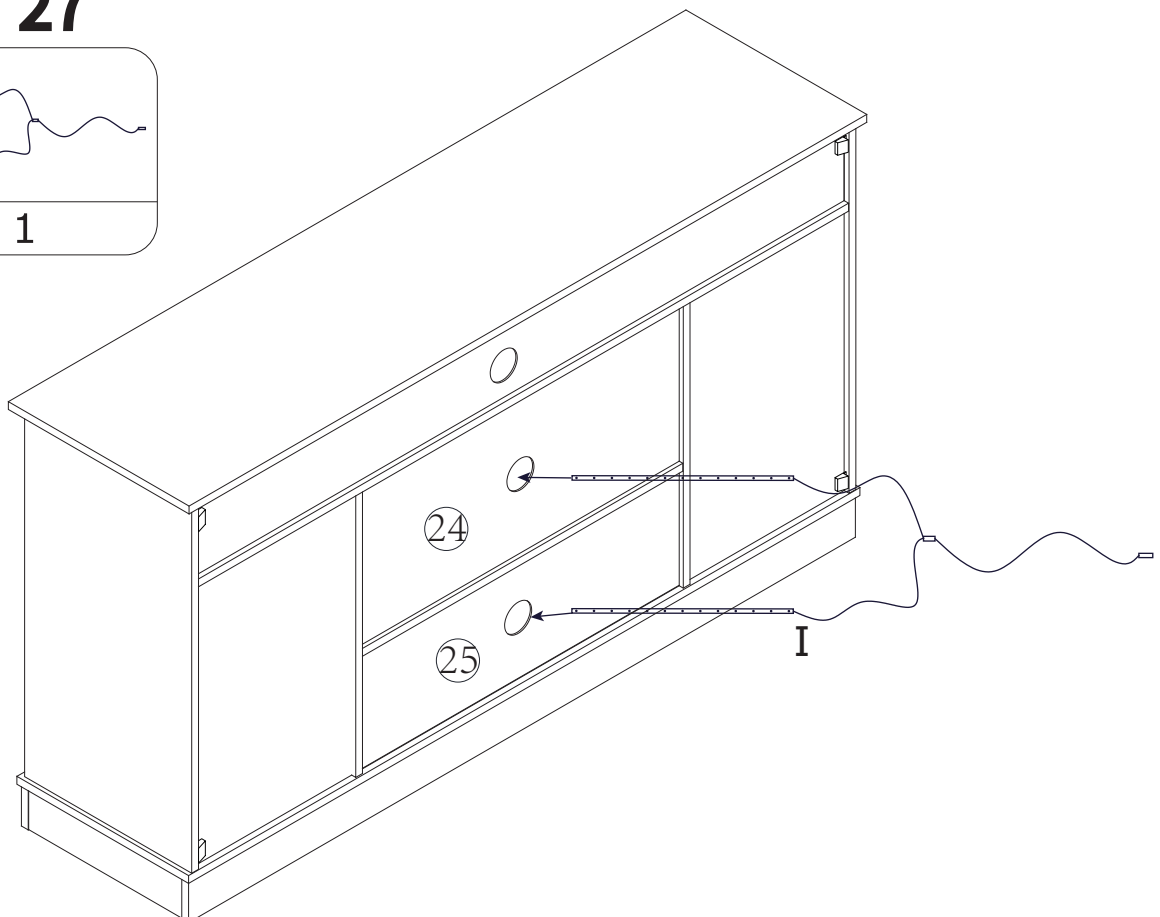
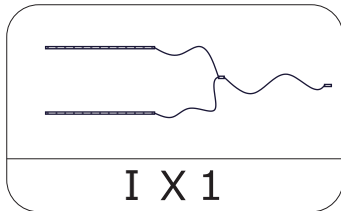

Schritt 28

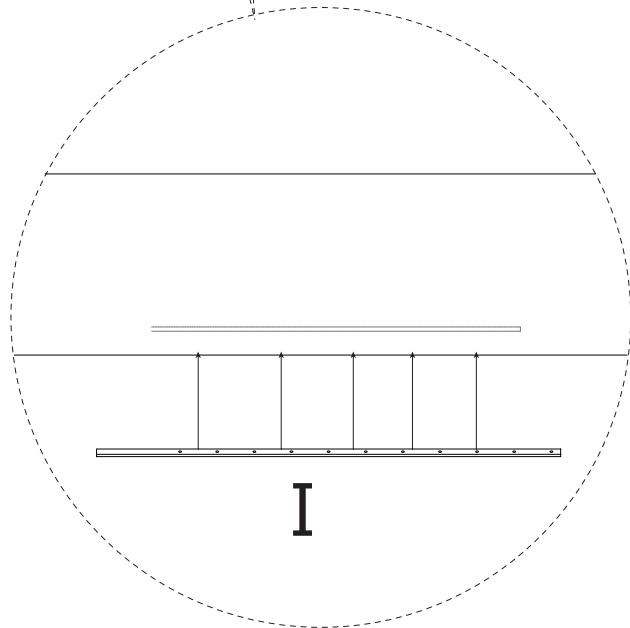
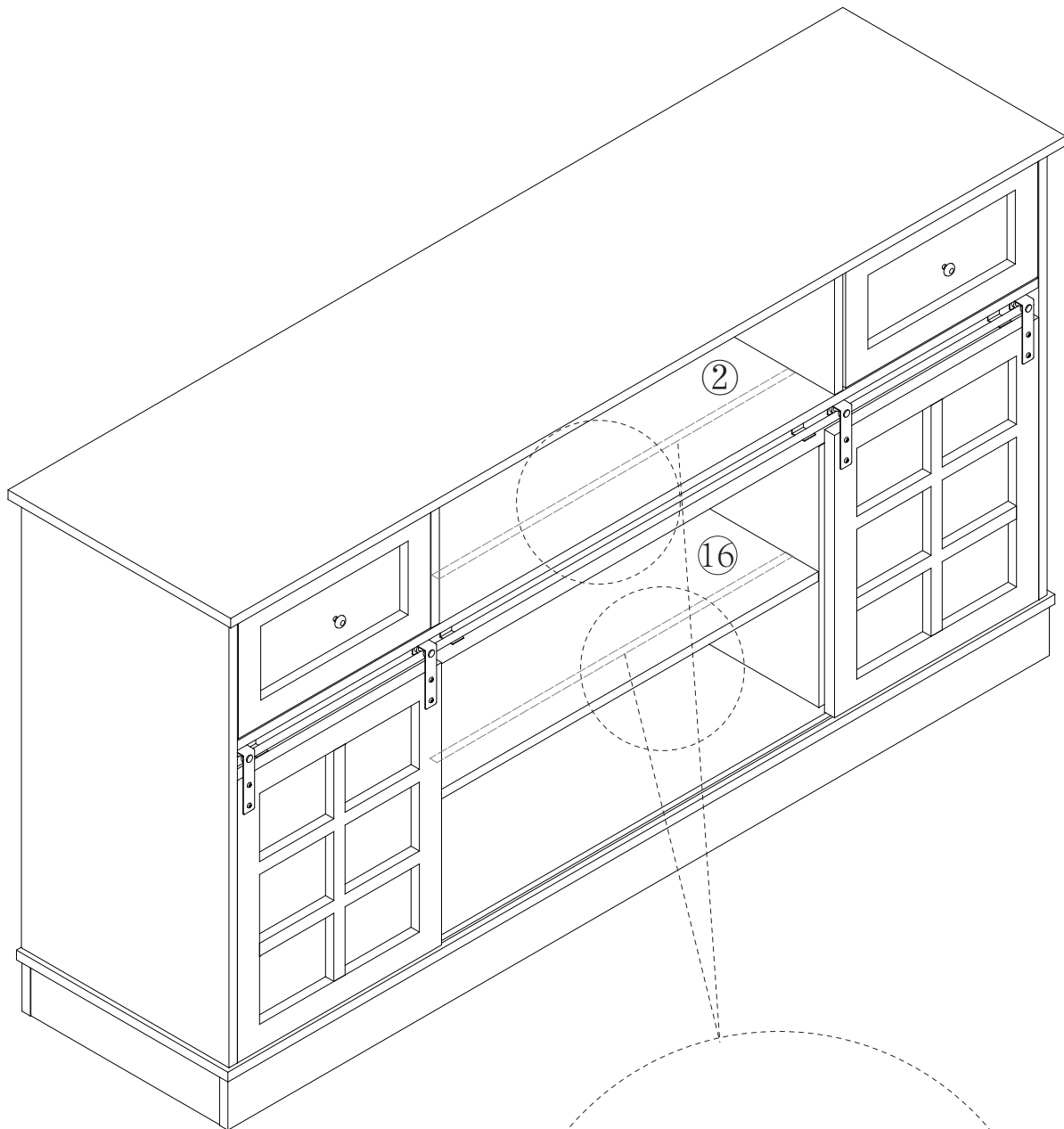

FINISH

