

# Installation Instruction

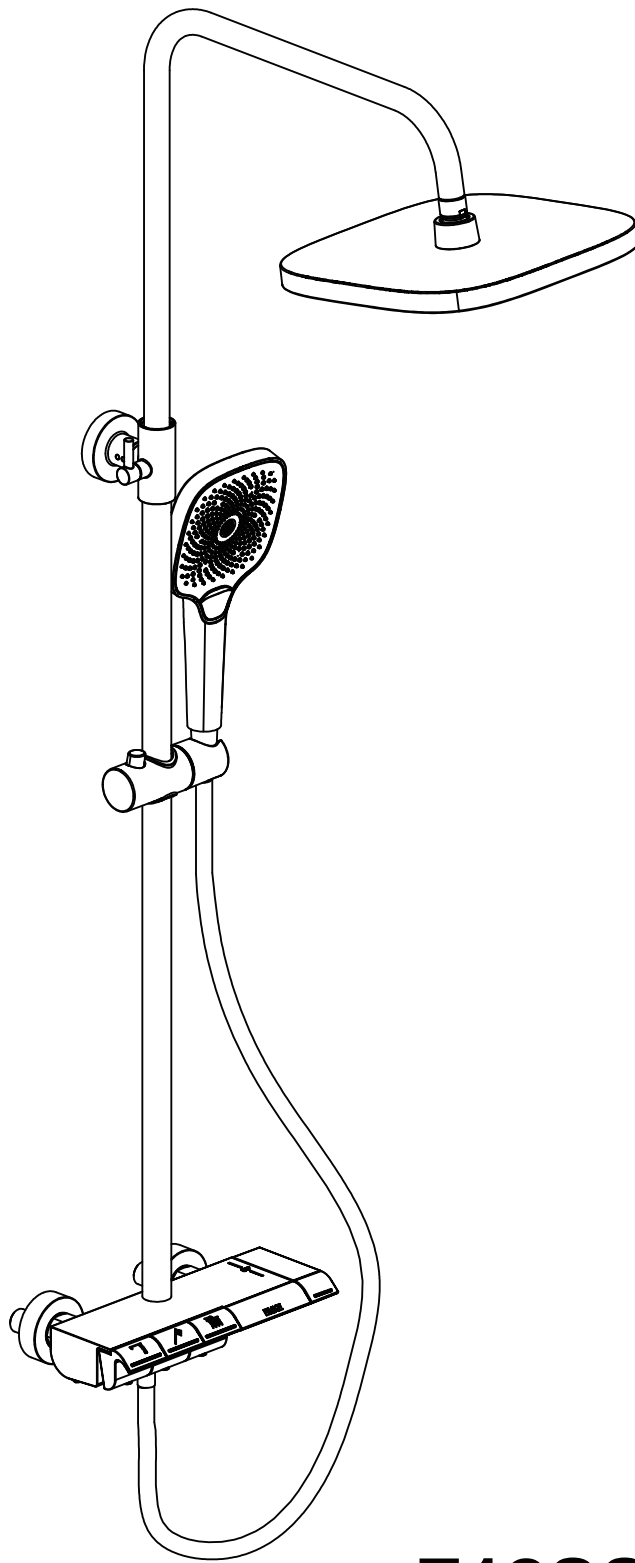

**F12SSC00CP**

---

English / Deutsche / Français / Español / Italiano

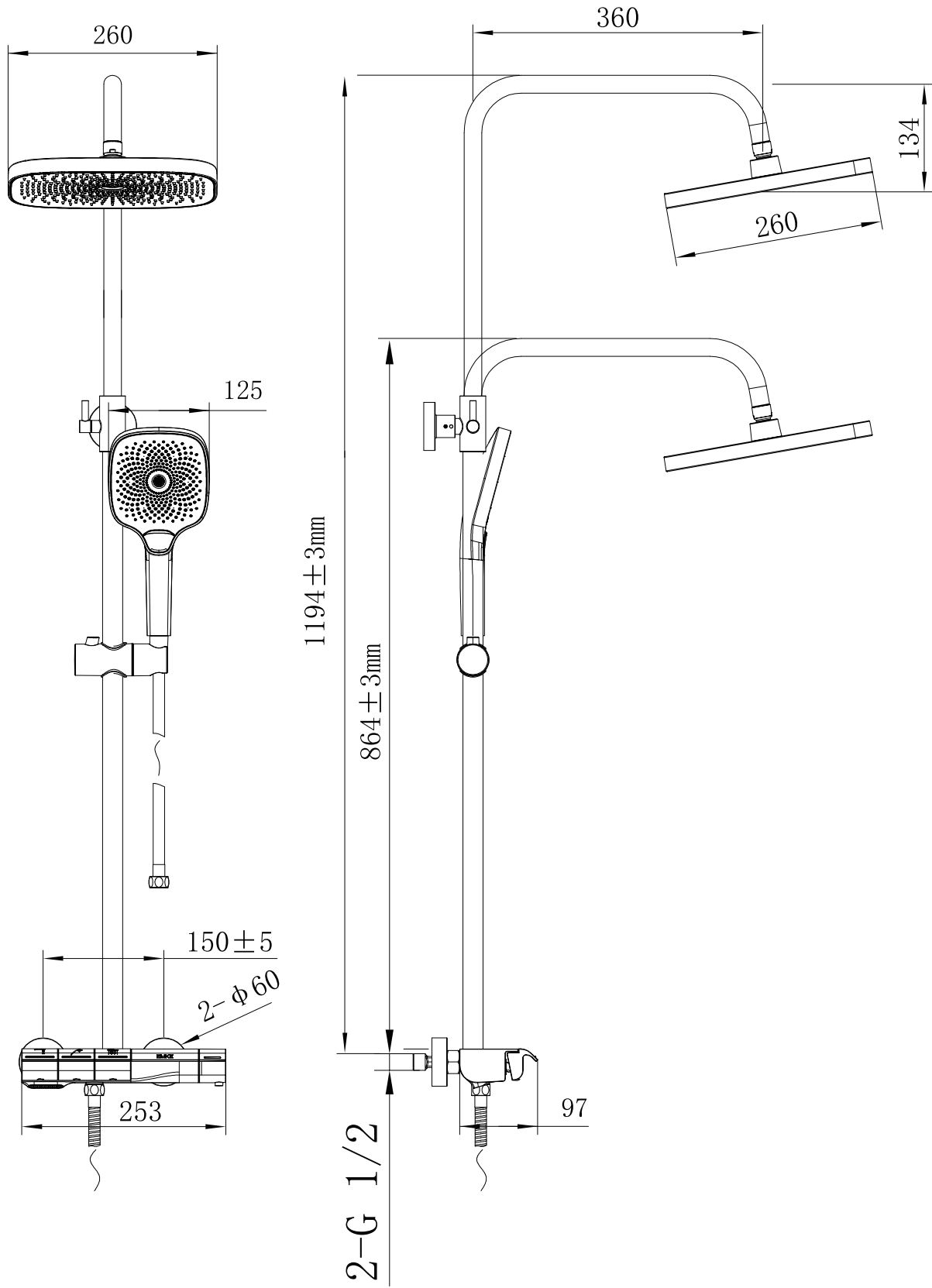

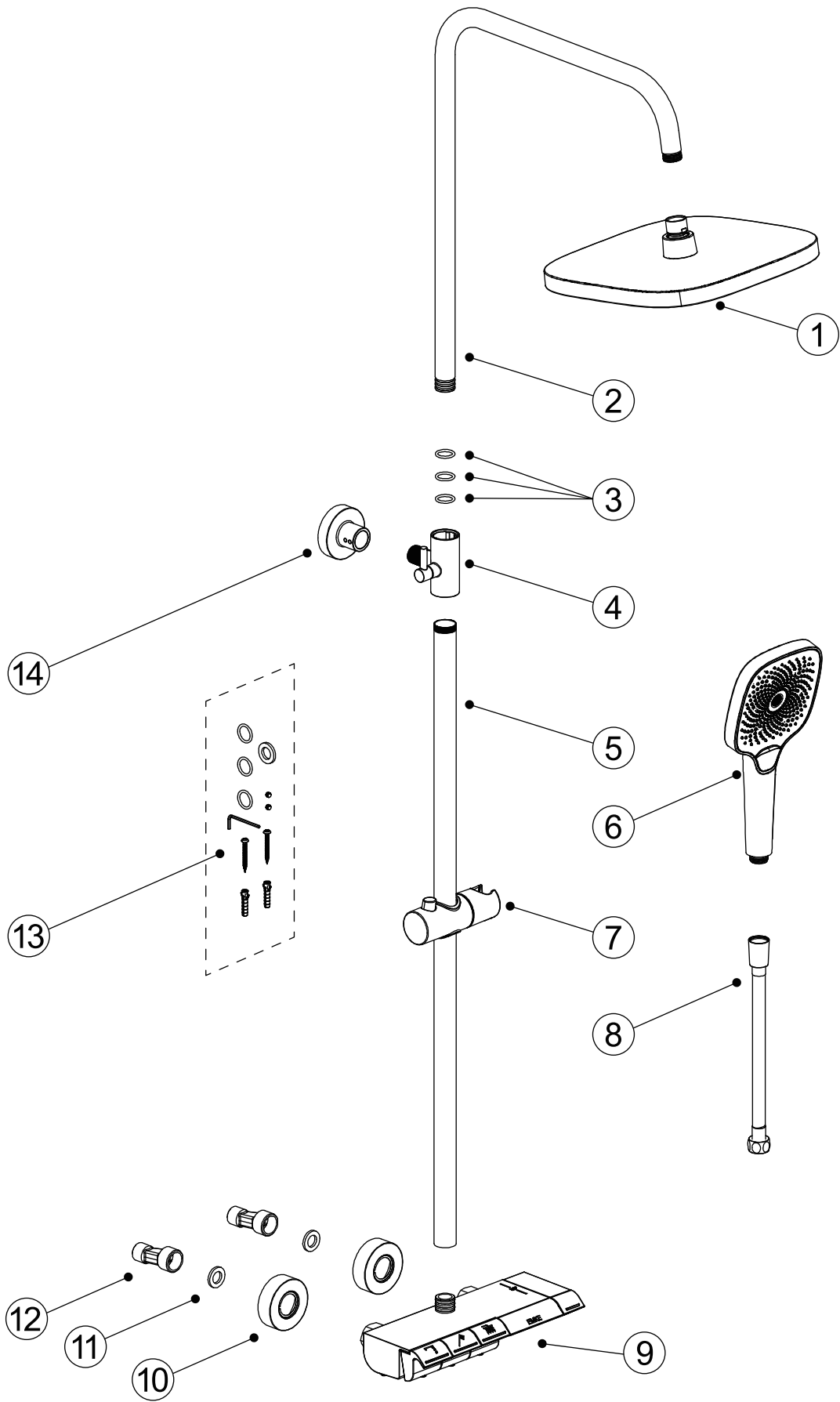

## Step 1: Clean the water pipe and install the curved connector

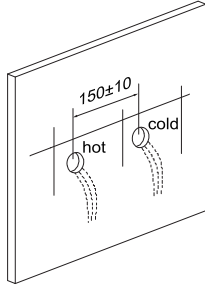

a) Run the water around 1-2 minutes to clean the water pipe

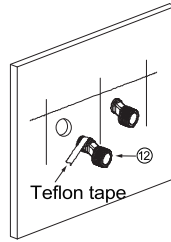

b) Wrap the teflon tape anticlockwise on the thread of the G1/2 end of the curved connector, connect them to the hot and cold water outlets by a wrench. Leave suitable depth out of the wall and adjust the distance between 2 connectors according to the width of the inlet on the thermostatic shower bar (Figure 2).

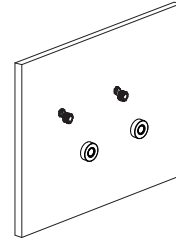

c) Make sure the 2 curved connectors are installed dead straight into the wall. The centre distance between 2 curved connectors is  $150\pm 10$ mm. Use the spirit level to make sure the centre line remains horizontal.

d) Screw the decorative covers on the wall (Figure 1).

e) Connect the thermostatic shower bar onto the curved connectors (Figure 2). Left side is hot water and right side is cold water.

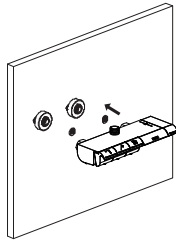

Figure 1

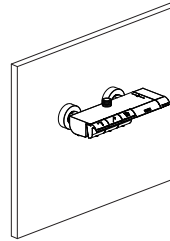

Figure 2

## Step 2: Assemble the pipe for the shower head

a) Insert the slider over the riser rail (Figure 3).

b) Connect the overhead arm pipe to the riser rail (Figure 4).

c) Connect the raiser rail to the thermostatic shower bar and mark the position of the pipe connector on the wall (Figure 5).

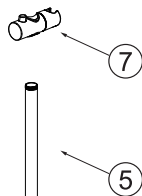

Figure 3

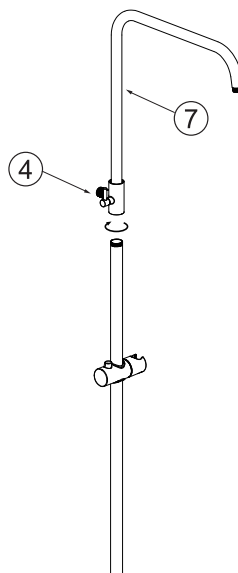

Figure 4

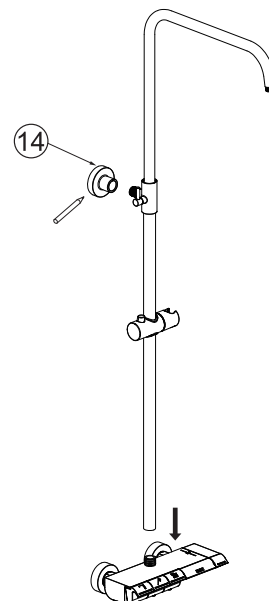

Figure 5

d) Install the wall holder on the marked position (Figure 6). Cover the thermostatic shower bar to prevent the dust. Connect the pipe connector to the wall holder and use the Allen key to secure (Figure 7).

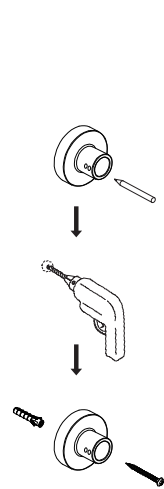

Figure 6

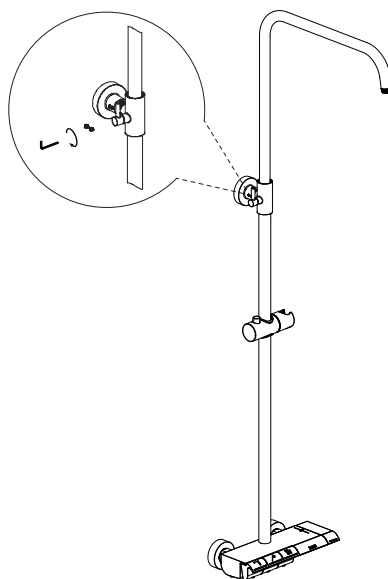
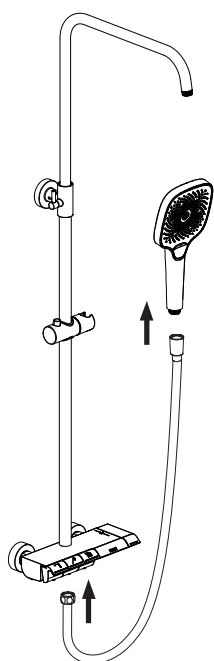
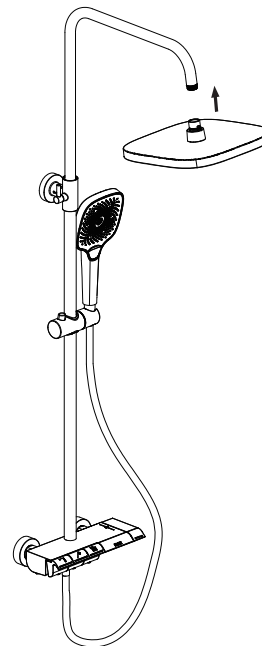

Figure 7

## Step 3: Assemble the shower head (Make sure there is a washer inside of the shower head)



a) Connect the hose to the thermostatic shower bar and connect the shower head on the other end.



b) Connect the overhead shower to the arm pipe.

## Function Guide :

### A. Adjust the water temperature:

Press the button and turn the temperature knob left and right to increase and decrease the temperature.

### B. Switch between the hand shower/overhead shower/bottom tap:

press the hand shower / overhead shower and bottom tap button.

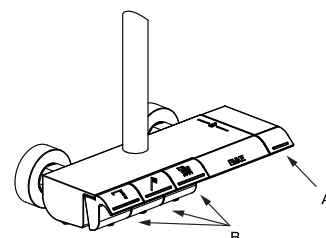

## Schritt 1: Reinigen Sie die Wasserleitung und installieren Sie den gebogenen Anschluss

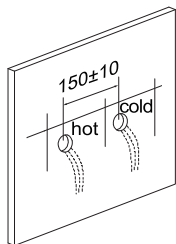

a) Lassen Sie das Wasser etwa 1-2 Minuten laufen, um die Wasserleitung zu reinigen

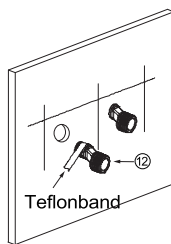

b) Wickeln Sie das Teflonband gegen den Uhrzeigersinn auf das Gewinde des G1/2-Endes des gebogenen Anschlusses und verbinden Sie es mit den Warm- und Kaltwasserauslässen mit einem Schraubenschlüssel. Lassen Sie eine angemessene Tiefe aus der Wand heraus und stellen Sie den Abstand zwischen den beiden Anschlüssen entsprechend der Breite des Einlasses an der Thermostat-Duschstange ein (Abbildung 2).

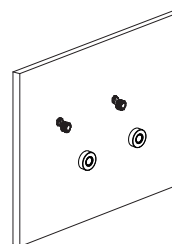

c) Vergewissern Sie sich, dass die 2 gebogenen Anschlüsse genau gerade in die Wand eingebaut sind. Der Achsabstand zwischen 2 gebogenen Anschlüssen beträgt  $150\pm 10$  mm. Verwenden Sie die Wasserwaage, um sicherzustellen, dass die Mittellinie horizontal bleibt.

d) Schrauben Sie die dekorativen Abdeckungen an die Wand (Abbildung 1).

e) Schließen Sie die Thermostat-Brausestange an die gebogenen Anschlüsse an (Abbildung 2). Die linke Seite ist für Warmwasser und die rechte Seite für Kaltwasser.



Abbildung 1



Abbildung 2

## Schritt 2: Montieren Sie das Rohr für den Duschkopf

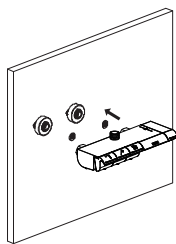
a) Schieben Sie den Schieber über die Steigschiene (Abbildung 3).

b) Verbinden Sie das Rohr des Überkopfarmes mit der Steigschiene (Abbildung 4).

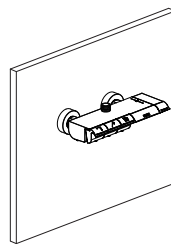
c) Verbinden Sie die Steigschiene mit der Thermostatbrausestange und markieren Sie die Position des Rohranschlusses an der Wand (Abbildung 5).



Abbildung 3



Abbildung 4

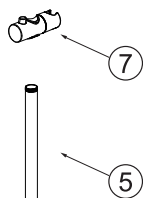

Abbildung 5

- d) Montieren Sie die Wandhalterung an der markierten Stelle (Abbildung 6). Decken Sie die Thermostat-Brausestange ab, um sie vor Staub zu schützen. Verbinden Sie das Rohrverbindungsstück mit der Wandhalterung und verwenden Sie den Inbusschlüssel zur Sicherung (Abbildung 7).

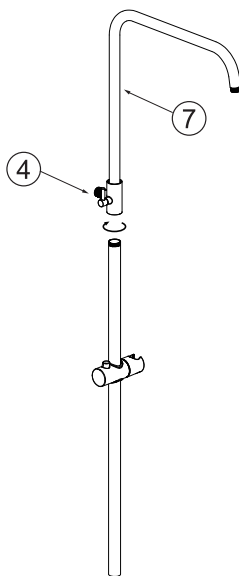

Abbildung 6

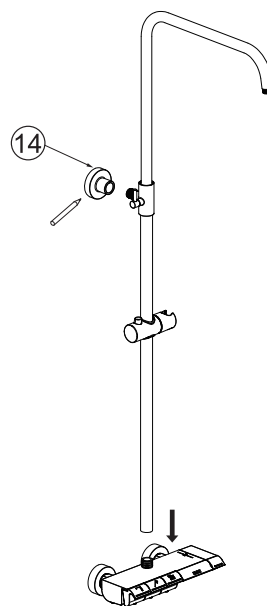

Abbildung 7

## Schritt 3: Montieren Sie den Duschkopf (Achten Sie darauf, dass sich im Inneren des Duschkopfes eine Unterlegscheibe befindet)

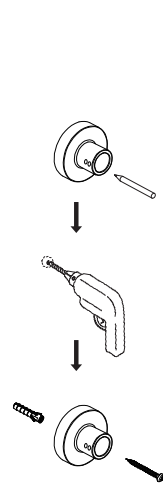

- a) Verbinden Sie den Schlauch mit der Thermostat-Brausestange und schließen Sie den Duschkopf am anderen Ende an

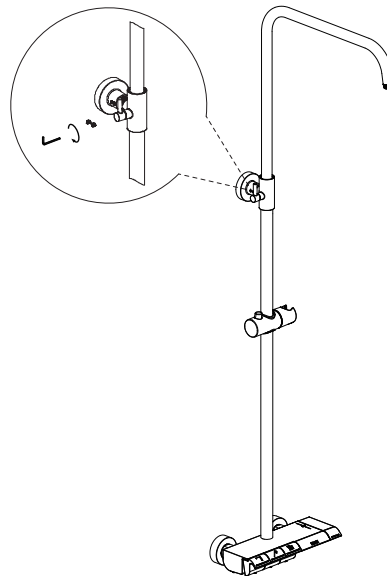
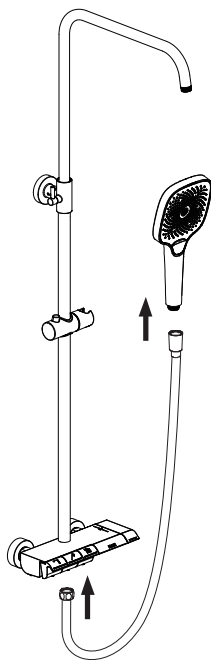
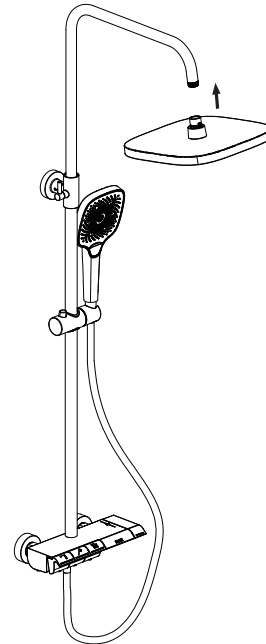

- b) Verbinden Sie die Kopfbrause mit dem Armrohr

## Funktionsübersicht :

### A. stellen Sie die Wassertemperatur ein:

Drücken Sie die Taste und drehen Sie den Temperaturregler nach links und rechts, um die Temperatur zu erhöhen oder zu verringern.

### B. zwischen Handbrause/Kopfbrause/Unterhahn umschalten:

Drücken Sie die Taste für Handbrause/Kopfbrause und Unterhahn.

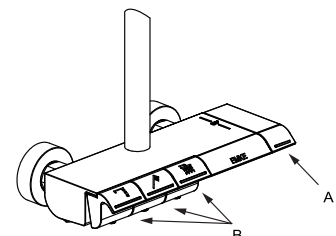

## Étape 1 : Nettoyer le tuyau d'eau et installer le connecteur courbe

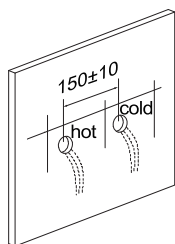

a) Faites couler l'eau pendant 1 à 2 minutes pour nettoyer le tuyau d'eau (Figure 1).

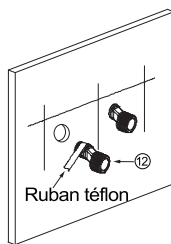

b) Enroulez le ruban téflon dans le sens inverse des aiguilles d'une montre sur le filetage de l'extrémité G1/2 du connecteur courbe, raccordez-les aux sorties d'eau chaude et froide à l'aide d'une clé. Laissez une profondeur suffisante dans le mur et réglez la distance entre les 2 raccords en fonction de la largeur de l'entrée de la barre de douche thermostatique.

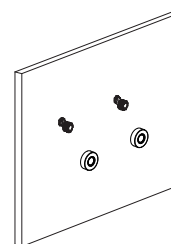

c) S'assurer que les 2 connecteurs courbes sont installés de manière parfaitement droite dans le mur. La distance centrale entre 2 connecteurs courbes est de  $150\pm 10$  mm. Utilisez le niveau à bulle pour vous assurer que la ligne centrale reste horizontale.

d) Vissez les couvercles décoratifs sur le mur (Figure 1).

e) Connectez la barre de douche thermostatique sur les connecteurs courbes (Figure 2).  
Le côté gauche est réservé à l'eau chaude et le côté droit à l'eau froide.

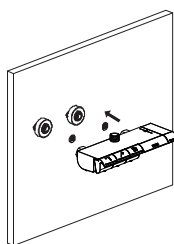

Figure 1

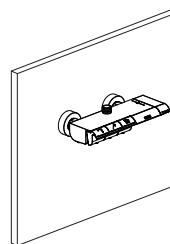

Figure 2

## Étape 2 : Assembler le tuyau pour la pomme de douche

a) Insérez le curseur sur le rail de la colonne montante (Figure 3).

b) Connectez le tuyau du bras supérieur au rail de la colonne montante (Figure 4).

c) Connectez le rail élévateur à la barre de douche thermostatique et marquez la position du connecteur de tuyau sur le mur (Figure 5).

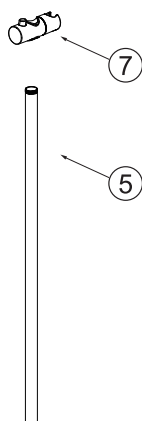

Figure 3

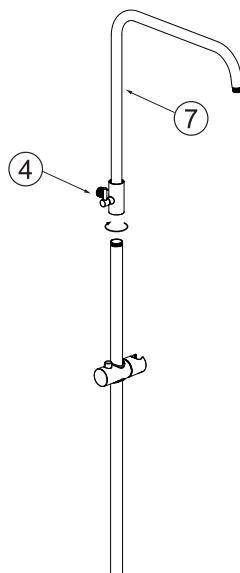

Figure 4

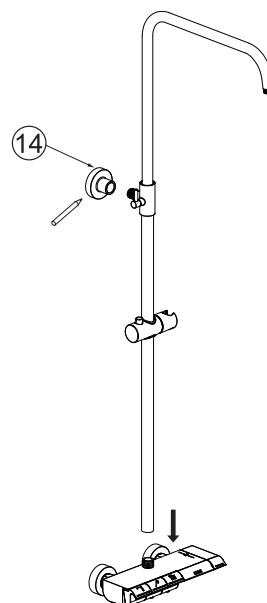

Figure 5



d) Installez le support mural sur la position marquée (Figure 6). Couvrez la barre de douche thermostatique pour éviter la poussière. Connectez le raccord de tuyau au support mural et utilisez la clé Allen pour le fixer (Figure 7).

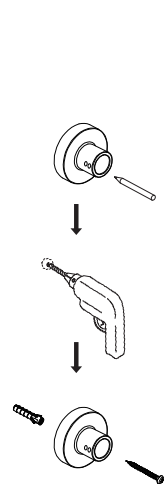

Figure 6

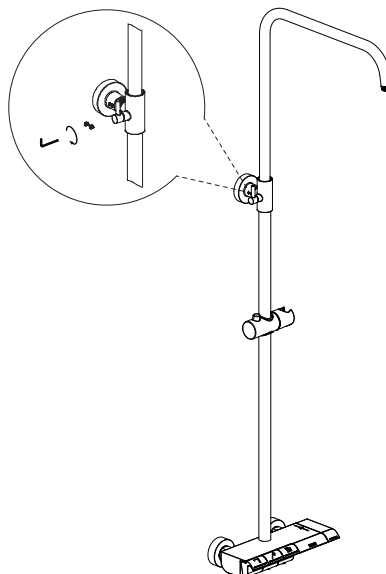
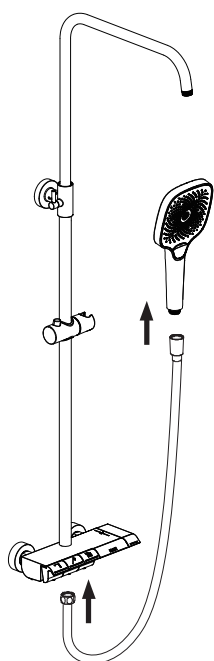
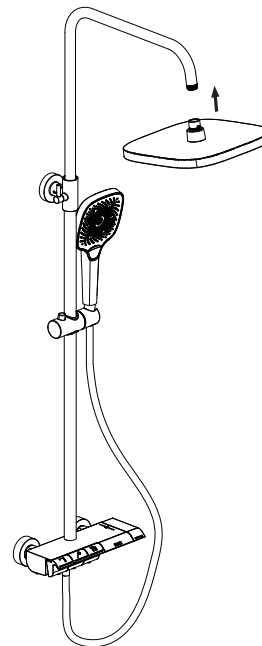

Figure 7

## Étape 3 : Assembler la pomme de douche (Assurez-vous qu'il y a une rondelle à l'intérieur de la pomme de douche)



a) Connectez le tuyau à la barre de douche thermostatique et connectez la pomme de douche à l'autre extrémité



b) Raccordez la douche de tête au tuyau du bras

## Guide des fonctions :

### A. Régler la température de l'eau:

Appuyez sur le bouton et tournez le bouton de température vers la gauche et la droite pour augmenter ou diminuer la température.

### B. Basculer entre la douche à main, la douche de tête et le robinet de fond:

Appuyez sur le bouton de la douche à main, de la douche de tête et du robinet de fond.

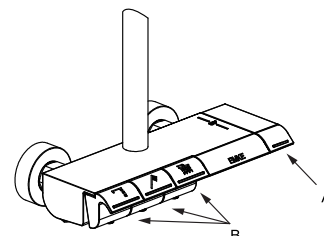

## Paso 1: Limpiar la tubería de agua e instalar el conector curvo

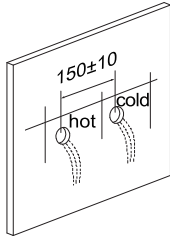

a) Deje correr el agua alrededor de 1-2 minutos para limpiar la tubería de agua.



b) Envuelva la cinta de teflón en sentido contrario a las agujas del reloj en la rosca del extremo G1/2 del conector curvo, conéctelos a las salidas de agua caliente y fría con una llave. Deje una profundidad adecuada fuera de la pared y ajuste la distancia entre los 2 conectores en función de la anchura de la entrada de la barra de ducha termostática.

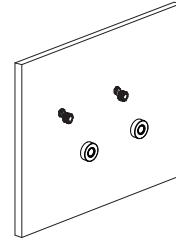

c) Asegúrese de que los 2 conectores curvos se instalan de forma totalmente recta en la pared. La distancia central entre los 2 conectores curvos es de  $150\pm 10$  mm. Utilice el nivel de burbuja para asegurarse de que la línea central permanece horizontal.

d) Atornille las tapas decorativas en la pared (Figura 1).

e) Conecte la barra de ducha termostática en los conectores curvos (Figura 2). El lado izquierdo es para el agua caliente y el derecho para el agua fría.



Figura 1



Figura 2

## Paso 2: Montar el tubo para la alcachofa de la ducha

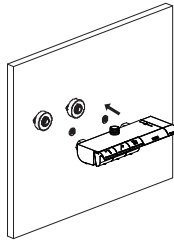
a) Inserte el deslizador sobre el riel ascendente (Figura 3).

b) Conecte el tubo del brazo superior al raíl elevador (Figura 4).

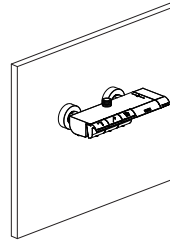
c) Conecte el raíl elevador a la barra de ducha termostática y marque la posición del conector de la tubería en la pared (figura 5).



Figura 3



Figura 4



Figura 5

d) Instale el soporte de pared en la posición marcada (Figura 6). Cubra la barra de ducha termostática para evitar el polvo. Conecte el conector de tuberías al soporte de pared y utilice la llave Allen para fijarlo (Figura 7).

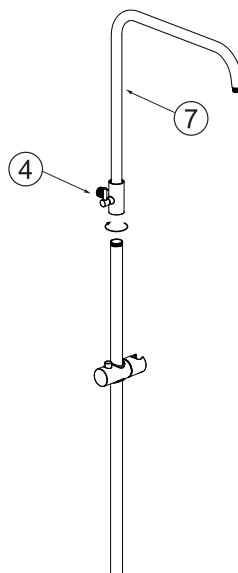

Figura 6

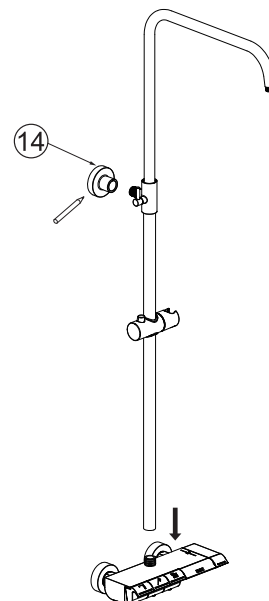

Figura 7

## Paso 3: Montar la alcachofa de la ducha (Asegúrese de que hay una arandela dentro de la alcachofa de la ducha)

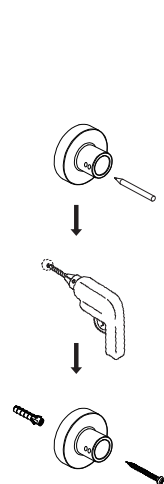

a) Conecte la manguera a la barra de ducha termostática y conecte la alcachofa de la ducha en el otro extremo.

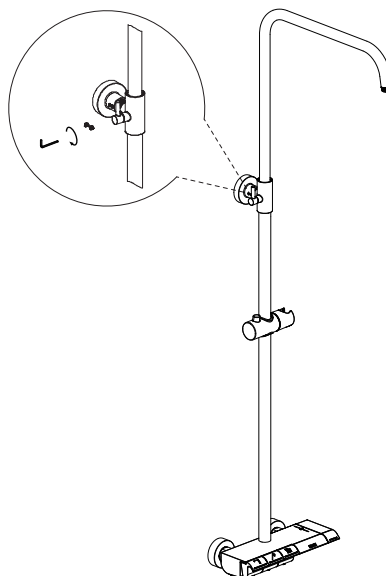
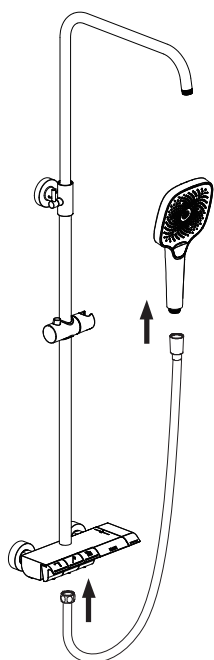
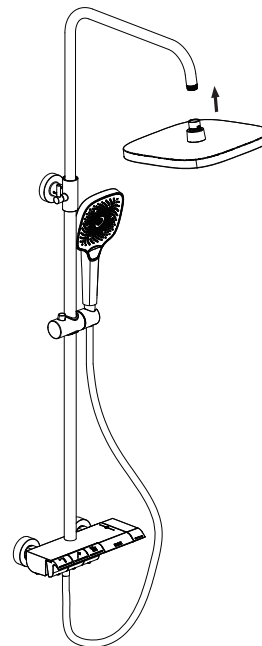

b) Conecte la ducha de techo al tubo del brazo

## Guía de funciones :

### A. Ajuste la temperatura del agua:

Pulse el botón y gire el mando de la temperatura a la izquierda y a la derecha para aumentar y disminuir la temperatura.

### B. Cambie entre la ducha de mano / ducha superior / grifo inferior:

pulse el botón de ducha de mano / ducha superior y grifo inferior.

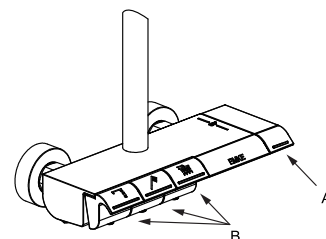

## Fase 1: pulire il tubo dell'acqua e installare il connettore curvo

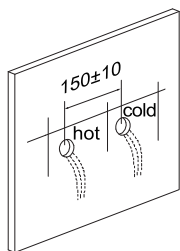

a) Far scorrere l'acqua per 1-2 minuti per pulire il tubo dell'acqua.



b) Avvolgere il nastro di teflon in senso antiorario sulla filettatura dell'estremità G1/2 del connettore curvo, collegarlo alle uscite dell'acqua calda e fredda con una chiave. Lasciare una profondità adeguata dalla parete e regolare la distanza tra i 2 connettori in base alla larghezza dell'ingresso della barra termostatica della doccia.

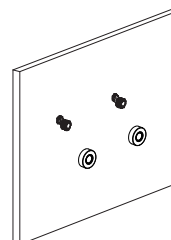

c) Assicurarsi che i 2 connettori curvi siano installati in modo mortalmente diritto nella parete. L'interasse tra i 2 connettori curvi è di  $150\pm 10$  mm. Utilizzare la livella a bolla d'aria per assicurarsi che la linea centrale rimanga orizzontale.

d) Avvitare le coperture decorative alla parete (Figura 1).

e) Collegare la barra termostatica della doccia ai connettori curvi (Figura 2). Il lato sinistro è quello dell'acqua calda e il lato destro quello dell'acqua fredda.



Figura 1



Figura 2

## Fase 2: montaggio del tubo per il soffione doccia

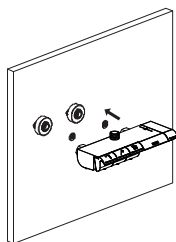
a) Inserire il cursore sulla barra montante (Figura 3).

b) Collegare il tubo del braccio superiore alla barra montante (Figura 4).

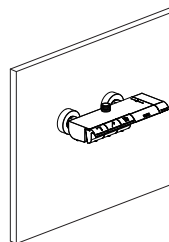
c) Collegare la barra montante alla barra termostatica della doccia e segnare la posizione del raccordo del tubo sulla parete (Figura 5).



Figura 3



Figura 4

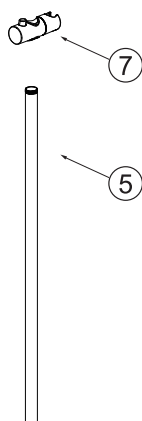

Figura 5

d) Installare il supporto a parete nella posizione contrassegnata (Figura 6). Coprire la barra termostatica della doccia per evitare la polvere.  
Collegare il connettore del tubo al supporto a parete e utilizzare la chiave a brugola per fissarlo (Figura 7).

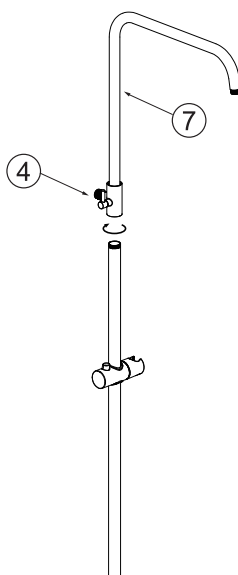

Figura 6

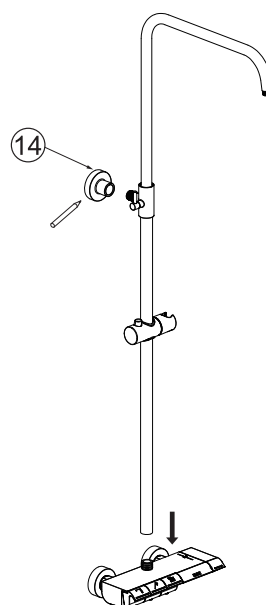

Figura 7

## Fase 3: montaggio del soffione (accertarsi che all'interno del soffione sia presente una rondella)

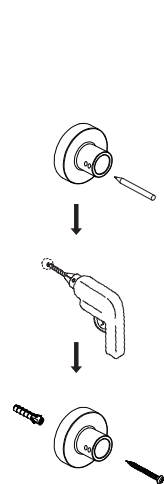

a) Collegare il tubo flessibile alla barra termostatica della doccia e collegare il soffione all'altra estremità.

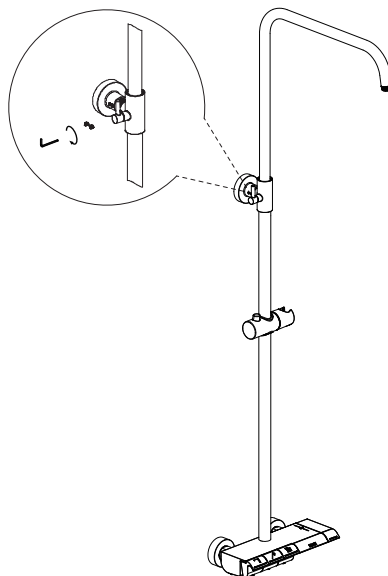
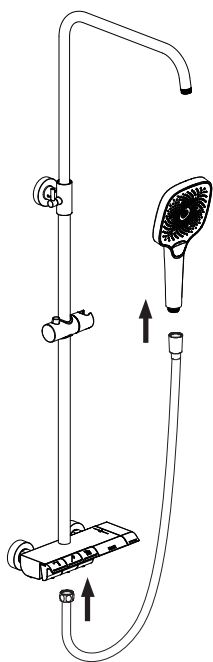
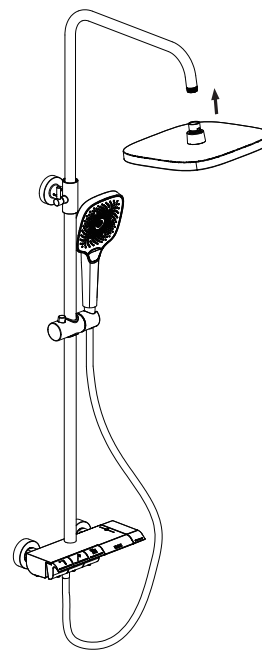

b) Collegare il soffione al tubo del braccio.

## Guida alle funzioni:

### A. Regolare la temperatura dell'acqua:

Premere il pulsante e ruotare la manopola della temperatura a destra e a sinistra per aumentare e diminuire la temperatura.

### B. Passare dalla doccetta al soffione al rubinetto di fondo:

Premere il pulsante della doccetta, del soffione e del rubinetto di fondo.

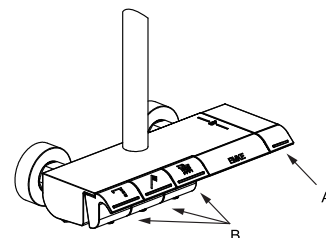



V02-03-2023