

Test Report

Report No.: CTT2206010086EN

Page 1 of 10

Applicant: SHENZHEN SHANGQIU TECHNOLOGY CO.,LTD

Address: 102#,BUILDING 9,XIN LIGAO INDUSTRIAL ZONE, NO 6, NEIHUAN ROAD, PINGHU,
LONGGANG AREA,SHENZHEN

Sample Received Date: Jun. 01, 2022

Completed Date: Jun. 08, 2022

Report Date: Jun. 08, 2022

The following merchandise was (were) submitted and identified on behalf of the applicant as:

Sample Name: Liquid Chalk Marker ;Chalk Marker

Model No.: FL-001;FM-460;FM-204;FM-150FM-201;FM-200;FM-408;FM-458

Test Age Group: 3+

Test Result(s): Please refer to next page(s).

Test Requested and Conclusion(s):

No.	Standard and Requirement	Conclusion(s)
1	Refer to EN 71-1:2014+A1:2018 Mechanical and physical properties (Excluding section 7.1)	PASS
2	Refer to EN 71-2:2020 Flammability	PASS
3	Refer to EN 71-3:2019+A1:2021 (Category II) - Soluble Heavy Metal	PASS
4	Refer to EN 71-3:2019+A1: 2021(Category III) - Soluble Heavy Metal	PASS

Signed for and on Behalf of CTT:



Hilary He/Carson Li
Technical Manager



Verification Report

This test report is issued by the company subject to its General Conditions of Services and accessible at <http://www.cttlab.com/order/202103190908290166.pdf>. The sample is provided by the applicant, our company is not responsible for the integrity, authenticity and identification information of the sample. Unless otherwise stated the results shown in this report only apply to the sample as received. Without prior written permission of the company, this test report cannot be reproduced, except in full. Any inquiry about this report, please raise from the date of receipt of the report within 30 days, overdue will not be accept. Items marked with "n" means they are not accredited by CNAS (if with CNAS logo), "s" means the item of subcontractor. All or part of items of this report are not in the accredited scope of CMA and cannot be as domestic social impartiality proof data.



Test Report

Report No.: CTT2206010086EN

Page 2 of 10

Test Result(s):

Mechanical and Physical Test - Refer to EN 71-1:2014+A1:2018

Section	Testing Items	Assessment
		6
4	General requirements	PASS
4.1	Material cleanliness	PASS
4.2	Assembly	NA
4.3	Flexible plastic sheeting	NA
4.4	Toy bags	NA
4.5	Glass	NA
4.6	Expanding materials	NA
4.7	Edges	PASS
4.8	Points and metallic wires	PASS
4.9	Protruding parts	NA
4.10	Parts moving against each other	NA
4.11	Mouth-actuated toys and other toys intended to be put in the mouth	NA
4.12	Balloons	NA
4.13	Cords of toy kites and other flying toys	NA
4.14	Enclosures	NA
4.14.1	Toys which a child can enter	NA
4.14.1 a) and b)	For toys having a door, lid or similar device	NA
4.14.1 c)	Toy chest	NA
4.14.2	Masks and helmets	NA
4.15	Toys intended to bear the mass of a child	NA
4.16	Heavy immobile toys	NA
4.17	Projectile toys	NA
4.18	Aquatic toys and inflatable toys	NA
4.19	Percussion caps specifically designed for use in toys and toys using percussion caps	NA
4.20	Acoustics	NA
4.21	Toys containing a non-electrical heat source	NA
4.22	Small balls	NA
4.23	Magnets	NA

This test report is issued by the company subject to its General Conditions of Services and accessible at <http://www.cttlab.com/order/202103190908290166.pdf>. The sample is provided by the applicant, our company is not responsible for the integrity, authenticity and identification information of the sample. Unless otherwise stated the results shown in this report only apply to the sample as received. Without prior written permission of the company, this test report cannot be reproduced, except in full. Any inquiry about this report, please raise from the date of receipt of the report within 30 days, overdue will not be accept. Items marked with "n" means they are not accredited by CNAS (if with CNAS logo), "s" means the item of subcontractor. All or part of items of this report are not in the accredited scope of CMA and cannot be as domestic social impartiality proof data.



Test Report

Report No.: CTT2206010086EN

Page 3 of 10

4.24	Yo-yo balls	NA
4.25	Toys attached to food	NA
4.26	Toy Disguise Costumes	NA
4.27	Flying toys	NA
5	Toys intended for children under 36 months	
5.1	General requirements:	NA
5.2	Soft-filled toys and soft-filled parts of a toy	NA
5.3	Plastic sheeting	NA
5.4	Cords, chains and electrical cables in toys	NA
5.5	Liquid-filled toys	NA
5.6	Speed limitation of electrically-driven ride-on toys	NA
5.7	Glass and porcelain	NA
5.8	Shape and size of certain toys	NA
5.9	Toys comprising monofilament fibers	NA
5.10	Small balls	NA
5.11	Play figures	NA
5.12	Hemispheric-shaped toys	NA
5.13	Suction cups	NA
5.14	Straps intended to be worn fully or partially around the neck	NA
5.15	Sledges with cords for pulling	NA
6	Packaging	
7	Warnings, markings and instructions for use	
7.1	General	NR*
7.2	Toys not intended for children under 36 months	NA
7.3	Latex balloons	NA
7.4	Aquatic toys	NA
7.5	Functional toys	NA
7.6	Hazardous sharp functional edges and points	NA
7.7	Projectile toys	NA
7.8	Imitation protective masks and helmets	NA
7.9	Toy kites	NA
7.10	Roller skates, inline skates, skateboards and certain other ride-on toys	NA

This test report is issued by the company subject to its General Conditions of Services and accessible at <http://www.cttlab.com/order/202103190908290166.pdf>. The sample is provided by the applicant, our company is not responsible for the integrity, authenticity and identification information of the sample. Unless otherwise stated the results shown in this report only apply to the sample as received. Without prior written permission of the company, this test report cannot be reproduced, except in full. Any inquiry about this report, please raise from the date of receipt of the report within 30 days, overdue will not be accept. Items marked with "n" means they are not accredited by CNAS (if with CNAS logo), "s" means the item of subcontractor. All or part of items of this report are not in the accredited scope of CMA and cannot be as domestic social impartiality proof data.



Test Report

Report No.: CTT2206010086EN

Page 4 of 10

7.11	Toys otherwise intended to be strung across a cradle, cot, or perambulator	NA
7.12	Liquid-filled teethingers	NA
7.13	Percussion caps specifically designed for use in toys	NA
7.14	Acoustics	NA
7.15	Toy bicycles	NA
7.16	Toys intended to bear the mass of a child	NA
7.17	Toys comprising monofilament fibres	NA
7.18	Toy scooters	NA
7.19	Rocking horses and similar toys	NA
7.20	Magnetic/electrical experimental sets	NA
7.21	Toys with electrical cables exceeding 300mm in length	NA
7.22	Toys with cords or chains intended for children of 18 months and over but under 36 months	NA
7.23	Toys intended to be attached to a cradle, cot or perambulator	NA
7.24	Sledges with cords for pulling	NA
7.25	Flying toys	NA
7.26	Improvised projectiles	NA

- Note:**
1. NA = Not Applicable
 2. NR = Not Requested
 3. "*" = Per client's requirement, the packaging was not evaluated.

Remark: Additional information according to the Toy Safety Directives 2009/48/EC requirement. These information also appears as a note within the EN71 but are not standard requirements:

1. Marking

The manufacturer's and importer's name, registered trade name or registered trade mark, the address and the CE-marking shall be indicated on the toy or, where that is not possible, on its packaging or in a document accompany the toy. In addition, manufacturers shall ensure that their

toys bear a type, batch, serial or model number or other element allowing their identification, or where the size or nature of the toy does not allow it, that the required information is provided on the packaging or in a document accompanying the toy.

- Manufacturer's name was not present and Manufacturer's address was not present.
- Importer's name was not present and Importer's address was not present.
- CE-Marking was present.

This test report is issued by the company subject to its General Conditions of Services and accessible at <http://www.cttlab.com/order/202103190908290166.pdf>. The sample is provided by the applicant, our company is not responsible for the integrity, authenticity and identification information of the sample. Unless otherwise stated the results shown in this report only apply to the sample as received. Without prior written permission of the company, this test report cannot be reproduced, except in full. Any inquiry about this report, please raise from the date of receipt of the report within 30 days, overdue will not be accept. Items marked with "n" means they are not accredited by CNAS (if with CNAS logo), "s" means the item of subcontractor. All or part of items of this report are not in the accredited scope of CMA and cannot be as domestic social impartiality proof data.



Test Report

Report No.: CTT2206010086EN

Page 5 of 10

- Product ID was present.

The submitted samples were undergone the use and abuse tests in accordance with the EN 71-1:2014+A1:2018

Testing Items	Parameter
	6
Torque test	0.34Nm
Tension test	90N
Drop test	5×850mm
Impact test	1×1Kg×100mm

Test Result(s):

Flammability - Refer to EN 71-2:2020

Section	Testing Items	Assessment
		6
4.1	General requirements	PASS
4.2	Toys to be worn on the head	NA
4.3	Toy disguise costumes and toys intended to be worn by a child in play	NA
4.4	Toys intended to be entered by a child	NA
4.5	Soft-filled toys	NA

Note: 1. NA = Not Applicable.

This test report is issued by the company subject to its General Conditions of Services and accessible at <http://www.cttlab.com/order/202103190908290166.pdf>. The sample is provided by the applicant, our company is not responsible for the integrity, authenticity and identification information of the sample. Unless otherwise stated the results shown in this report only apply to the sample as received. Without prior written permission of the company, this test report cannot be reproduced, except in full. Any inquiry about this report, please raise from the date of receipt of the report within 30 days, overdue will not be accept. Items marked with "n" means they are not accredited by CNAS (if with CNAS logo), "s" means the item of subcontractor. All or part of items of this report are not in the accredited scope of CMA and cannot be as domestic social impartiality proof data.



Test Report

Report No.: CTT2206010086EN

Page 6 of 10

Test Result(s):

Soluble Heavy Metal - Refer to EN 71-3:2019+A1:2021 (Category II)

Method: EN 71-3:2019+A1:2021, analyzed by Inductively coupled plasma mass spectrometry (ICP-MS) or Inductively Coupled Plasma Optical Emission Spectrometer (ICP-OES).

No.	Substances Name	CAS No.	Limit (mg/kg)	Reporting Limit (mg/kg)	Result (mg/kg)
					1
1	Soluble Aluminum (Al)	7429-90-5	560	5	273
2	Soluble Antimony (Sb)	7440-36-0	11.3	5.0	N.D.
3	Soluble Arsenic (As)	7440-38-2	0.9	0.5	N.D.
4	Soluble Barium (Ba)	7440-39-3	375	5	N.D.
5	Soluble Boron (B)	7440-42-8	300	5	N.D.
6	Soluble Cadmium (Cd)	7440-43-9	0.3	0.1	N.D.
7	Soluble CrIII	--	9.4	2.0	2.3
8	Soluble CrVI	18540-29-9	0.005	0.005	N.D.
9	Soluble Cobalt (Co)	7440-48-4	2.6	1.0	N.D.
10	Soluble Copper (Cu)	7440-50-8	156	5	N.D.
11	Soluble Lead (Pb)	7439-92-1	0.5	0.2	N.D.
12	Soluble Manganese (Mn)	7439-96-5	300	5	N.D.
13	Soluble Mercury (Hg)	7439-97-6	1.9	1.0	N.D.
14	Soluble Nickel (Ni)	7440-02-0	18.8	5.0	N.D.
15	Soluble Selenium (Se)	7782-49-2	9.4	5.0	N.D.
16	Soluble Strontium (Sr)	7440-24-6	1125	5	N.D.
17	Soluble Tin (Sn)	7440-31-5	3750	2.5	N.D.
18	Soluble Organic tin	--	0.2	0.1	N.D.
19	Soluble Zinc (Zn)	7440-66-6	938	5	9
Conclusion					PASS

- NOTE:**
1. mg/kg = milligram per kilogram (ppm).
 2. N.D. = Not Detected (Less than Reporting Limit).
 3. Migration of organic tin was calculated by summat ion of the migration values of Methyl tin, Dimethyl tin, Di-n-propyl tin, Butyl tin, Dibutyl tin, Tributyl tin, Tetrabutyl tin, n-Octyl tin, Di-n-octyl tin, Diphenyl tin, Triphenyl tin and was expressed as tributyltin cation content. however other organic tin compounds may also be present in the sample, The Toy Safety Directive (2009/48/EC) requirement covers total migratable organic tin.
 4. Soluble chromium (VI) test method: EN 71-3:2019+A1:2021 Annex F, analyzed by Ion Chromatograph Ultraviolet spectroscopy (IC-UV).

This test report is issued by the company subject to its General Conditions of Services and accessible at <http://www.cttlab.com/order/202103190908290166.pdf>. The sample is provided by the applicant, our company is not responsible for the integrity, authenticity and identification information of the sample. Unless otherwise stated the results shown in this report only apply to the sample as received. Without prior written permission of the company, this test report cannot be reproduced, except in full. Any inquiry about this report, please raise from the date of receipt of the report within 30 days, overdue will not be accept. Items marked with "n" means they are not accredited by CNAS (if with CNAS logo), "s" means the item of subcontractor. All or part of items of this report are not in the accredited scope of CMA and cannot be as domestic social impartiality proof data.



Test Report

Report No.: CTT2206010086EN

Page 7 of 10

5. Soluble organic tin test method: EN 71-3:2019+A1:2021 Annex G, analyzed by Gas Chromatography - Mass Spectroscopy (GC-MS).

Test Result(s):

Soluble Heavy Metal - Refer to EN 71-3:2019+A1: 2021(Category III)

Method: EN 71-3:2019+A1:2021, analyzed by Inductively coupled plasma mass spectrometry (ICP-MS) or Inductively Coupled Plasma Optical Emission Spectrometer (ICP-OES) .

No.	Substances Name	CAS No.	Limit (mg/kg)	Reporting Limit (mg/kg)	Result (mg/kg)	
					2	3
1	Soluble Aluminum (Al)	7429-90-5	28130	5	25	N.D.
2	Soluble Antimony (Sb)	7440-36-0	560	5	N.D.	N.D.
3	Soluble Arsenic (As)	7440-38-2	47	2.5	N.D.	N.D.
4	Soluble Barium (Ba)	7440-39-3	18750	5	N.D.	N.D.
5	Soluble Boron (B)	7440-42-8	15000	5	N.D.	N.D.
6	Soluble Cadmium (Cd)	7440-43-9	17	5	N.D.	N.D.
7	Soluble CrIII	--	460	2.0	N.D.	N.D.
8	Soluble CrVI	18540-29-9	0.053	0.025	N.D.	N.D.
9	Soluble Cobalt (Co)	7440-48-4	130	5	N.D.	N.D.
10	Soluble Copper (Cu)	7440-50-8	7700	5	N.D.	N.D.
11	Soluble Lead (Pb)	7439-92-1	23	5	N.D.	N.D.
12	Soluble Manganese (Mn)	7439-96-5	15000	5	N.D.	N.D.
13	Soluble Mercury (Hg)	7439-97-6	94	5	N.D.	N.D.
14	Soluble Nickel (Ni)	7440-02-0	930	5	N.D.	N.D.
15	Soluble Selenium (Se)	7782-49-2	460	5	N.D.	N.D.
16	Soluble Strontium (Sr)	7440-24-6	56000	5	N.D.	N.D.
17	Soluble Tin (Sn)	7440-31-5	180000	2.5	N.D.	N.D.
18	Soluble Organic tin	--	12	2.5	N.D.	N.D.
19	Soluble Zinc (Zn)	7440-66-6	46000	5	N.D.	N.D.
Conclusion					PASS	PASS

This test report is issued by the company subject to its General Conditions of Services and accessible at <http://www.cttlab.com/order/202103190908290166.pdf>. The sample is provided by the applicant, our company is not responsible for the integrity, authenticity and identification information of the sample. Unless otherwise stated the results shown in this report only apply to the sample as received. Without prior written permission of the company, this test report cannot be reproduced, except in full. Any inquiry about this report, please raise from the date of receipt of the report within 30 days, overdue will not be accept. Items marked with "n" means they are not accredited by CNAS (if with CNAS logo), "s" means the item of subcontractor. All or part of items of this report are not in the accredited scope of CMA and cannot be as domestic social impartiality proof data.



Test Report

Report No.: CTT2206010086EN

Page 8 of 10

No.	Substances Name	CAS No.	Limit (mg/kg)	Reporting Limit (mg/kg)	Result (mg/kg)	
					4	5
1	Soluble Aluminum (Al)	7429-90-5	28130	5	51	N.D.
2	Soluble Antimony (Sb)	7440-36-0	560	5	N.D.	N.D.
3	Soluble Arsenic (As)	7440-38-2	47	2.5	N.D.	N.D.
4	Soluble Barium (Ba)	7440-39-3	18750	5	16	N.D.
5	Soluble Boron (B)	7440-42-8	15000	5	N.D.	N.D.
6	Soluble Cadmium (Cd)	7440-43-9	17	5	N.D.	N.D.
7	Soluble CrIII	--	460	2.0	N.D.	N.D.
8	Soluble CrVI	18540-29-9	0.053	0.025	N.D.	N.D.
9	Soluble Cobalt (Co)	7440-48-4	130	5	N.D.	N.D.
10	Soluble Copper (Cu)	7440-50-8	7700	5	N.D.	N.D.
11	Soluble Lead (Pb)	7439-92-1	23	5	N.D.	N.D.
12	Soluble Manganese (Mn)	7439-96-5	15000	5	N.D.	N.D.
13	Soluble Mercury (Hg)	7439-97-6	94	5	N.D.	N.D.
14	Soluble Nickel (Ni)	7440-02-0	930	5	N.D.	N.D.
15	Soluble Selenium (Se)	7782-49-2	460	5	N.D.	N.D.
16	Soluble Strontium (Sr)	7440-24-6	56000	5	10	N.D.
17	Soluble Tin (Sn)	7440-31-5	180000	2.5	N.D.	N.D.
18	Soluble Organic tin	--	12	2.5	N.D.	N.D.
19	Soluble Zinc (Zn)	7440-66-6	46000	5	N.D.	N.D.
Conclusion					PASS	PASS

- NOTE:**
1. mg/kg = milligram per kilogram (ppm).
 2. N.D. = Not Detected (Less than Reporting Limit).
 3. Migration of organic tin was calculated by summation of the migration values of Methyl tin, Dimethyl tin, Di-n-propyl tin, Butyl tin, Dibutyl tin, Tributyl tin, Tetrabutyl tin, n-Octyl tin, Di-n-octyl tin, Diphenyl tin, Triphenyl tin and was expressed as tributyltin cation content. However other organic tin compounds may also be present in the sample, The Toy Safety Directive (2009/48/EC) requirement covers total migratable organic tin.
 4. The soluble organic tin was not conducted due to the soluble tin is not detected.
 5. Soluble chromium (VI) test method: EN 71-3:2019+A1:2021 Annex F, analyzed by Ion Chromatograph Ultraviolet spectroscopy (IC-UV).
 6. Soluble organic tin test method: EN 71-3:2019+A1:2021 Annex G, analyzed by Gas Chromatography - Mass Spectroscopy (GC-MS).

This test report is issued by the company subject to its General Conditions of Services and accessible at <http://www.cttlab.com/order/202103190908290166.pdf>. The sample is provided by the applicant, our company is not responsible for the integrity, authenticity and identification information of the sample. Unless otherwise stated the results shown in this report only apply to the sample as received. Without prior written permission of the company, this test report cannot be reproduced, except in full. Any inquiry about this report, please raise from the date of receipt of the report within 30 days, overdue will not be accept. Items marked with "n" means they are not accredited by CNAS (if with CNAS logo), "s" means the item of subcontractor. All or part of items of this report are not in the accredited scope of CMA and cannot be as domestic social impartiality proof data.



Test Report

Report No.: CTT2206010086EN

Page 9 of 10

Test Material List

Material No.	Sample Description	Location
1	Bright orange ink	Bright orange cartridge ink
2	White fibre	Pen point
3	White plastic	Penholder
4	White paper with multicolor printing with glue	Penholder sticker
5	Bright orange plastic	Bright orange cap
6	Mark pen	Individual

Photo of Sample:



This test report is issued by the company subject to its General Conditions of Services and accessible at <http://www.cttlab.com/order/202103190908290166.pdf>. The sample is provided by the applicant, our company is not responsible for the integrity, authenticity and identification information of the sample. Unless otherwise stated the results shown in this report only apply to the sample as received. Without prior written permission of the company, this test report cannot be reproduced, except in full. Any inquiry about this report, please raise from the date of receipt of the report within 30 days, overdue will not be accept. Items marked with "n" means they are not accredited by CNAS (if with CNAS logo), "s" means the item of subcontractor. All or part of items of this report are not in the accredited scope of CMA and cannot be as domestic social impartiality proof data.



Test Report

Report No.: CTT2206010086EN

Page 10 of 10

Location indication:

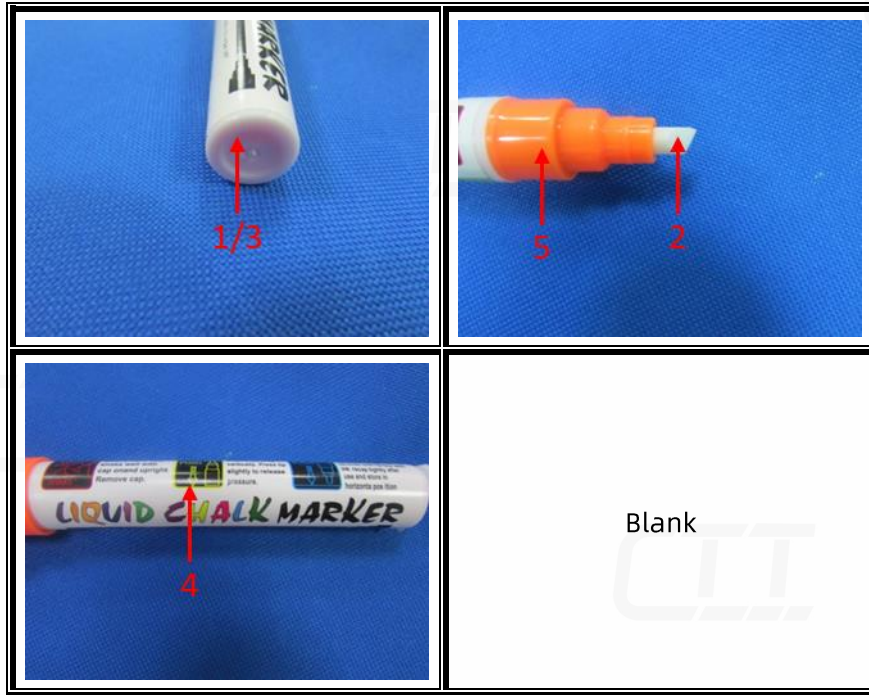

End of Report

This test report is issued by the company subject to its General Conditions of Services and accessible at <http://www.cttlab.com/order/202103190908290166.pdf>. The sample is provided by the applicant, our company is not responsible for the integrity, authenticity and identification information of the sample. Unless otherwise stated the results shown in this report only apply to the sample as received. Without prior written permission of the company, this test report cannot be reproduced, except in full. Any inquiry about this report, please raise from the date of receipt of the report within 30 days, overdue will not be accept. Items marked with "n" means they are not accredited by CNAS (if with CNAS logo), "s" means the item of subcontractor. All or part of items of this report are not in the accredited scope of CMA and cannot be as domestic social impartiality proof data.

