

Wilhelm Hoffmeister GmbH + Co KG, Hueckerstr. 19, 32272 Bünde

Külschrankumbau 165cm

Nr. 301 Rev.00

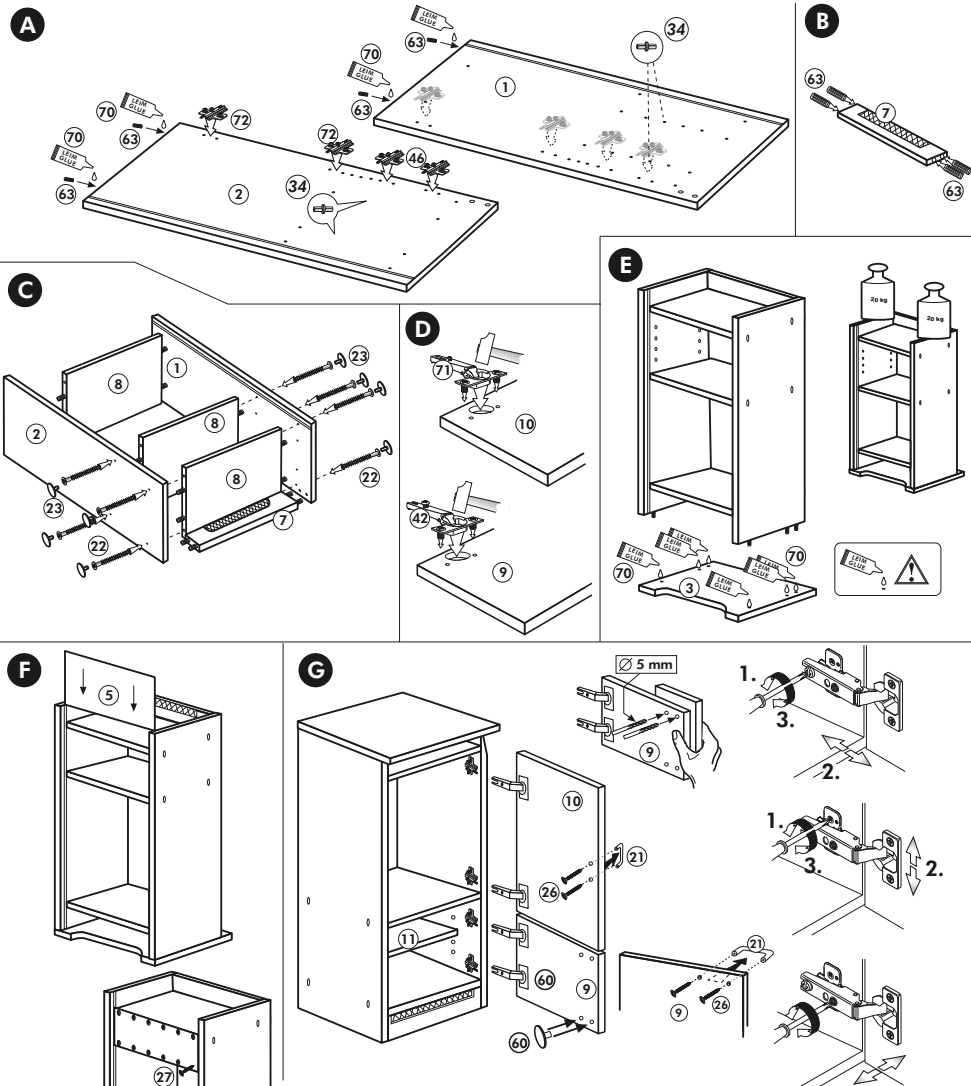
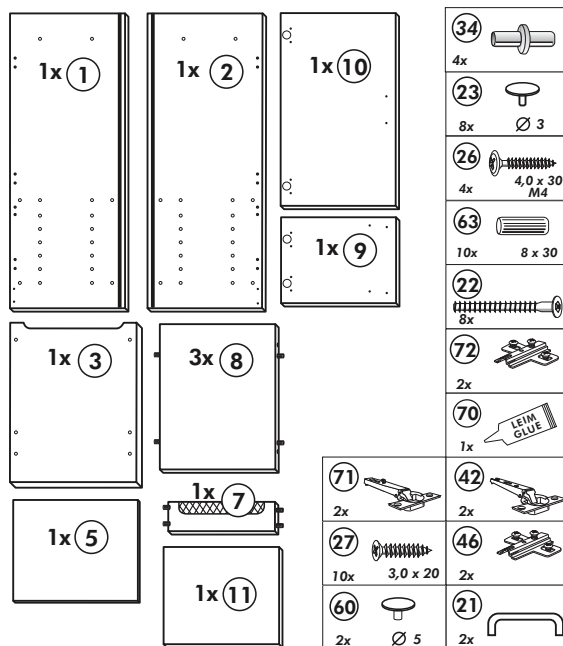
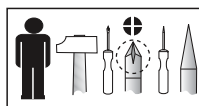

Apothekerschrank 165 cm

Nr. 306 Rev.01

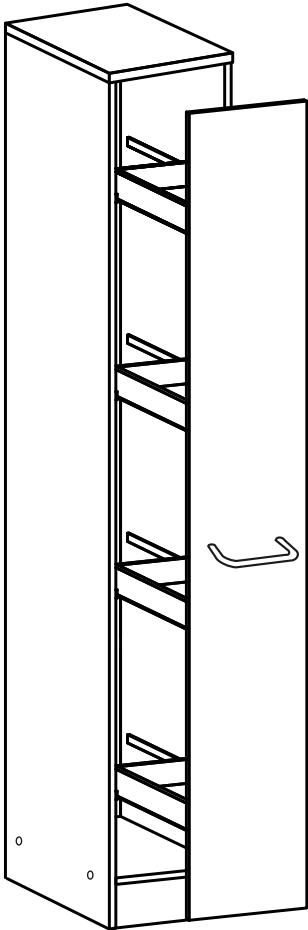
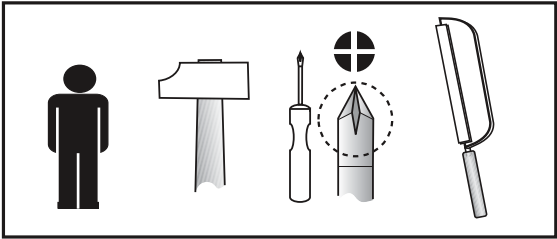

1.

70 1x LEIM GLUE	26 2x 4,0 x 30 M4	78 4x links 	79 4x rechts 	22 4x 	36 64x 3,5 x 16
23 4x 	21 1x 	27 3x 3,0 x 20 	119 1x 	63 10x 8 x 30 	66 4x

Holzteile:

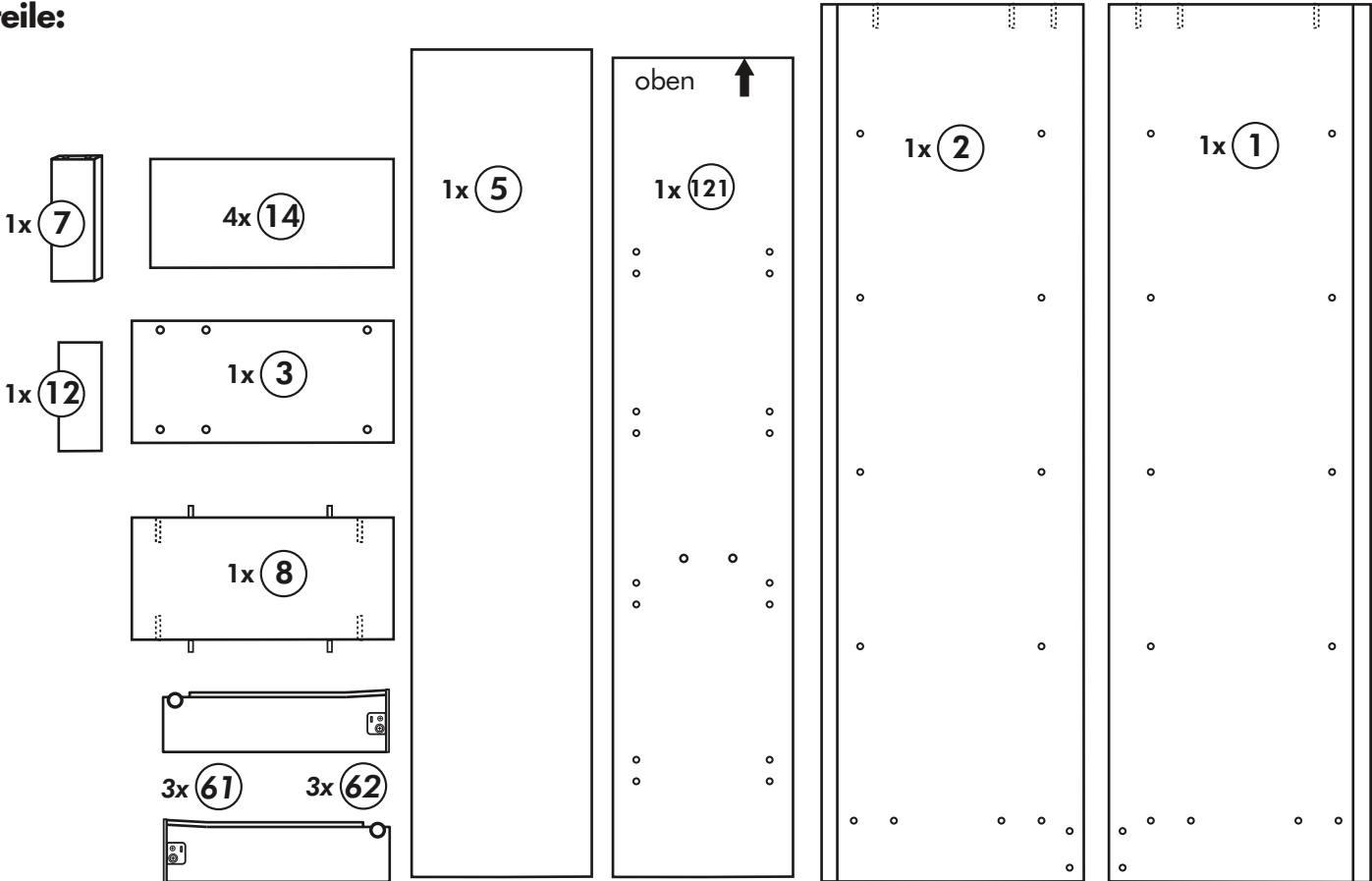

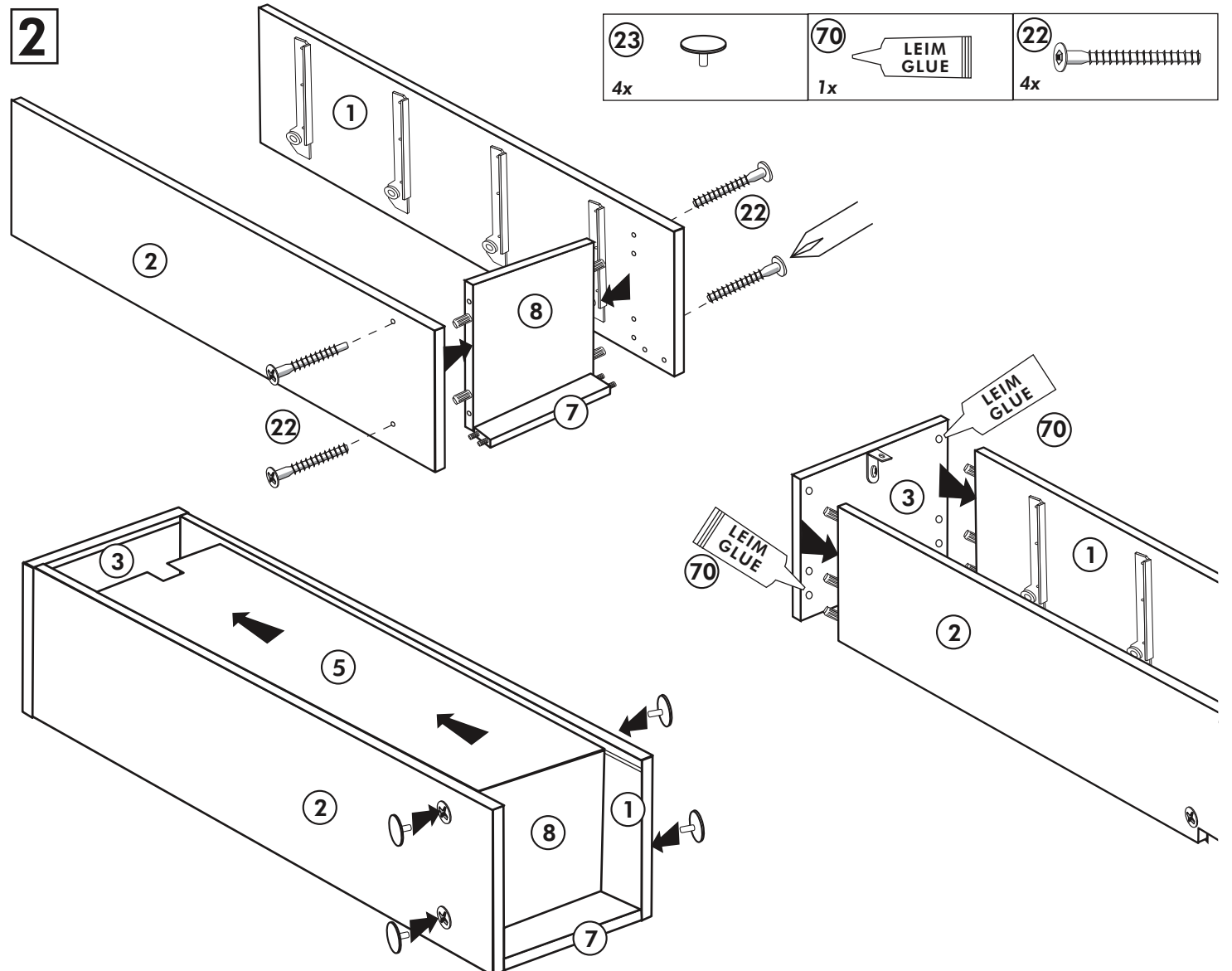
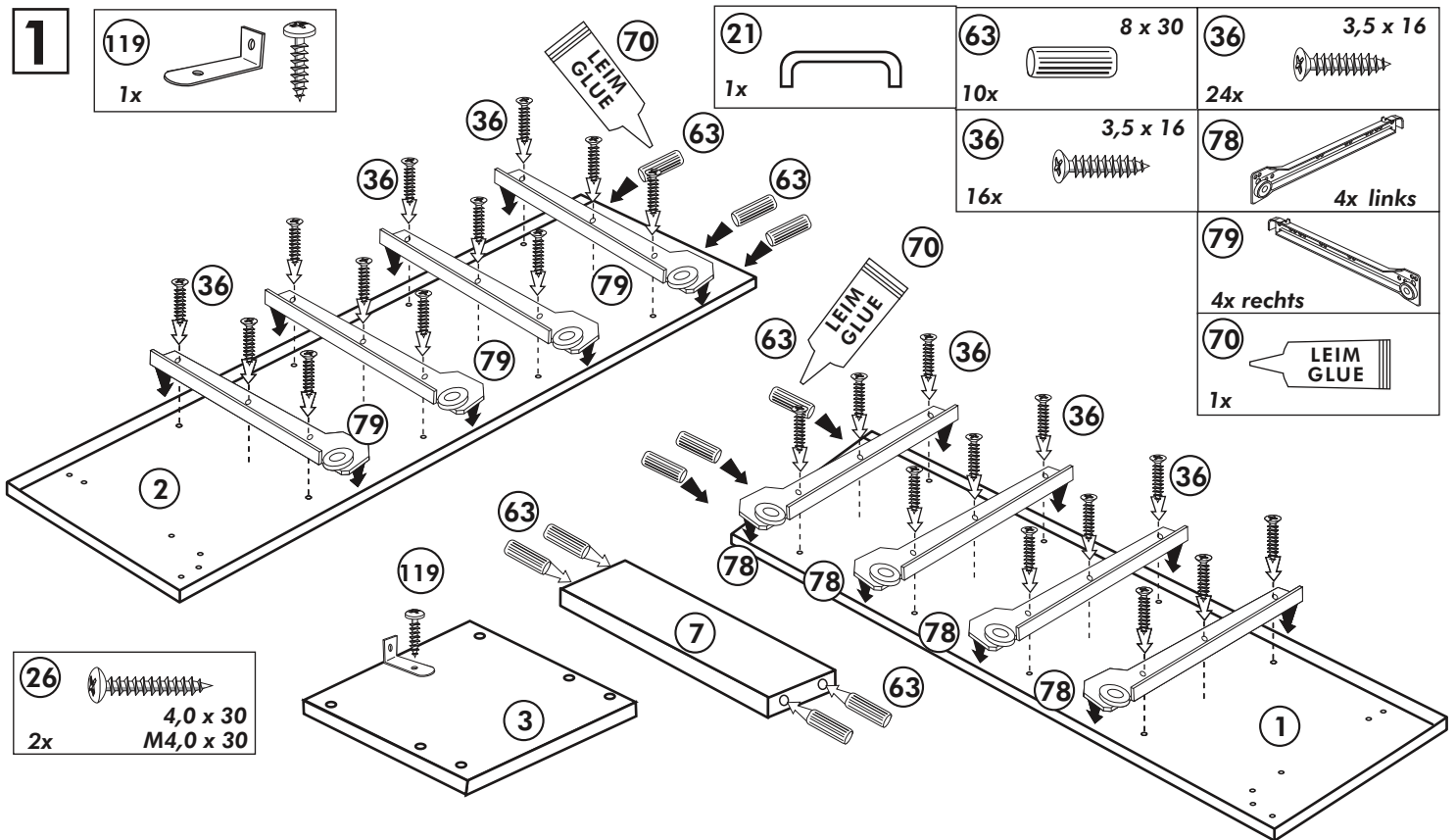

3

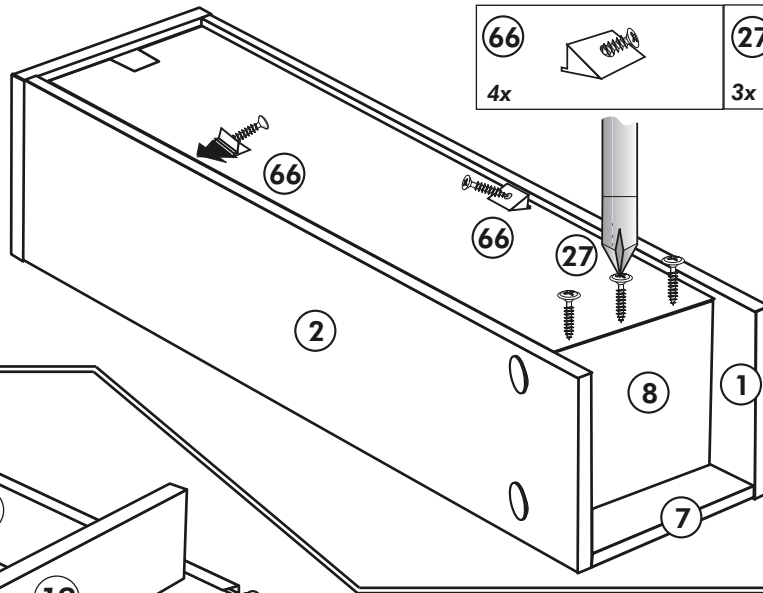
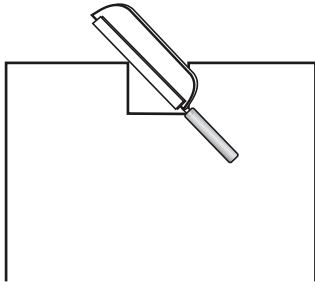
66
4x27
3x

3,0 x 20

4 4x

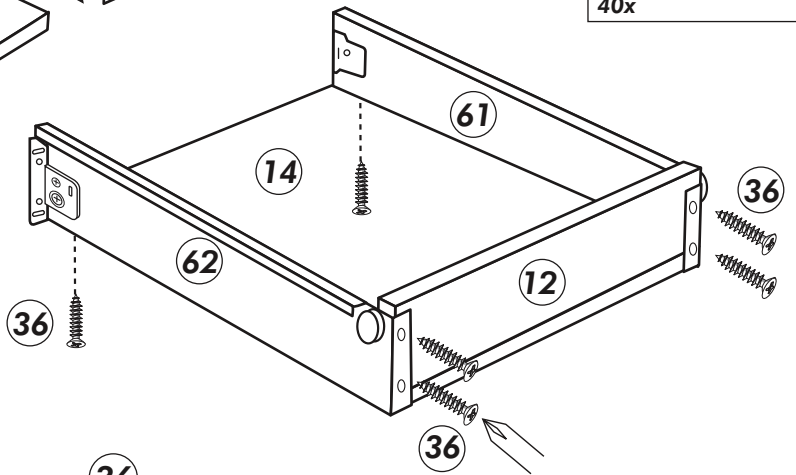
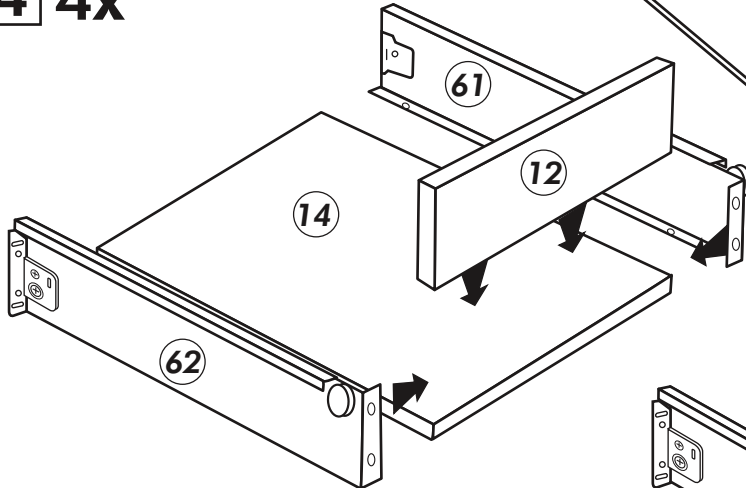
36
40x

3,5 x 16

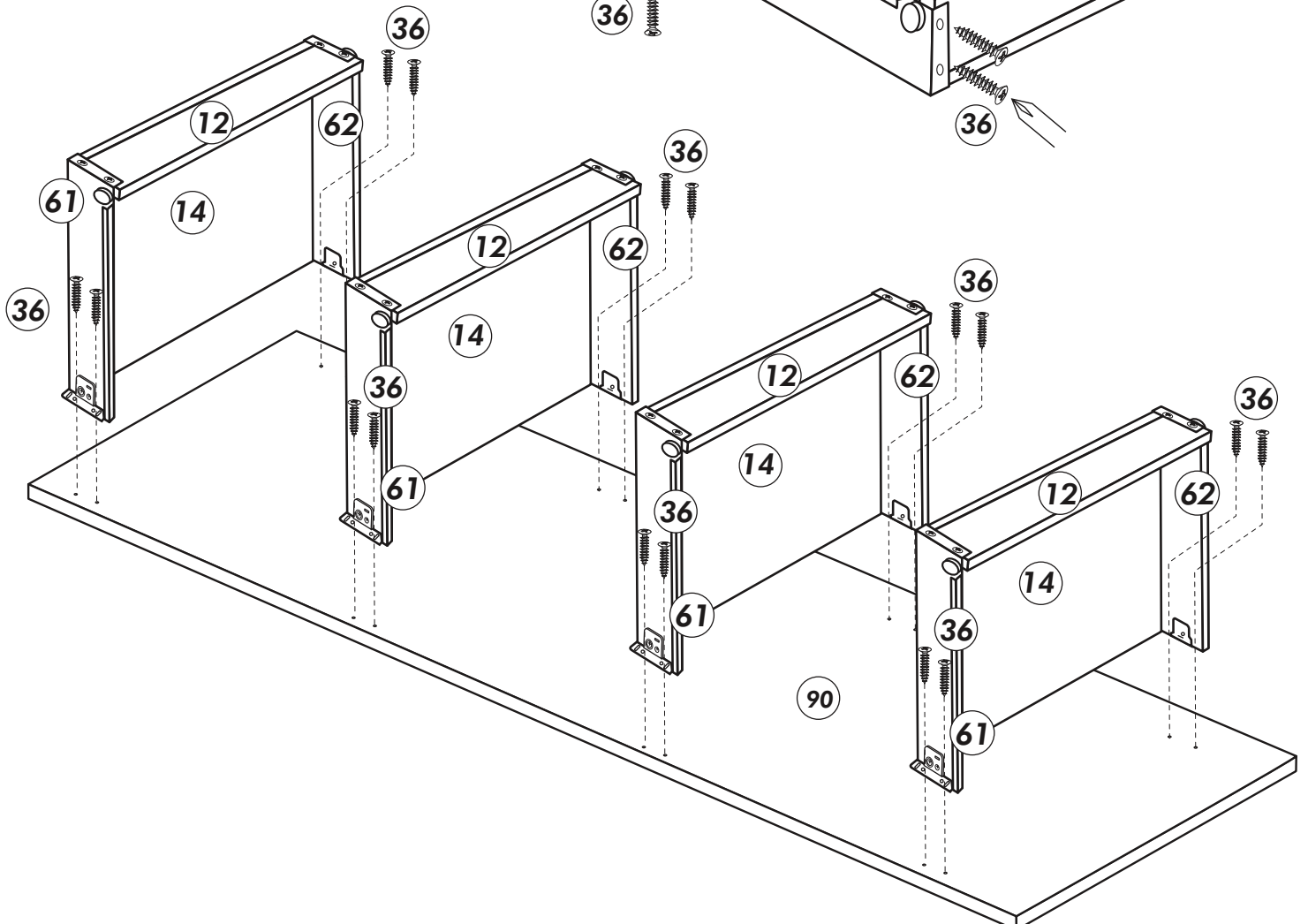



Achtung!
Der Schrank muß mit dem Winkel
von innen an der Wand befestigt werden,
weil der Schrank bei geöffnetem Auszug
nach vorne kippen kann.

