

# Baby Walker Assembly Instructions

Walker 3 in 1

*Please scan the QR code to watch the assembly video Instructions.*

*Veuillez scanner le code QR pour regarder les instructions vidéo d'assemblage.*

*Bitte scannen Sie den QR-Code, um die Montagevideo-Anleitung anzusehen.*

*Por favor, escanee el código QR para ver las instrucciones de montaje en video.*

*Si prega di scansionare il codice QR per guardare le istruzioni video di montaggio.*

*Scan de QR-code om de montagevideo-instructies te bekijken.*

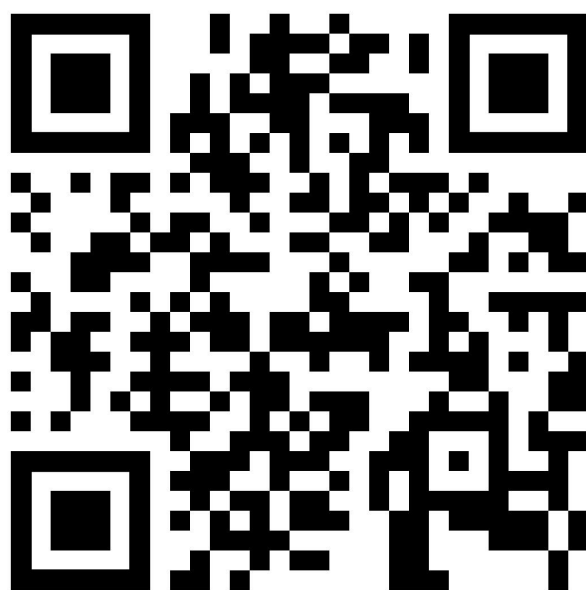
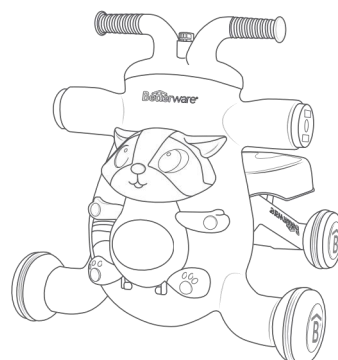

23223

# Rogue

Grows  
With Me

3-in-1 walker

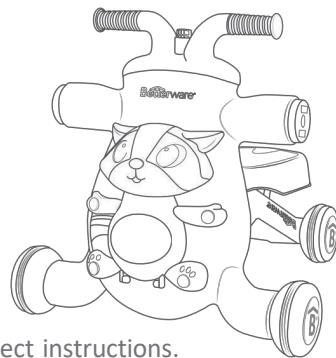

Please refer to the correct instructions.  
The product must be installed by an adult.

## Quick guide



More than 6 months  
In 3 years

Learn more about  
the product  
Here

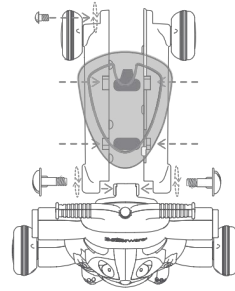
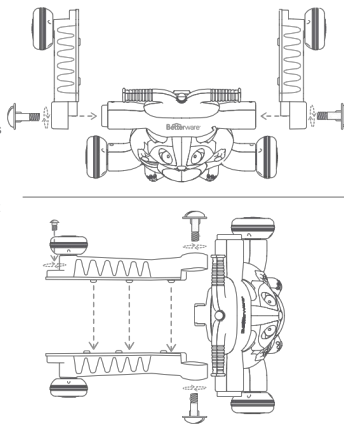

## 1 Identify



1 (A) screw

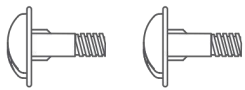

2 (B) Screw

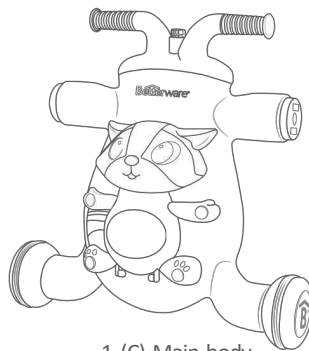

1 (C) Main body

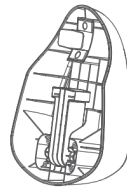

1 (D) seat

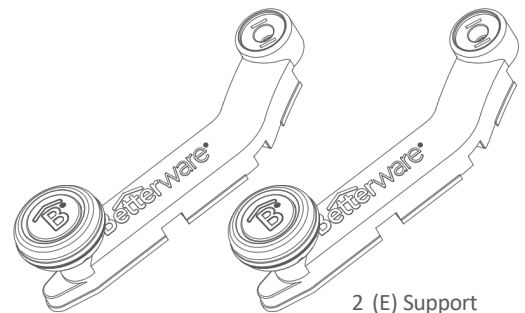

2 (E) Support

## 2 Choose the use

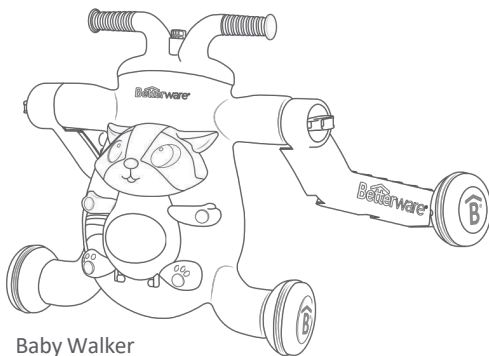

Baby Walker

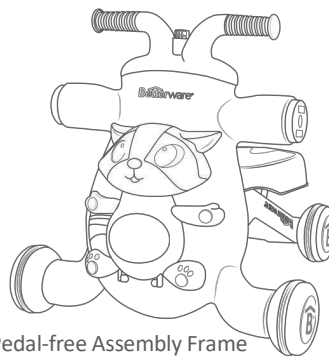

Pedal-free Assembly Frame

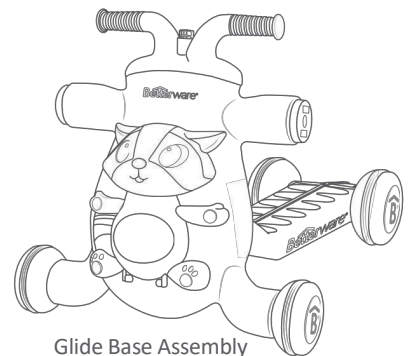

Glide Base Assembly

## 3 Assemble the baby walker

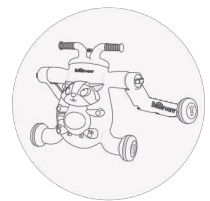
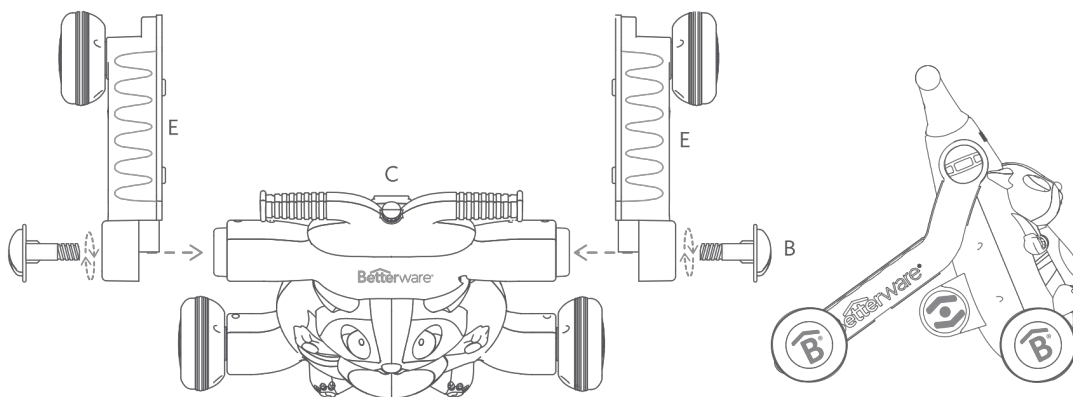

- Can accommodate the support in the image by placing part of the texture (wave) up and screwing the screw.
- Before placing the screws, the bracket must be correctly assembled on the main body.

## 4 Assemble the pedal-free frame

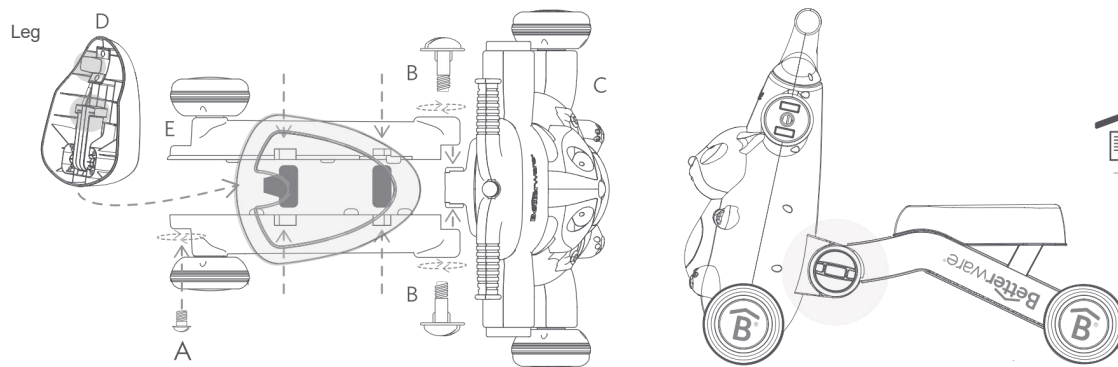

- Position the support bases with the textured surfaces (wave patterns) facing downward.
- Unfold the seat legs, then install the wheels by placing the seat into the center cavities while simultaneously attaching Component C.
- Secure all parts with screws as shown in the illustration.
- Ensure Screw A is properly tightened, as it provides critical stability and safety to the product.

## 5 Assemble the glide base

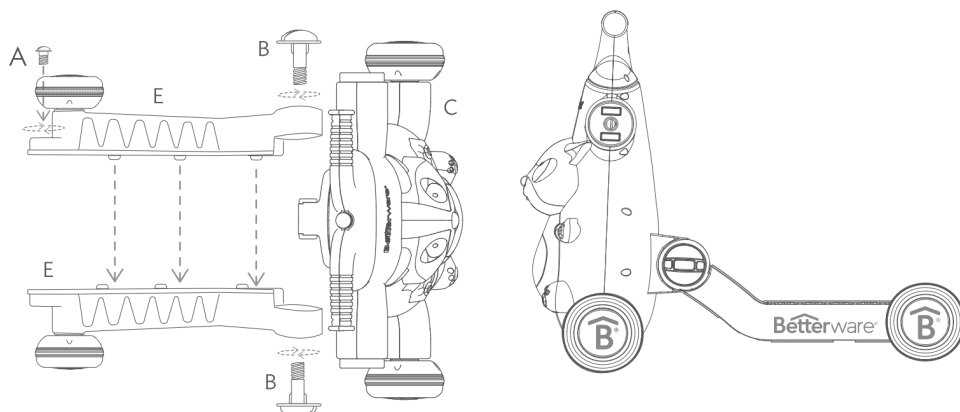

- Position the support brackets as shown in the image, ensuring the textured surface (wave pattern) faces upwards, then securely tighten the screws on the rear.
- Verify Fastener A is properly adjusted, as it provides essential stability and safety to the product.

## 6 Adjust the height

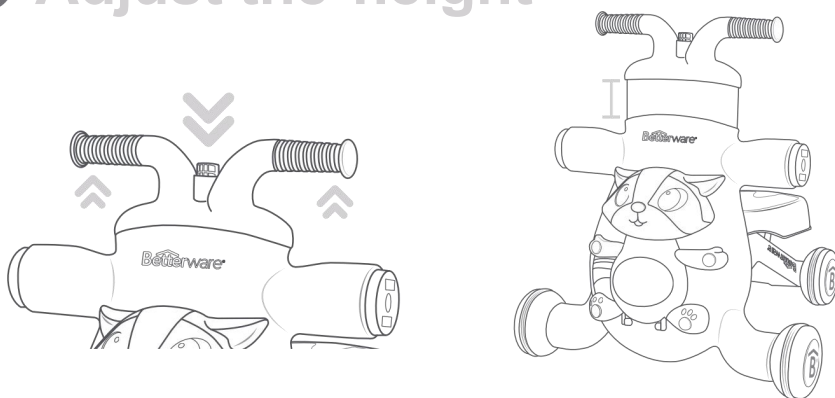

- Press the button and raise the handlebar to the highest position.
- Press the button again to lower the handlebar.

## 7 Guard

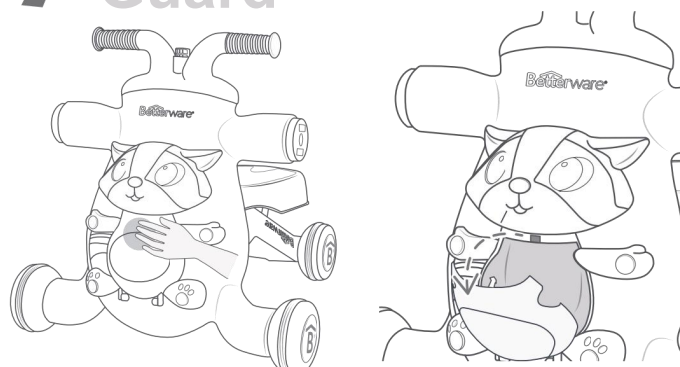

Press the upper abdomen area of Roque to open.

## ! Safety Warnings

### TO PREVENT SERIOUS INJURY OR DEATH:

- Use only with children who can hold their head up steadily.
- Never leave child unattended. Always keep child in view while using the product.
- Keep away from stairs, pools, hot surfaces, or other hazardous areas.
- Place on flat, level surface to prevent tipping.
- Contains small parts (e.g. screws) – Adult supervision required to prevent swallowing.
- Keep out of reach of children under recommended age (36 months).
- **Cleaning:** Wipe with damp cloth using mild soap. Do not immerse.

# Rogue Grows With Me

Walker 3 in 1

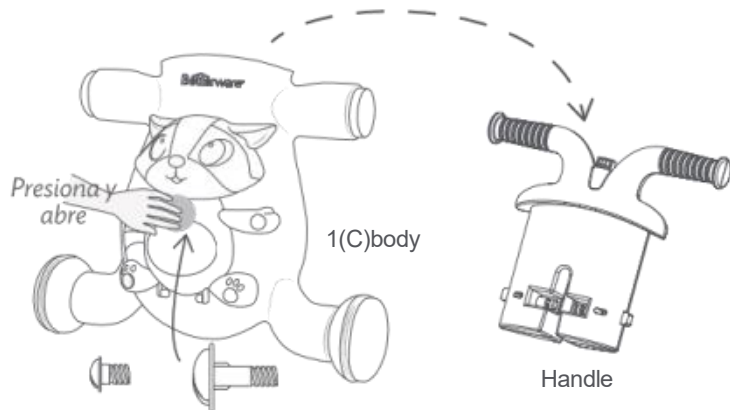

1 (A) screw 2 (B) screws  
(In the interior of Rogue)

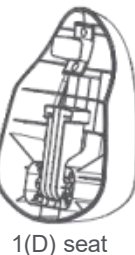
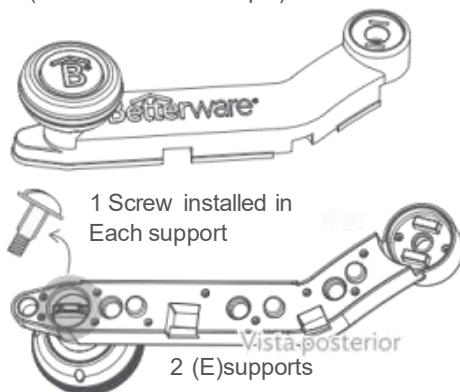

1(D) seat

## Assemble the Walker

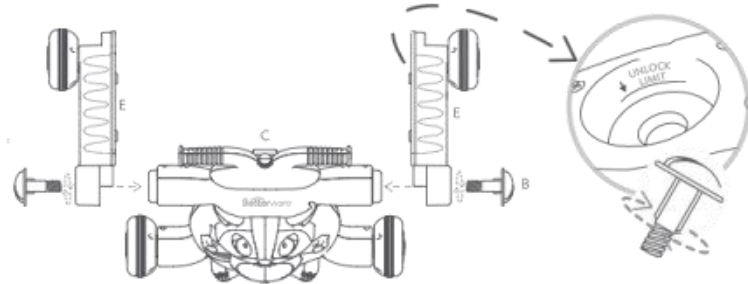

● Gradually tighten clockwise (to the right) to control wheel rotation.

● Fully lock wheels: screw to the stop position

● Unlock: unscrew to the "Unlock limit" line



● Manually validate proper wheel movement

## Assemble the Pedal-Free Frame

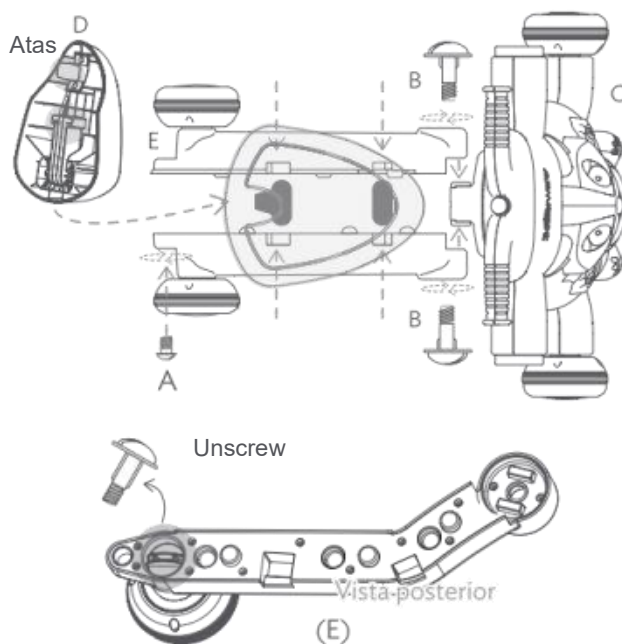

Retirar los tronillos de frenado de las piezas (E) antes de armar.

## Assemble the Glide Base

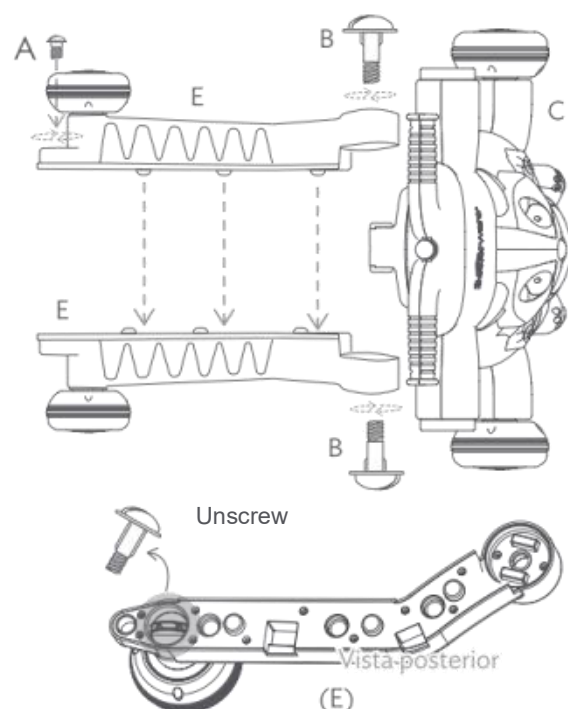

Retirar los tronillos de frenado de las piezas (E) antes de armar.