



USER MANUAL

Bidet Seat

Contents

- Thank you for your purchase of the product.
- Be sure to read this Instruction Manual before using your product and keep it in a safe place for future reference.

Safety notes	1	Before use
Product description	2	
Product dimension	2	
Component description	3	
Installation steps	4	Installation and use
Function introduction	7	
Cleaning and maintenance	8	Other matters
Product technical specification	9	
Faults and solutions	9	
Warranty Card	10	

Safety notes

Read the safety instructions carefully before use so as to properly use the product.
Note the following warnings relevant to the safety.

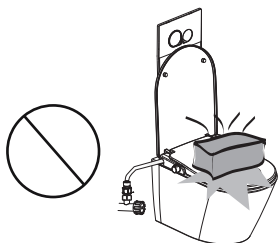

Do not place heavy objects on the toilet seat or the toilet cover

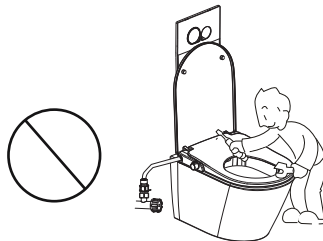

Do not disassemble, repair and modify products by without authorization.

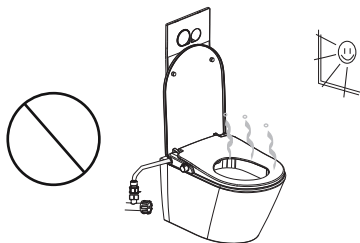

Do not place this product in direct sunlight.

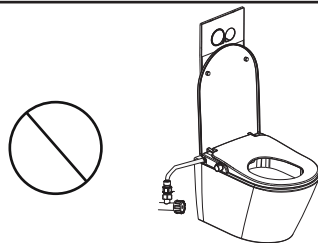

Do not bend or twist the water supply hose.

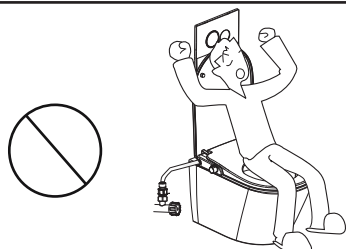

Do not lean against the toilet lid when in use

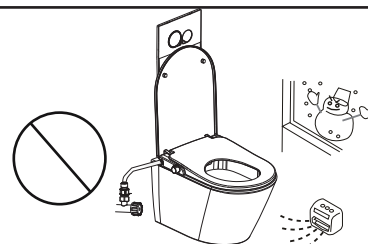

The room temperature of toilet shall be above 0°C.

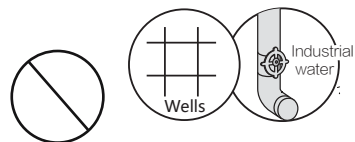

Do not connect to the substandard water pipe.



Please clean with the diluted kitchen cleaning agent and do not use the following items: Benzene, paint thinner, detergent powder, nylon brush, etc.

Product description

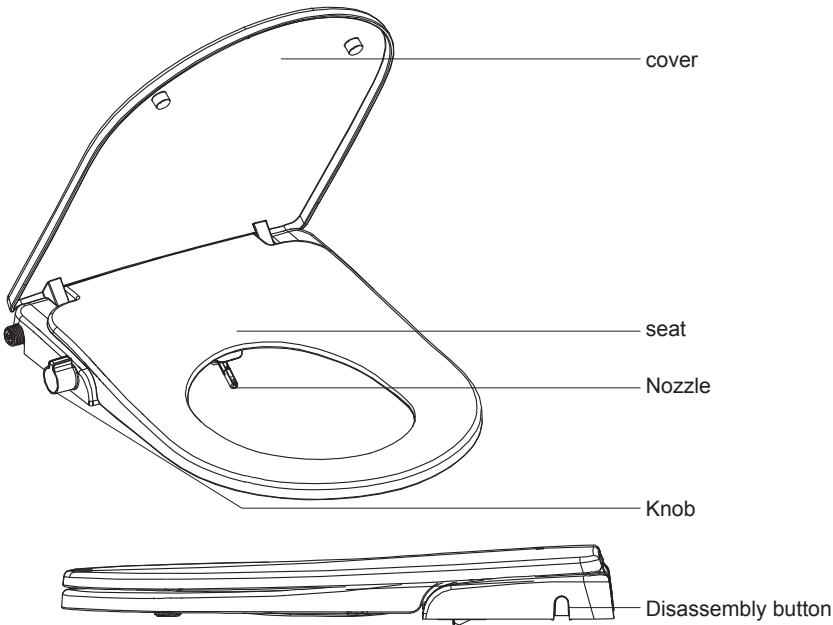

- Product dimension drawing

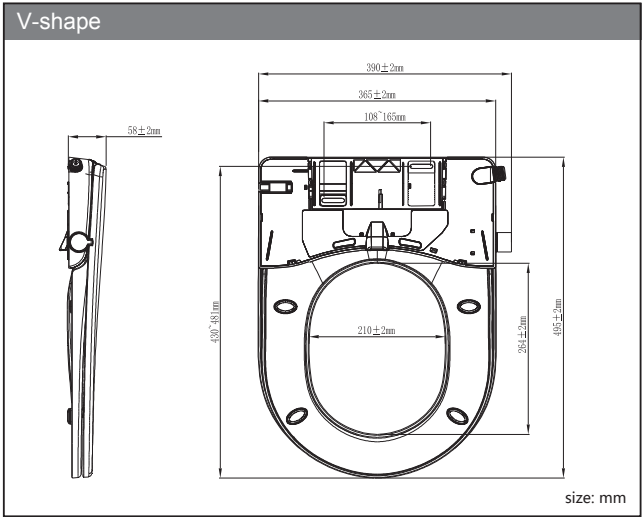

Component description

1. Cover plate

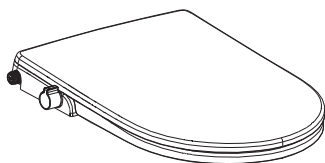

2. Installation template

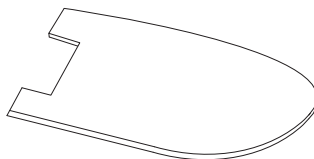

3. Fixation part

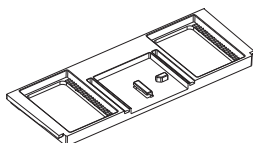

Fixing plate



Adjustment plates



Seat bolts

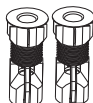

Nuts

4. Adapter



5. tube



6. User manual

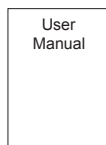

Installation steps

• Installation tools



Cross screwdriver

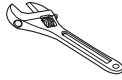

Monkey wrench



Barrel and rag

• Attention before installation

1. Water pressure range: 0.07-0.8MPa, please follow the instructions.
2. Corner valves shall be located close to the location where this product is installed and disassembled.
3. Please use the braided hose that comes with the product to prevent water leakage.
4. When installing braided hose, be careful to prevent the black gasket falling out.

• Installation Procedure

1. Loosen the nut connecting and remove the old cover.

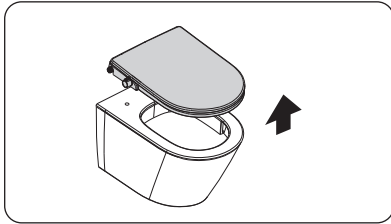

2. Place the installation template on the ceramic as shown. Align it with the rim of toilet.

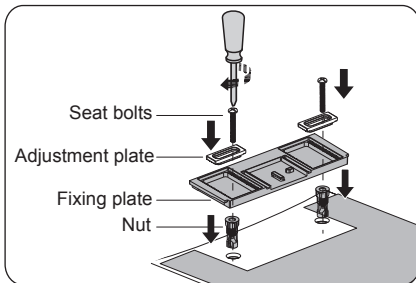
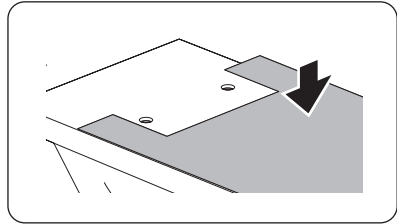

3. ① Insert the nuts into ceramic hole;
② Place fixing plate in notch part of template;
③ Place adjusting plate in fixing plate;
④ Align seat bolts hole, and tighten up;

Installation steps

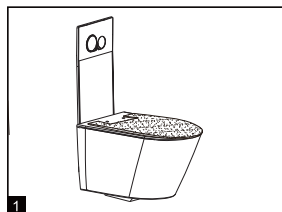

Position the template onto the bowl and use it as a guide to align the mounting plate

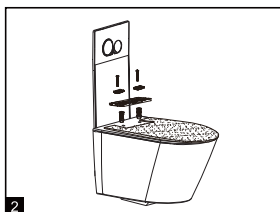

Position the mounting plate over the bowl holes, insert the adjustment plates into the mounting plate to align with the bowl holes, install the seat bolts and nuts to secure the mounting plate to the bowl

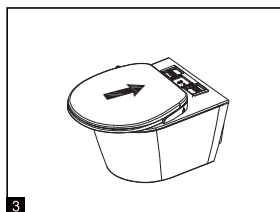

Position the seat over the mounting plate [the back of the seat needs to align with the back notch], then slide the seat backwards.

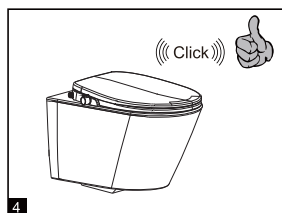

There will be an audible click when engaged correctly.

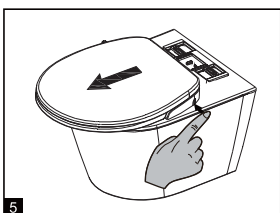

To remove the seat, press the release button on the side of the seat and slide it forwards as far as possible, then lift off.

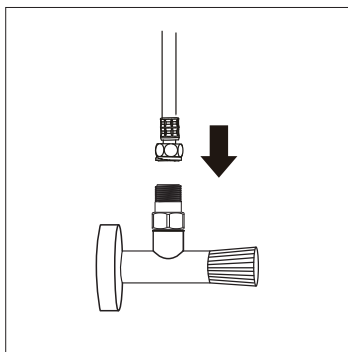

Install the adapter onto the stop valve. Install the tube and existing pipe onto the adapter

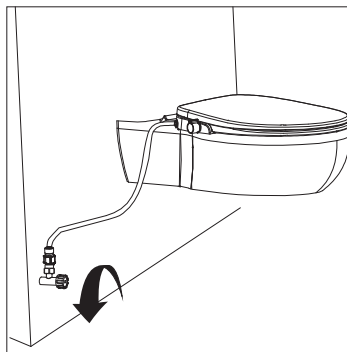

Turn on the stop valve and turn on the bidet. Check all joints for leaks.

Function introduction

- Konb function



Posterior Cleaning



Feminine Cleaning

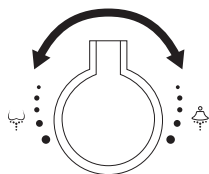

OPERATION

To activate the bidet, turn the control knob forwards or backwards until it clicks, Turn further to increase the pressure, Return to the upright position to turn off.

Cleaning and maintenance

• Manual cleaning of spray tube

- Gently pull out the nozzle and dip the neutral detergent with a soft cloth, sponge or small brush.
- Gently support the nozzle, wipe the spray tube and nozzle.

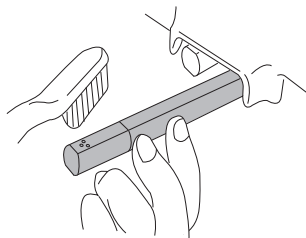

• Clean filter screen

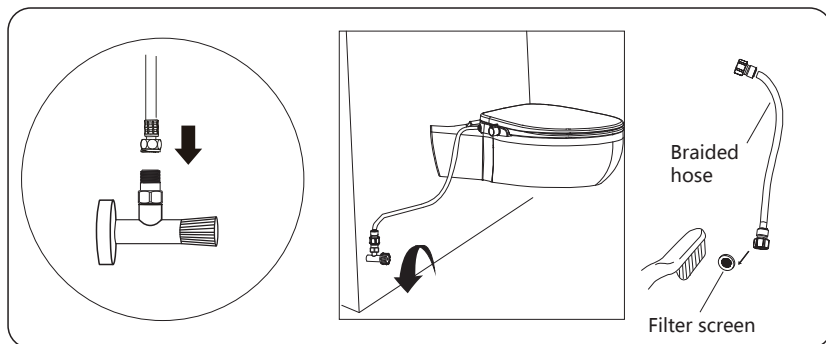

i Tips:

- Make sure that the corner valve close off before you clean the filter screen ;
- Clean the filter screen when the water flow is less than normal hours.
- During cleaning process, the product must be thoroughly separated from the water inlet hose;
- Reinstall the filter screen in reverse order after cleaning.

• Product surface cleaning

- Wipe the product surface with a sponge or soft cloth dampened with room temperature water or a neutral detergent.
- Lift the upper cover and the seat ring when cleaning other parts with cleaning agents.
- Do not put cover on before the cleaning agent in the ceramic toilet is completely washed, otherwise the surface may be corroded by the evaporation of cleaning agent.

Product technical specification

Items		Description
Water supply pressure		0.07-0.8 MPa
Water supply temperature		Water at room temperature
Ambient temperature		0 ~ 40℃
Net weight		About 2.8kg
Cleaning device	Water amount regulation	Stepless regulation
	Protective device	Anti-backflow valve
Others	Antibacterial material	Nozzle
	Control operation	Knob

Faults and solutions

Phenomenon	Possible cause	Solution
Low flushing	Knob is not completely turned on.	Increase knob regulating angle.
	Water pressure too low	Contact relevant departments to solve water pressure problems
Turn on knob and no the water comes out	Valve is off	Open the vavle
	The filter of the water inlet pipe is blocked	Clean the filter of the water inlet pipe
	Nozzle clogging	Remove the nozzle and clean
Spray rod cannot reset	Water quality is too bad to blocking the spray rod	Clean spray rod
Base leaking	Water pressure too high	Contact relevant departments to solve water pressure problems

Warranty Card

To dear customers:

Thank you for choosing our E-bidet! If any problem occurs during use, please simply remove and check the problems pursuant to the user's manual. When you cannot remove such problems, contact your local supplier or call the service hotline.

I. Information:

Customer information	Customer name		
	Address		
	TEL		
Dealer information	Name		
	TEL		
Model		Product series number	
Purchase date	Y M D	Warranty period	One-year free warranty since the purchase date

II. Notes to warranty card:

1. Please complete the warranty card.
2. Warranty cards and invoices are important for the warranty service.
If the product failure occurs during warranty period, please show the warranty card and the invoice when the dealer or after-sales service personnel of the Company provide on-site maintenance and repair.
3. The warranty card cannot be reissued, please keep it properly.

III. Rules on free maintenance

During the warranty period, the Company will provide repair free of charge according to the use instructions, precautions for normal use.

IV. Paid maintenance is required in the following circumstances that do not fall within the scope of free maintenance:

1. Out of warranty.
2. The valid invoice and warranty card cannot be provided during the warranty period.
3. Failure or damage caused by transportation, collision after purchase.
4. Product damage during abnormal use, failure and damage during the warranty period caused by human factors or natural disasters, such as fire, earthquake, flood, lightning or environmental pollution, etc.
5. Failure or damage caused by unauthorized disassembly, modification or maintenance due to user's cause or responsibility.
6. Failure or damage caused by violation of maintenance regulations in use, such as improper use of cleaning agent or wiping and maintenance methods not compliant with maintenance requirements.
7. The consumable items (such as sealing rings, etc.) or products have failed or damaged due to sand and impurities.
8. Conduct the secondary transfer according to the customer's requirements.

