

LICIA

25000404

LKZ 42373

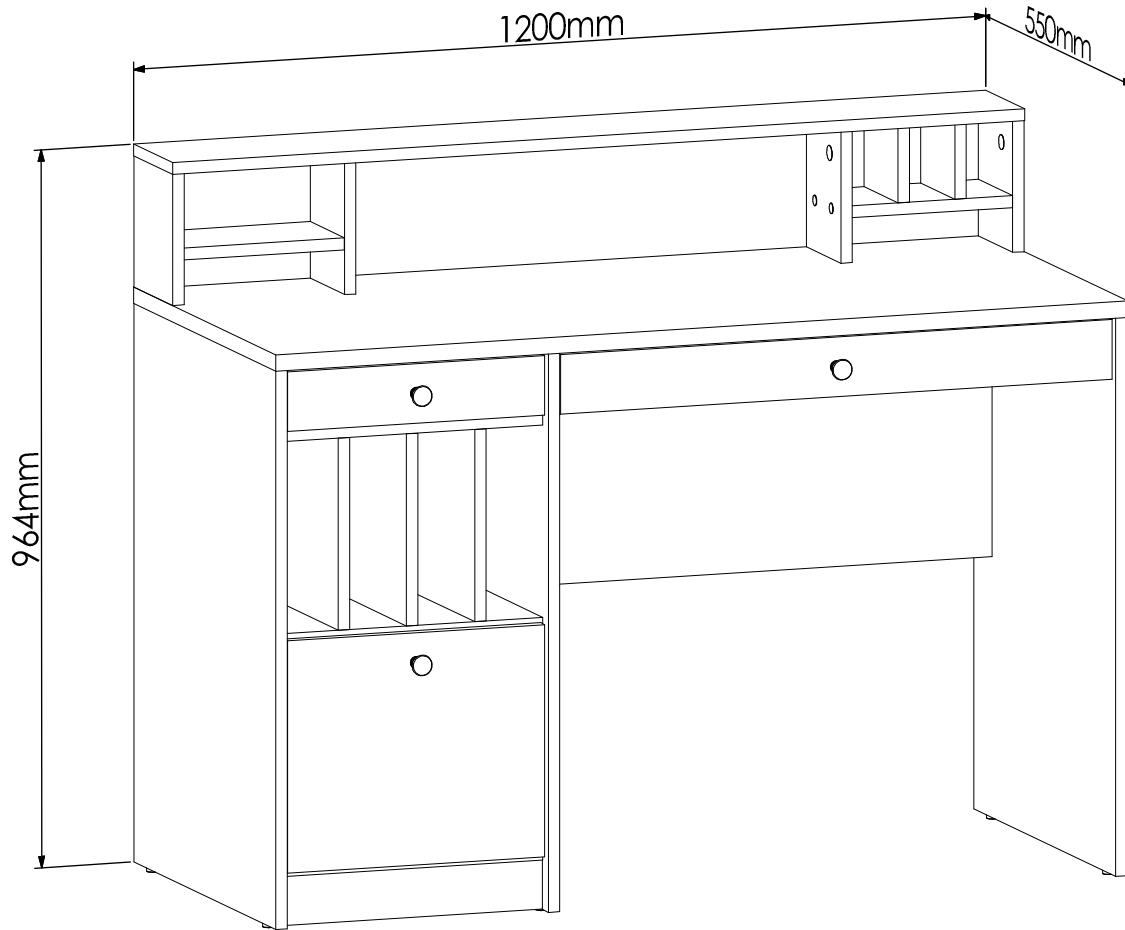

- | | |
|---|-------------------------------------|
| (D) Montageanleitung | (GB) Assembly instructions |
| (FR) Notice de montage | (IT) Istruzioni di montaggio |
| (NL) Handleiding voor de montage | (PL) Instrukcja montażu |
| (CZ) Montážní návod | (SK) Návod na montáž |
| (HU) Szerelési útmutató | (RO) Instrucțiuni de montaj |
| (TR) Montaj talimati | (RU) Инструкция по монтажу |

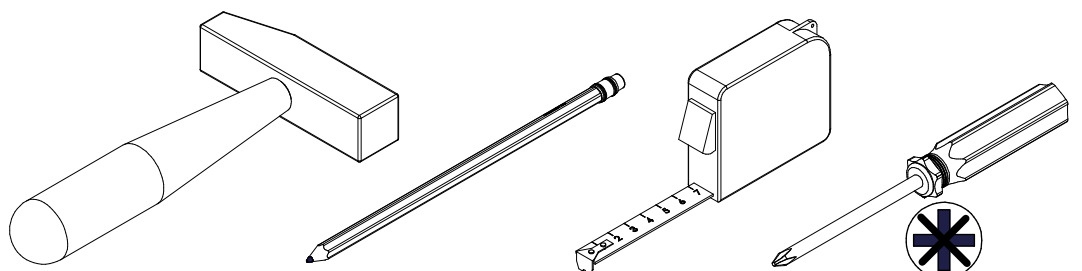
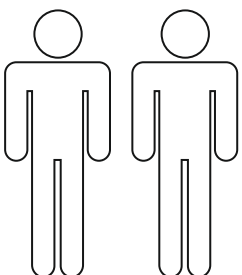

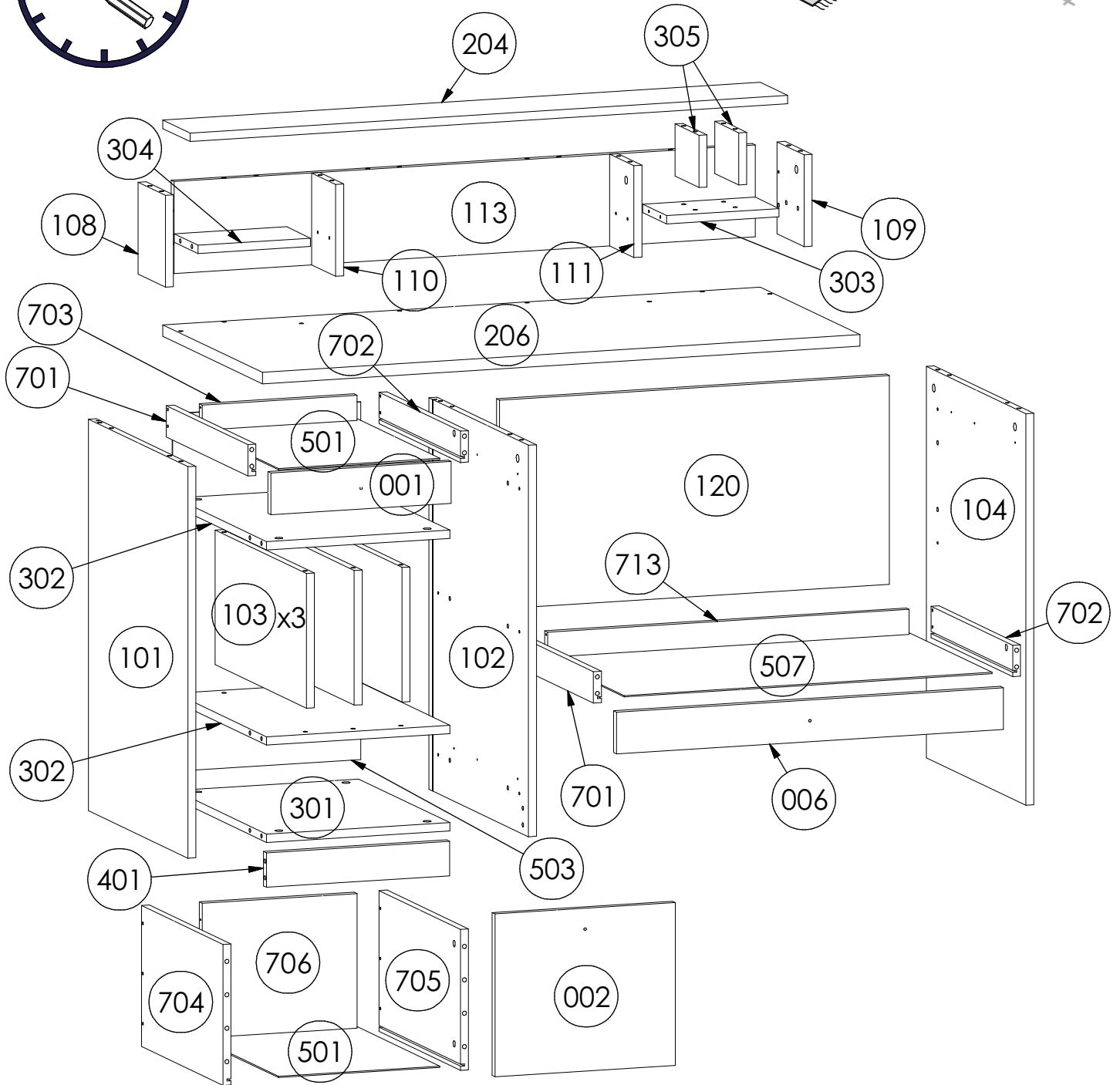
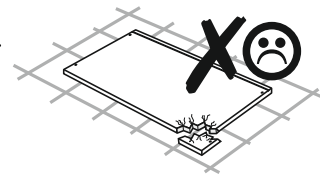
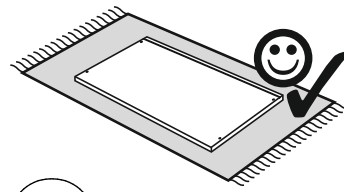
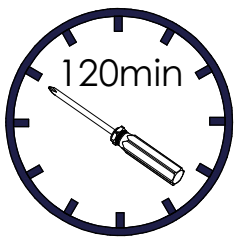

Nr	L[mm]	B[mm]	H[mm]	St	Colli	Nr	L[mm]	B[mm]	H[mm]	St	Colli
001	362	80	16	1	1/2	302	504	368	16	2	2/2
002	362	312	16	1	2/2	303	226	132	16	1	1/2
006	777	80	16	1	1/2	304	226	132	16	1	1/2
101	750	549	16	1	2/2	305	132	100	16	2	2/2
102	750	549	16	1	2/2	401	368	66	16	1	2/2
103	504	258	16	3	2/2	501	453	324	16	2	1/2
104	750	549	16	1	2/2	503	685	378	2.5	1	1/2
108	176	150	16	1	1/2	507	739	453	2.5	1	1/2
109	176	150	16	1	1/2	701	450	60	16	2	2/2
110	176	133	16	1	1/2	702	450	60	16	2	2/2
111	176	133	16	1	1/2	703	311	48	16	1	2/2
113	1167	176	16	1	1/2	704	450	270	16	1	1/2
120	783	400	16	1	1/2	705	450	270	16	1	1/2
204	1200	151	16	1	1/2	706	311	258	16	1	1/2
206	1200	550	22	1	1/2	713	726	48	16	1	2/2
301	504	368	16	1	2/2						

Service - Dienstverlening - Serwis - Servis - Сервисная служба

Name - Naam - Nazwa - Isim - Название

Nr. - No. - Номер

Typ - Type - Тип - Тип

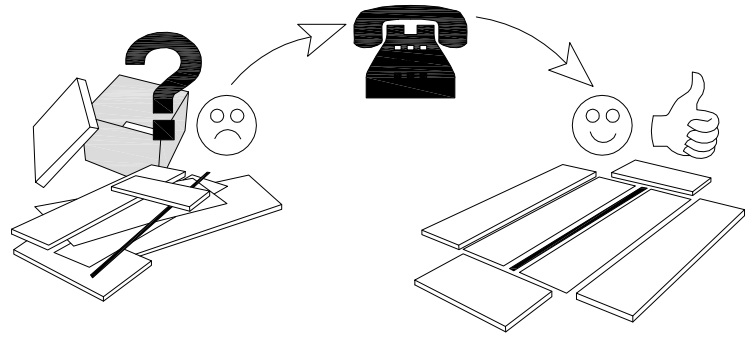
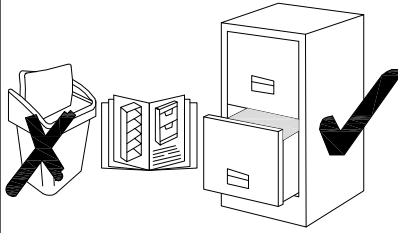

A1

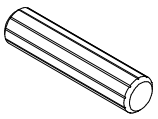

68x

G1

B1

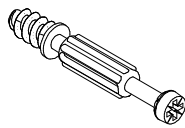

40x

G3

C1

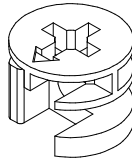

32x

H1

C2



8x

J3

D1

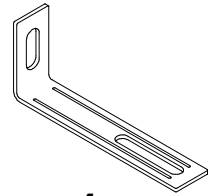

1x

J4

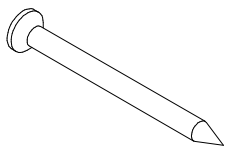

19x

K1

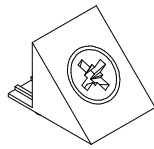

8x

N3

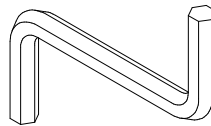

1x

U25

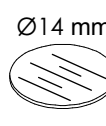

Ø14 mm

12x

W1



Ø21 mm

4x

W2

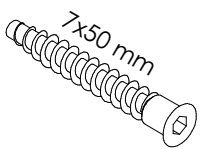

12x

W3

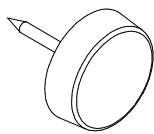

6x

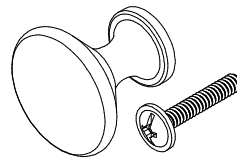

3x

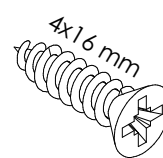

20x

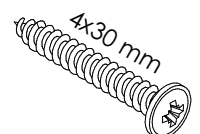

14x

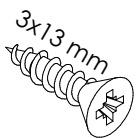

18x

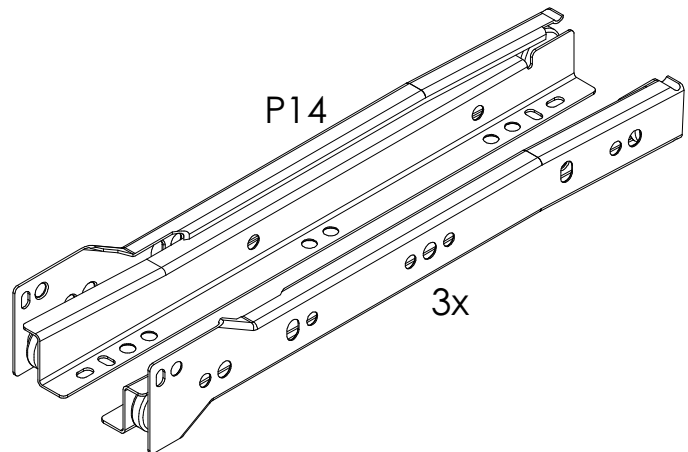

1

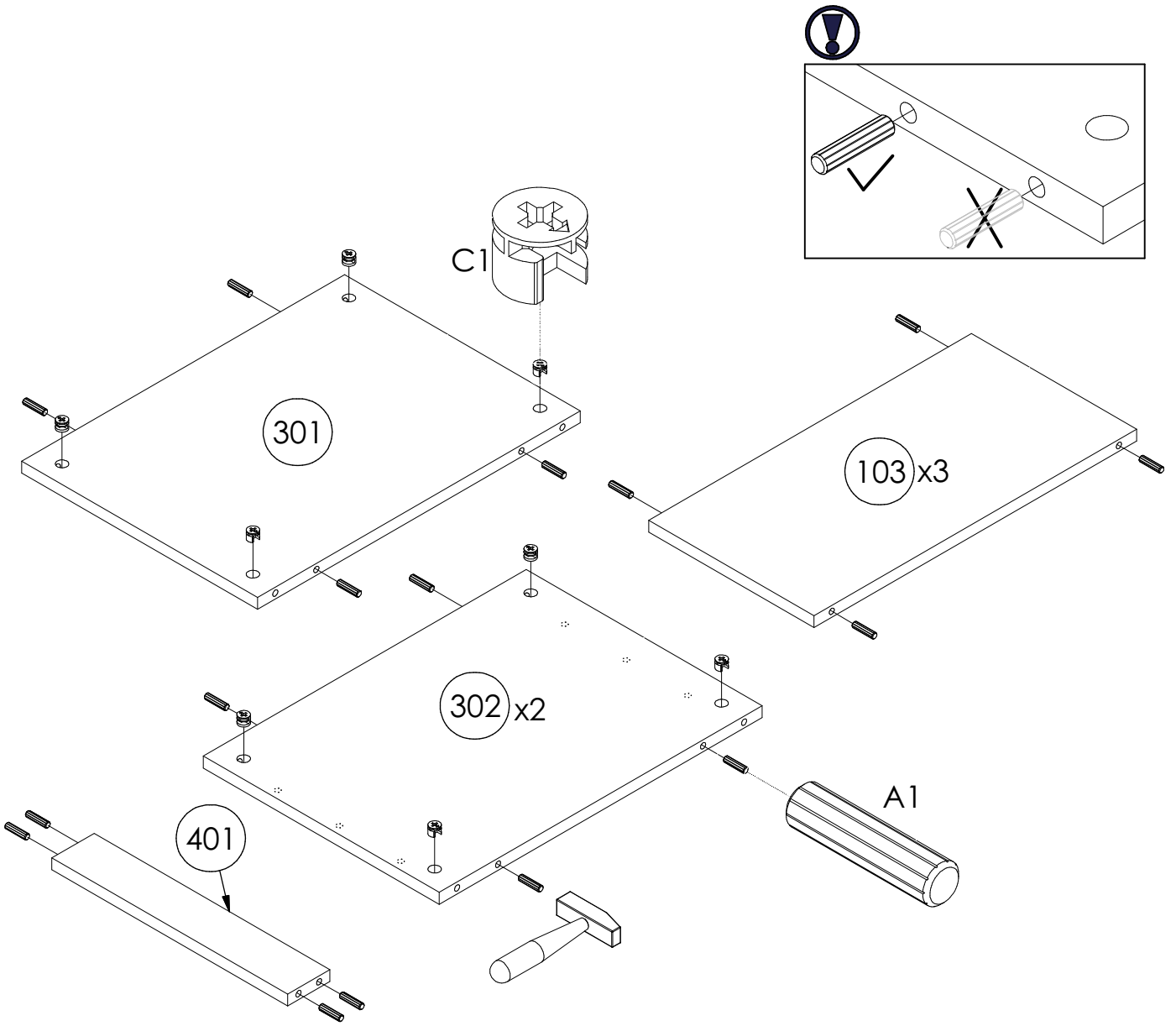

2

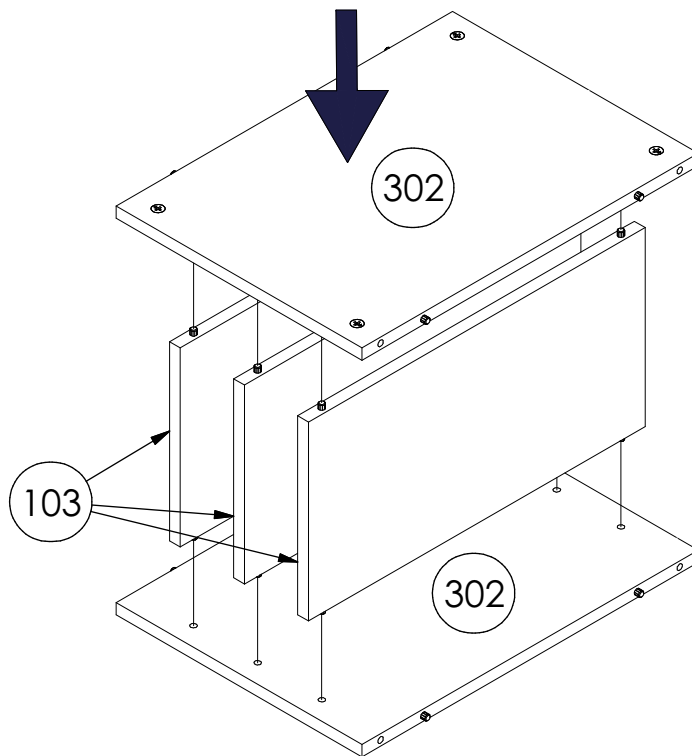

3

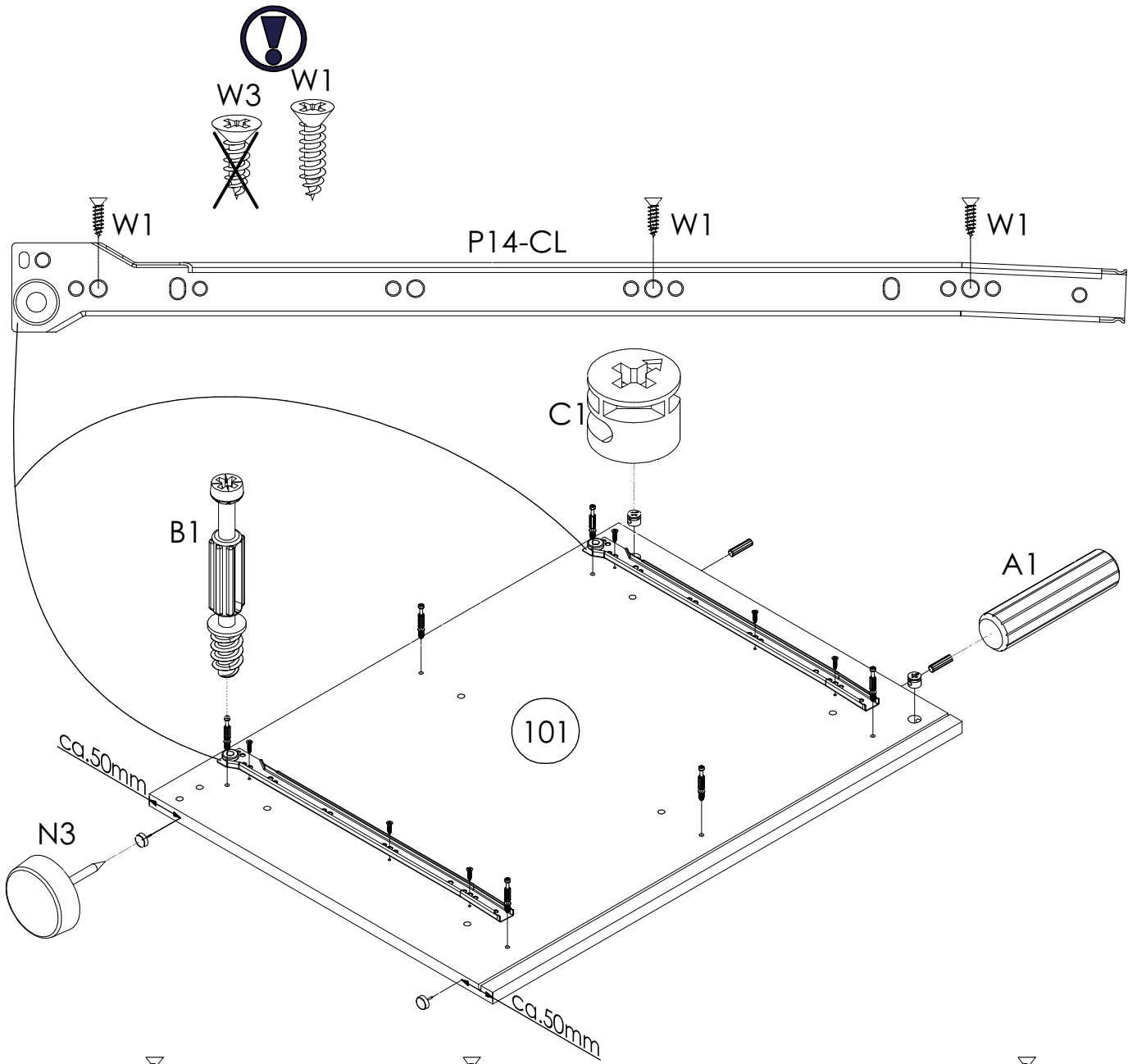

4

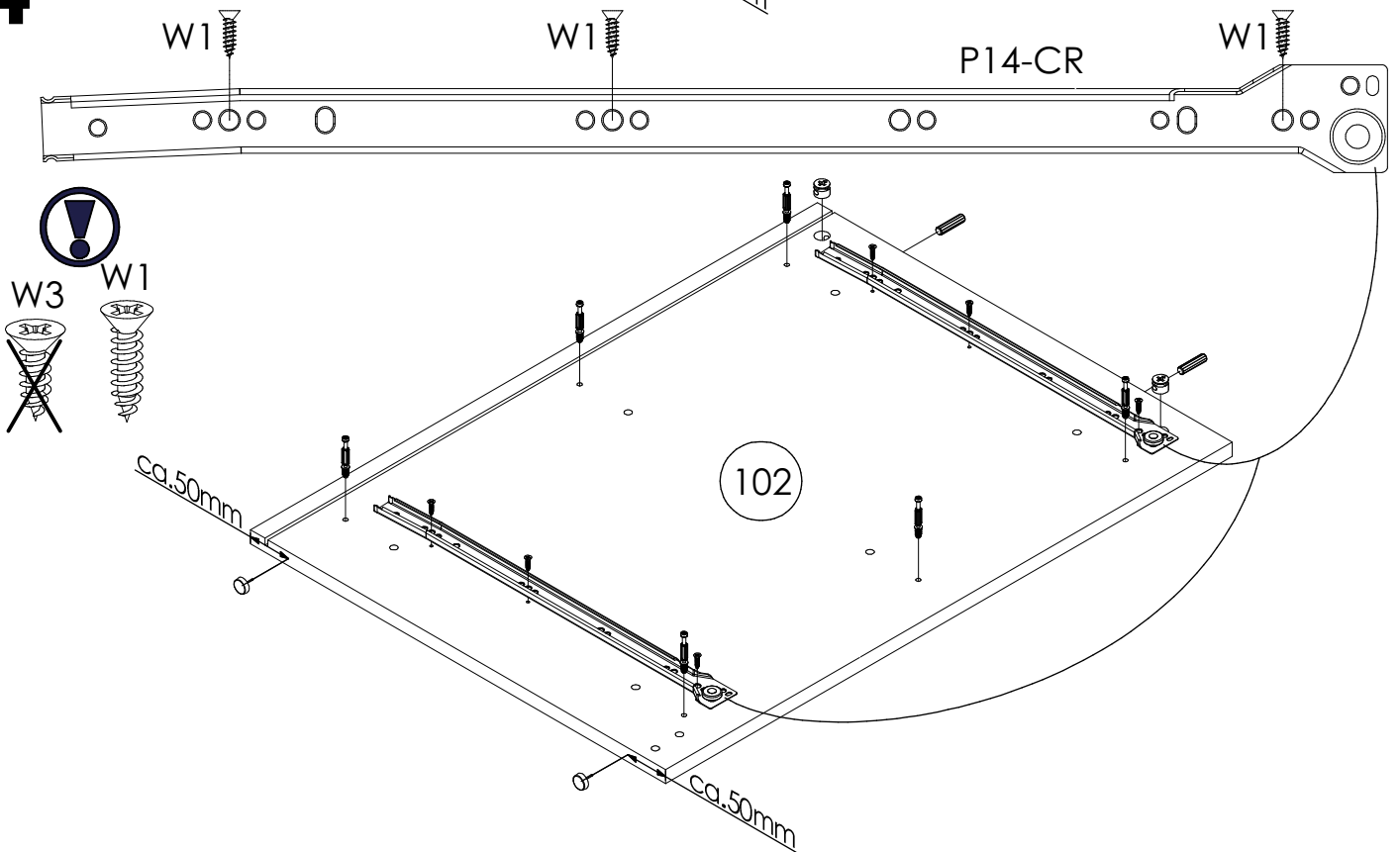

5

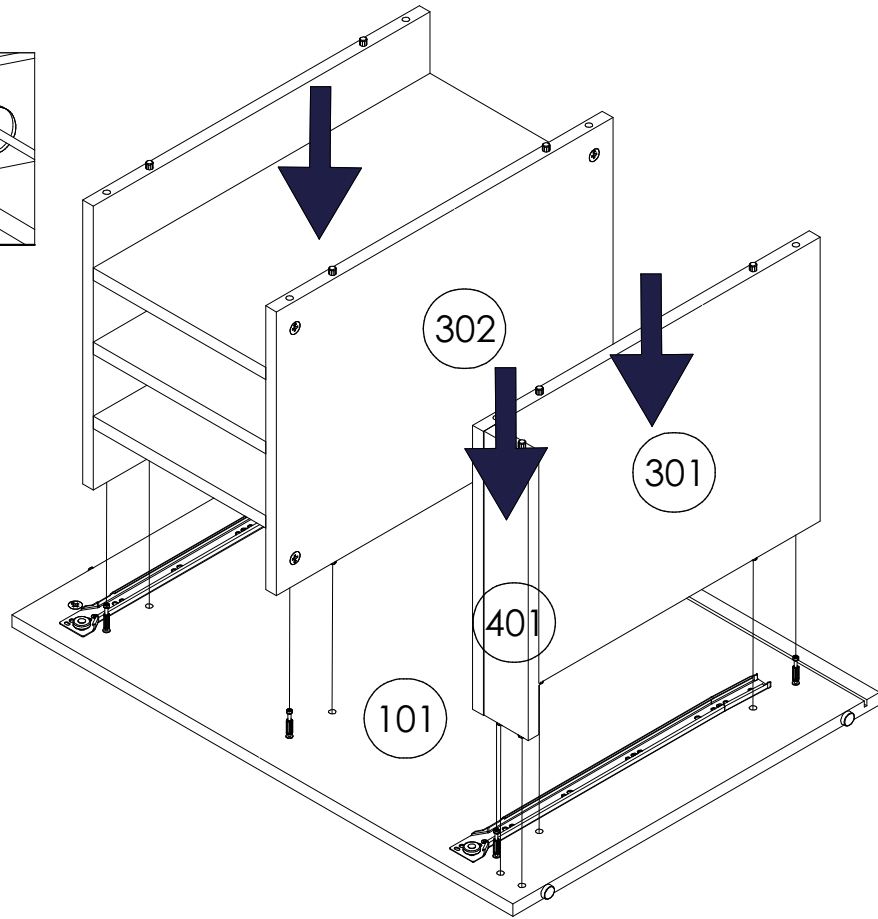
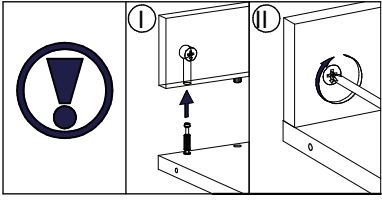

6

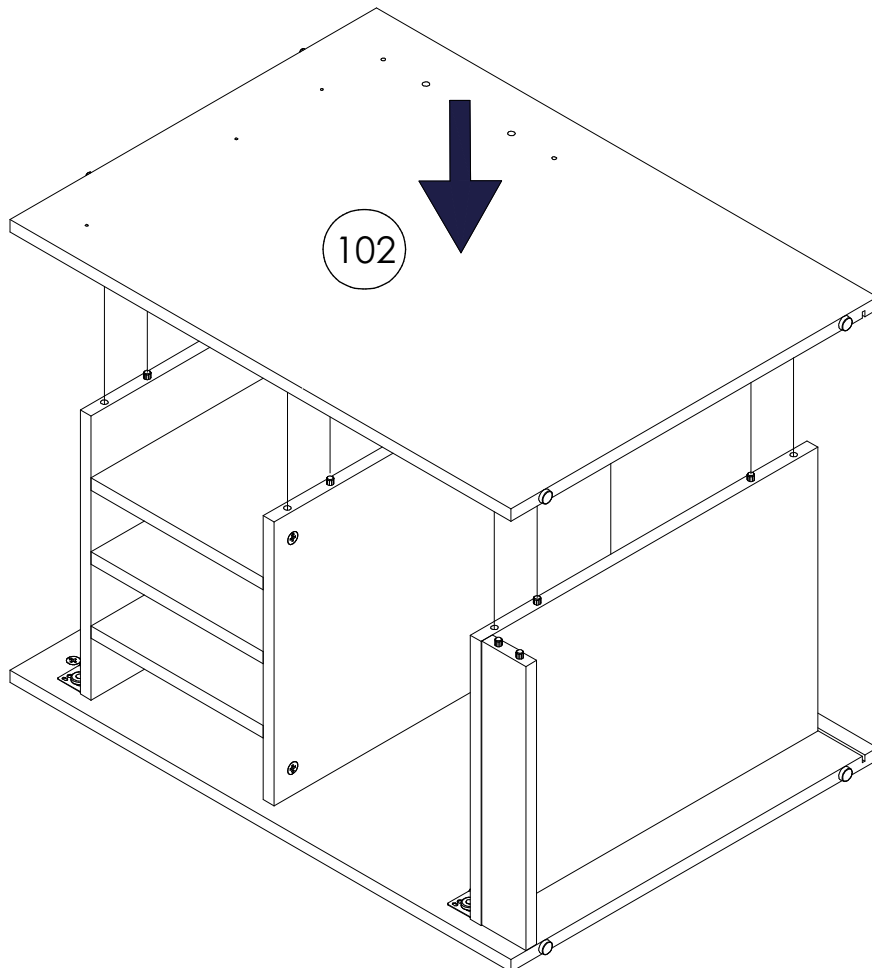

7

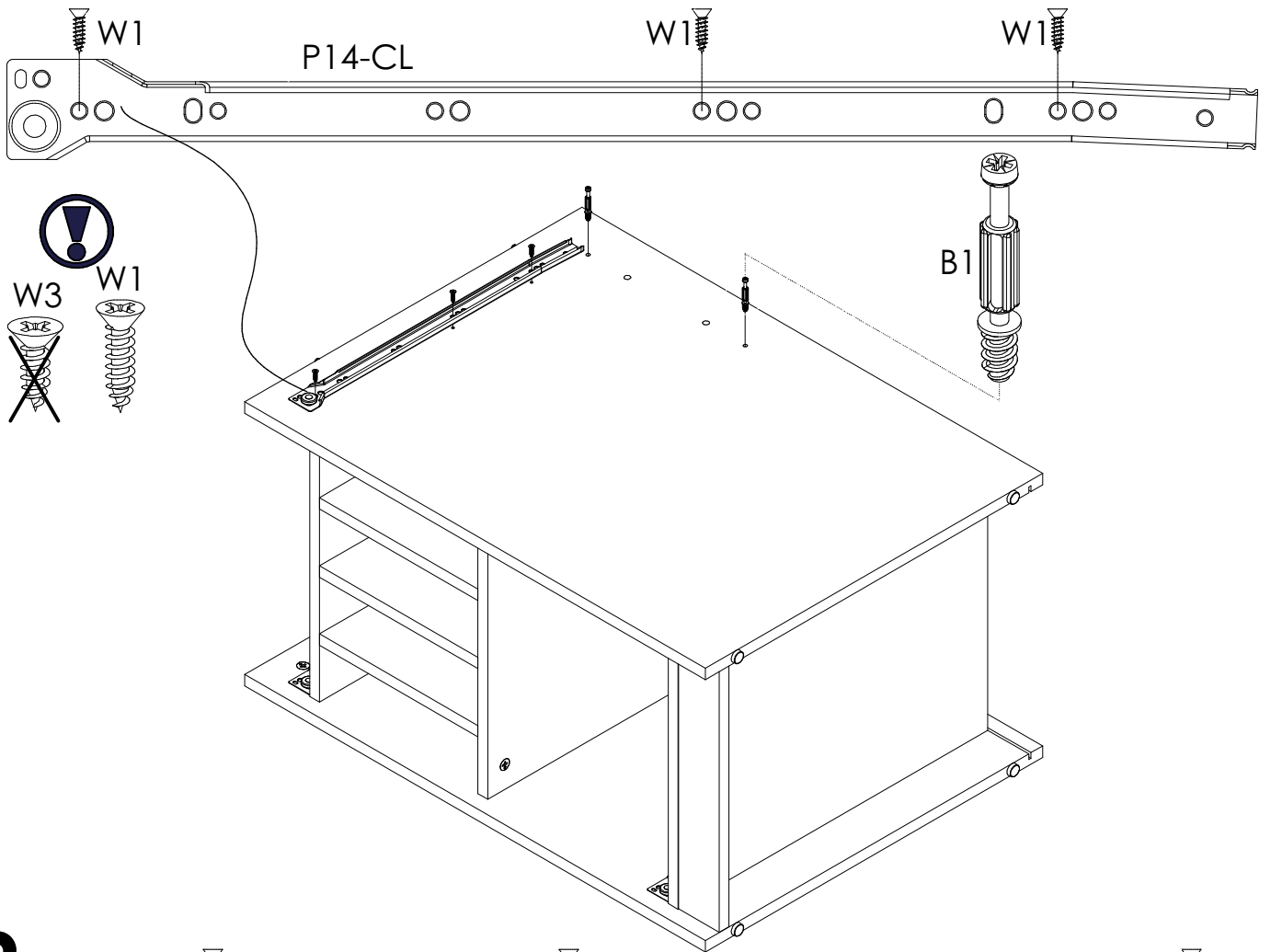

8

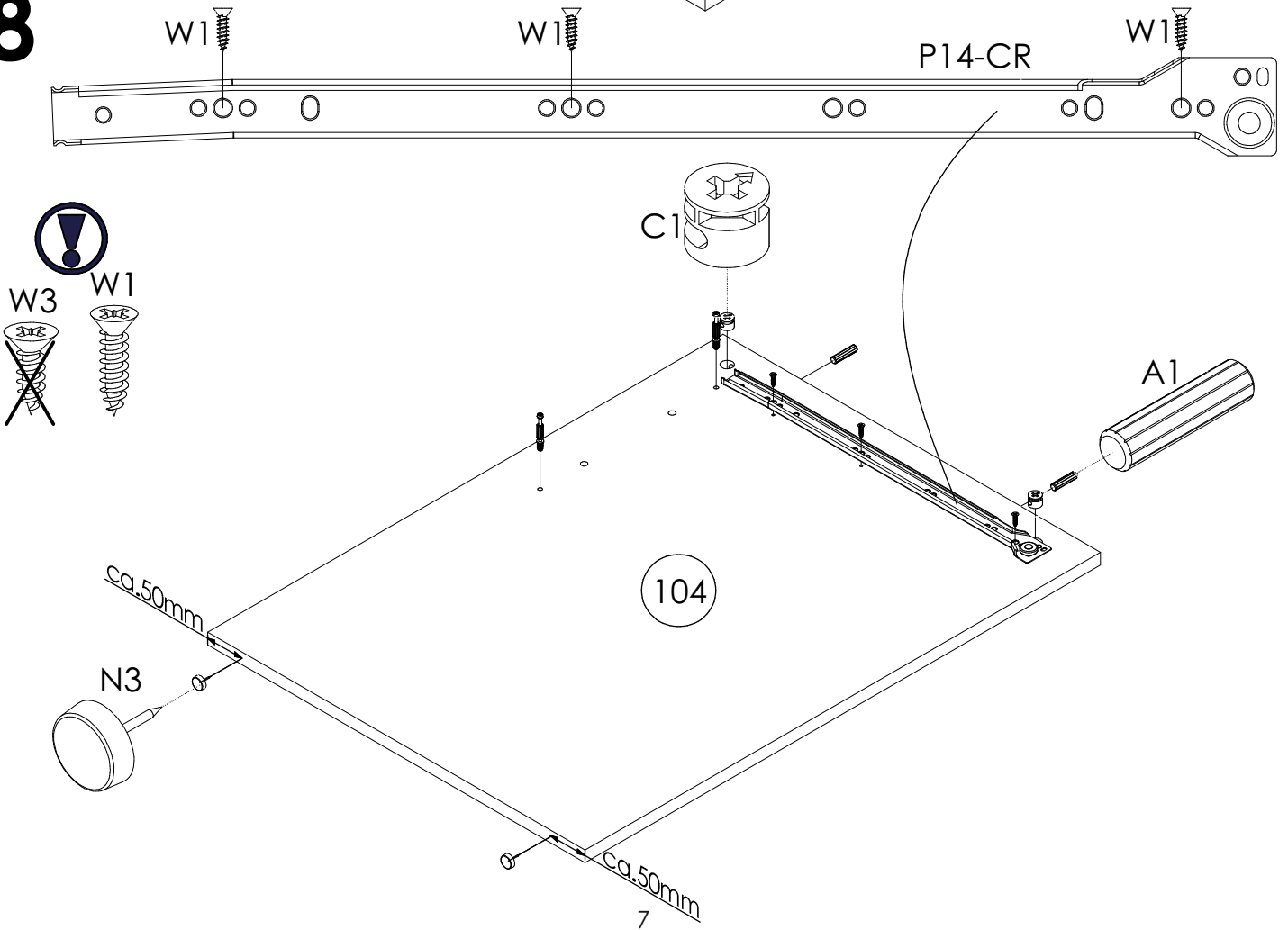

9

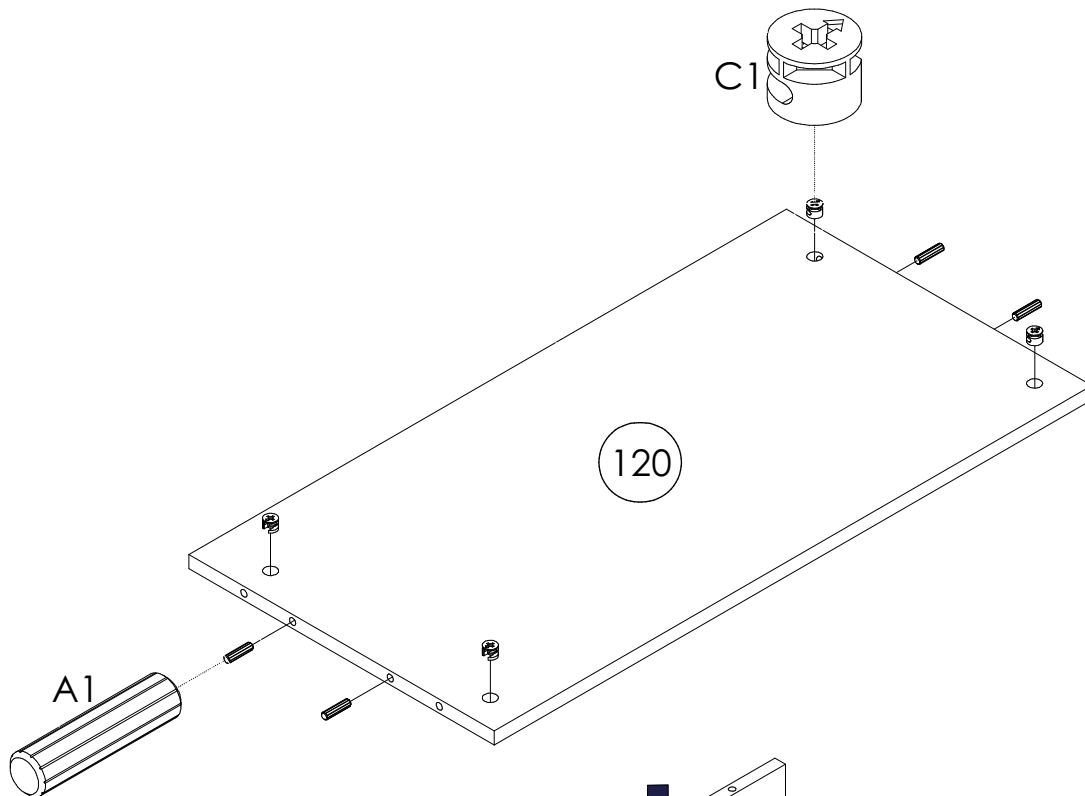

10

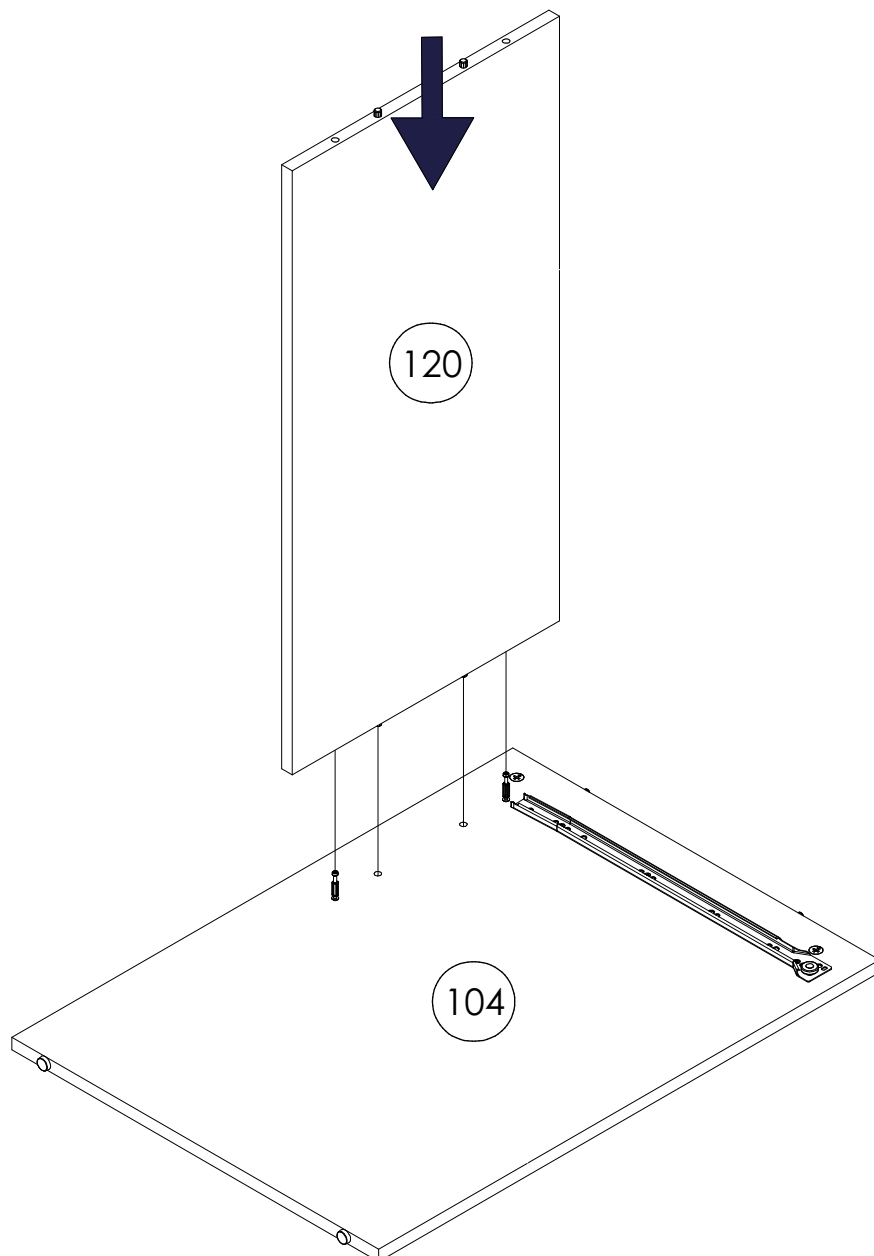

11

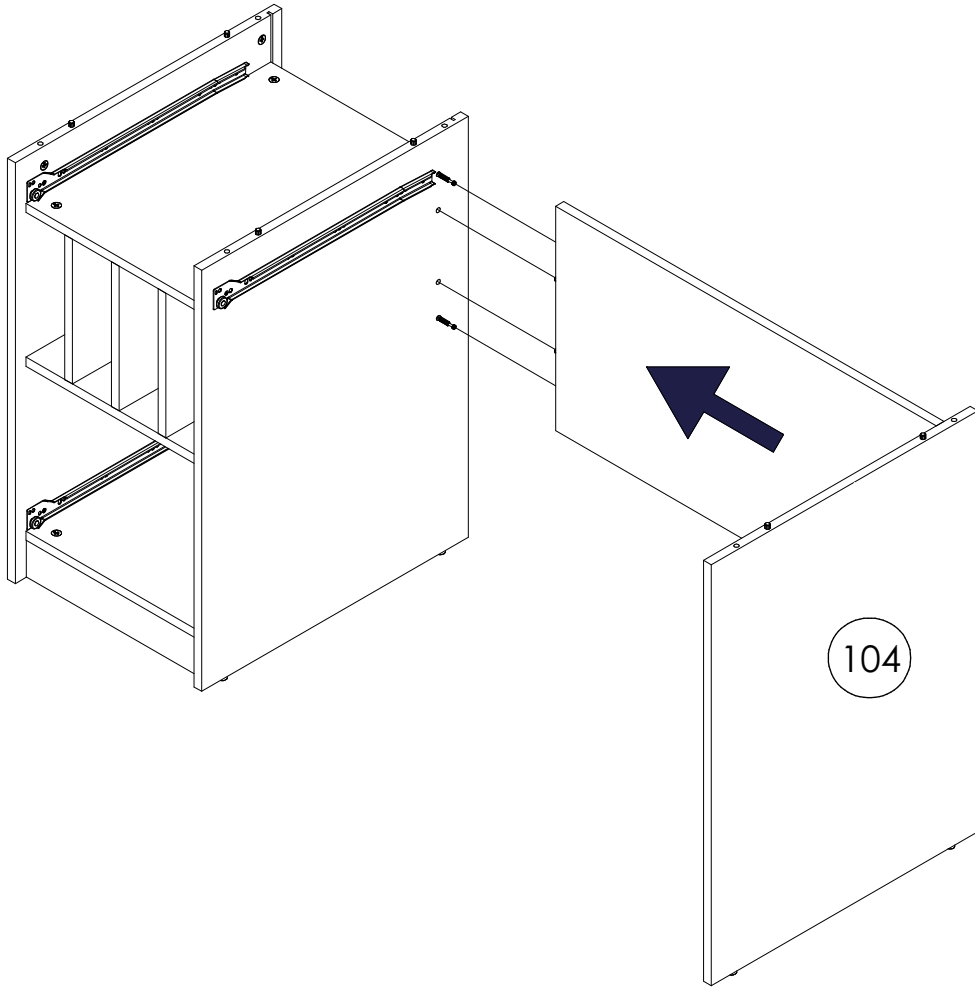

12

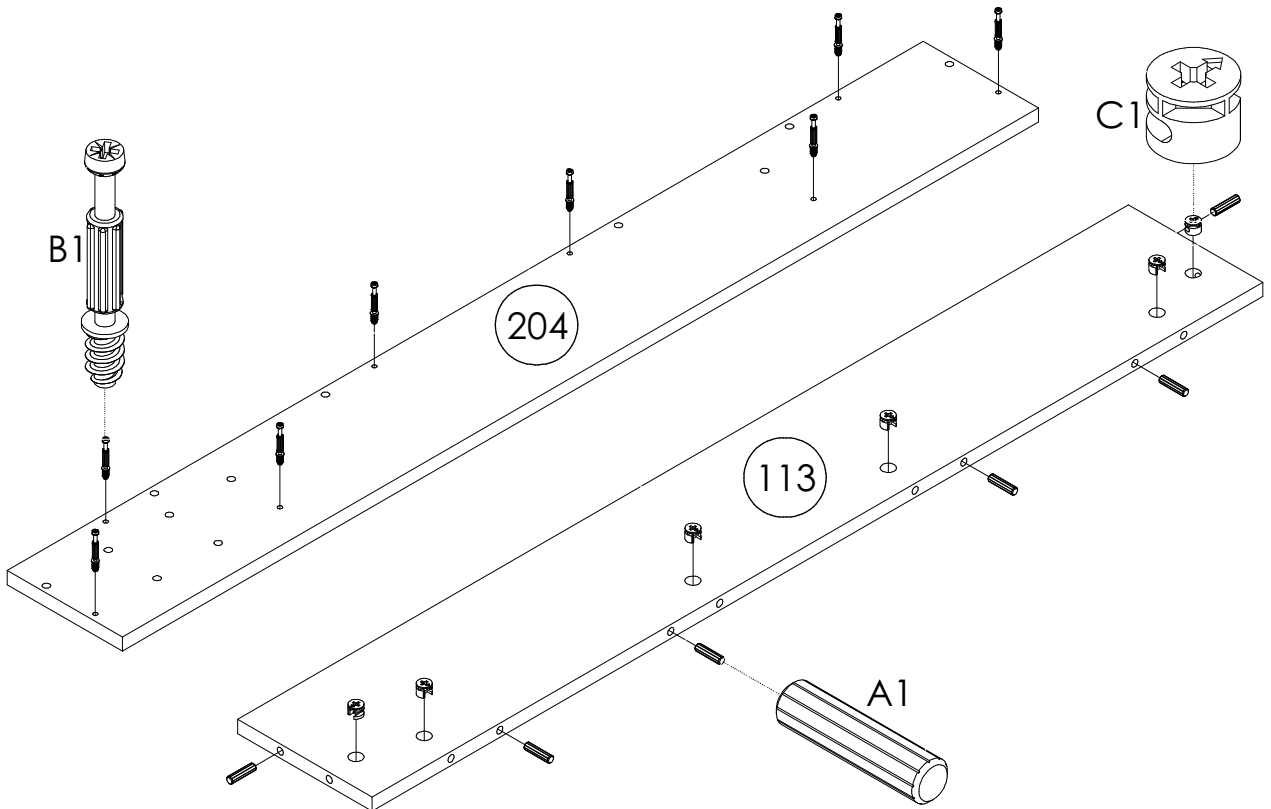

13

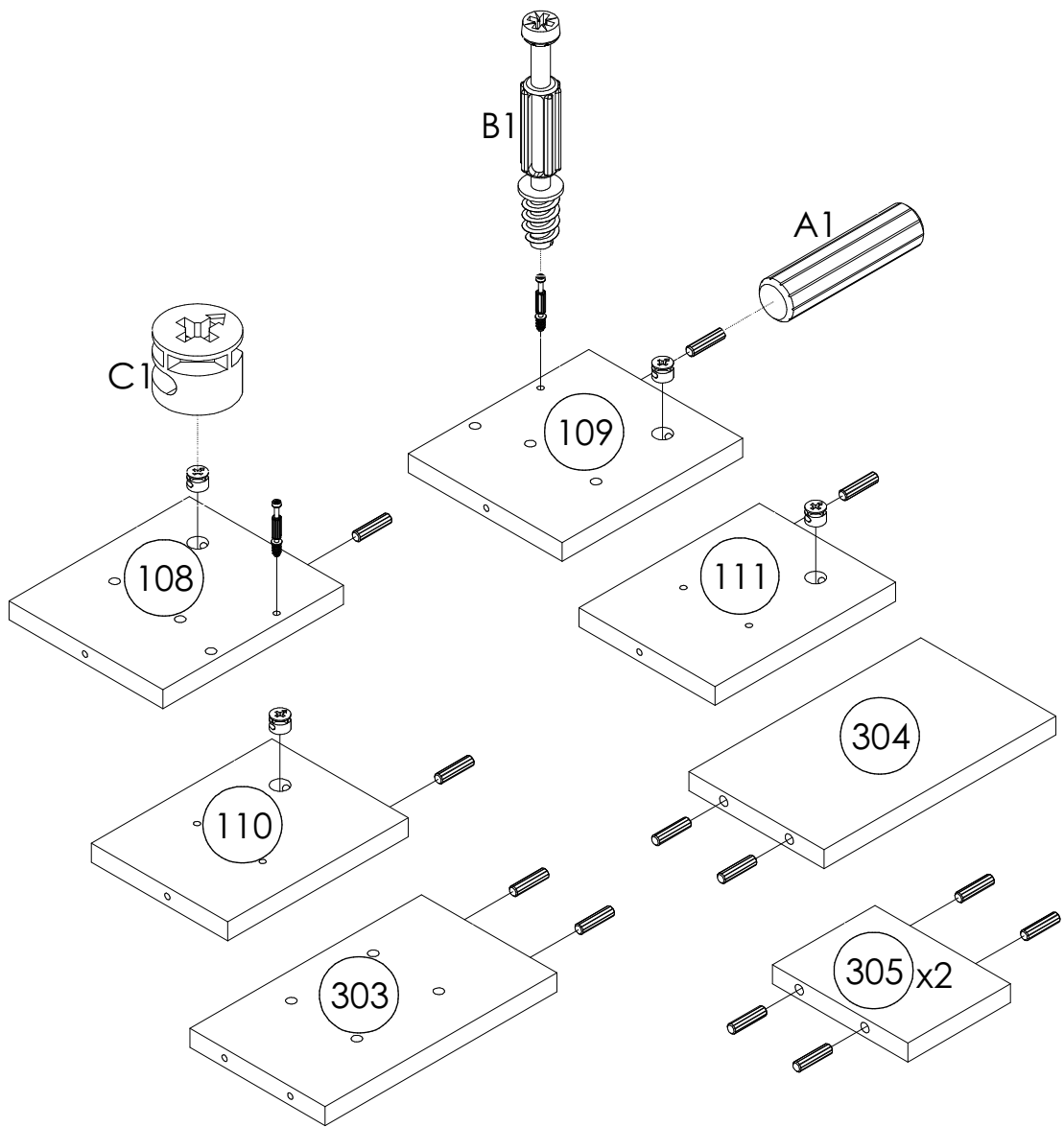

14

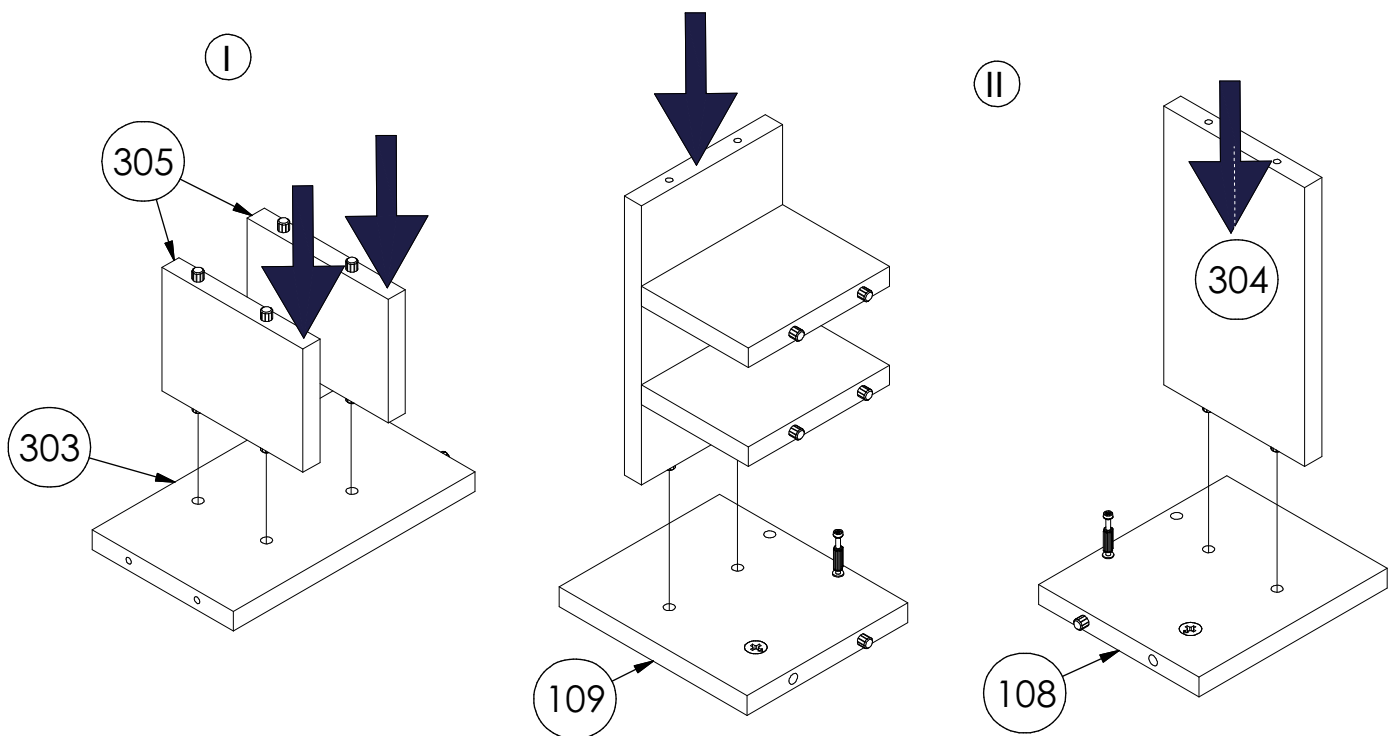

15

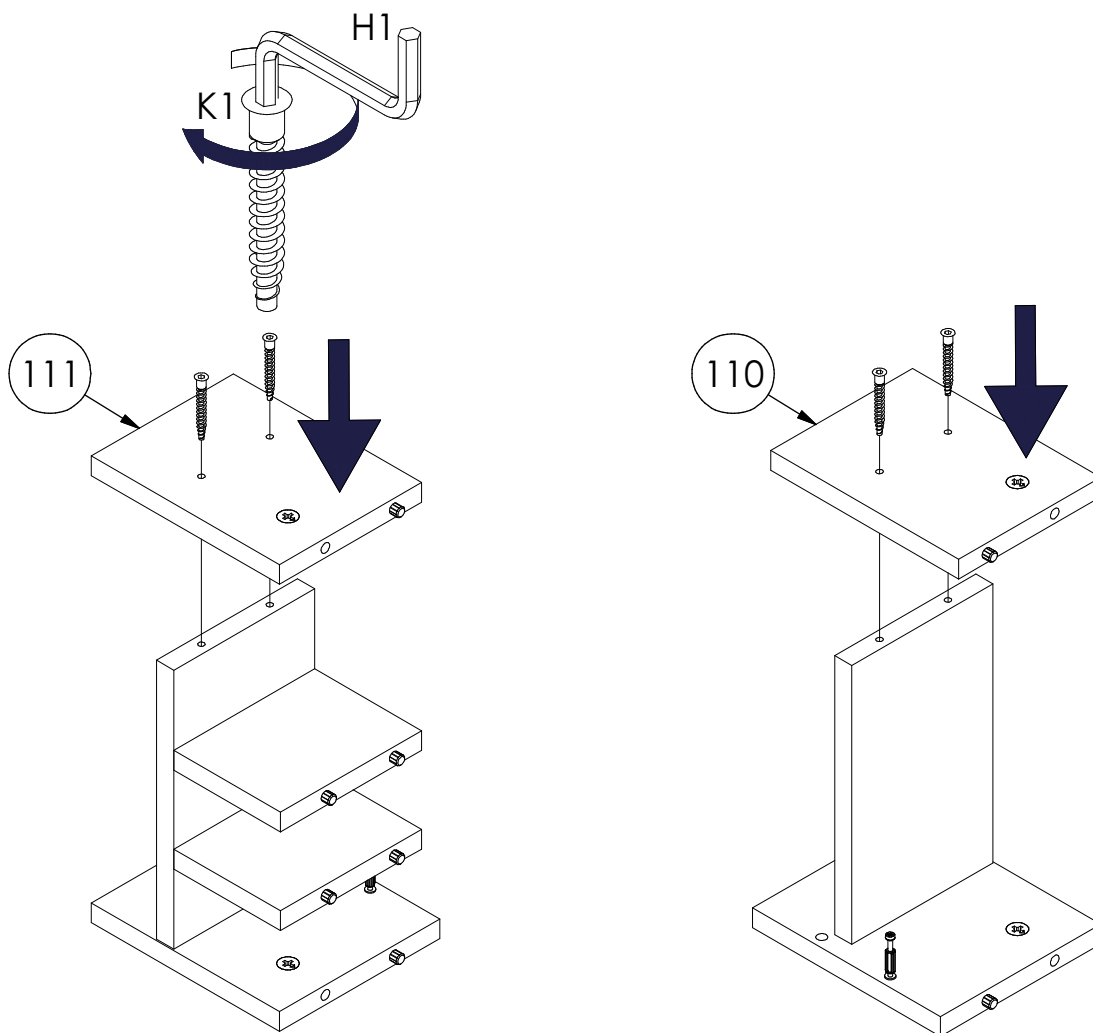

16

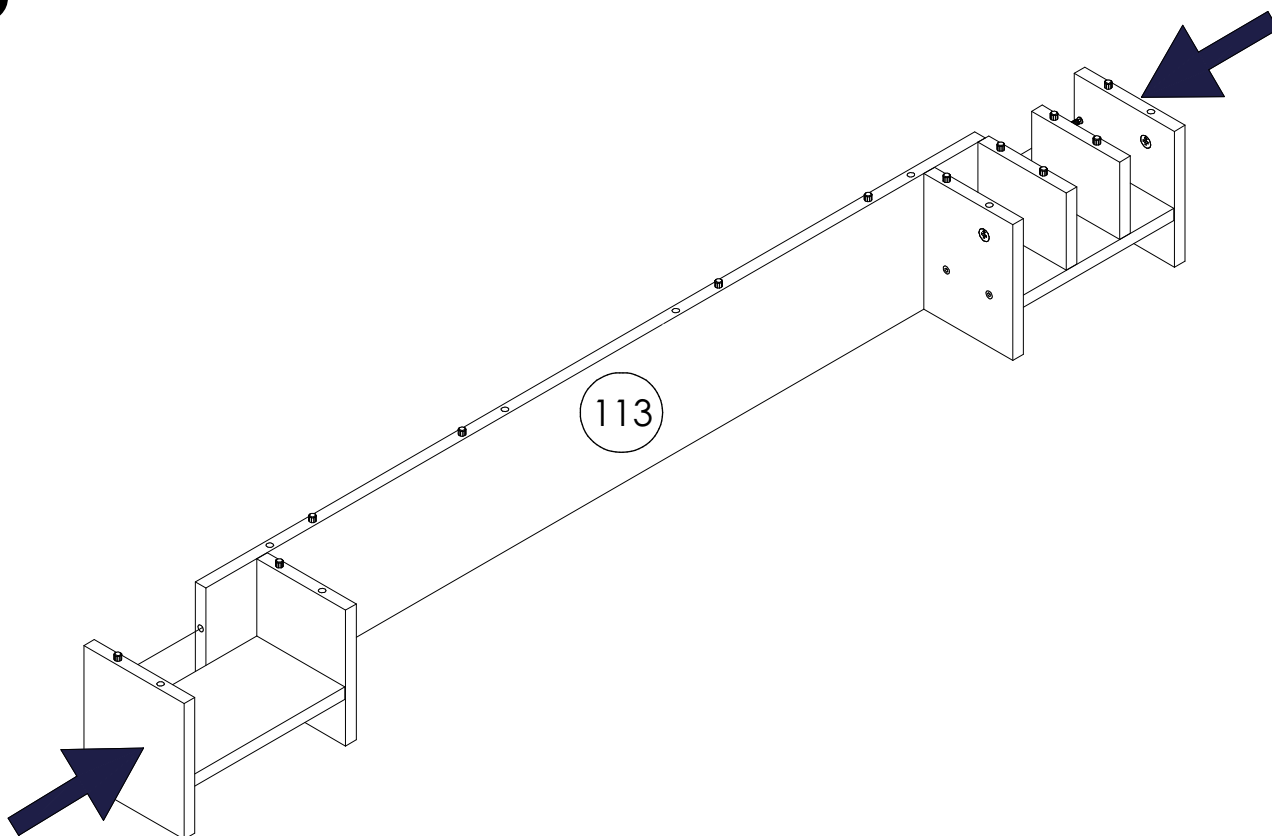

17

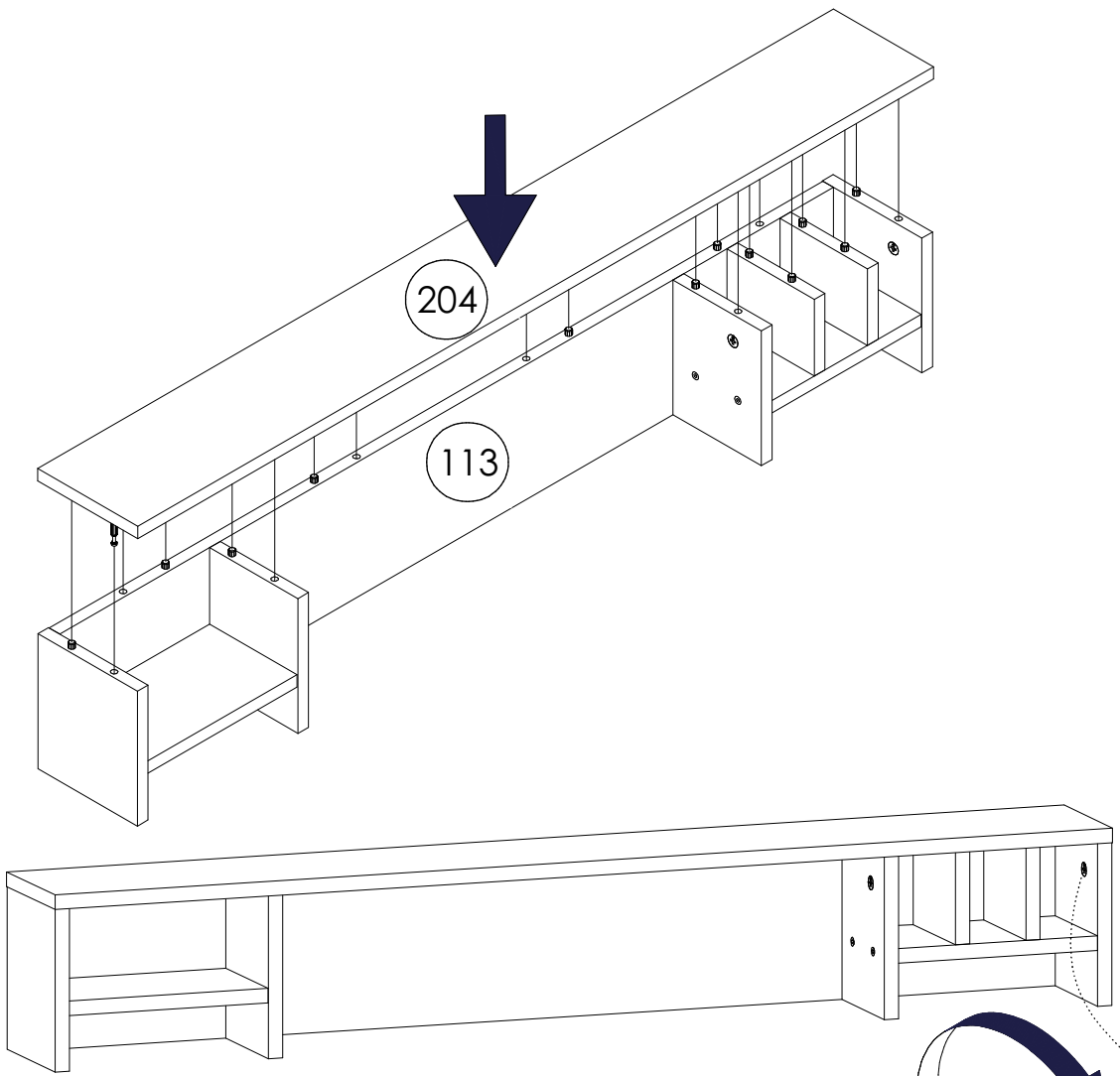

18

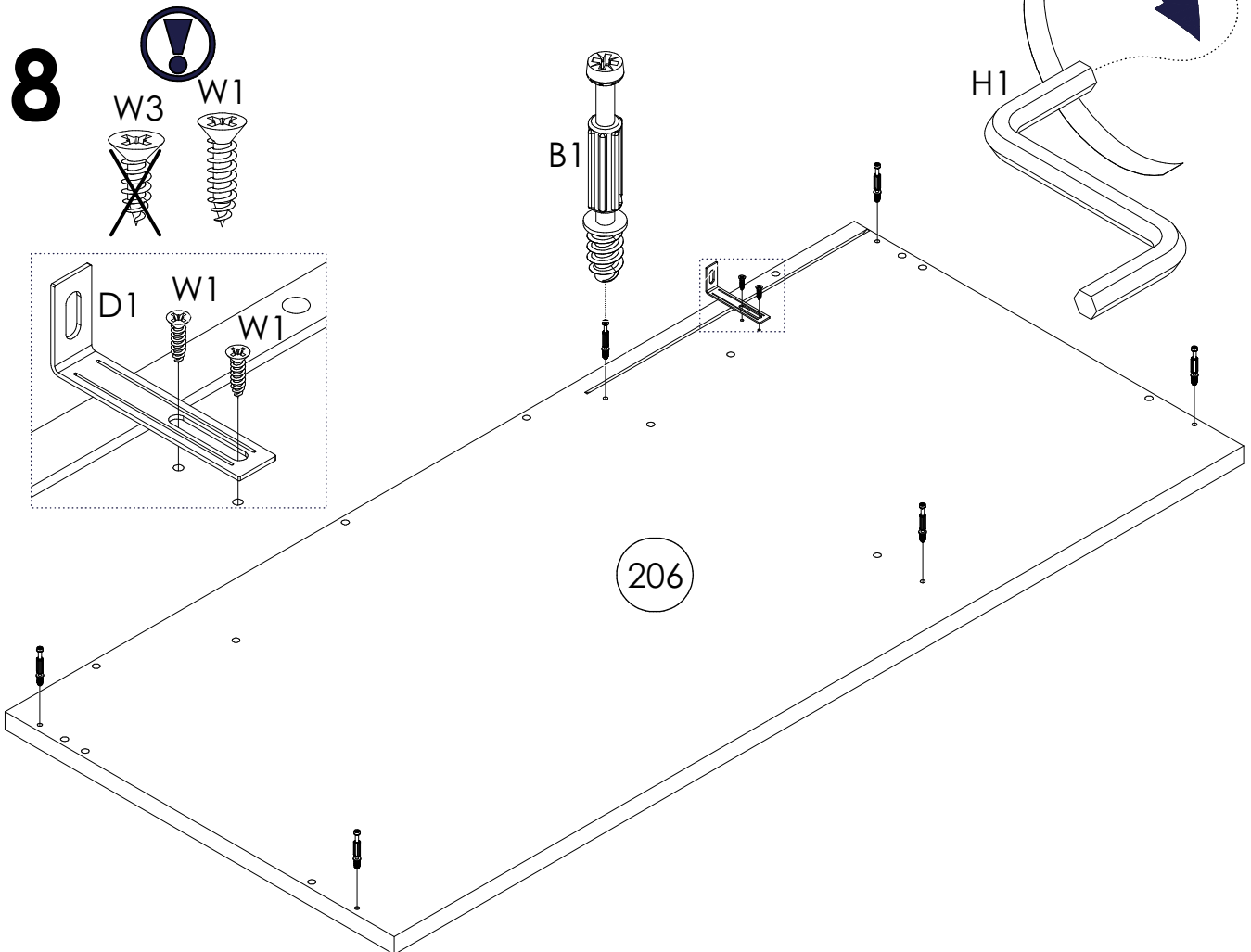

19

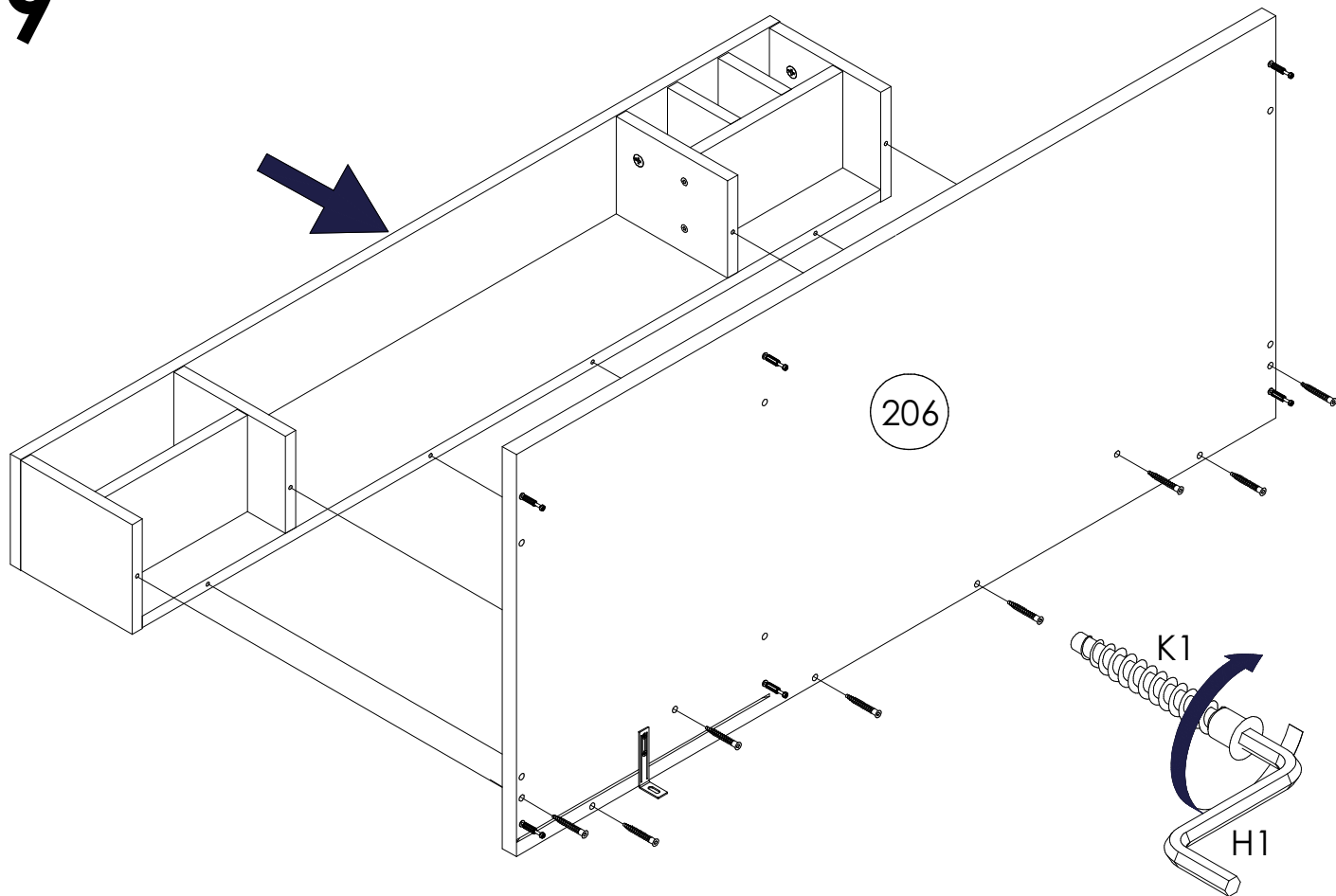

20

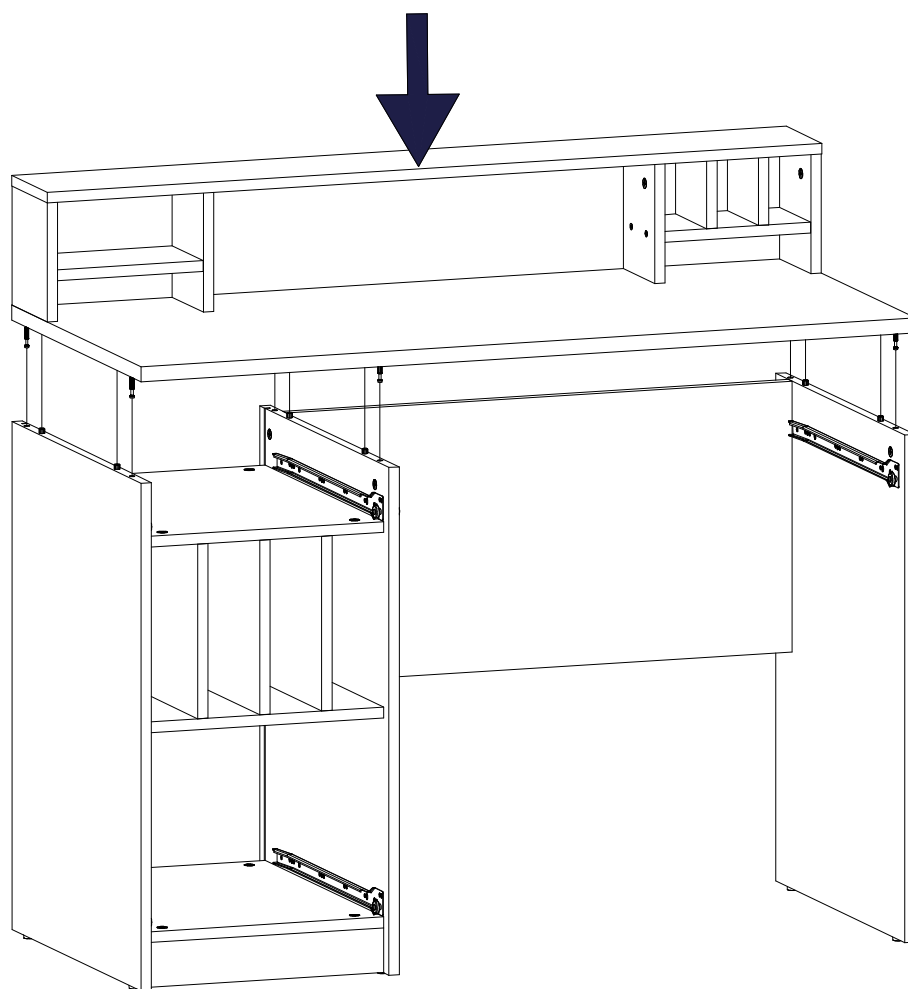

21

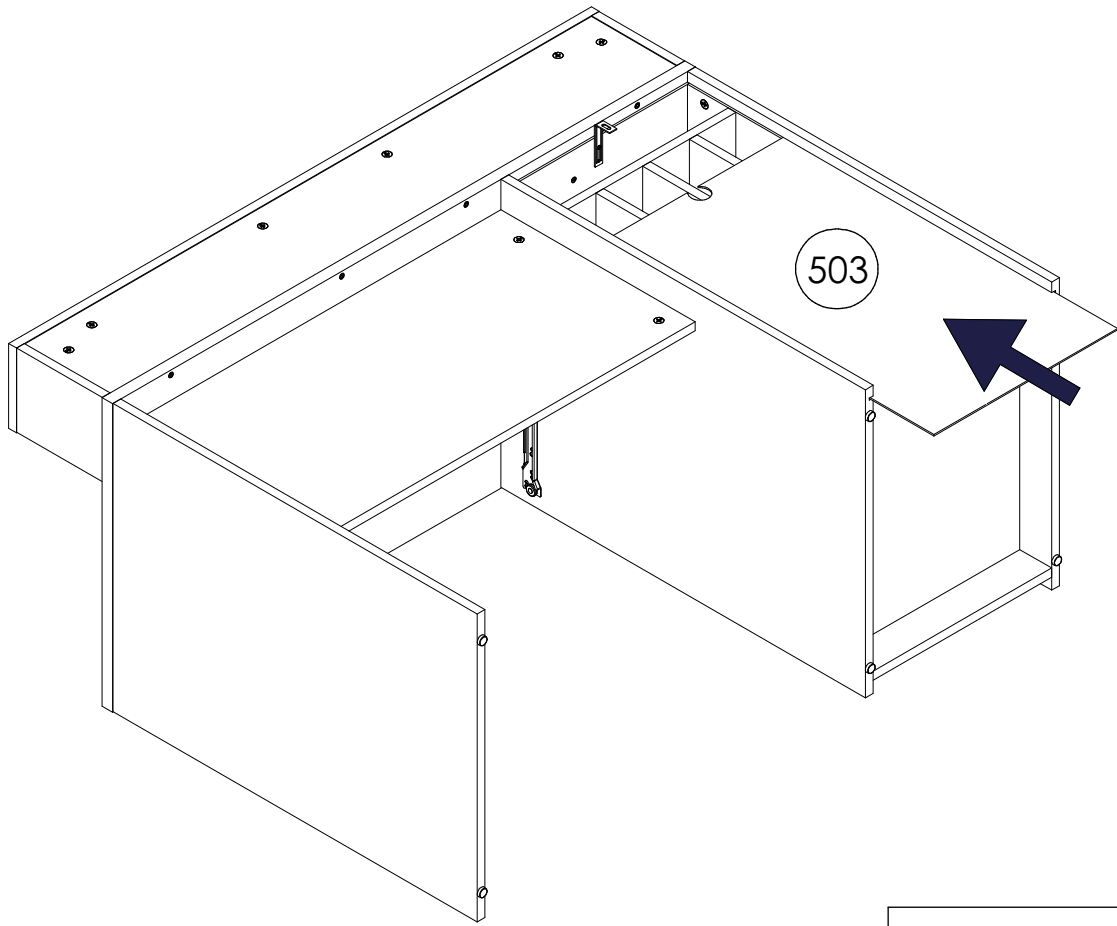

22

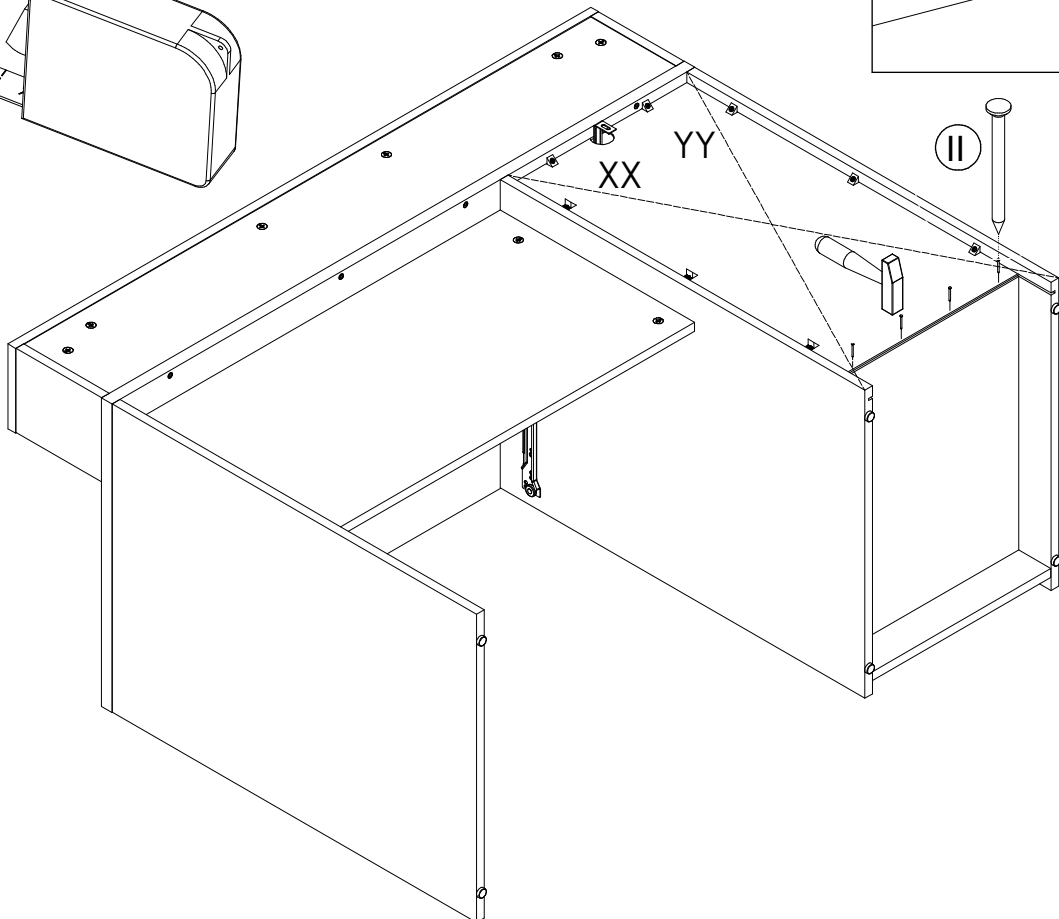
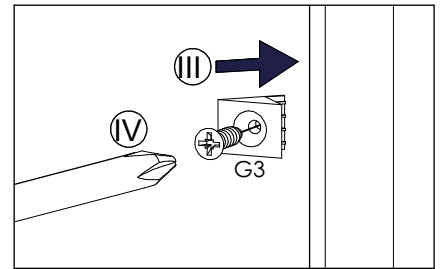
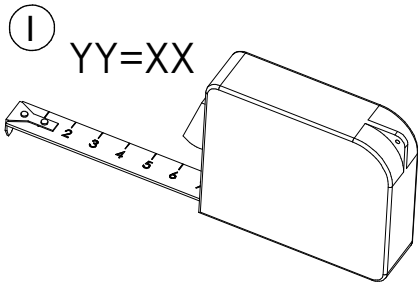

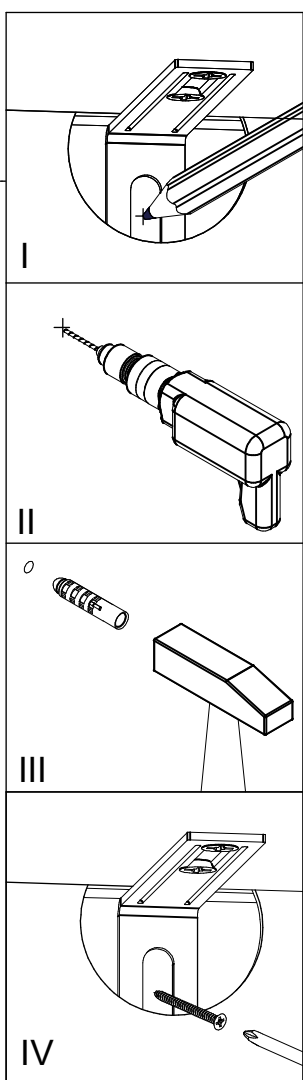
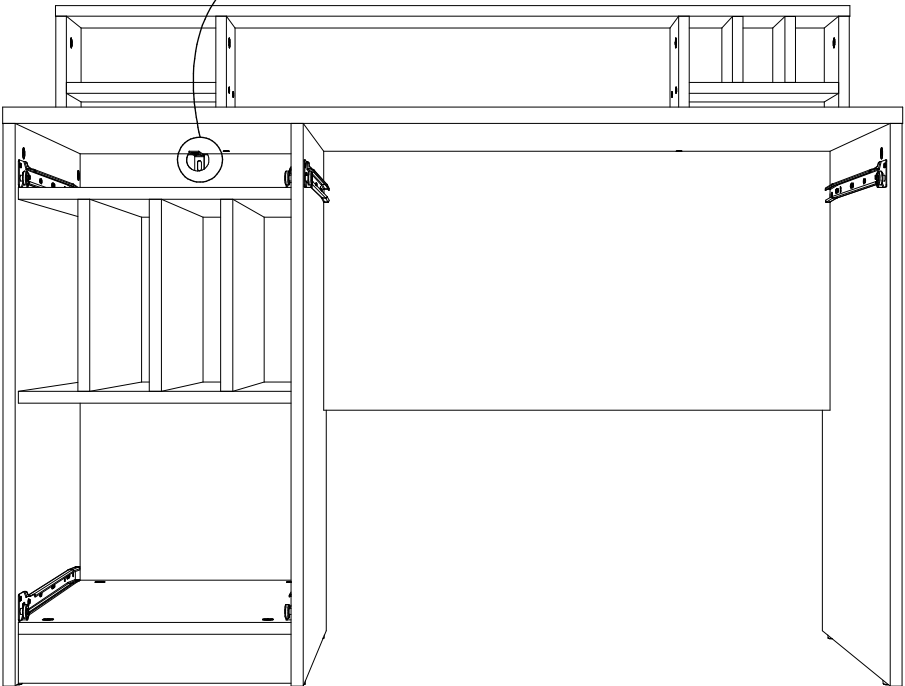
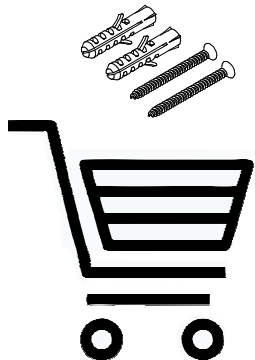



Achtung • Attention • Attenzione
Opgelet • Uwaga • Pozor • Figyelem
Atenție • Dikkat • Внимание



(D)	Wandbefestigung dient als Kippschutz – unbedingt anbringen! Bei einigen Wandtypen kann ein Spezialdübel erforderlich sein!
(GB)	The wall fastening serves to prevent tipping – be absolutely sure to mount it! For certain wall types, a special wall plug may be necessary!
(FR)	La fixation murale sert de protection contre le basculement – à installer impérativement ! Pour certains types de murs il faut des chevilles spéciales !
(IT)	Il fissaggio alla parete serve da protezione anti-ribaltamento – attaccarla assolutamente ! Per alcune strutture di parete può essere necessario un tassello speciale !
(NL)	Bevestiging aan de muur dient als kantelbescherming – zeker en vast bevestigen ! Bij enkele muurtypes is een speciale plug misschien vereist !
(PL)	Mocowanie do ściany jest jednocześnie zabezpieczeniem przed przewróceniem – koniecznie zamontować! Do niektórych rodzajów ścian koniecznie zastosować specjalne kołki mocujące.
(CZ)	Montáž na stěnu slouží jako ochrana proti převrnutí – bezpodmienečně umístěte! Uněkterých typů stěn může být zapotřebí speciální hmoždinka !
(SK)	Upevnenie na stenu slúži ako ochrana proti prevráteniu – bezpodmienečne použite! Pre niektoré druhy stien môže byť potrebná špeciálna hmoždenka !
(HU)	A terméket a falhoz kel rögzíteni, különben az felborulhat! Egyes faltípusoknál speciális tiplit kell használni !
(RO)	Sistemul de fixare la perete servește ca protecție la răsturnare – de montat obligatoriu! Pentru unele tipuri de pereți este posibil să fie necesar un diblu special !
(TR)	Duvardaki sabitleme, devrilmeye karşı bir emniyet tedbiridir ve mutlaka monte edilmelidir! Bazı duvar tiplerinde bunun için özel bir düble gerekli olabilir !
(RU)	Обязательно установите крепление на стене во избежание опрокидывания ! Для некоторых типов стен может потребоваться специальный дюбель !

24

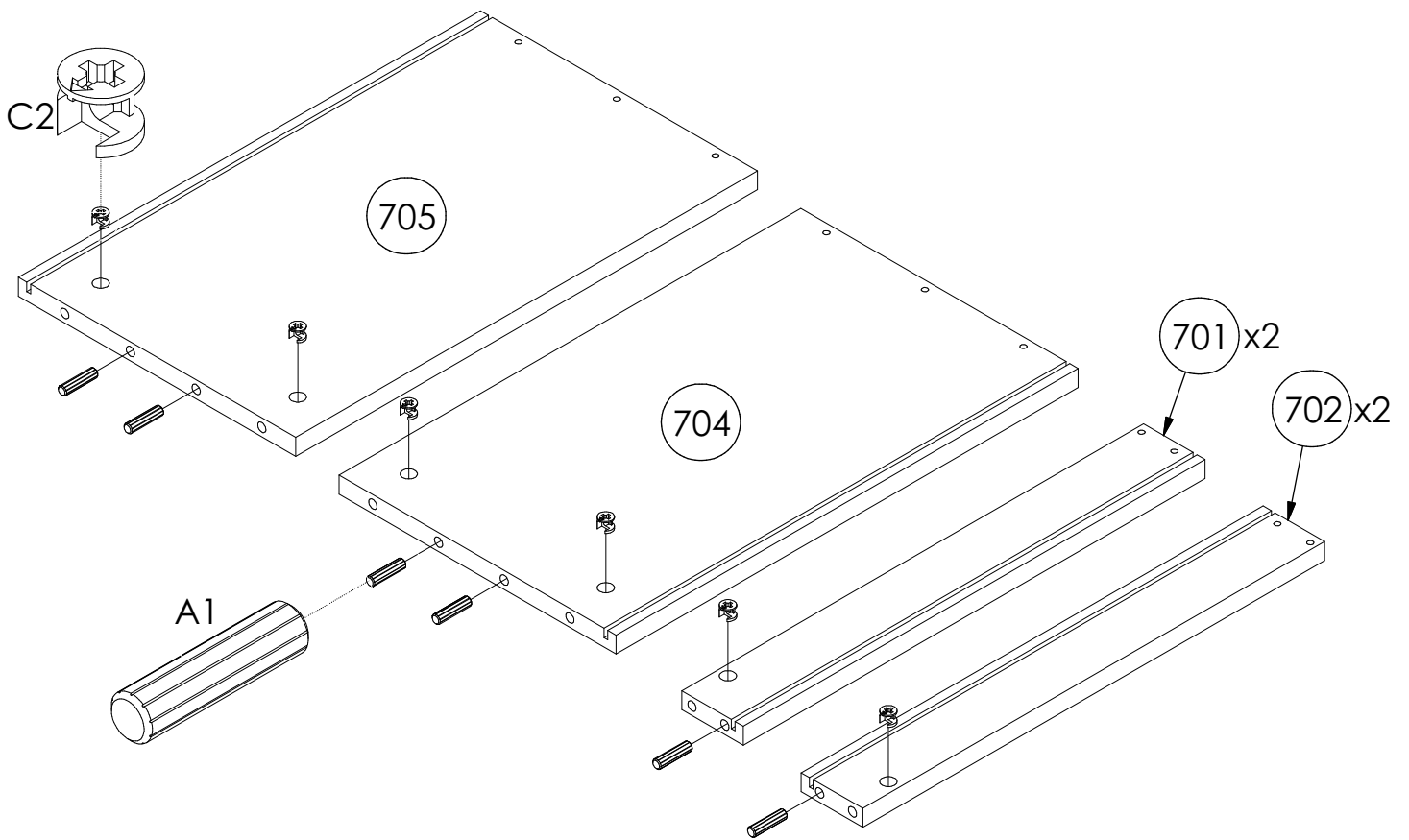

25

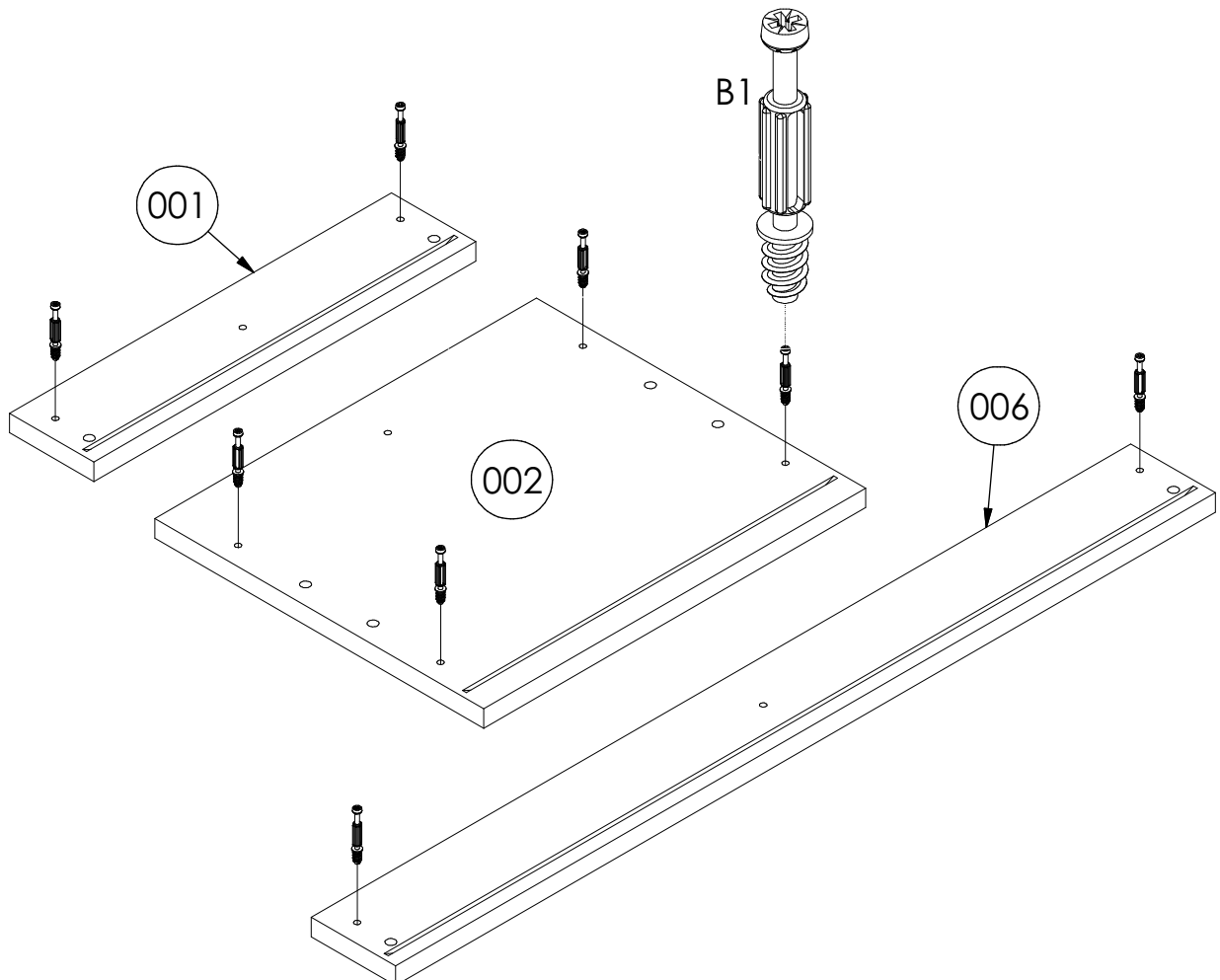

26

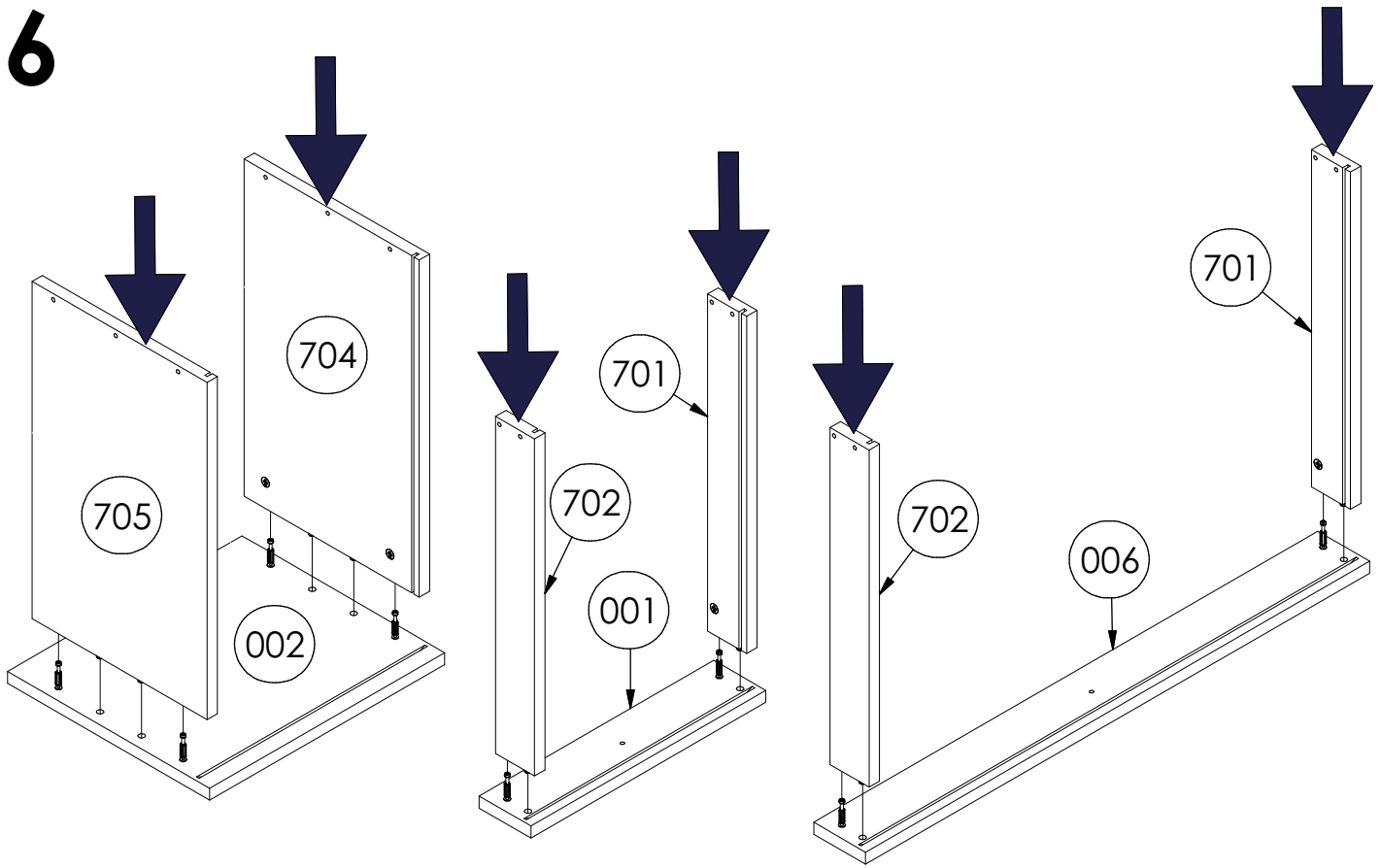

27

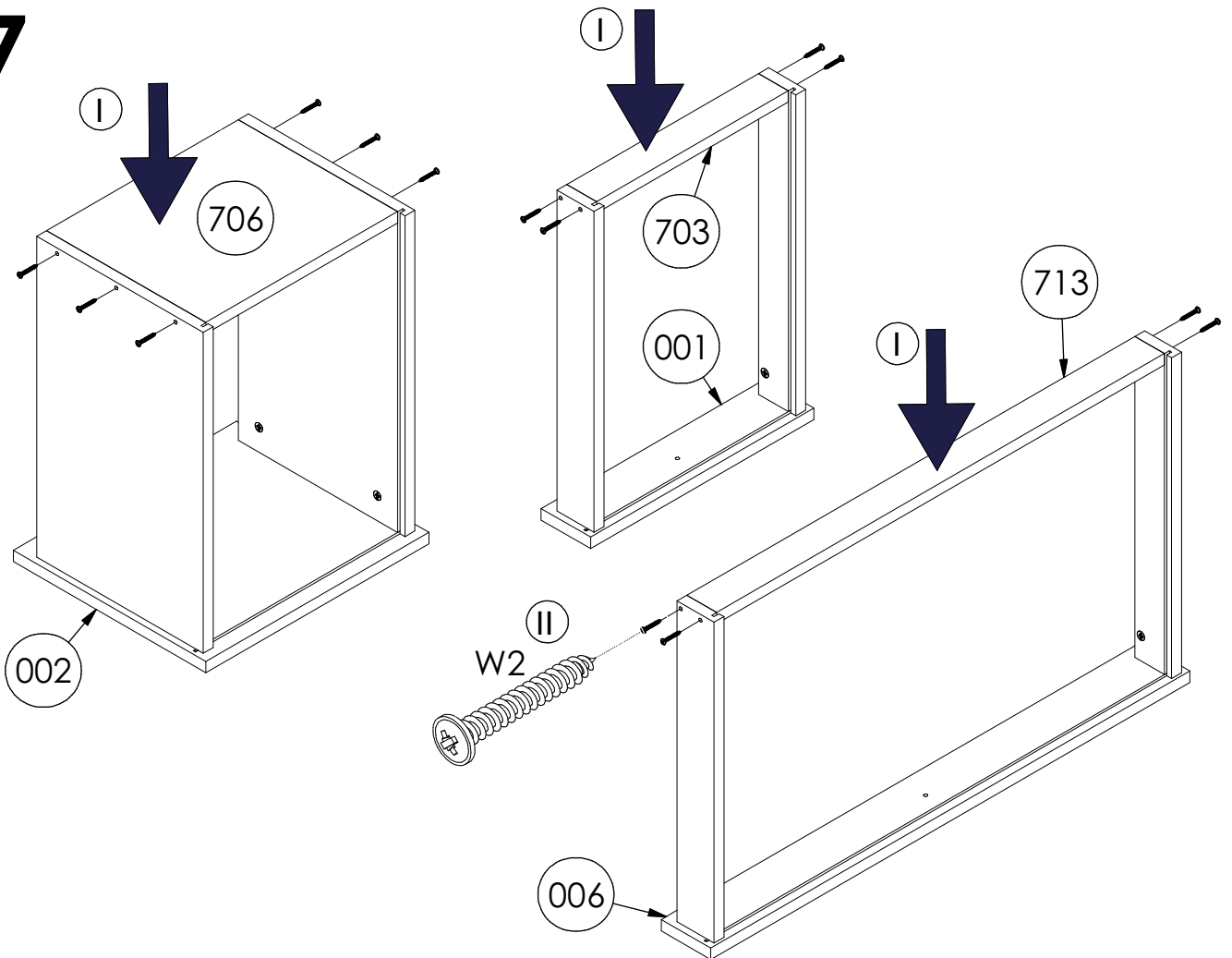

28

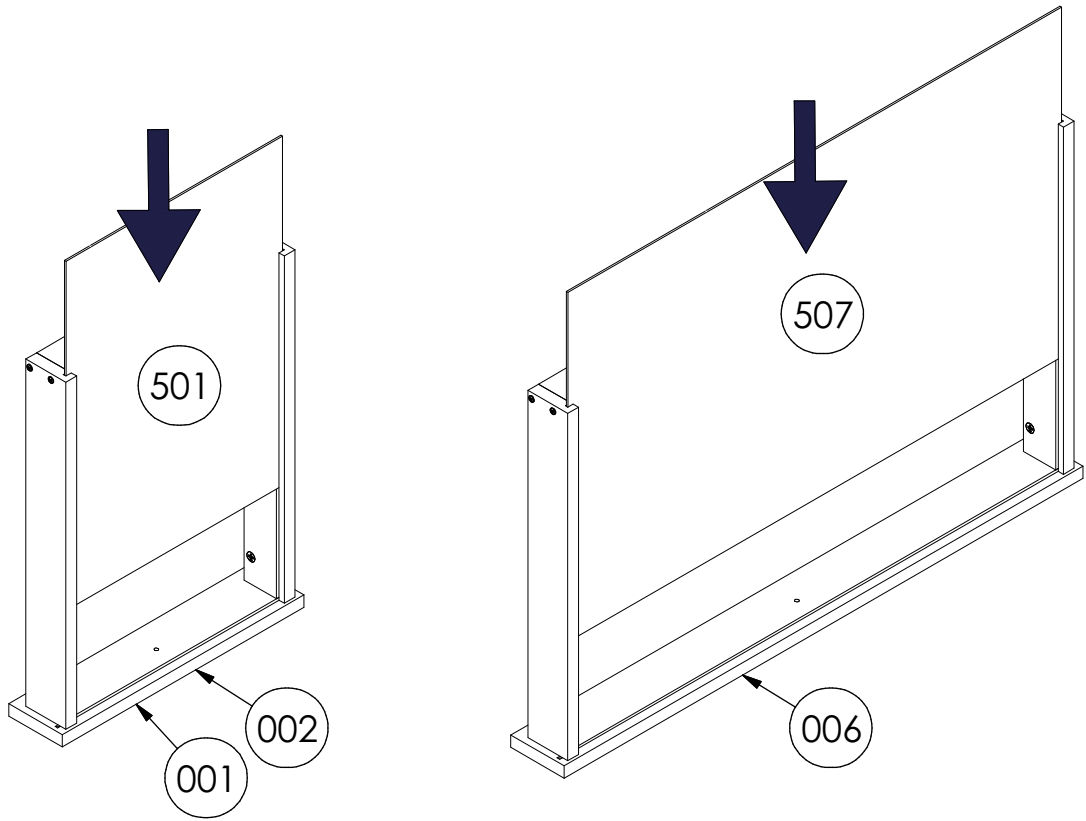

29

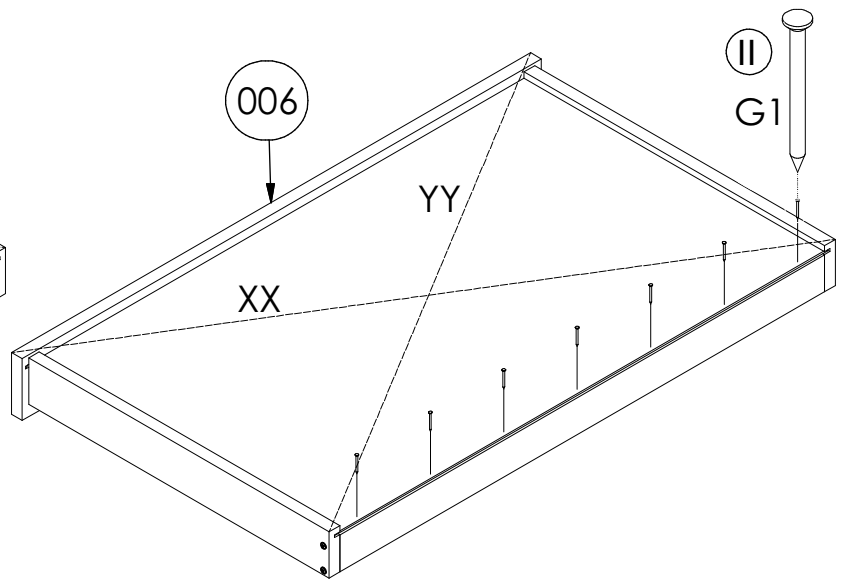
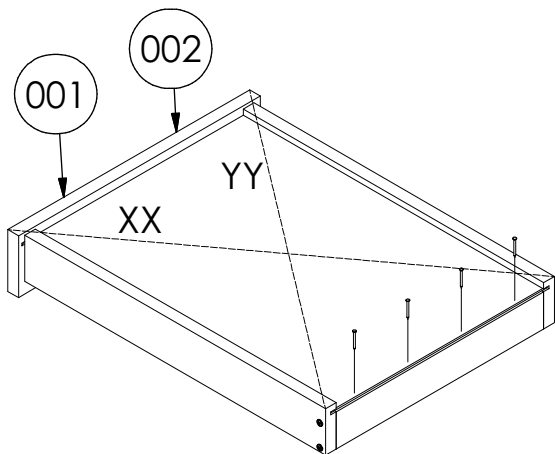
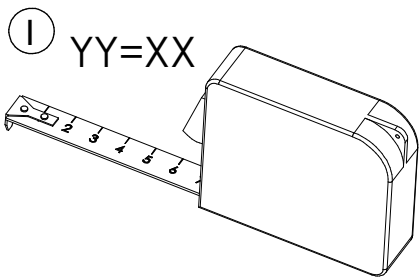

30

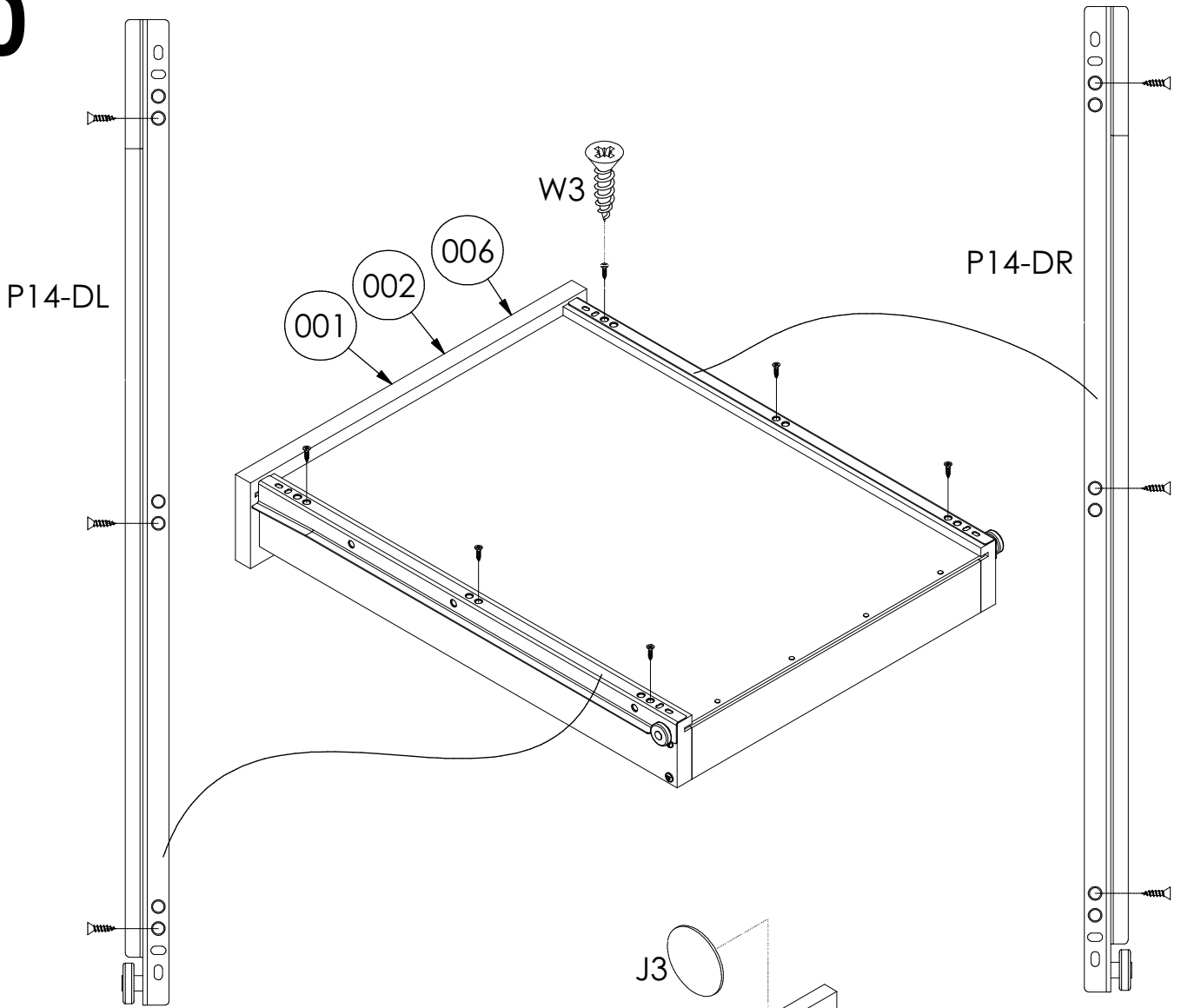

31

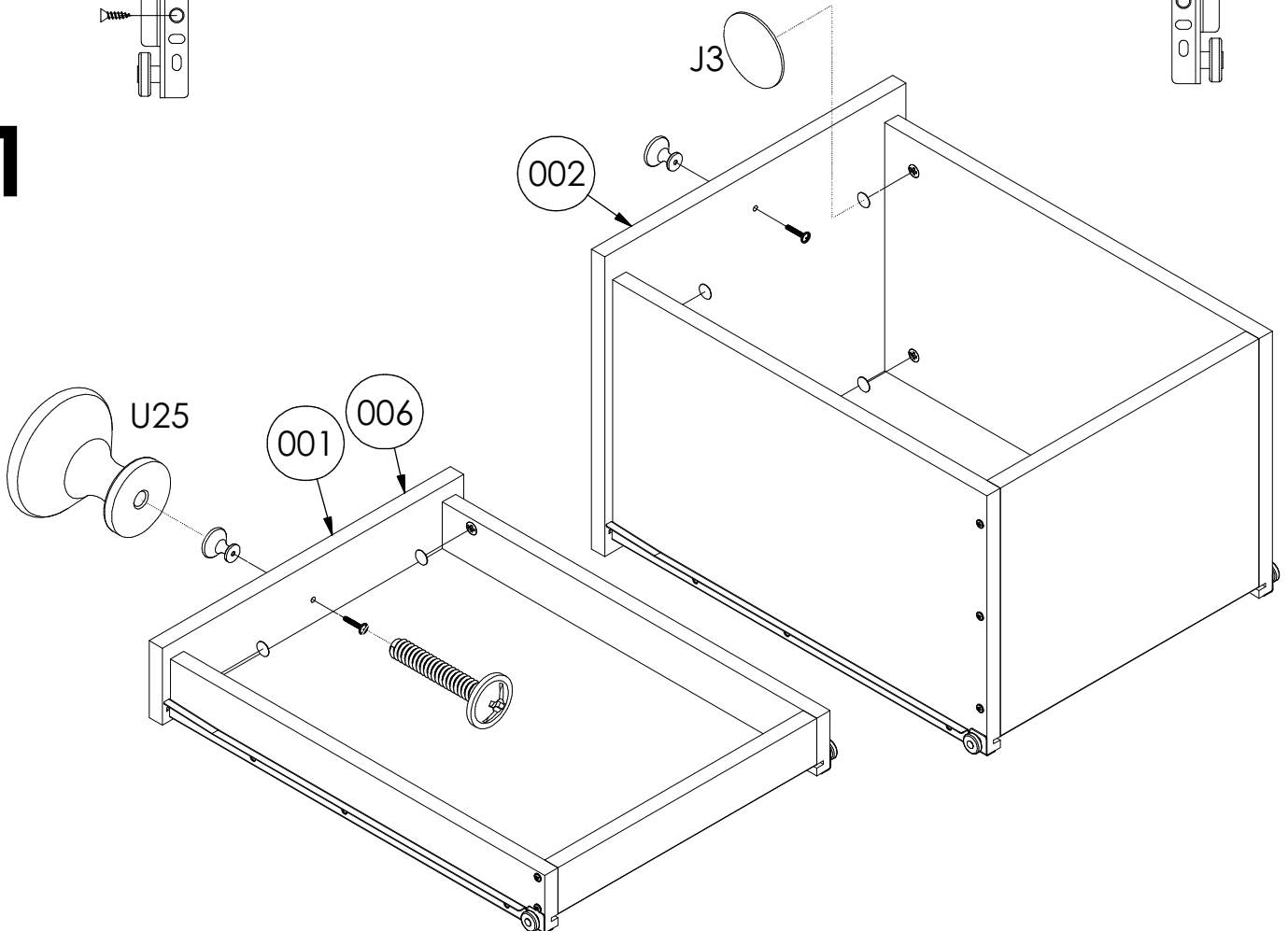

32

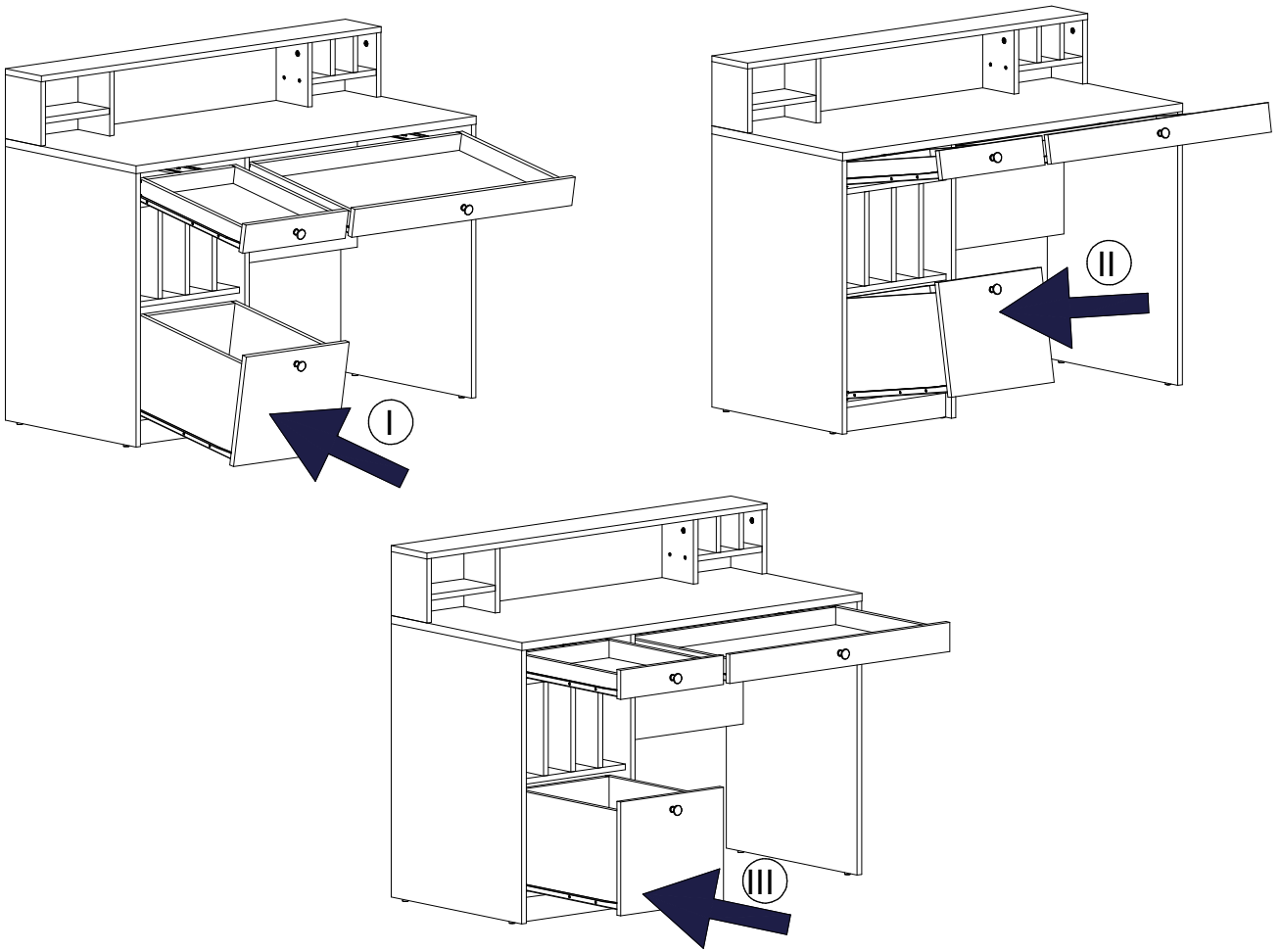

33

