

**SPECIFICATION:**

Operating Voltage (Max.): 60 Vdc  
 Operating Current (Max.): 24 A  
 Operating Temperature: -10°C to 70°C  
 Measuring Category: 0

**MATERIAL:**

Material (Housing): ABS  
 Material (Contact Area): brass, nickel plated

**HANDLING:**

Terminal: screw

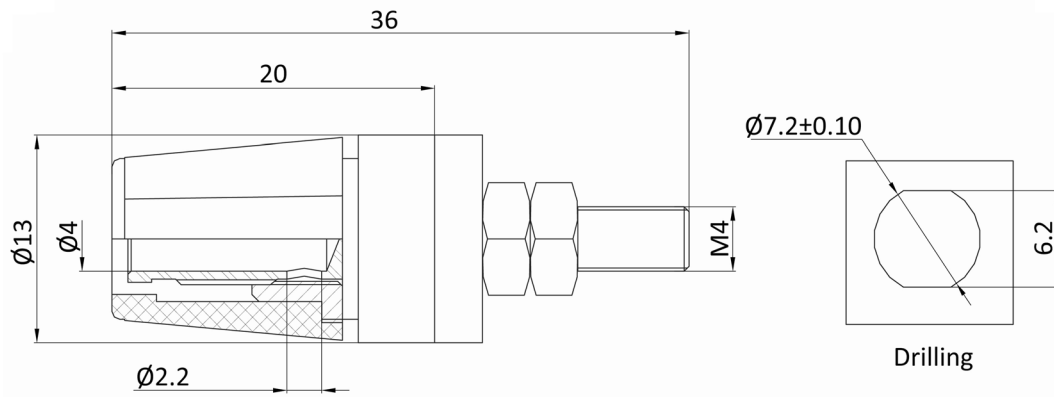

**Order Information**

Identifier:

PKI40

Colour:

#

Binding post 4 mm insulated

SW: black

RT: red

BL: blue

GE: yellow

GN: green