

# ***Ariete***

Air Fryer

**QUICK GUIDE**



**Mod. 4631**





Leggere sempre le Avvertenze di sicurezza prima di utilizzare l'apparecchio. Per maggiori informazioni sul funzionamento dell'apparecchio, consultare le Istruzioni per l'uso.



Always read the Safety warnings before using the appliance. For further information about the appliance operation, read the Instructions for use.



Lisez toujours les Consignes de sécurité avant d'utiliser l'appareil. Pour plus d'informations sur le fonctionnement de l'appareil, reportez-vous au mode d'emploi.



Lesen Sie vor der Verwendung des Geräts immer die Sicherheitshinweise. Weitere Informationen über die Bedienung des Geräts finden Sie in der Gebrauchsanweisung.



Lea siempre las advertencias de seguridad antes de utilizar el aparato. Para obtener más información sobre el funcionamiento del aparato, consulte las Instrucciones de uso.



Ler sempre as advertências de segurança antes de utilizar o aparelho. Para mais informações sobre o funcionamento do aparelho, consultar as instruções de uso.



Lees altijd de veiligheidswaarschuwingen door alvorens het apparaat te gebruiken. Raadpleeg de gebruiksaanwijzing voor meer informatie over het gebruik van het apparaat.



Πριν χρησιμοποιήσετε τη συσκευή, διαβάζετε πάντα τις προειδοποιήσεις ασφαλείας. Για περισσότερες πληροφορίες σχετικά με τη λειτουργία της συσκευής, συμβουλευθείτε τις οδηγίες χρήσης.



Перед использованием прибора обязательно ознакомьтесь с правилами техники безопасности. Для получения дополнительной информации о работе прибора обратитесь к руководству по эксплуатации.



اقرأ تحذيرات السلامة دائماً قبل استعمال الجهاز. للحصول على المزيد من المعلومات حول عمل الجهاز، يجب الاطلاع على تعليمات الاستخدام.



Перед початком використання приладу обов'язково ознайомтеся з правилами техніки безпеки. Для отримання додаткової інформації про роботу приладу ознайомтеся з посібником з експлуатації.



Przed przystąpieniem do obsługi urządzenia należy zawsze zapoznać się z ostrzeżeniami dotyczącymi bezpieczeństwa. Więcej informacji na temat obsługi urządzenia można znaleźć w instrukcji obsługi.



Læs altid sikkerhedsadvarslerne inden brug af apparatet. Vedrørende yderligere oplysninger om apparatets funktion henvises til brugsanvisningen.

IT

EN

FR

DE

ES

PT

NL

EL

RU

AR

UA

PL

DA

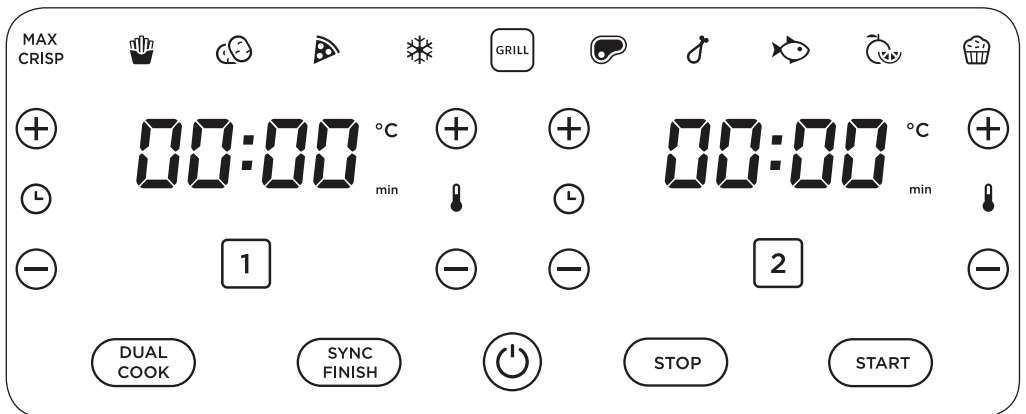
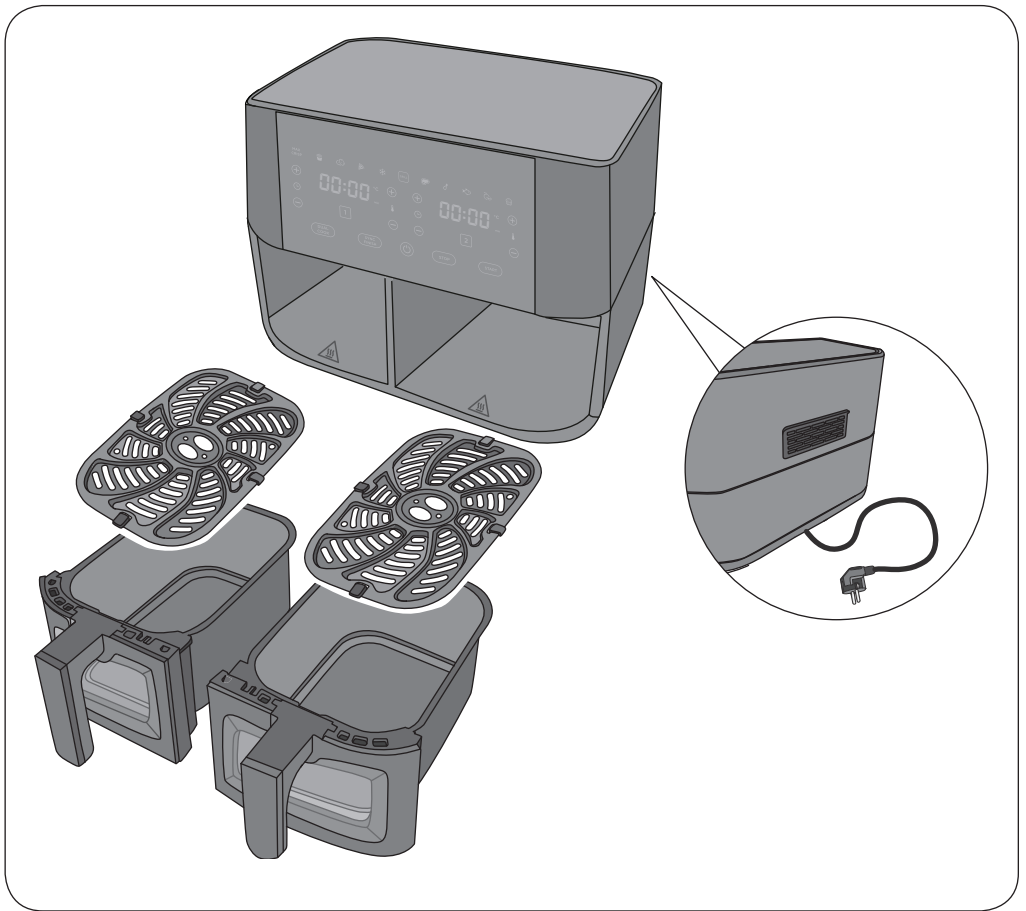



Operazioni preliminari | Preliminary operations | Opérations préliminaires | Erste Schritte | Operaciones preliminares | Operações preliminares | Voorbereidende werkzaamheden | Προκαταρκτικές ενέργειες | Предварительные операции | العمليات الأولية | Підготовчі дії | Czynności wstępne | Forberedelser

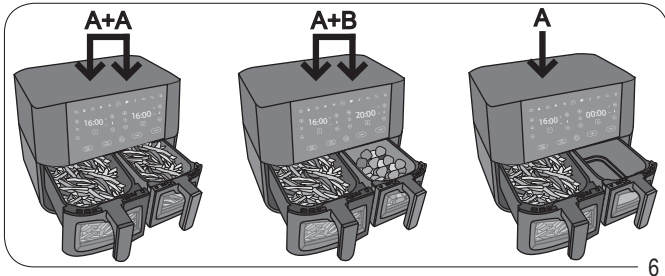
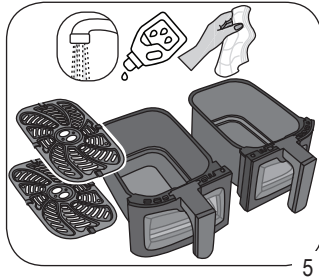
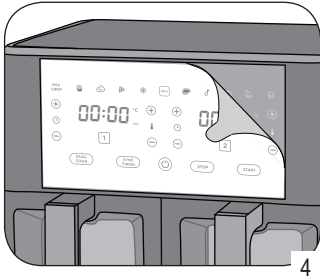
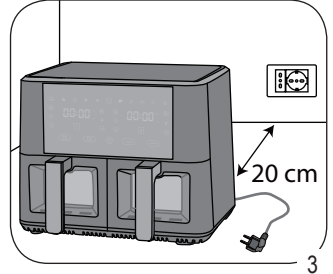
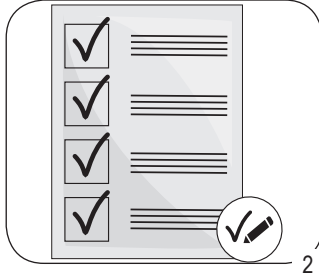
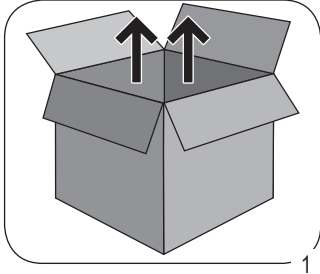



Cottura singola | Single cooking | Cuisson simple | Einzelgaren | Cocción única | Cozedura com um cesto | Gebrauch van de enkele mand | Μονό ψήσιμο | Одинокое приготовление | طهي فردي | Одинарне приготування | Smażenie pojedyncze | Tilberedning med enkelt kurv

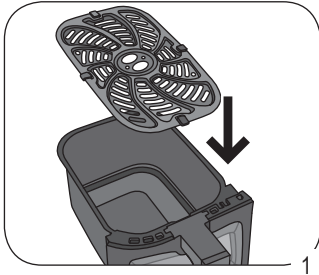

1



2

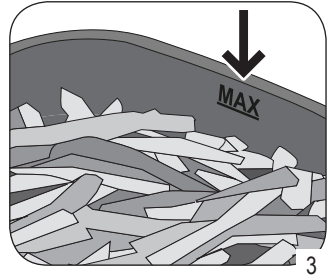

3

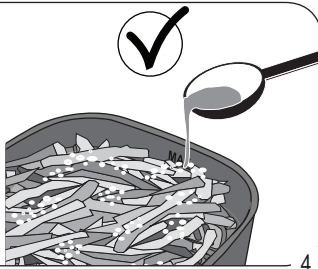
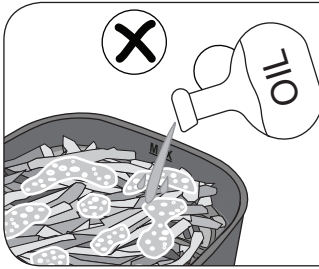

4

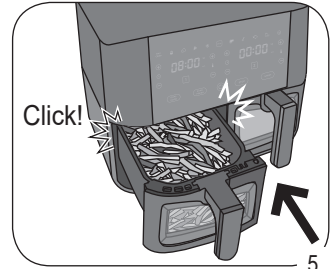

5

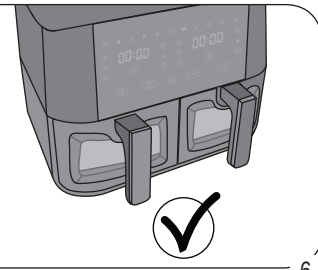
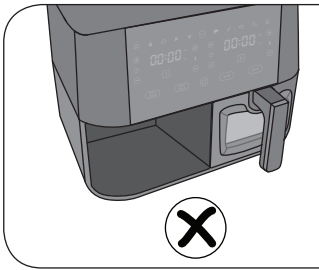

6

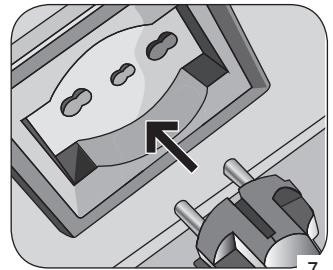

7

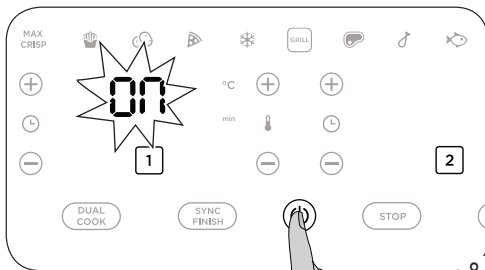

8

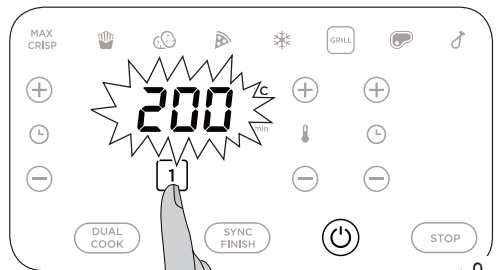

9

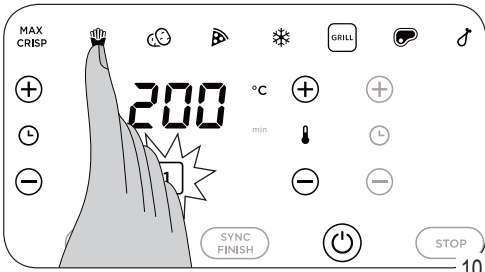

10

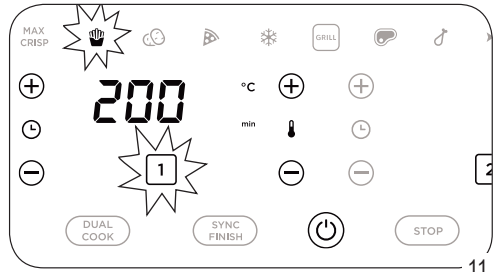

11



12

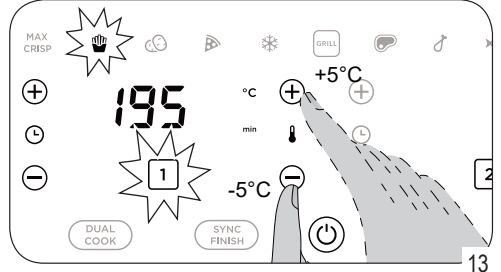

13



14

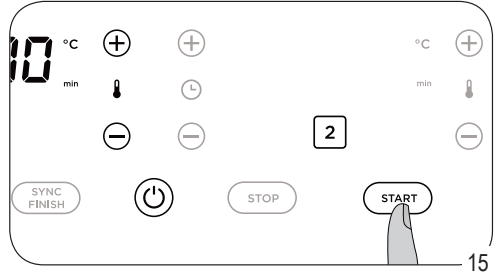

15

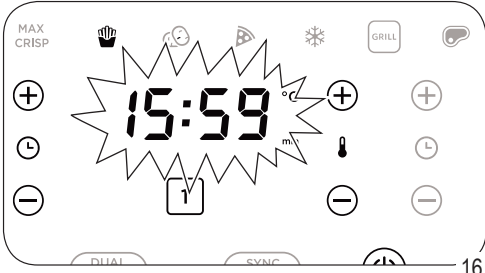

16

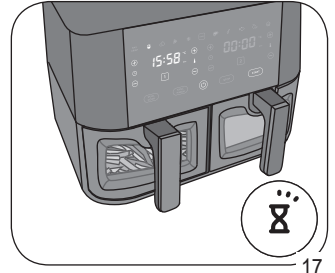

17



18

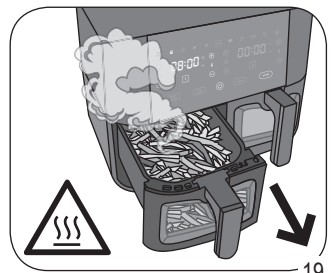

19

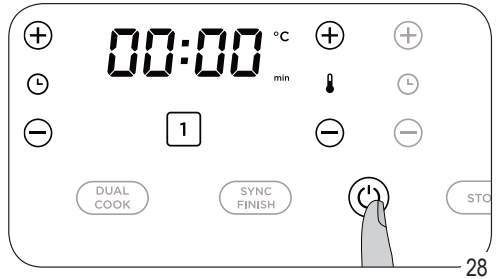
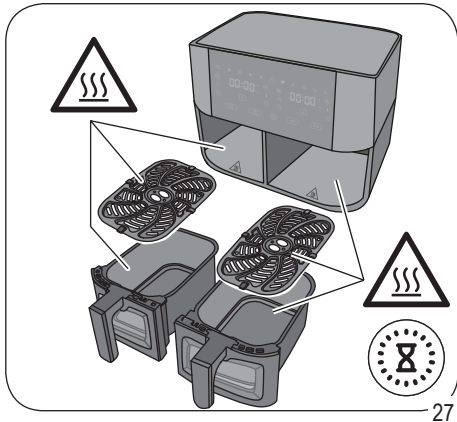
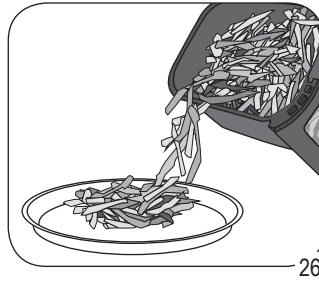
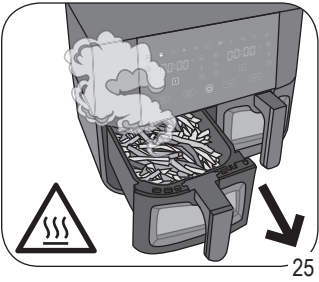
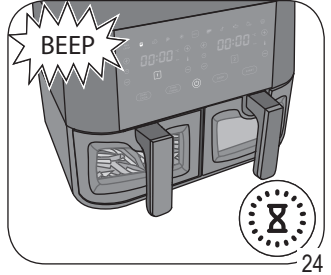
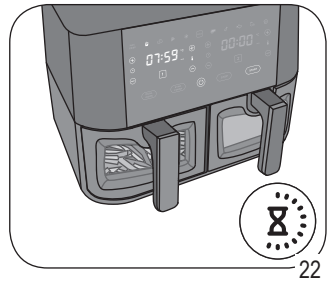
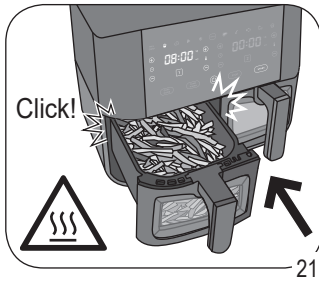





Doppia cottura | Dual cooking | Double cuisson | Doppeltgaren | Cocción doble | Cozedura com dois cestos | Gebruik van de dubbele mand | Διπλό ψήσιμο | Двойное приготовление | الطهي المزدوج | Подвійне приготування | Smażenie podwójne | Tilberedning med to kurve

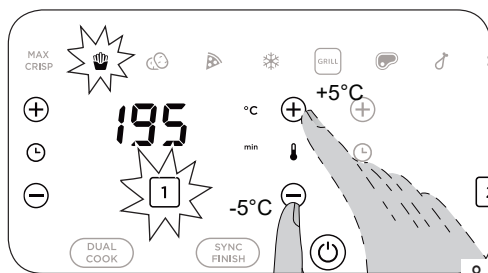
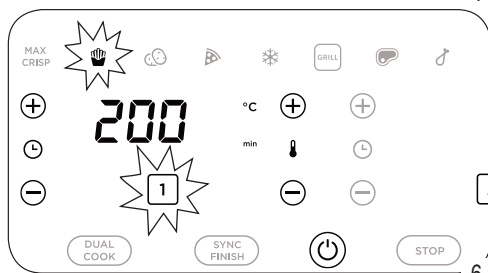
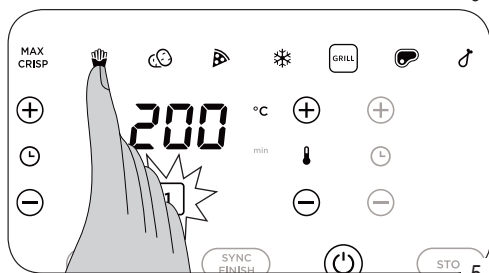
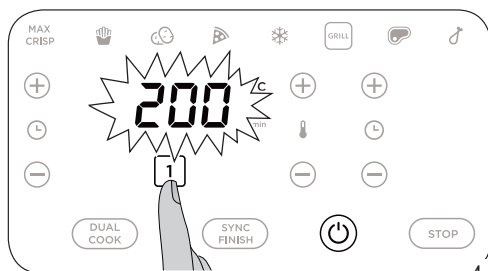
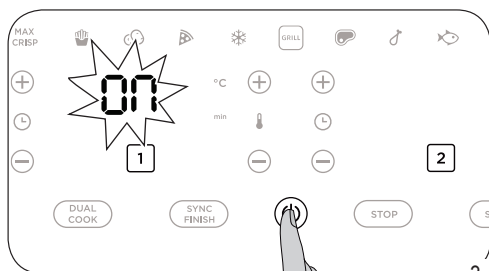
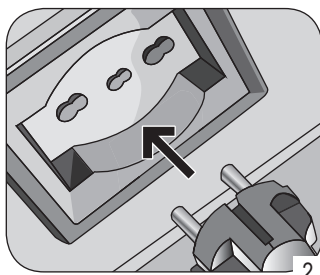
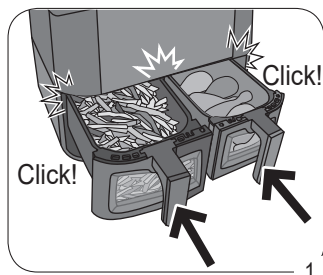



9

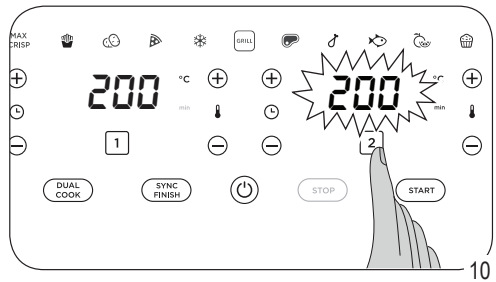

10

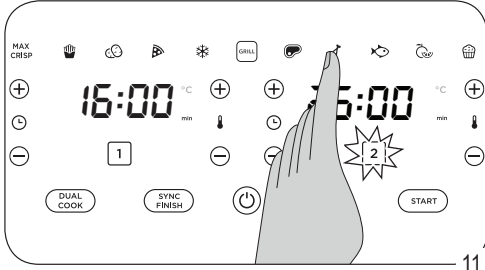

11

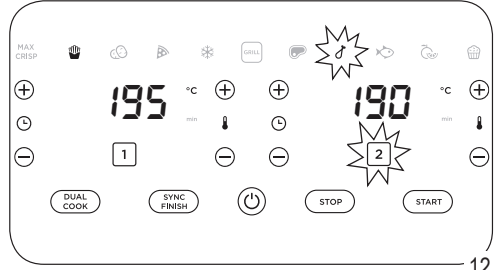

12



13



14



15



16

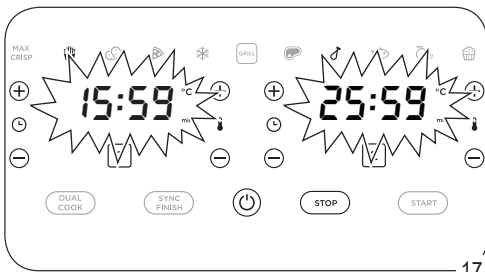

17

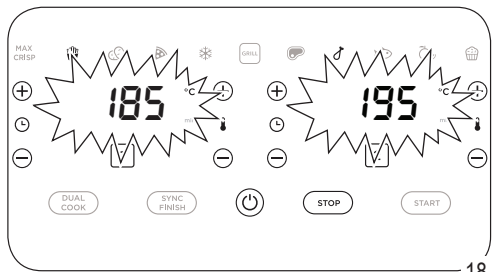

18

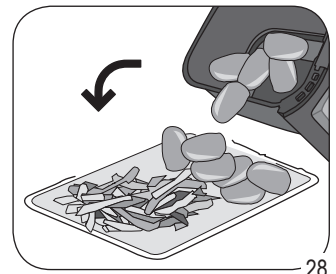
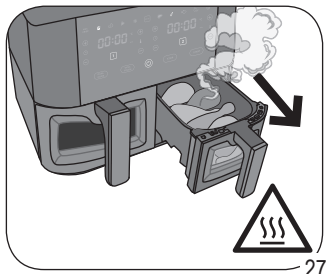
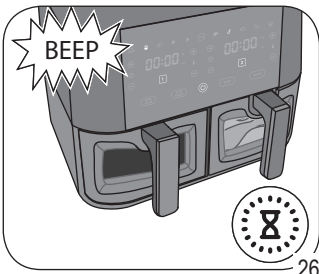
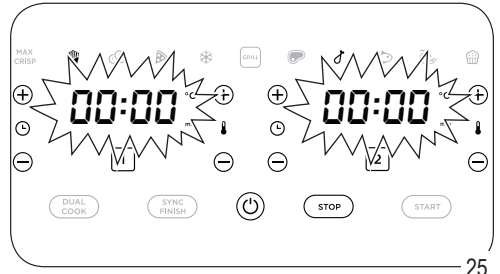
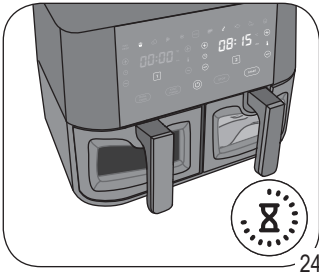
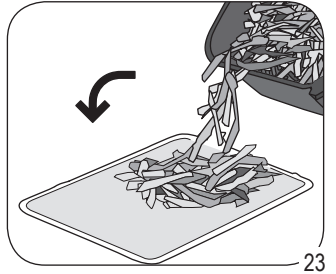
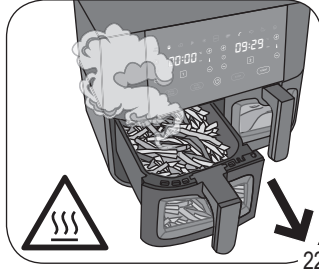
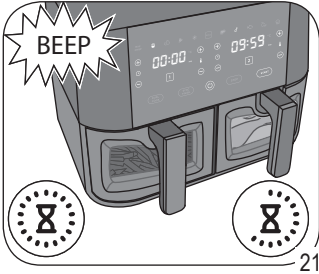
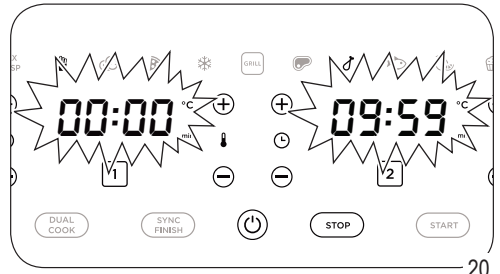
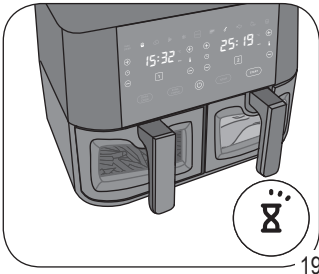



Funzione DUAL COOK | DUAL COOK function | Fonction DUAL COOK | DUAL COOK-Funktion | Función DUAL COOK | Função DUAL COOK | DUAL COOK-functie | Λειτουργία DUAL COOK | Функцію DUAL COOK | "DUAL COOK" المزودج الطهي | Функцію DUAL COOK | Funkcję DUAL COOK | Funktionen DUAL COOK

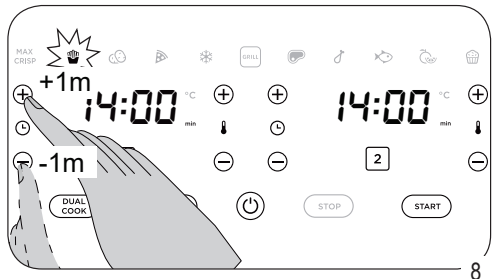
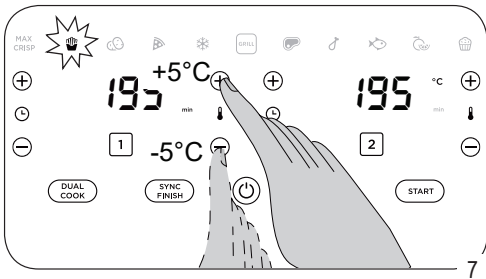
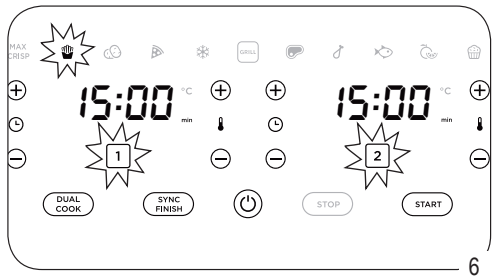
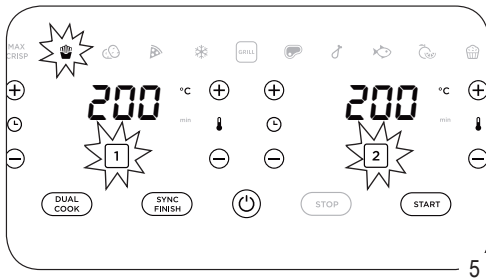
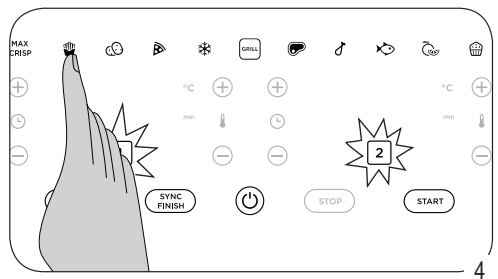
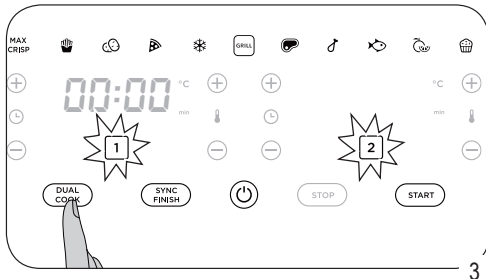
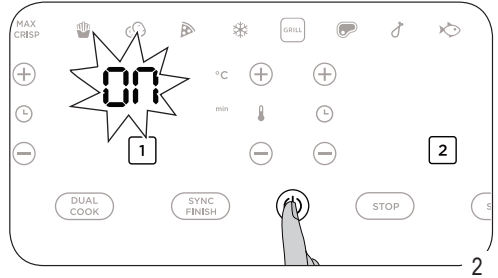
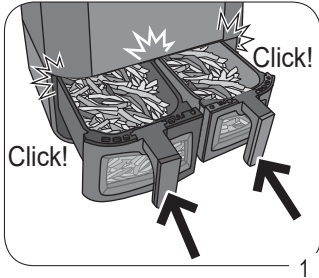

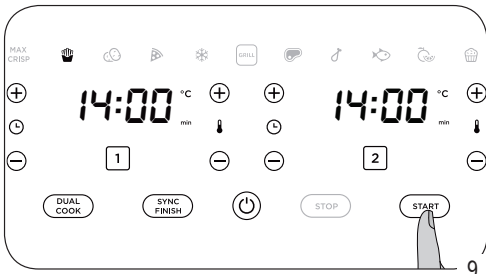

9

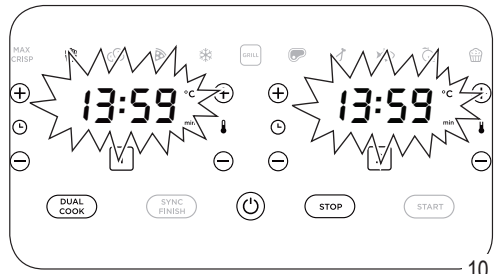

10

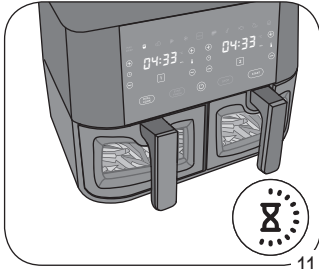

11

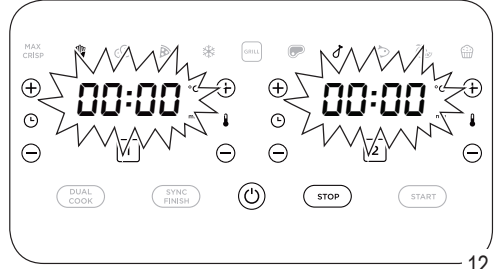

12

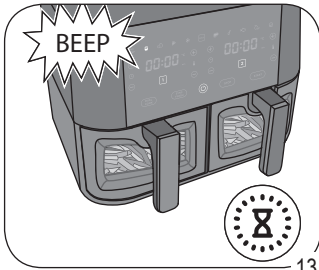

13

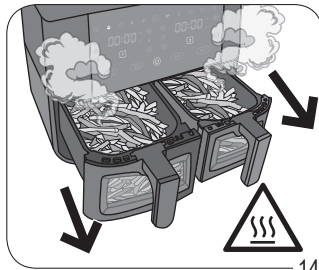

14

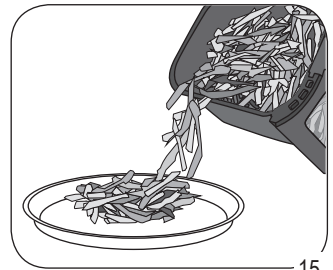

15



Funzione Sync finish | Sync finish function | Fonction SYNC FINISH | SYNC FINISH-Funktion | Función SYNC FINISH | Função SYNC FINISH | SYNC FINISH-functie | Λειτουργία SYNC FINISH | Функцію SYNC FINISH | SYNC FINISH وظيفة | Функцію SYNC FINISH | Funkcję SYNC FINISH | Funktionen SYNC FINISH

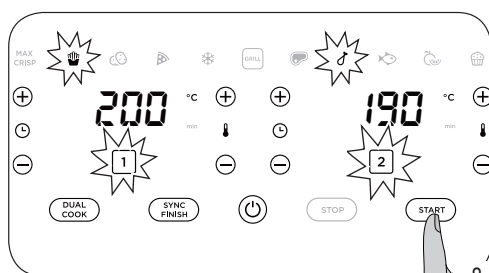
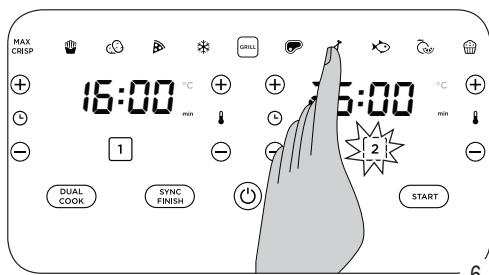
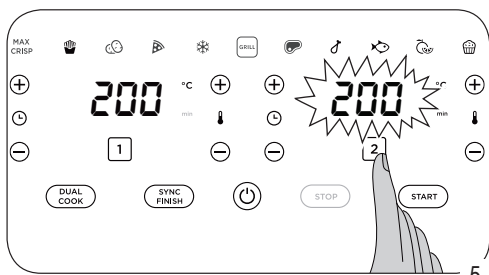
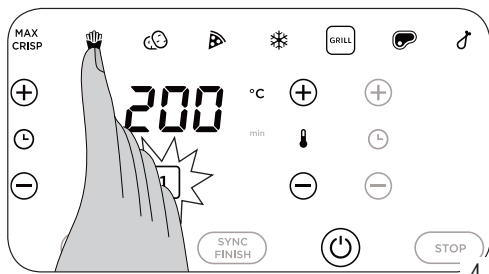
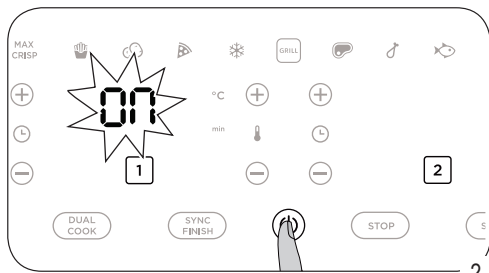
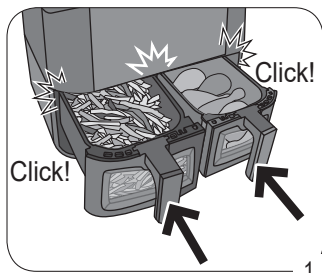

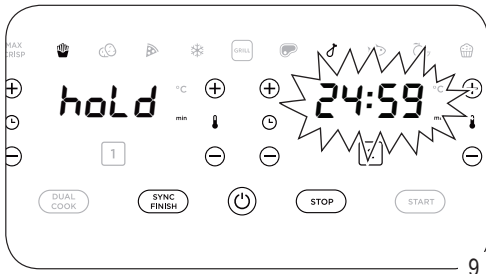

9

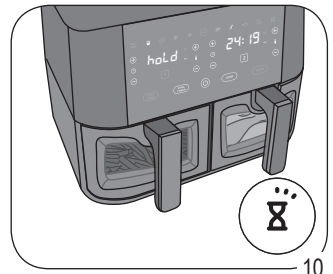

10

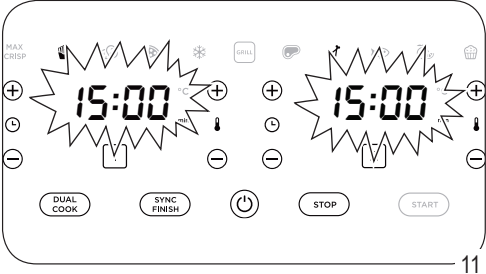

11

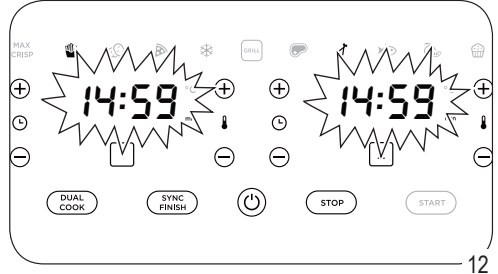

12

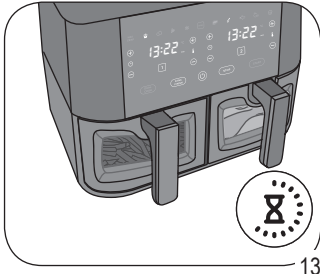

13

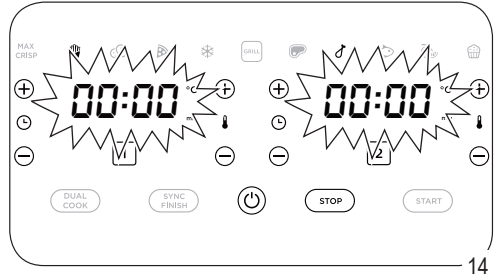

14

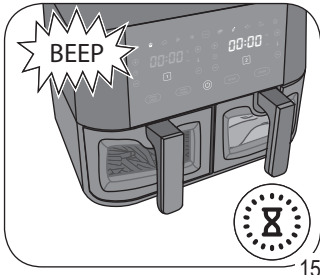

15

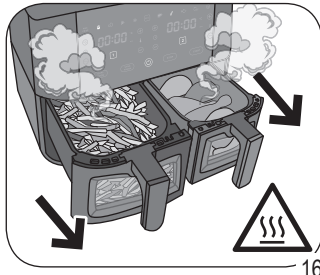

16

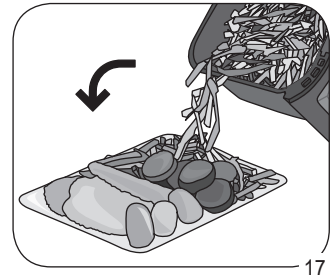

17





Instructions for use available here:



***Ariete***

De' Longhi Appliances Srl  
Divisione Commerciale Ariete  
Via San Quirico, 300  
50013 Campi Bisenzio (FI)  
E-Mail: [info@ariete.net](mailto:info@ariete.net)  
Internet: [www.ariete.net](http://www.ariete.net)

COD. 6385100201 REV. 0 19/12/2023

827070