

# skølm.

**Zandor**  
Metallkommode

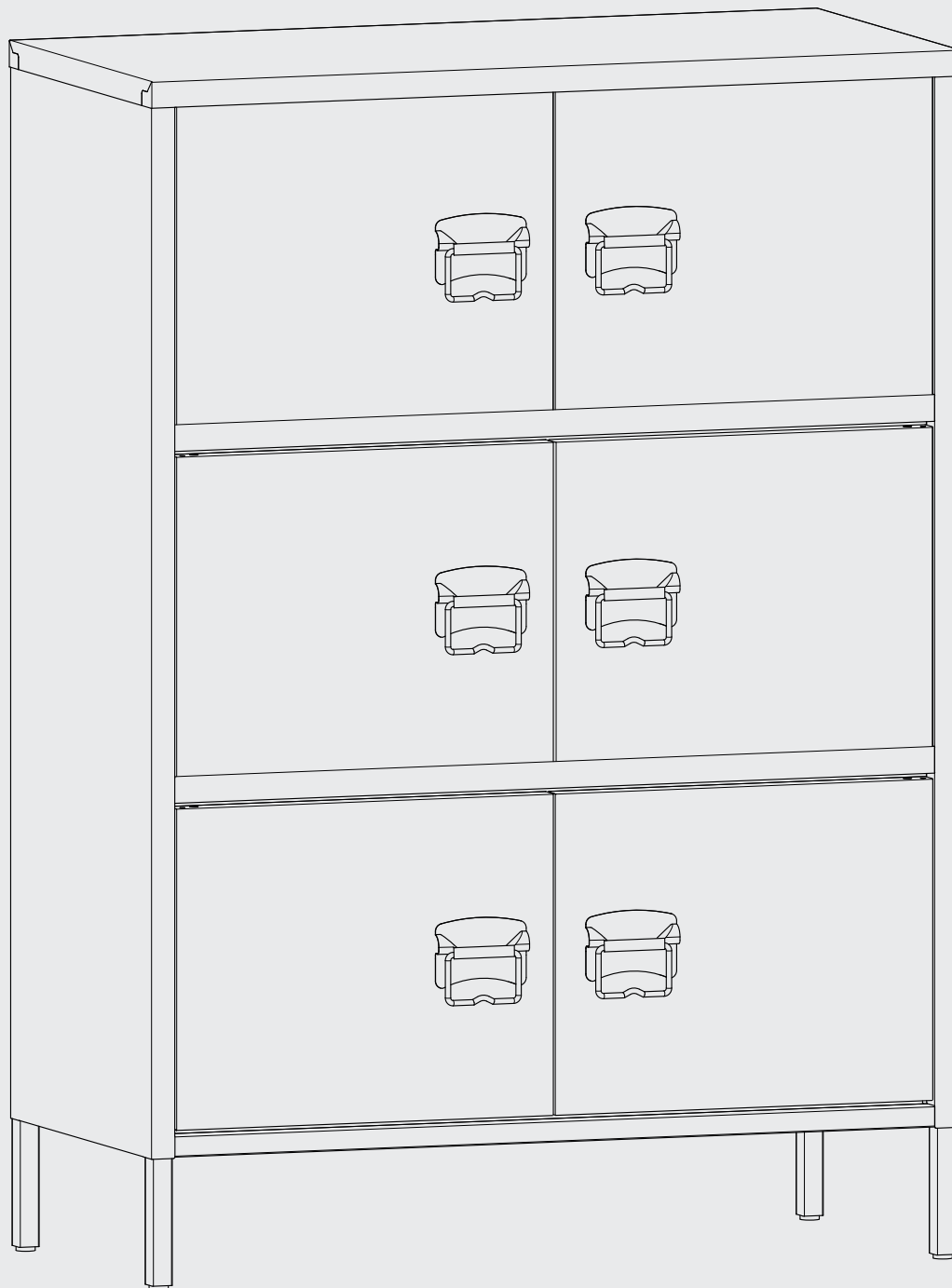



# Hey,

wir freuen uns, dass Du Dich für unser Produkt entschieden hast. Beachte die kommenden Hinweise, um den Aufbau problemlos zu gestalten.

**Viel Spaß mit Deinem Produkt!**

# 50%

weniger Fehler beim Aufbau durch  
sorgfältiges Lesen der Anleitung

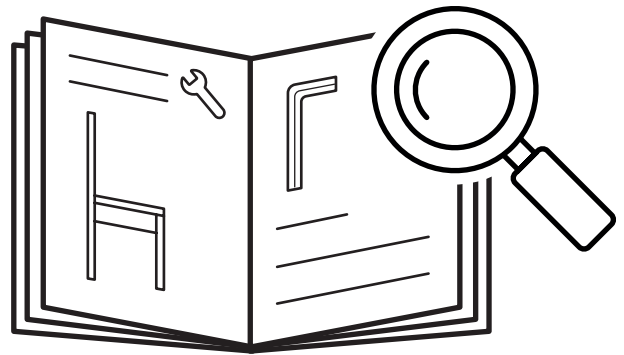

## 50-70

min

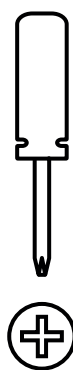
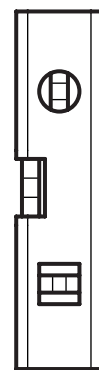

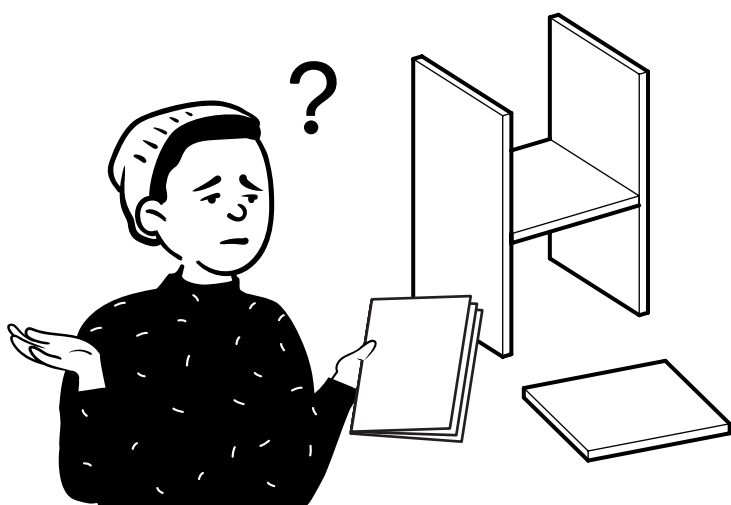
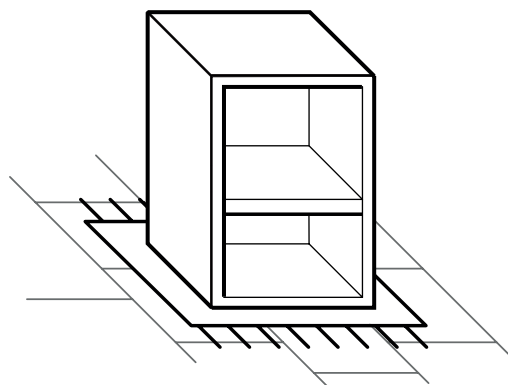
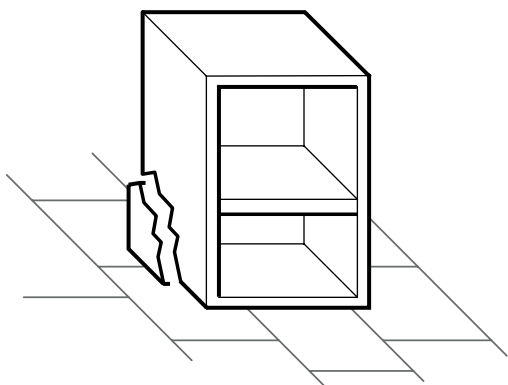

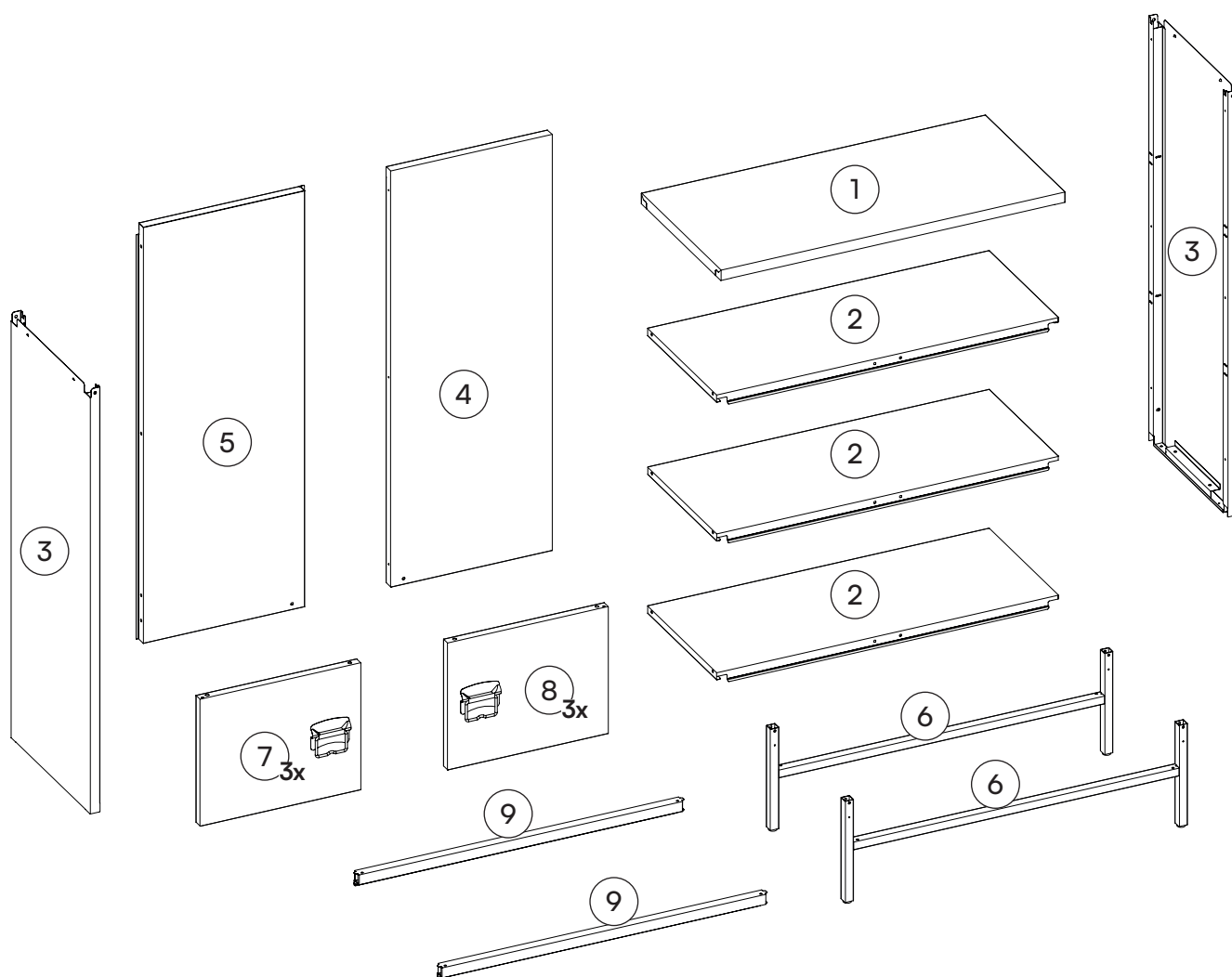

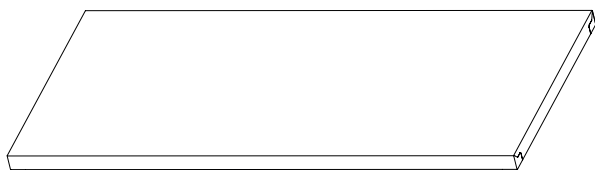

1 Deckel  
1x

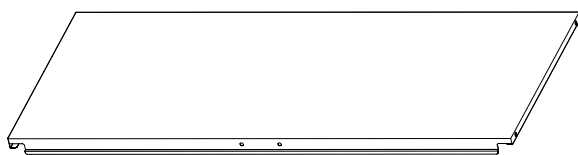

2 Zwischenboden  
3x

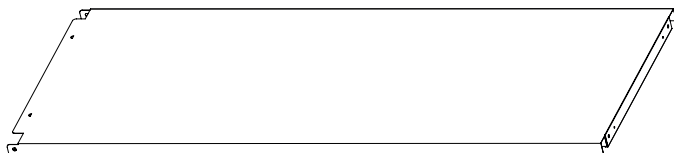

3 Seitenteil  
2x



4 Rückwand, rechts  
1x

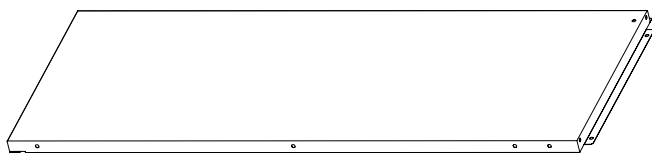

5 Rückwand, links  
1x

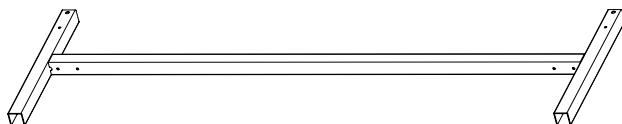

6 Bein  
2x

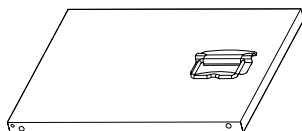

7 Tür, links  
3x

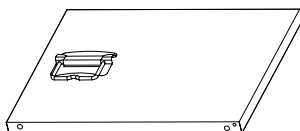

8 Tür, rechts  
3x

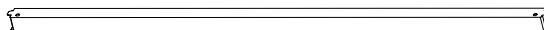

9 Mittelleiste  
2x

**L19** - Beilagscheibe

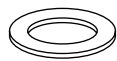

6x

**L20** - Fuß

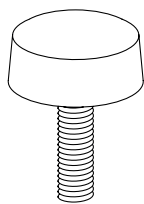

4x

**L21** - Regalhalter

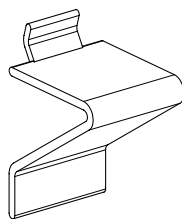

8x

**L36** - Magnet

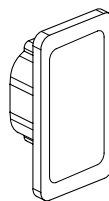

6x

**L51** - Anschlagdämpfer



6x

**K12** - Schraube

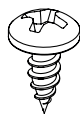

15x

**C14** - Bolzen

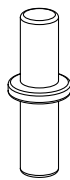

2x

**C37** - Bolzen

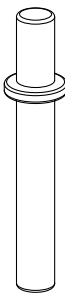

4x

**C38** - Federbolzen



2x

## Ein letzter Check:

Bitte überprüfe, ob Du alle Teile hast.

**Viel Spaß beim Aufbau!**

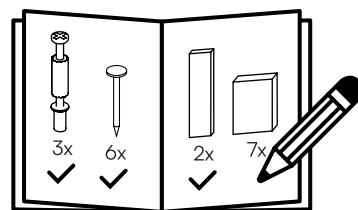

7

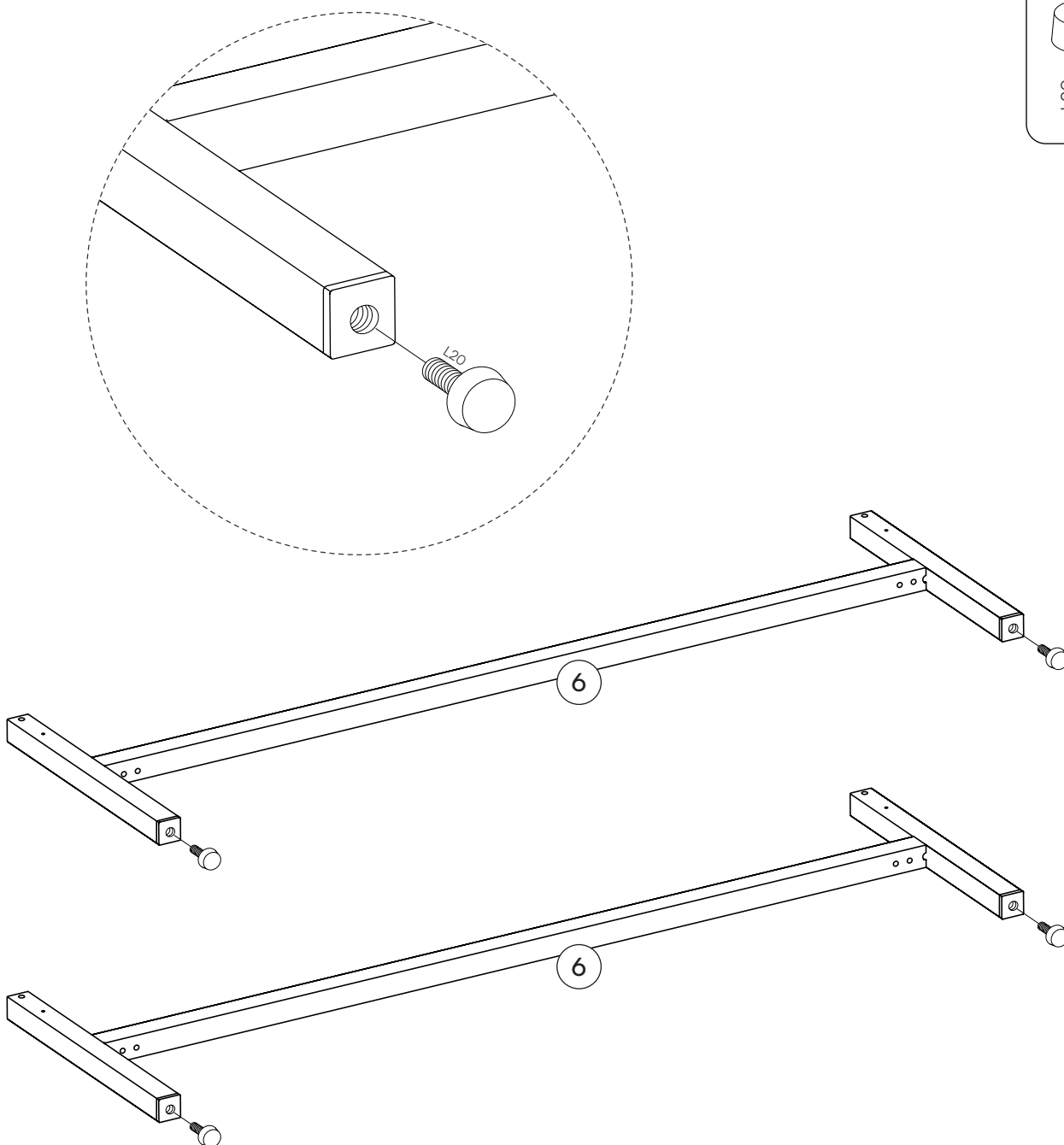
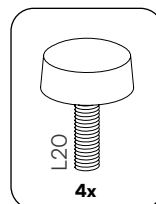

# 2

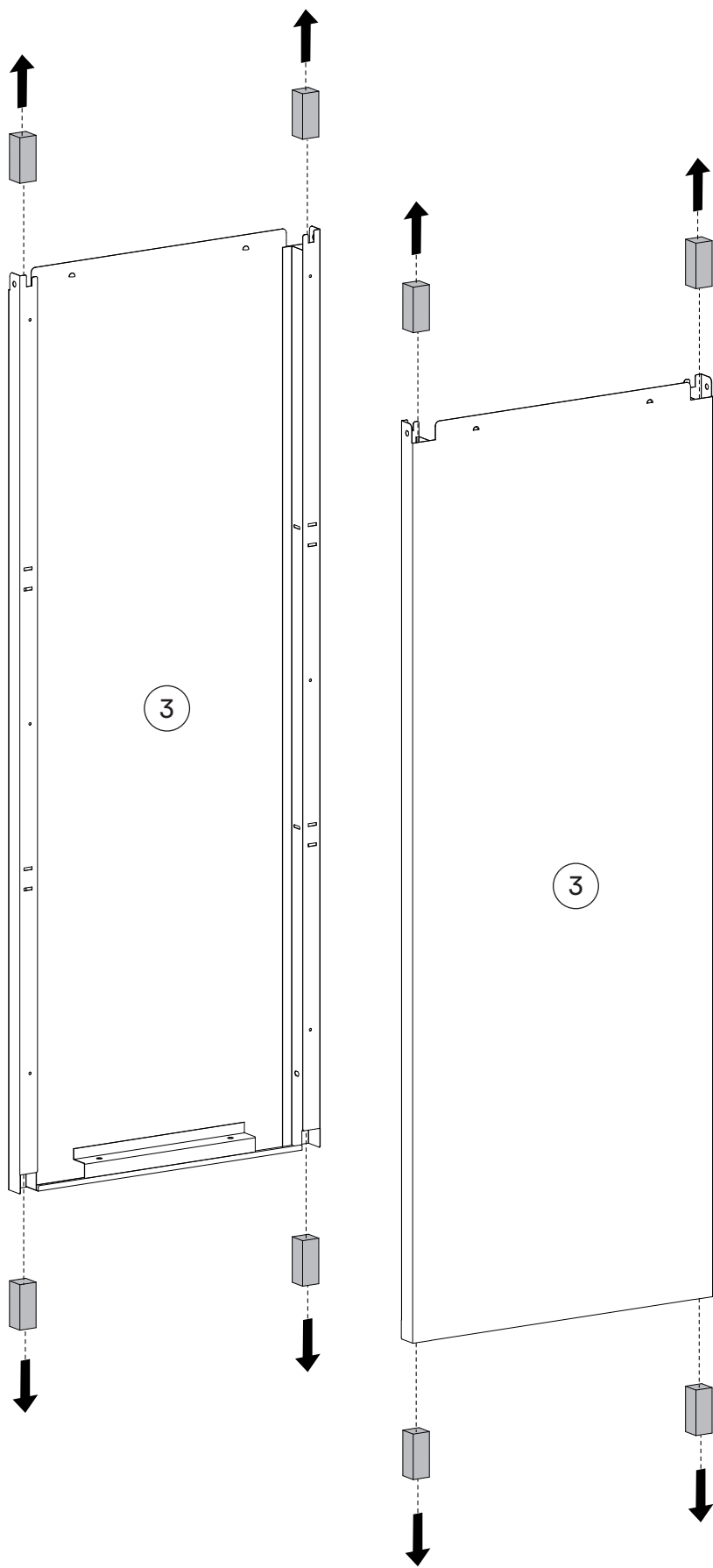

# 3

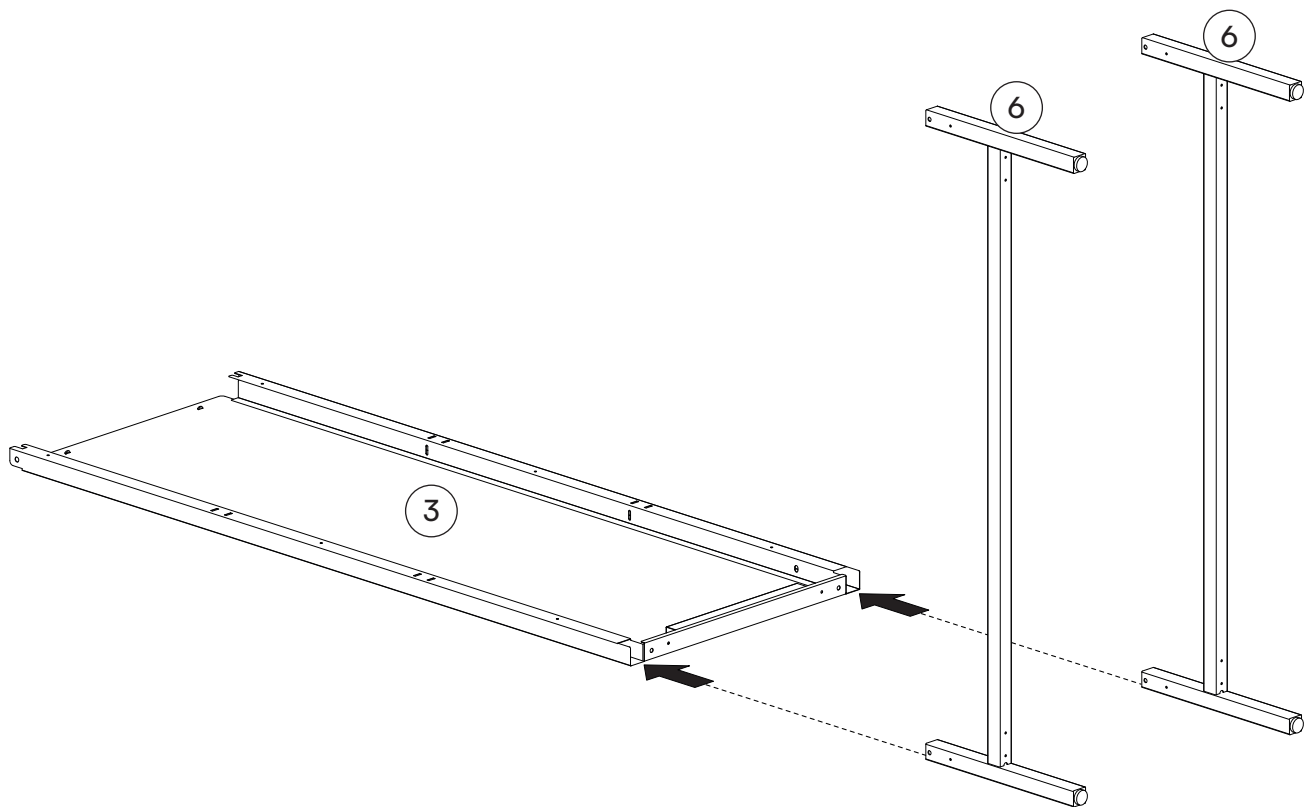

4

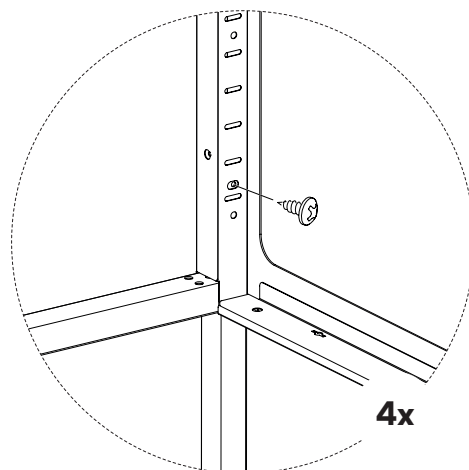
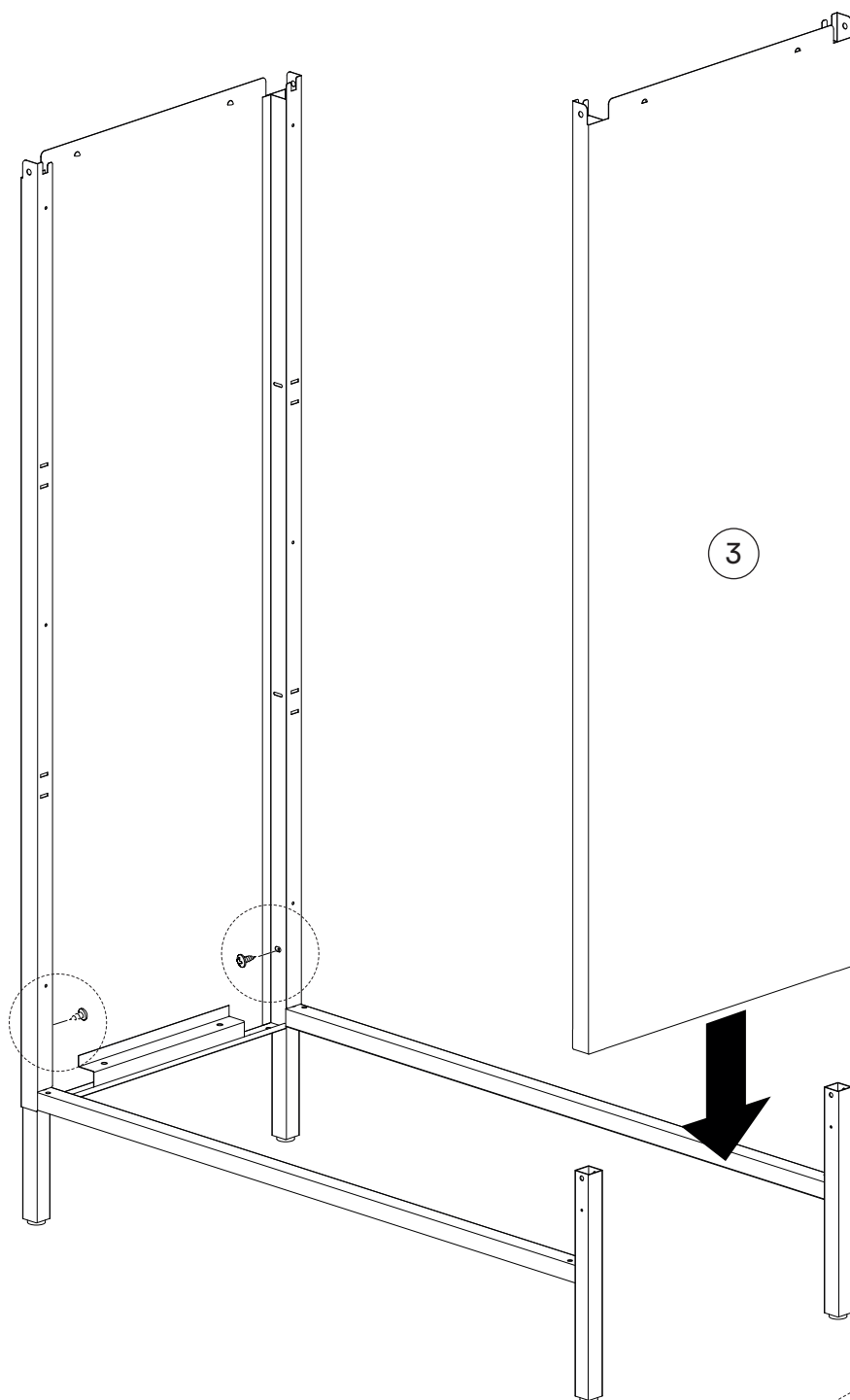
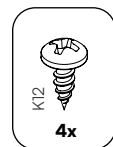

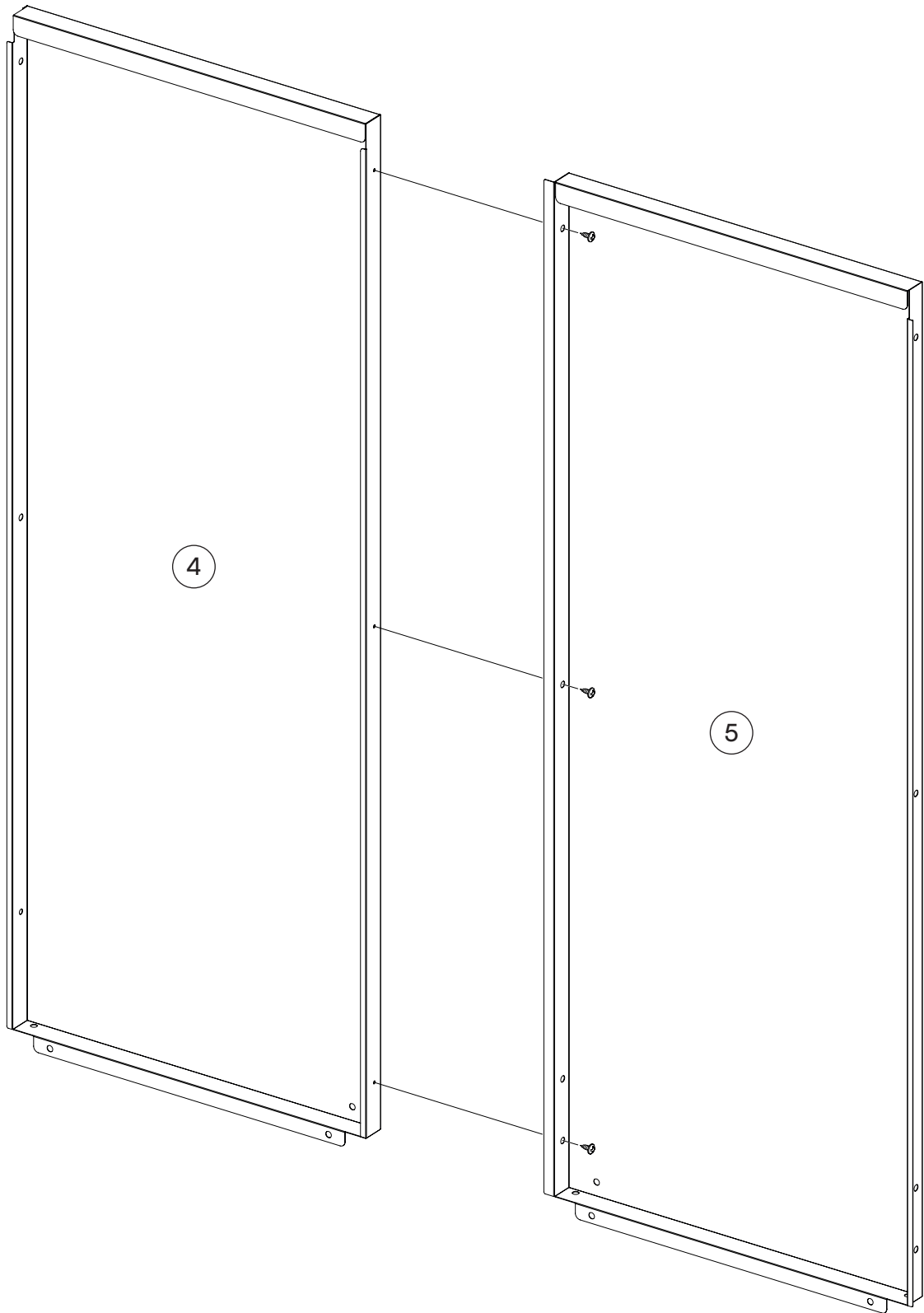
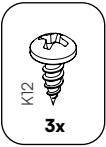

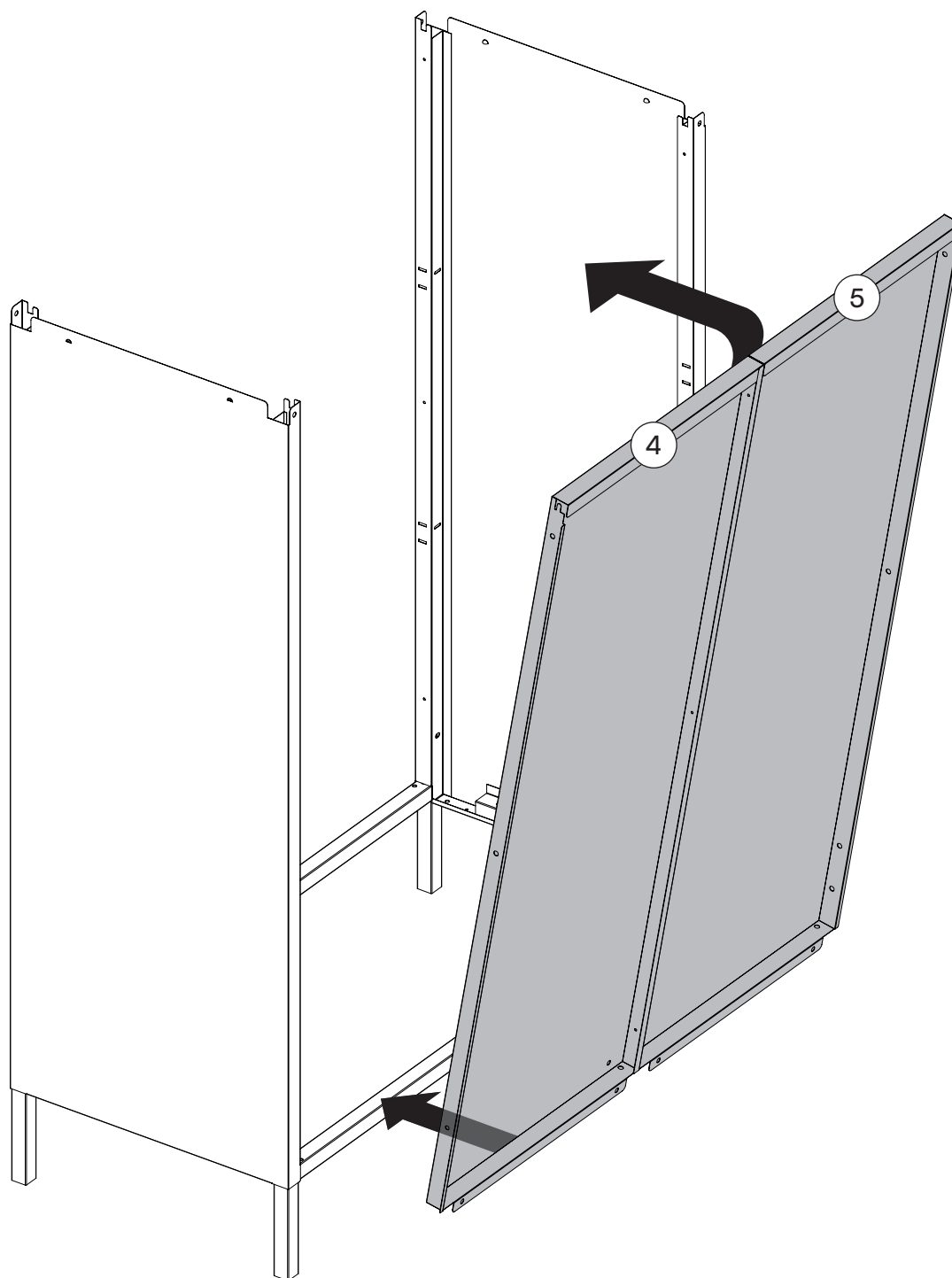

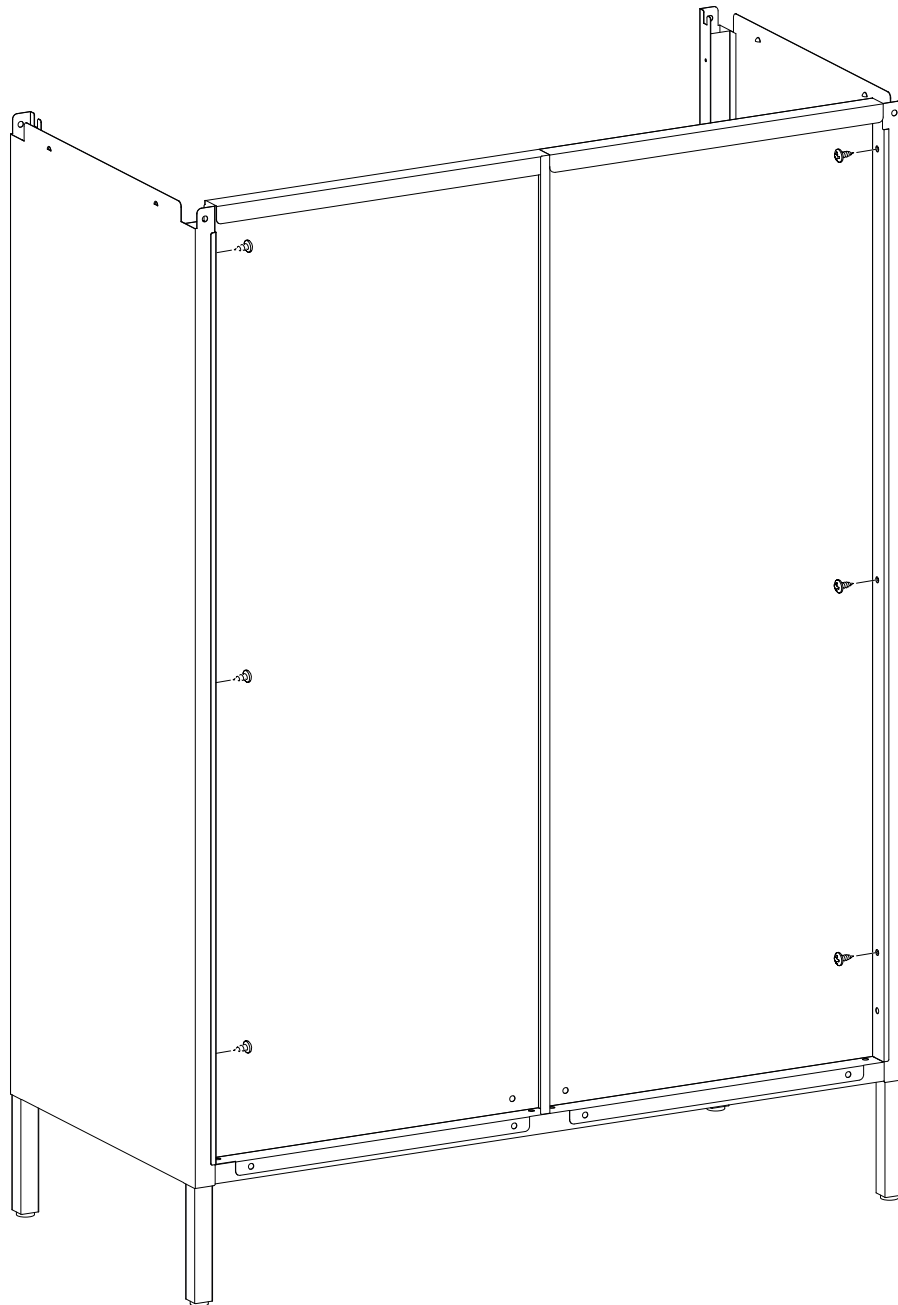
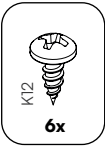

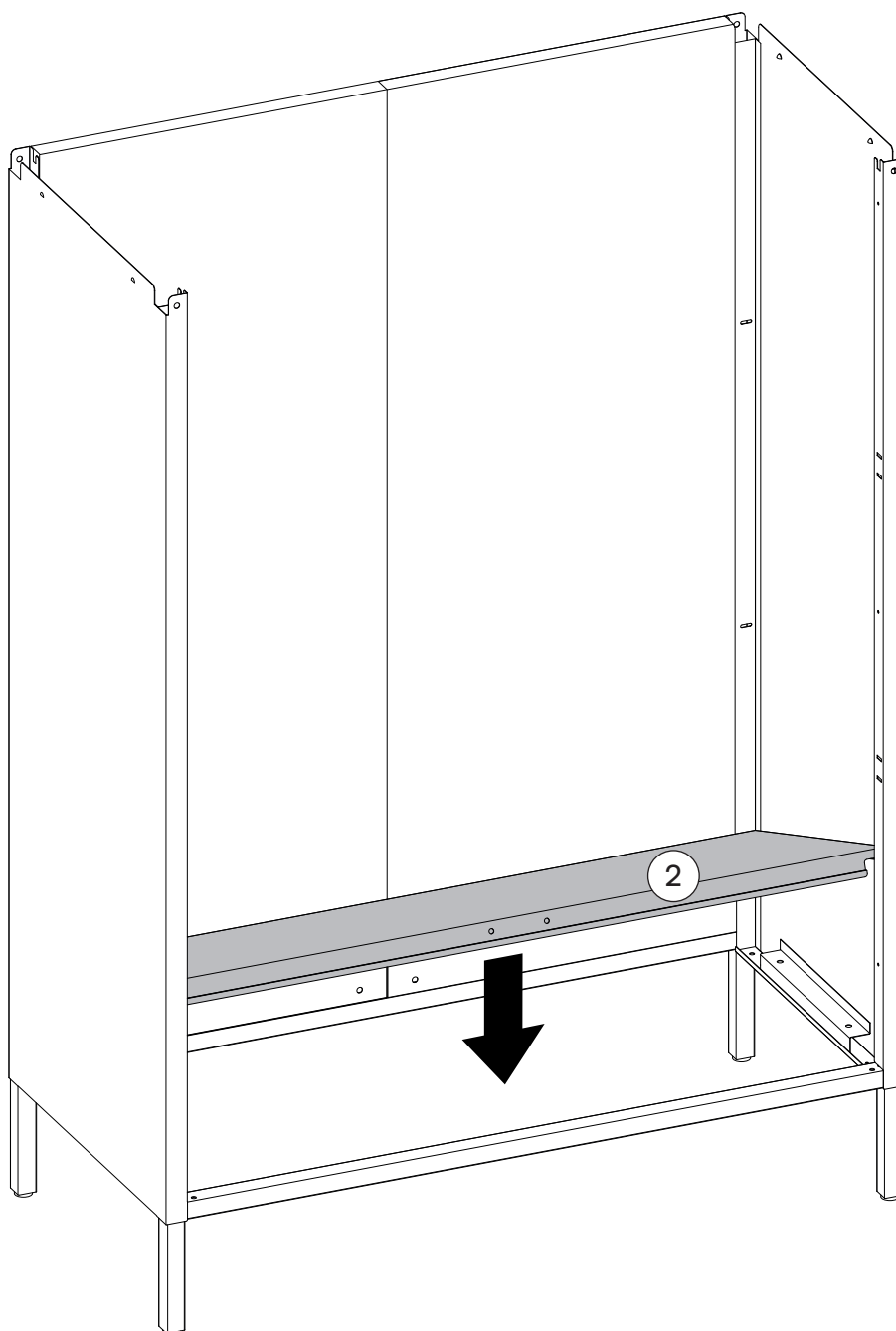

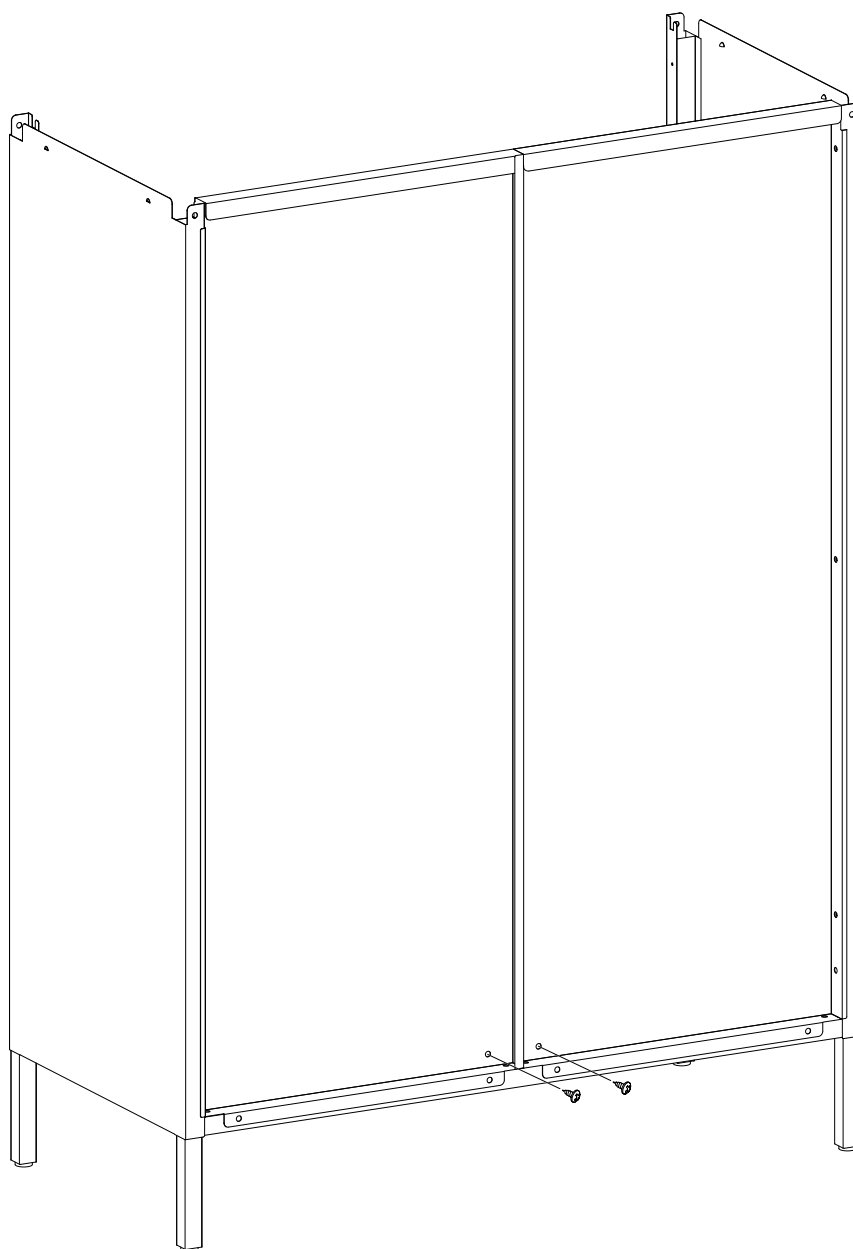
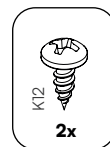

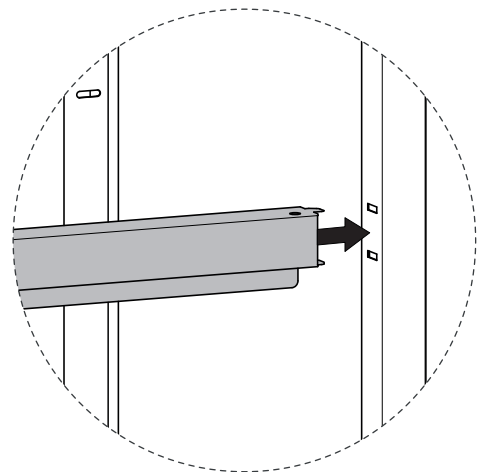
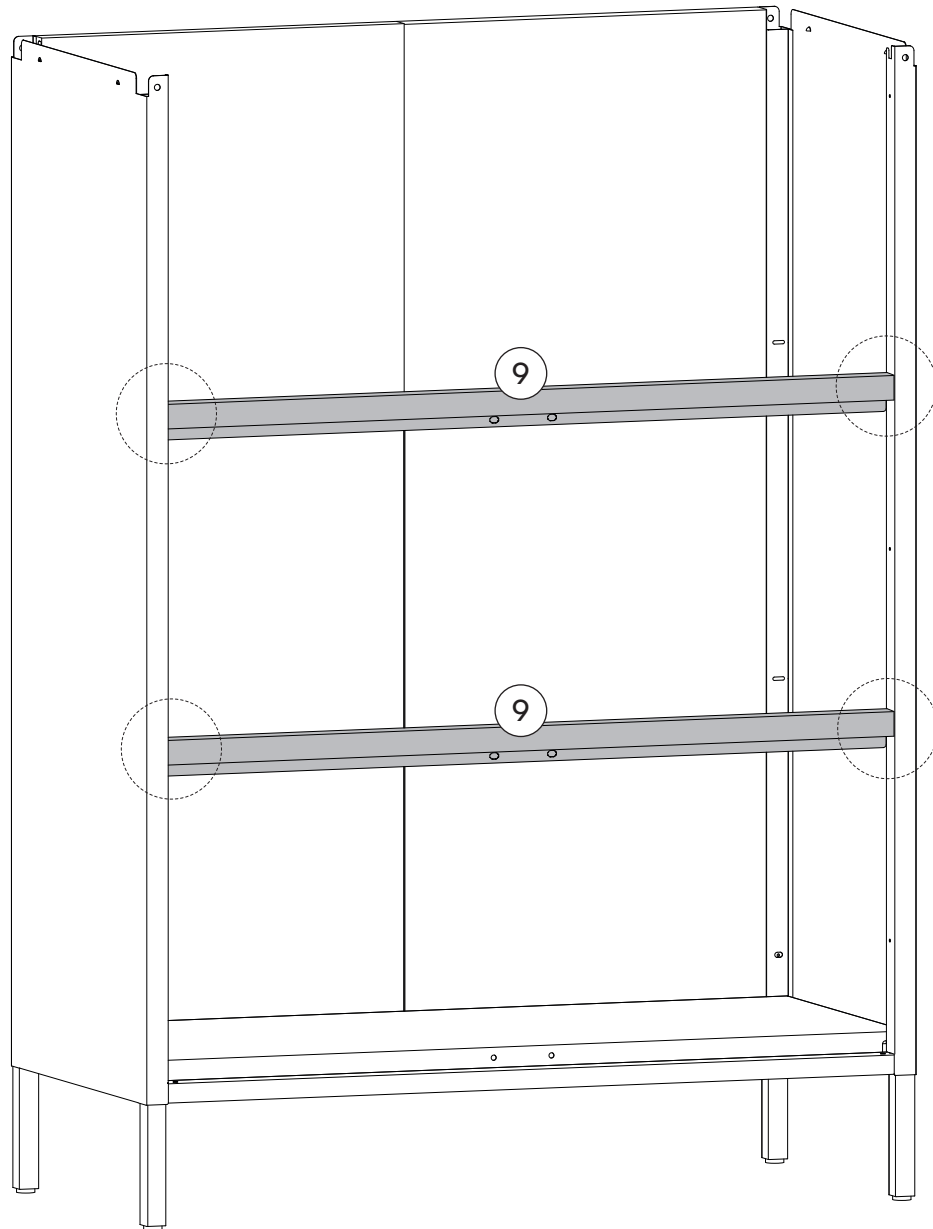

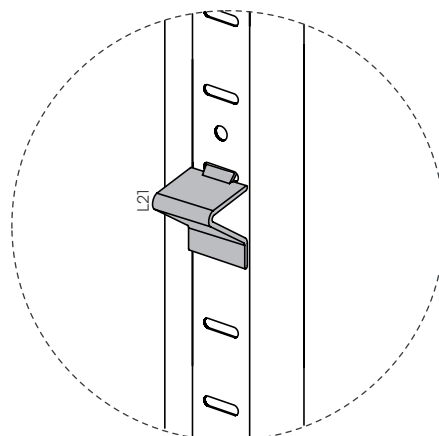
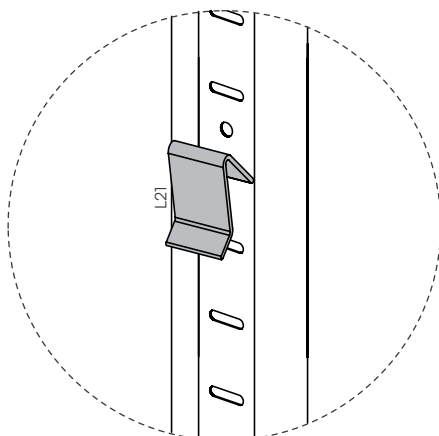
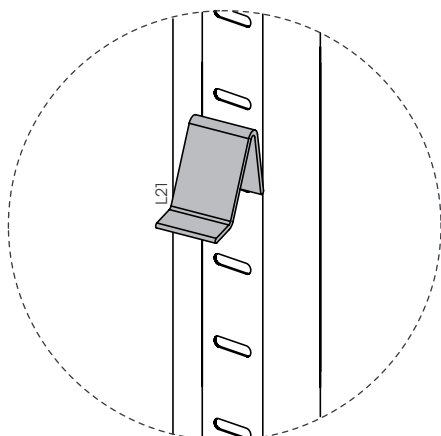
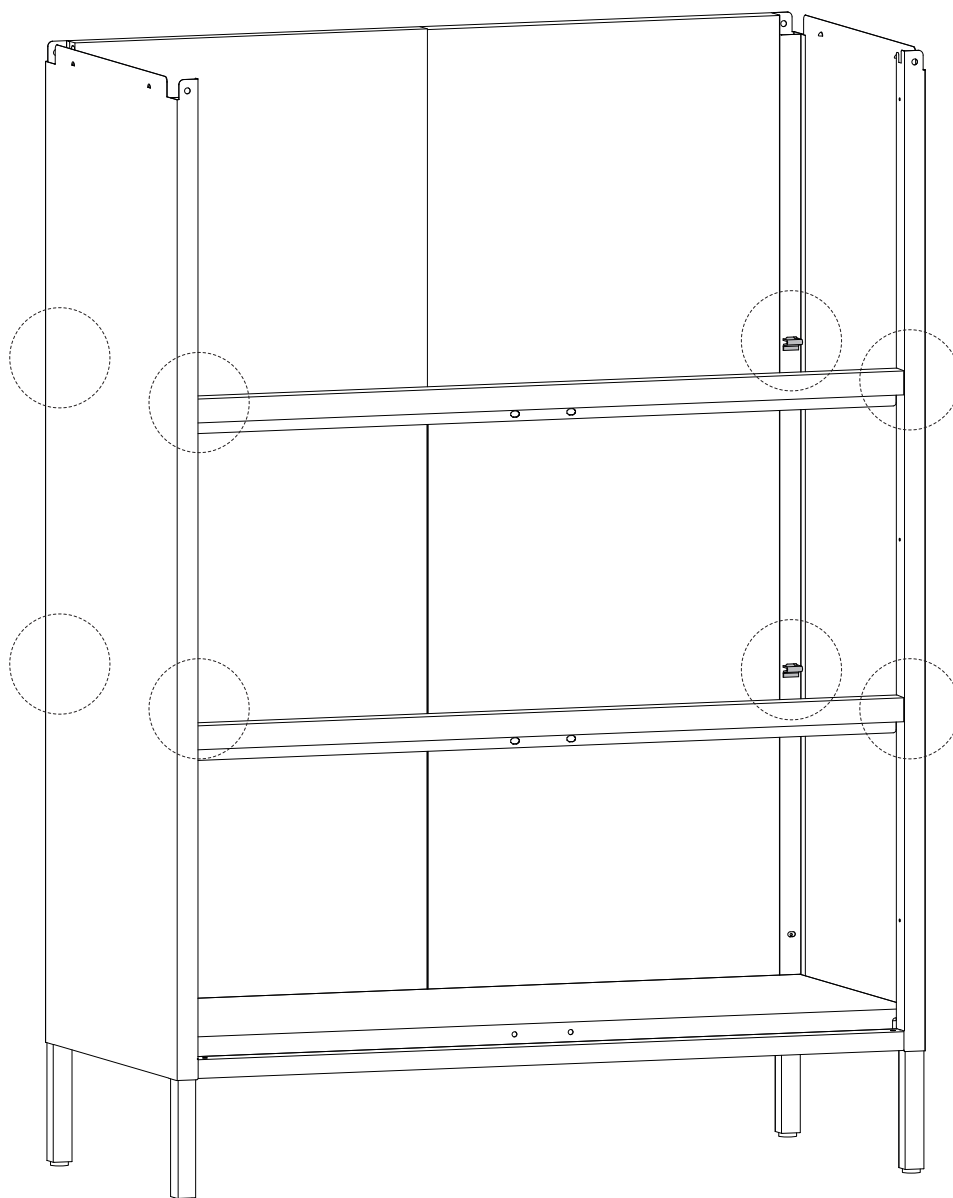
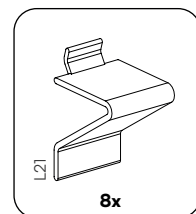

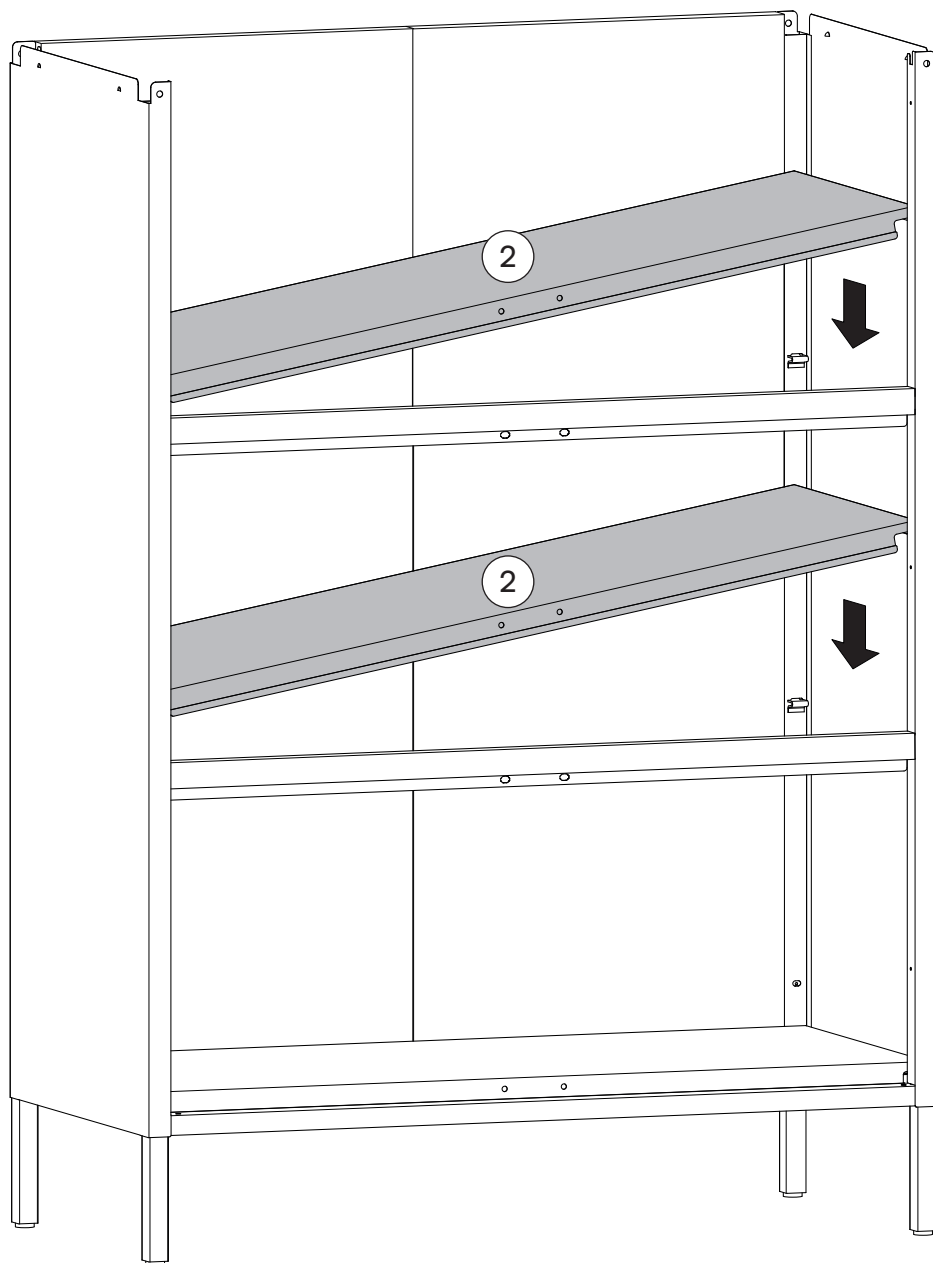

# 13

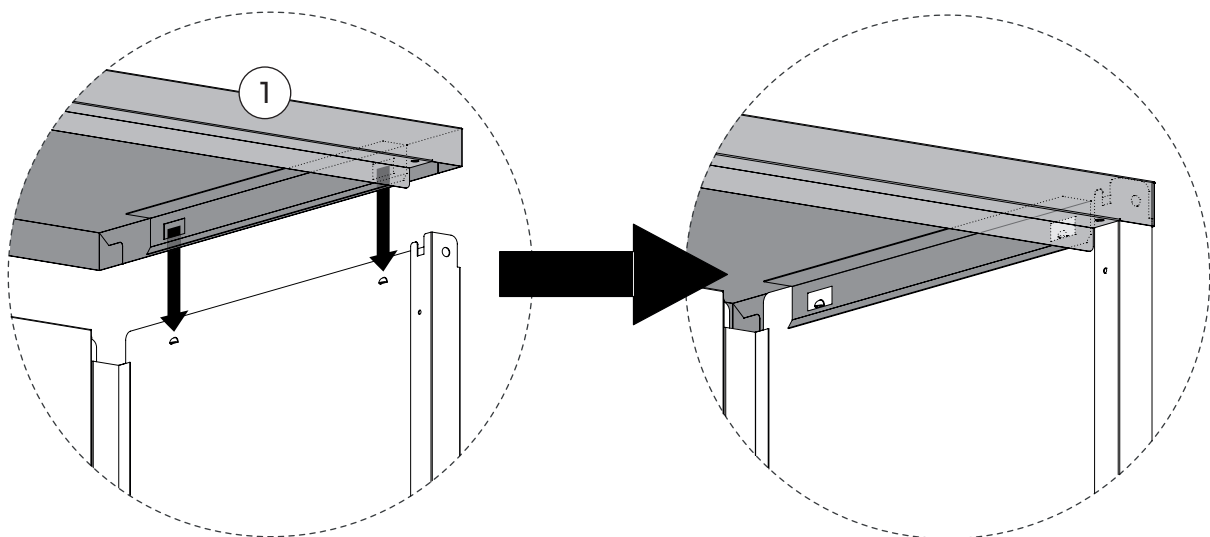
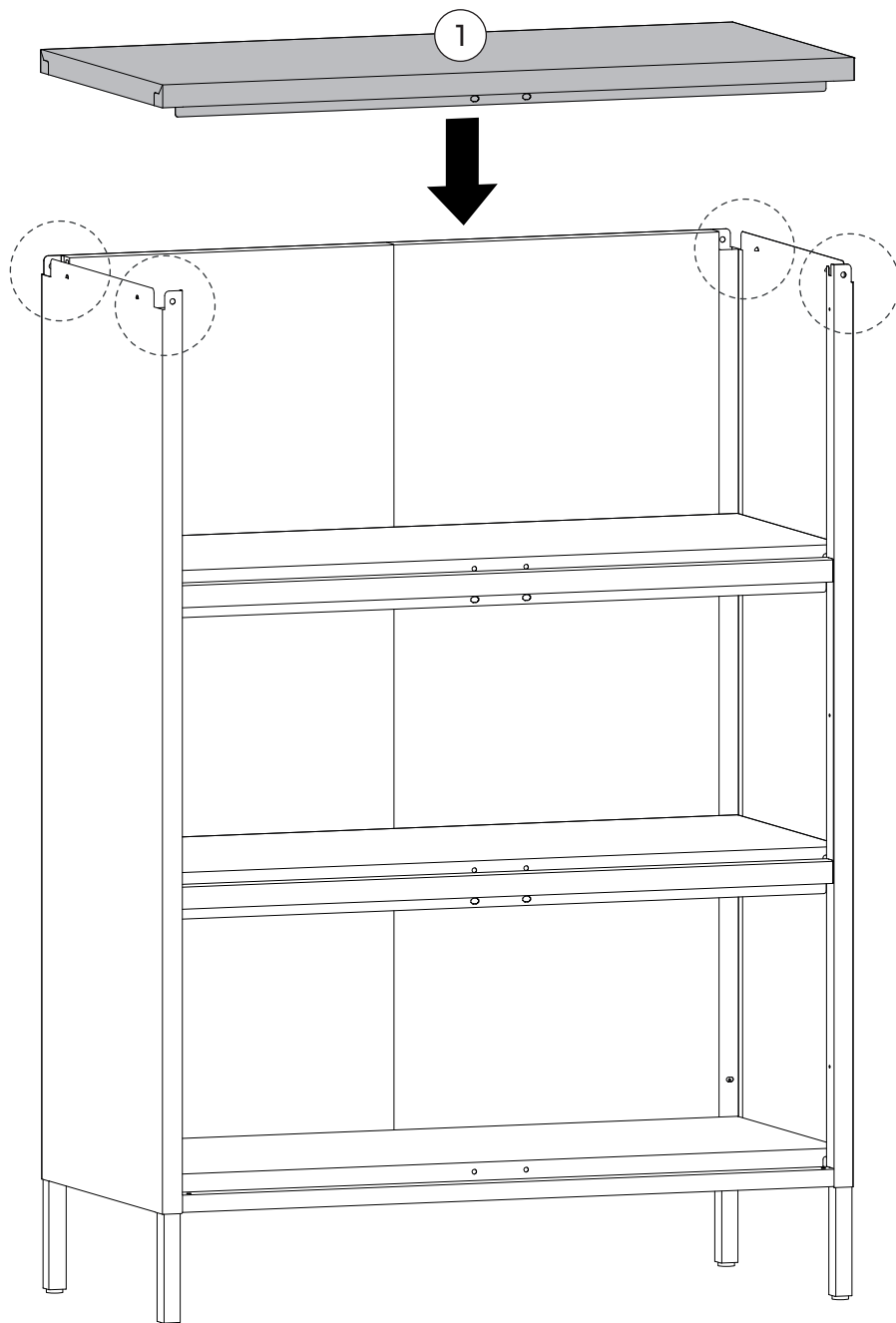

14

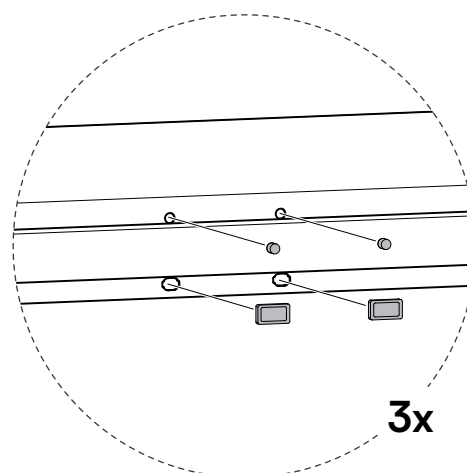
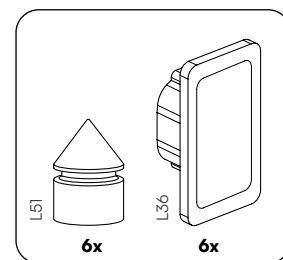
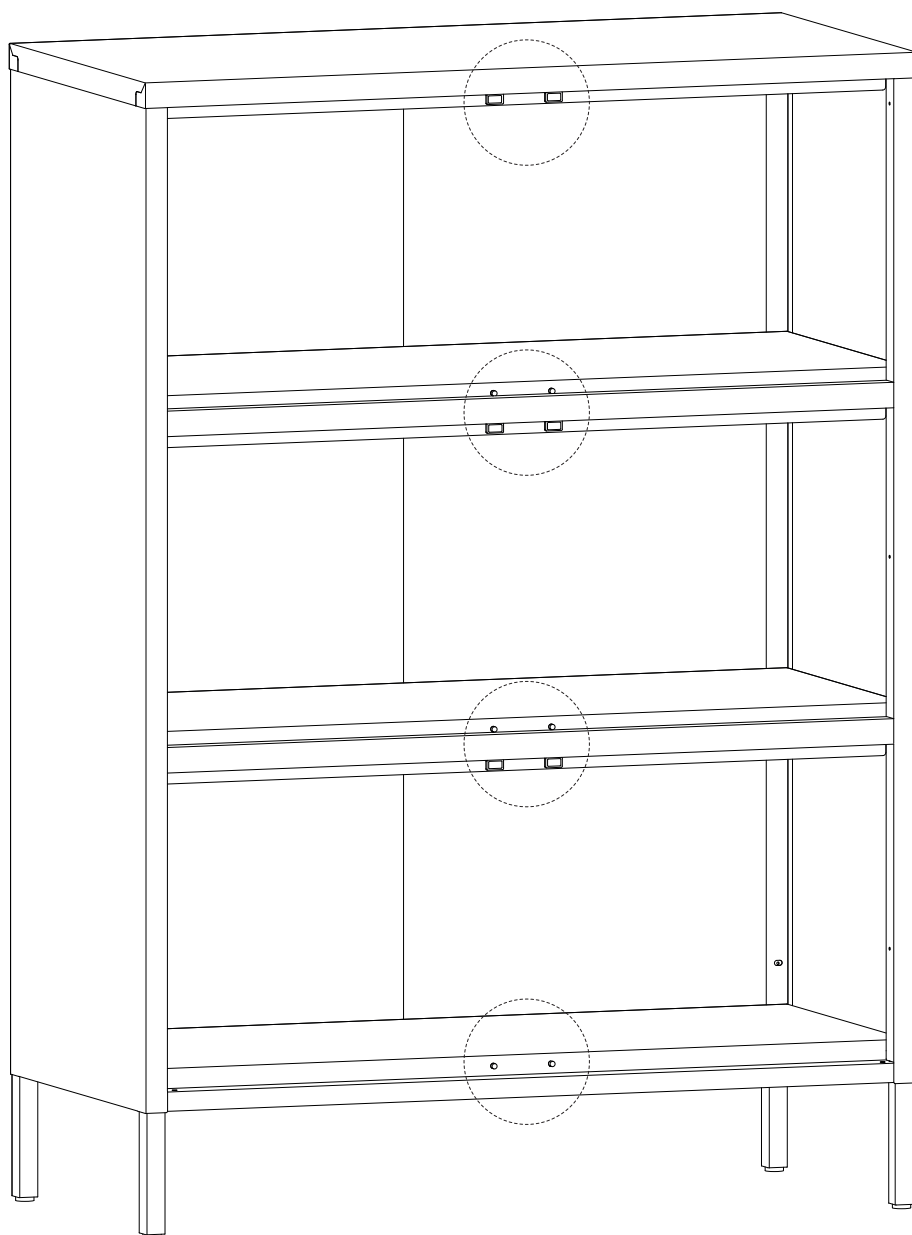

15

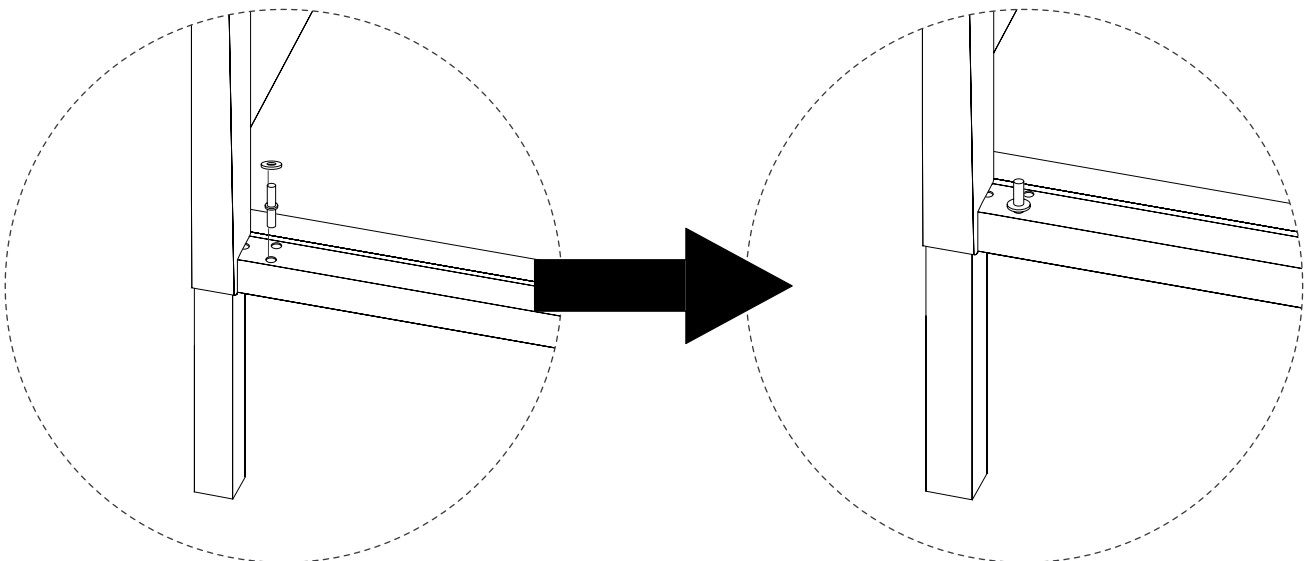
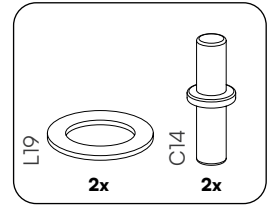
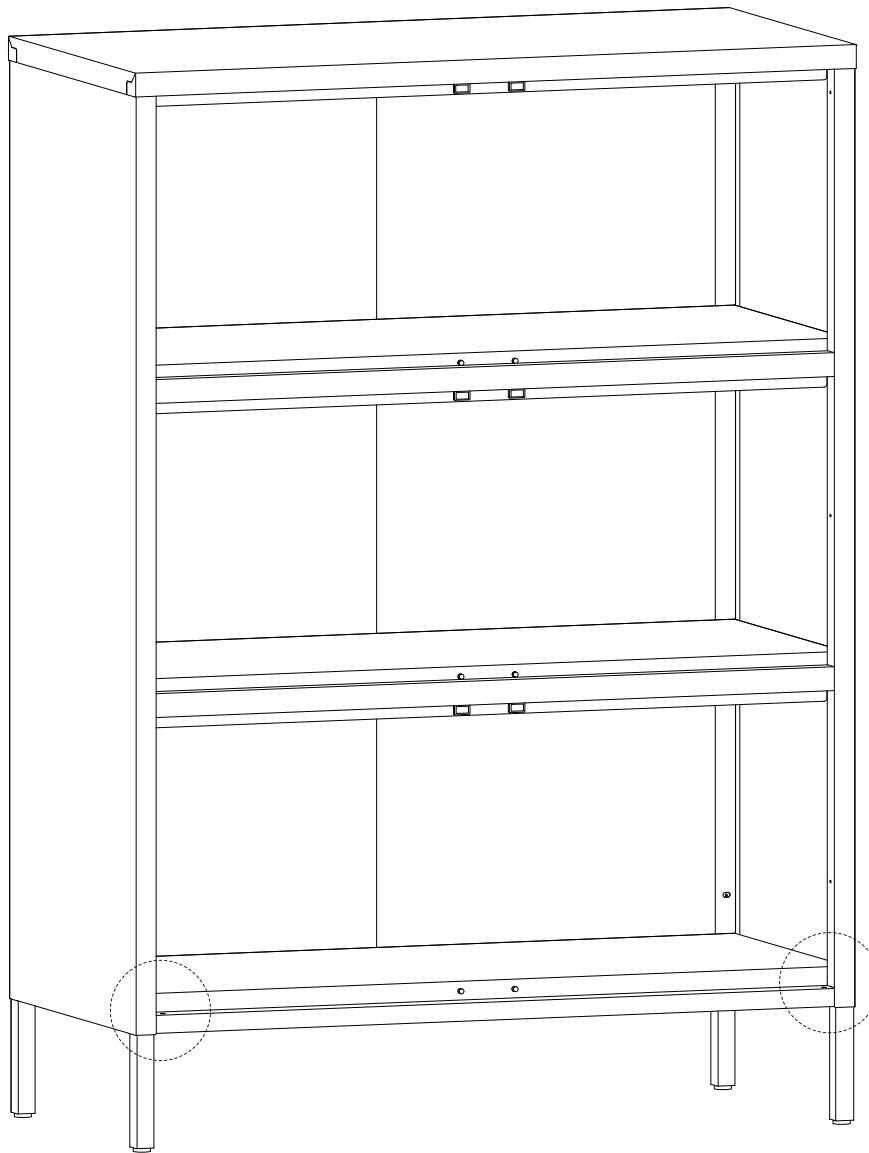

# 16

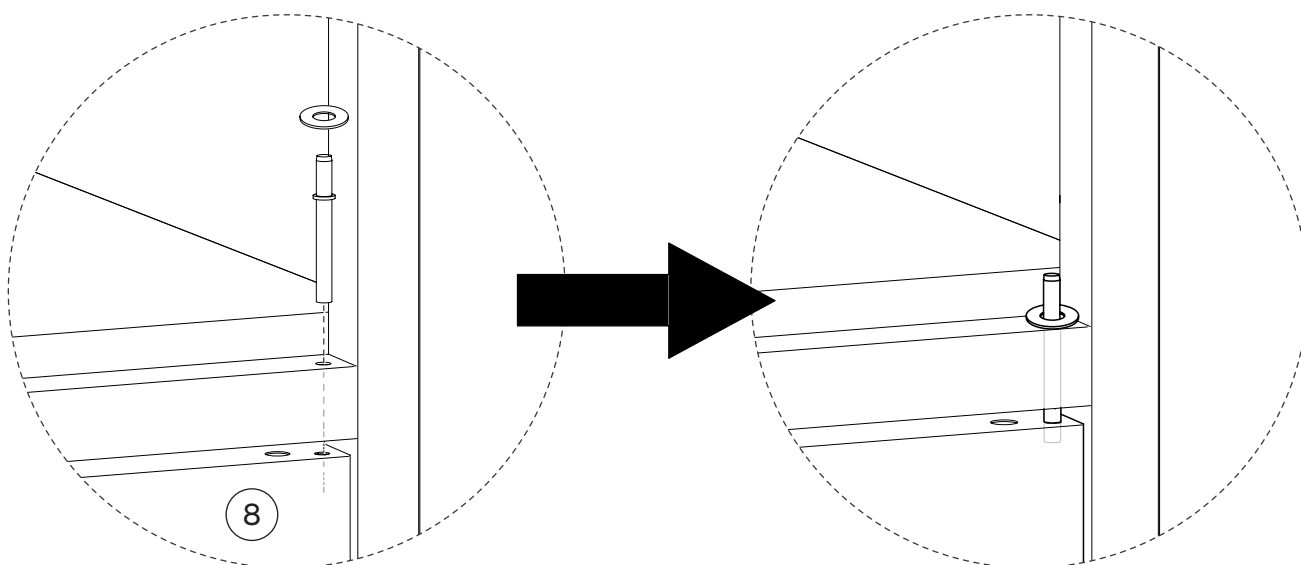
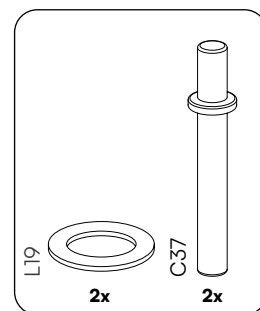
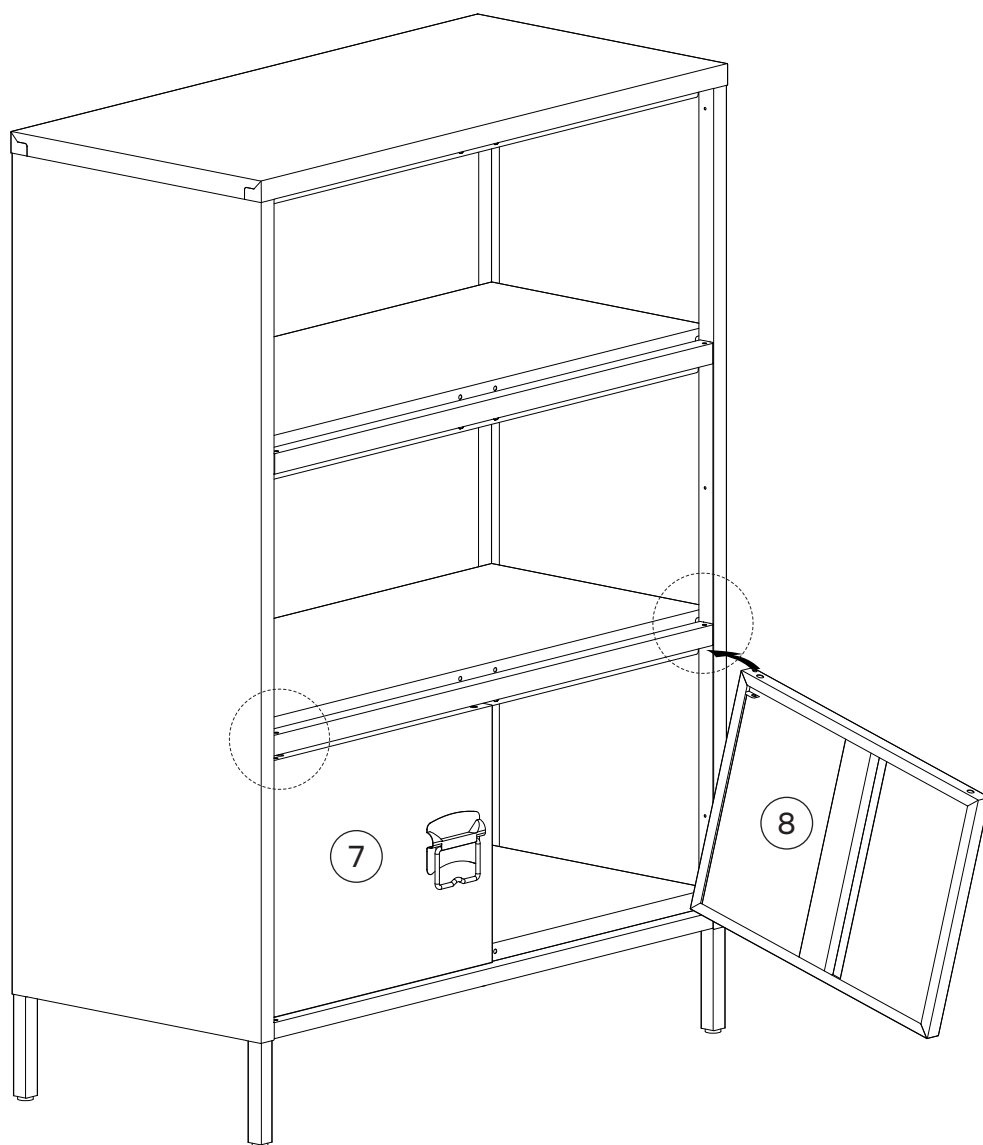

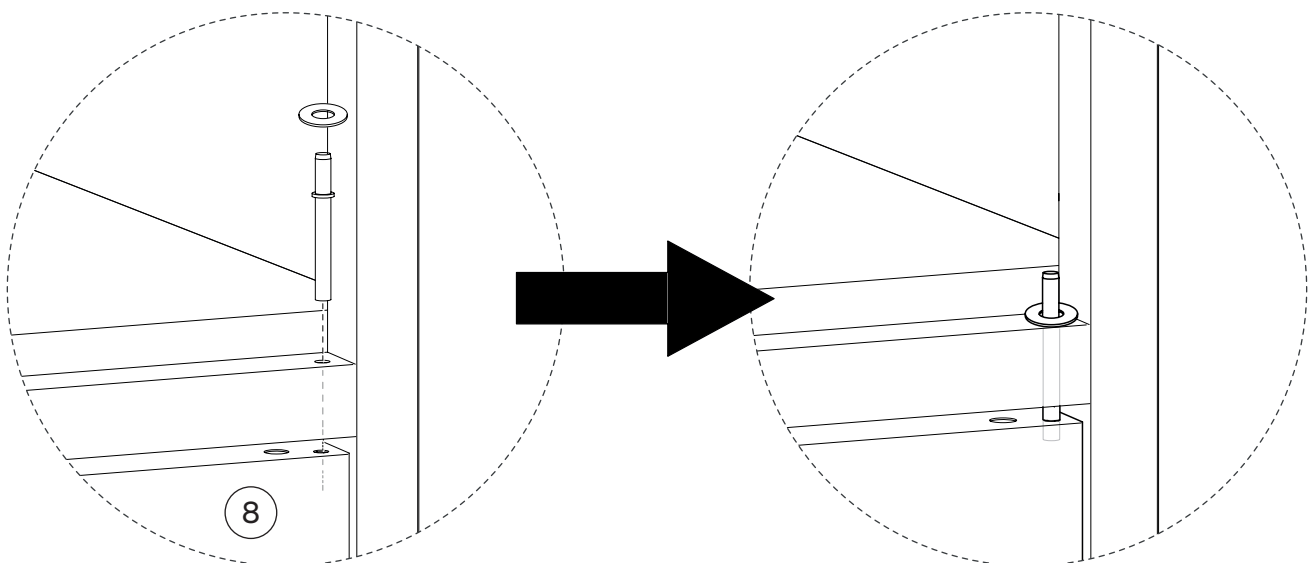
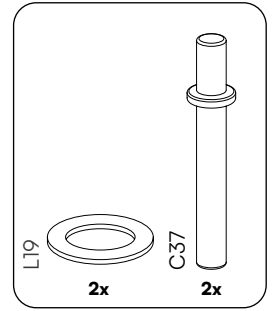
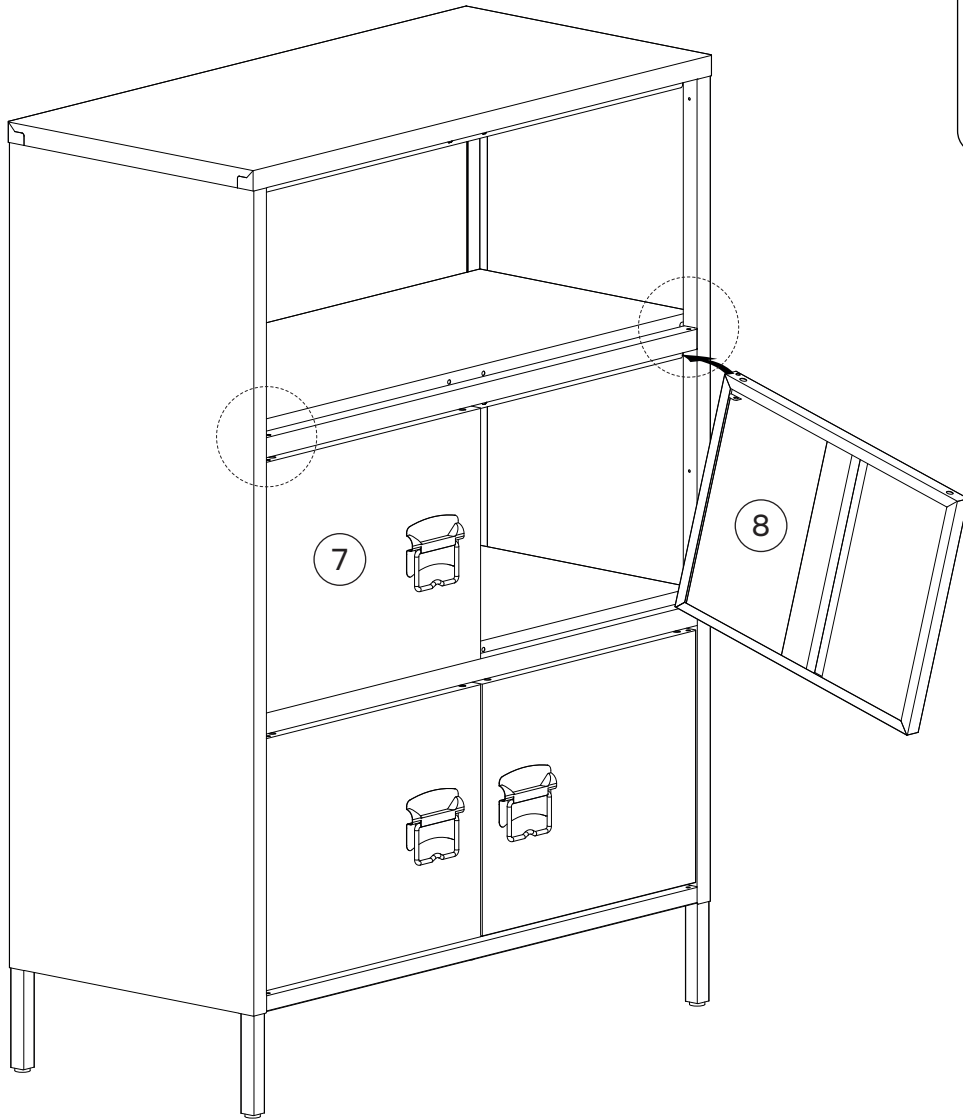

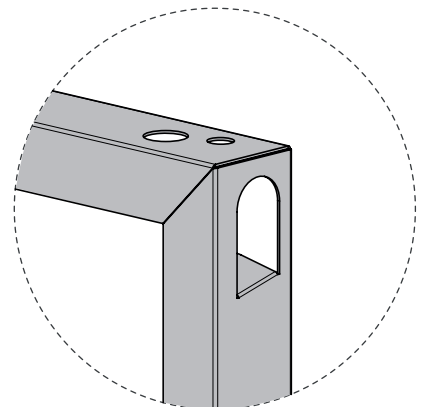
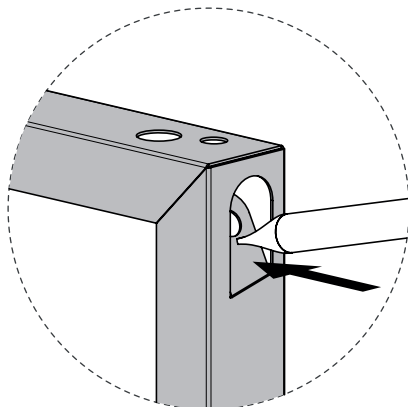
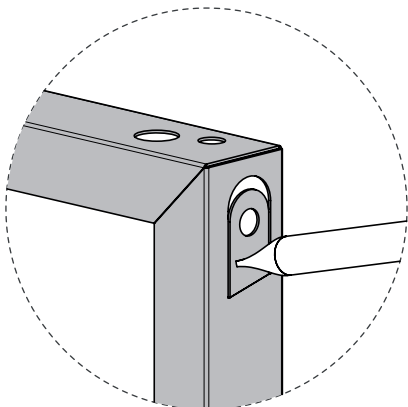
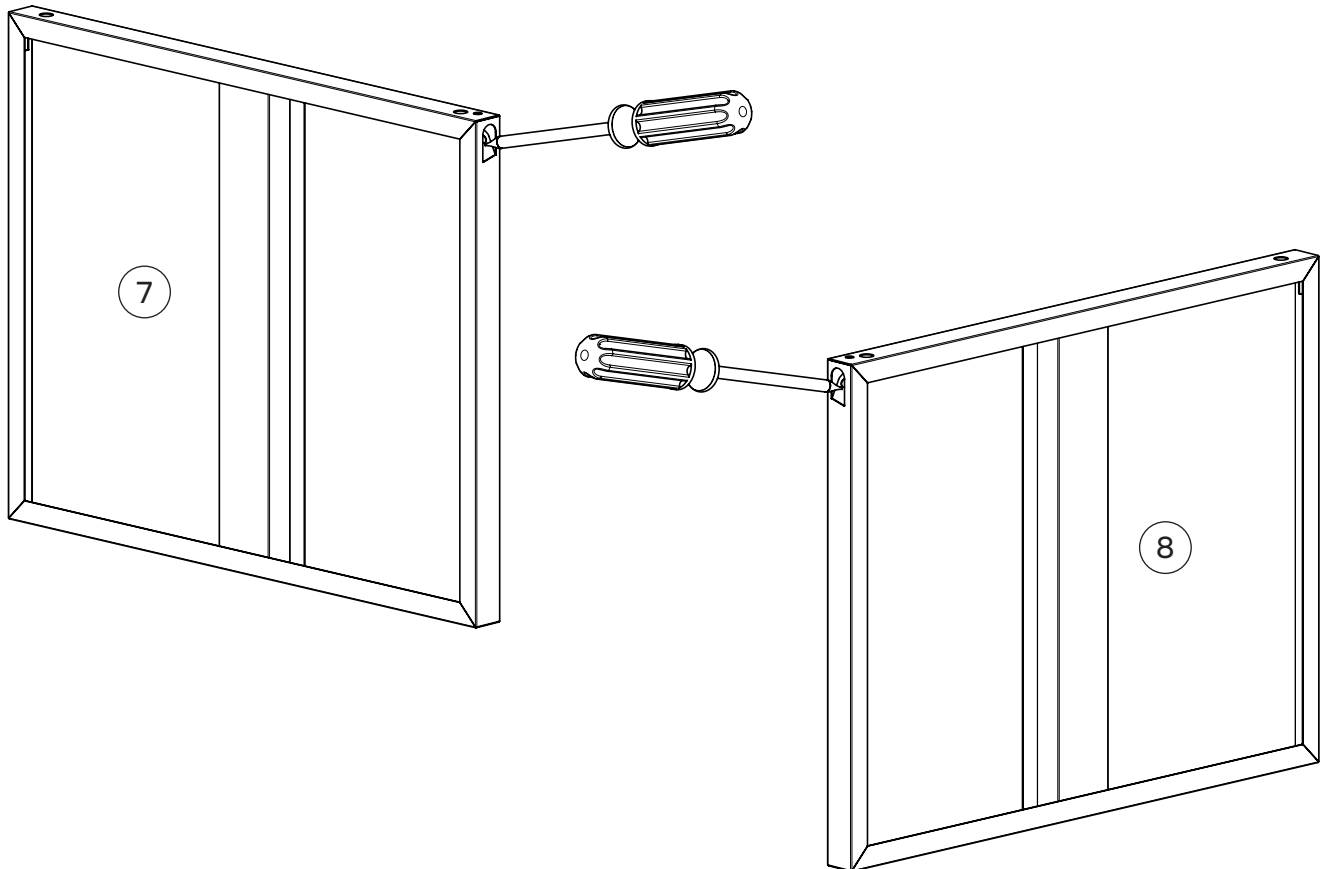

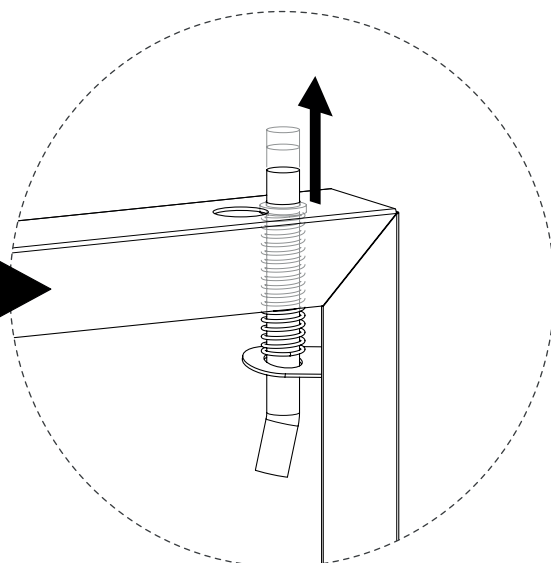
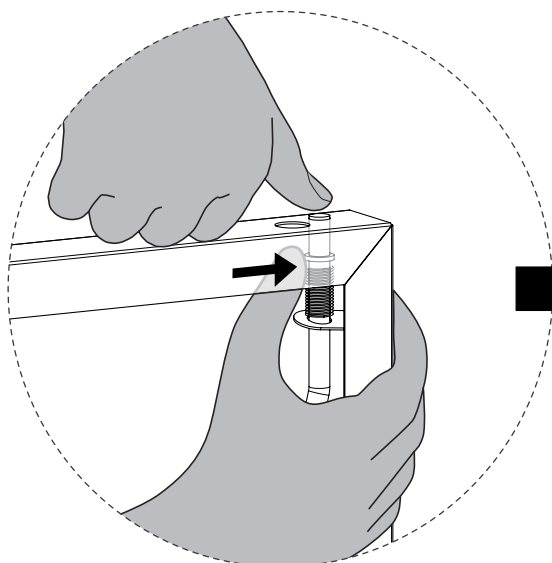
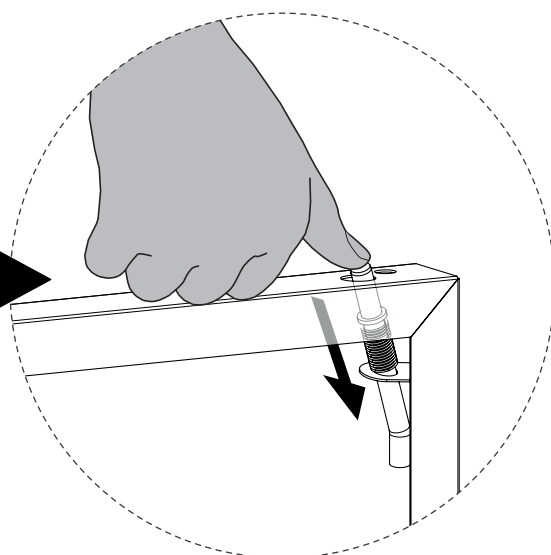
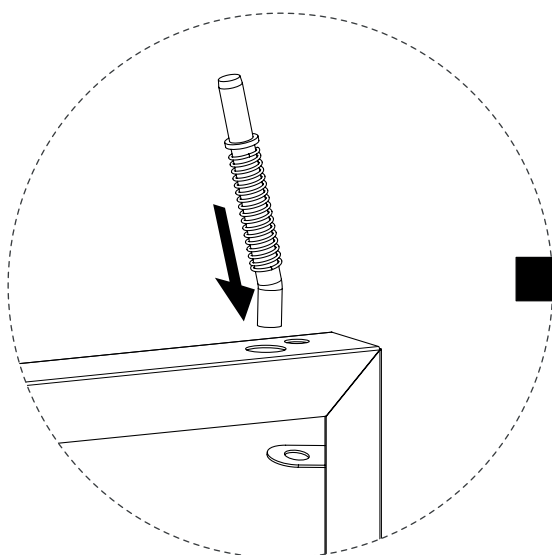
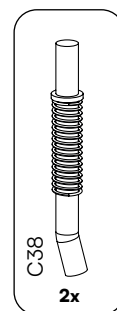
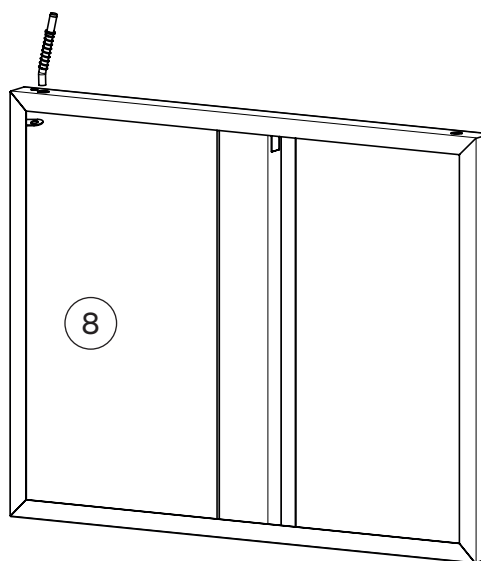
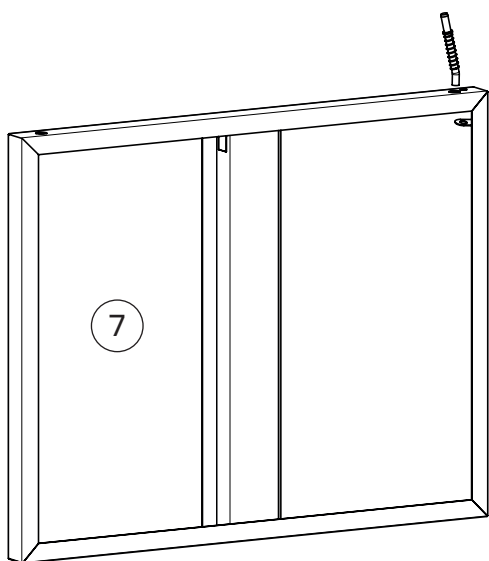

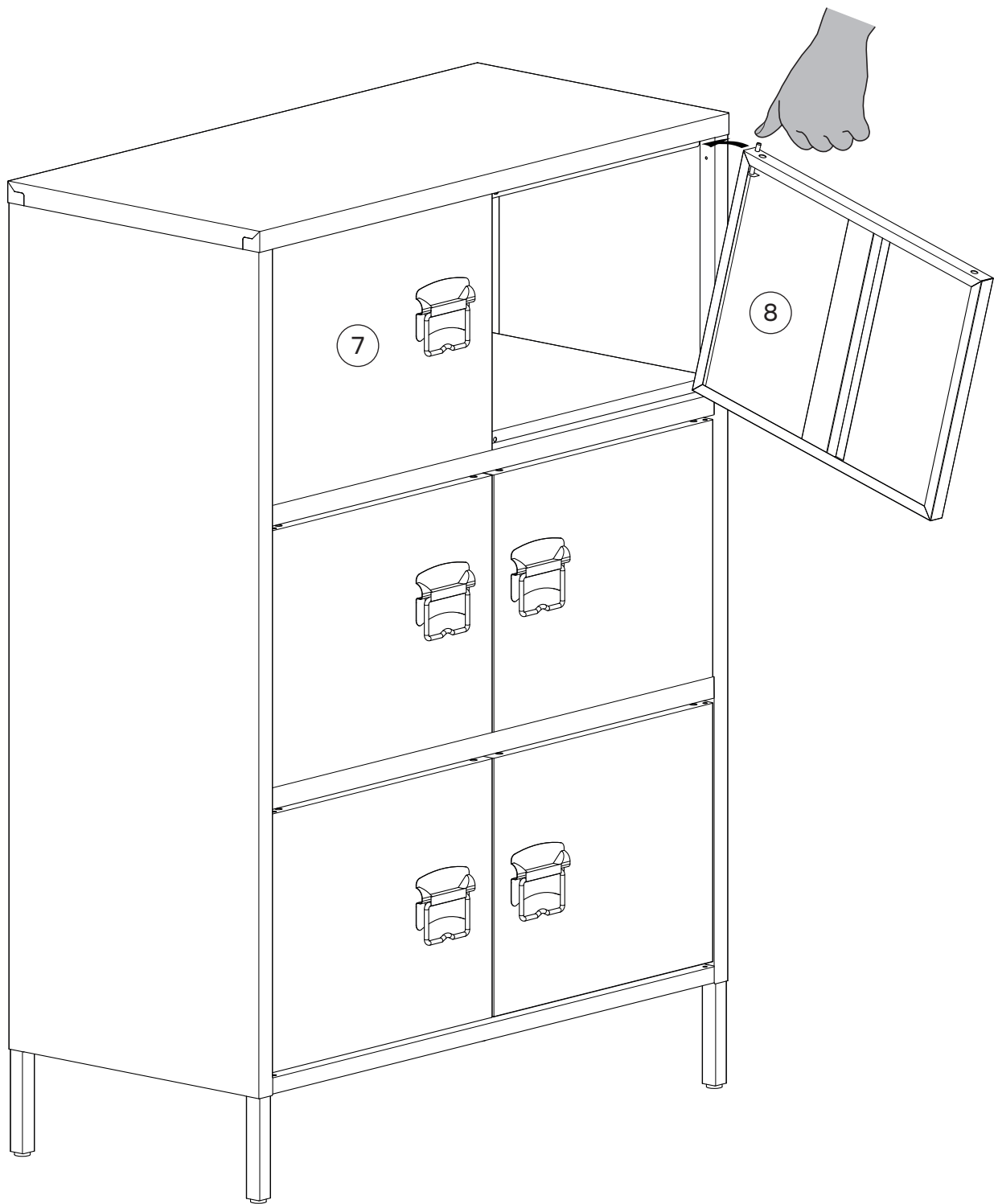

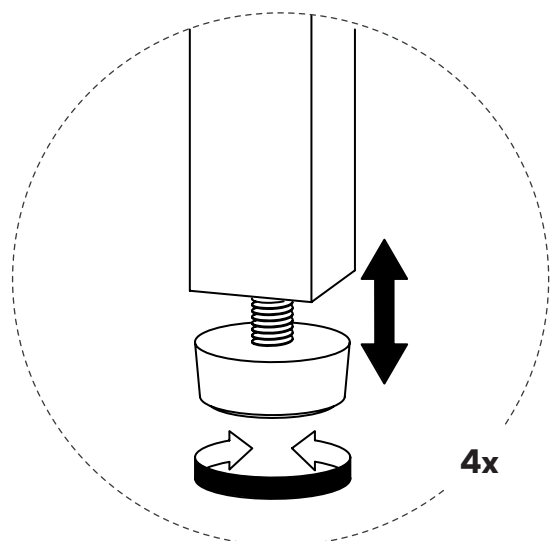
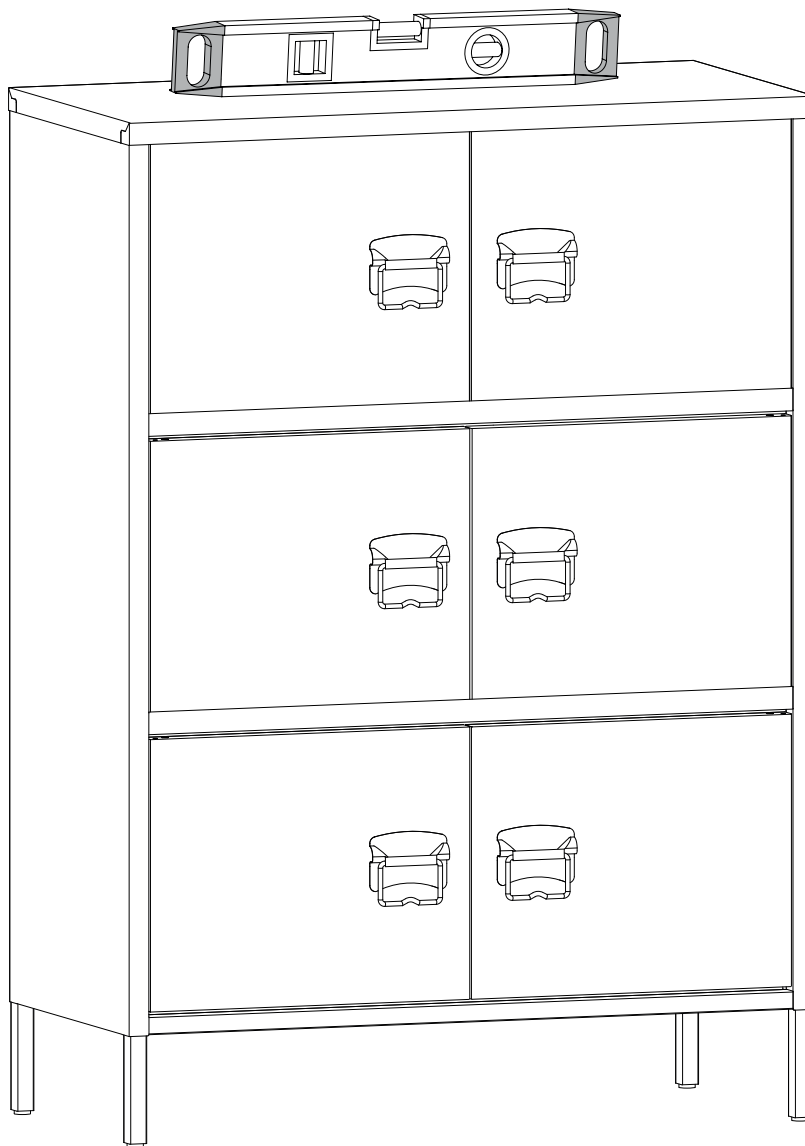

Geschafft!



