

skølm.

Atria
Lowboard

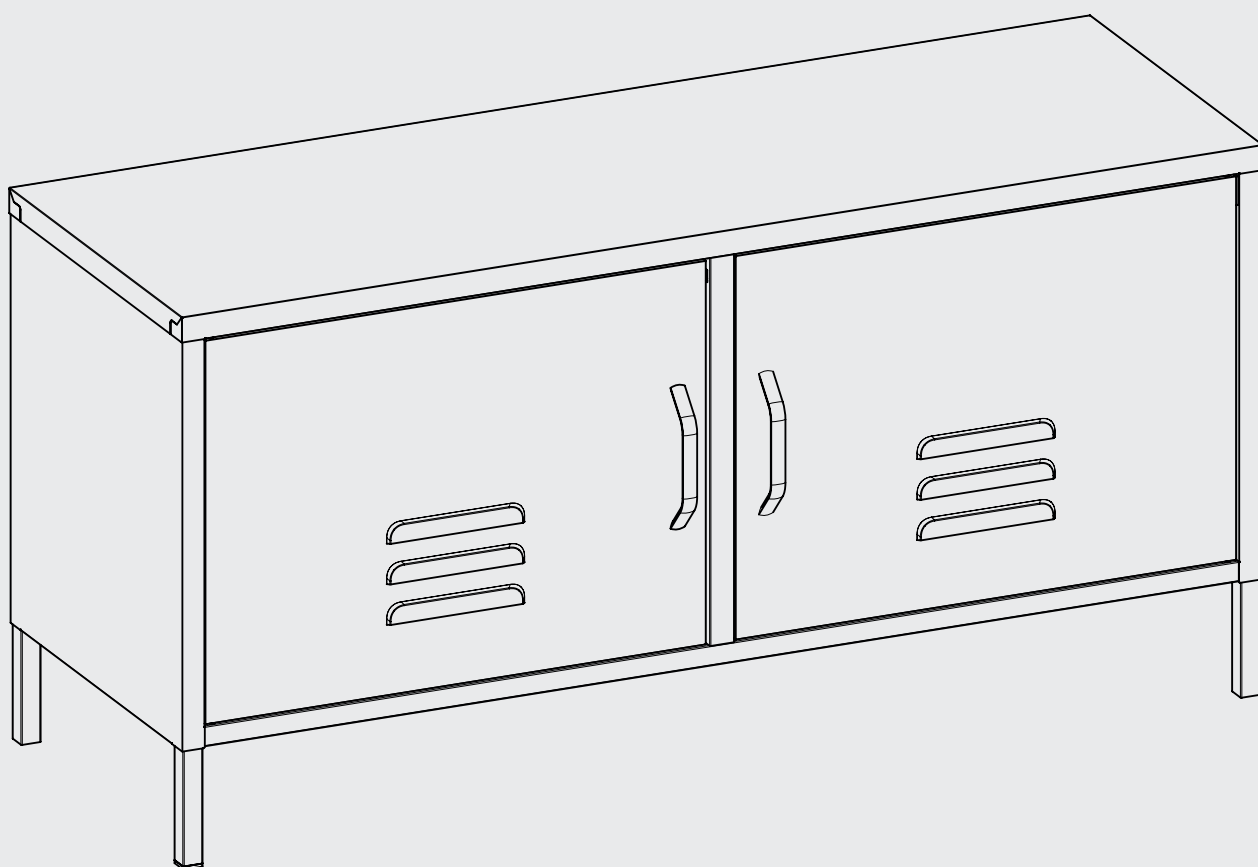



Hey,

wir freuen uns, dass Du Dich für unser Produkt entschieden hast. Beachte die kommenden Hinweise, um den Aufbau problemlos zu gestalten.

Viel Spaß mit Deinem Produkt!

50%

weniger Fehler beim Aufbau durch sorgfältiges Lesen der Anleitung

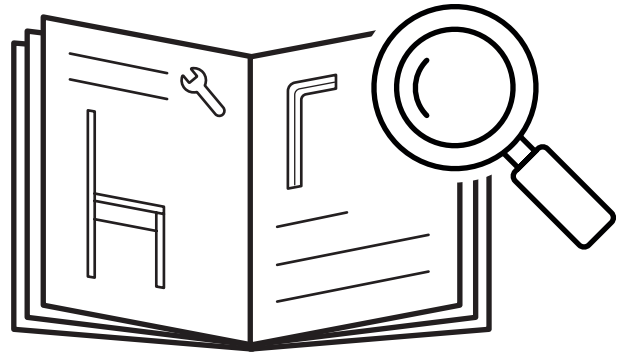

50-70

min



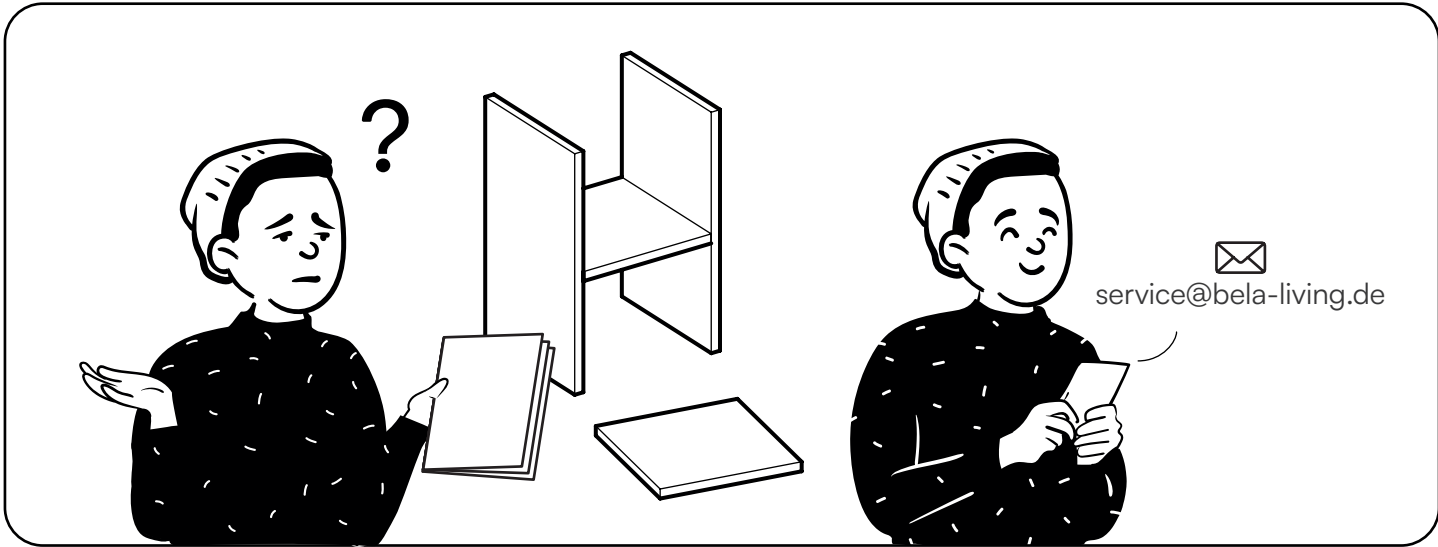
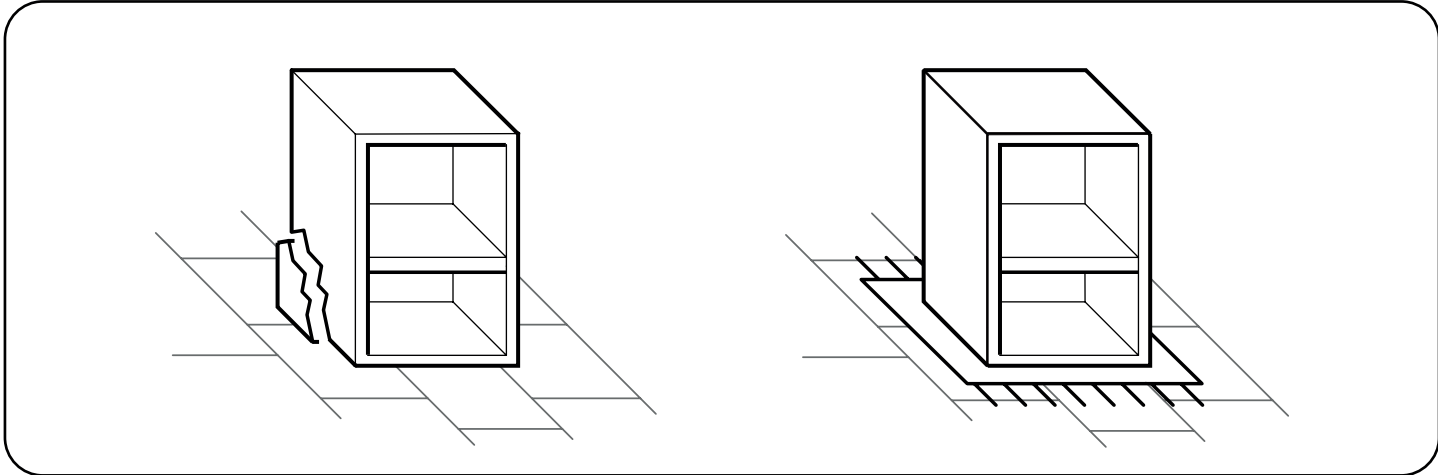

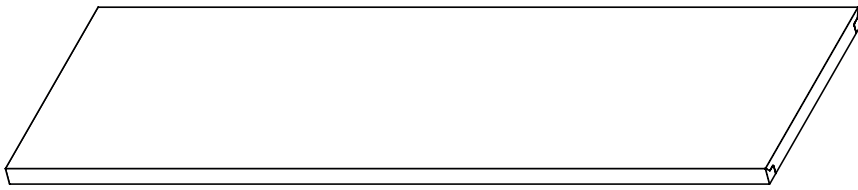

1 Oberboden
1x

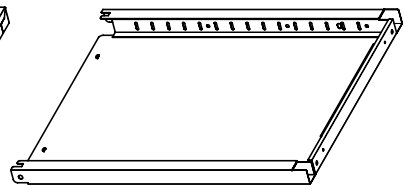

2 Seitenteil
2x

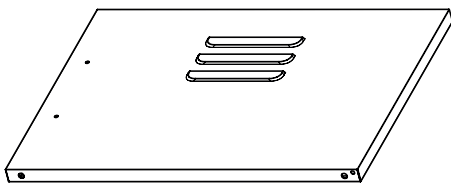

3 Tür, links
1x

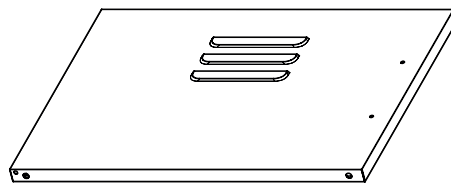

4 Tür, rechts
1x

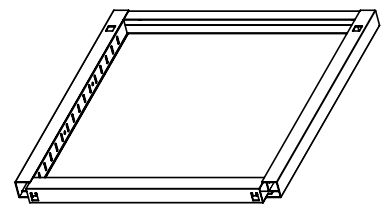

5 Mittelrahmen
1x

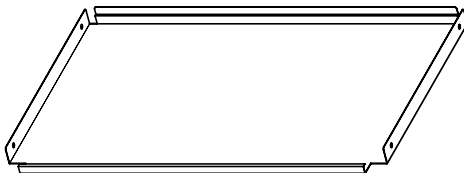

6 Boden
2x



7 Fach
2x



8 Griff
2x

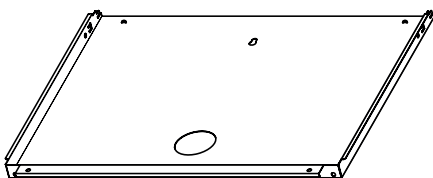

9 Rückwand
2x

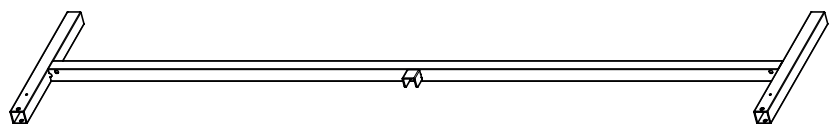

10 Fußgestell
2x

K22 - Schraube



4x

C14 - Bolzen

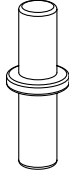

2x

K10 - Schraube



4x

L19 - Unterlegscheibe



2x

L80 - Fuß

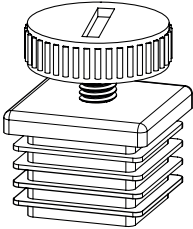

4x

L21 - Regalhalter

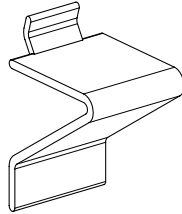

6x

L18 - Magnet

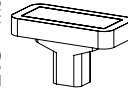

4x

2

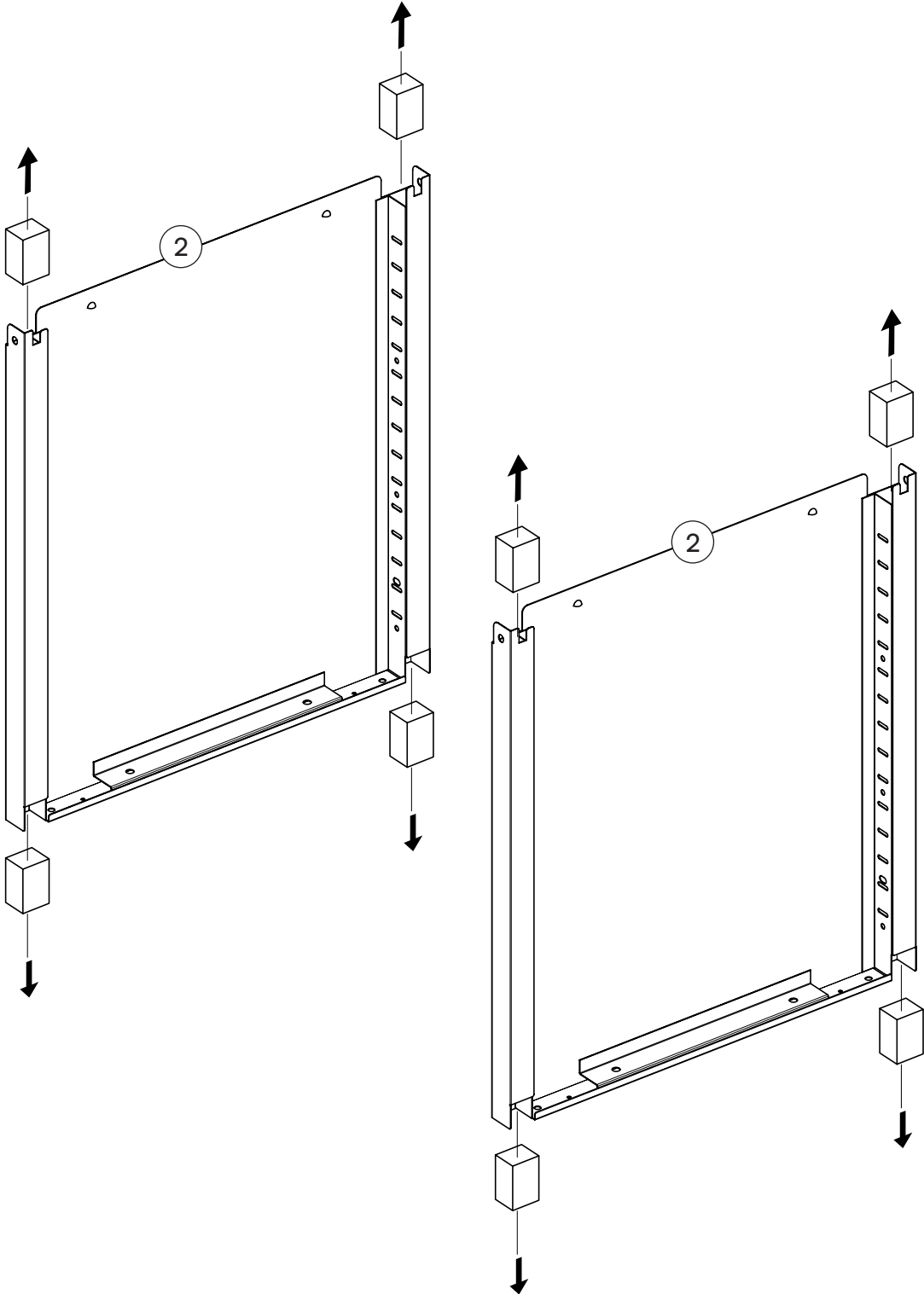

3

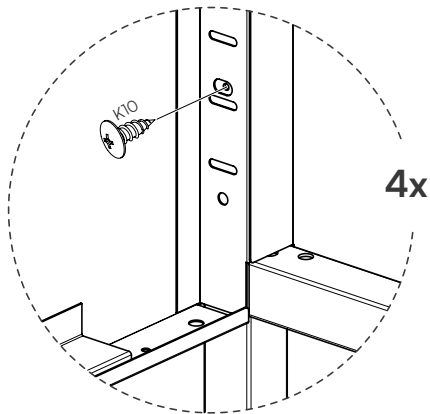
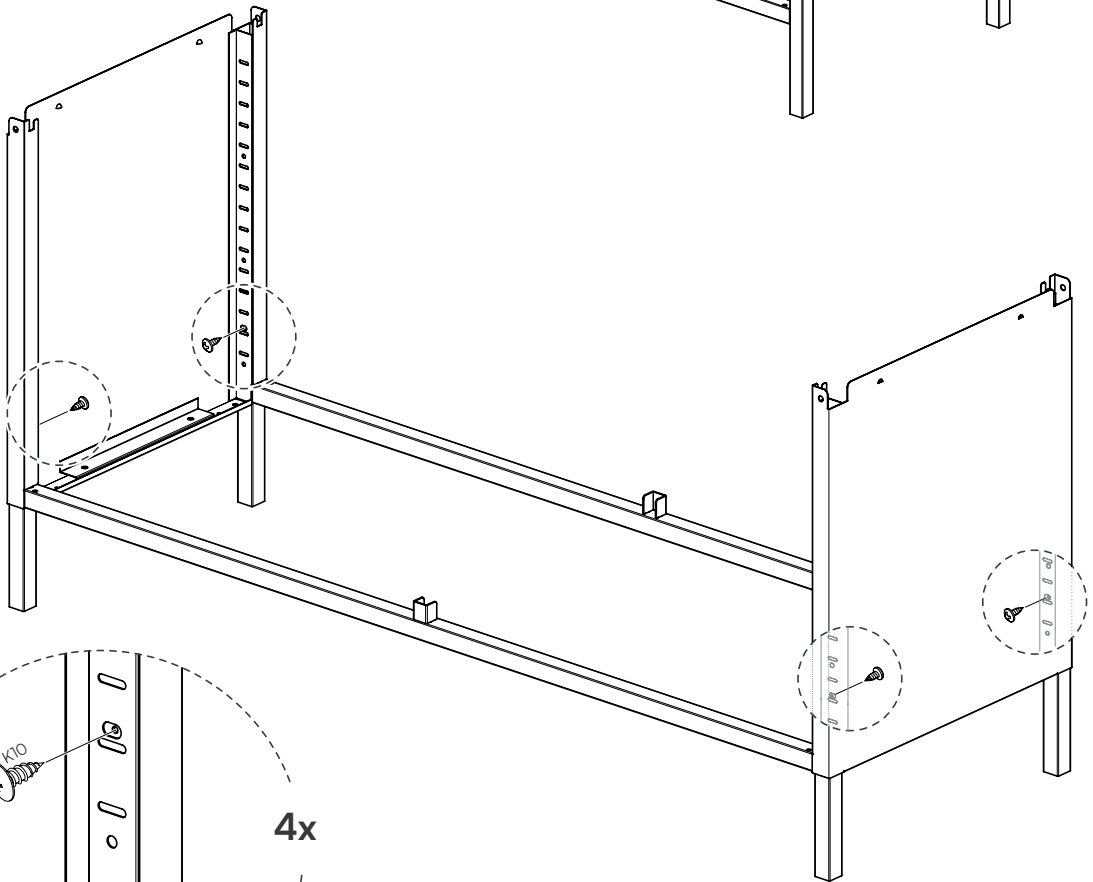
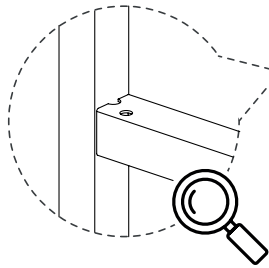
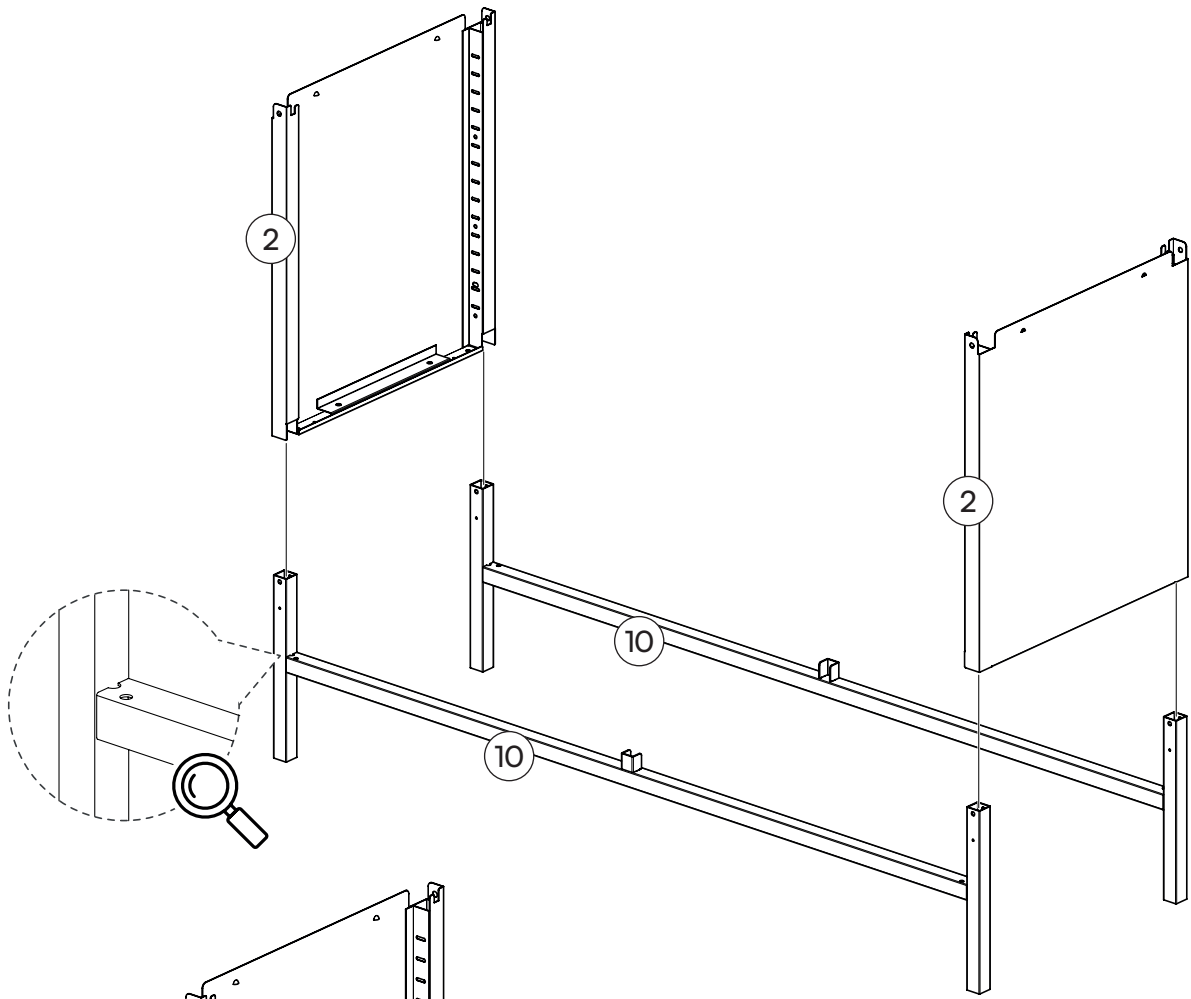
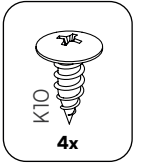

4

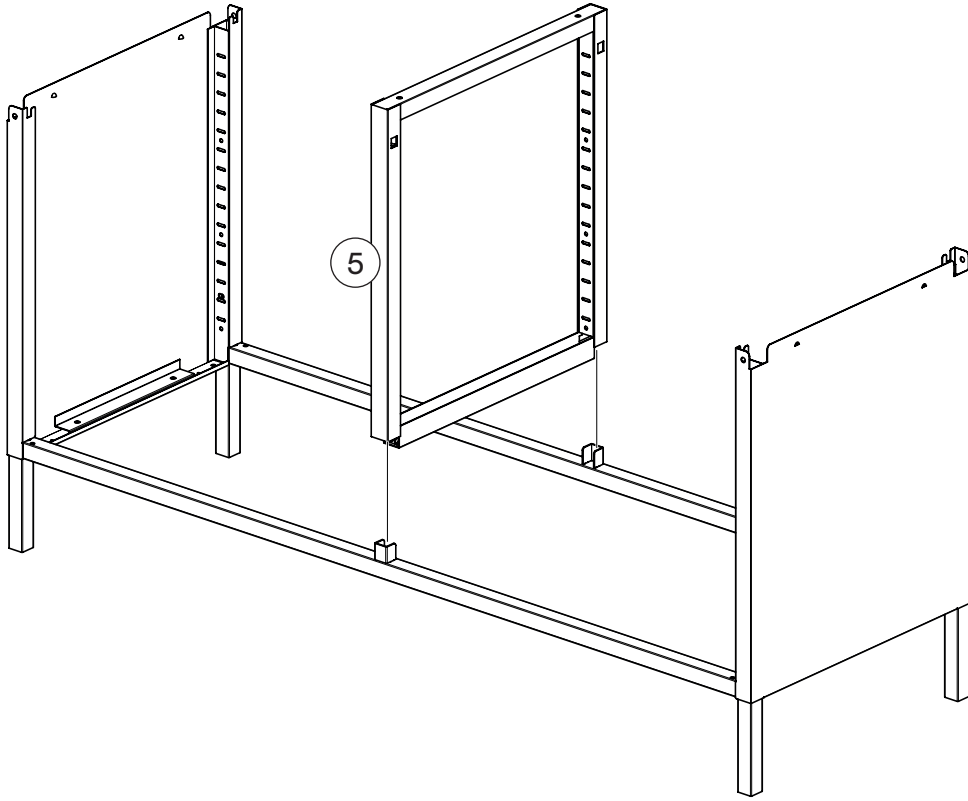

5

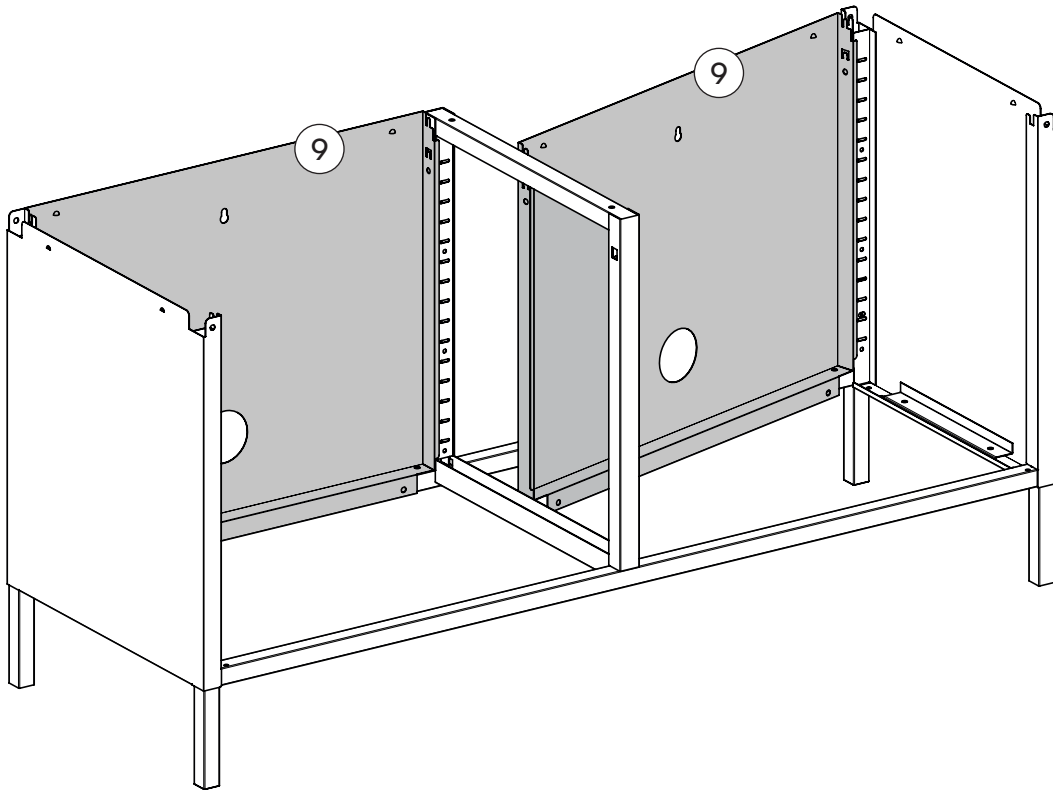

6

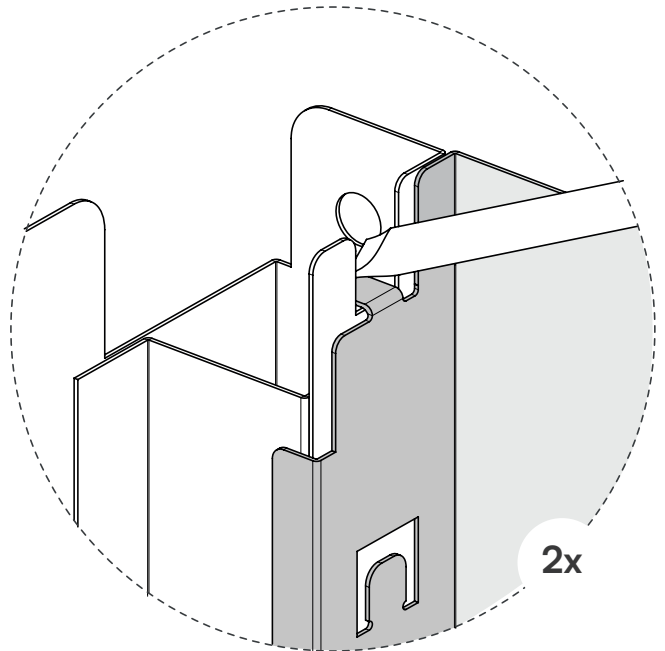
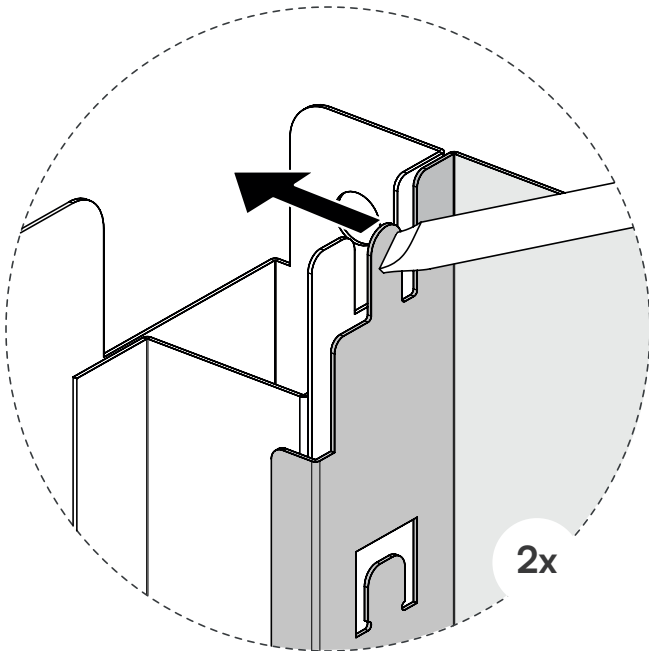
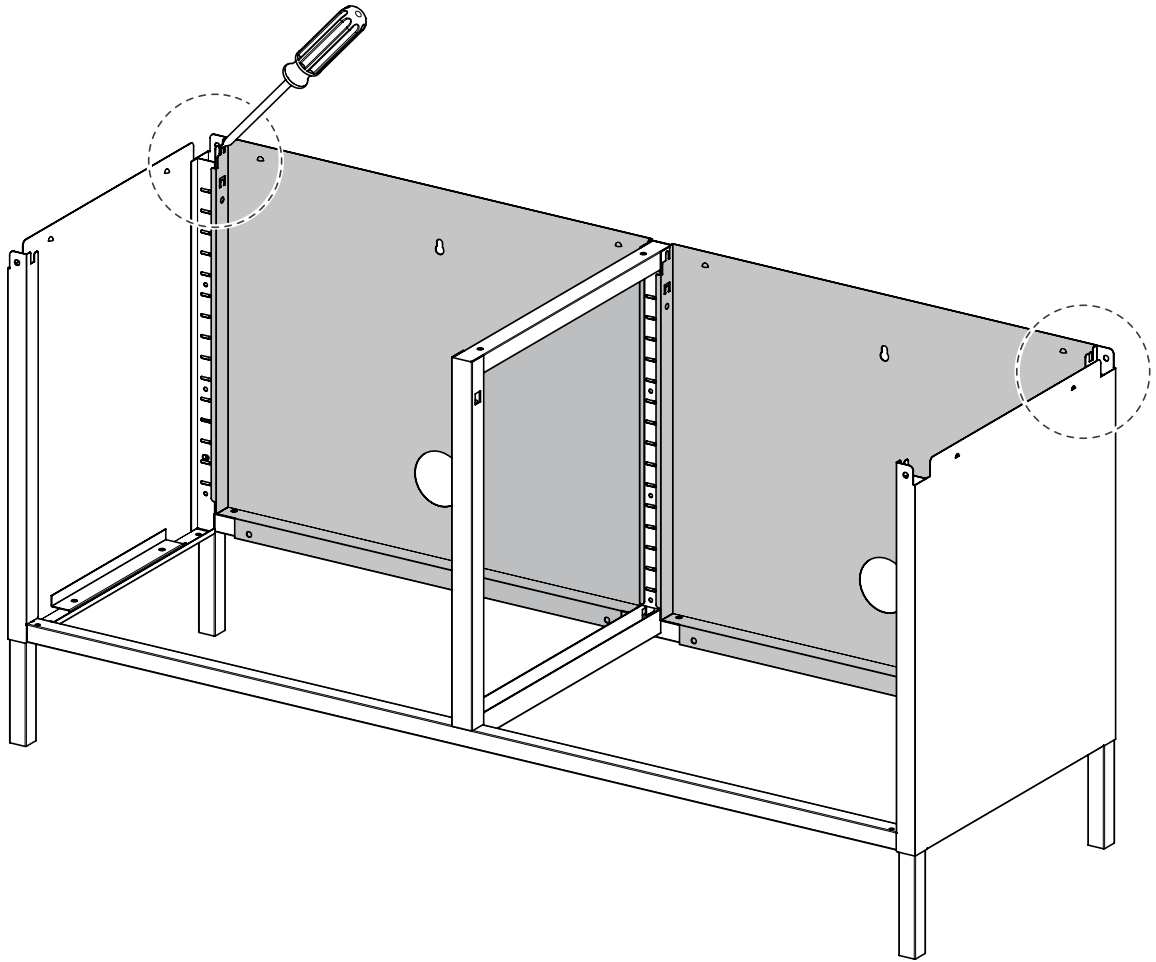

7

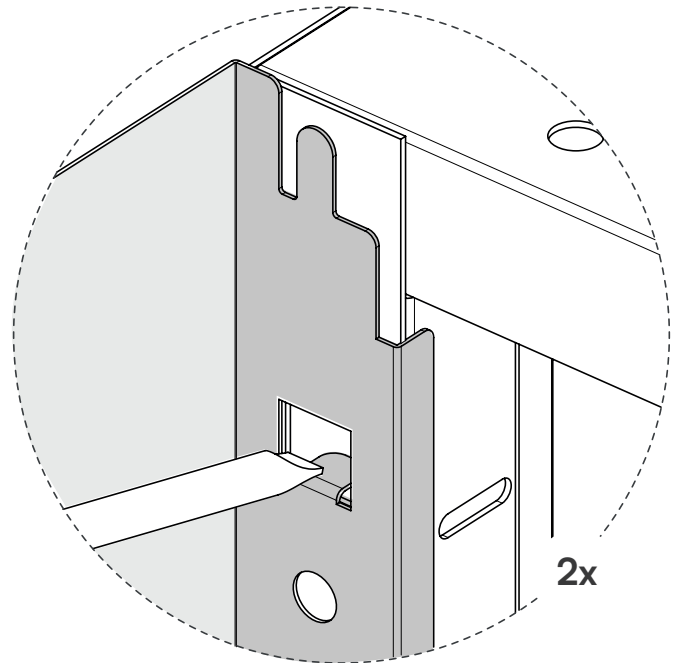
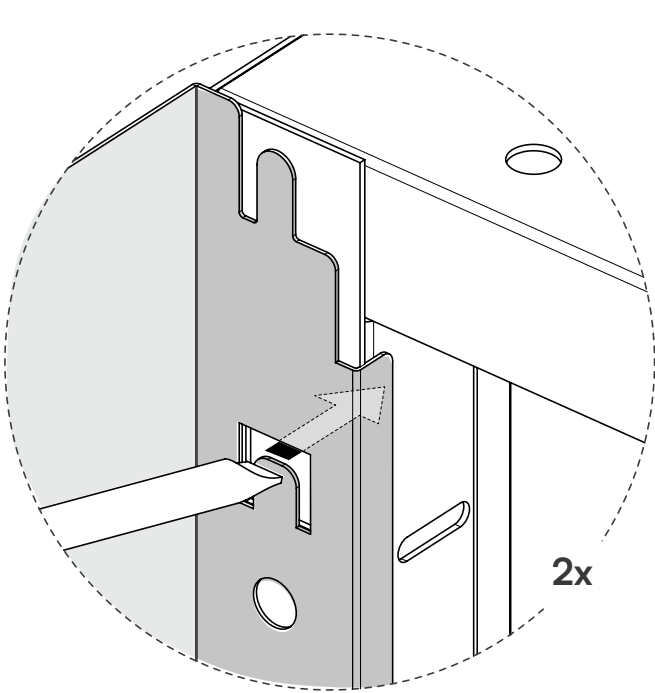
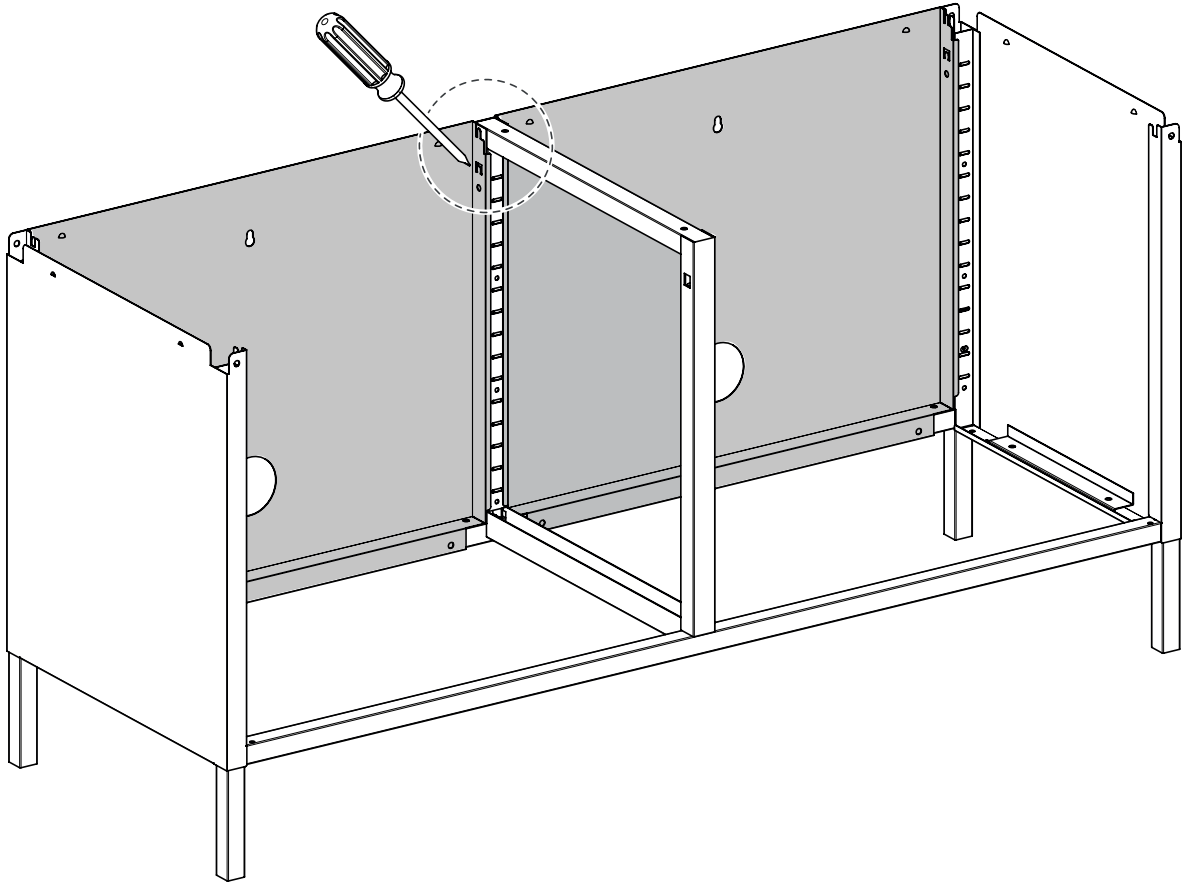

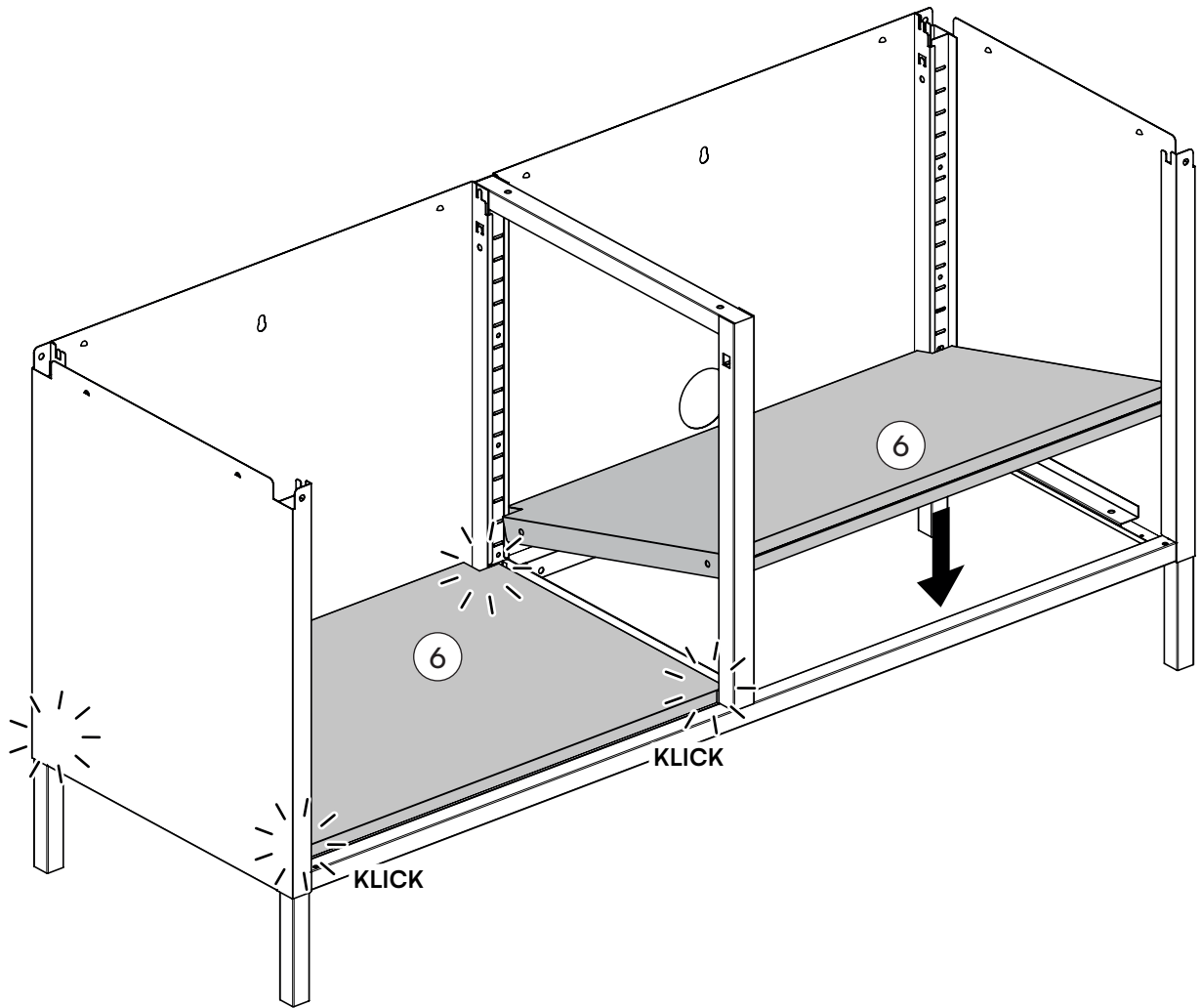

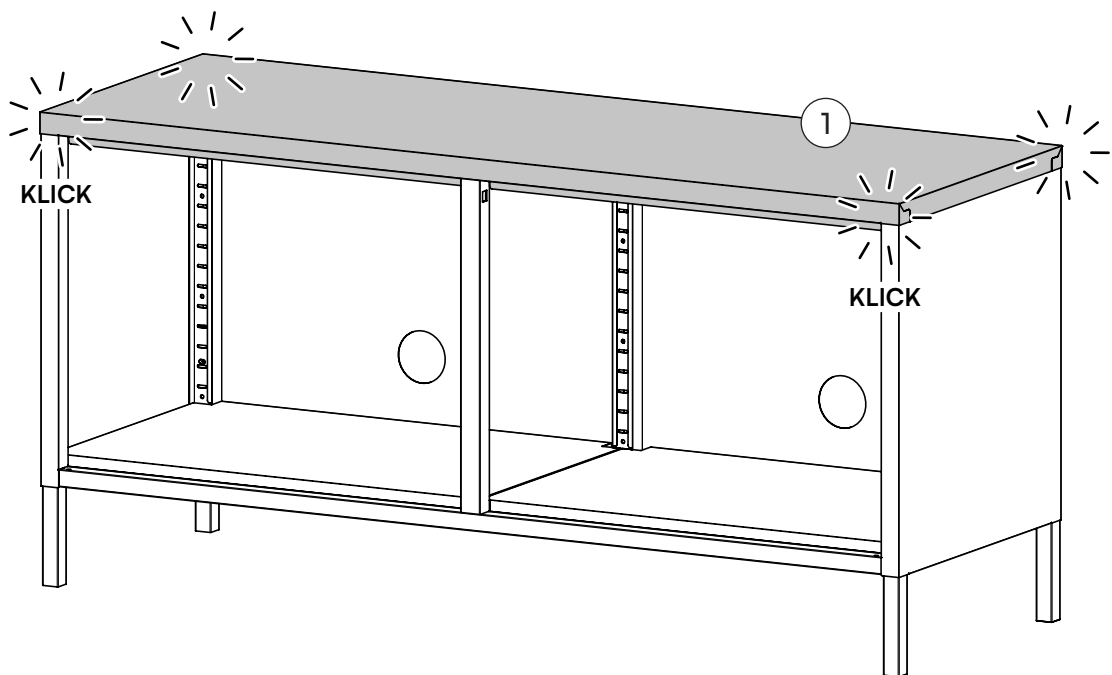
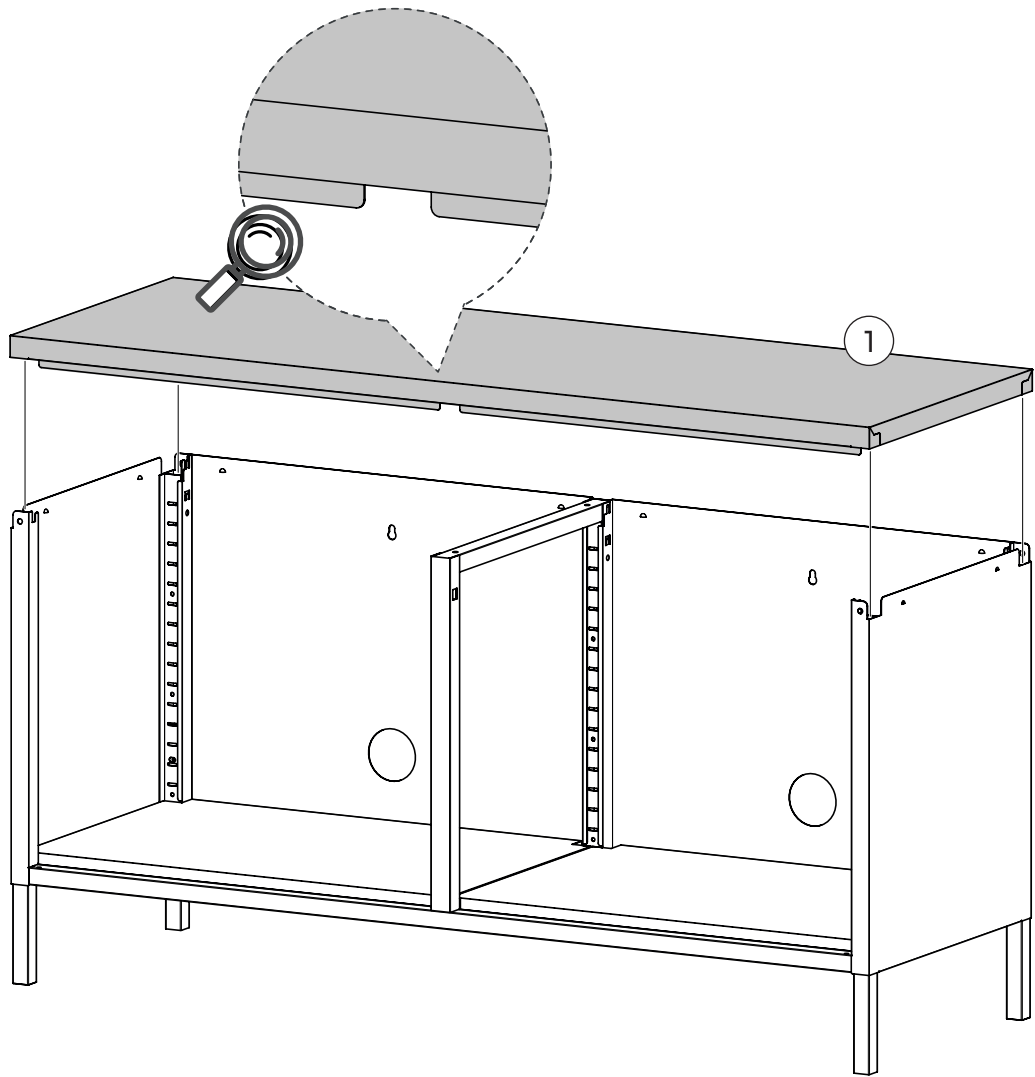

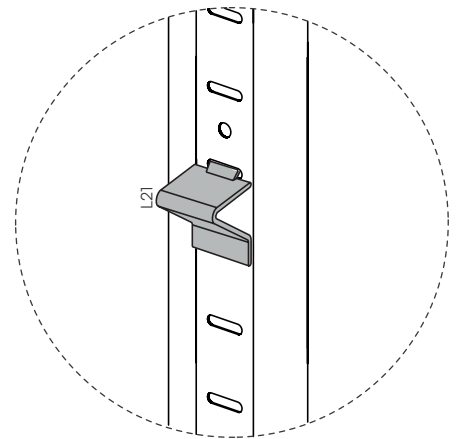
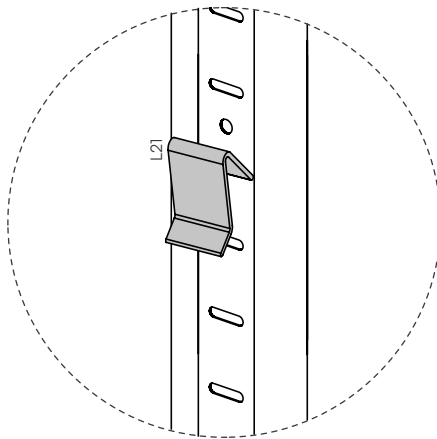
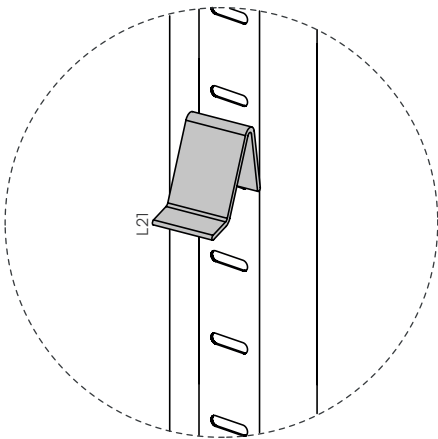
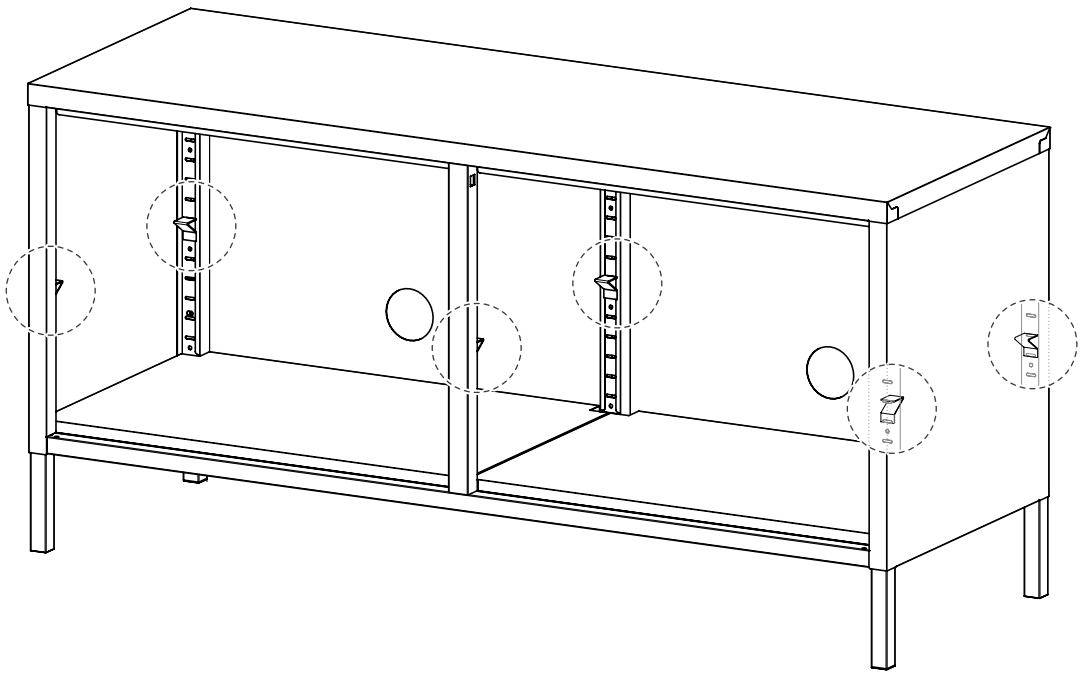
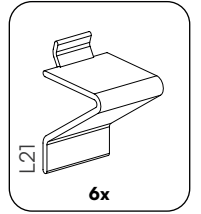

11

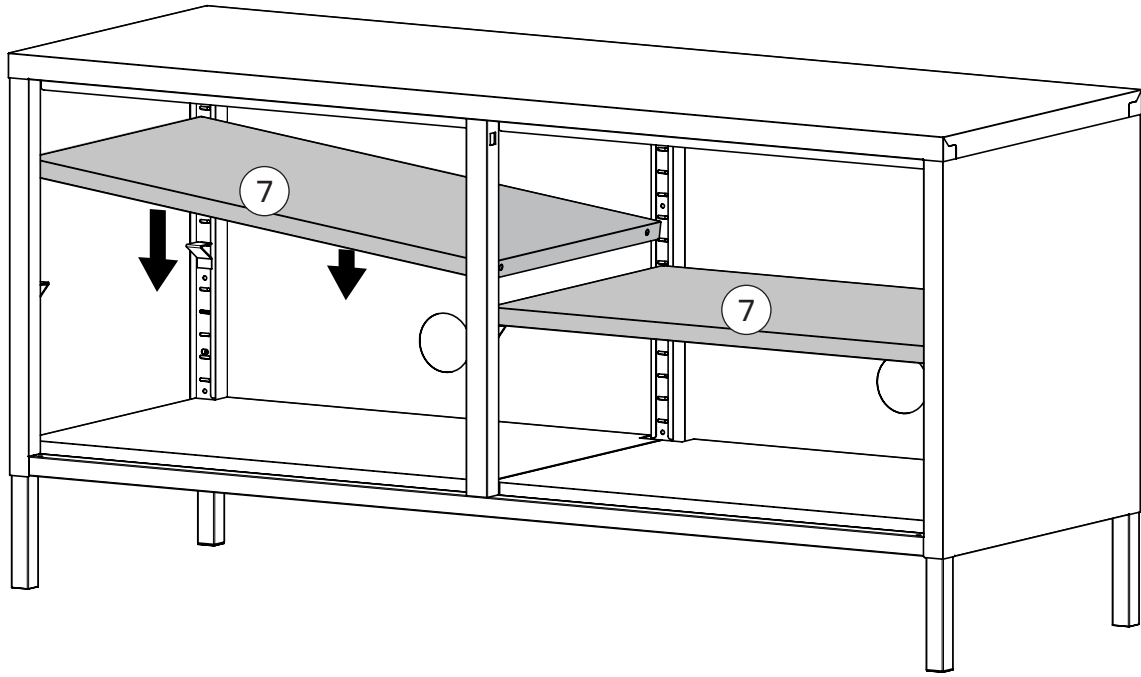

12

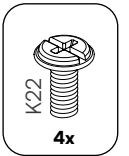
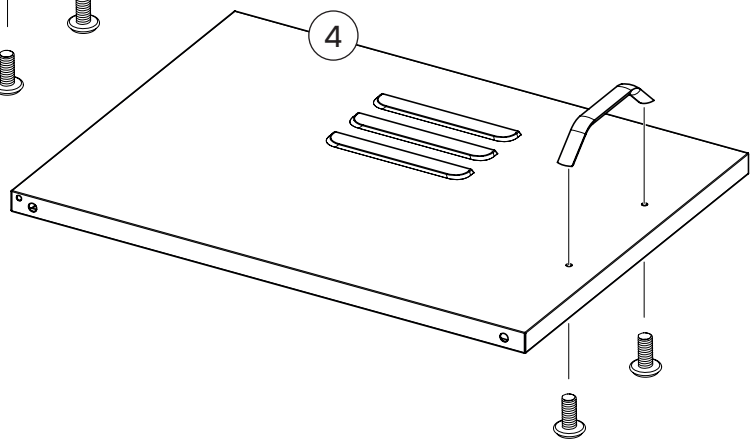
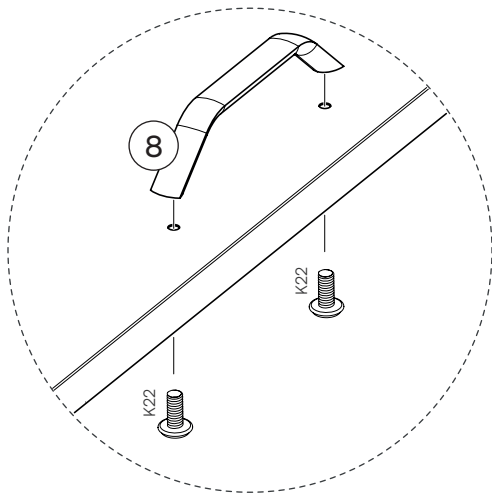
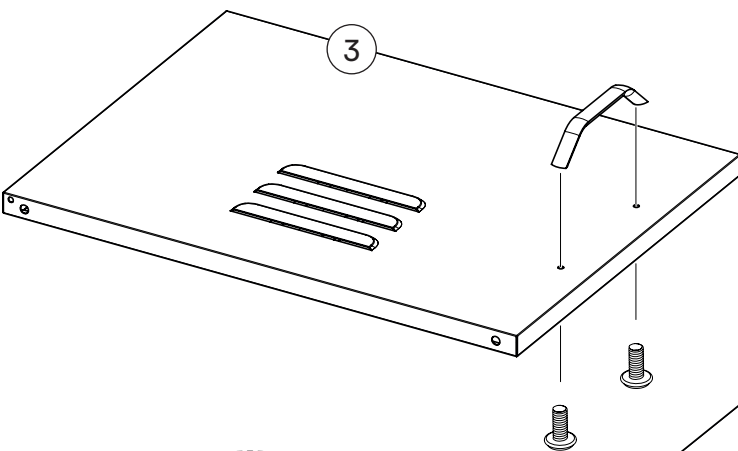

13

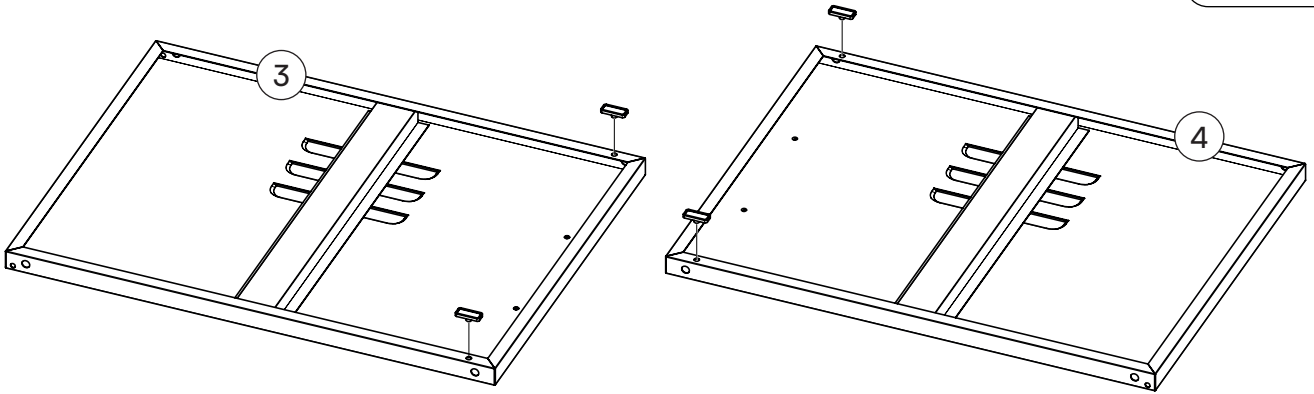
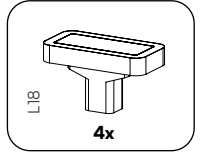

14

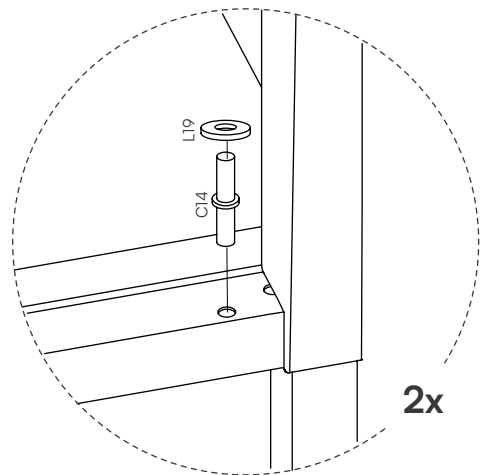
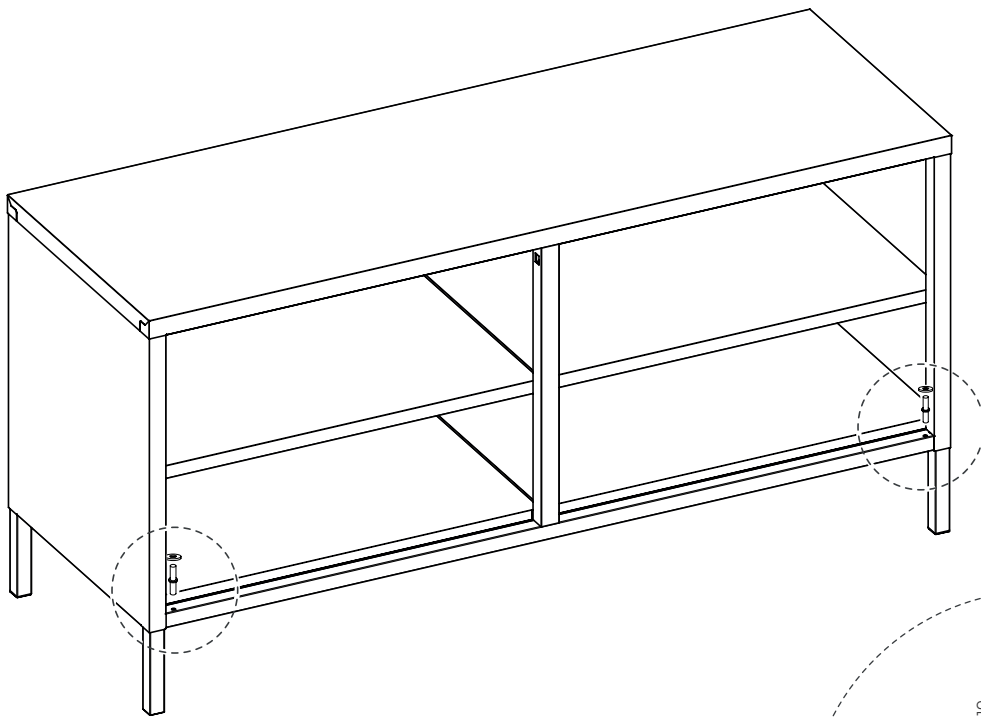
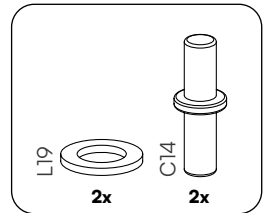

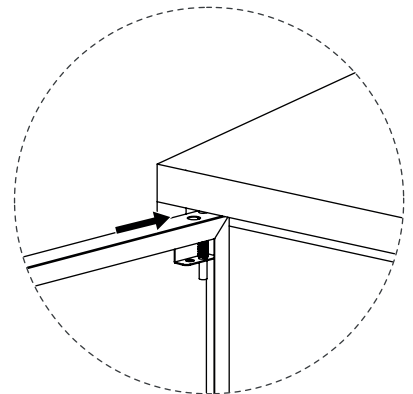
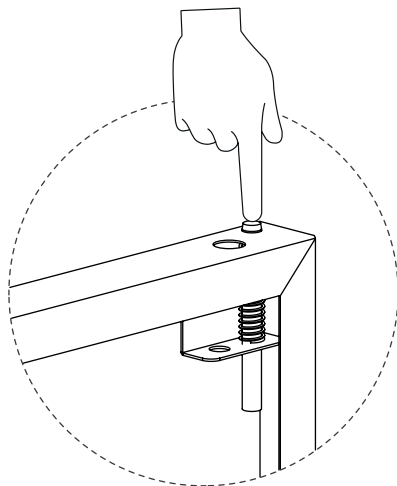
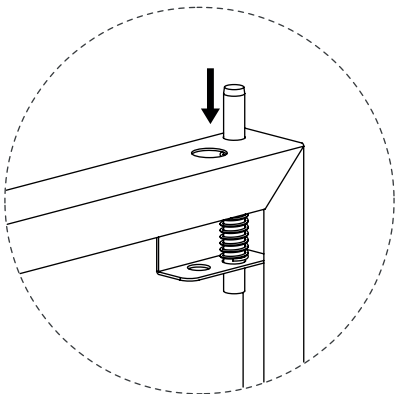
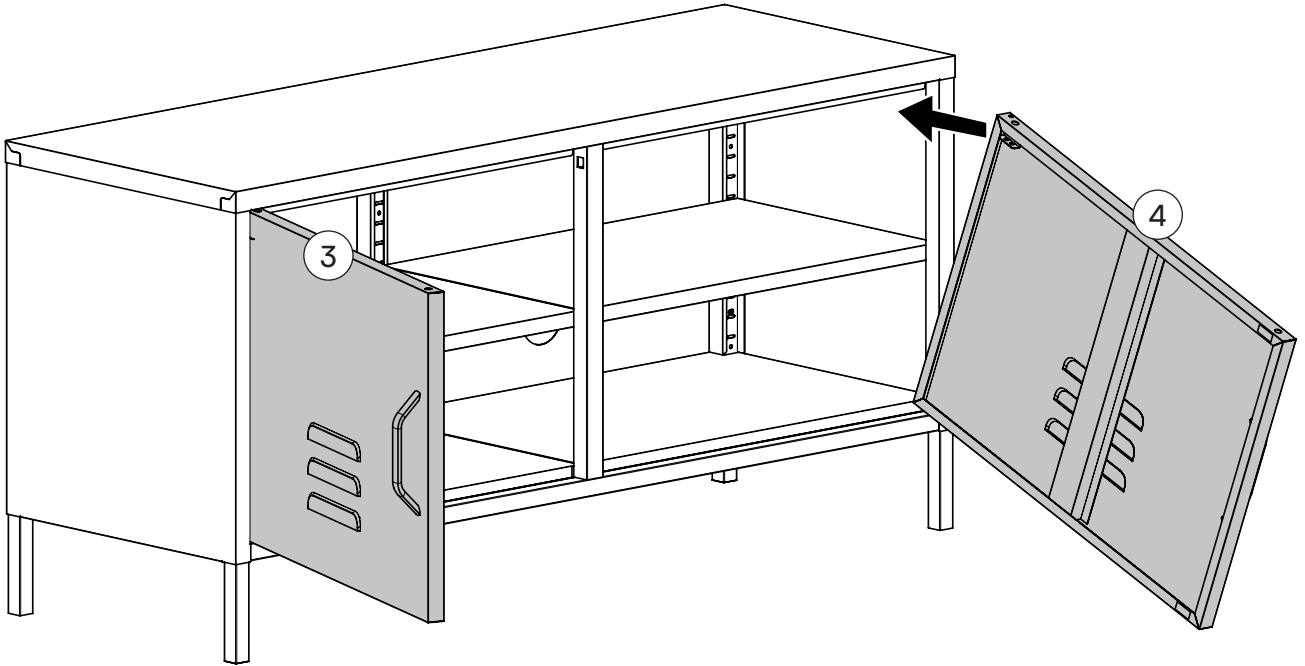

16

