

RIMINI

18963218

LKZ 42416 / 75033

12

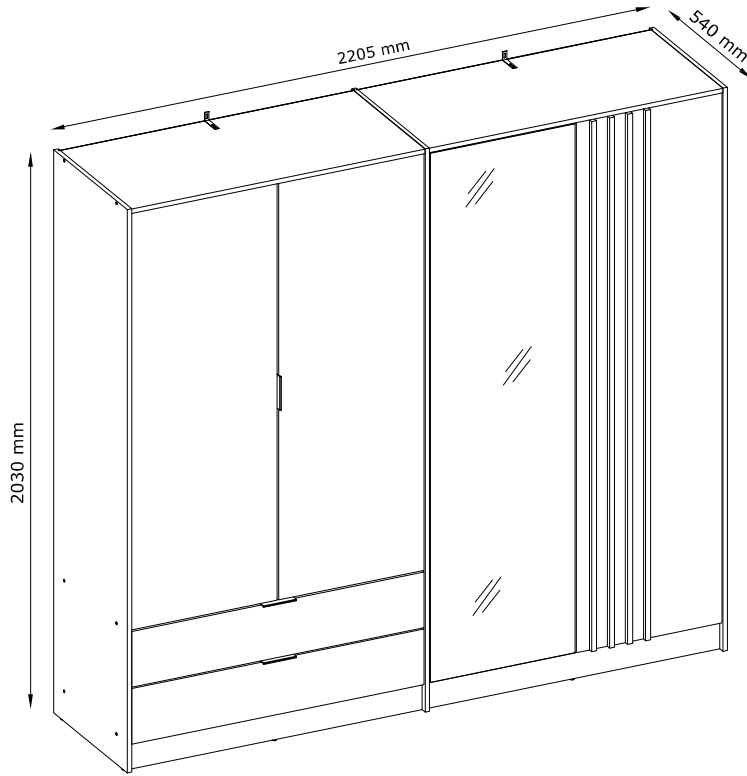

D

Montageanleitung

Kleiderschrank >Rimini<

FR

Notice de montage

Armoire >Rimini<

NL

Handleiding voor de montage

Kast >Rimini<

CZ

Montážní návod

Kabinet >Rimini<

HU

Szerelési útmutató

Szekrény >Rimini<

TR

Montaj talimatı

Dolap >Rimini<

GB

Assembly instructions

Wardrobe >Rimini<

IT

Intruzioni di montaggio

Armadio >Rimini<

PL

Instrukcja montażu

Szafa >Rimini<

SK

Návod na montáž

Skriňa >Rimini<

RO

Instructiuni de montaj

Cabinet >Rimini<

RU

Инструкция по монтажу

Шкаф >Rimini<

SRB

Упутства за инсталацију

Гардеробу >Rimini<

HR

Upute za instalaciju

Ormar >Rimini<

SL

Návod na montaž

Kabinet >Rimini<

LT

Surinkimo instrukcijos

Kabinetas >Rimini<

LV

Montāžas instrukcija

Ministru kabinets >Rimini<

EE

Kokkupaneku juhised

Kabinet >Rimini<

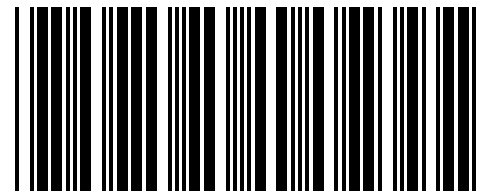
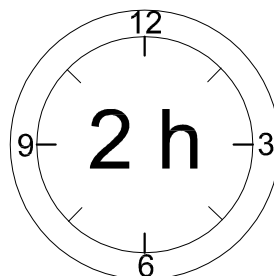
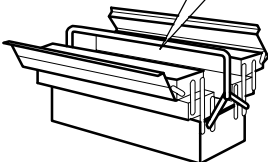
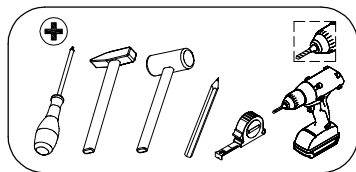
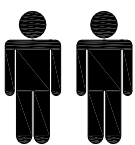

* 2 3 3 6 2 1 *

D-Ziehen Sie alle Schrauben sowie tragende Verbindungsteile nach ca. 5 Wochen nach, um ein dauerhafte Standsicherheit zu gewährleisten.

GB-After approx. 5 weeks, tighten all screws and load-bearing connecting parts to ensure permanent stability.

FR-Resserrez toutes les vis ainsi que les pièces de fixation au bout d'environ 5 semaines pour garantir une sécurité de fixation durable.

IT- Ristringere tutte le viti e giunture dopo ca. 5 settimane, al fine di garantire una durevole solidità.

NL-Draai alle schroeven en ook dragende verbindingstukken na ca. 5 weken nog eens vast, zodateen continue stabiliteit wordt gegarandeerd.

PL-Prosimy po ok. 5 tygodniach dokręcić wszystkie śruby i elementy łączeniowe. Zagwarantuje to Państwu trwałość i stabilność połączeń.

CZ- Dotáhněte všechny šrouby a nosné spojovací díly přibližně po 5 týdnech, aby se zaručila trvalá stabilita.

SK-Po cca 5 týždňoch dotiahnite skrutky, aby bola zaručená ich trvalá stabilita.

HU-Húzza utána - kb. 5 hét múlva - az összes csavart és a teherhordó összekötő-alkatrészeket abiztonság érdekében.

RO-Pentru a asigura o stabilitate de durată, strângeți după cca. 5 săptămâni toate șuruburile, precumși toate elementele portante de legătură.

TR-Tüm vida ve taşıyıcı bağlantı parçalarını kalıcı bir duruş güvenliğini sağlamak için yaklaşık 5 haftasonra tekrar sıkınız.

RU - Подкрутите все болты, а также несущие соединительные детали припл. через 5 недель для обеспечения устойчивости в течение длительного времени.

SRB - Molim vas после акрокса. 5 недеља затегните све шрафове и причвршћиваче. То ће вам гарантовати трајност и стабилност веза.

HR - Molim vas, nakon cca. 5 tjedana zategnite sve vijke i pričvršćivače. To će vam jamčiti trajnost i stabilnost priključaka.

SL - Pýtame sa po cca. 5 týždňov utiahnite všetky skrutky a upevňovacie prvky. To zaručuje trvanlivosť a stabilitu spojov.

LT - Mes prašome po maždaug. 5 savaites priveržkite visus varžtus ir tvirtinimo detales. Taip užtikrinamas jungčių patvarumas ir stabilumas.

LV - Mēs lūdzam pēc apm. 5 nedēļas, pievelciet visas skrūves un stiprinājumus. Tas garantē savienojumu izturību un stabilitāti.

EE - Küsime pärast ca. 5 nädalat, pingutage kõiki kruvisid ja kinnitusi. See tagab ühenduste vastupidavuse ja stabiilsuse.

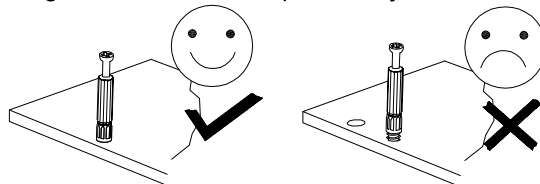

D Bitte nur mit einem Staubtuch oder leicht feuchtem Lappen reinigen. Keine scheuernden Putzmittel verwenden.

GB Please only clean with a duster or a damp cloth. Do not use any abrasive cleaners.

FR Veuillez nettoyer uniquement avec un chiffon à poussière ou un chiffon légèrement humide. N'pas utiliser de détergent abrasif.

IT Si raccomanda di pulire solo con un panno per la polvere o uno strofinaccio umido. Non utilizzare detersivi abrasivi.

NL Reinig alleen met een stofdoek of een lichtjes vochtige doek. Gebruik geen schurende poetsmid-delen.

PL Czyszczenie należy wykonać wyłącznie za pomocą ściereczki lub lekko nawilżonego ręcznika. Nie stosować środków czyszczących do szorowania.

CZ Čistěte prosím jen prachovkou nebo lehce navlhčeným hadrem. Nepoužívejte drhňoucí čisticí prostředky.

SK Na čistenie používajte len prachovku alebo zľahka navlhčenú utierku. Nepoužívajte žiadne drhňúce čistiace prostriedky.

HU Kérjük, csak portórlő kendővel vagy enyhén nedves ronggyal tisztítsa. Ne használjon dörzshatású tisztítószert.

RO Vă rugăm să utilizați la curățare exclusiv o cârpă de șters praful sau o cârpă ușor umezită. Nu utilizați substanțe de curățat abrazive.

TR Lütfen sadece bir toz beziyle veya hafif nemli yumuşak bir bezle siliniz. Aşındırıcı temizlik malze-meleri kullanmayınız.

RU Для чистки используйте, пожалуйста, тряпку для пыли или слегка влажную ветошь. Неиспользовать абразивные чистящие средства.

SBR Чишћење треба обавити само крпом или благо влажним пешкиром. Немојте користити средство за чишћење рибања.

HR Čišćenje treba obaviti samo krpom ili blago navlaženim ručnikom. Ne koristite sredstva za čišćenje ribanja.

SL Čistenie by sa malo vykonávať len handričkou alebo ľahko navlhčeným uterákom. Nepoužívajte čistiace prostriedky na drhnutie.

LT Valyti galima tik šluoste arba lengvai sudrėkintu rankšluosčiu. Nenaudokite šveičiamųjų valiklių.

LV Tīršana jāveic tikai ar drānu vai viegli samitrinātu dvieli. Neizmantojiet tīršanas līdzekļus.

EE Puhastada tohib ainult lapiga või kergelt niisutatud rätikuga. Ärge kasutage puhastusvahendeid.

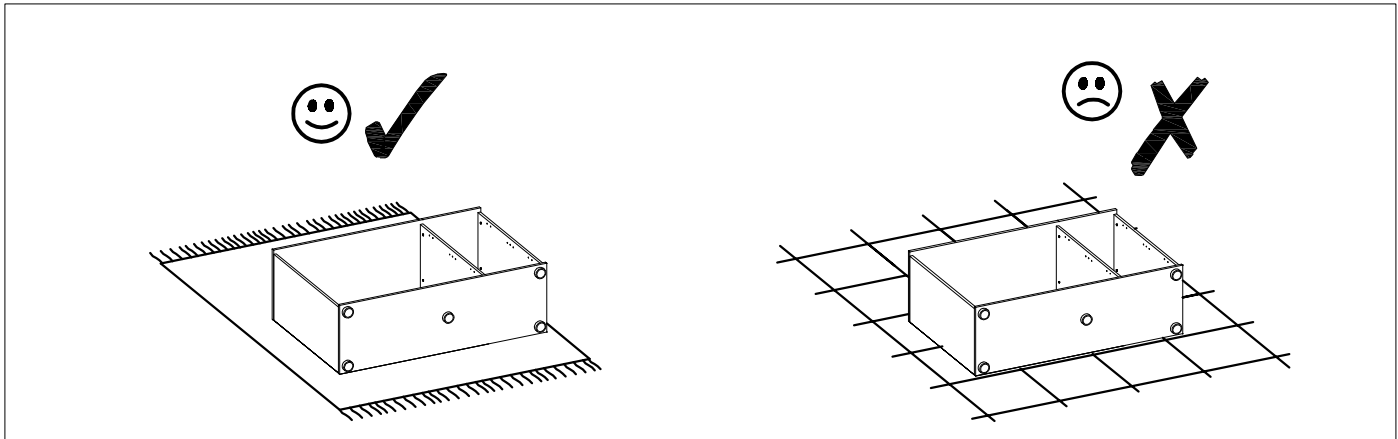
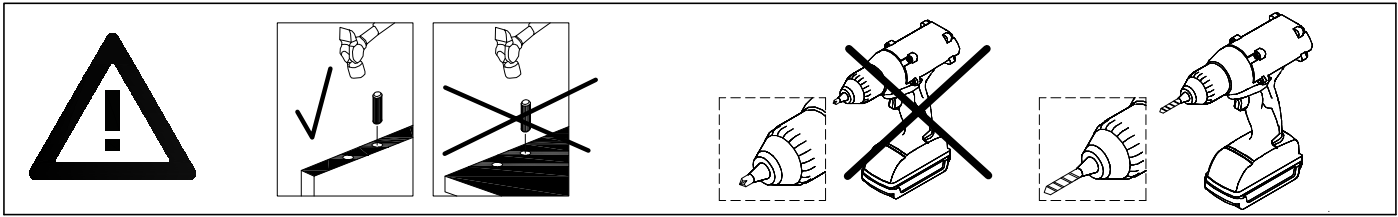
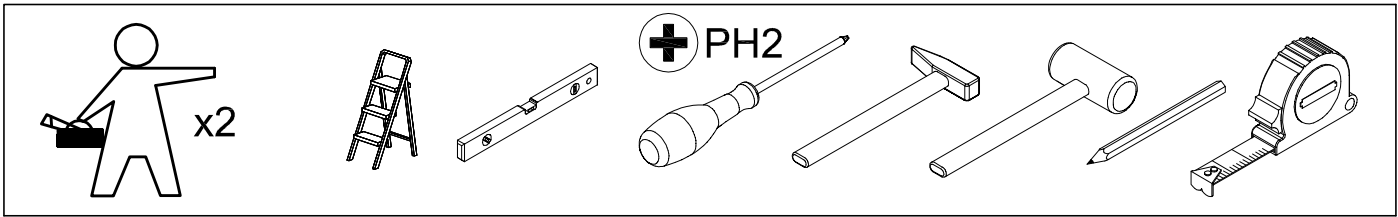

Service · Assistenza · Dienstverlening · Serwis Servis · Szerviz · Сервисная служба · Сервис · Serwis · Servis

Name · Nom · Nome · Naam ·
Nazwa · Jméno · Názov · Név ·
Denumire · Isim · Название

Typ · Type · Tip · Tipus · Тiпо ·
Тип

Rimini

12

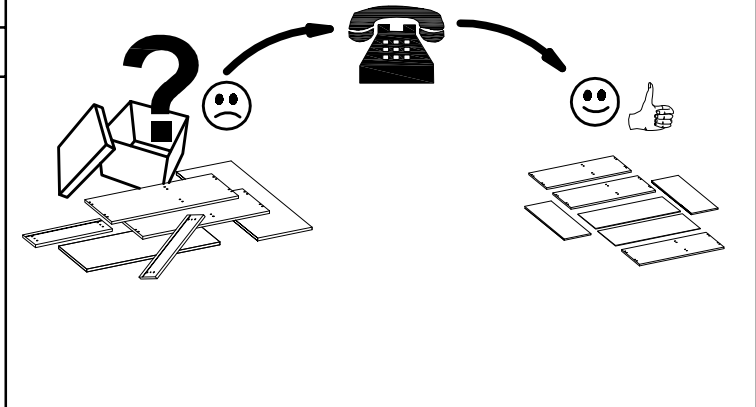
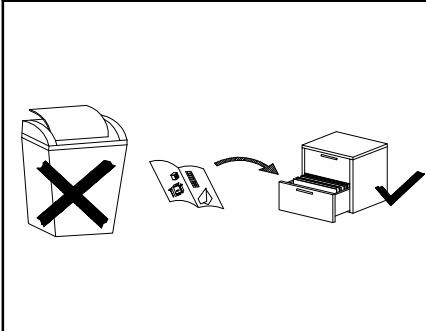

A Ø8x30 mm x20 3989	B Ø8x50 mm x4 3991	C Ø8x50 mm x8 3991	D Ø6,5x36,5 mm x4 4066	E Ø15x12 mm x12 3996
F Ø6,5x76 mm x4 4062	G 15x14x11 mm x20 4044	H Ø5x16 mm x16 4017	I Ø3,5x16 mm x50 3918	J Ø6,0x13 mm x8 3877
K Ø3,0x20 mm x22 3914	L Ø4,0x25 mm x16 145556	M Ø6,4x50mm x24 3884	N 4 mm x1 3984	O x14 70313
P 42x17x20 mm x4 4069	R 75x15x32 mm x2 71900	S Ø20 mm x2 136239	T Ø20 mm x4 136239	U Ø10 mm x10 142727
W L-350mm x2 kpl 3804	X Ø35 mm , KR15 x12 68850	Y L-120 mm x3 209928	Z L-1068 mm x2 72529	
A1 L-332 mm x2 67701	B1 L-1890 mm x2 217025			

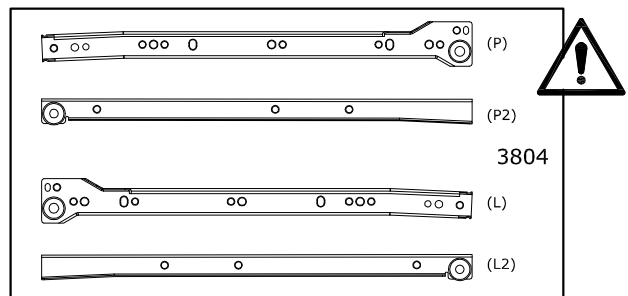
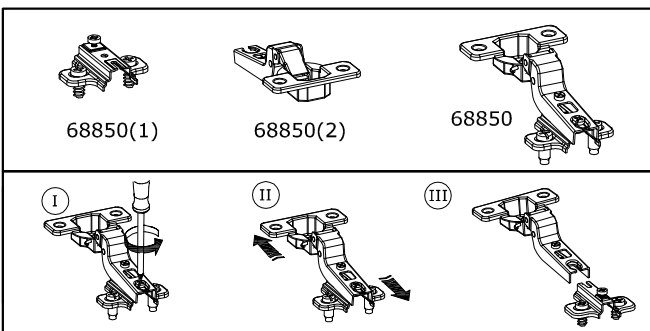

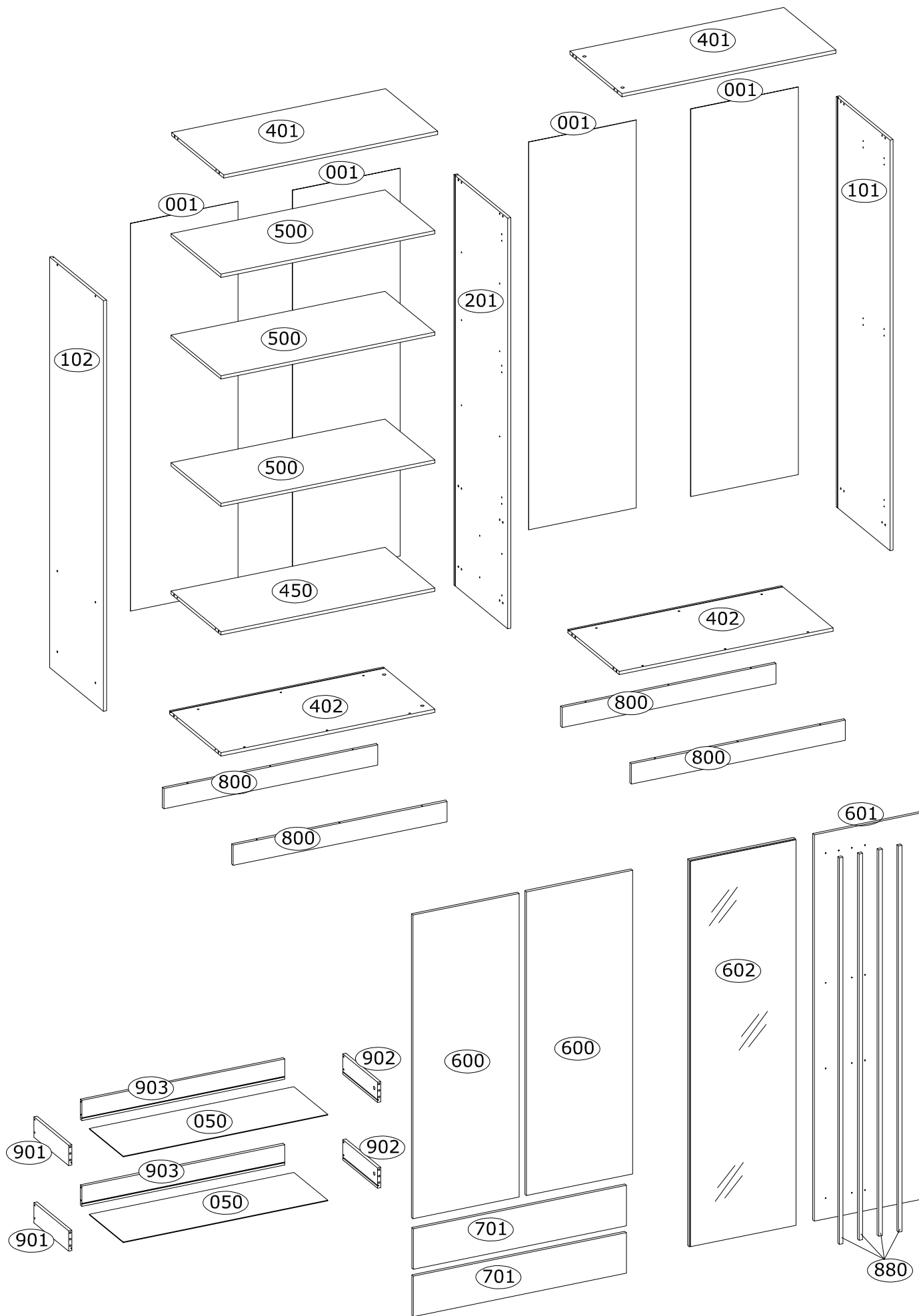

1

A Ø8x30 mm x8 3989	E Ø15x12 mm x4 3996	
------------------------------------	-------------------------------------	--

2x

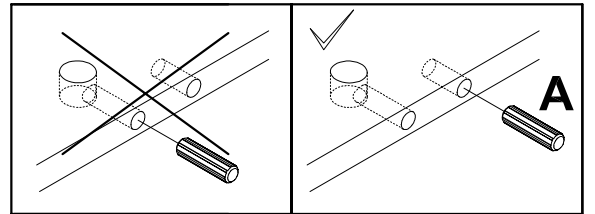
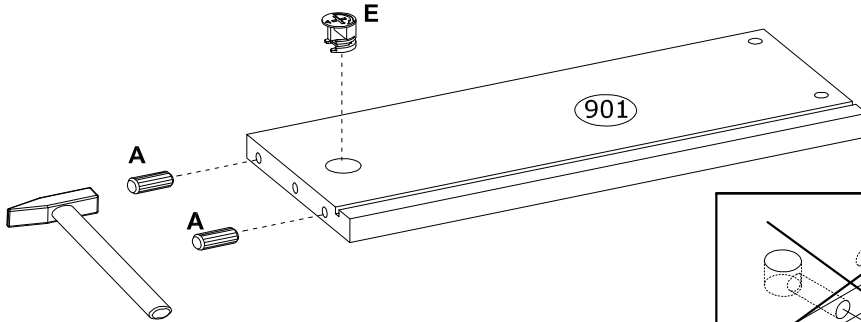
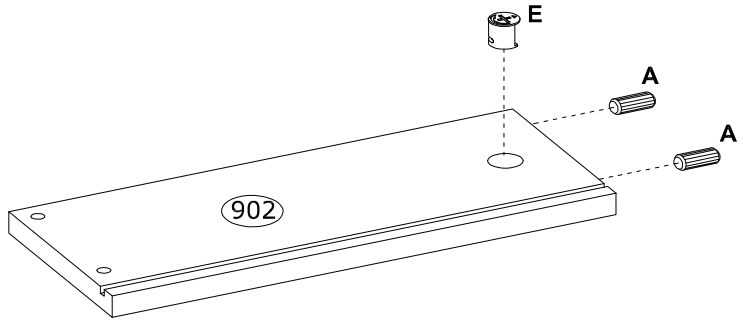

2

C Ø8x50 mm x8 3991	
------------------------------------	--



2x

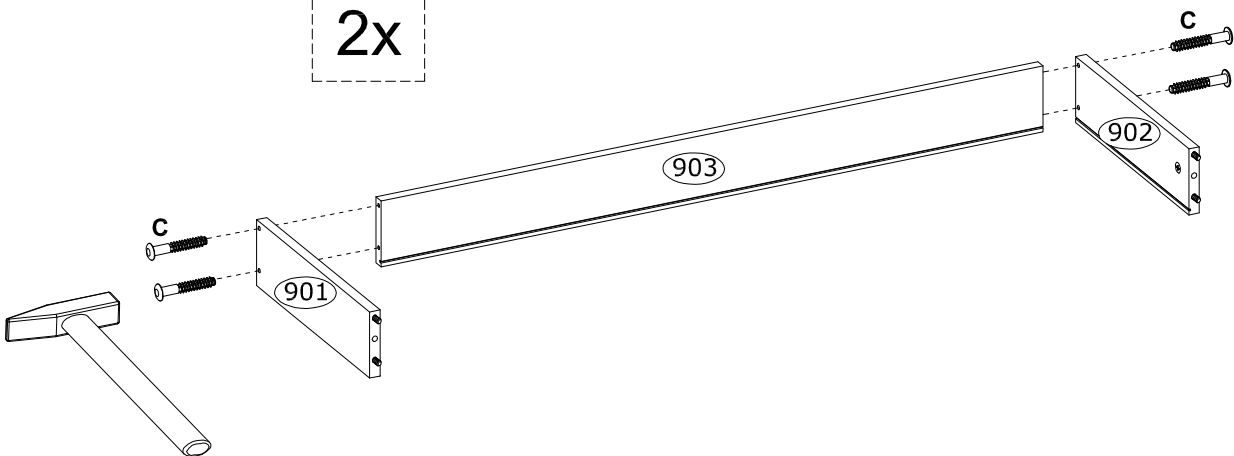

3

D Ø6,5x36,5 mm
x4
4066

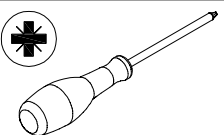

2x

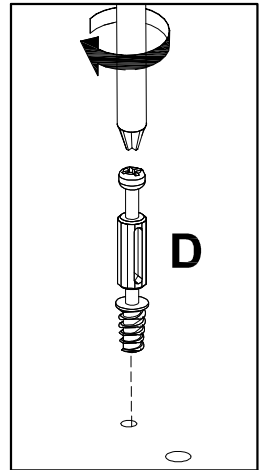
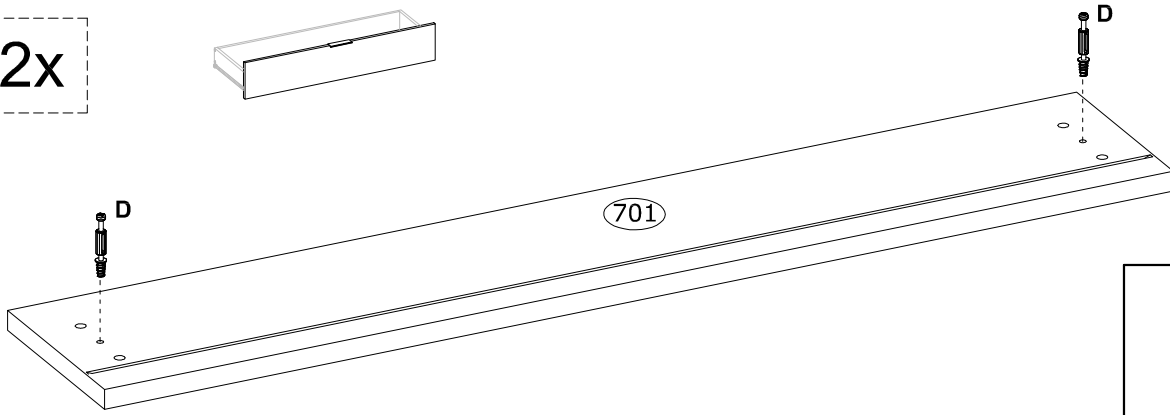

4

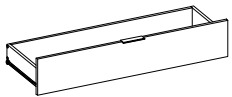

2x

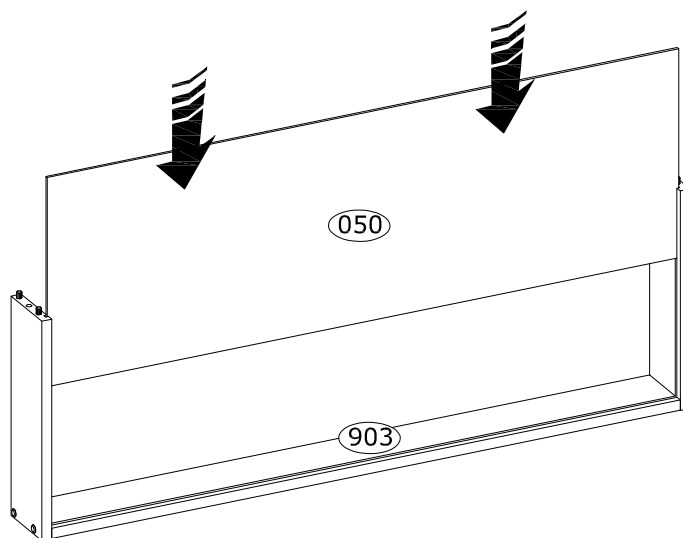

5

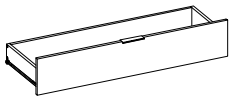
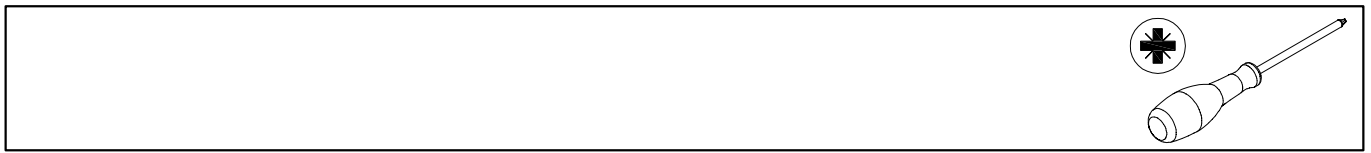

2x

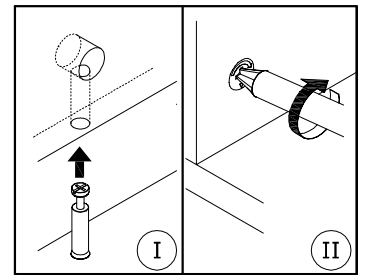
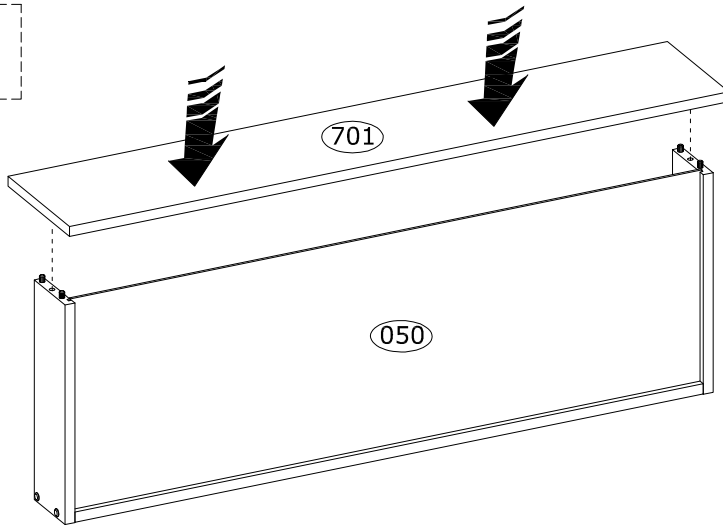

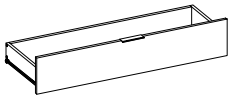
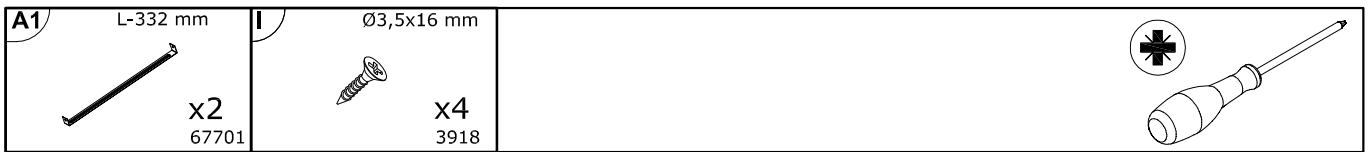

6

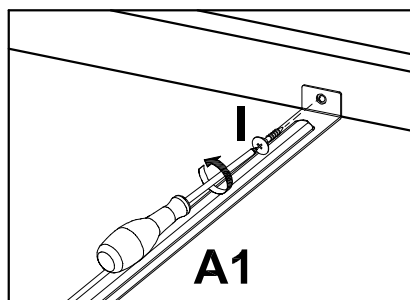
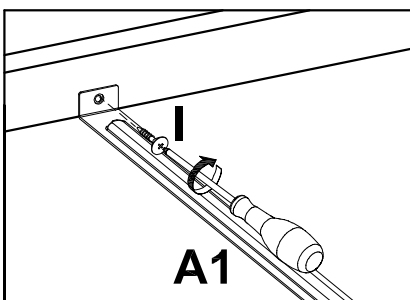
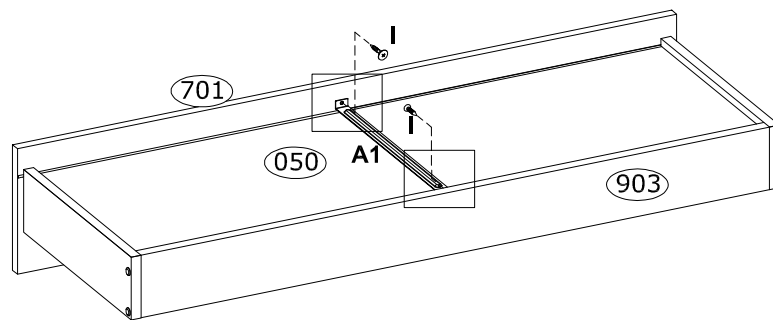

2x

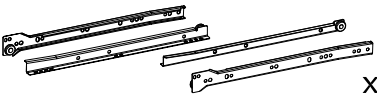

7

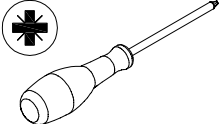

W  L-350mm x2 kpl 3804	I  Ø3,5x16 mm x8 3918	
---	---	--

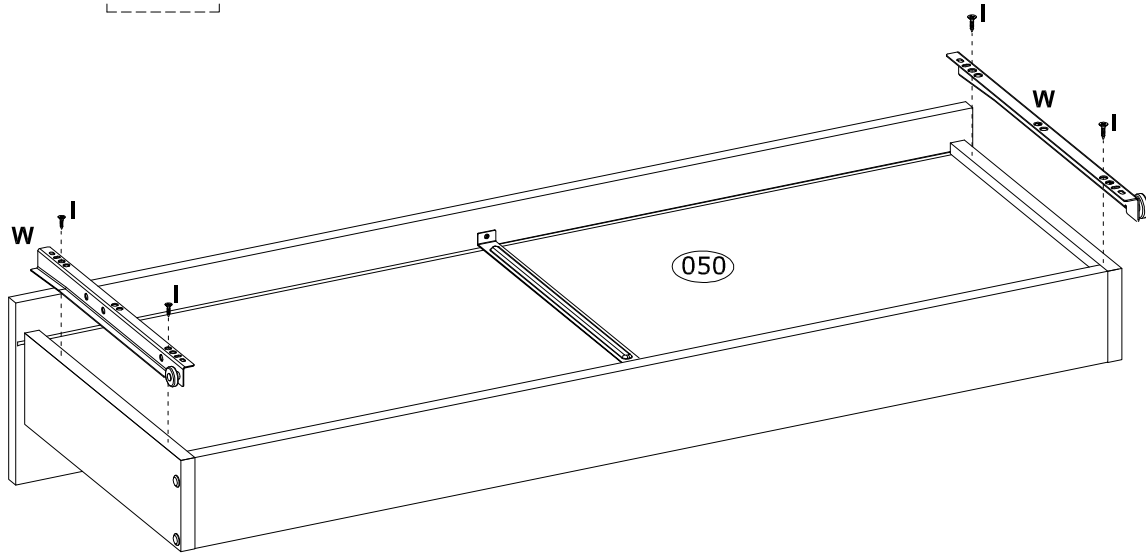

2x



8

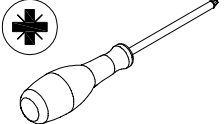

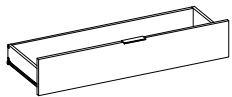
Y  L-120 mm x2 209928	I  Ø3,5x16 mm x4 3918	
---	---	---

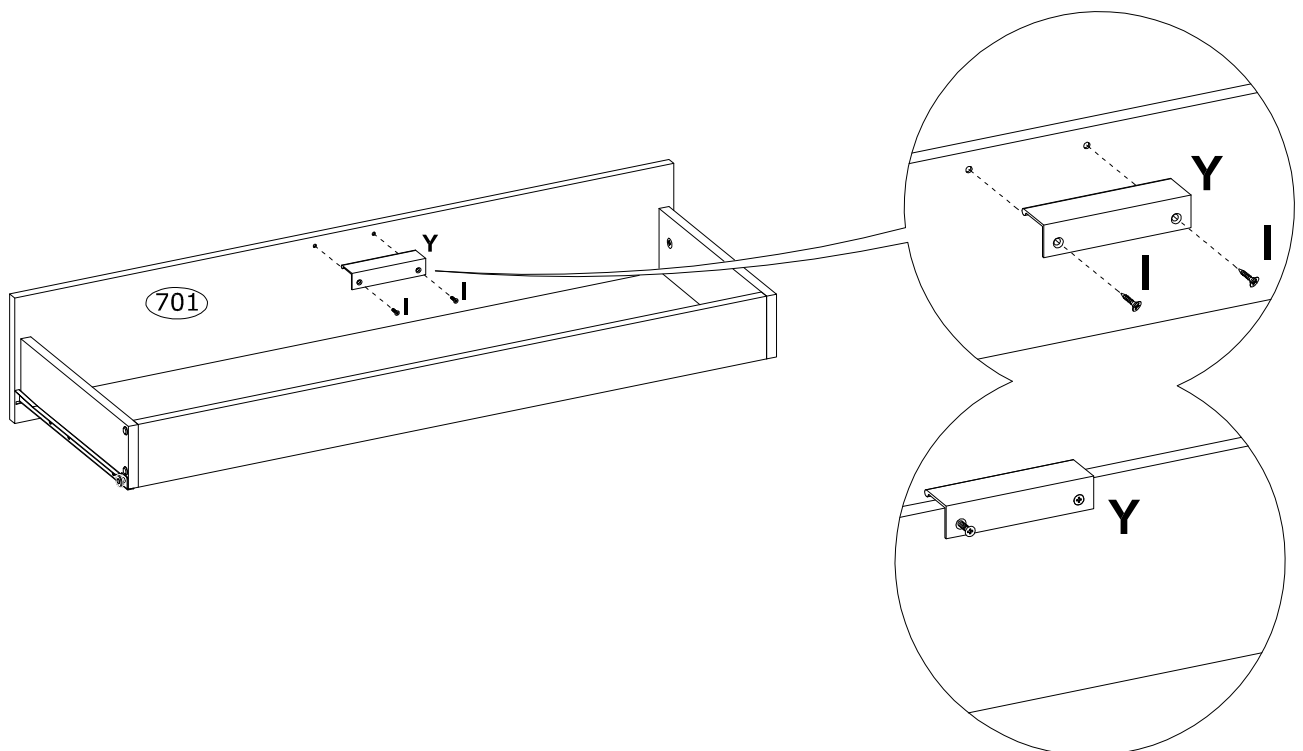

2x

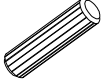

9

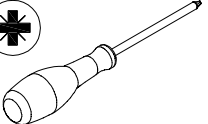
A Ø8x30 mm  x4 3989	B Ø8x50 mm  x2 3991	 
---	---	---

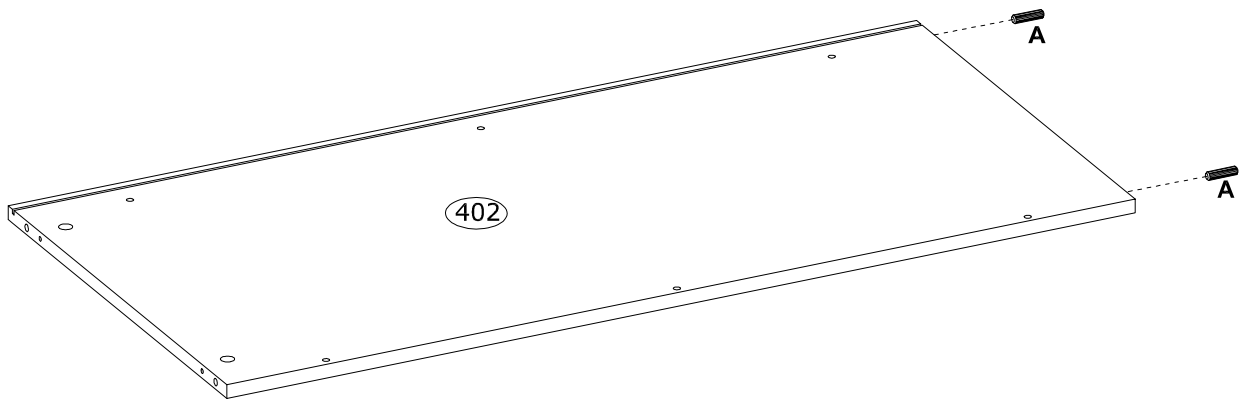
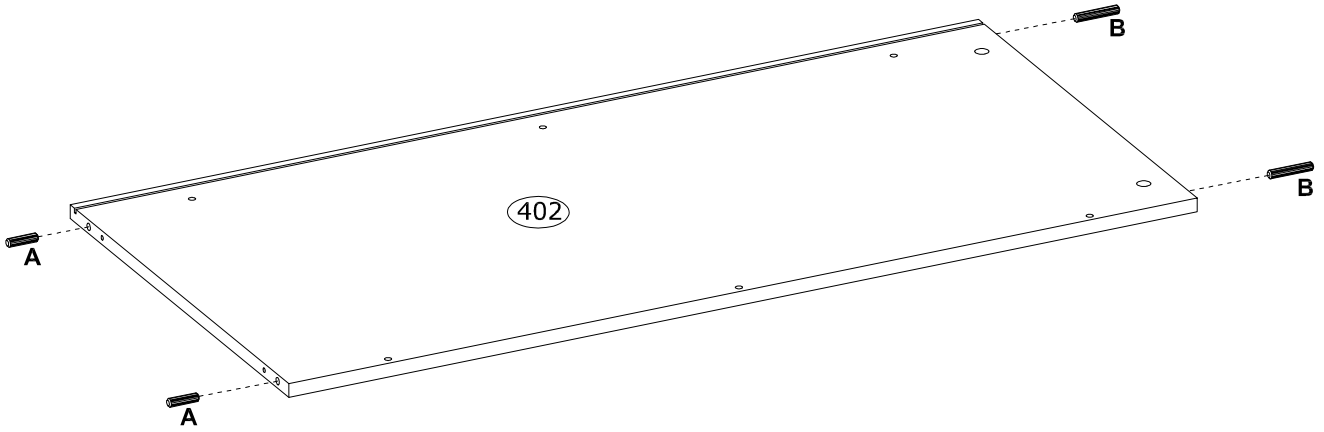

10

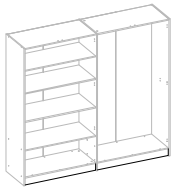
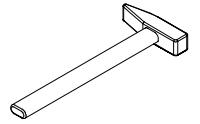

	x8 70313
---	-------------

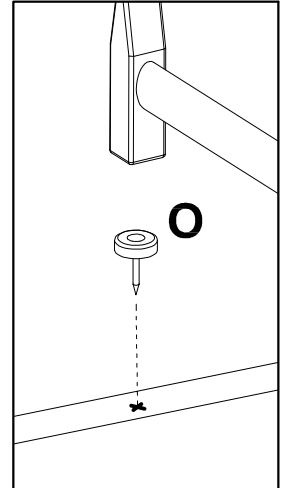
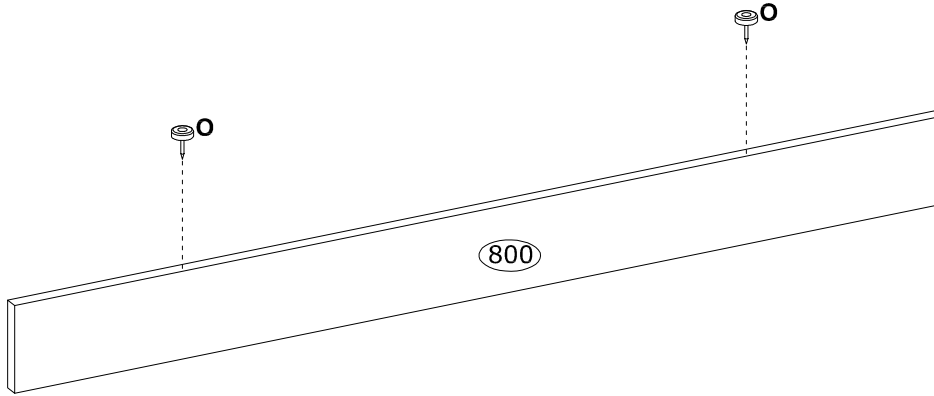

4x





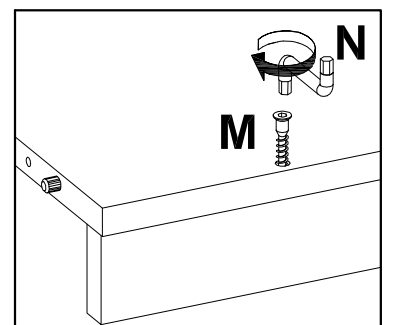
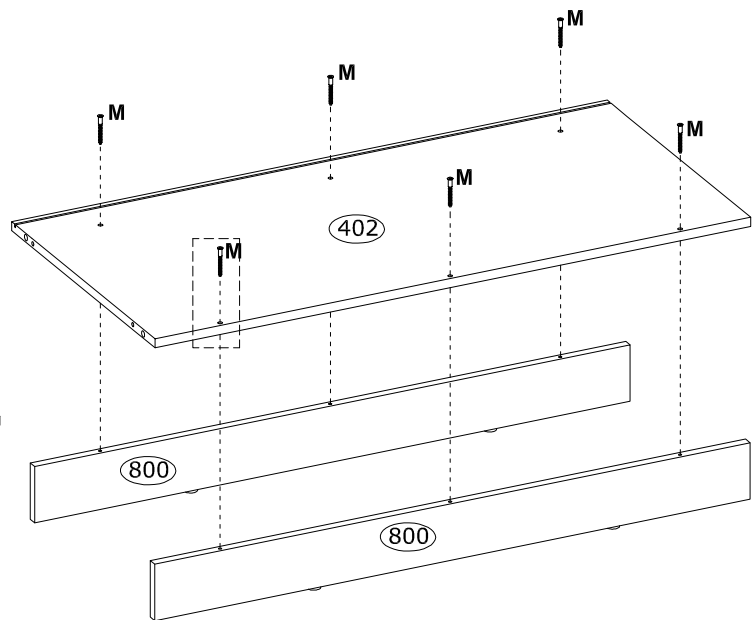
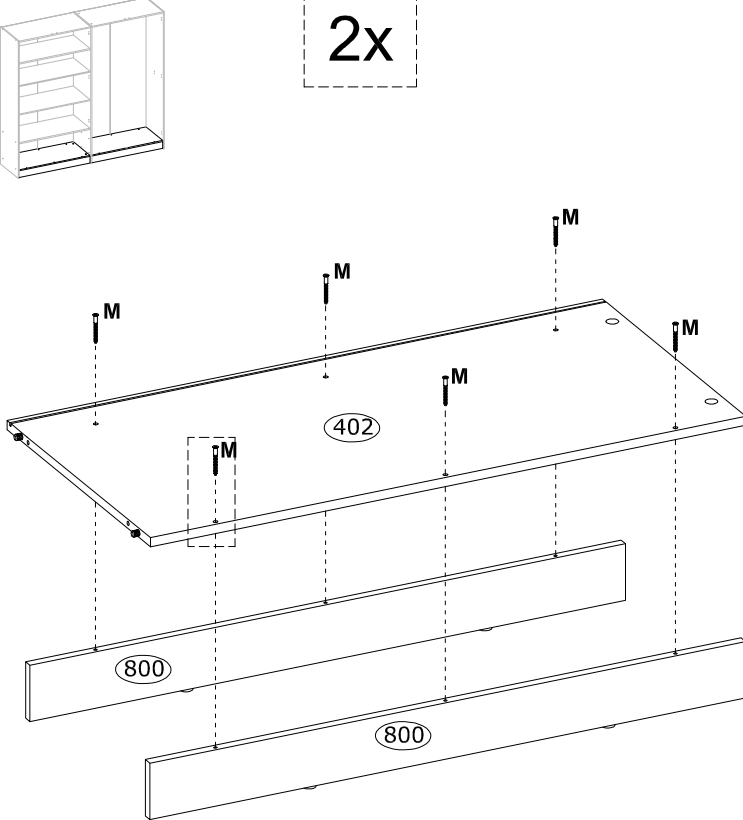
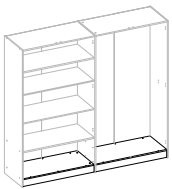

11

M	Ø6,4x50mm	N	4 mm
	x12 3884		x1 3984

2x

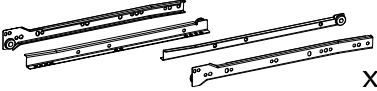
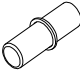

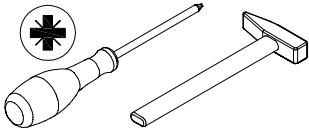



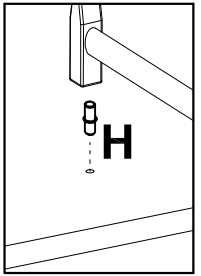
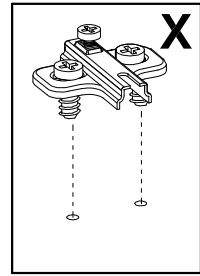
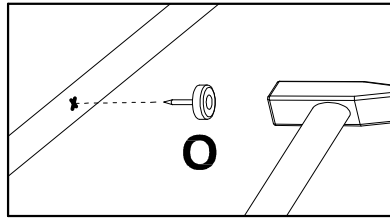
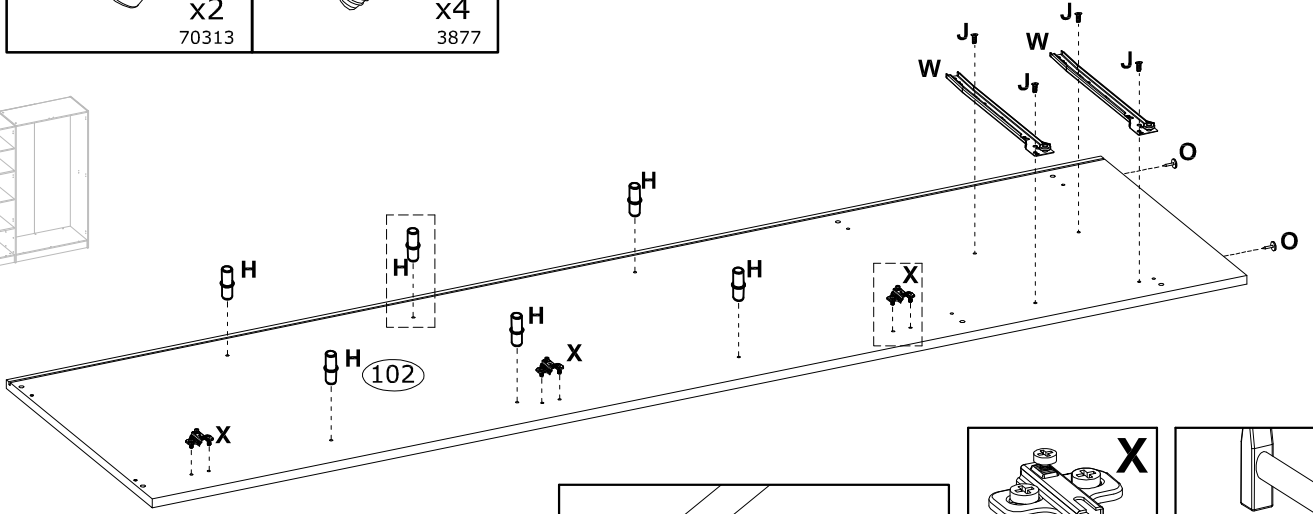
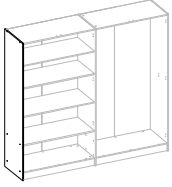

12

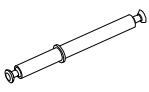
W  L-350mm x2 kpl 3804	H  Ø5x16 mm x6 4017	X  Ø35 mm , KR15 x3 68850	
O  x2 70313	J  Ø6,0x13 mm x4 3877		



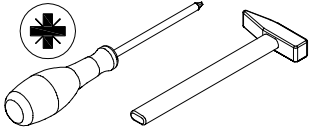

13

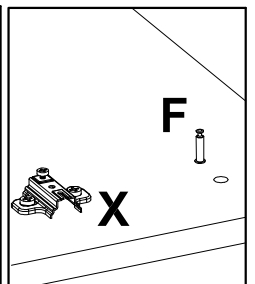
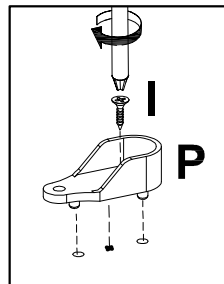
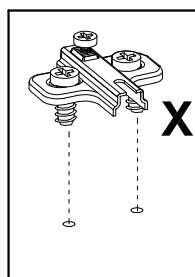
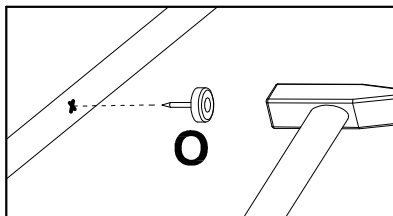
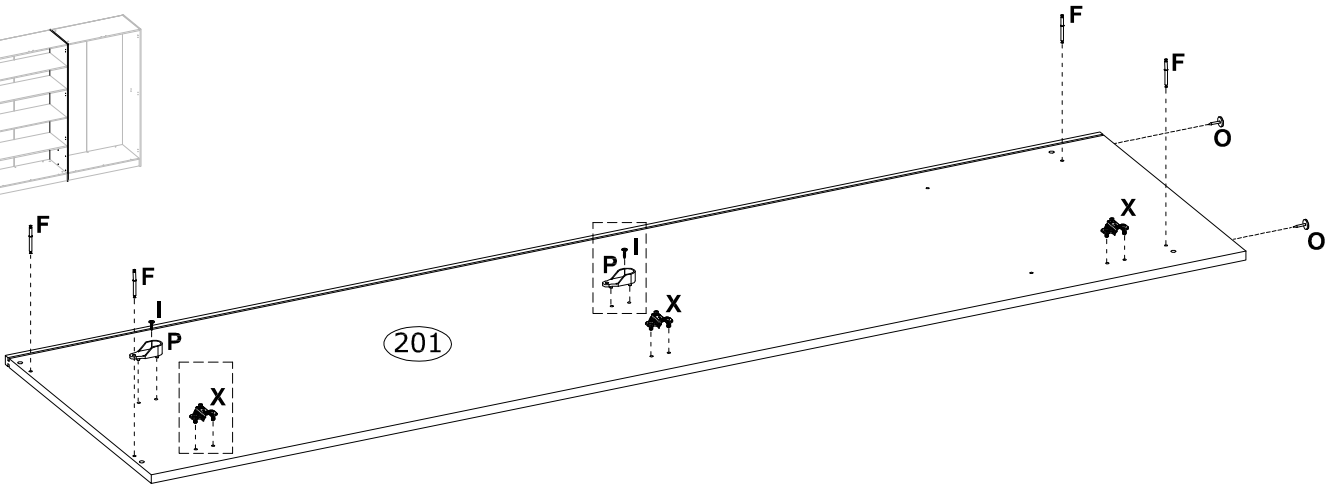
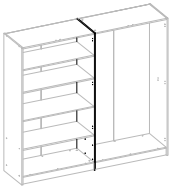
F  Ø6,5x76 mm x4 4062	X  Ø35 mm , KR15 x3 68850	O  x2 70313	I  Ø3,5x16 mm x2 3918	
P  42x17x20 mm x2 4069				



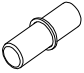

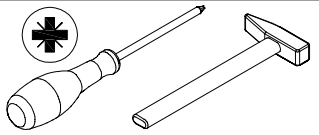
14

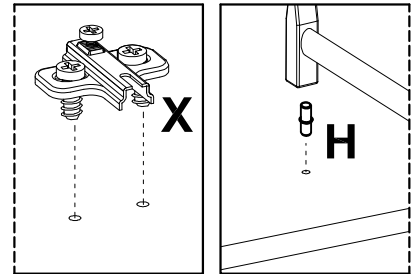
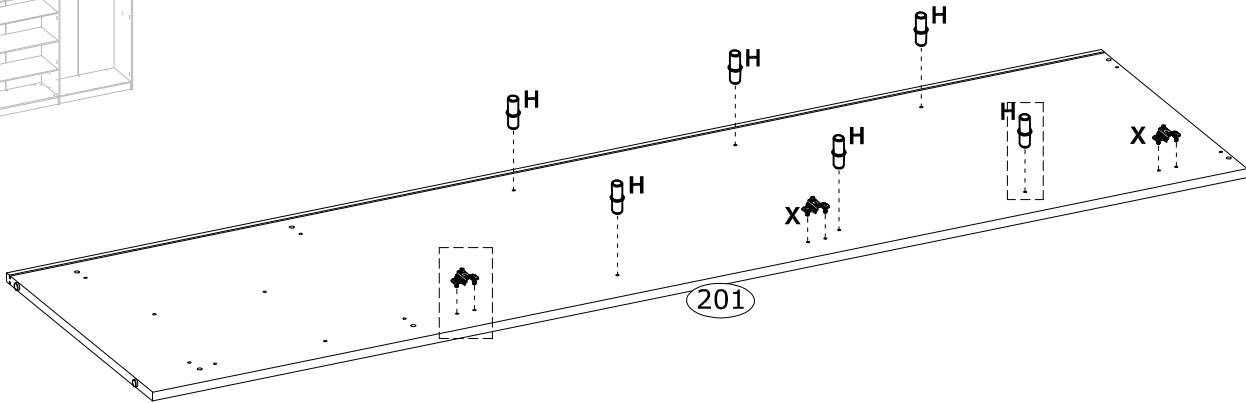
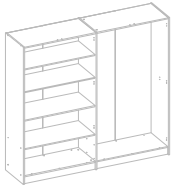
<p>H Ø5x16 mm x6 4017</p> 	<p>X Ø35 mm , KR15 x3 68850</p> 	
--	--	--



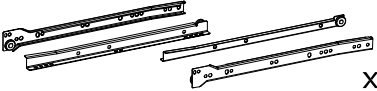

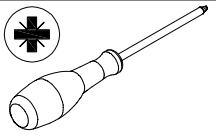

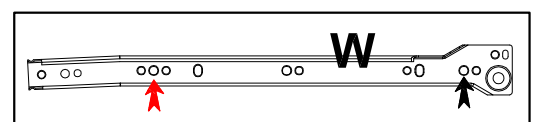
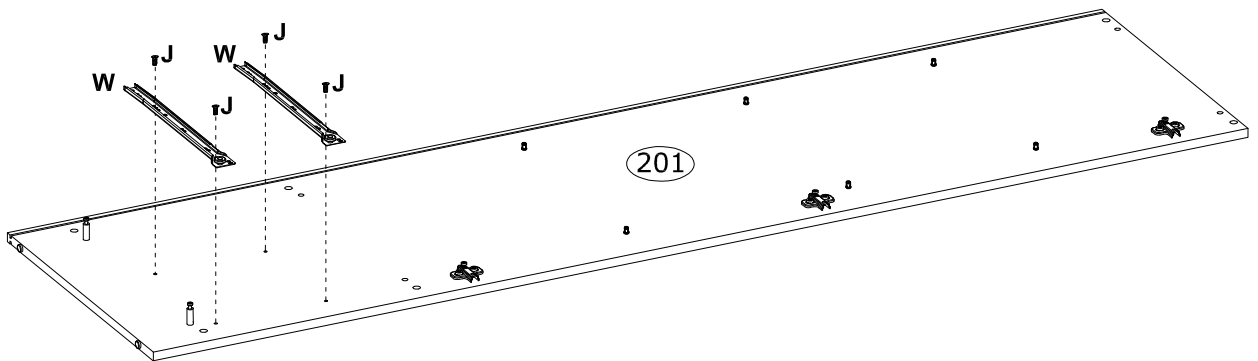
15

<p>W L-350mm x2 kpl 3804</p> 	<p>J Ø6,0x13 mm x4 3877</p> 	
---	--	---

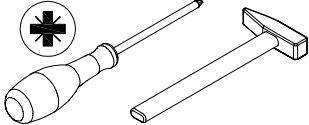

16

<p>P 42x17x20 mm x2 4069</p> 	<p>X Ø35 mm , KR15 x3 68850</p> 	<p>I Ø3,5x16 mm x2 3918</p> 	<p>O x2 70313</p> 	
---	--	--	--	--

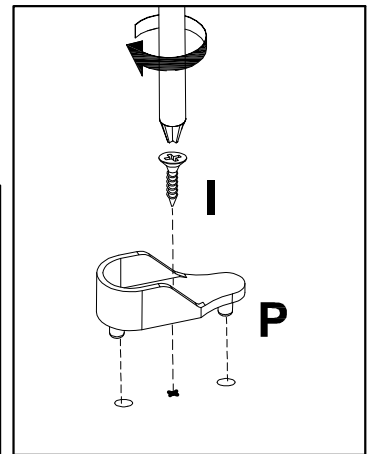
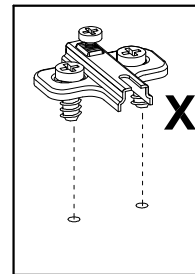
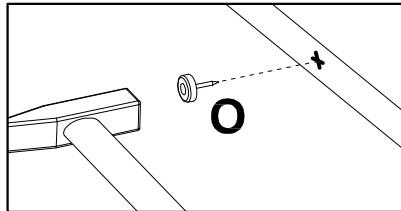
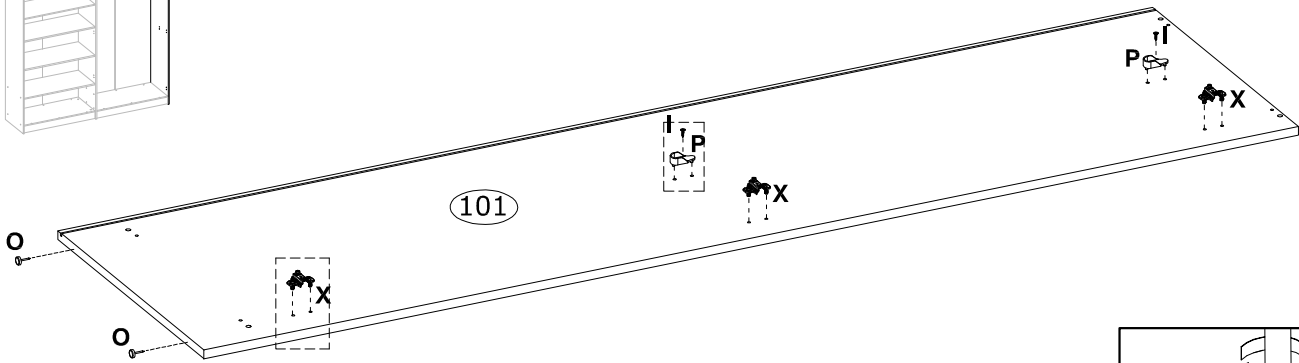
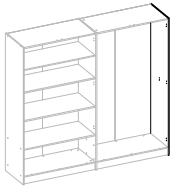

17

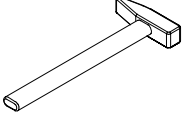
<p>A Ø8x30 mm x4 3989</p> 	
--	---

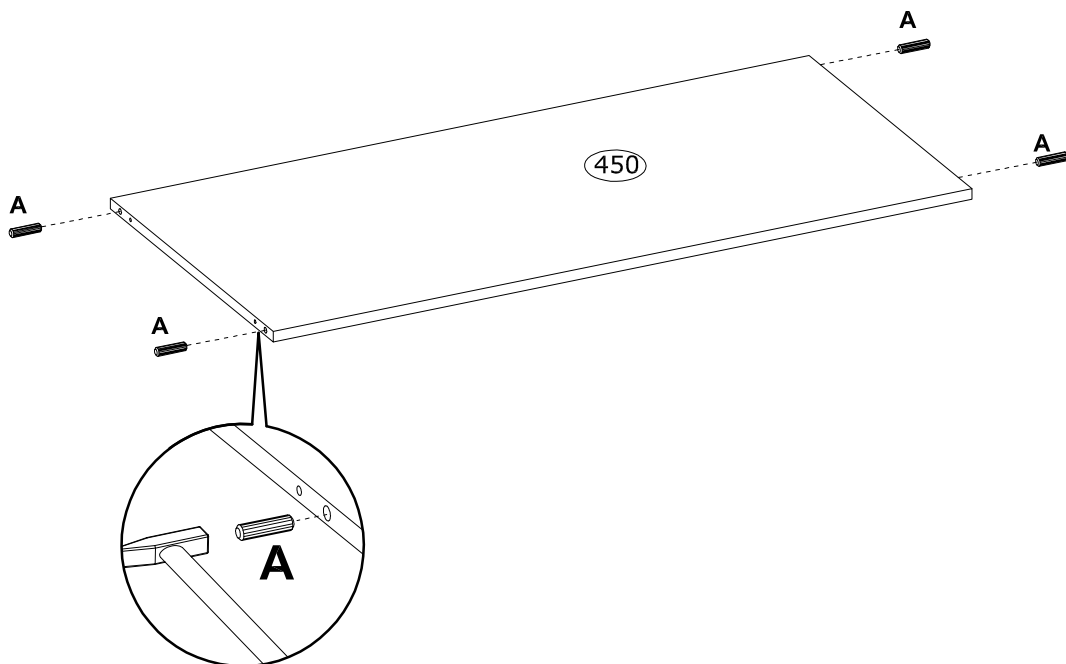

18

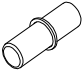
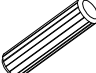
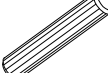
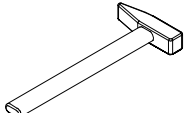
H Ø5x16 mm  x4 4017	A Ø8x30 mm  x4 3989	B Ø8x50 mm  x2 3991	
---	---	---	--

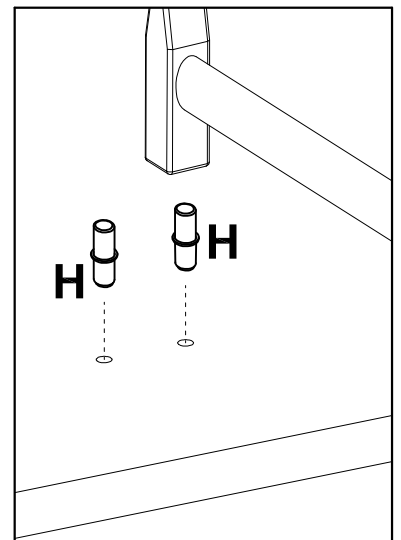
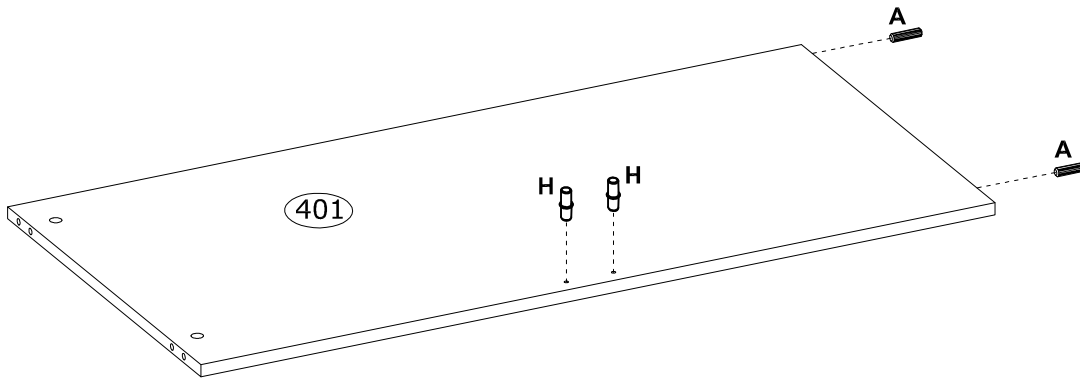
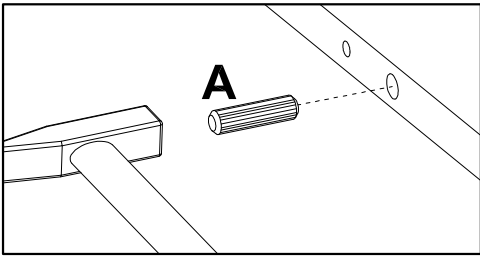
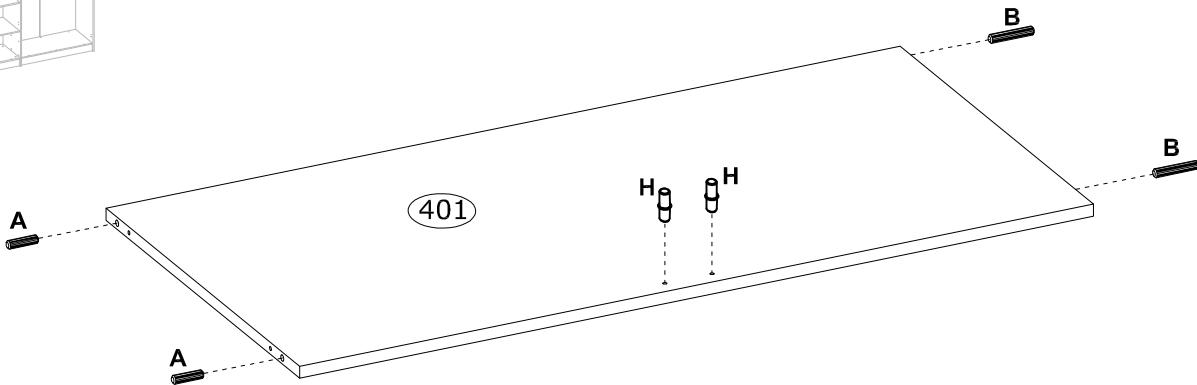

19

E $\varnothing 15 \times 12$ mm
x4
3996

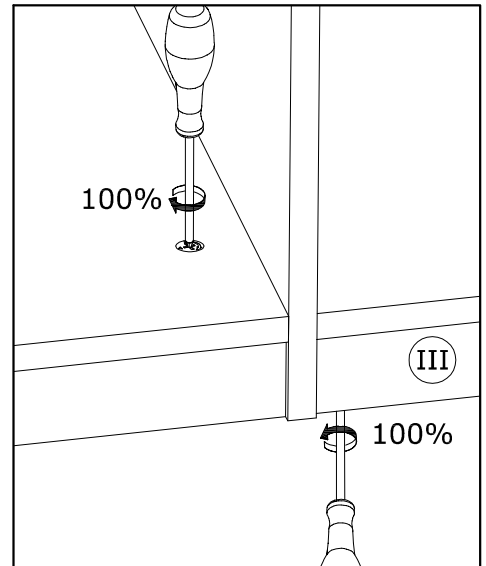
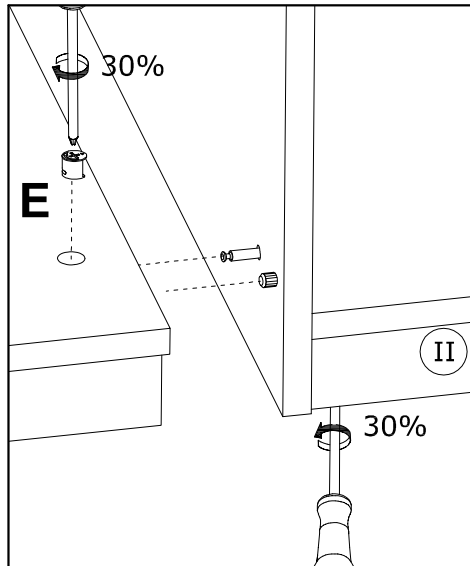
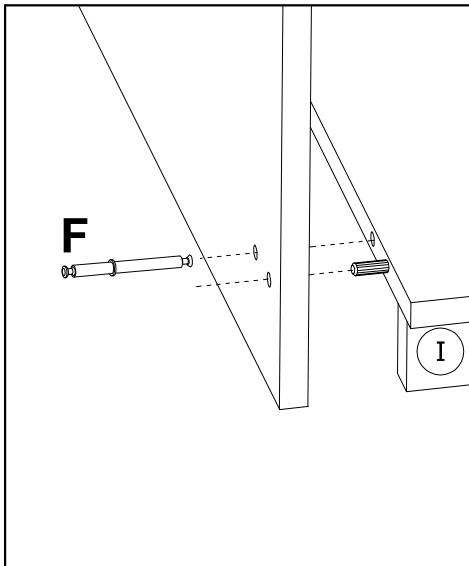
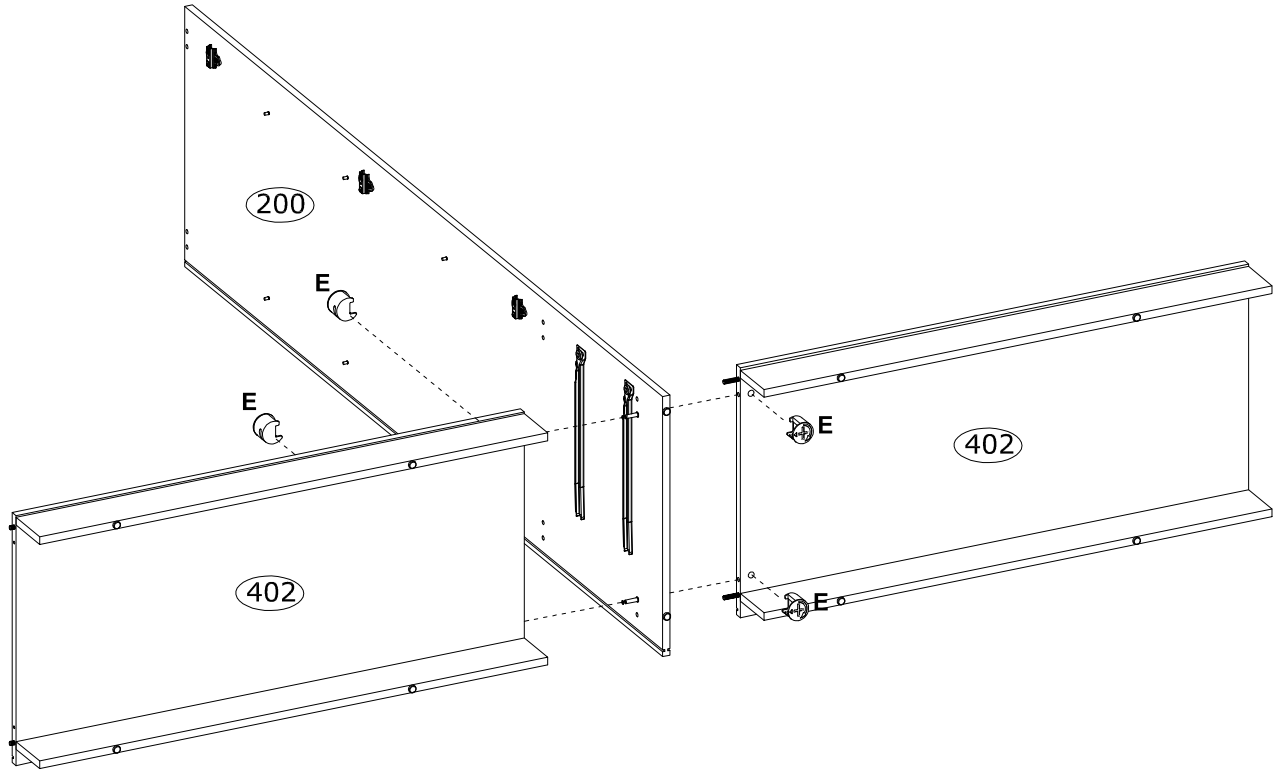
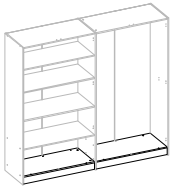
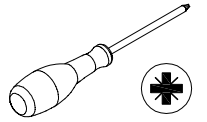



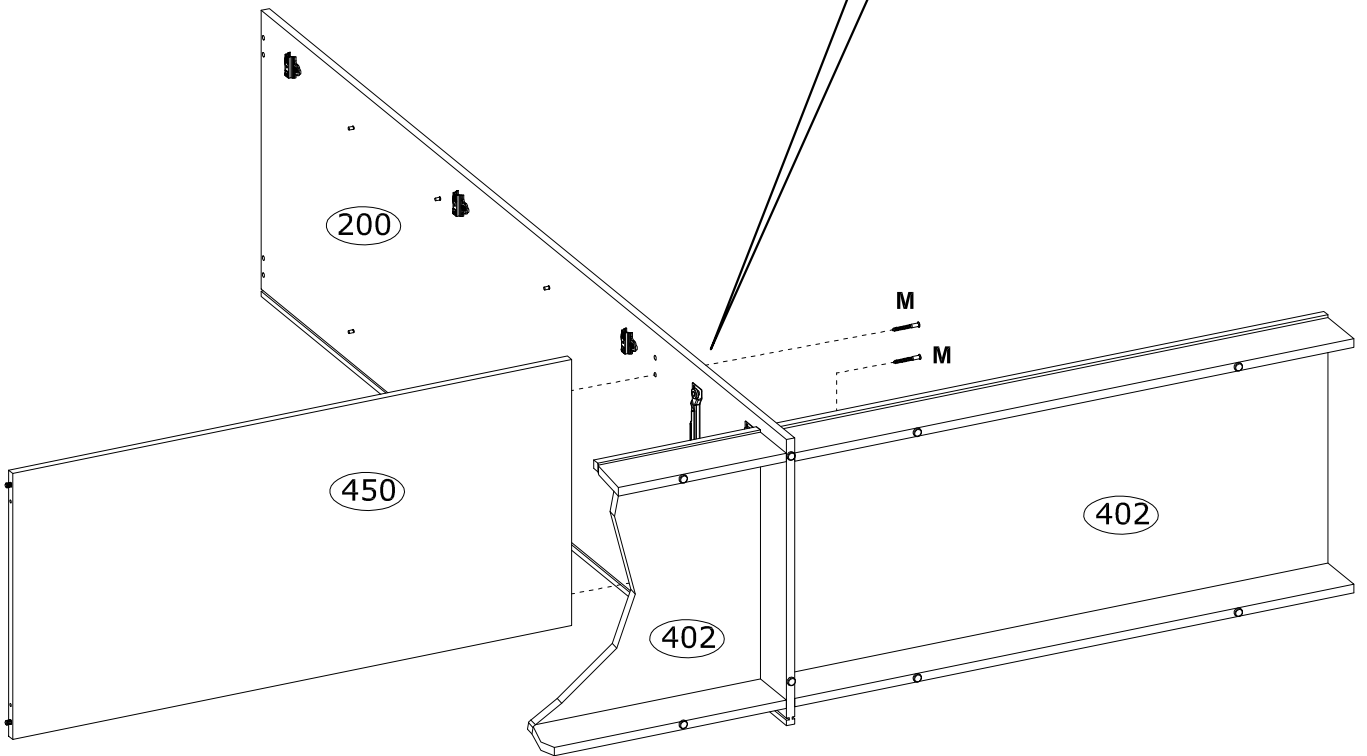
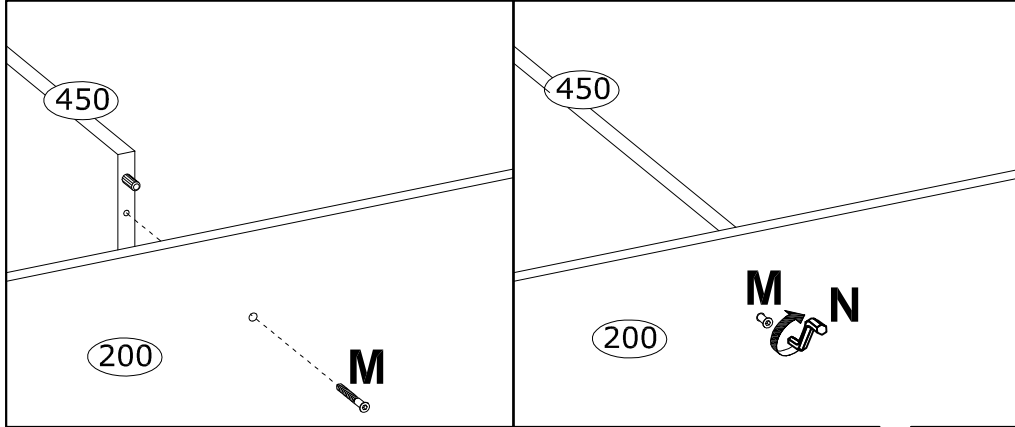
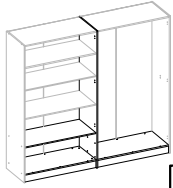

20

M Ø6,4x50mm  x2 3884	N 4 mm  x1 3984
---	--



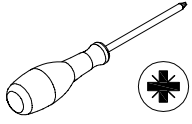

21

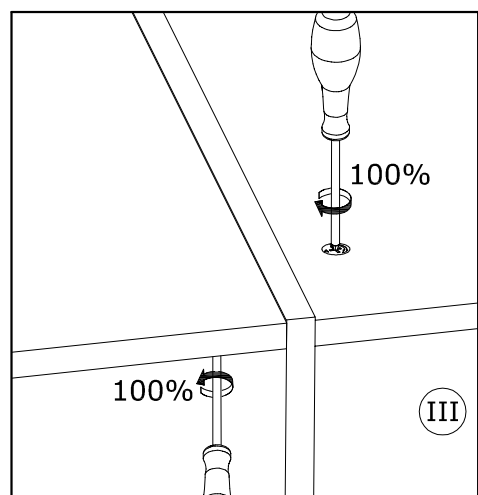
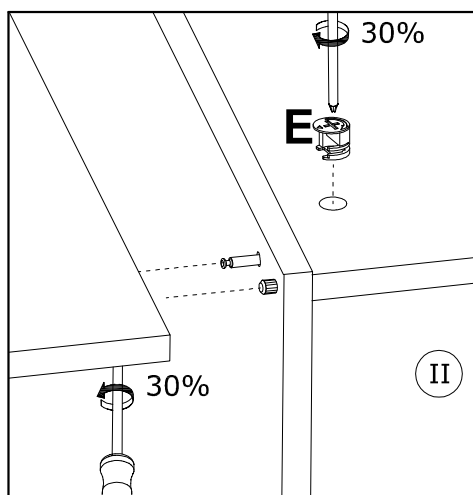
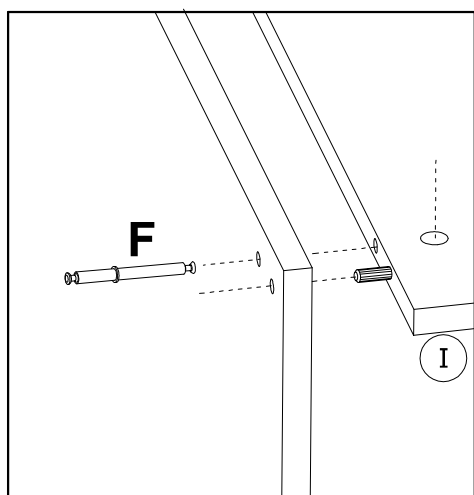
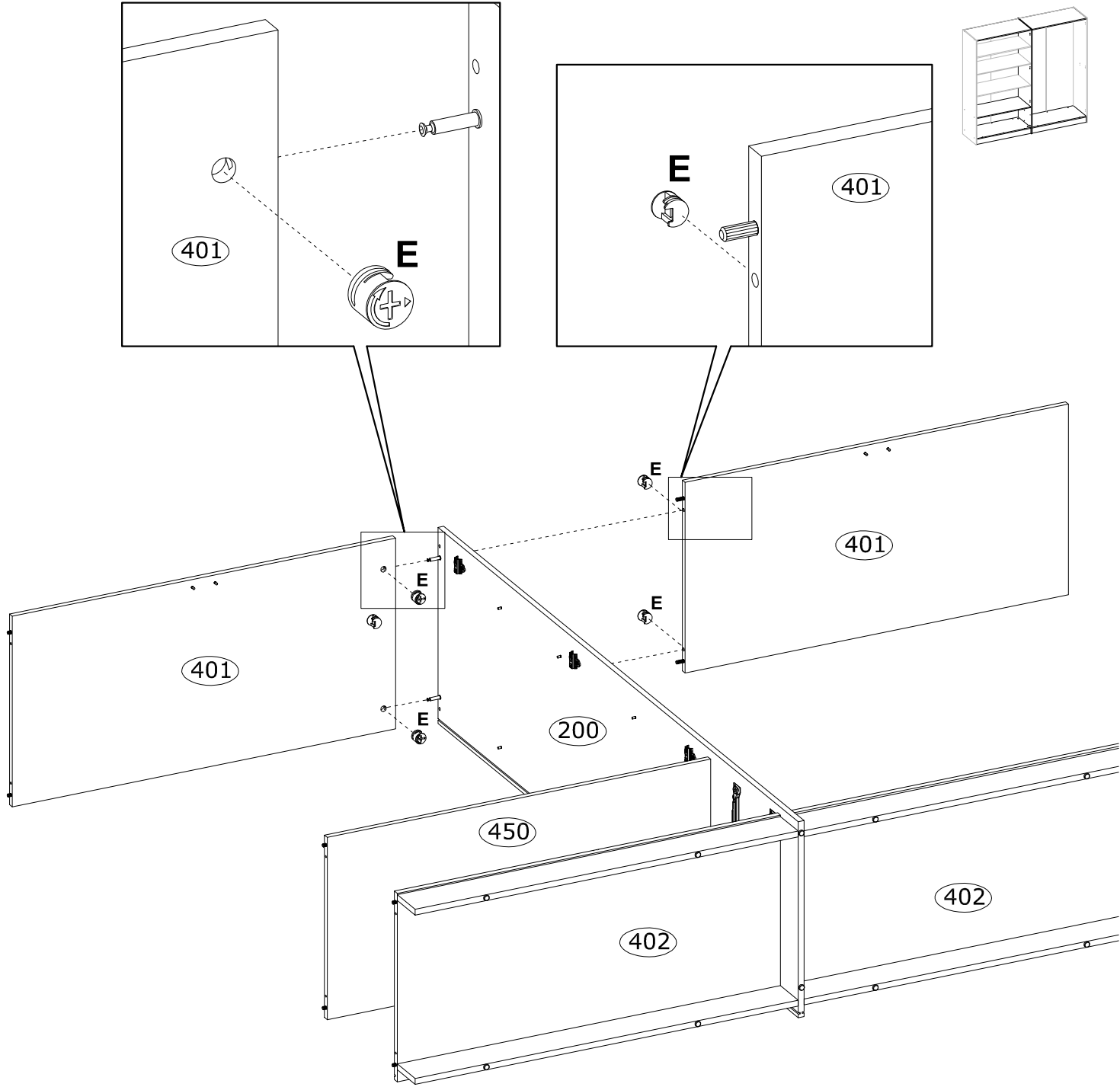
E Ø15x12 mm  x4 3996	T Ø20 mm  x4 136239	 
--	---	--



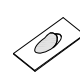

22

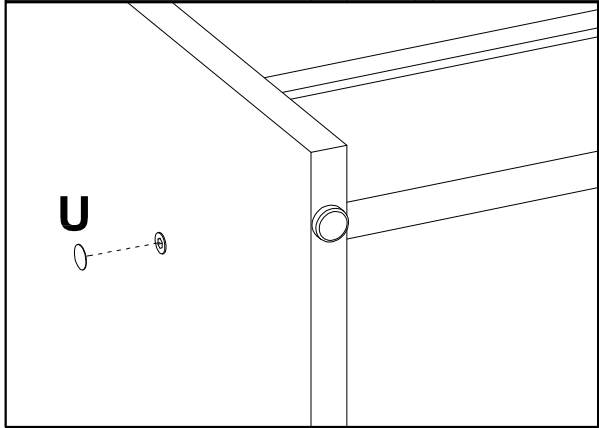
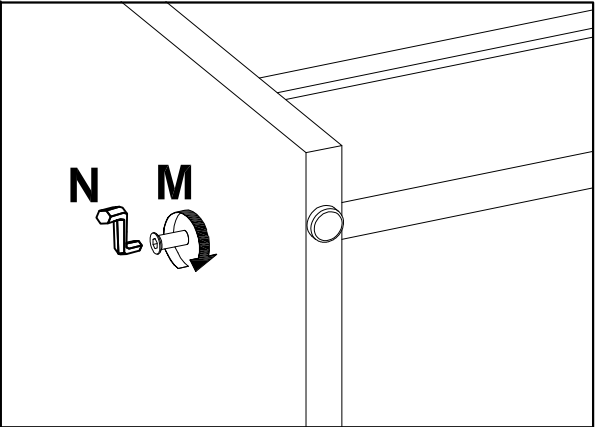
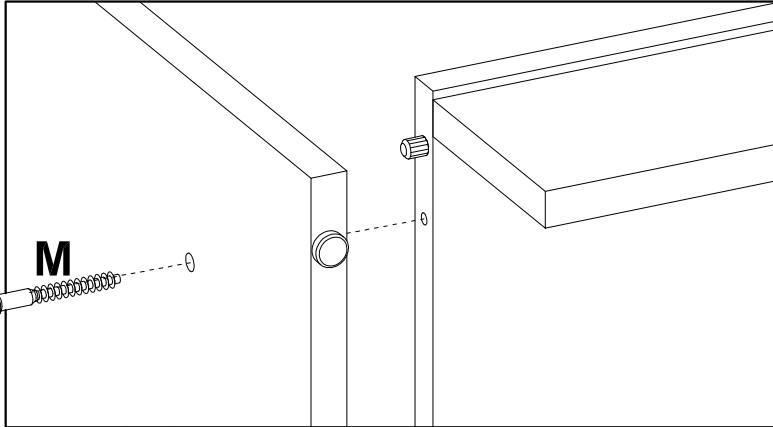
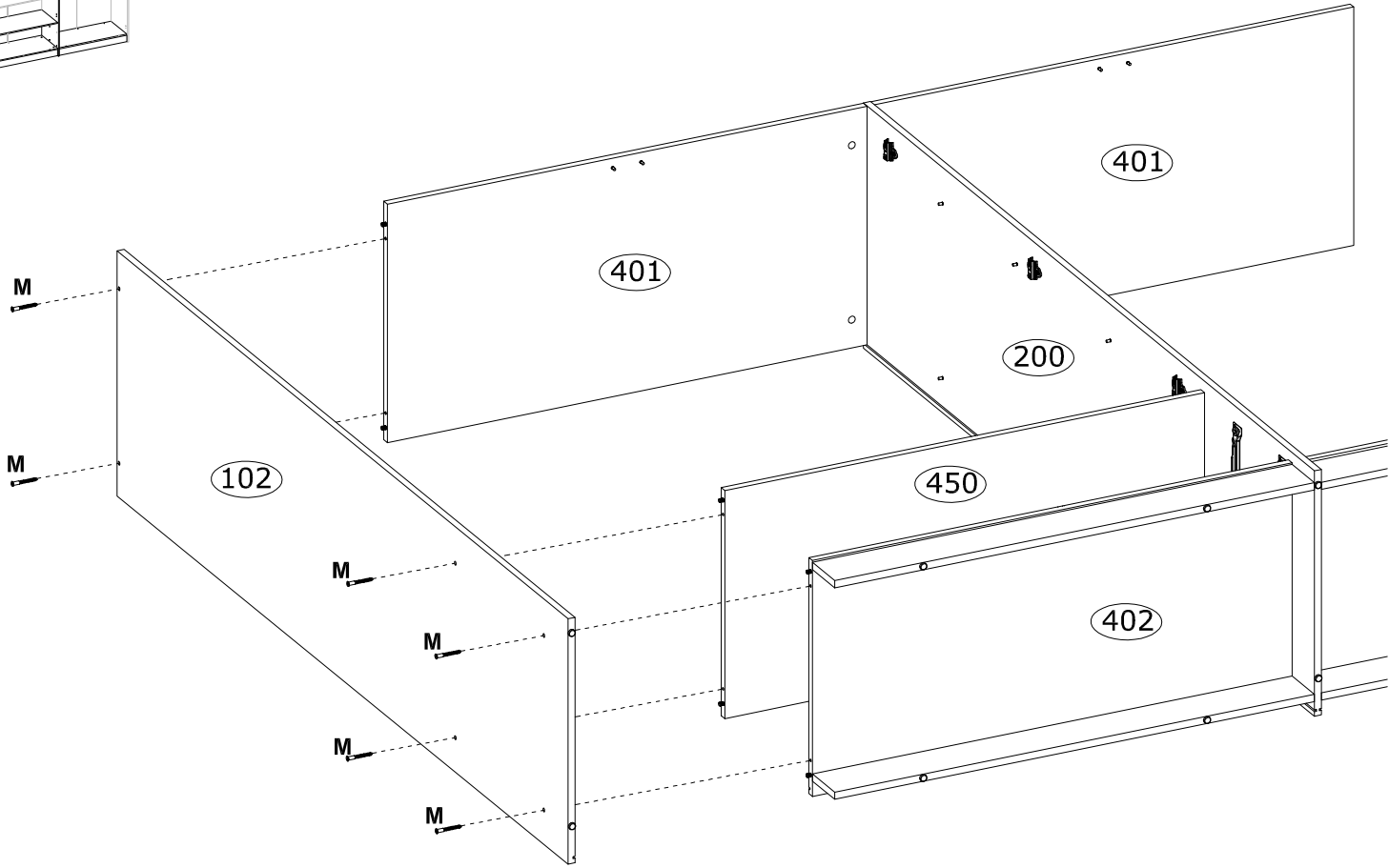
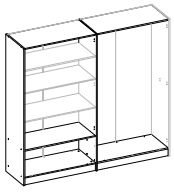
M Ø6,4x50mm  x6 3884	N 4 mm  x1 3984	U Ø10 mm  x6 142727	
---	--	--	--

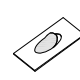

23

M Ø6,4x50mm  x4 3884	N 4 mm  x1 3984	U Ø10 mm  x4 142727	
---	--	--	--

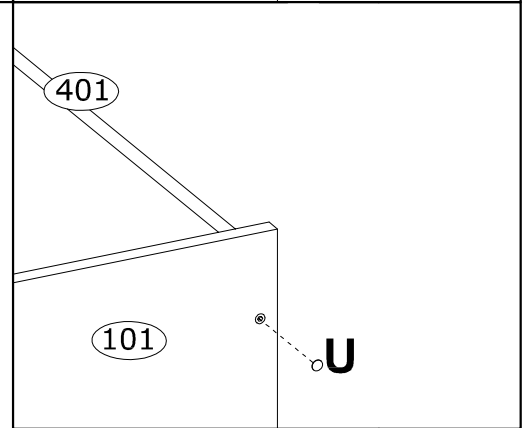
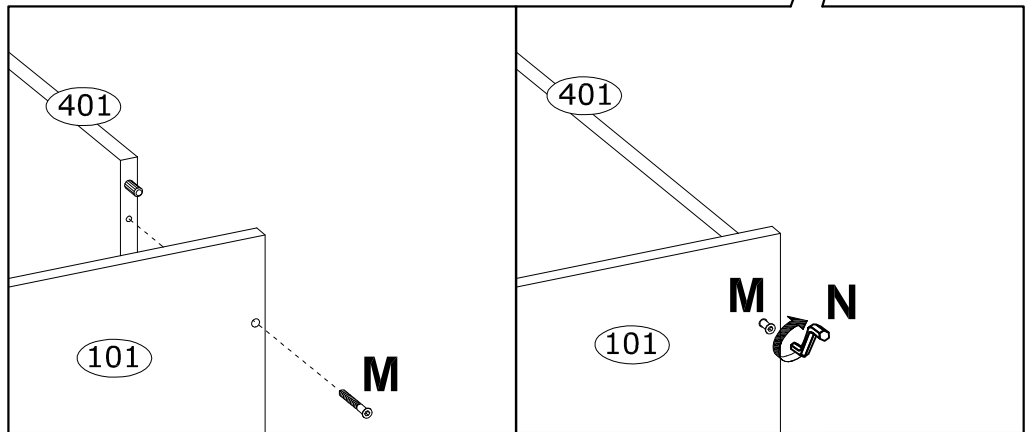
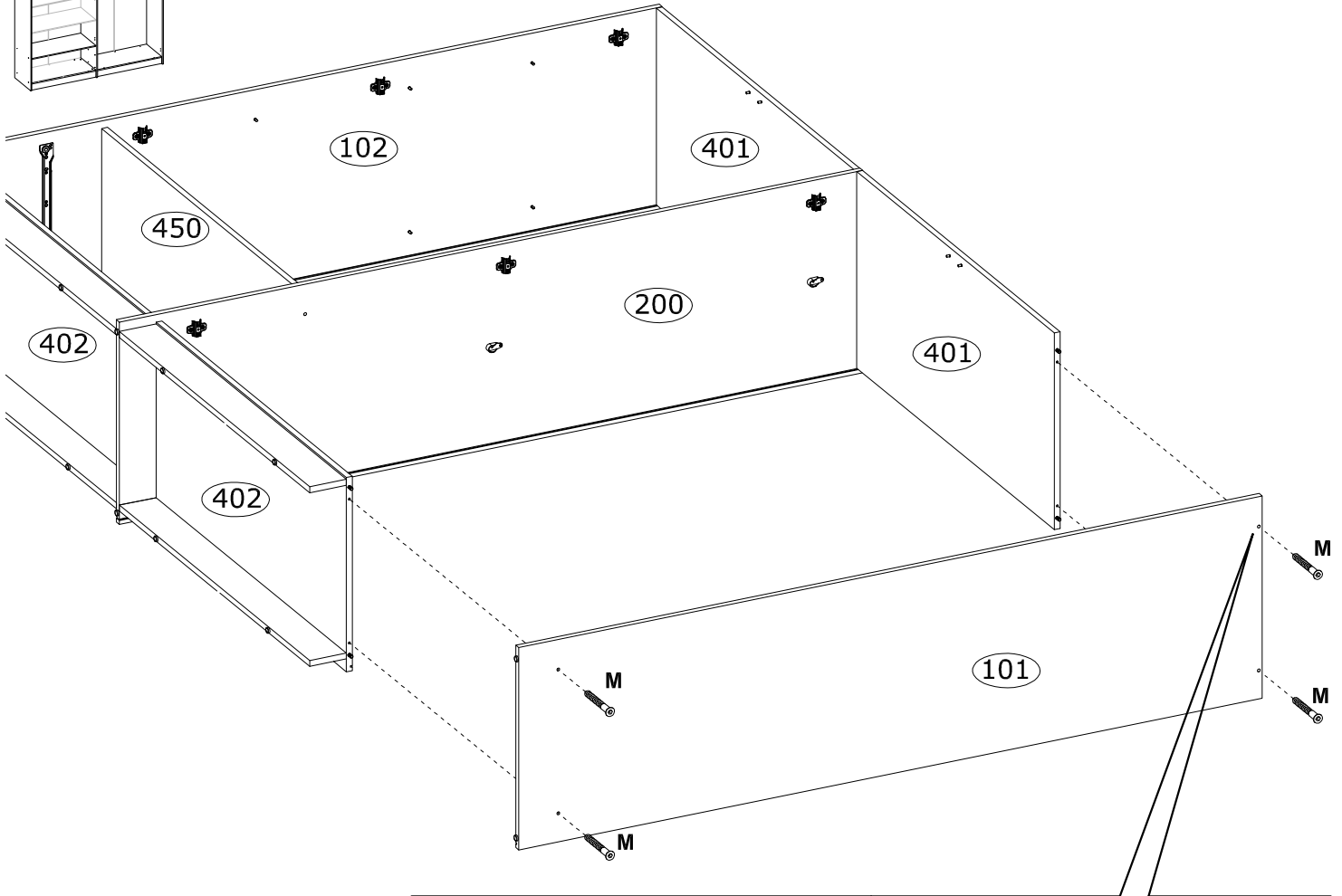
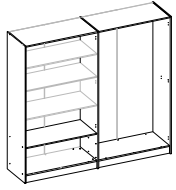

24

B1
L-1890 mm
x2
217025

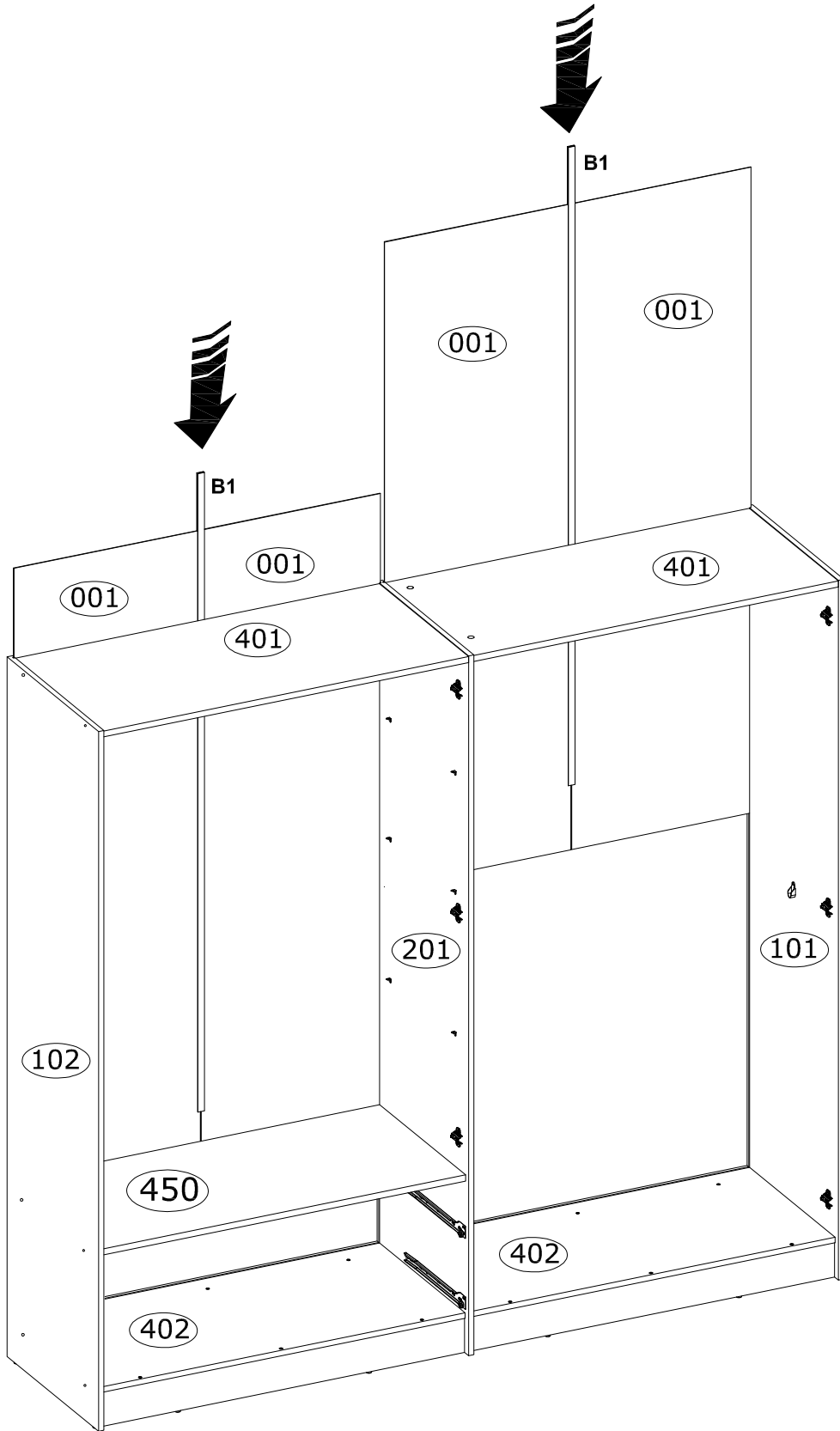
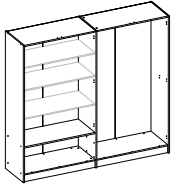

25

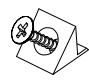

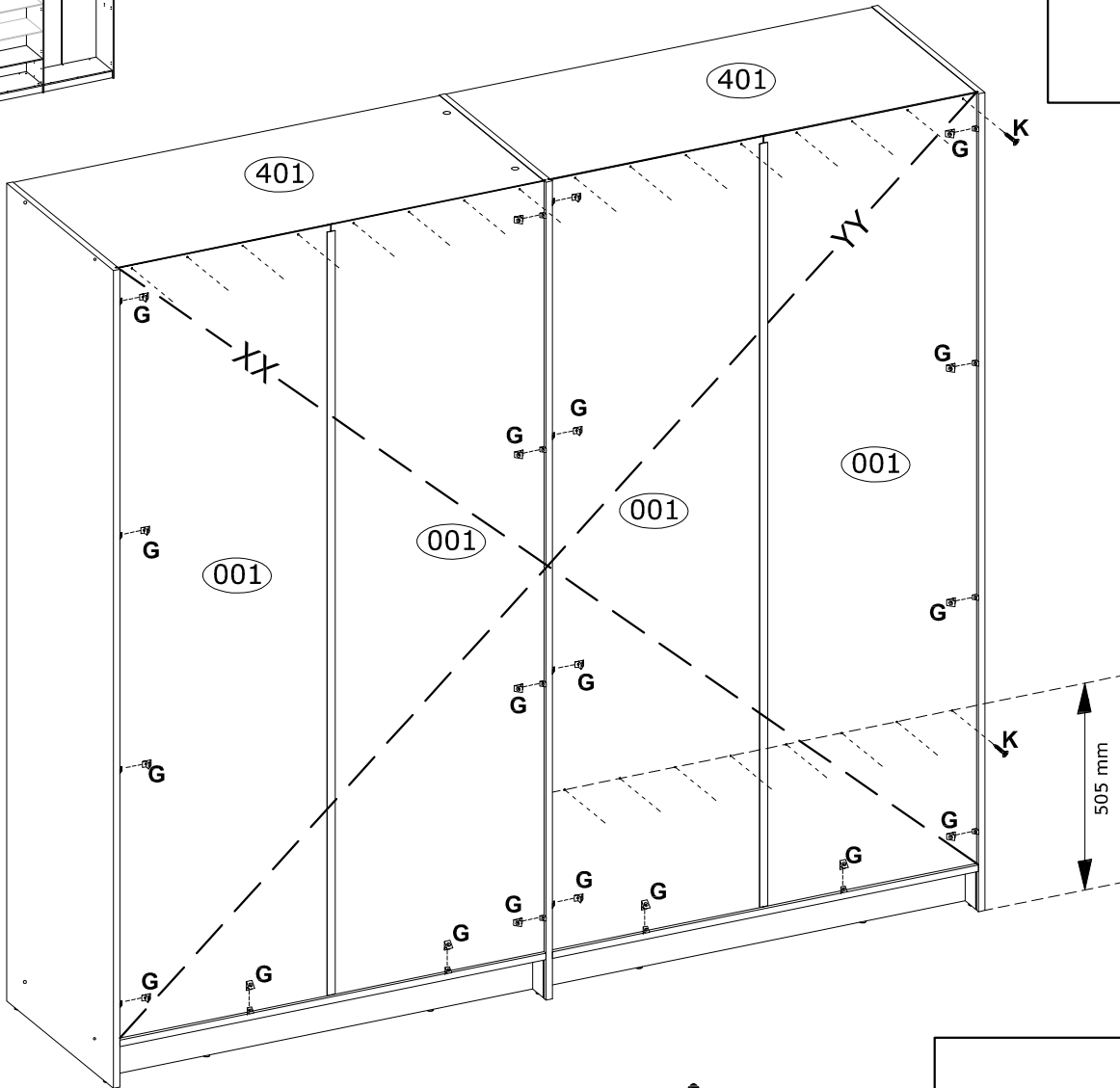
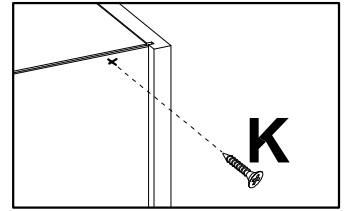
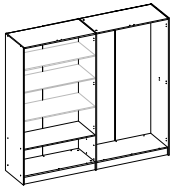
G 15x14x11 mm  x20 4044	K Ø3,0x20 mm  x22 3914	   
---	--	---

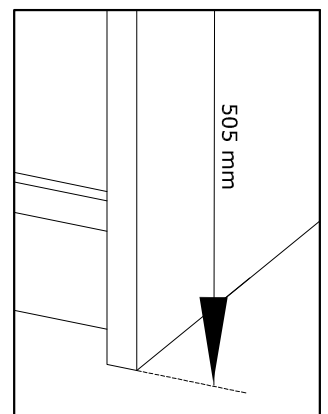
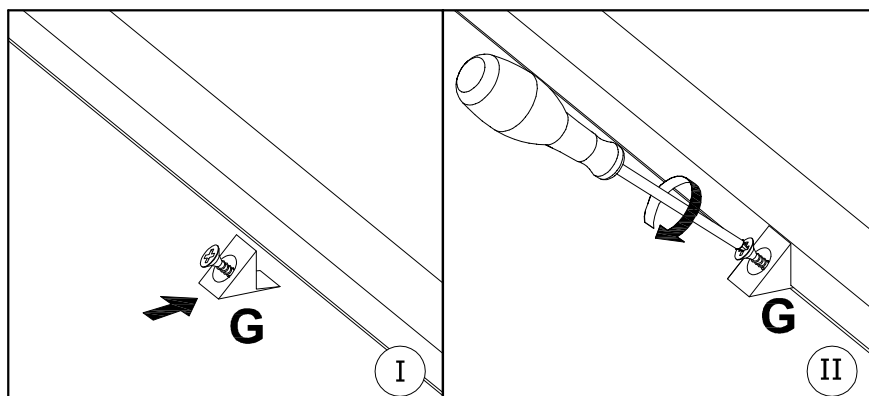
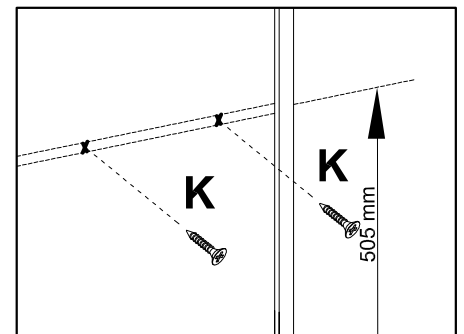

$XX = YY \equiv 90^\circ$

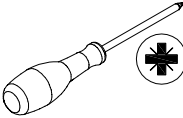

26

<p>Y</p> <p>L-120 mm</p>  <p>x1 209928</p>	<p>X</p> <p>Ø35 mm , KR15</p>  <p>x6 68850</p>	<p>I</p> <p>Ø3,5x16 mm</p>  <p>x14 3918</p>	
--	---	---	--

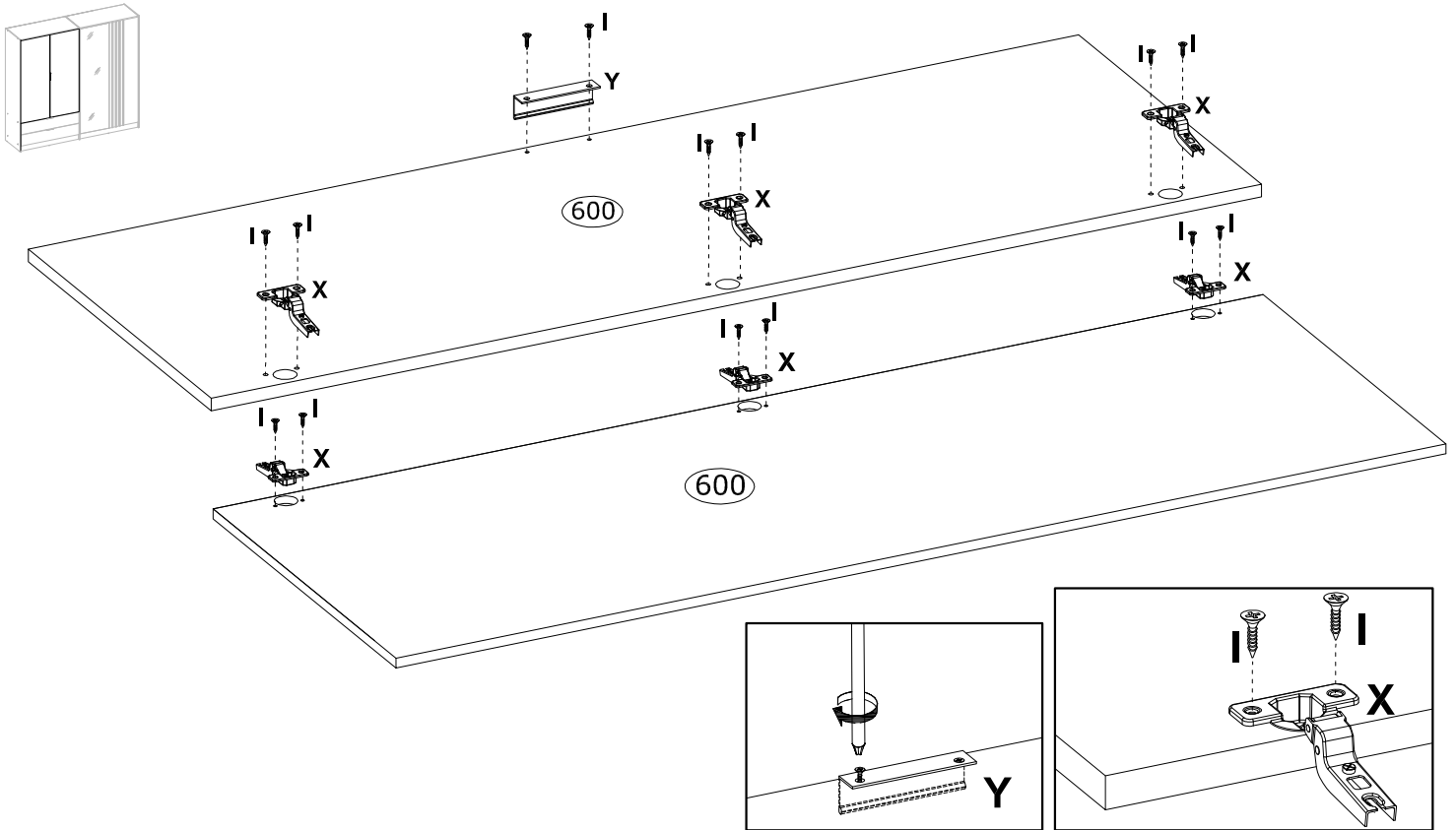

27

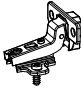
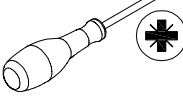
<p>X</p> <p>Ø35 mm , KR15</p>  <p>x6 68850</p>	<p>I</p> <p>Ø3,5x16 mm</p>  <p>x12 3918</p>	
--	---	---

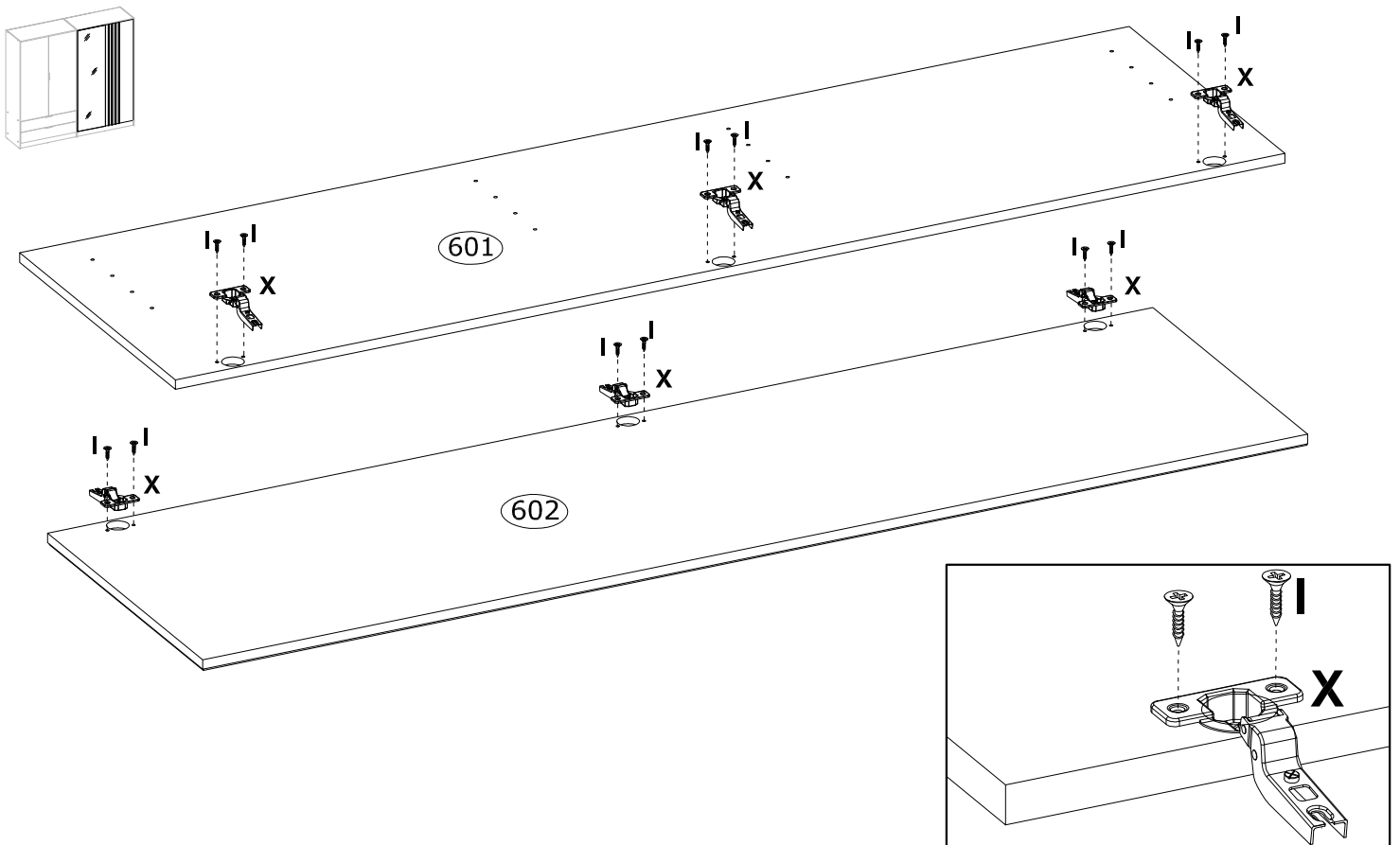

28

L
Ø4,0x25 mm
x16
145556

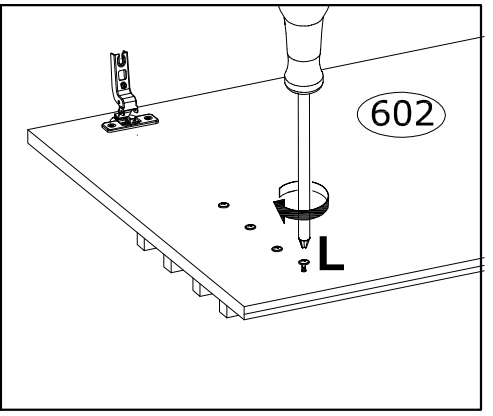
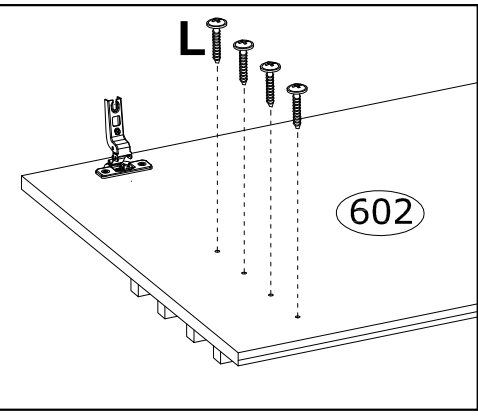
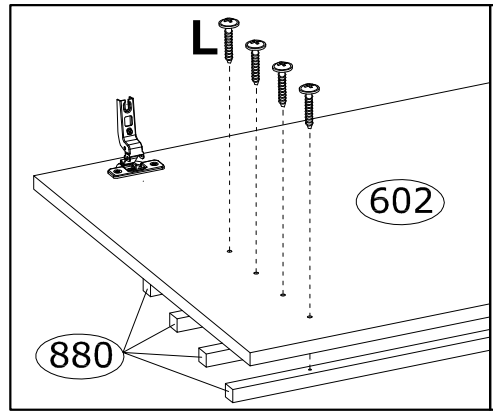
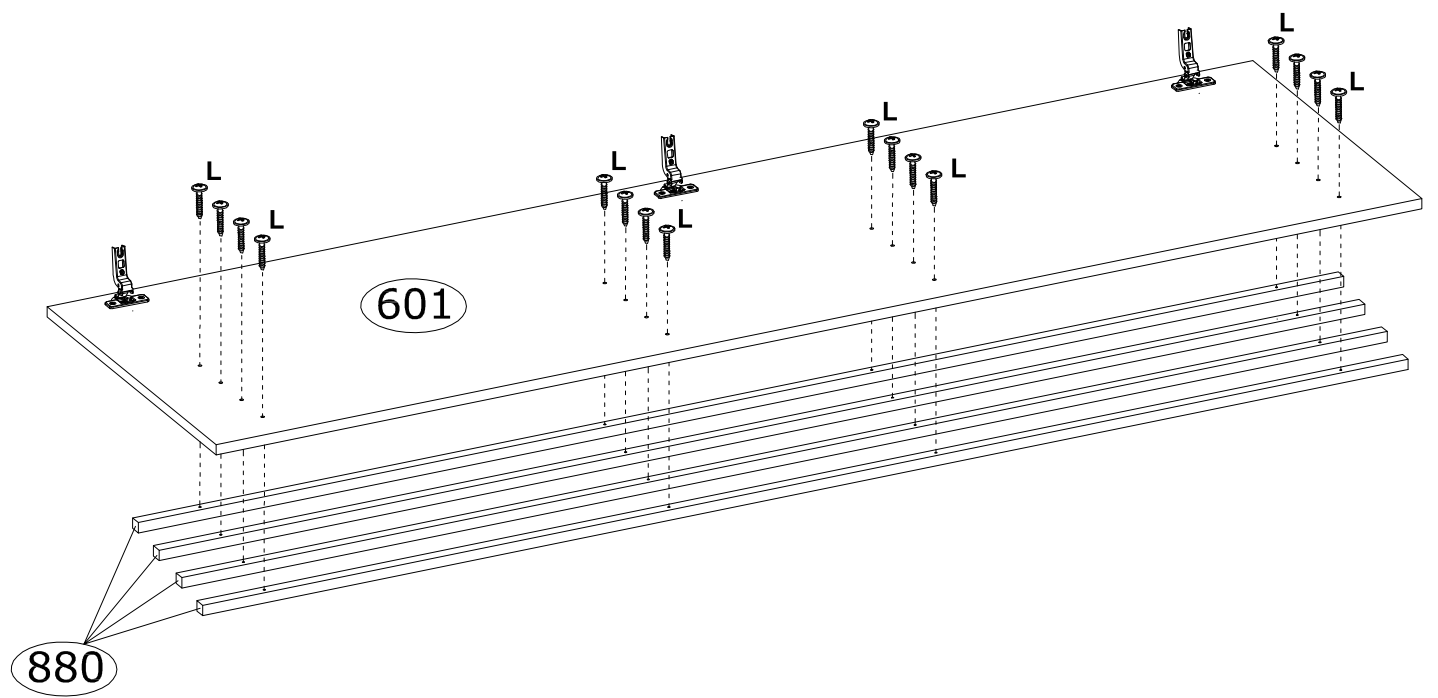
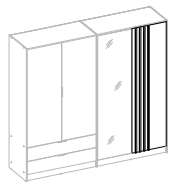
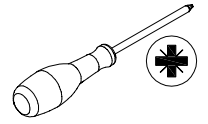

29



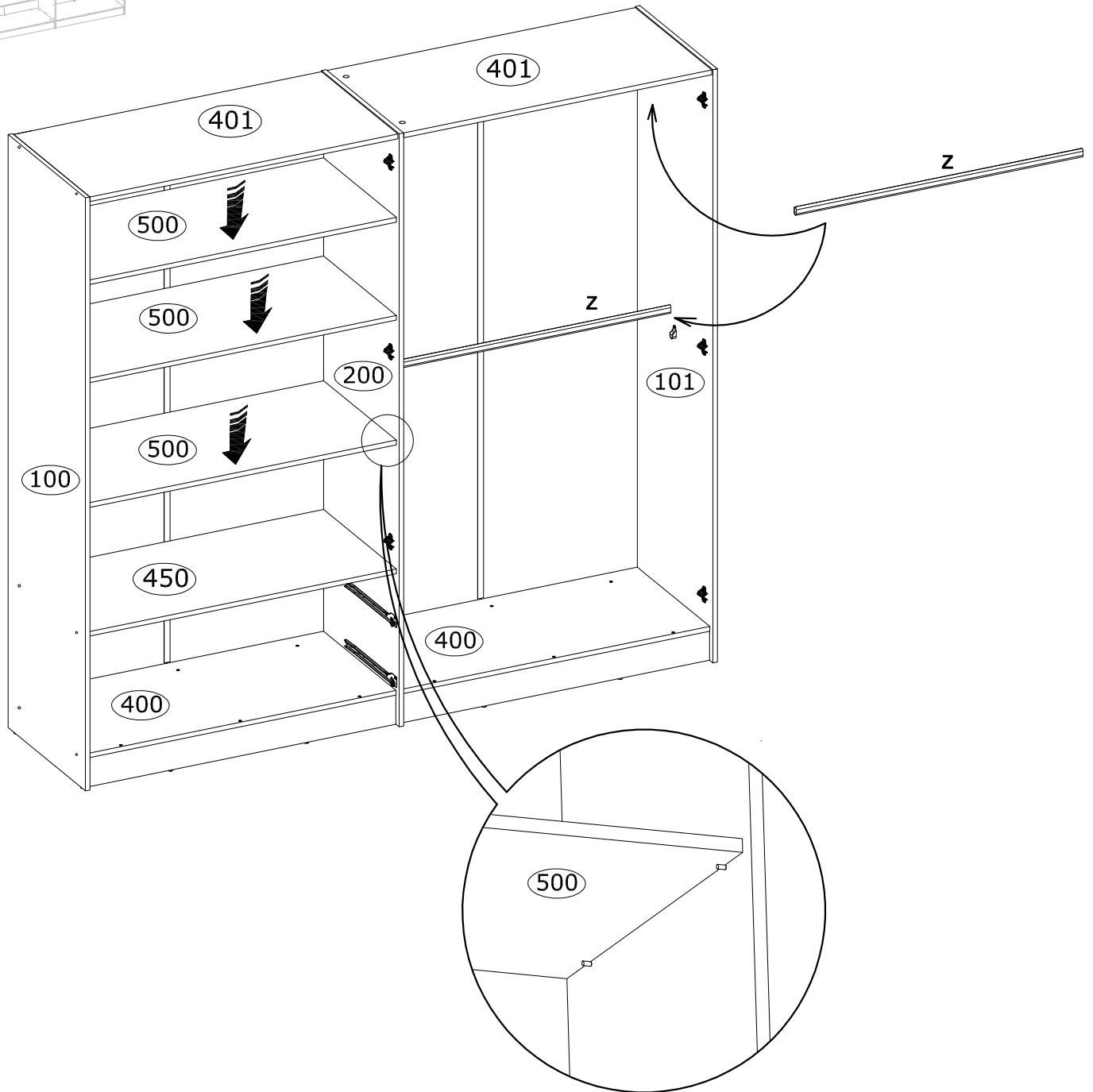
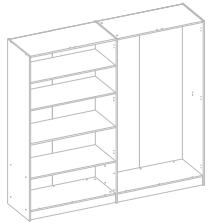
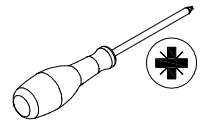

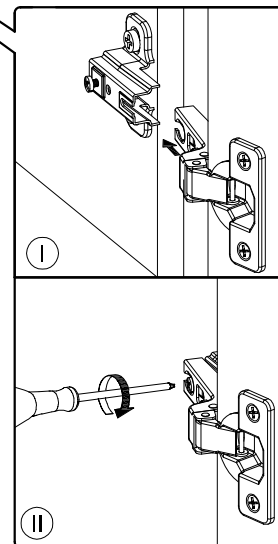
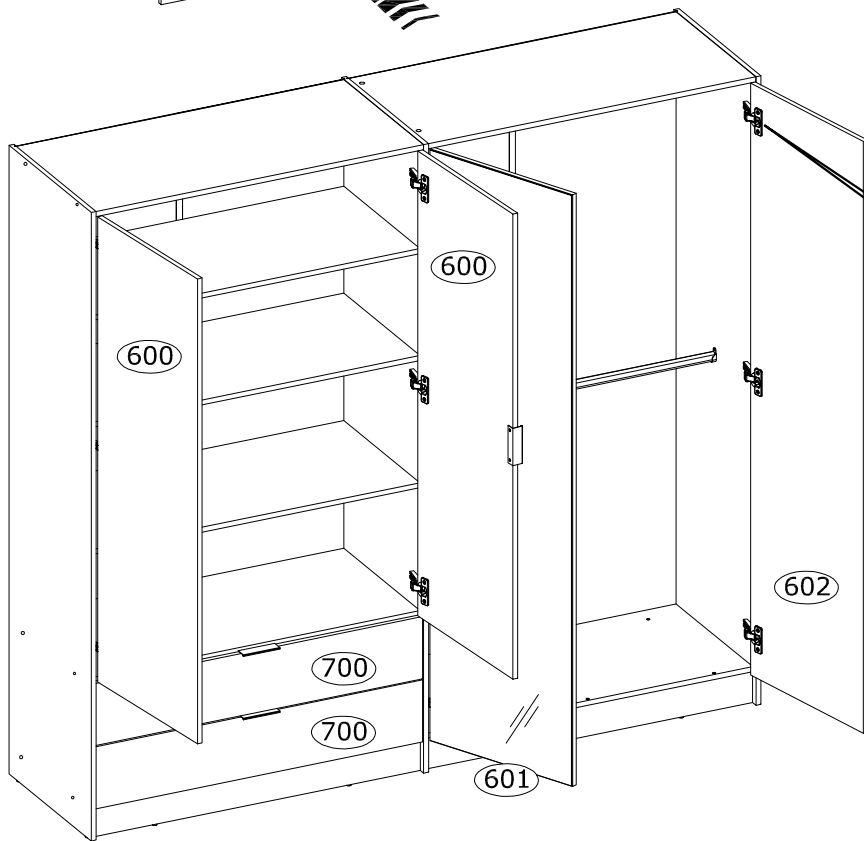
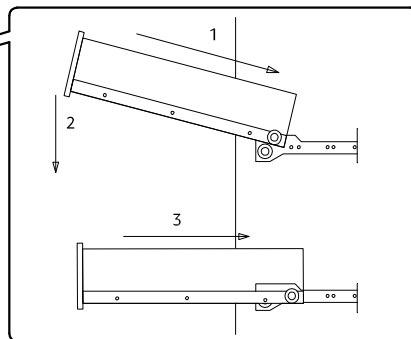
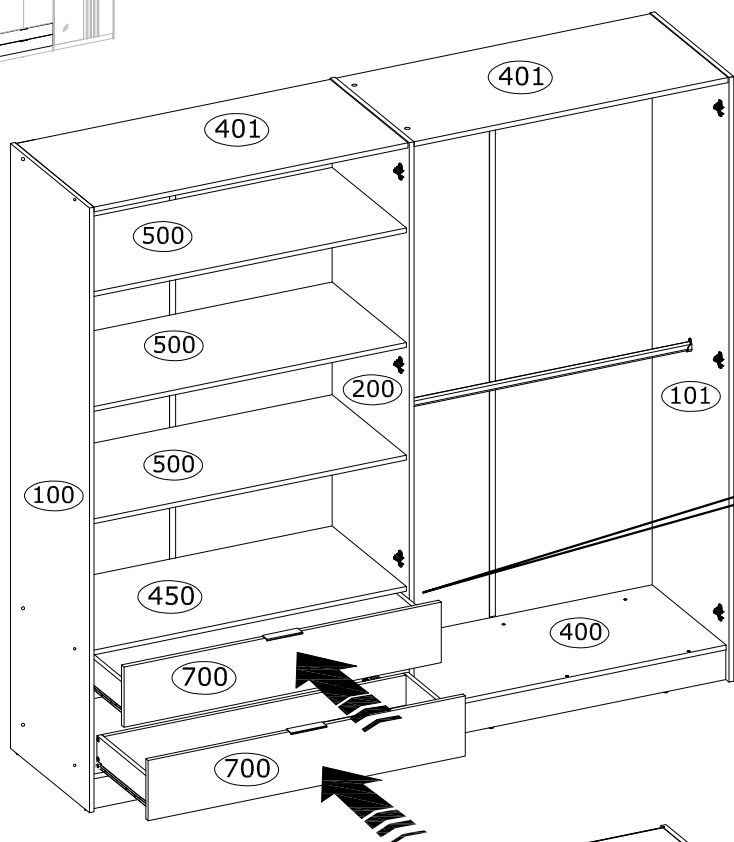
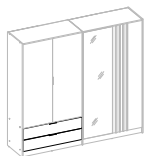
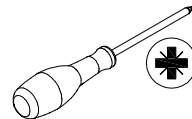

Z
L-1068 mm
x2
72529



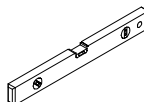

30

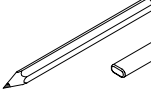
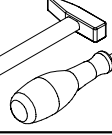

31

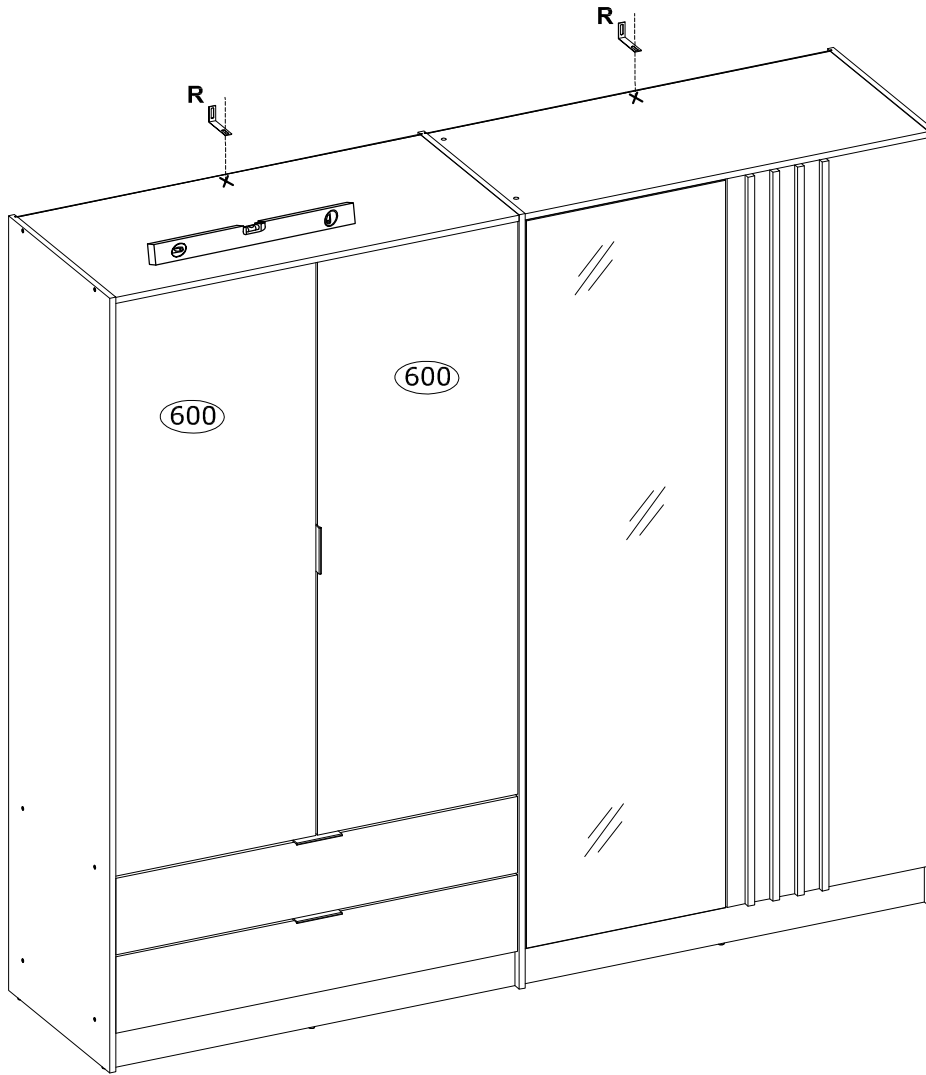
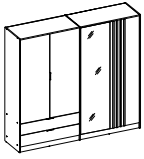
R 75x15x32 mm  x2 71900	I Ø3,5x16 mm  x4 3918	     
--	---	--

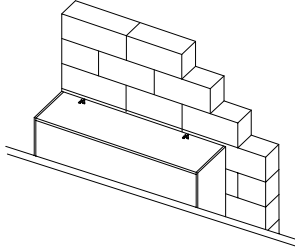
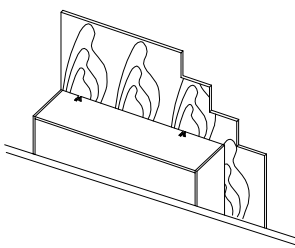
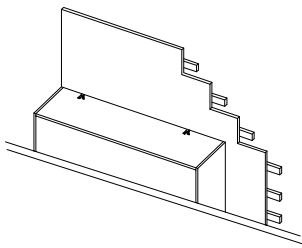
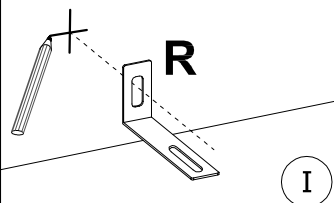
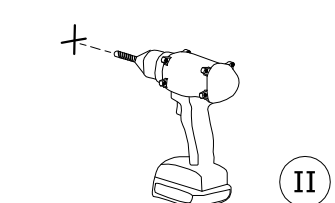
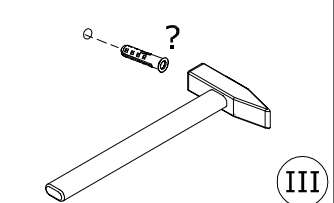
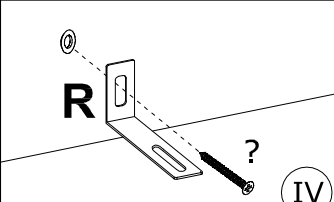
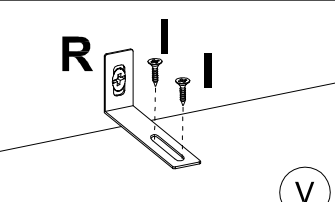

			
 I	 II	 III	
 IV	 V		

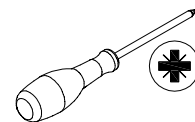

Türen einstellen (Scharniere justieren)
 Adjusting the door (adjusting the hinges)
Régler les portes (ajuster les charnières)
 Sistemare le porte (regolare le cerniere)
Deuren instellen (scharnieren afstellen)
 Nastawić drzwi (wyregulować zawiasy)
Vyrovnaťte dvířka (seřid'te závěsy)
 Nastavenie dverí (nastavenie závesov)
Állítsa be az ajtókat (állítsa be a zsanérokat)

Reglare uși (ajustare balamale)
Kapilarin ayarlanması (mentşelerin seviye ayarı)
 Регулировка дверей (регулировка шарнира)
Поставите врата (подесите шарке)
 Postavite vrata (podesite šarke)
Nastavenie dverí (nastavenie závesov)
 Sureguliuokite duris (sureguliuokite vyrius)
Pielāgojiet durvis (noregulējiet eņģes)
 Reguleeri uks (reguleeri hinged)

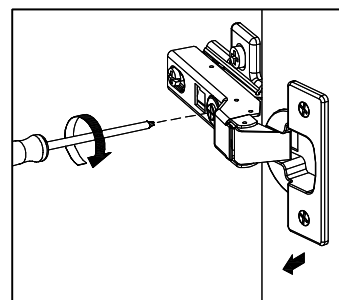
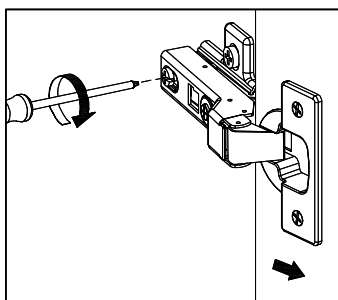
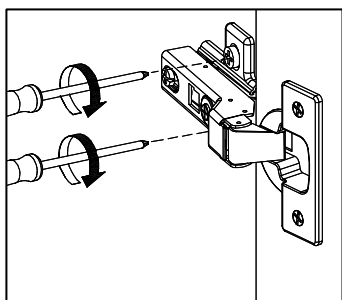
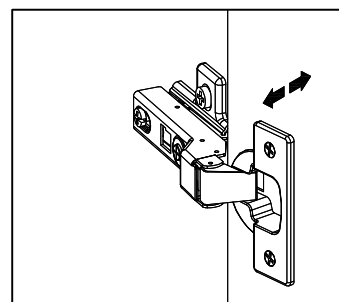
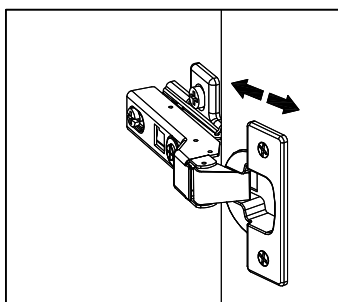
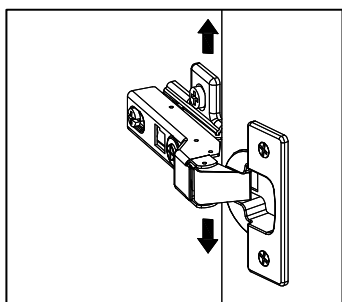
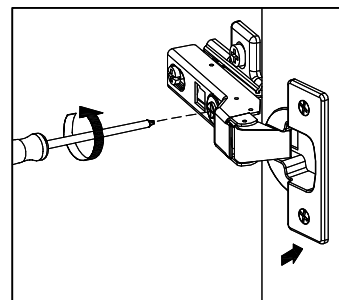
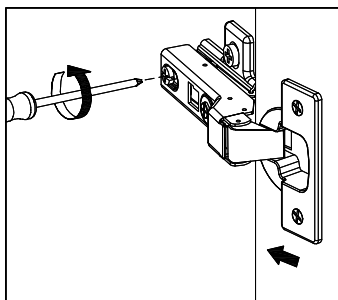
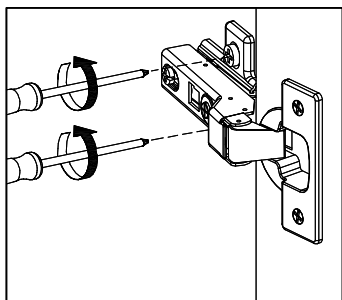
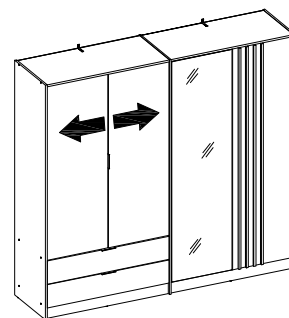
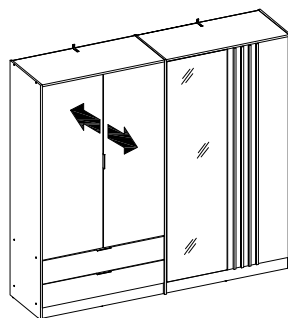
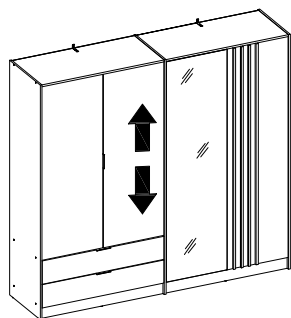

FR
**DONNEZ
 OU
 RECYCLEZ**



ASSOCIATION

OU

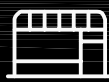

MAGASIN

OU



LIVRAISON

OU



DÉCHÈTERIE

Adresses sur quefairedemesdechets.fr