

Display

Battery charge indicator (approx. 45 min. run time)

Akkuladestand (ca. 45 Min. Laufzeit)

Dirty water tank full
Schmutzwassertank voll

Level 2

Boost button
Boost-Taste



Fresh water tank empty
Frischwassertank leer

Level 1

Switch button
Einstellungstaste

On/Off switch
Ein-/Aus-Schalter

Scan code for videos
Code scannen für Videos



www.kaercher.com/fc7

5.969-435.0 (07/21)

KÄRCHER

FC 7 CORDLESS QUICKSTART GUIDE

First assembly
Erstmontage

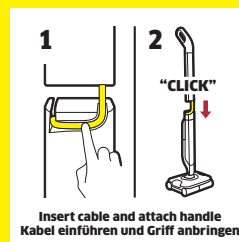

First steps before use
Erste Schritte vor dem Einsatz

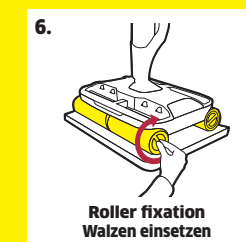
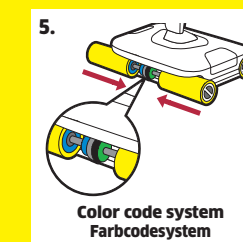
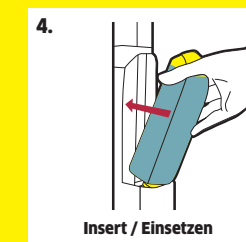
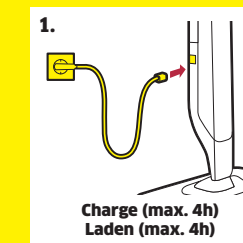

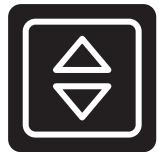

Switch cleaning mode
Reinigungsmodus wechseln

Level 1



Level 2



Activate boost function
Boost-Funktion aktivieren

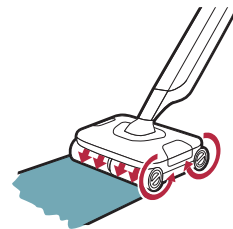

Please note:
Frequent boosting causes dirty water tank to fill quickly.

Hinweis:
Durch Anwenden der Boostfunktion wird der Schmutzwassertank schneller voll.

Cleaning and storing
Reinigung und Verstaung

Step 1: Clean the device
Schritt 1: Gerat reinigen

1.

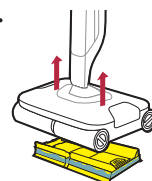

2.



3.

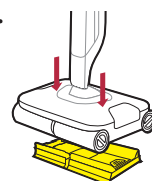

4.

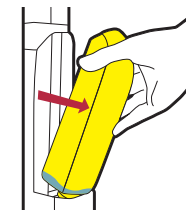

5.

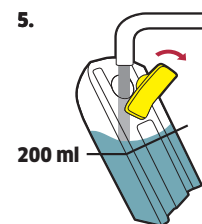

6.

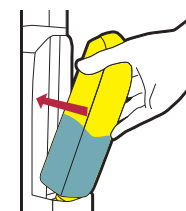

7.

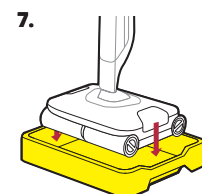

8.

Press 3 sec.
3 Sek. gedrückt halten



9.

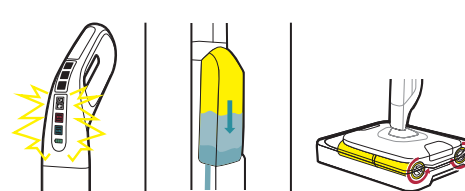

Please wait about 2 min. Bitte ca. 2 Min. warten

Step 2: Store the device
Schritt 2: Gerat verstaung



10.

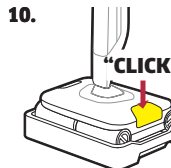

11.

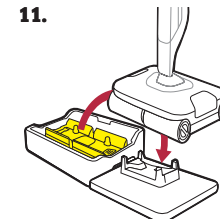

12.

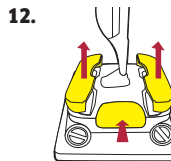

13.

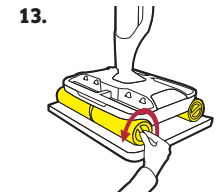

14.

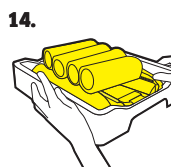

15.

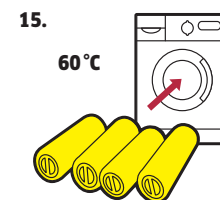

16.



17.

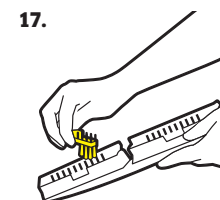

18.



19.

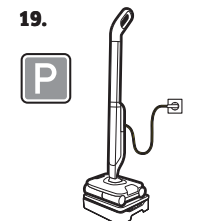

Refill fresh water tank
Frischwassertank auffullen

1.



2.

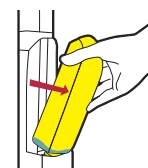

3.

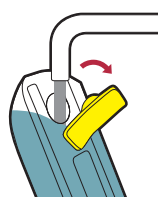

4.

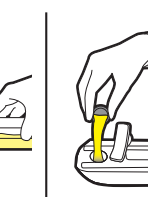

5.

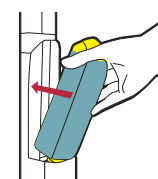

Empty dirty water tank
Schmutzwassertank leeren

1.



2.

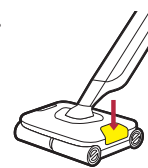

3.

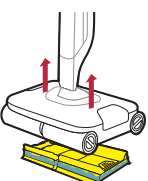

4.



5.

