

# USER MANUAL

## IN THE BOX

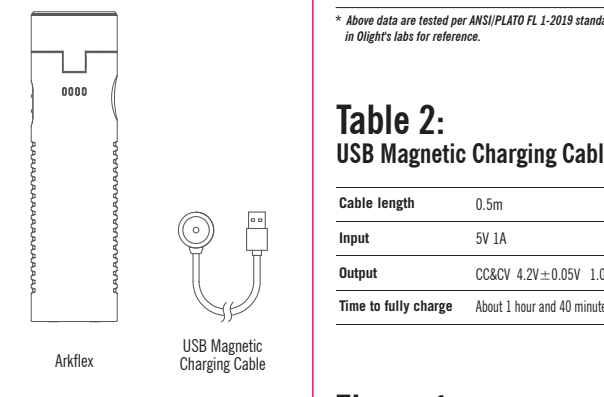

**Table 1: Specifications**

	COOL WHITE CCT: 6500K CRI>70
TURBO	1000 lumens, 40m, 50min
HIGH	450 lumens, 50m, 10min
MED	150 lumens, 60-50m, 30min
LOW	15 lumens, 38m, 10days
MOON	1.5 lumens, 10days

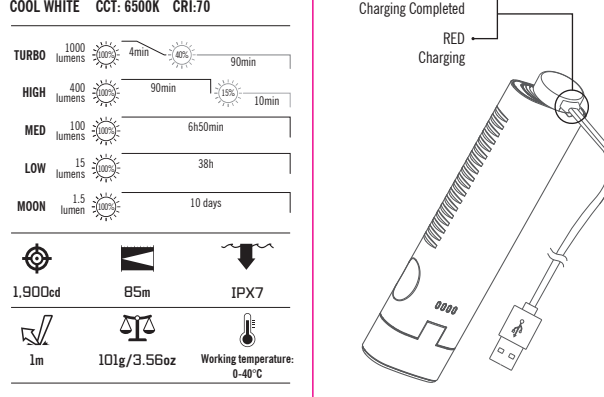

## (EN) English

- Product specifications see Table 1 & Table 2.
1. Product Specifications, see Table 1 and Table 2.
2. Charge, see Figure 1.
3. The light head can be turned 90 degrees, as shown in Figure 2.
- Note: The hinge is a fragile component, so please handle with care. Avoid dropping after rotating the head to a specific angle.
4. HOW TO OPERATE
- 4.1 ON/OFF, see Figure 3:
- Press the button to turn on/off. The flashlight will directly access the memorized brightness level when turned on again.
- 4.2 Lock/Unlock, see Figure 4:
- To lock the light when it's off, press and hold the button (for about 2 seconds) until the Moonlight mode (if it is operated in lockout mode), the red indicator will be on briefly as a signal. To unlock the light, press and hold the button for about 1 second until the Moonlight mode is on.
- 4.3 Change brightness level, see Figure 5:
- In white light mode, press and hold the button to change brightness levels. The brightness will cycle through the following modes: Moonlight (or Turbo) -> Low -> Medium -> High -> Low. Release the button to select the brightness level.
- 4.4 Moonlight mode, see Figure 6:
- In off state, press and hold the button for over 1 second to enter the Moonlight mode. If the memorized mode is Moonlight, just press the button.
- 4.5 Turbo mode, see Figure 7:
- Quickly double press the button to enter Turbo mode, and quickly double press again to return to the memorized mode.
- 4.6 Stroke mode, see Figure 8:
- Triple press the button to activate stroke mode.
5. Battery Indicator:
- 5.1 Normal mode, see Figure 9-1;
- 5.2 Moonlight mode, see Figure 9-2;
- 5.3 Strobes mode, see Figure 9-3;
- 5.4 Turbo mode, see Figure 9-4;
- 5.5 Non-Moonlight mode, see Figure 9-1-1;
- 5.6 Moonlight mode, see Figure 9-2-1;
- 5.7 Strobes mode, see Figure 9-3-1;
- 5.8 Turbo mode, see Figure 9-4-1;
- 5.9 Non-Moonlight mode, see Figure 9-1-2;
- 5.10 Moonlight mode, see Figure 9-2-2;
- 5.11 Strobes mode, see Figure 9-3-2;
- 5.12 Turbo mode, see Figure 9-4-2;

**(CN) 简体中文**  
多语言字典, 参见 Table 3;

**(SV) Swedish**  
Flerspråkigt uppslagsverk, se tabell 3;  
1. Produktspecifikation, se tabell 1 och tabell 2;  
2. Laddning, se figur 1;  
3. Ljusshuvudet kan vridas 90 grader, som visas i figur 2;  
Obs: Huvudsvavlet är en ömtålig komponent, hantera med försiktighet. Undvik att tappa efter att ha vridit huvudet.

**(FI) Finnish**  
Monikielinen sanakirja, katso taulukko 3;  
1. Tuotetiedot, katso taulukko 1 ja 2;  
2. Lataus, katso kuva 1;  
3. Valaisinjäsen voidaan kääntää 90° kuvan 2 mukaisesti.  
Huomautus: Pään nivel on herkkä komponentti, käsittele varovasti. Vältä tuomista pään kääntämisestä jälkeen.

**(NO) Norwegian**  
Flerspråklig ordbok, se tabell 3;  
1. Produktspesifikasjon, se tabell 1 og tabell 2;  
2. Lading, se figur 1;  
3. Ljushovudet kan vridas 90 grader, som visas i figur 2;  
Obs: Hovedsvavlet er en ømtålig komponent, hantera med försiktighet. Undvik att tappa efter att ha vridit huvudet.

## Figure 2 Light Head Can be Turned 90 Degrees

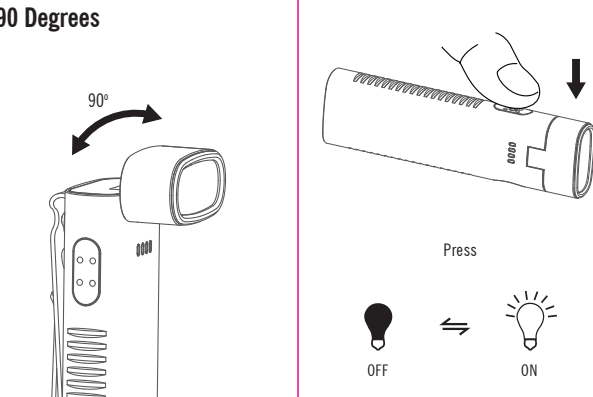

## Figure 3 ON/OFF

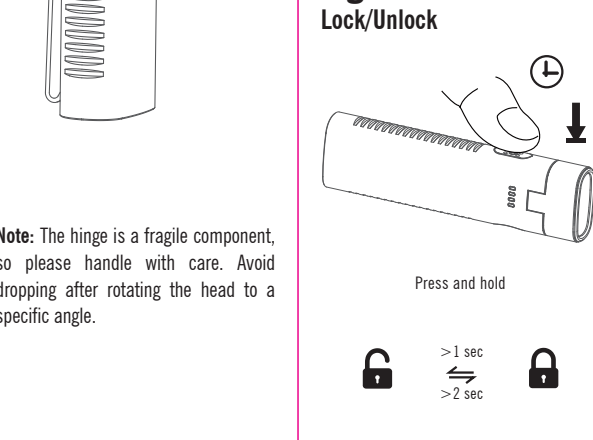

Note: The hinge is a fragile component, so please handle with care. Avoid dropping after rotating the head to a specific angle.

**(NL) Nederlands**  
Meertalig woordenboek, zie tabel 3;  
1. Productspecificatie, zie tabel 1 en tabel 2;  
2. Opladen, zie figuur 1;  
3. De lampkop kan 90 graden worden gedraaid, zoals getoond in Figuur 2;  
Opmerking: Het draagpunt van de lampkop is een kwetsbaar onderdeel. Vermijd vallen na het omdraaien van de kop.  
4. HOE TE BEDIENEN

## Figure 3 ON/OFF

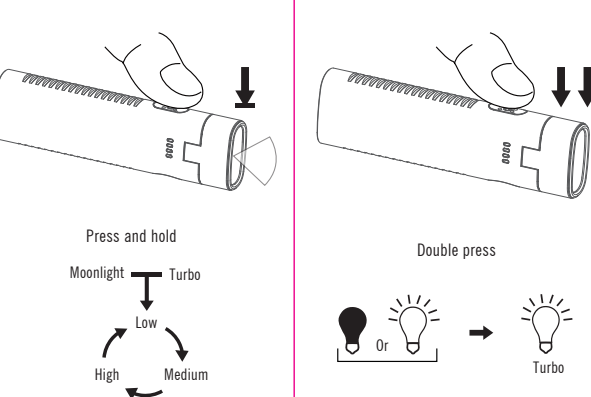

## Figure 4 Lock/Unlock

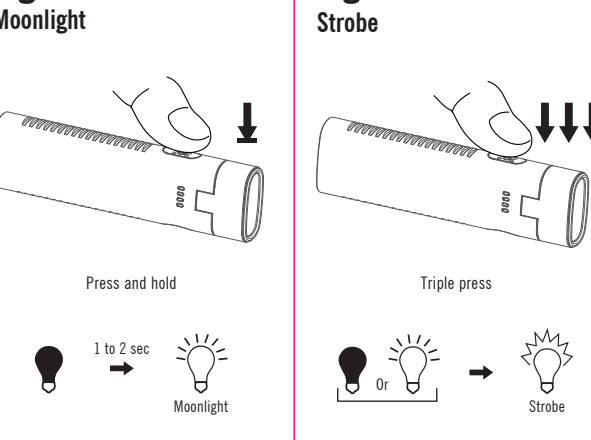

**(DE) Deutsch**  
Mehrsprachiges Wörterbuch, siehe Tabelle 3;  
1. Produktspezifikation, siehe Tabelle 1 und Tabelle 2;  
2. Aufladen, siehe Abbildung 1;  
3. Der Lampenkopf kann um 90° gedreht werden, wie in Abbildung 2 gezeigt.  
Hinweis: Der Lampenkopf ist ein empfindliches Teil, bitte vorsichtig behandeln. Bitte Stürze nach dem Drehen des Lampenkopfes vermeiden.

## Figure 5 Change Brightness Level

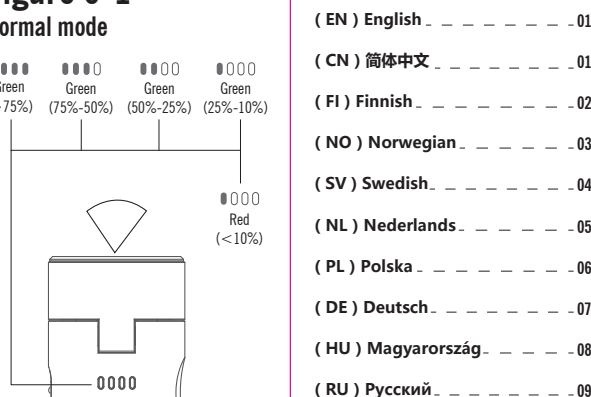

## Figure 6 Moonlight

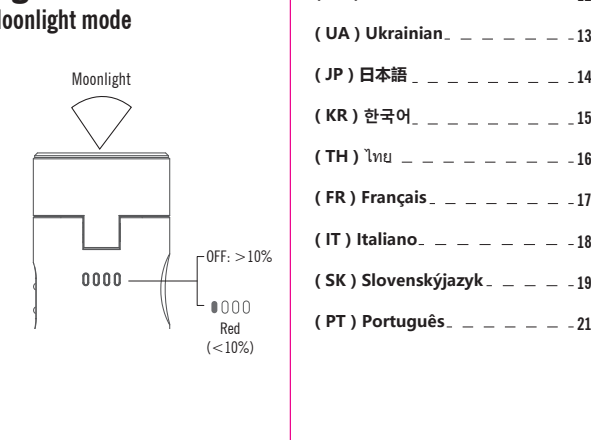

**(PL) Polska**  
Słownik wielojęzyczny, zobacz Tabelę 3;  
1. Specyfikacja produktu, zobacz Tabelę 1 i Tabelę 2;  
2. Ładowanie, zobacz Obraz 1;  
3. Wyświetlacz światła może być obrócony o 90 stopni, jak pokazano na rysunku 2;  
Uwaga: Łącznik jest delikatną częścią, należy go obsługiwać ostrożnie. Unikaj upadku po obróceniu głowicy latarki.

## Figure 7 Turbo

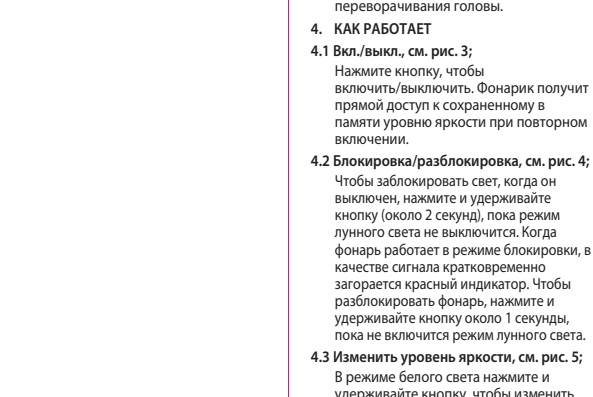

## Figure 8 Strobe

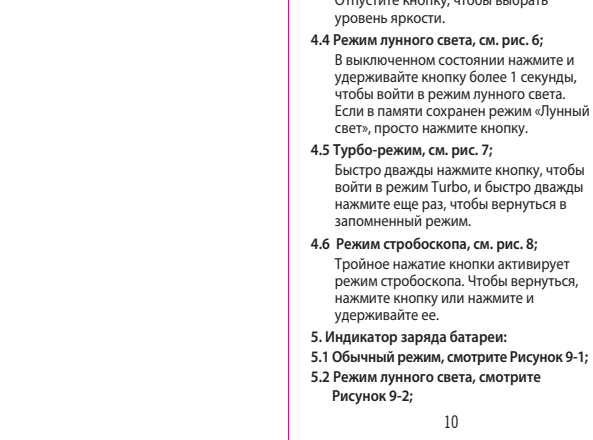

**(RU) Русский**  
Многоязычный словарь, см. таблицу 3;  
1. Технические характеристики изделия, см. Таблицу 1 и Таблицу 2;  
2. Зарядка, см. рис. 1;  
3. Световой головкой можно повернуть на 90 градусов, как показано на рисунке 2;

## Battery Indicator

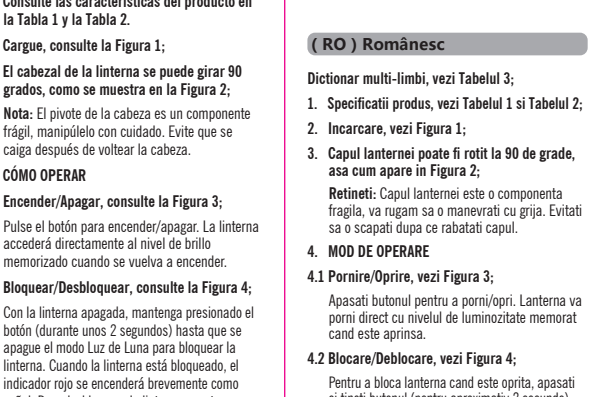

## Figure 9-1 Normal mode

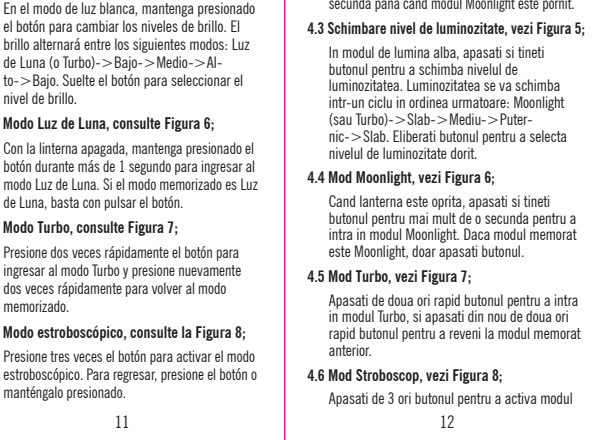

## Figure 9-2 Moonlight mode

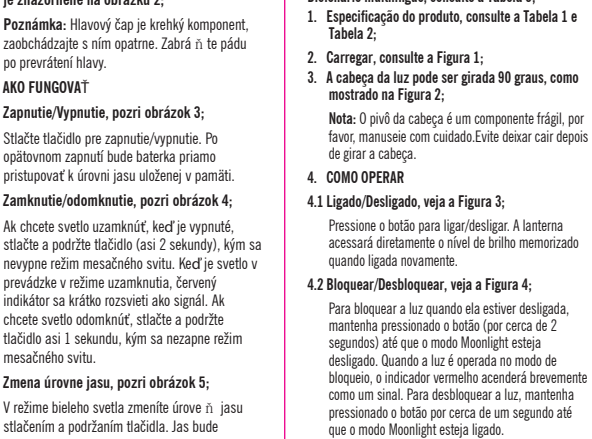

**(HU) Magyarországi**  
Többnyelvű szótár, lásd 3. táblázat;  
1. Műszaki adatok, lásd 1. és 2. táblázat;  
2. Töltés, lásd 1. ábra;  
3. A lámpafej 90 fokkal elfordítható, lásd 2. ábra;  
Megjegyzés: A fej elforgatása törékeny alkatrészt érint.

## (ES) Español

Diccionario multilingüe, consulte la Tabla 3;  
1. Consulte las características del producto en la Tabla 1 y la Tabla 2;  
2. Cargue, consulte la Figura 1;  
3. El cabezal de la linterna se puede girar 90 grados, como se muestra en la Figura 2;  
Nota: El pivote de la cabeza es un componente frágil, manipuléelo con cuidado. Evite que se caiga después de voltear la cabeza.

## (RO) Românesc

Dictionar multi-limbă, vezi Tabelul 3;  
1. Specificații produs, vezi Tabelul 1 și Tabelul 2;  
2. Încarcare, vezi Figura 1;  
3. Capul lanternei poate fi rotit la 90 de grade, așa cum apare în Figura 2;  
4. Încercare de baterii:  
5.1 Modul normal, consulta la Figura 9-1;  
5.2 Modul de luz de luna, consulta la Figura 9-2;

## (UA) Ukrainian

Багатомовний словник, див. Таблицю 3;  
1. Технічні характеристики виробу, див. Таблицю 1 та Таблицю 2;  
2. Заряджання, див. Малюнок 1;  
3. Керування світлом:  
5. Індикатор заряду батареї:  
5.1 Стандартний режим, див. Малюнок 9-1;  
5.2 Режим "Місячного світла", див. Малюнок 9-2;

## (JP) 日本語

多言語辞書はTable 3をご参照ください。  
1. 製品仕様はTable 1及びTable 2をご参照ください。  
2. 充電方法についてはFigure 1をご参照ください。  
3. ライトヘッドは90度回転できます。詳しくはFigure 3をご参照ください。  
4. バッテリー充電方法についてはFigure 4をご参照ください。  
5.1 モードについてはFigure 9-1をご参照ください。  
5.2 ムーンモードについてはFigure 9-2をご参照ください。

## (KR) 한국어

다른 언어로 해당 단어를 확인하시려면 Table 3을 참고해 주십시오.  
1. 제품仕様, Table 1과 2 참고  
2. 충전, Figure 1  
3. 라이트 헤드는 90도 회전, Figure 2 참고  
4. 배터리 충전 방법, Figure 3 참고  
5.2 모드, Figure 9-2 참고

## (FR) Français

Dictionnaire multi-langues, voir Table 3;  
1. Caractéristiques du produit, voir Table 1 et Table 2;  
2. Recharge, voir Figure 1;  
3. La tête de la lampe peut pivoter à 90 degrés, voir Figure 2;  
Remarque : le pivot de la tête est un composant fragile, veuillez le manipuler avec précaution et évitez de faire tomber la lampe après avoir tourné la tête.

## (TH) ไทย

พจนานุกรมหลายภาษา  
1. รายละเอียดผลิตภัณฑ์  
2. วิธีการชาร์จไฟ  
3. หัวไฟสามารถหมุนได้ 90 องศา  
4. วิธีการชาร์จแบตเตอรี่  
5.1 โหมดปกติ  
5.2 โหมดไฟจันทร์

## (IT) Italiano

Dizionario multilingua, vedi Tabella 3;  
1. Specifiche del prodotto, vedere Tabella 1 e Tabella 2;  
2. Caricatura, vedere Figura 1;  
3. La testa della luce può essere ruotata di 90 gradi, come mostrato nella Figura 2;

## (PT) Português

Dicionário multilíngue, consulte a Tabela 2;  
1. Especificações do produto, consulte a Tabela 1 e Tabela 2;  
2. Carregar, consulte a Figura 1;  
3. A cabeça da luz pode ser girada 90 graus, como mostrado na Figura 2;  
Nota: O pivô da cabeça é um componente frágil, manipule com cuidado. Evite cair depois de girar a cabeça.

## (SK) Slovenský jazyk

Viacjazyčný slovník, pozri tabuľku 3;  
1. Špecifická produkta, pozri tabuľku 1 a tabuľku 2;

## WARRANTY

We are proud to offer a lifetime warranty in Australia, China, France, Germany, and the USA. We are also working hard to expand coverage to more countries, where we provide a 2 or 5-year warranty. The warranty covers defects in material and workmanship under normal use, excluding loss, theft, deliberate damage, or cosmetic damage. For complete warranty information, please visit [qlight.com](https://www.qlight.com) or your local [qlight.com](https://www.qlight.com) official website.

- Australia Customer Support**  
contact@qlightstore.com.au
- Austria Customer Support**  
kontakt@qlightstore.at
- Canada Customer Support**  
ca@qlightstore.ca
- China Customer Support**  
Wechat: qlights
- France Customer Support**  
ca@qlightstore.fr
- Germany Customer Support**  
kontakt@qlightstore.de
- Italy Customer Support**  
contact@qlightstore.it
- Japan Customer Support**  
ca@qlightstore.jp
- Korea Customer Support**  
qlightkorea@qlight.com
- Spain Customer Support**  
contact@qlightstore.es
- Thailand Customer Support**  
ca@qlightstore.co.th
- UK Customer Support**  
contact@qlightstore.uk
- USA Customer Support**  
ca@qlightstore.com
- For other countries and regions, please contact Global Customer Support**  
contact@qlight.com

## (EN) English

3.4000.0781 C. 12.07.2023

