

2-Sitzer medium ALR

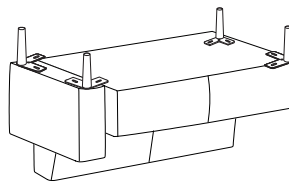

2-Sitzer medium AL/R

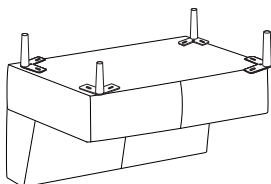

2-Sitzer medium ohne Armlehne

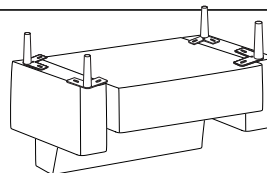

1,5-Sitzer (medium, maxi) ALR

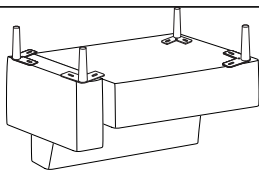

1,5-Sitzer (medium, maxi) AL/R

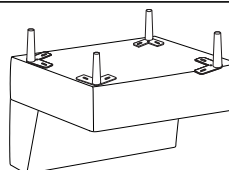

1,5-Sitzer (medium, maxi) ohne Armlehne

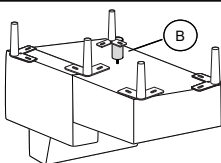

Longchair long (groß) AL/R
 Longchair (groß) AL/R

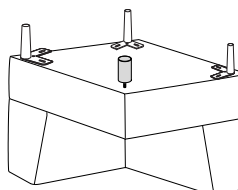

Spitzecke klein / Kombiecke

A	Höhe 120 mm	B	Höhe	C	Höhe 120 mm	D		E		F	Modellnummer 32595, 32596, 32734, 32735
											Stand 04.01.2024
Metallfuß		Stützfuß		Metallfuß							Revision 11
Kundenseitig		Kundenseitig		Kundenseitig							Verfasser IKR

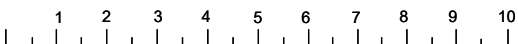

DE Fuß / Position

EN Foot / Position

NL Poot / Positie

IT Piedi / Posizione

RU Ноги / Позиция

FR Pied / Position

ES Pie / Posición

TR Ayak / Pozisyon

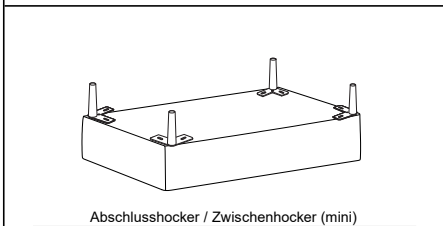
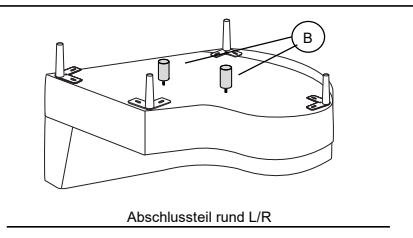
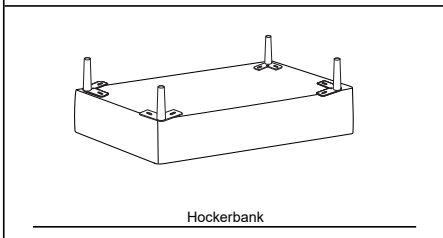
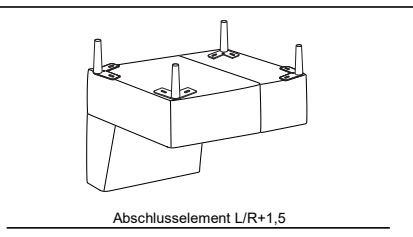
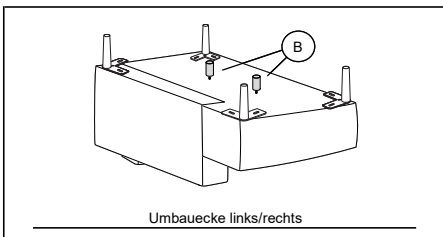

- (A) Metallfuß 908 schwarz matt **120mm**
Metallfuß 906 Chrom glänzend **120mm**
- (C) Metallfuß 865 schwarz matt **120mm**
Metallfuß 506 Chrom glänzend **120mm**

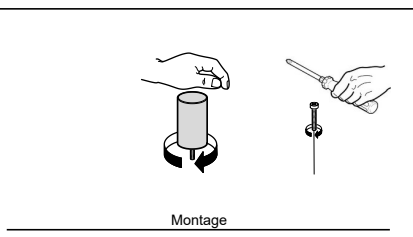
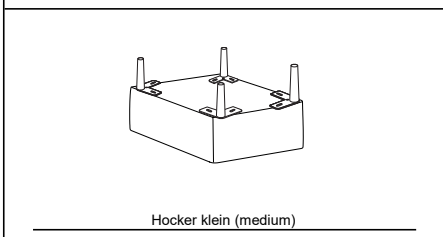

(A) Höhe 120 mm	(B) Höhe	(C) Höhe 120/150mm	(D)	(E)	(F)	Modellnummer 32595, 32596, 32734, 32735
						Stand 04.01.2024
Metallfuß	Stützfuß	Metallfuß				Revision 11
Kundenseitig	Kundenseitig	Kundenseitig				Verfasser IKR

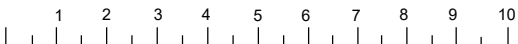

FOB_FU_0539

DE Fuß / Position

EN Foot / Position

NL Poot / Positie

IT Piedi / Posizione



RU Ноги / Позиция

FR Pied / Position

ES Pie / Posición

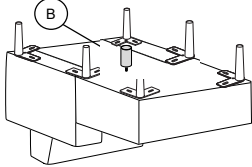
TR Ayak / Pozisyon

 <p style="text-align: center;">Longseat</p>	

A Höhe	B Höhe	C Höhe	D Höhe	E Höhe	F	Modellnummer 32595, 32596, 32734, 32735
						Stand 04.01.2024
Metallfuß	Stützfuß	Metallfuß				Revision 11
Kundenseitig	Kundenseitig	Kundenseitig				Verfasser IKR

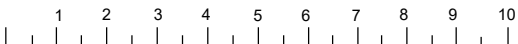

25.03.2013

Stand

00

Revision

APO

Verfasser

1 / 1

Seite(n)

höhenverstellbarer Stützfuß

Bezeichnung

FOB_MO_0011

lfd. Nr.

1

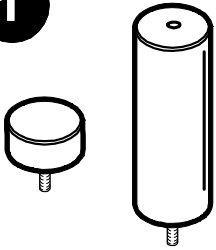

2

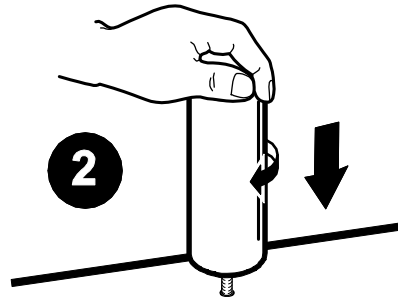

3

