

Artikel.-Nr.:

**0811-KO\_24**

Montageanleitung.-Nr.:

**MA1-00458**

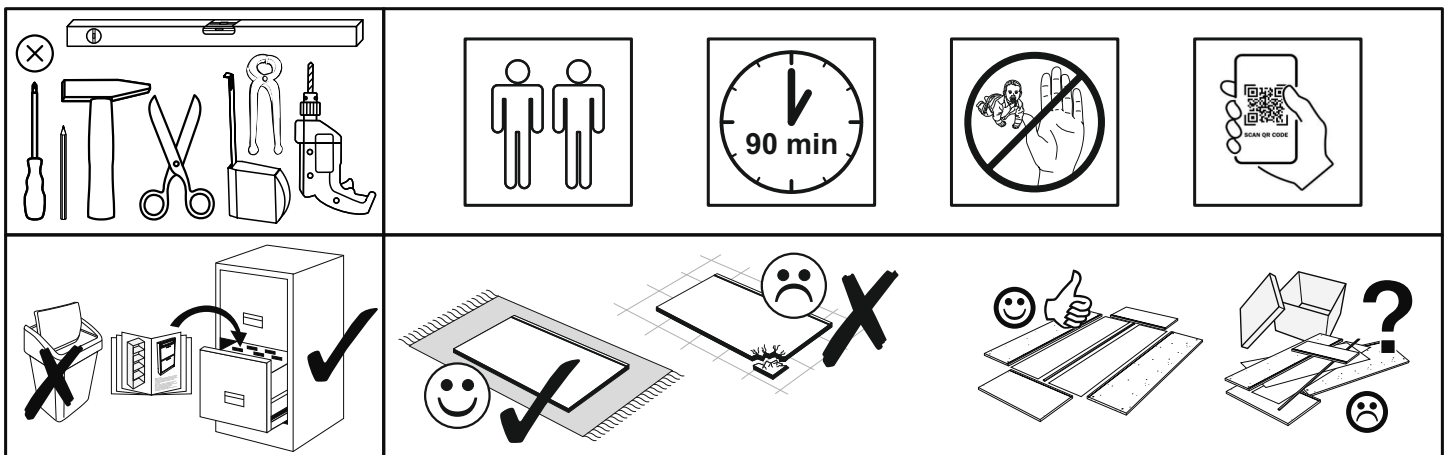

SCAN ME

Das Ersatzteil-Anforderungsformular finden Sie auf  
The replacement parts requisition form you find on  
<https://www.maeusbacher.de/ersatzteile/>

## BT1-00230 Colli 1/2

B03-43		B03-11		B03-07	
4x		4x		2x	

## BT1-00553 Colli 1/2

B05-185		B05-190	
4x		2x	
B06-535		B05-20	
6x		16x	ø20mm

## BT1-00005 Colli 1/2

B02-173		B01-123	
8x		16x	4,0x15

## BT1-00552 Colli 1/2

B02-10		B02-20		B02-65	
42x	ø15x12mm	26x		8x	
B01-10		B02-103		B05-20	
8x	6,3x50	42x	8x30	16x	ø20mm
B02-160		B01-200		B01-30	
8x		16x	6,3x13	52x	3x16
B01-80		B01-90		B01-122	
8x	3,5x13	6x	3,5x20	8x	4,0x13
B01-327		B08-80			
12x	M4x19	1x			

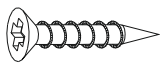

L = 20 mm

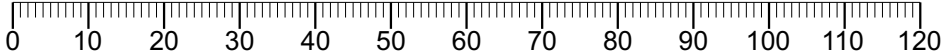

SCAN ME

## Colli 1/2

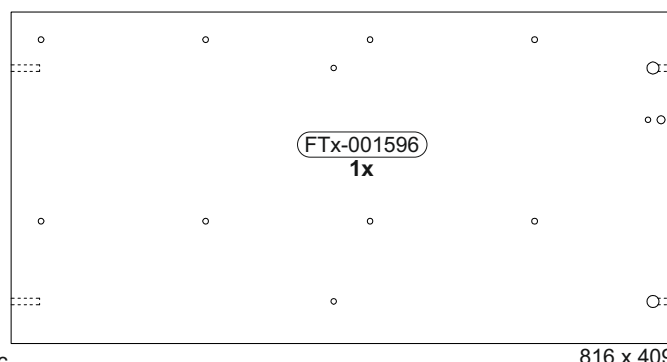
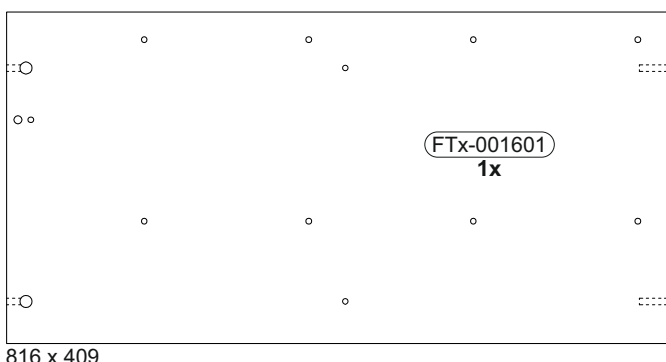
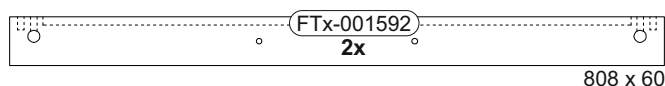
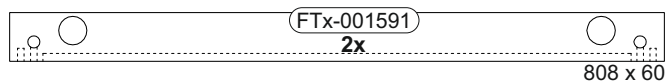
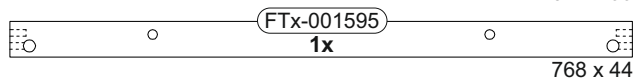
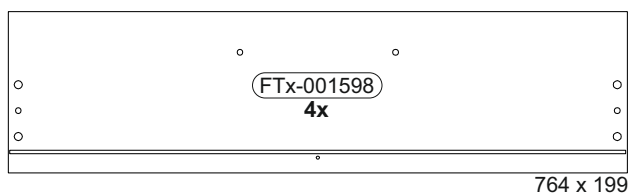
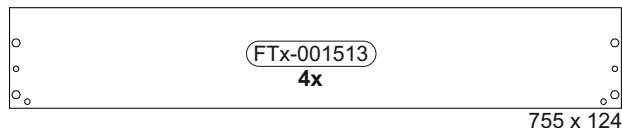
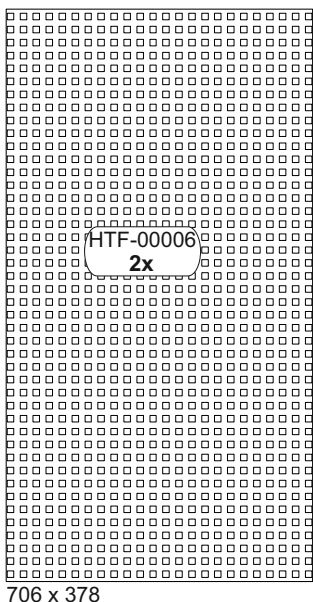
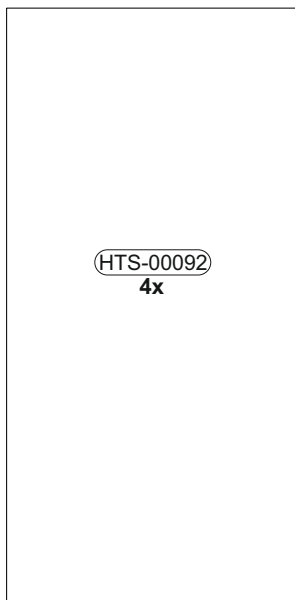
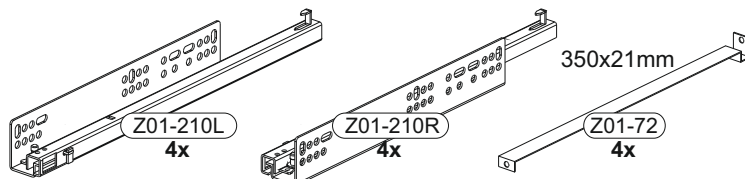
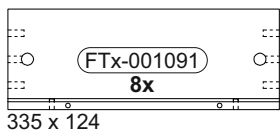
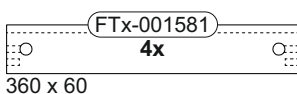

**Colli 1/2**

(FTx-001214)  
1x

(Z02-500)  
3x

500 x 50

468 x 397

(HTR-00491)  
2x

1746 x 414

(FTx-001599)  
1x

816 x 444

(FTx-001593)  
1x

816 x 444

(FTx-001600)  
1x

1773 x 444

(FTx-001602)  
1x

1773 x 444

**1**

	<b>B02-10</b> 16x	 ø15x12mm	<b>B02-20</b> 16x	 32x	 8x30	<b>B01-122</b> 8x	 4,0x13	<b>B01-30</b> 36x	 3x16
						<b>B06-535</b> 4x		<b>B01-327</b> 8x	 M4x19

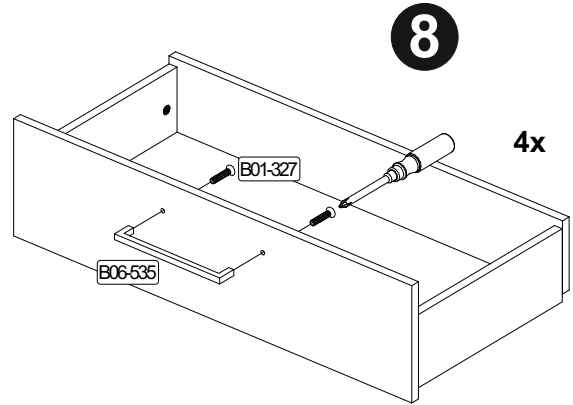
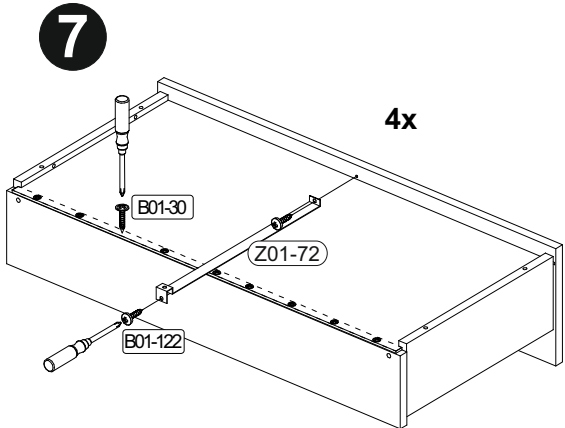
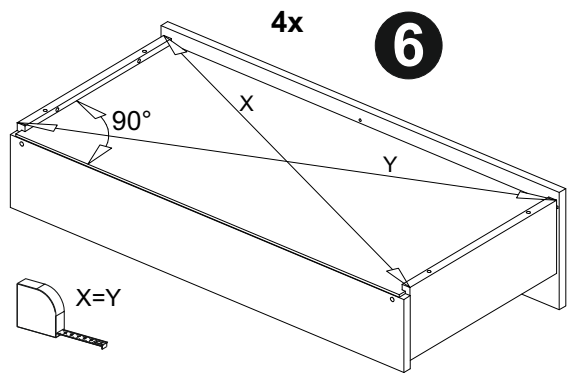
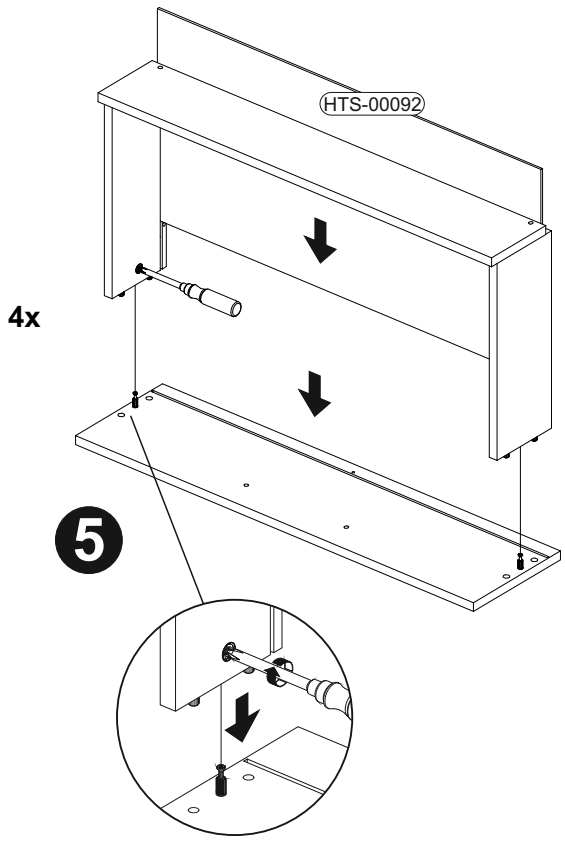
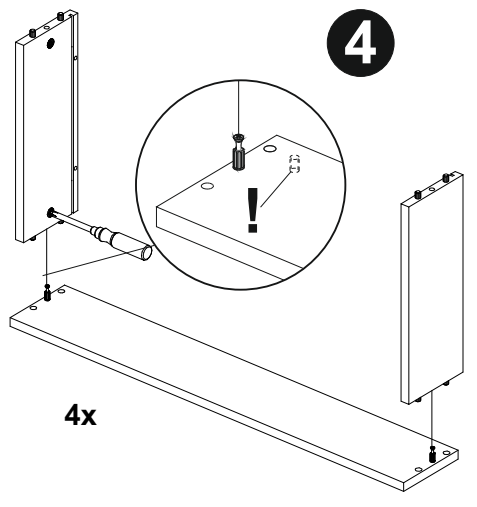
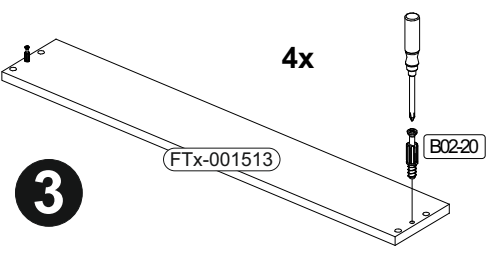
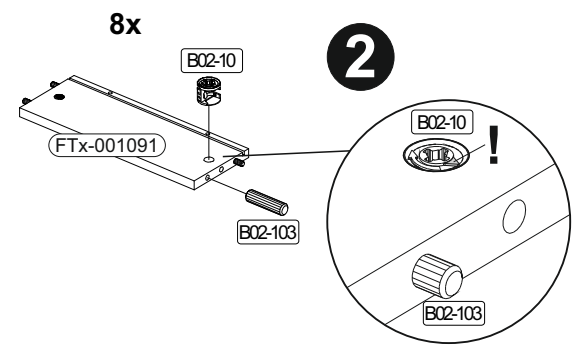
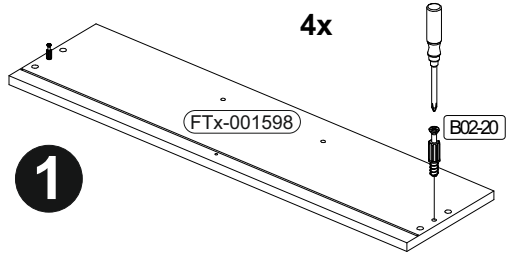

2

	2x	1x		2x		8x	
	$\varnothing 15 \times 12 \text{mm}$						6,3x13

1

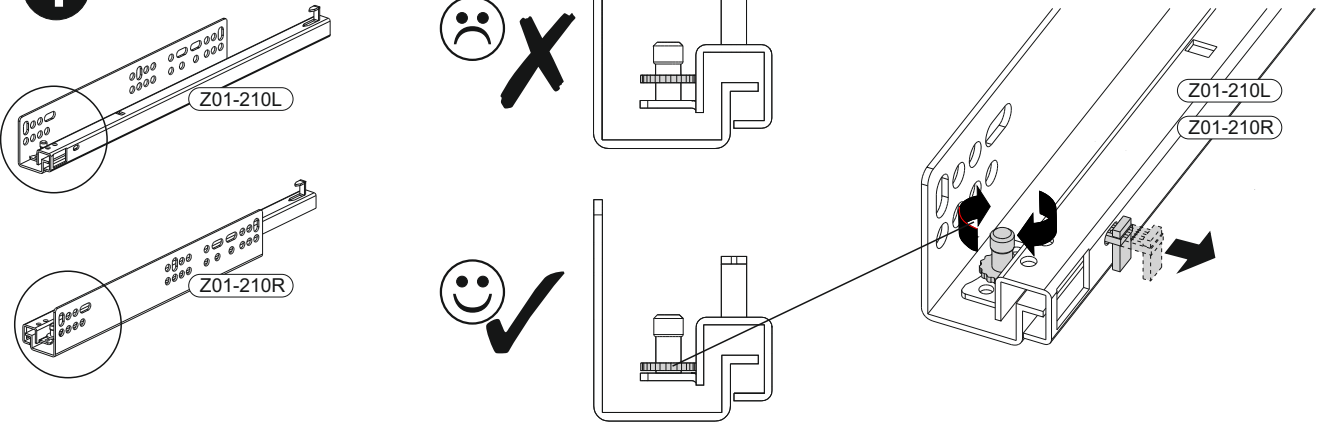

2

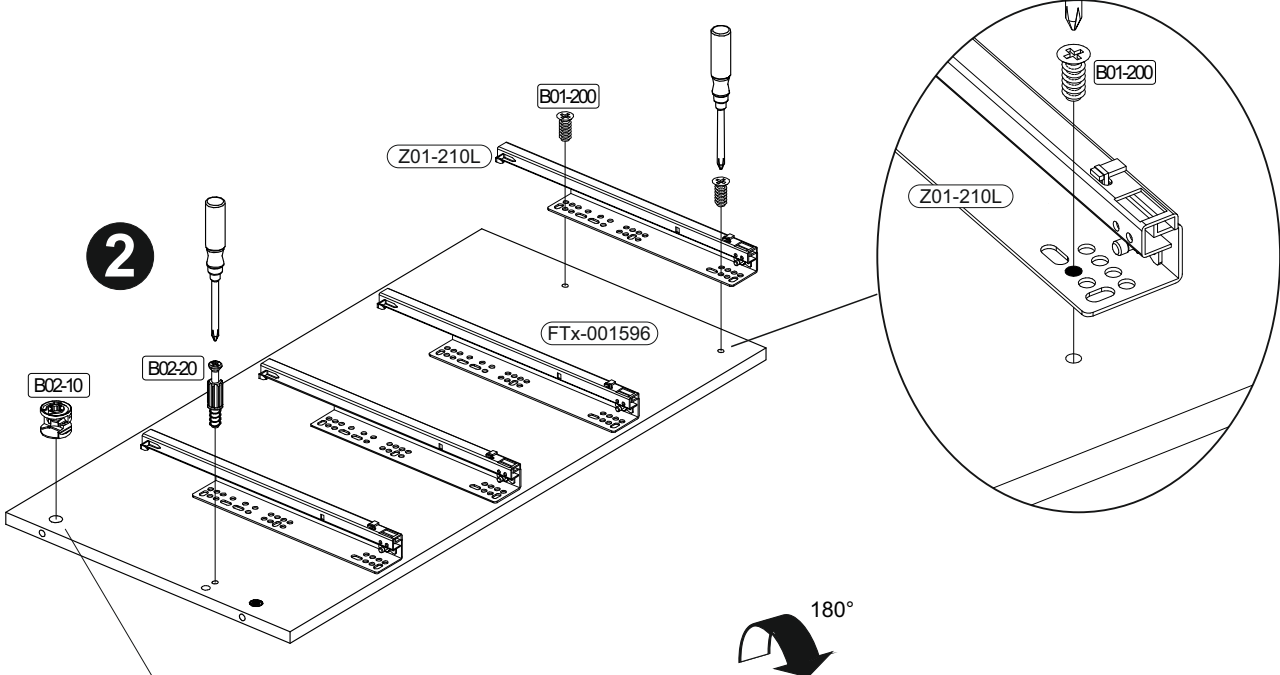

3

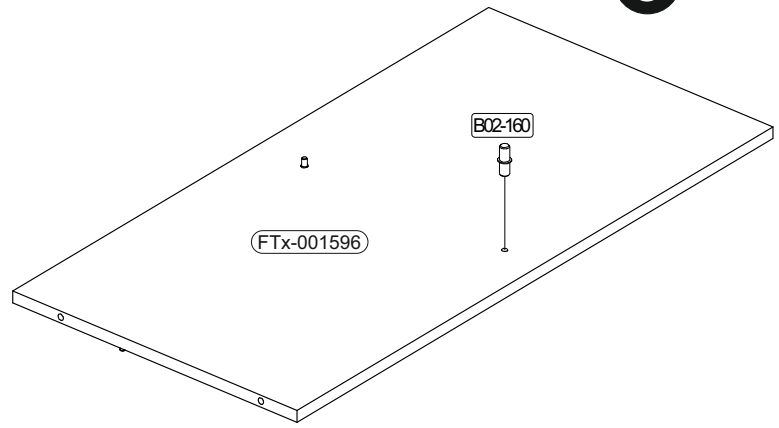
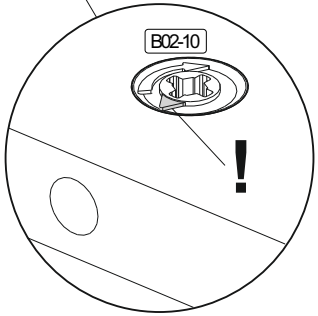

**3**

	B02-10	ø15x12mm	B02-20	B02-160		B01-200	6,3x13
	2x		1x	2x		8x	

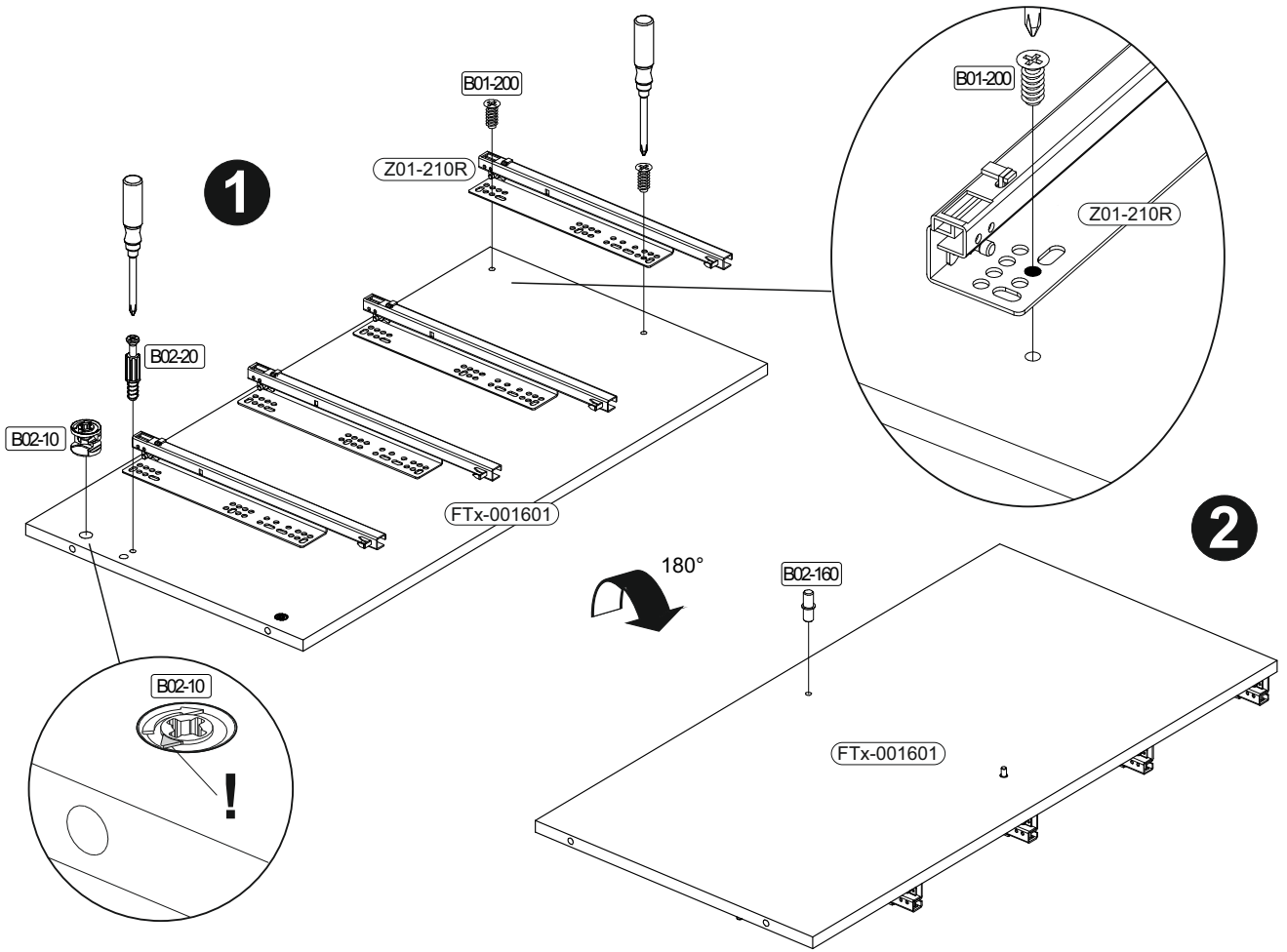

**4**

	B02-10	ø15x12mm	B02-160	B03-11	
	4x		4x	4x	

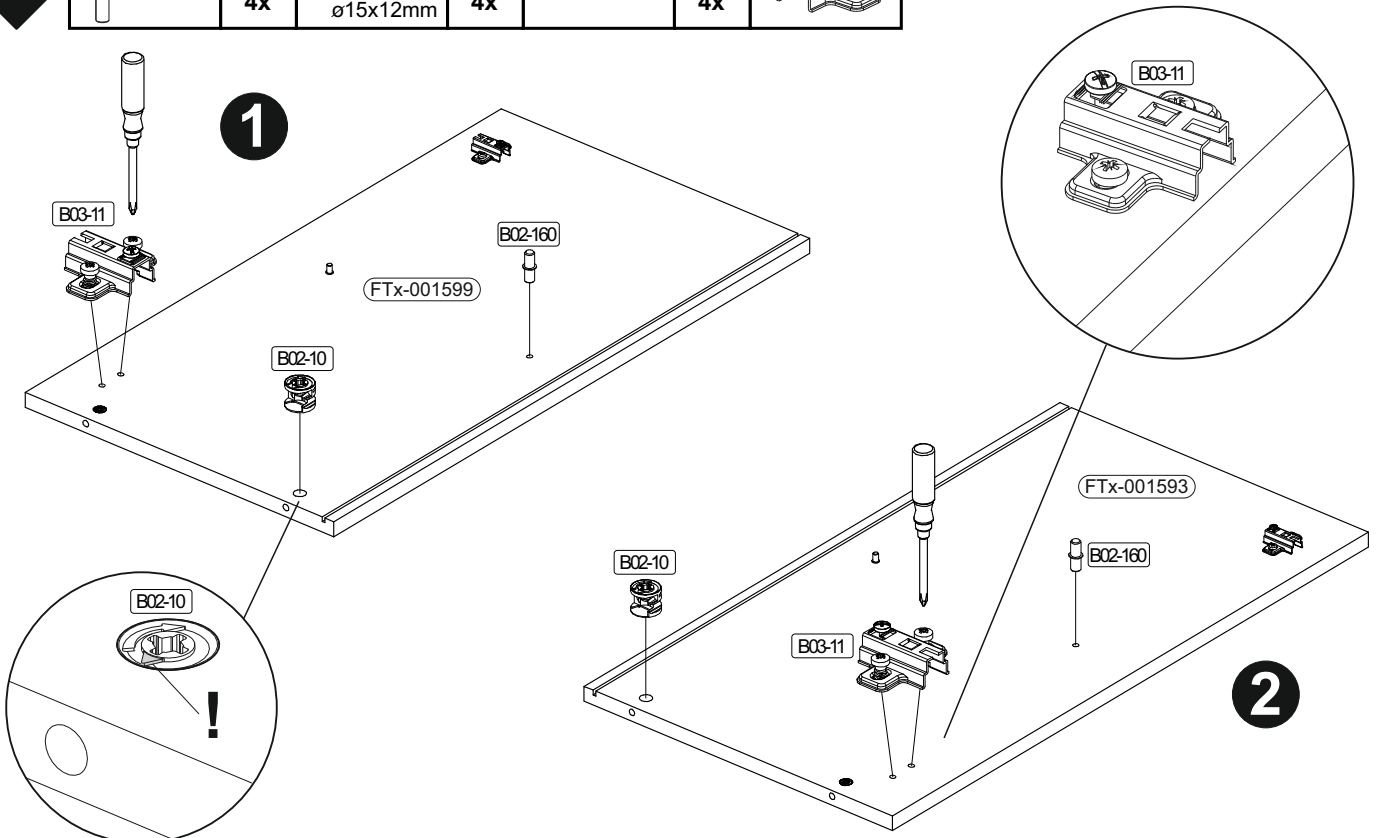

**5**

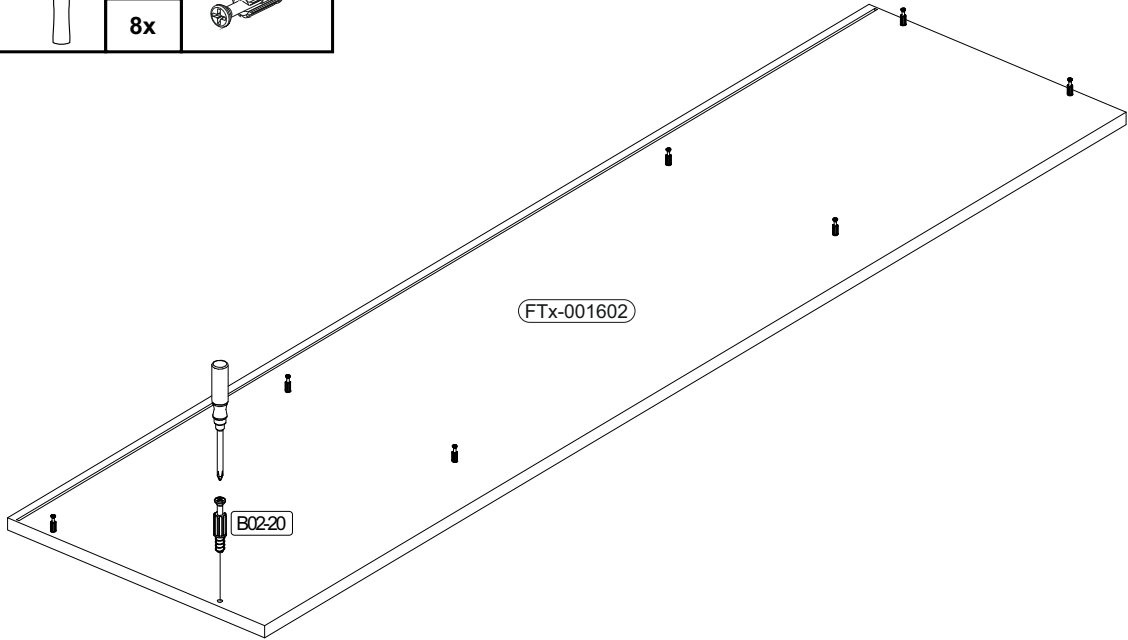
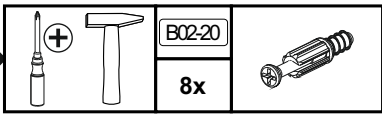

**6**

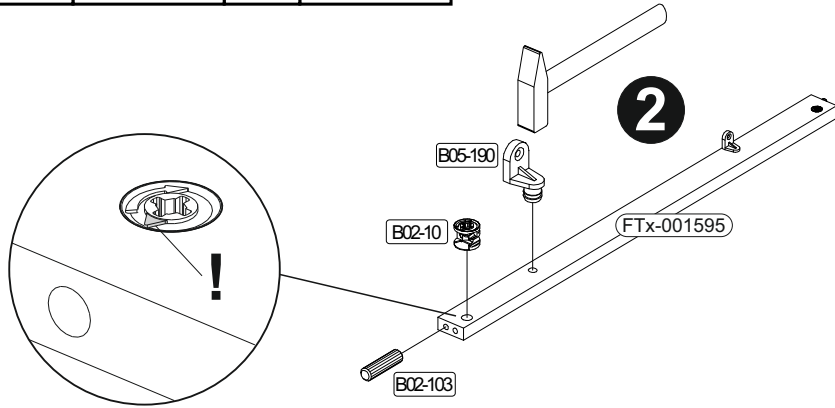
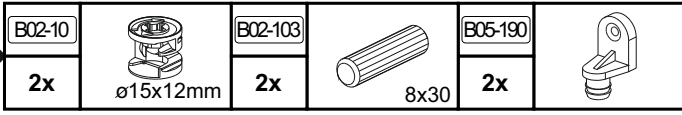

**7**

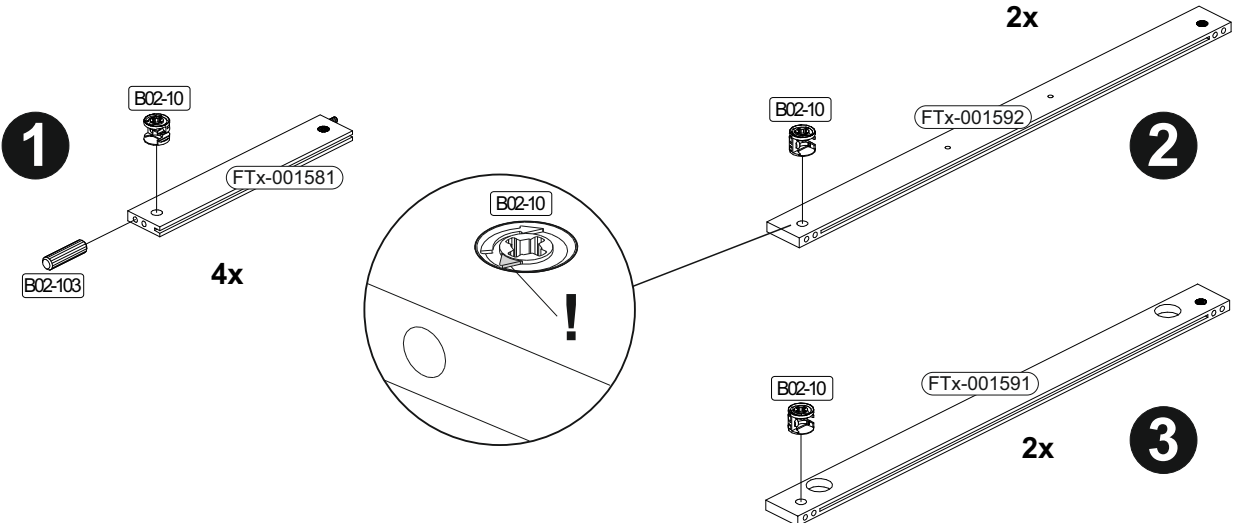
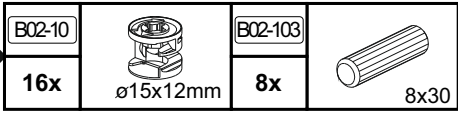

8

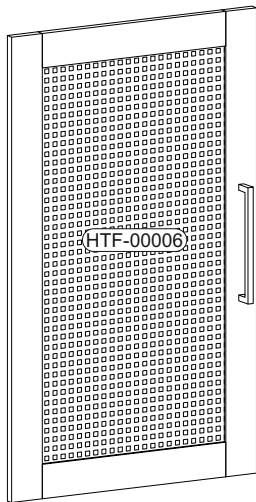
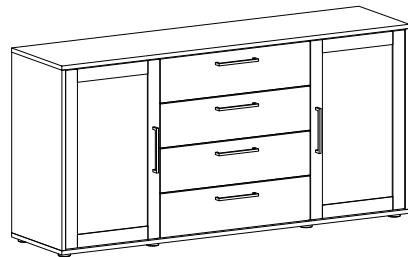
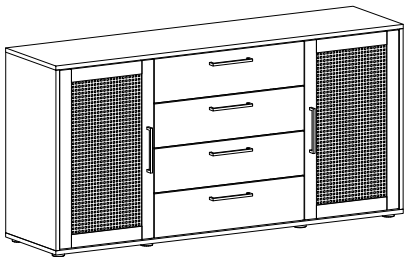
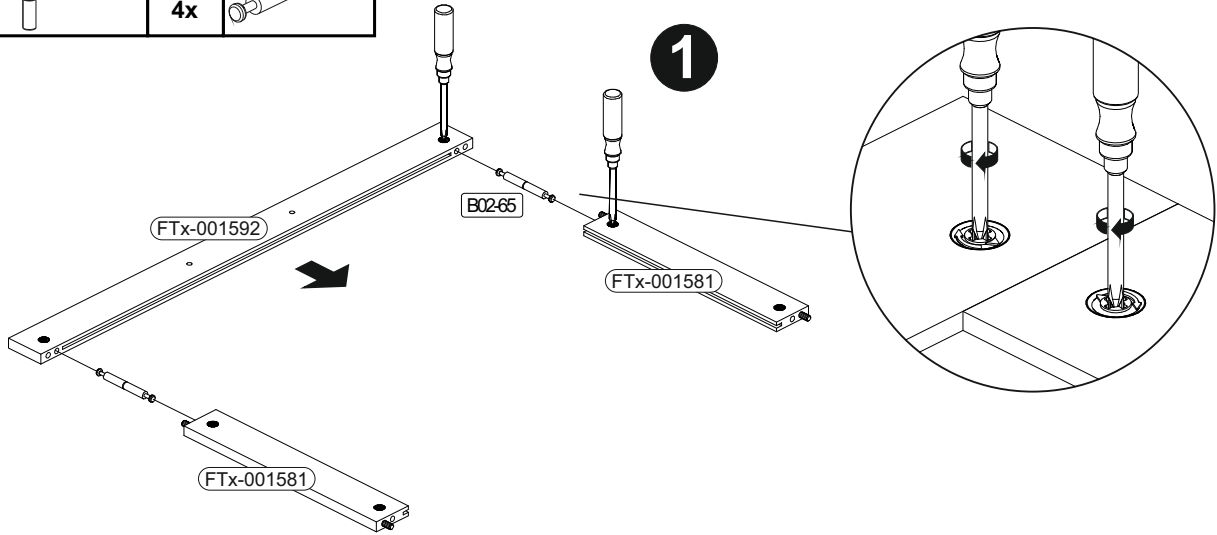
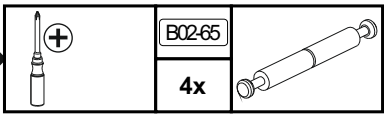

???

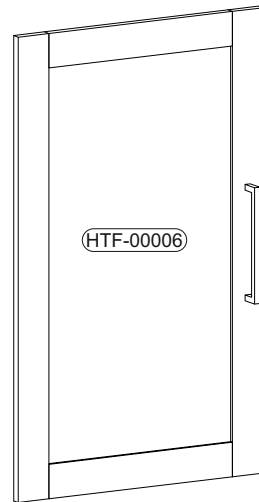

2

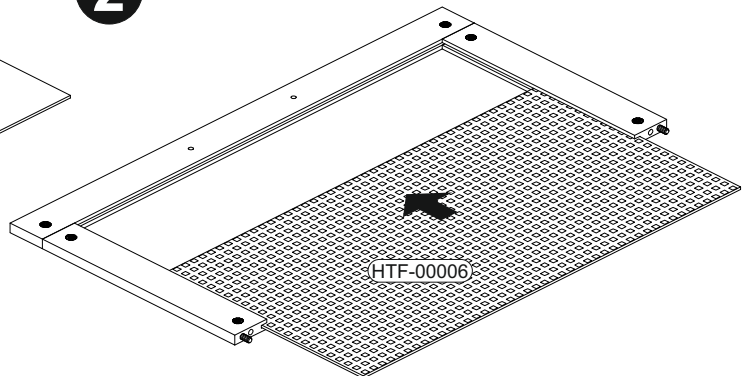
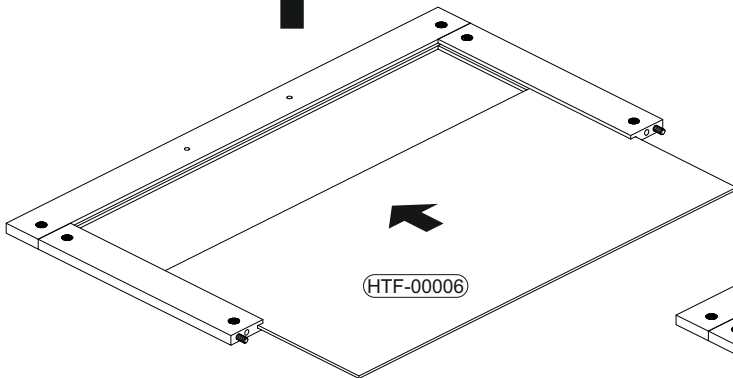



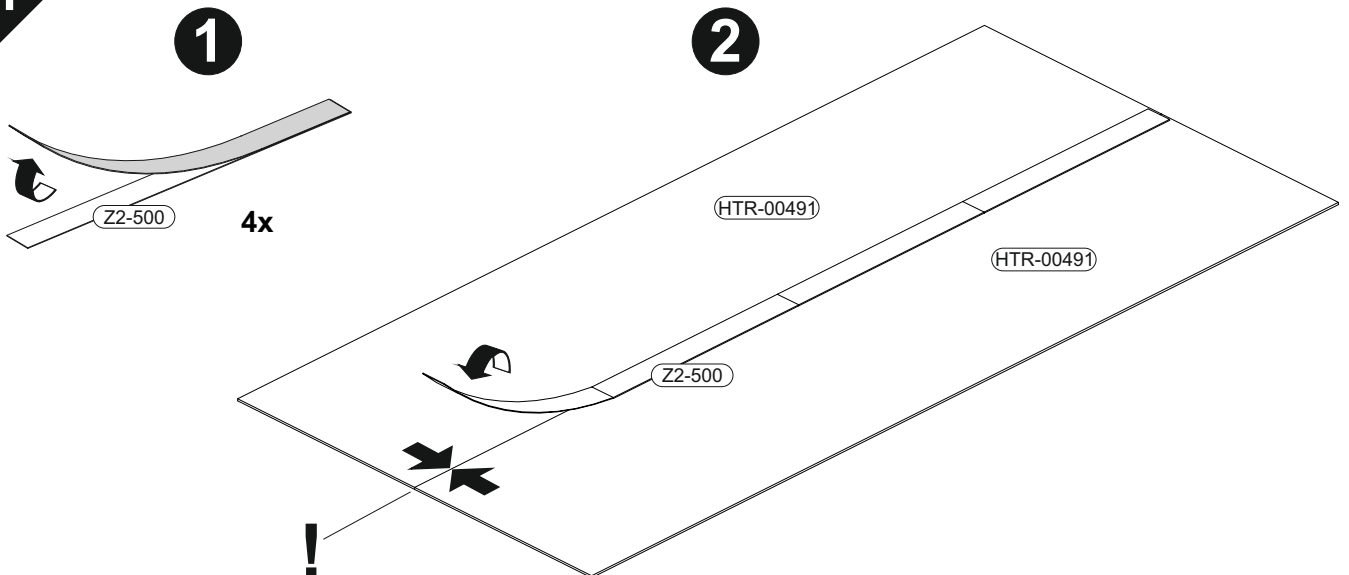
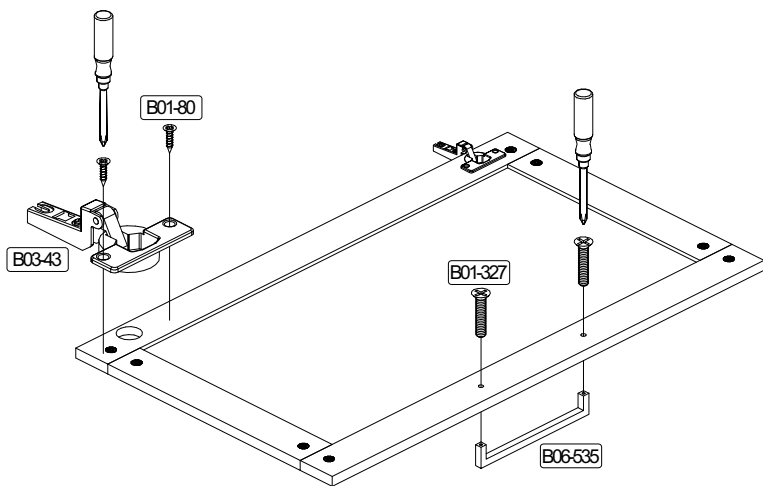
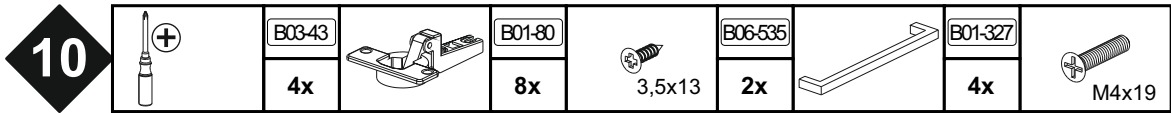
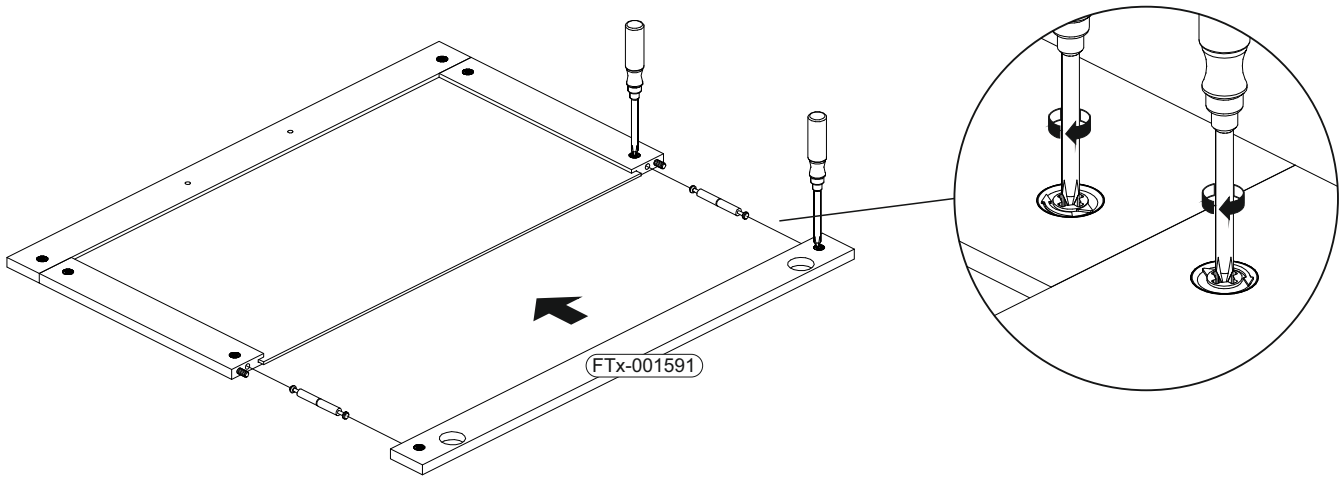
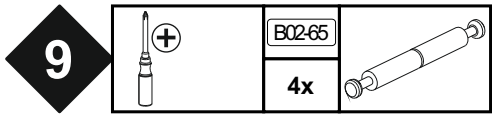

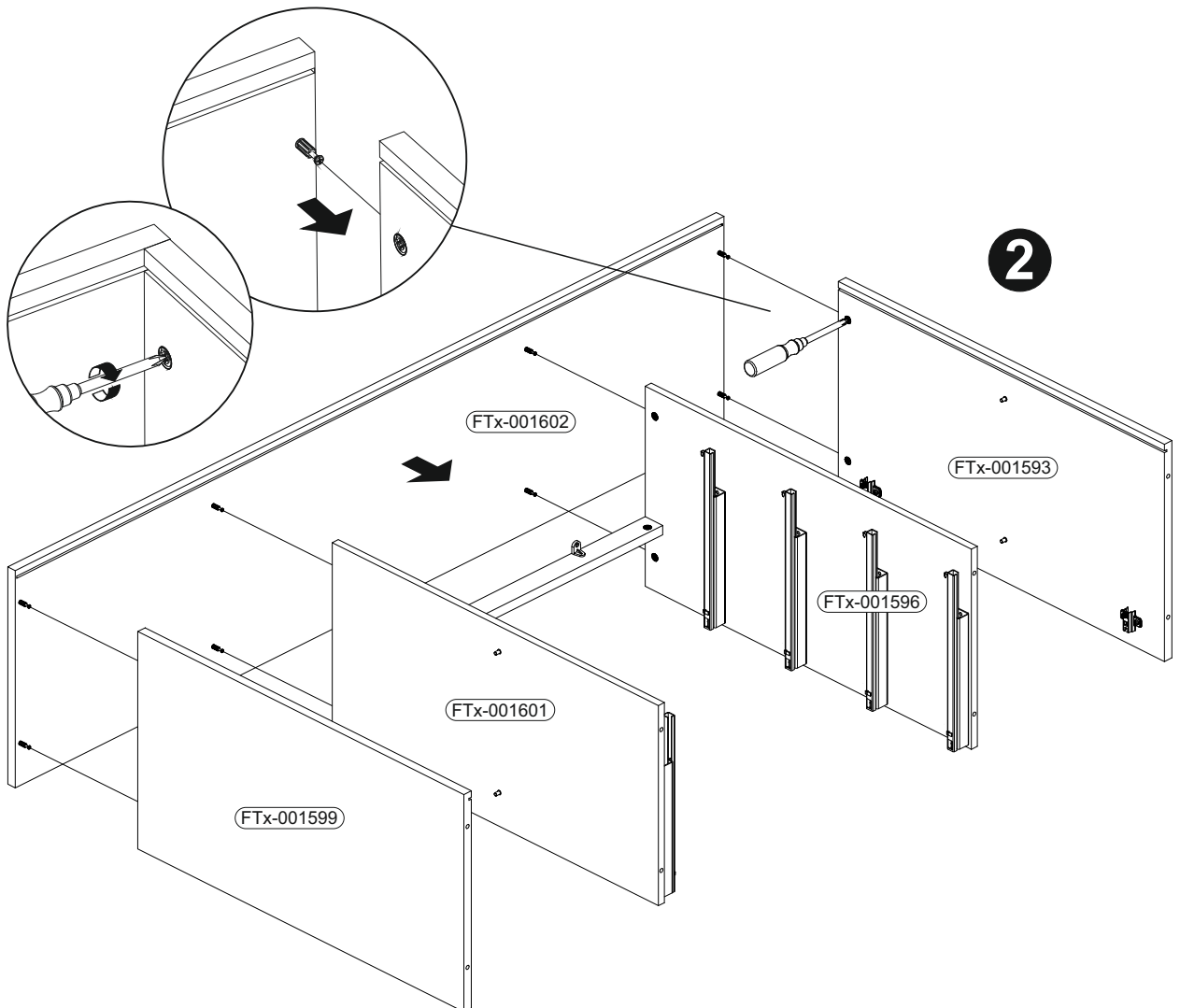
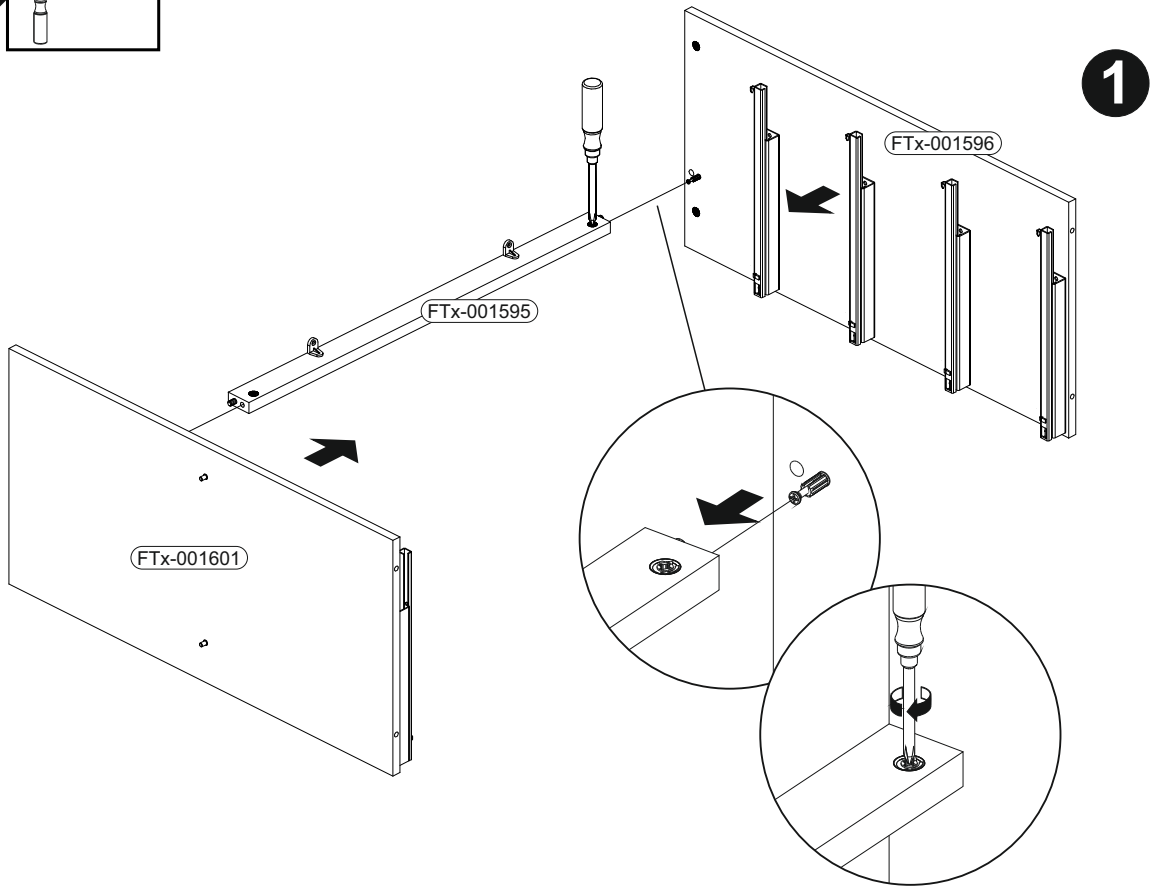
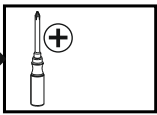

12



13

	B01-90	
	4x	

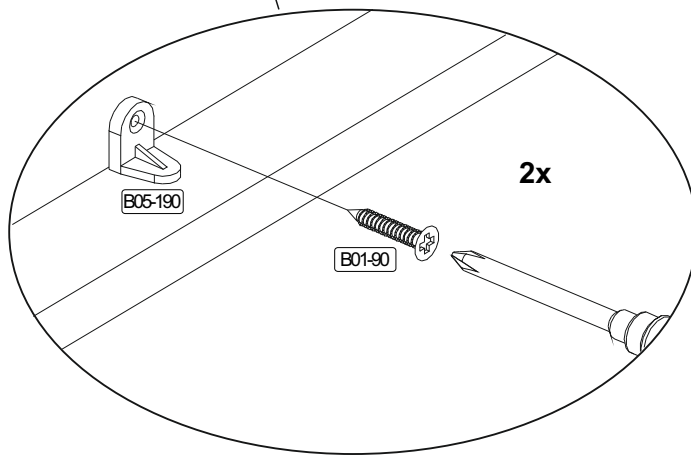
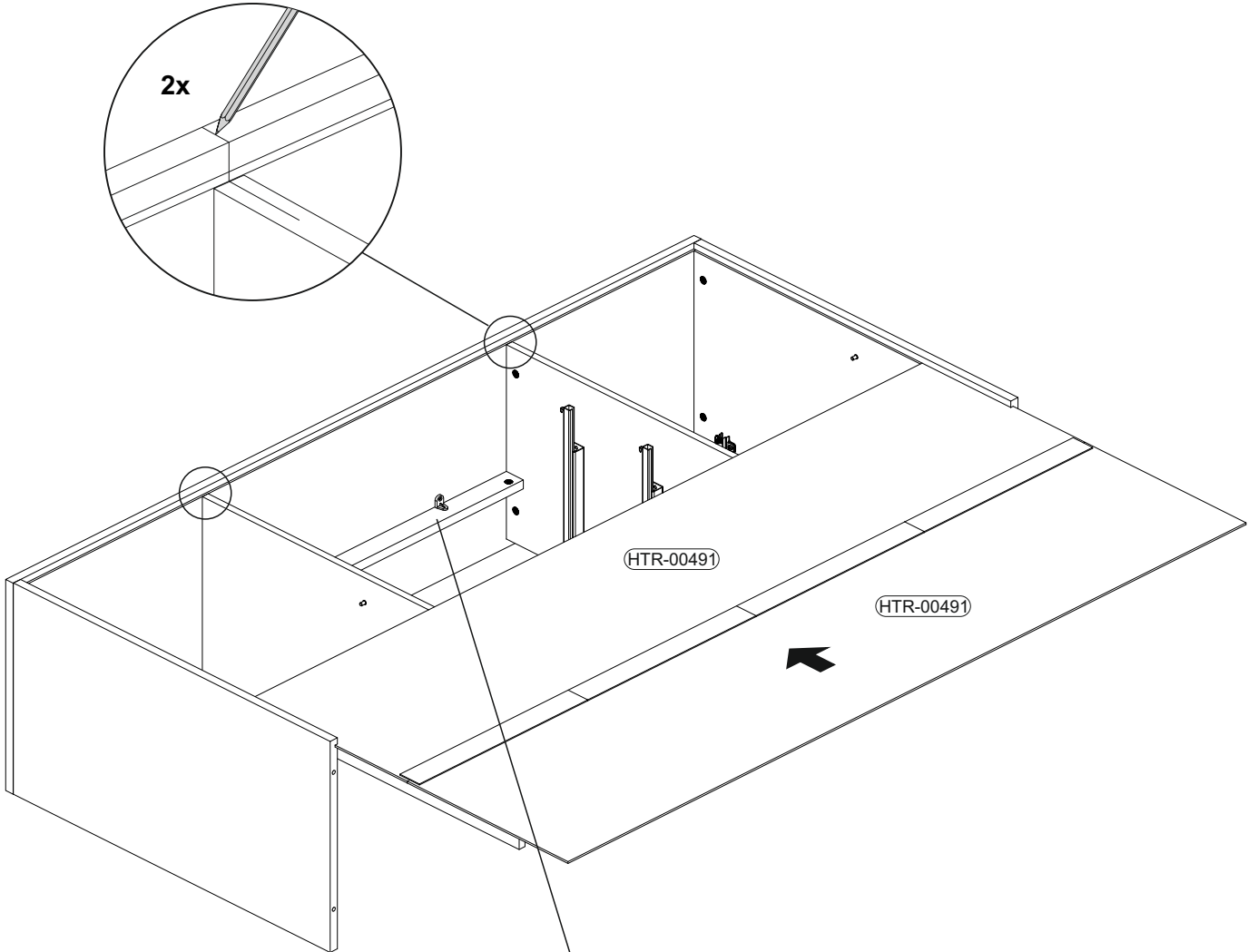

14

	B01-10		6,3x50
	8x		



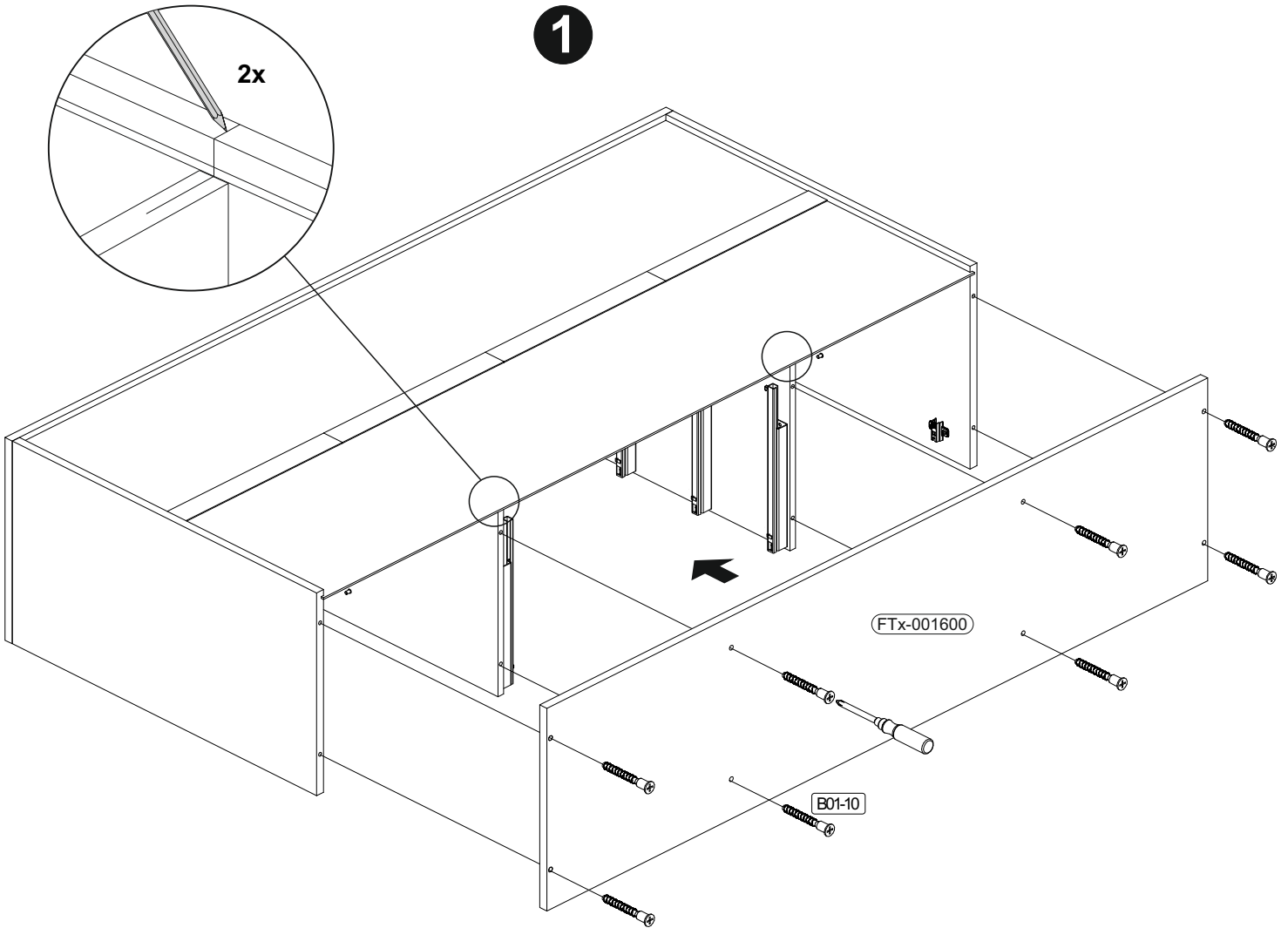



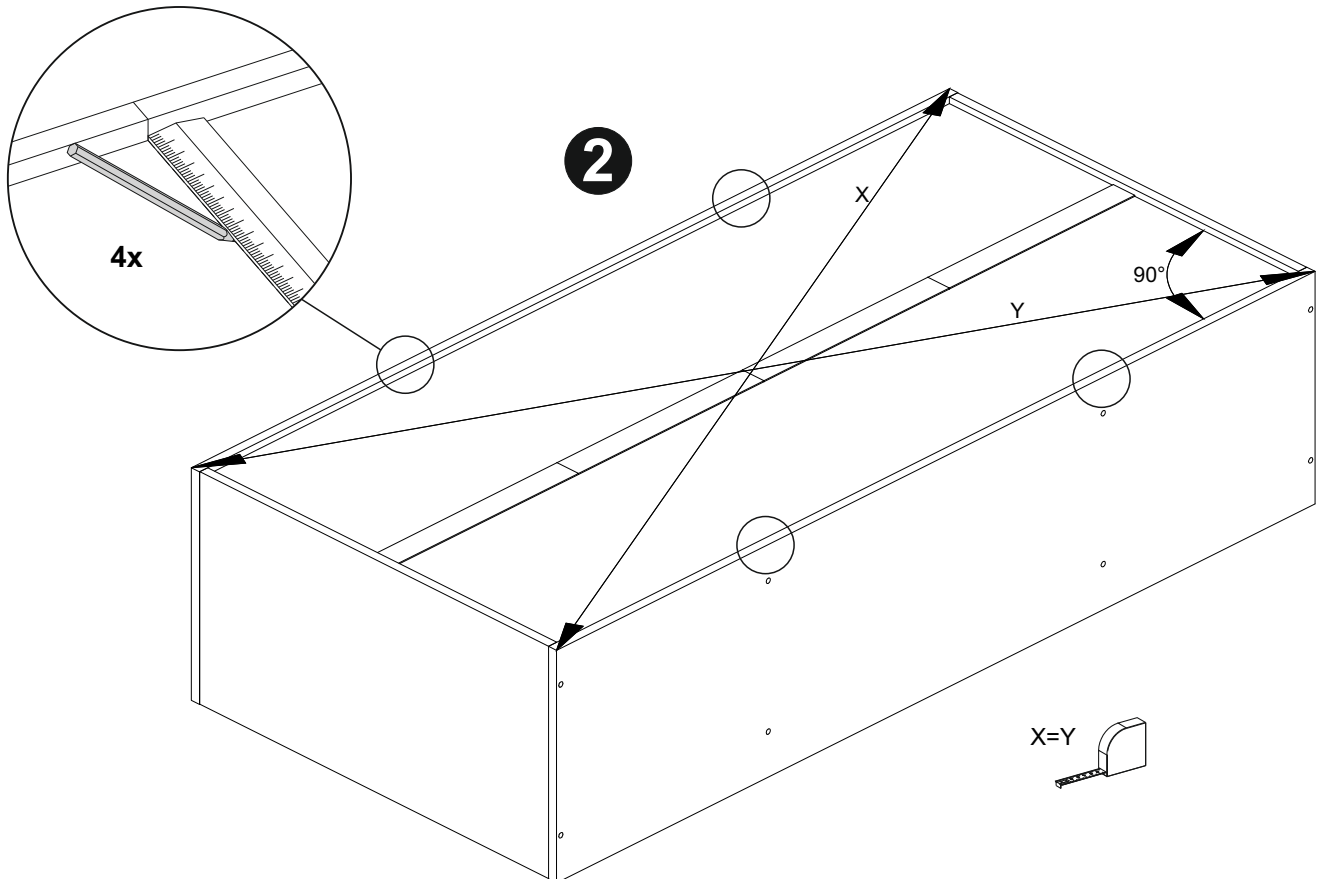

1

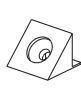

2



15

								
	4x	4x	16x	16x	3x16	8x	16x	4,0x15

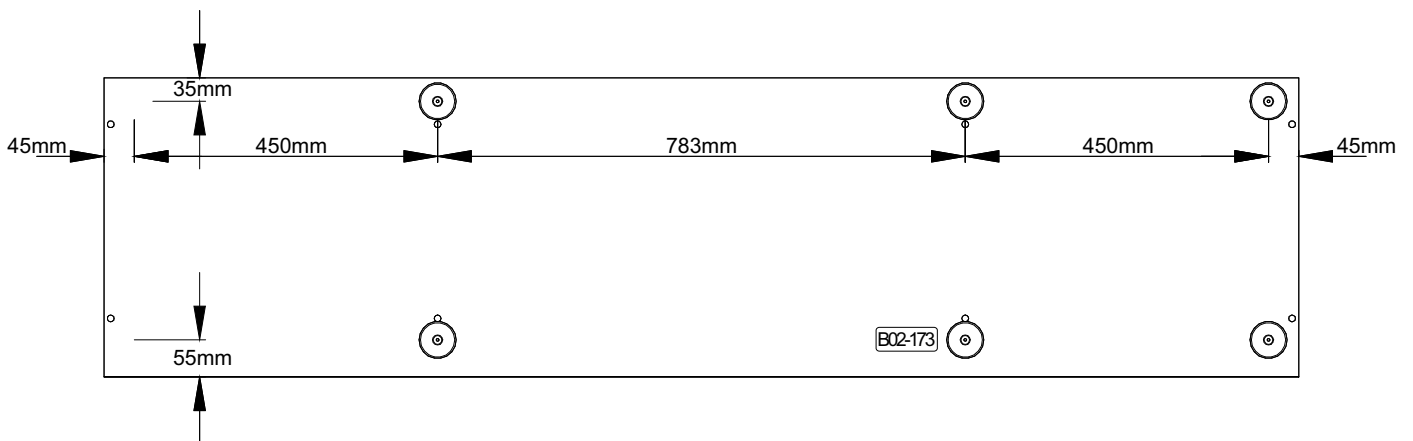
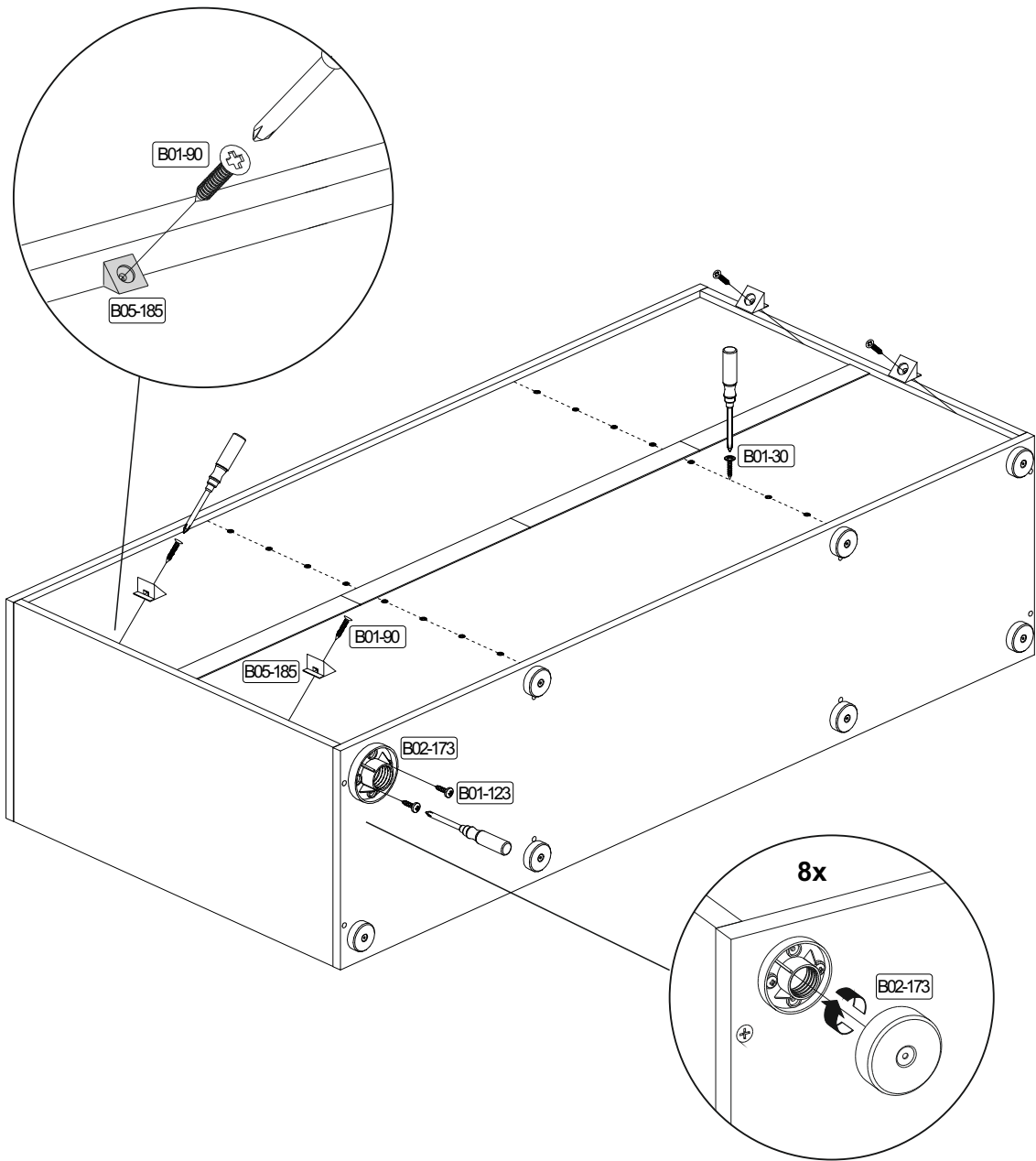

16

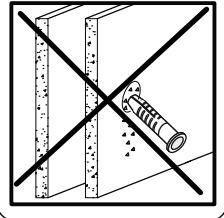
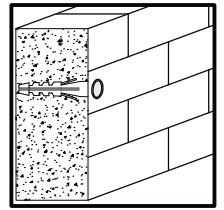
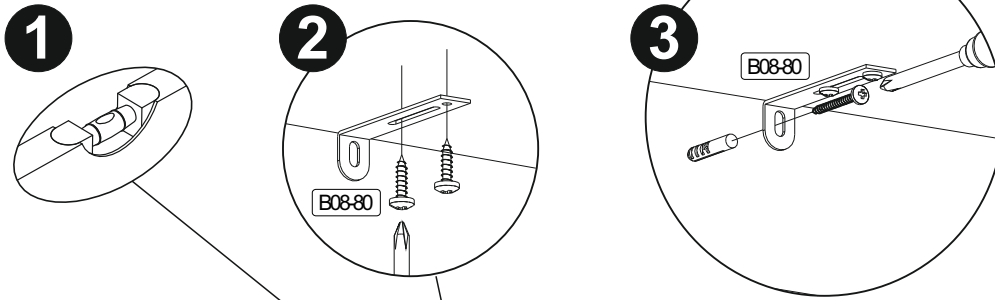
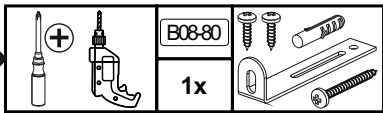

▶ SCAN ME

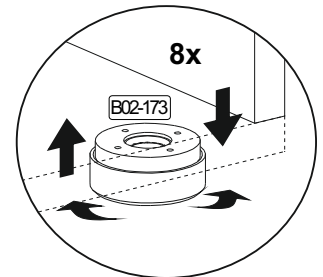
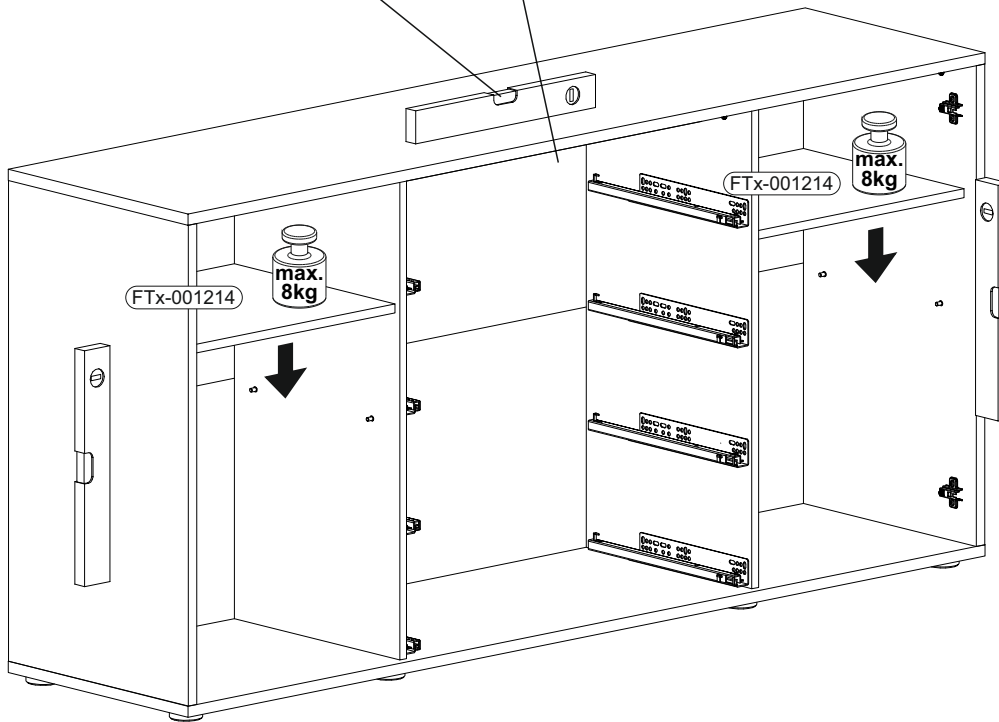

<b>Achtung • Attention • Attenzione • Opgelet • Uwaga • Pozor • Figyelem • Atenție • Dikkat • Внимание</b>	
<b>(D)</b>	Wandbefestigung dient als Kippschutz - unbedingt anbringen! Bei einigen Wandtypen kann ein Spezialdübel erforderlich sein!
<b>(GB)</b>	The wall fastening serves to prevent tipping - be absolutely sure to mount it! For certain wall types, a special wall plug may be necessary!
<b>(FR)</b>	La fixation murale sert de protection contre le basculement – à installer impérativement ! Pour certains types de murs il faut des chevilles spéciales !
<b>(TR)</b>	Duvardaki sabitleme, devrilmeye karşı bir emniyet tedbiridir ve mutlaka monte edilmelidir! Bazı duvar tiplerinde bunun için özel bir dübel gerekli olabilir!
<b>(IT)</b>	Il fissaggio alla parete serve da protezione anti-ribaltamento – attaccarla assolutamente! Per alcune strutture di parete può essere necessario un tassello speciale!
<b>(NL)</b>	Bevestiging aan de muur dient als kantelbescherming – zeker en vast bevestigen! Bij enkele muurtypes is een speciale plug misschien vereist!
<b>(RU)</b>	Обязательно установите крепление на стене во избежание опрокидывания! Для некоторых типов стен может потребоваться специальный дюбель!
<b>(CZ)</b>	Montáž na stěnu slouží jako ochrana proti převrnutí – bezpodmínečně umístěte! U některých typů stěn může být zapotřebí speciální hmoždinka!
<b>(HU)</b>	A termék a falhoz kel rögzíténi, különben az felborulhat! Egyes faltípusoknál speciális tiplit kell használni!
<b>(RO)</b>	Sistemul de fixare la perete servește ca protecție la răsturnare - de montat obligatoriu! Pentru unele tipuri de pereți este posibil să fie necesar un diblu special!
<b>(PL)</b>	Mocowanie do ściany jest jednocześnie zabezpieczeniem przed przewróceniem – koniecznie zamontować! Do niektórych rodzajów ścian konieczne zastosować specjalne kołki mocujące.
<b>(SK)</b>	Upevnenie na stenu slúži ako ochrana proti prevráteniu – bezpodmienečne použite! Pre niektoré druhy stien môže byť potrebná špeciálna hmoždinka!

17

	B05-20	
16x		ø20mm

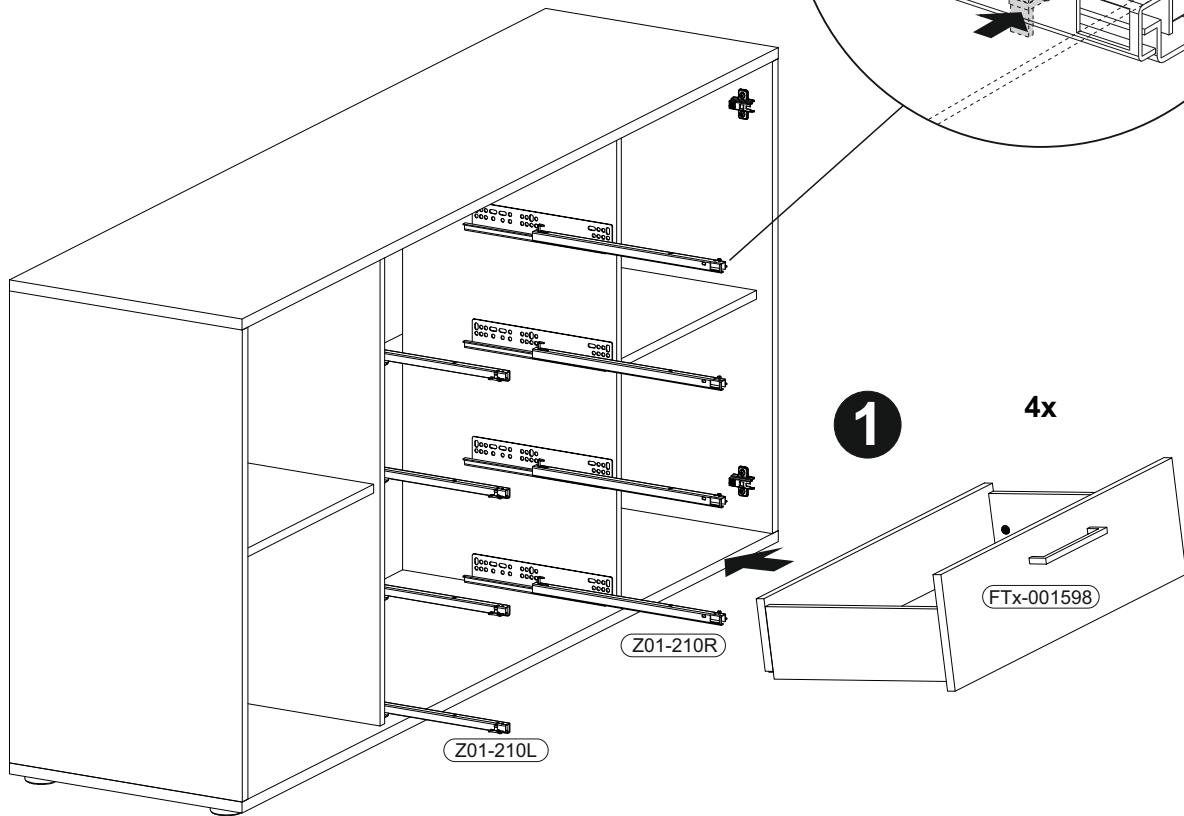
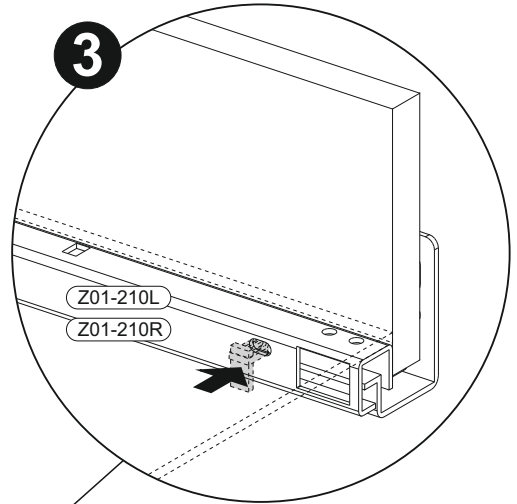
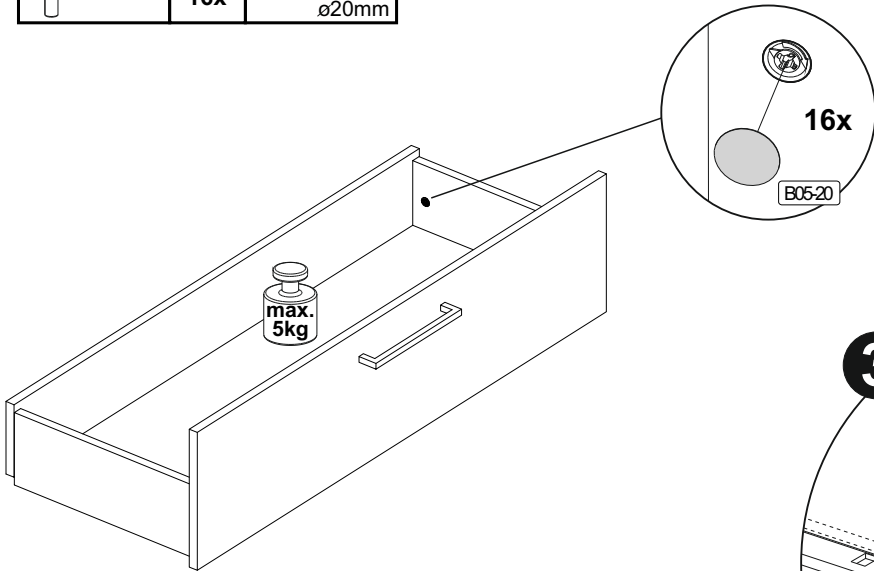

▶ SCAN ME

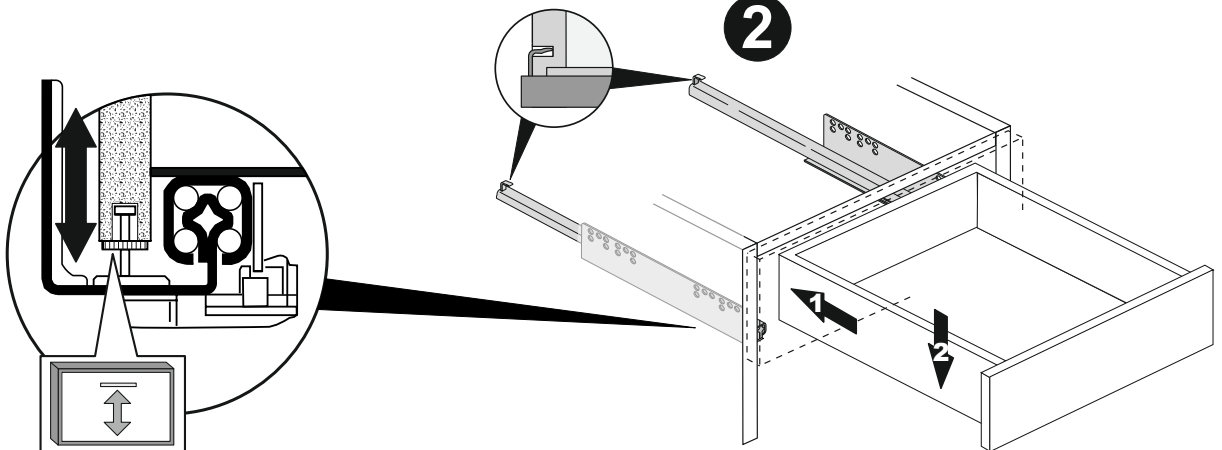

18

	B05-20		B03-07	
	16x	ø20mm	2x	

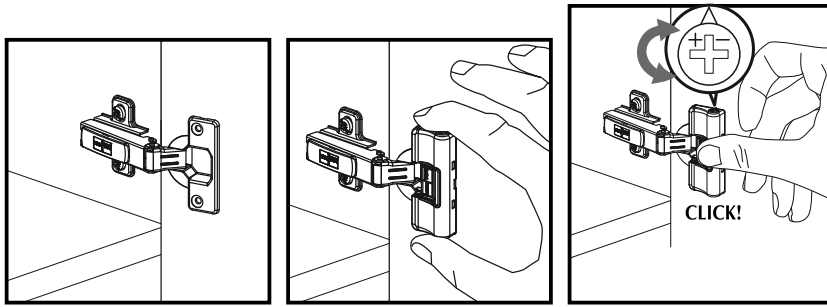

3

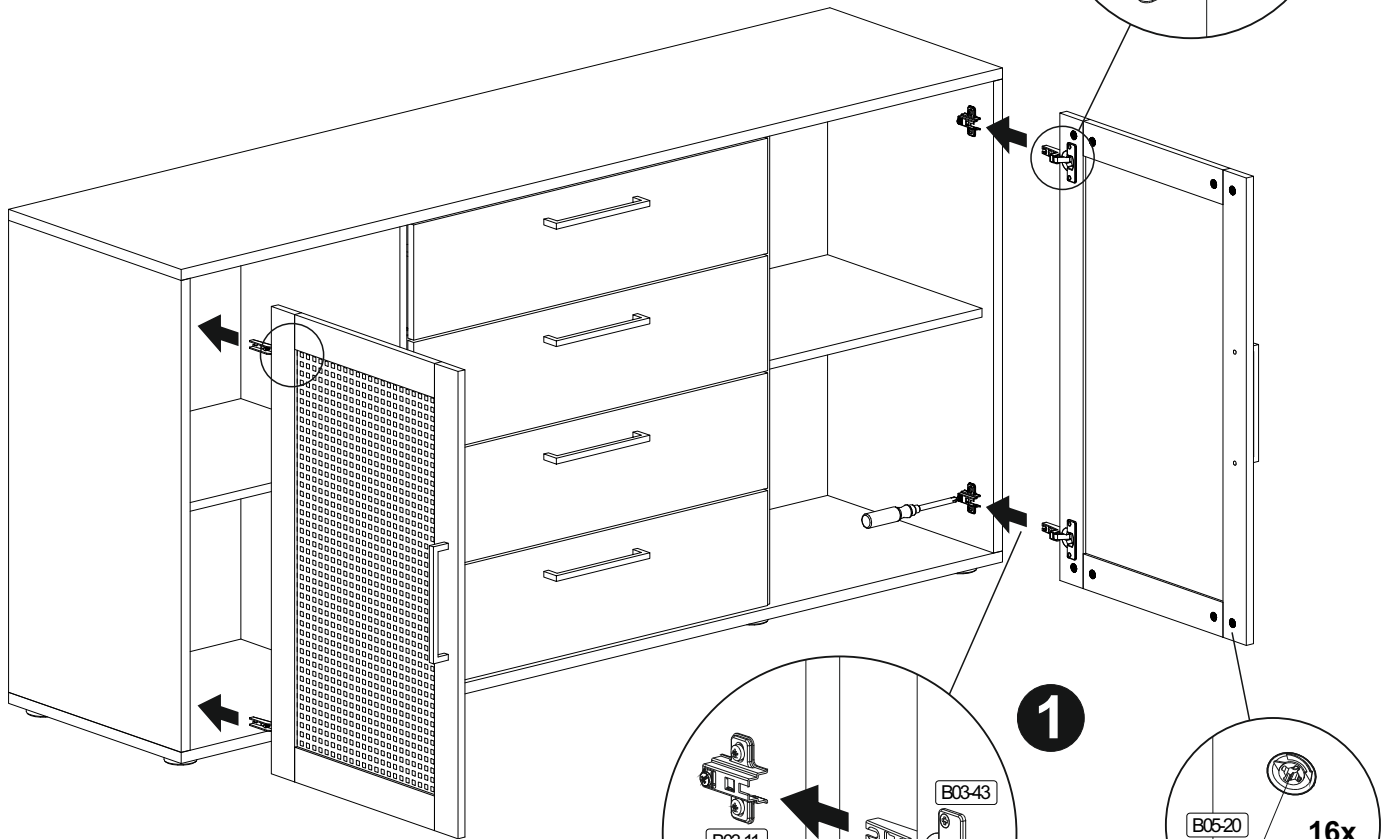
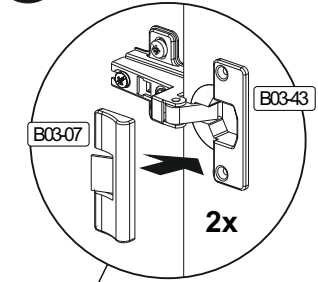

1

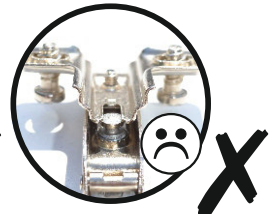
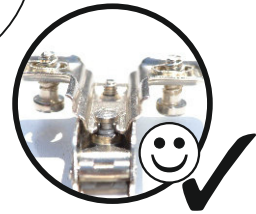
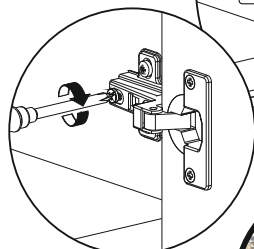

2



SCAN ME

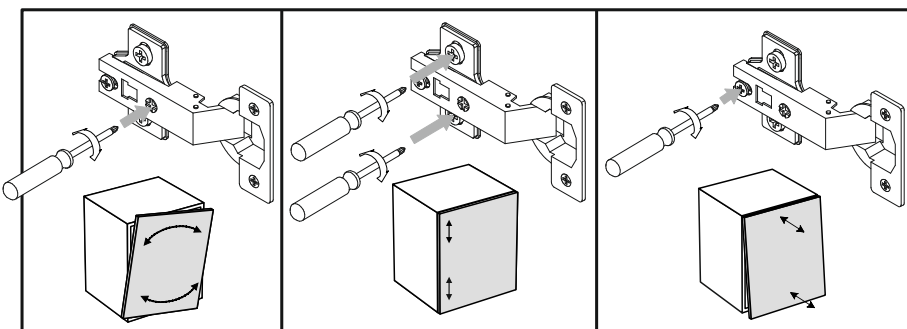



REPC-Nr.:

Service • Assistenza • Dienstverlening • Serwis  
Servis • Szerviz • Сервисная служба

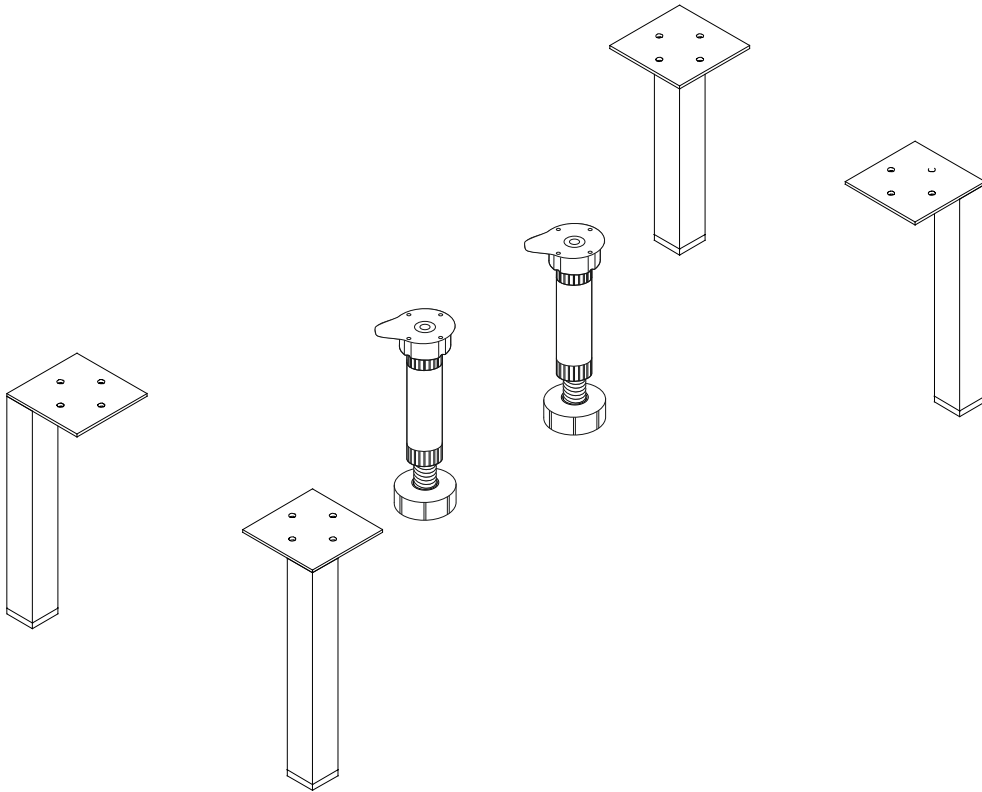

Artikel.-Nr.:

**0800-4er Füße Quadrat**

Montageanleitung.-Nr.:

**MA1-00207**

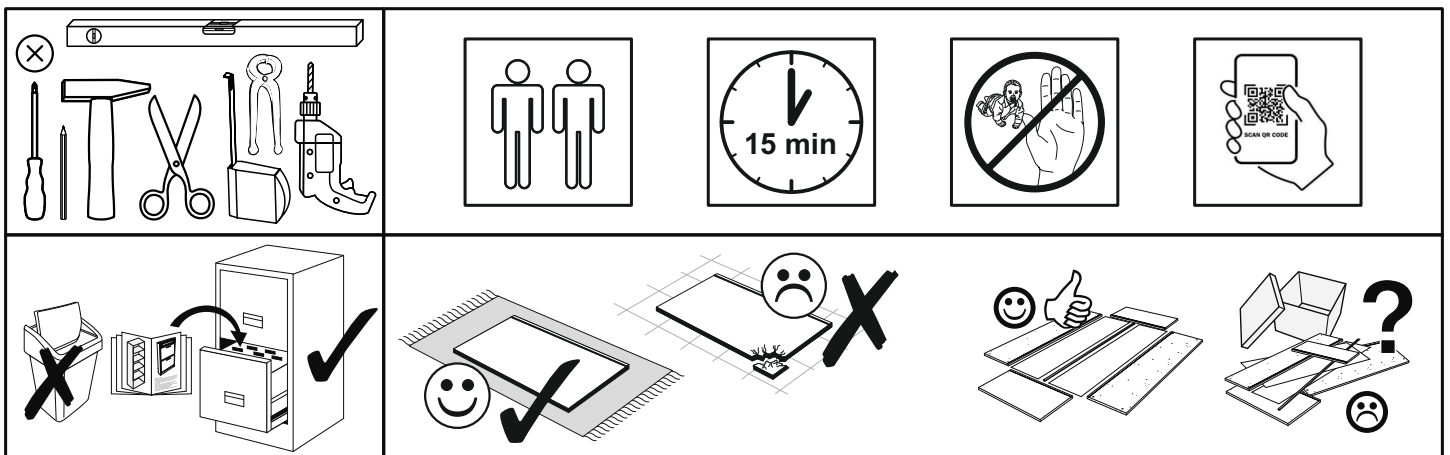

SCAN ME

Das Ersatzteil-Anforderungsformular finden Sie auf  
The replacement parts requisition form you find on  
<https://www.maeusbacher.de/ersatzteile/>

B01-90	
24x	3,5x20

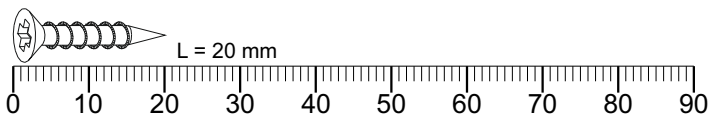

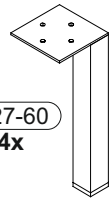
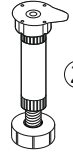
	
Z27-60 4x	Z03-100 2x
150x20x20mm	136-170mm

**1**



B01-90	
24x	3,5x20

